

BAD AXE, ENGLER FIELD (E53)

B

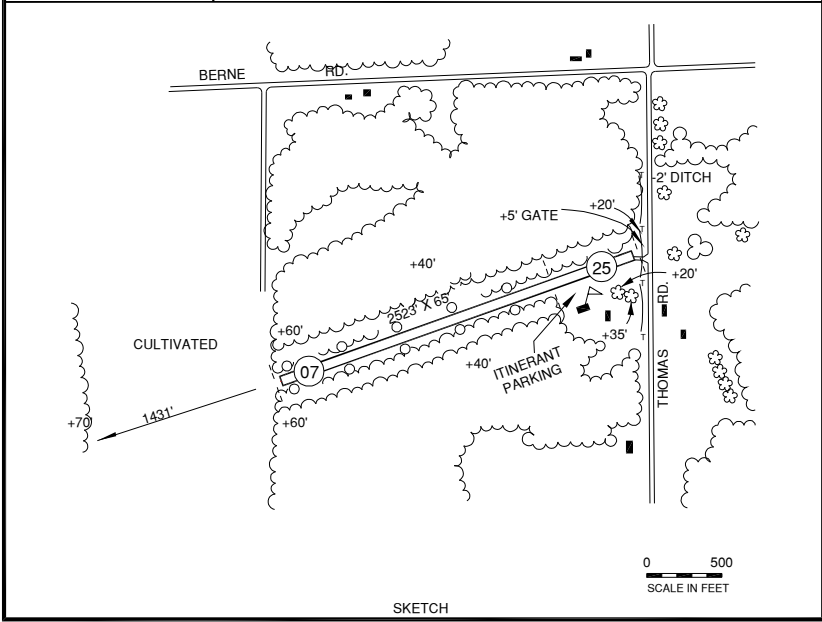
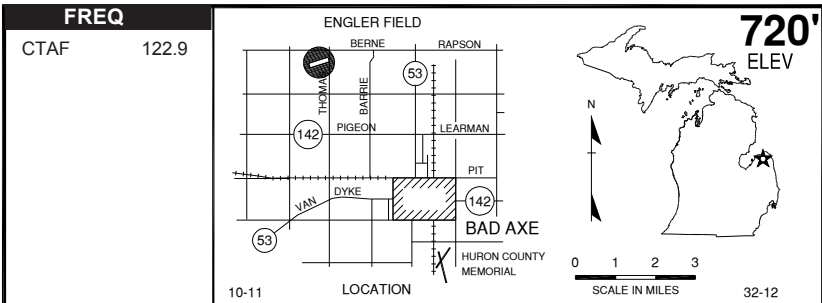

RWY LENGTH BEYOND DISPLACED THR
 07/ —
 25/ 1948

COORDINATES
 43° 50.77' N
 083° 02.81' W

License
 Basic Utility

FM CITY: 4.0 mi NW
LGT: LIRL (NSTD*) not for public use
MGR: Alan Engler
PH: 989-269-8815
FBO: None
ATND: Intmt, owner resides at arpt

NAV AIDS: 108.2 (BAX) 338° 4.0 NM to fld.
FUEL: None
RPR: None
WX: None
SNW RMVL: Ireg-vfy
TRNSP: None
MEALS: In town, 4.0 mi
RON: In town, 4.0 mi

- Caution, P-Lines in NE apch.
- Crops W of rwy 07/25 can grow to be 7 ft during growing season.
- *NSTD LIRL. first 575' rwy 25 not lighted.
- +5' gate 40 ft east of rwy.

BAD AXE, HURON COUNTY MEM. (BAX)

B

FREQ	
VOR	108.2
AWOS	118.600
CTAF/U	122.975
LANSING FSS	
RCO	122.65
CLEVELAND	
CTR	127.7

HURON COUNTY MEMORIAL

9-11 LOCATION

SCALE IN MILES

763'
ELEV

09532.A
32-02

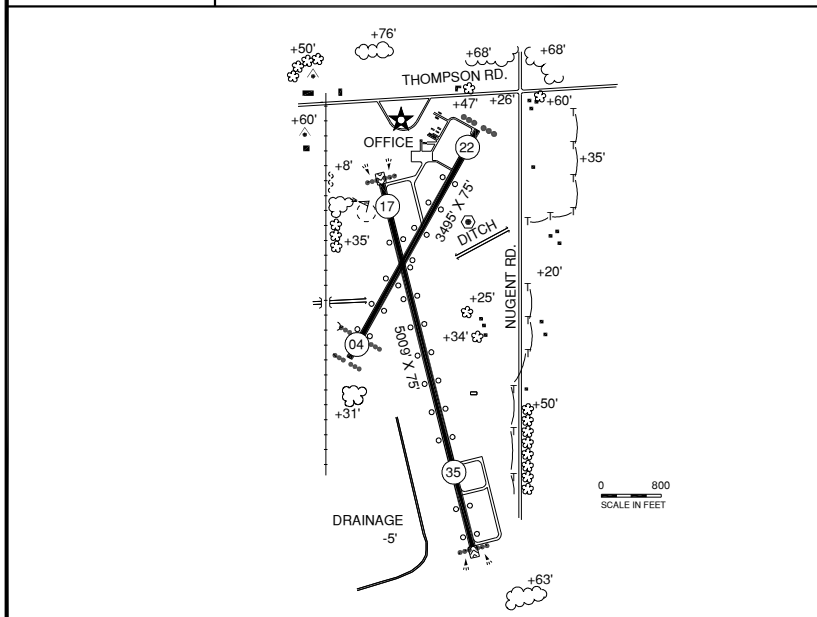

RWY LENGTH BEYOND DISPLACED THR

17/ — * 04/ 3195
35/ — * 22/ —

COORDINATES

43° 46.86N
082° 59.14W

License

General Utility

FM CITY: 1.0 mi S

LGT: ROTG BCN, NSTD* MIRL (10% intsty). For 100% intsty MIRL, PAPI, REIL, std pcl CTAF

MGR: Ellen M. Engler

PH: 989-269-6511

989-269-6404 (Rd Comm)

FBO: Engler Avn 989-269-6349 (fax)

Bowman Avn, LLC 989-553-1519

ATND: 0830-1630, Unatnd major hol aft hrs call 989-269-8815

NAV AIDS: IAP, 108.2 (BAX) at fld.

FUEL: 100LL, JET A

RPR: Major A&P by appointment

WX: AWOS 989-269-4137

WX Briefing System

SNW RMVL: Yes

TRNSP: Thumb Area Transit, weekdays 800-

322-1125, bicycles

MEALS: In town, 1.0 mi

RON: In town, 1.0 mi

- Admin bldg access—depress V, then simultaneous III-II, then I.
- Birds on & invof arpt.
- NSTD MIRL. Last 2000' not split amber/white lens.

BALDWIN MUNICIPAL (7D3)

B

<p>FREQ</p> <p>CTAF 122.9</p> <p>MINN CNTR 120.85</p>	<p>9-11 LOCATION</p>	<p>828' ELEV</p> <p>09536.A 43-01</p>
--	----------------------	--

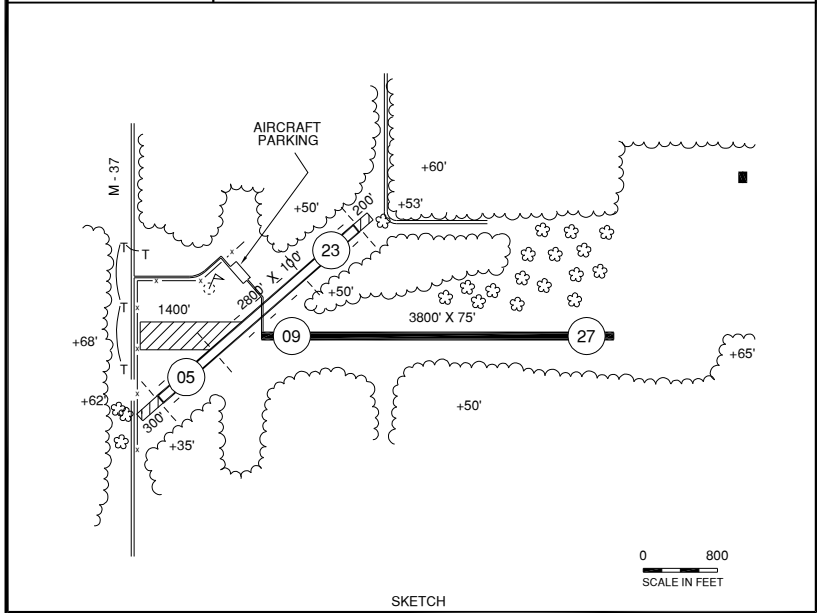

RWY LENGTH BEYOND DISPLACED THR

05/ 2000' * 09/ —
23/ 2000' * 27/ —

COORDINATES

43° 52.53'N
085° 50.53'W

License
Basic Utility

FM CITY: 2.0 S

LGT: None

MGR: James A. Rock

PH: 231-745-4511
231-745-7453 (Mgr Res)
231-745-7738 (Village Hall)

FBO: None

ATND: Unatnd
CLSD Nov-Apr & when snw coverd

NAV AIDS: IAP, 117.6 (HIC) 344° 18.9 NM to fld.

FUEL: None

RPR: None

WX: None

SNW RMVL: No

TRNSP: None

MEALS: In town, 1.0 mi

RON: In town, 0.5 mi

- Rwy 9-27 considerable pavement cracking with vegetation growing through cracks.
- Deer on & invof arpt.

