

MICHIGAN AIRPORT DEVELOPMENT PROGRAM

AIP CAPITAL IMPROVEMENT PLAN 2012-2022



Luce County Airport Newberry, MI

Date of Latest ALP - **1990**
ACIP Airport Code - **D**
Airport Identifier - **ERY**

MDOT-AERO
2700 E AIRPORT SERVICE DRIVE
LANSING, MICHIGAN 48906

Prepared by: URS Corporation
Sponsor: County of Luce
Submitted by: Jay Hollnagel
Date: October 28, 2011

TEN-YEAR AIRPORT CAPITAL IMPROVEMENT PROGRAM (CIP) FY-2012 to FY-2022

Luce County Airport ERY

Year	Project Description	Cost*	Remarks/Item Justification
2012	Available Federal Entitlements (NPE) \$180,000 (\$30,000 Carryover from 2011)		
	Truck with Underbody Plow	\$ 155,000	New Truck is needed to replace existing aging equipment. Existing equipment consists of: Ford Series 9000 single axle with front plow and belly blade bought with local funds and a Terex model sk1873 with Tenneco snow blower purchased with grant funds in 2003. The airport would like to replace the Ford truck with a similar item. The airport relies heavily on the plow because the Terex does not have a belly blade and is not a sufficient single plow vehicle due to local snow load and icing conditions. Truck will be single axle diesel, with front directional plow, adjustable weight, belly blade, and sweeper attachment.
	Fed \$147,250 - State \$3,875 - Local \$3,875 - Total \$155,000 Carryover \$32,750		
2013	Available Federal Entitlements (NPE) \$182,750		
	AWOS Component Replacement	\$ 60,000	Existing AWOS parts have exceeded their useful life. Current parts will be used to replace existing on existing mounts.
	User Survey Consultant Coordination	\$ 10,000	Work will consist of distributing and compiling user survey forms and other operational data for MDOT to prepare the User Survey for justification for the runway extension. Data will be purchased from Flight Aware for airport data.
	Fed \$66,500 - State \$1,750 - Local \$1,750 - Total \$70,000 Carryover \$116,250		
2014	Available Federal Entitlements (NPE) \$266,250		
	EA for Runway 18/36 Construction	\$ 115,000	EA needed for new paved north/south runway. Will cover both future and ultimate length up to 5000'. Preliminary engineering will be done to support the EA.
	Land Acquisition for Rwy 18/36 Construction	\$ 160,000	Land may be needed for approach clearing for the new 18/36 Runway. Once planning is complete this task will be updated with detailed costs.
	Fed \$261,250 - State \$6,875 - Local \$6,875 - Total \$275,000 Carryover \$5,000		
2015	Available Federal Entitlements (NPE) \$155,000		
	Design for Runway 18/36	\$ 80,000	Design Runway for following year construction
	Fed \$76,000 - State \$2,000 - Local \$2,000 - Total \$80,000 Carryover \$79,000		
2016	Available Federal Entitlements (NPE) \$229,000		
	Phase I Runway 18/36 Turf (3,200'x100')	\$ 290,000	Cross wind runway will provide additional capacity during strong Northerly Cross winds. In the winter aircraft are unable to use the primary runway due to the strong cross winds. Initial construction will be for a turf runway. Grading done for this phase will be cut through a small hill. Material will be placed in low area to the north to begin fill for ultimate 5000' paved runway.
	Fed \$275,500 - State \$7,250 - Local \$7,250 - Total \$290,000 Funds in addition to NPE are needed for this year.		
2017	Available Federal Entitlements (NPE) \$150,000		
	Phase II Runway 18/36 Paving and Lighting (3,200'x75')	\$ 1,660,000	Cross wind runway will provide additional capacity during strong Northerly Cross winds. In the winter aircraft are unable to use the primary runway due to the strong cross winds. Project will pave and light turf runway.
	Fed \$1,577,000 - State \$41,500 - Local \$41,500 - Total \$1,660,000 Funds in addition to NPE are needed for this year.		
2018	Available Federal Entitlements (NPE) \$150,000		
	PFC Runway 11/29	\$ 373,000	Existing pavement needs to be sealed and PFC will preserve existing pavement for 6-8 additional years before resurfacing is needed.
	Replace Rwy 11/29 MIRL and Pave Shoulders	\$ 430,000	A new LED lighting system will be provided for energy efficiency. Previous rehabilitation was completed in 2004. Paved shoulders are needed to facilitate snow removal on the runway. This is especially critical for medical flights in the winter when the snow must be cleared quickly on the runway. Heavy snow in this region makes paved shoulders a more critical feature for this airport.
	Fed \$762,850 - State \$20,075 - Local \$20,075 - Total \$803,000 Funds in addition to NPE are needed for this year.		
2019	Available Federal Entitlements (NPE) \$150,000		
	Land Acquisition for Rwy 18/36 Extension (DNR)	\$ 100,000	Land will be needed for the 18/36 Runway Extension. Once ALP update planning is complete this task will be updated with detailed costs.
	Fed \$95,000 - State \$2,500 - Local \$2,500 - Total \$100,000 Carryover \$0		
2020	Available Federal Entitlements (NPE) \$205,000		
	Terminal Building	\$ 215,000	A new terminal building is needed at the airport. Current building is a trailer with county offices. There is no dedicated terminal building.
	Fed \$204,250 - State \$5,375 - Local \$5,375 - Total \$215,000 Carryover \$750		
2021	Available Federal Entitlements (NPE) \$150,750		
	LED REIL and Beacon with Wind Turbine	\$ 158,000	Project will provide energy savings and power generation for the airport. LED lighting is more efficient and long lasting which reduces down time from burnt out bulbs. LED REIL is able to run on lower power which makes it safer and cheaper to provide maintenance. Wind turbine on the beacon tower will provide power generation for the airport. Mounting the turbine on the existing tower will ensure that no obstruction is created and will reduce the installation cost for the turbine.
	Fed \$150,100 - State \$3,950 - Local \$3,950 - Total \$158,000 Carryover \$650		
2022	Available Federal Entitlements (NPE) \$150,650		
	Extend Runway 18/36 to 5000 LFT	\$ 910,000	Airport requires a 5000' Runway to provide needed runway length for jet traffic. Fed. Ex. has expressed interest in the past in using this site for air transport. The airport will work to obtain letters from users to justify the need for this extension.
	Fed \$864,500 - State \$22,750 - Local \$22,750 - Total \$910,000 Funds in addition to NPE are needed for this year.		

* Includes Federal Cost of 95%, State Cost of 2.5%, and Local Cost of 2.5%. When costs exceed available Federal Entitlements (NPE), additional funding will be needed from Federal Apportionment or Federal Discretionary funds.

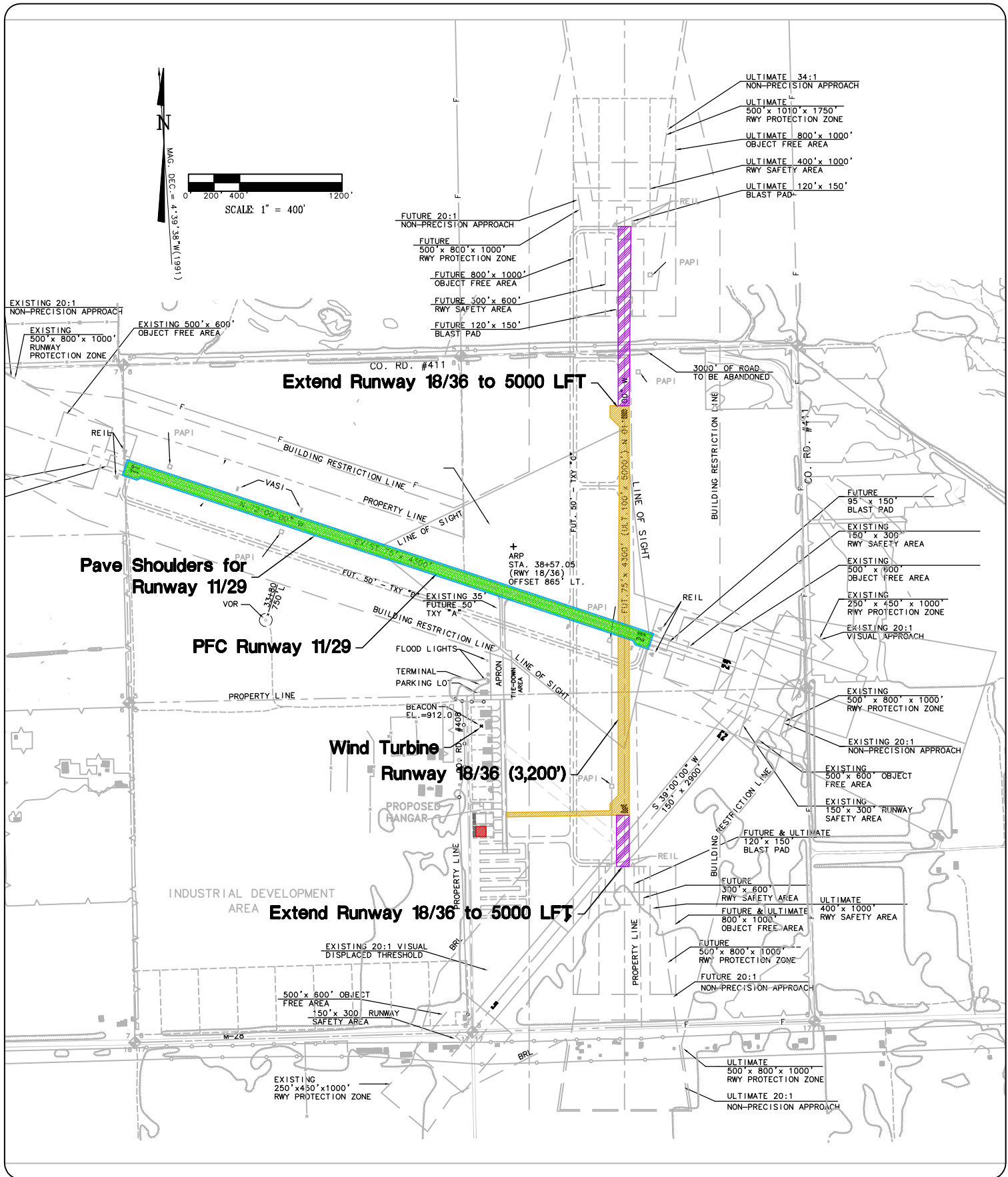

MICHIGAN STATE BLOCK GRANT PROGRAM
TEN-YEAR AIRPORT CAPITAL IMPROVEMENT PROGRAM (CIP) FY-2012* to FY-2022

*ACIP includes current development year (2012 already programmed - minor changes acceptable)

Airport Name: Luce County Airport	Date prepared: 10-28-11
Associated City: Newberry, MI	Prepared By: URS Corporation
Sponsor: County of Luce	Sponsor email address & phone: 906-293-2926 lucescountyairport@yahoo.com
Airport Identifier: ERY	FINAL ACIP due to MDOT AERO: no later than 12/1/11

Development Year	Project Description	Shown on ALP? (Yes or No)	ACIP Code**	NPIAS Priority Rating**	Federal Entitlements	Federal Apportionment	Federal Discretionary	State	Local	Total	Remarks/Item Justification - Provide as much detail as possible.	
2012					<i>Available Entitlements</i>	\$ 180,000	(\$150,000 NPE plus \$30,000 NPE carryover from 2011.)					
	Truck with Underbody Plow	NA	ST-EQ-SN	44	\$ 147,250	\$ -		\$ 3,875	\$ 3,875	\$ 155,000	New Truck is needed to replace existing aging equipment. Existing equipment consists of: Ford Series 9000 single axle with front plow and belly blade bought with local funds and a Terex model sk1873 with Tenneco snow blower purchased with grant funds in 2003. The airport would like to replace the Ford truck with a similar item. The airport relies heavily on the plow because the Terex does not have a belly blade and is not a sufficient single plow vehicle due to local snow load and icing conditions. Truck will be single axle diesel, with front directional plow, adjustable weight, belly blade, and sweeper attachment.	
					\$ -	\$ -				\$ -		
					\$ -	\$ -				\$ -		
					<i>Carryover</i>	\$ 32,750						
2013					<i>Available Entitlements</i>	\$ 182,750						
	AWOS Component Replacement	Yes	ST-EQ-WX	42	\$ 57,000	\$ -		\$ 1,500	\$ 1,500	\$ 60,000	Existing AWOS parts have exceeded their useful life. Current parts will be used to replace existing on existing mounts.	
	User Survey Consultant Coordination	Yes	PL-PL-MA	62	\$ 9,500	\$ -		\$ 250	\$ 250	\$ 10,000	Work will consist of distributing and compiling user survey forms and other operational data for MDOT to prepare the User Survey for justification for the crosswind runway. Data will be purchased from Flight Aware for airport data.	
					\$ -	\$ -				\$ -		
					<i>Carryover</i>	\$ 116,250						
2014					<i>Available Entitlements</i>	\$ 266,250						
	EA for Runway 18/36 Construction	Yes	CA-RW-CO	59	\$ 109,250	\$ -		\$ 2,875	\$ 2,875	\$ 115,000	EA needed for new paved north/south runway. Will cover both future and ultimate length up to 5000'. Preliminary engineering will be done to support the EA.	
	Land Acquisition for Rwy 18/36 Construction	Project will be shown on ALP update.	CA-RW-CO	59	\$ 152,000	\$ -		\$ 4,000	\$ 4,000	\$ 160,000	Land may be needed for approach clearing for the new 18/36 Runway. Once planning is complete this task will be updated with detailed costs.	
					\$ -	\$ -				\$ -		
					<i>Carryover</i>	\$ 5,000						
2015					<i>Available Entitlements</i>	\$ 155,000						
	Design for Runway 18/36	Yes	CA-RW-CO	59	\$ 76,000	\$ -		\$ 2,000	\$ 2,000	\$ 80,000	Design Runway for following year construction	
					\$ -	\$ -				\$ -		
					\$ -	\$ -				\$ -		
					<i>Carryover</i>	\$ 79,000						
2016					<i>Available Entitlements</i>	\$ 229,000						
	Phase I Runway 18/36 Turf (3,200'x100')	Yes	CA-RW-CO	59	\$ 229,000	\$ 46,500		\$ 7,250	\$ 7,250	\$ 290,000	Cross wind runway will provide additional capacity during strong Northerly Cross winds. In the winter aircraft are unable to use the primary runway due to the strong cross winds. Initial construction will be for a turf runway. Grading done for this phase will be cut through a small hill. Material will be placed in low area to the north to begin fill for ultimate 5000' paved runway.	
					\$ -	\$ -				\$ -		
					\$ -	\$ -				\$ -		
					<i>Carryover</i>	\$ -						
2017					<i>Available Entitlements</i>	\$ 150,000						
	Phase II Runway 18/36 Paving and Lighting (3,200'x75')	Yes	CA-RW-CO	59	\$ 150,000	\$ 1,427,000		\$ 41,500	\$ 41,500	\$ 1,660,000	Cross wind runway will provide additional capacity during strong Northerly Cross winds. In the winter aircraft are unable to use the primary runway due to the strong cross winds. Project will pave and light turf runway.	
					\$ -	\$ -				\$ -		
					\$ -	\$ -				\$ -		
					<i>Carryover</i>	\$ -						
2018					<i>Available Entitlements</i>	\$ 150,000						
	PFC Runway 11/29	Yes	RE-RW-IM	66	\$ 150,000	\$ 204,350		\$ 9,325	\$ 9,325	\$ 373,000	Existing pavement needs to be sealed and PFC will preserve existing pavement for 6-8 additional years before resurfacing is needed.	
	Replace Rwy 11/29 MIRL and Pave Shoulders	Project will be shown on ALP update.	RE-RW-LI	66	\$ -	\$ 408,500		\$ 10,750	\$ 10,750	\$ 430,000	A new LED lighting system will be provided for energy efficiency. Previous rehabilitation was completed in 2004. Paved shoulders are needed to facilitate snow removal on the runway. This is especially critical for medical flights in the winter when the snow must be cleared quickly on the runway. Heavy snow in this region makes paved shoulders a more critical feature for this airport.	
					\$ -	\$ -				\$ -		
					<i>Carryover</i>	\$ -						
2019					<i>Available Entitlements</i>	\$ 150,000						
	Land Acquisition for Rwy 18/36 Extension (DNR)	Project will be shown on ALP update.	CA-RW-EX	51	\$ 95,000	\$ -		\$ 2,500	\$ 2,500	\$ 100,000	Land will be needed for the 18/36 Runway Extension. Once ALP update planning is complete this task will be updated with detailed costs.	
					\$ -	\$ -				\$ -		
					<i>Carryover</i>	\$ 55,000						
2020					<i>Available Entitlements</i>	\$ 205,000						
	Terminal Building	No	CA-TE-IM	39	\$ 204,250	\$ -		\$ 5,375	\$ 5,375	\$ 215,000	A new terminal building is needed at the airport. Current building is a trailer with county offices. There is no dedicated terminal building.	
					\$ -	\$ -				\$ -		
					<i>Carryover</i>	\$ 750						
2021					<i>Available Entitlements</i>	\$ 150,750						
	LED REIL and Beacon with Wind Turbine	Yes	RE-EQ-VI	62	\$ 150,100	\$ -		\$ 3,950	\$ 3,950	\$ 158,000	Project will provide energy savings and power generation for the airport. LED lighting is more efficient and long lasting which reduces down time from burnt out bulbs. LED REIL is able to run on lower power which makes it safer and cheaper to provide maintenance. Wind turbine on the beacon tower will provide power generation for the airport. Mounting the turbine on the existing tower will ensure that no obstruction is created and will reduce the installation cost for the turbine.	
					\$ -	\$ -				\$ -		
					<i>Carryover</i>	\$ 650						
2022					<i>Available Entitlements</i>	\$ 150,650						
	Extend Runway 18/36 to 5000 LFT	Yes	CA-RW-EX	51	\$ 150,650	\$ 713,850		\$ 22,750	\$ 22,750	\$ 910,000	Airport requires a 5000' Runway to provide needed runway length for jet traffic. Fed. Ex. has expressed interest in the past in using this site for air transport. The airport will work to obtain letters from users to justify the need for this extension.	
					\$ -	\$ -				\$ -		
					\$ -	\$ -				\$ -		

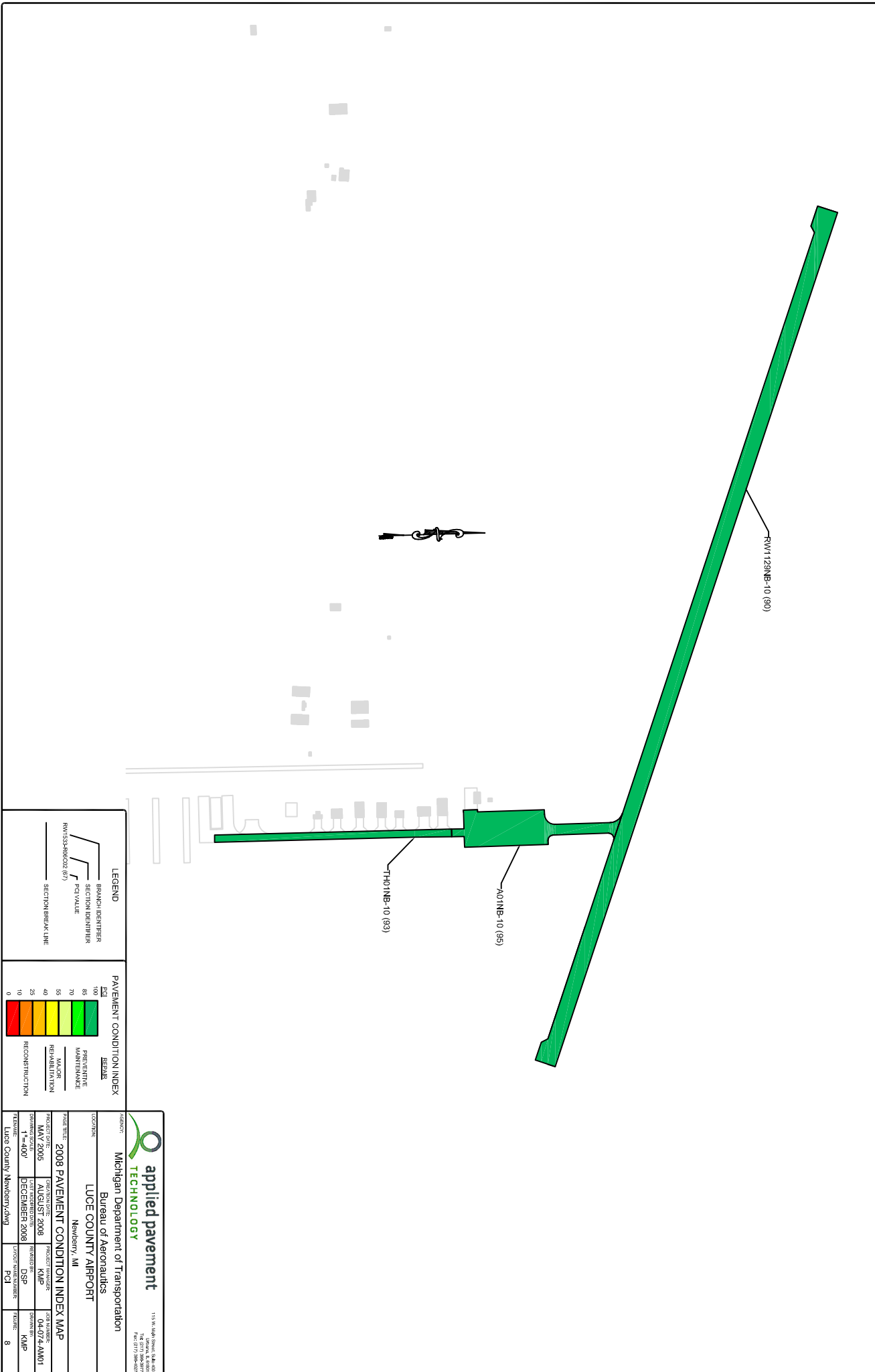

LEGEND

- BRANCH IDENTIFIER
- SECTION IDENTIFIER
- PCI VALUE
- SECTION BREAK LINE

PAVEMENT CONDITION INDEX

100	90	80	70	60	50	40	30	20	10	0
GOOD	GOOD	GOOD	GOOD	GOOD	GOOD	GOOD	GOOD	GOOD	GOOD	GOOD
MAJOR RECONSTRUCTION	REPAIR/RECONSTRUCTION	REPAIR/RECONSTRUCTION	REPAIR/RECONSTRUCTION	REPAIR/RECONSTRUCTION	REPAIR/RECONSTRUCTION	REPAIR/RECONSTRUCTION	REPAIR/RECONSTRUCTION	REPAIR/RECONSTRUCTION	REPAIR/RECONSTRUCTION	REPAIR/RECONSTRUCTION

		applied pavement TECHNOLOGY		115 W. Main Street, S.E. 400 Tallahassee, FL 32301 Tel: (904) 386-9977 Fax: (904) 386-4072	
Michigan Department of Transportation Bureau of Aeronautics LUCE COUNTY AIRPORT Newberry, MI					
PROJECT TITLE: 2008 PAVEMENT CONDITION INDEX MAP					
PROJECT DATE: JAN 2008	PROJECT OWNER: AUGUST 2008	PROJECT MANAGER: KMP	DATA SOURCE: OCT-07-AM01		
SCALE: 1"=400'	DRAWN BY: DSP	CHECKED BY: DSP	DATE: DEC 2008	PROJECT NUMBER: DSP	DRAWING NUMBER: KMP
SHEET NUMBER: LUCE COUNTY NEWBERRY.DWG	TOTAL SHEETS: PCI	SHEET NUMBER: PCI	TOTAL SHEETS: 8		