

Michigan Department of Natural Resources and Environment
Environmental Resource Management Division

SOLID WASTE DISPOSAL AREA OPERATING LICENSE

This license is issued under the provisions of Part 115, Solid Waste Management, of the Natural Resources and Environmental Protection Act, 1994 PA 451, as amended, MCL 324.11501 et seq., and authorizes the operation of this solid waste disposal area (Facility) in the state of Michigan. This license does not obviate the need to obtain other authorizations as may be required by state law.

FACILITY NAME: Citizens Disposal Landfill

LICENSEE/OPERATOR: Citizens Disposal, Inc.

FACILITY OWNER: Citizens Disposal, Inc.

PROPERTY OWNER: Citizens Disposal, Inc.

FACILITY TYPE(S): Municipal Solid Waste Landfill

FACILITY ID NUMBER: 470517

COUNTY: Genesee

LICENSE NUMBER: 9291

ISSUE DATE: November 10, 2010

EXPIRATION DATE: November 10, 2015

FACILITY DESCRIPTION: The Citizens Disposal, Inc., Landfill, a municipal solid waste landfill, consists of 236.51 acres located in the SW 1/4 of Section 23, Mundy Township, Genesee County, Michigan, as identified in Attachment A and fully described in this license.

AREA AUTHORIZED FOR DISPOSAL OF SOLID WASTE: As described in Section 2 and identified in Attachment A of this license.

RESPONSIBLE PARTY: Mr. Robert Thornton
Citizens Disposal, Inc.
2361 West Grand Blanc Road
Grand Blanc, Michigan 48439
810-655-4207

RENEWAL OPERATING LICENSE: This License Number 9291 supersedes and replaces Solid Waste Disposal Area Operating License Number 9145 issued to Citizens Disposal, Inc., on October 19, 2006.

This license is subject to revocation by the Director of the Michigan Department of Natural Resources and Environment, if the Director finds that this Facility is not being constructed or operated in accordance with the approved plans, the conditions of a permit or license, Part 115, or the rules promulgated under Part 115. Failure to comply with the terms and provisions of this license may result in legal action leading to civil and/or criminal penalties pursuant to Part 115. This license shall be available through the licensee during its term and remains the property of the Director.

THIS LICENSE IS NOT TRANSFERABLE.



Steven R. Sliver, Chief, Solid Waste and Land Application Section
Environmental Resource Management Division

Licensee: Citizens Disposal, Inc.
Facility Name: Citizens Disposal Landfill
Operating License Number: 9291
Issue Date: November 10, 2010

The licensee shall comply with all terms of this license and the provisions of Part 115 and the administrative rules implementing Part 115 (Part 115 Rules). This license includes the license application and any attachments to this license.

1. The licensee shall operate the Facility in a manner that will prevent violations of any state or federal law.
2. The following portions of the Facility are authorized to receive solid waste by this license:

ACTIVE PORTIONS NOT AT FINAL GRADE: The area(s) identified as portions of Phases I and IA, all of Phase II, and Cell A of Phase III were authorized to receive waste by the previous license. This area's total acreage is 58.69 acres.

3. The following portions of the Facility **WILL BE** authorized to receive solid waste by this license following approval by the Michigan Department of Natural Resources and Environment (DNRE) of construction certification:

UNCONSTRUCTED AREA(S) WITH FINANCIAL ASSURANCE: The area(s) identified as Phase III, Cell D, totaling 13.05 acres, are included in the calculation of financial assurance as required by Section 11523 of Part 115. This portion(s) of the Facility shall be authorized to receive waste, as part of this license, when acceptable certification is submitted to the DNRE, as required by Section 11516(5) of Part 115, and determined by the DNRE to be consistent with Part 115 and the Part 115 Rules. The certification shall verify that construction of this area(s) was in accordance with the Construction Permit(s) listed in Item 8 of this license, Part 115, and the Part 115 Rules.

4. The following portions of the Facility are **NOT** authorized to receive solid waste by this license:

a. **UNCONSTRUCTED AREA(S) WITHOUT FINANCIAL ASSURANCE:** The area(s) identified as Phase III, Cells B and C are not constructed and are not included in the calculation of financial assurance as required by Section 11523 of Part 115. This area's total acreage is 31.15 acres.

b. **CLOSED UNIT(S) OR A PORTION OF A UNIT WHERE THE FINAL COVER HAS BEEN CERTIFIED CLOSED AND ACCEPTED BY THE DNRE:** The following unit(s) and/or portion(s) are closed:

EXISTING UNIT(S): The unit(s) identified as portions of Phase I and IA had final closure certified on March 18, 1998. This certification was reviewed and approved by the DNRE on May 6, 1998. This area's total acreage is 6.1 acres.

5. The attached map (Attachment A) shows the Facility, the area permitted for construction, monitoring points, leachate storage units, site roads, other disposal areas, and related appurtenances.
6. Issuance of this license is conditioned on the accuracy of the information submitted by the Applicant in the Application for License to Operate a Solid Waste Disposal Area (Application) received by the DNRE on August 10, 2010, and any subsequent amendments. Any material or intentional inaccuracies found in that information is grounds for the revocation or modification of this license and may be grounds for enforcement action. The licensee shall inform the DNRE's Environmental Resource Management Division (ERMD), Lansing District Supervisor, of any inaccuracies in the information in the Application upon discovery.
7. This license is issued based on the DNRE's review of the Application, submitted by Citizens Disposal, Inc., for the Citizens Disposal Landfill, dated August 3, 2010. The Application consists of the following:
 - a. Application Form EQP 5507.
 - b. Application fee in the amount of \$5,000.00.
 - c. Certification of construction by N/A.
 - d. Waste Characterization: N/A,

Licensee: Citizens Disposal, Inc.
Facility Name: Citizens Disposal Landfill
Operating License Number: 9291
Issue Date: November 10, 2010

e. Restrictive Covenant:

The Citizens Disposal, Inc., Landfill restrictive covenant on 122.57 acres is on file at the Genesee County Register of Deeds recorded on November 8, 2002, as Liber 200211080125809 pages 1-5. A copy is on file with the DNRE.

f. Perpetual Care Fund Agreement, established as an escrow account, signed by Mr. Robert Thornton, Landfill Manager, Citizens Disposal, Inc., on April 17, 1997, was executed by the DNRE on May 23, 1997.

g. Financial Assurance.

i. Financial Assurance Required:

The amount of financial assurance required for this Facility was calculated based on the calculation worksheet form EQP 5507A entitled, "Form A, Financial Assurance Required," and is \$7,011,810.00.

The Facility has provided financial assurance totaling \$7,011,810.58, based on the requirements of Section 11523 of Part 115, consisting of a combination of the Perpetual Care Fund established under Section 11525 of Part 115, bonds, and the financial capability of the Applicant as evidenced by a financial test. The financial assurance mechanisms used by the Facility are summarized below in Items ii and iii, respectively.

ii. Financial Assurance Provided Via a Perpetual Care Fund:

- (1) The amount of the required financial assurance can be reduced pursuant to Section 11524 of Part 115, if the amount of money in the Perpetual Care Fund plus the amount of the reduced financial assurance equals the amount of financial assurance required in Section 11523 of Part 115 and is approved by the DNRE.
- (2) The Perpetual Care Fund Agreement statement showed a balance of \$1,913,749.58 in the Facility's Perpetual Care Fund as of May 31, 2010. Of this amount, the DNRE has granted the request to use \$1,913,749.58 toward the total amount of financial assurance required.

iii. Financial Assurance Provided Via Bond:

The following financial assurance has been received from the Applicant to meet the amount of financial assurance required:

Surety Bond	\$5,098,061.00
Total Amount Received:	\$5,098,061.00

iv. Financial Assurance Updates Required:

For Type II landfills, the financial assurance cost estimates of closure and postclosure activities must be updated annually and the corresponding requisite amount of financial assurance must be adjusted annually for the costs of inflation. The corresponding financial assurance, as adjusted for inflation and other factors, is due on November 10, 2011, and each year thereafter.

8. The following documents approved with Construction Permit Number(s) 0303, 0398, 4094, and 4106 issued to Citizens Disposal, Inc., on July 13, 1994, December 17, 2001, May 23, 2008, and September 30, 2009, are incorporated in this license by reference:

- a. Engineering Plan sheet numbers 1, 9, 10, 12, and 13 for the Citizens Disposal, Inc., permit modification titled "Construction Permit Application," prepared by Midwestern Consulting, dated January 15, 2008.

Licensee: Citizens Disposal, Inc.
Facility Name: Citizens Disposal Landfill
Operating License Number: 9291
Issue Date: November 10, 2010

- b. Volume calculations for the Citizens Disposal, Inc., permit modification titled "Revised Final Cover Grades," prepared by Midwestern Consulting, dated January 2008.
- c. Operations Manual located in Section 4.0 of the Engineering Report for the Citizens Disposal, Inc., Phase III Expansion, prepared by STS Consultants Ltd., dated August 2001.
- d. Engineering Plans for the Citizens Disposal, Inc., titled "Construction Permit Application Engineering Report," prepared by STS Consultants Ltd., dated July 2001, and revised November 2001.
- e. Engineering Report located in Volume 1 of the Construction Permit Application for the Citizens Disposal, Inc., Landfill, prepared by STS Consultants Ltd., dated August 17, 2001, and revised November 5, 2001.
- f. Construction Quality Assurance Program located in Volume 1, Appendix E, of the Citizens Disposal, Inc., Construction Permit Application, prepared by STS Consultants Ltd., dated August 17, 2001, and revised November 5, 2001.
- g. Closure and Post-Closure Plans located in Section 6.0 of the Engineering Report for the Citizens Disposal, Inc., Phase III Expansion, prepared by STS Consultants Ltd., dated August 17, 2001, and revised November 2001.
- h. Hydrogeologic Investigation Report located in Volume 2 of the Construction Permit Application for the Citizens Disposal, Inc., Landfill, prepared by STS Consultants Ltd., dated August 17, 2001, and revised November 2 and November 6, 2001.
- i. Environmental Monitoring Plan (Hydrogeological Monitoring Plan) located in Section 8.0 of the Hydrogeologic Investigation Report for the Citizens Disposal, Inc., Phase III Expansion, prepared by STS Consultants Ltd., dated August 17, 2001, and revised November 2 and November 6, 2001.
- j. Volume calculations for the Citizens Disposal, Inc., permit modification titled "Construction Permit Modification," prepared by Midwestern Consulting, dated May 2009.
- k. Engineering Plan sheet numbers 1, 3, 8, 9, 10, 11, 12, 13, 15, 16, 17, 18, 19, 20, and 25 for the Citizens Disposal, Inc., permit modification titled "Construction Permit Application," prepared by Midwestern Consulting, dated June 2, 2009.
- l. Hydrogeological Report titled, "Revised Hydrogeological Study Report," prepared by G.R. Kunkle and Associates, Inc., dated December 23, 1993, and revised March 8, 1994.
- m. Hydrogeological Report Titled, "Hydrogeological Study and Report Volume II," prepared by G.R. Kunkle and Associates, Inc., dated March 18, 1992, and revised June 7, 1994
- n. Surface Water, Subsurface Drain, and Hydrogeological Monitoring Plan titled, "Surface and Ground Water Quality Monitoring Program for Citizens Disposal, Inc.," prepared by G.R. Kunkle and Associates, Inc., dated January 25, 1994, and revised April 11, 1996, (This plan was superseded by the monitoring plan listed below).
- o. Topographic Maps prepared by Rowe Engineering, Inc., dated March 1994.
- p. Engineering Report titled, "Construction Permit Application for Phase II (Modified)," prepared by Rowe Engineering, Inc., NTH Consultants, Ltd., and G.R. Kunkle and Associates, Inc., dated March 1994.
- q. Engineering Plans titled, "Phase II – Modified Cap Design," prepared by Rowe Engineering, Inc., dated March 1994.
- r. Operation Plans titled, "Operational Specifications," prepared by Rowe Engineering, Inc., NTH Consultants, Ltd., and G.R. Kunkle and Associates, Inc., dated March 1994.
- s. Construction Quality Assurance Program titled, "Construction Quality Assurance Plan," prepared by Rowe Engineering, Inc., NTH Consultants Ltd., and G.R. Kunkle and Associates, Inc., dated September 7, 1993.

Licensee: Citizens Disposal, Inc.
Facility Name: Citizens Disposal Landfill
Operating License Number: 9291
Issue Date: November 10, 2010

- t. "Explosive Gas Control Program for Citizens Disposal, Inc., Landfill, Genesee County, Michigan" prepared by G.R. Kunkle and Associates, Inc., dated September 7, 1993.
 - u. Operations Manual located in Section 4.0 of the Engineering Report for the Citizens Disposal, Inc., Phase III Expansion, prepared by STS Consultants Ltd., dated August 2001.
 - v. Engineering Plans for the Citizens Disposal, Inc. titled "Construction Permit Application Engineering Report," prepared by STS Consultants Ltd., dated July 2001, and revised November 2001.
 - w. Engineering Report located in Volume 1 of the Construction Permit Application for the Citizens Disposal, Inc., Landfill, prepared by STS Consultants Ltd., dated August 2001, and revised November 2001.
 - x. Engineering Plan Numbers CDI-ED9, 10, 11, 12, 14, 15, 16, and 17 prepared by STS, Ltd., dated July 2001, and revised October 2004.
 - y. Construction Quality Assurance Program located in Volume 1, Appendix E of the Citizens Disposal, Inc., Construction Permit Application, prepared by STS Consultants Ltd., dated August 17, 2001, and revised November 2001.
 - z. Closure and Post-Closure Plans located in Section 6.0 of the Engineering Report for the Citizens Disposal, Inc., Phase III Expansion, prepared by STS Consultants Ltd., dated August 17, 2001, and revised November 2001.
 - aa. Hydrogeologic Investigation Report located in Volume 2 of the Construction Permit Application for the Citizens Disposal, Inc., Landfill, Phase III Expansion, prepared by STS Consultants Ltd., dated August 2001, and revised November 2, 2001, and November 6, 2001.
 - bb. Environmental Monitoring Plan (Hydrogeological Monitoring Plan) located in Section 8.0 of the Hydrogeologic Investigation Report for the Citizens Disposal, Inc., prepared by STS Consultants Ltd., dated August 17, 2001, and revised November 2, 2001, and November 6, 2001.
 - cc. Solidification Plan for Citizens Disposal Landfill prepared by Golder Associates, Inc., dated November 23, 2004, and approved for use on January 18, 2005.
 - dd. Minor permit modification to revise leachate sewer system prepared by Midwestern Consulting, Inc., dated January 31, 2005, and approved on March 1, 2005.
 - ee. Minor permit modification to add DR 11 HDPE to the possible choices for leachate piping prepared by Midwestern Consulting, Inc., dated February 22, 2005, and approved on March 2, 2005.
 - ff. Primary Indicator Parameter & Heavy Metals Evaluation (Report) prepared by NTH Consultants, Ltd. (NTH), and received on November 22, 2004. The plan was revised on September 9, 2005, and September 14, 2005, and approved on October 6, 2005.
9. The following additional documents, approved since the issuance of the construction permit(s) referenced in Item 8, are incorporated in this license by reference: None.
10. Consent Order/Judgment Number: N/A.
11. The licensee shall repair any portion of the certified liner or leachate collection system that is found to be deficient or damaged during the term of this license unless determined otherwise by the DNRE.
12. The licensee shall have repairs to any portion of the certified liner or leachate collection system recertified by a registered professional engineer in accordance with R 299.4921 of the Part 115 Rules and approved by the DNRE before receiving waste in that portion of the certified liner or leachate collection system. The licensee shall submit the recertification to the DNRE's ERMD, Lansing District Supervisor, for review and approval.

Licensee: Citizens Disposal, Inc.
Facility Name: Citizens Disposal Landfill
Operating License Number: 9291
Issue Date: November 10, 2010

13. The licensee shall conduct hydrogeological monitoring in accordance with the approved hydrogeological monitoring plan, dated August 17, 2001, and revised November 2, 2001, and November 6, 2001. The sampling analytical results shall be submitted to the DNRE's ERMD, Lansing District Office.
14. Modifications to the approved hydrogeological monitoring plan referenced in Item 13 may be approved, in writing, by the ERMD, Lansing District Supervisor. Proposed revisions must be submitted in a format specified by the DNRE.
15. Leachate may be recirculated if a leachate recirculation plan has been approved, in writing, by the ERMD, Lansing District Supervisor.
16. Modifications to approved engineering plans that constitute an upgrading, as defined in R 299.4106a(l) of the Part 115 Rules, may be approved, in writing, by the ERMD, Lansing District Supervisor.
17. Requests for alternate daily cover may be approved, in writing, by the ERMD, Lansing District Supervisor.
18. Leakage Control Criteria:
 - a. The active portions of the unit(s) authorized to receive waste by this license is a monitorable unit(s) which is located over a natural soil barrier and that is in compliance with the provisions of R 299.4422(2) of the Part 115 Rules. This pertains to Phase I, Phase IA, and Phase III fill areas at the facility.
 - b. The active portions of the unit(s) authorized to receive waste by this license is a monitorable unit(s) which is located over a natural soil barrier and that is in compliance with the provisions of R 299.4422(2) of the Part 115 Rules. In addition, the Facility has elected to install a secondary leachate collection system. The action flow rate for each unit is 200 gallons/acre/day. This pertains to Phase II.
19. **VARIANCES:** None.
20. **SPECIAL CONDITIONS:**
 - a. The licensee shall place a compacted layer of not less than six inches of earthen material, unless an exemption is granted, of suitable cover material on all exposed solid waste by the end of each working day, as required by R 299.4429(1) of the Part 115 Rules. Suitable cover shall be either uncontaminated soil or an alternate cover approved by the ERMD, listed in Item i, below. Alternate cover shall be restricted as indicated in Item ii and applied as per the approved operational plan submitted by the licensee.
 - i. Approved alternate cover shall be any of the following:
Product/Waste Material
 - (1) Compost Screening Waste per Citizens Disposal's August 16, 1995, request;
 - (2) Re-usable synthetic blankets as described in Condition O of Construction Permit Number 0263 issued to Citizens Disposal, Inc., on June 17, 1992;
 - (3) Sprayed on cover materials as described in Condition O of Construction Permit Number 0263 issued to Citizens Disposal, Inc., on June 17, 1992;
 - (4) Fines from Mid-Michigan Demolition Debris and Recycling Inc., Flint, Michigan, that are not useable as boiler fuel. Material consists of dirt, wood, and other ground up construction debris, per Citizens Disposal Inc., July 1, 1999, proposal;
 - (5) Auto Shredder Fluff from the following, per Citizens Disposal Inc., December 6, 2002, proposal:
 - (a) Prolerized New England, 69 Rover Street, Everett, Massachusetts.

Licensee: Citizens Disposal, Inc.
Facility Name: Citizens Disposal Landfill
Operating License Number: 9291
Issue Date: November 10, 2010

- (b) Advanced Recycling, Poplar Avenue, Concord, New Hampshire
 - (c) Rensselaer Iron & Steel, Inc., 35 Riverside Avenue, Rensselaer, New York.
 - (d) Metals Management, 234 Universal Drive, North Haven, Connecticut.
- (6) Filter Cake from GM Lansing Car Assembly – Body Plant per Citizens Disposal's November 3, 2003, request.
 - (7) Foundry Sand from Grede Foundries, Inc., Vassar, Michigan, per Citizens Disposal's October 4, 2004, request.
 - (8) Filter Cake from wastewater treatment plant sludge from the General Motors Pontiac Assemble Center, Pontiac, Michigan, per Citizens Disposal's April 12, 2006, request.
 - (9) Paint Sludge generated at the General Motors Pontiac Assemble Center, Pontiac, Michigan, per Citizens Disposal's August 9, 2007, request.
 - (10) Shredder Fluff generated at Spooner Metals, LLC, located at 5032 N. Dort Highway, Flint, Michigan, per Citizens Disposal's March 5, 2008, request.
 - (11) Shredder Fluff generated at Poscor Shred Services located at 799 Parkdale Avenue North, Hamilton, Ontario, per Citizens Disposal's April 25, 2008, request.
- ii. The above materials are approved for daily cover when used in the following manner:
- (1) The licensee shall use the material as daily cover only. The material cannot be used for road building or fill in other areas of the Facility's operation.
 - (2) The licensee shall maintain copies of the testing performed on Class B and Class C materials in the facility operating record.
 - (3) The licensee shall only stockpile material in a secure manner within the active cell.
 - (4) This approval does not preclude the licensee from disposing of the material as waste in the active fill area instead of using the material as daily cover.
 - (5) This approval shall immediately become void upon documentation by the DNRE that the alternative cover is not being used in accordance with listed conditions, that the alternative cover is not providing the necessary protection, that the material no longer meets the alternative daily cover guidelines, or that the process producing the waste material has changed.
 - (6) If the material does not meet the guidelines from Attachment 2 of Operational Memo 115-10, Revision 2, for nonvolatiles, the licensee shall ensure that fugitive dust emissions from this material do not occur. Acceptable methods to ensure fugitive emissions do not occur are:
 - (a) Implement a schedule to wet down material; or
 - (b) Cover the material with a tarp; or
 - (c) Apply an approved foam or other appropriate commercial dust control product.
 - (7) This approval to use alternative cover shall expire on November 10, 2010.

Licensee: Citizens Disposal, Inc.
Facility Name: Citizens Disposal Landfill
Operating License Number: 9291
Issue Date: November 10, 2010







b. Electrical Generation

- i. A registered professional engineer has certified that the electrical generator plant was constructed in accordance with all applicable building codes.
 - ii. The electrical generator plant is part of the active work area. The licensee shall operate and maintain this portion of the active work area in accordance with Part 115 and its administrative rules.
 - iii. The licensee shall operate the electrical generator plant shown in as-built drawings transmitted to the Michigan Department of Environmental Quality (MDEQ) on June 21, 1994, in a manner consistent with the operations outlined in the licensee's June 21, 1994, letter to the MDEQ.
 - iv. The licensee shall operate the electrical generator plant so that noise is controlled in compliance with R 299.4431.
 - v. The licensee shall discharge all gas condensate from the generator station either to the leachate collection system or to the public sanitary sewerage system. This discharge shall comply with all applicable discharge regulations. Leachate from the leachate wet well shall not be reintroduced to the landfill area without the MDNRE's approval.
21. **TERM:** This license shall remain in effect until its expiration date, unless revoked or continued in effect, as provided by, the Administrative Procedures Act, 1969 PA 306, as amended, or unless superseded by the issuance of a subsequent license.

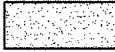
END OF LICENSE

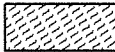
GRAND BLANC ROAD

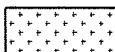
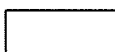
ATTACHMENT "A"

-  CERTIFIED PARTIALLY CLOSED AREA = 6.10 AC.
-  ACTIVE FILL AREA NOT YET AT FINAL GRADE = 58.69 AC.
-  CONSTRUCTED AREA WITH FINANCIAL ASSURANCE = 0.0 AC.
-  UNCONSTRUCTED AREA WITH FINANCIAL ASSURANCE = 13.05 AC.
-  UNCONSTRUCTED AREA W/O FINANCIAL ASSURANCE = 31.15 AC.
-  ANCILLARY AREA = 127.52 AC.
-  EXISTING GROUNDWATER MONITORING WELLS
-  EXISTING GAS MONITORING PROBES

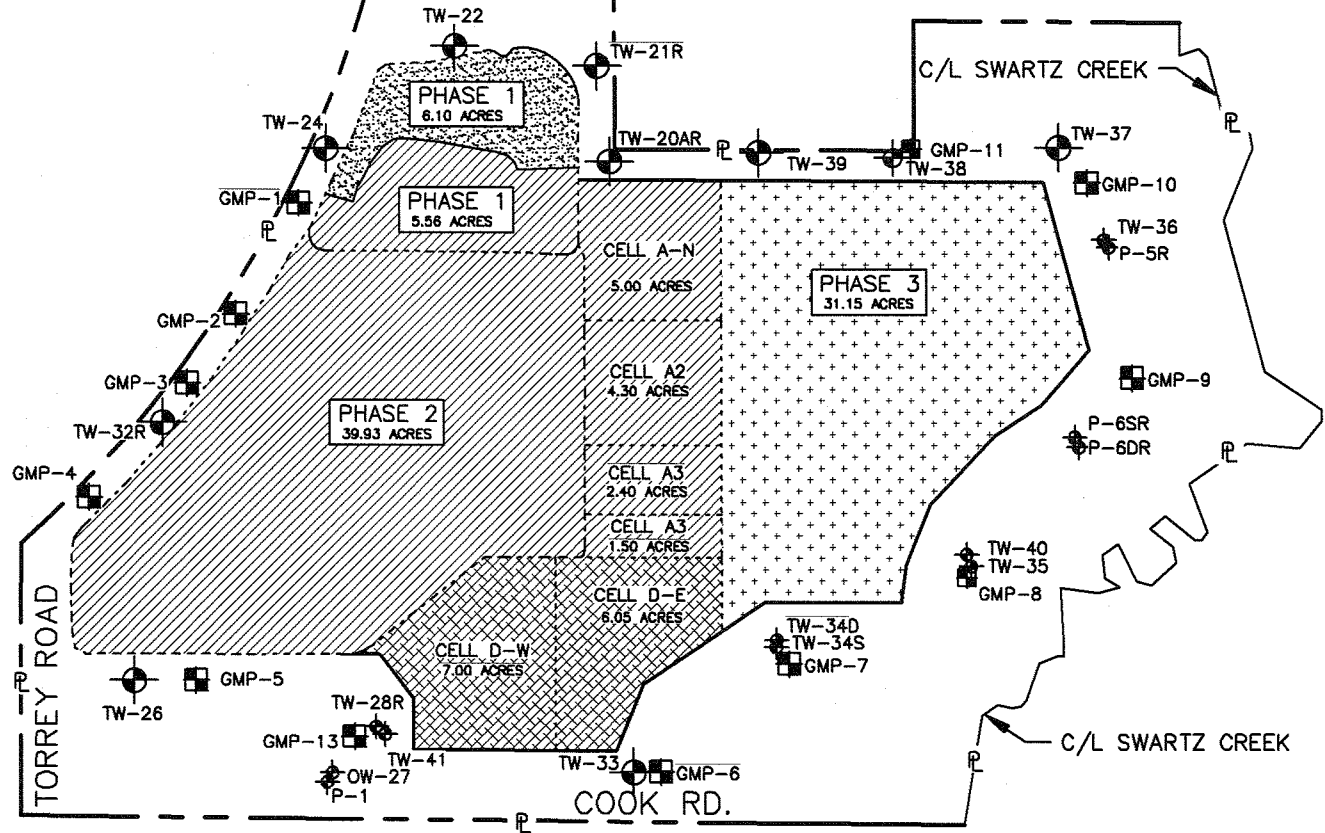

MIDWESTERN CONSULTING



Civil, Environmental and
Transportation Engineers
Planners, Surveyors
Landscape Architects

3815 Plaza Drive
Ann Arbor, Michigan 48108
Phone: 734.995.0200
Fax 734.995.0599

CITIZENS DISPOSAL, INC.
ATTACHMENT "A"

DATE: 5/10/10 JOB NO.: **00022**

SCALE: 1" = 600'



SHEET 1 OF 1