



Michigan Department of Environmental Quality
Waste and Hazardous Materials Division

SOLID WASTE DISPOSAL AREA CONSTRUCTION PERMIT

This construction permit is issued under the provisions of Part 115, Solid Waste Management, of the Natural Resources and Environmental Protection Act, 1994 PA 451, as amended, MCL 324.11501 et seq., to permit the construction of a solid waste disposal area (Facility) in the state of Michigan. This permit does not obviate the necessity of obtaining other authorization as may be required by state law.

FACILITY NAME: Eagle Valley Recycling and Disposal Facility

PERMITTEE/FACILITY OWNER: Waste Management of Michigan, Inc.

PROPERTY OWNER: Waste Management of Michigan, Inc.

TYPE OF FACILITY: Municipal Solid Waste Landfill

FACILITY ID: 63-000026

COUNTY: Oakland

PERMIT NUMBER: 0411

ISSUE DATE: April 15, 2003

EXPIRATION DATE: One year from date of issuance unless development of the Facility begins within the year.

FACILITY DESCRIPTION: The Eagle Valley Recycling and Disposal Facility, a Municipal Solid Waste Landfill, consists of 338 acres located at 600 West Silver Bell Road; Sections 26, 27, and 35; T4N; R10E; Orion Township; Oakland County; Michigan. The Facility is identified in Attachment A and is fully described in this permit.

RESPONSIBLE PARTY: Mr. Mike Stallard, District Manager
Waste Management of Michigan, Inc.
600 West Silver Bell Road
Lake Orion, Michigan 48359
248-391-0990

This permit is subject to revocation by the Director of the Michigan Department of Environmental Quality (Director) if the Director finds that the disposal area is not being constructed or operated in accordance with the approved plans, the conditions of a permit or license, Part 115, or the rules promulgated under Part 115. This permit shall be available through the applicant during its term and remains the property of the Director. Failure to comply with the terms and provisions of this permit may result in legal action leading to civil and/or criminal penalties as stipulated in Part 115.

THIS PERMIT IS NOT TRANSFERABLE UNLESS PRIOR AUTHORIZATION HAS BEEN OBTAINED FROM THE DIRECTOR.

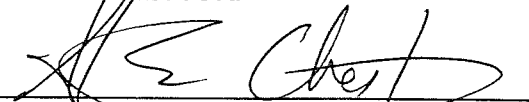
Steven E. Chester
Michigan Department of Environmental Quality

Permittee/Facility Owner: Waste Management of Michigan, Inc.
Facility Name: Eagle Valley Recycling and Disposal Facility
Construction Permit Number: 0411
Issue Date: April 15, 2003

The permittee shall comply with all terms of this permit and the provisions of Part 115 and its rules. This permit includes the permit application and any attachments to this permit.

1. The permittee shall construct the Facility in a manner that will not violate any state or federal law.
2. This permit authorizes the construction of the disposal area as defined in the Application for Permit to Construct a Solid Waste Disposal Area (Application) documents, dated December 16, 2002, and received by the Michigan Department of Environmental Quality (Department) on December 18, 2002. The new disposal area authorized by this permit shall not be utilized for the disposal of solid waste until an operating license for the disposal area is issued by the Department.
3. The attached map (Attachment A) shows the Facility, the area permitted for construction, area(s) authorized for the placement and/or acceptance of solid waste, monitoring points, leachate storage units, site roads, and related appurtenances.
4. Issuance of this permit is based on the assumption that the information submitted by the Applicant in the Application dated December 16, 2002, and any subsequent amendments are accurate. Any inaccuracies or deviations found in this information may be grounds for the revocation or modification of this permit and/or other enforcement action. The permittee shall inform the Department's Waste and Hazardous Materials Division, Southeast Michigan District Supervisor, of any known inaccuracies and/or any deviation in the information of the Application that would affect the permittee's ability to comply with the applicable rules or permit conditions. This permit is issued based on Department review of the Application, EQP 5506. The Application includes the following documents or their approved revisions that are incorporated by reference and become enforceable portions of this permit:
 - a. Application Form EQP 5506.
 - b. Fee in the amount of \$1,750 was submitted with the Application dated January 14, 2002. The January 14, 2002 Application was withdrawn on February 11, 2002.
 - c. Application for Eagle Valley Recycling and Disposal Facility, Phase II Development, prepared by Earth Tech, Inc., dated December 16, 2002, and revised April 10, 2003.
 - d. Engineering plans titled Waste Management of Michigan, Inc., Eagle Valley Recycling and Disposal Facility, Phase II Development, Orion Township, Oakland County, Michigan, prepared by Earth Tech, Inc., dated December 2002 and revised April 4, 2003.
 - e. Hydrogeologic Investigation Phase II Development, Eagle Valley Recycling and Disposal Facility, Orion Township, Oakland County, Michigan, prepared by NTH Consultants, Ltd., dated January 2002 and revised March 2003.
 - f. Hydrogeologic Monitoring Plan, Eagle Valley Recycling and Disposal Facility, Orion Township, Oakland County, Michigan, prepared by NTH Consultants, Ltd., and last revised April 7, 2003.
 - g. Eagle Valley Recycling and Disposal Facility, Phase II Development Application, Responses to the Department Technical Comments, prepared by Earth Tech, Inc., dated March 4, 2003.
 - h. Eagle Valley Recycling and Disposal Facility, Phase II Development Application, Second Response to Department Comments, prepared by Earth Tech, Inc., dated April 4, 2003.
5. The sampling parameters and monitoring frequencies are outlined in the Hydrogeological Monitoring Plan. The sampling results shall be submitted to the Department's Waste and Hazardous Materials Division, Southeast Michigan District Office.

Permittee/Facility Owner: Waste Management of Michigan, Inc.
Facility Name: Eagle Valley Recycling and Disposal Facility
Construction Permit Number: 0411
Issue Date: April 15, 2003

6. **VARIANCES:** None.
7. **SPECIAL CONDITIONS:** The applicant shall install the security fence depicted on Drawing Number 2 and described in Note 4 of the engineering plans listed in Item 4.d. within one year of issuance of this construction permit.
8. **TERM:** This construction permit shall expire one year after the date of issuance, unless development under the construction permit is initiated within that year.

END OF PERMIT

LEGEND

- ◻ OMW-25 EXISTING MONITORING WELL
- (M) PERIMETER DRAIN AND UNDERDRAIN PT.
- ▲ (S) OR (T) SURFACE WATER MONITORING PT.
- ◻ EVU-12A SHALLOW MONITORING WELL

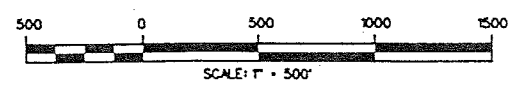
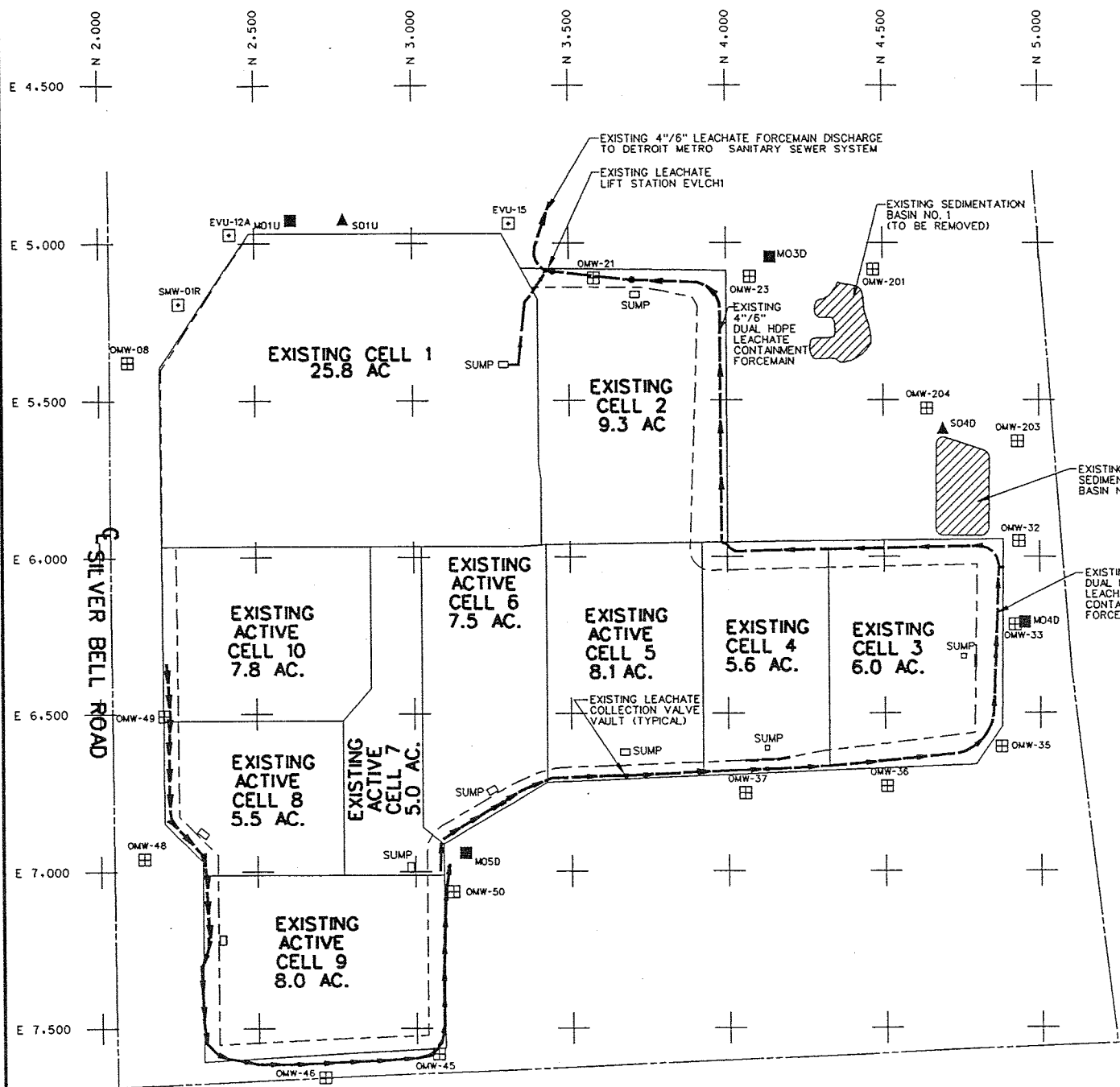
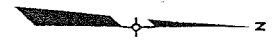

EXISTING ACTIVE CELLS: 88.60 AC.
CURRENT SOLID WASTE AREA: 88.60 AC.

EAGLE VALLEY RECYCLING
 AND DISPOSAL FACILITY

ATTACHMENT - A
EXISTING FACILITY PLAN
DECEMBER 2002



REVISED 02/28/03

DGN - L:\WORK\64880\CADD\Civil\ATCHAO3.dgn