



JENNIFER M. GRANHOLM  
GOVERNOR

STATE OF MICHIGAN  
DEPARTMENT OF ENVIRONMENTAL QUALITY  
LANSING



STEVEN E. CHESTER  
DIRECTOR

June 2, 2006

Mr. Perry M. Thomas  
Chief Compliance Officer  
Ypsilanti Community Utility Authority  
Wastewater Treatment Plant  
2777 State Road  
Ypsilanti, MI 48198-9112

Dear Mr. Thomas:

SUBJECT: Septage Receiving Facility Operating Plan Approval  
Ypsilanti Community Utilities Authority  
Wastewater Treatment Plant

Review of the Ypsilanti Community Utilities Authority (YCUA) Wastewater Treatment Plant (WWTP) received on October 13, 2005, is complete. The purpose of the review was to ensure that the plan addressed all of the required elements of Part 117, Septage Waste Servicers, Natural Resources and Environmental Protection Act, 1994 PA 451, as amended. The operating plan is approved.

There are two items in your plan that we are requesting further clarification. They are:

Service area:

- Does the YCUA WWTP accept septage waste that is pumped outside of the current 15 radial mile service area? If so, please update the operating plan to reflect this.

Septage waste accepted:

- Does the plant accept food establishment septage (FES)? If so, please modify the operating plan to reflect this. If this or the previous question is not applicable you do not have to modify the plan.

The YCUA septage receiving facility must operate in accordance with the approved plan. If a change in operations or conditions is anticipated, please file an amendment to the plan at least thirty days prior to the proposed date for implementation.

Mr. Perry M. Thomas  
Page 2  
June 2, 2006

If you have any questions regarding this matter, please contact me at the number below.

Sincerely,

A handwritten signature in cursive script that reads "Matthew Campbell".

Matthew Campbell  
Septage/Waste Program Coordinator  
On-Site Wastewater Unit  
Drinking Water and Environmental Health Section  
Water Bureau  
517-335-4178

MCC:DLR

cc: Mr. Richard M. Fleece, R.S., Environmental Health Director, Washtenaw County,  
Department of Environmental Health Regulation  
Mr. Jon Russell, Supervisor, DEQ, Water Bureau, Jackson District Office



YPSILANTI COMMUNITY UTILITIES AUTHORITY

2777 STATE ROAD  
YPSILANTI, MICHIGAN 48198-9112  
TELEPHONE: (734) 484-4600  
FAX: (734) 484-3369  
WEBSITE: www.ycua.org

October 7, 2005

Mr. Matt Campbell, Septage Waste Program Coordinator  
Drinking Water and Environmental Health Section, Water Bureau  
Michigan Department of Environmental Quality  
525 West Allegan Street  
Lansing, MI 48909-7773

Dear Mr. Campbell:

The Ypsilanti Community Utilities Authority's (YCUA) NPDES Permit # MI0042676 is hereby submitting the **Exhibits I-IV of the Operating Plan for Septage Receiving.**

Please attach the **Exhibits I-IV** to the end of the YCUA Operating Plan for Septage Receiving they were inadvertently omitted.

I am sorry for any inconvenience this may have caused.

If you have any questions or if I can be of any assistance, please contact me.

Sincerely,

Perry M. Thomas  
YCUA Chief Compliance Officer

PMT: pt  
Enclosures: **Exhibits I - IV**

**RECEIVED**  
MICH. DEPT. OF ENVIRONMENTAL QUALITY

OCT 13 2005

WATER BUREAU  
DWEHS

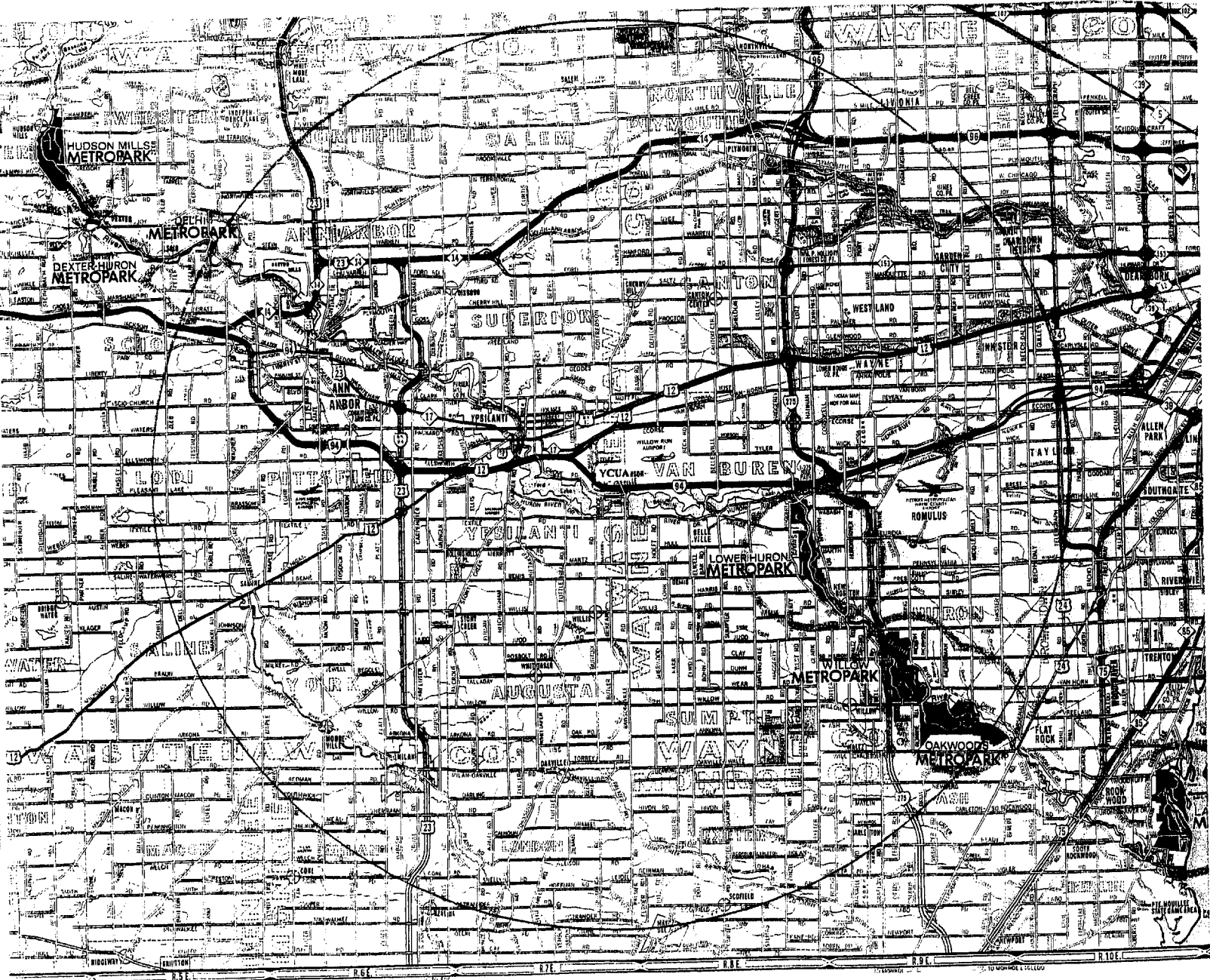

RECEIVED  
MICH. DEPT. OF ENVIRONMENTAL QUALITY

OCT 13 2005

WATER BUREAU  
DWEHS

WILLOWOOD AVENUE

Exhibit II

Septage  
Receiving  
Station

DETENTION  
BASIN

WORK UNDER  
CONTRACT 01R0123-S

STATE STREET

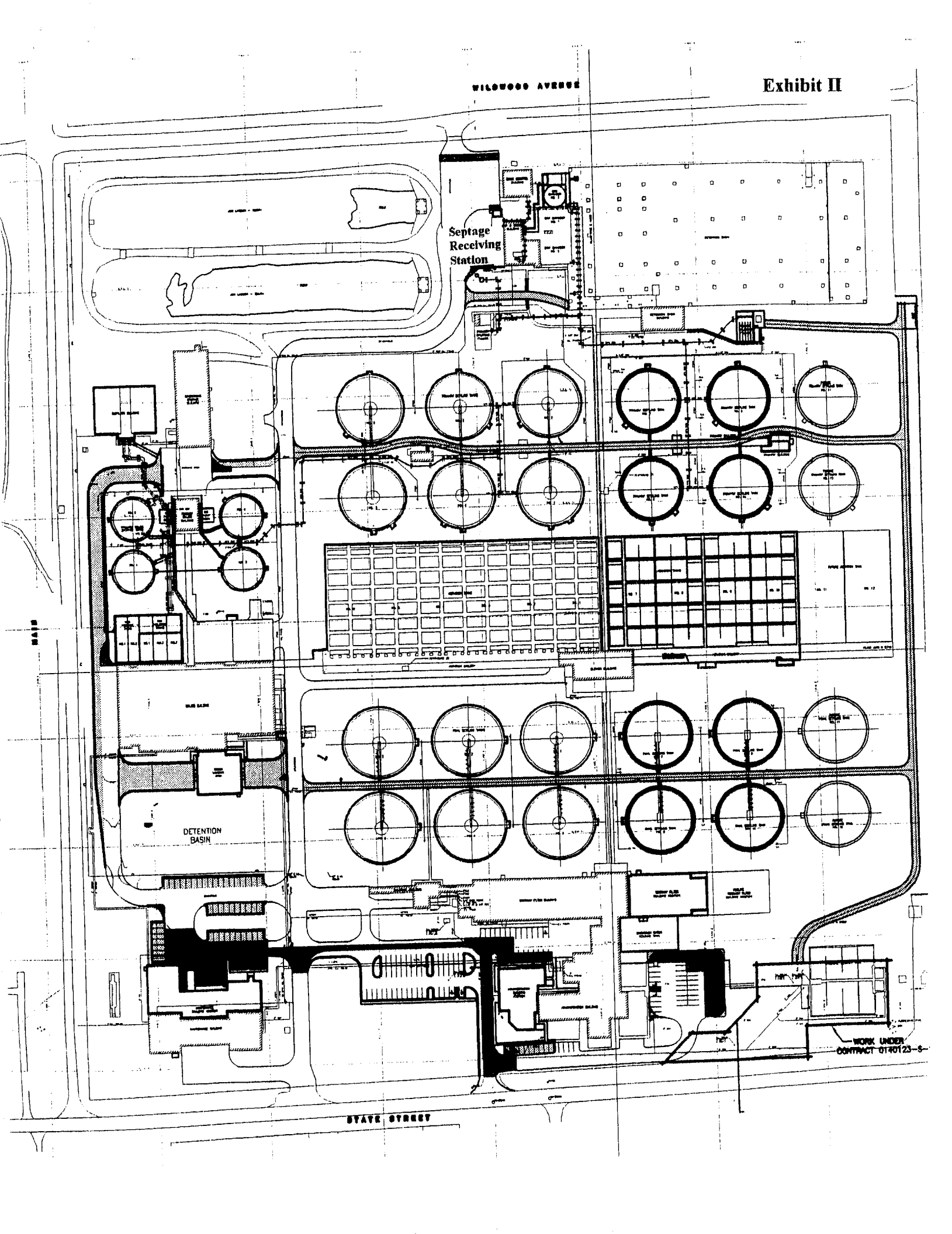

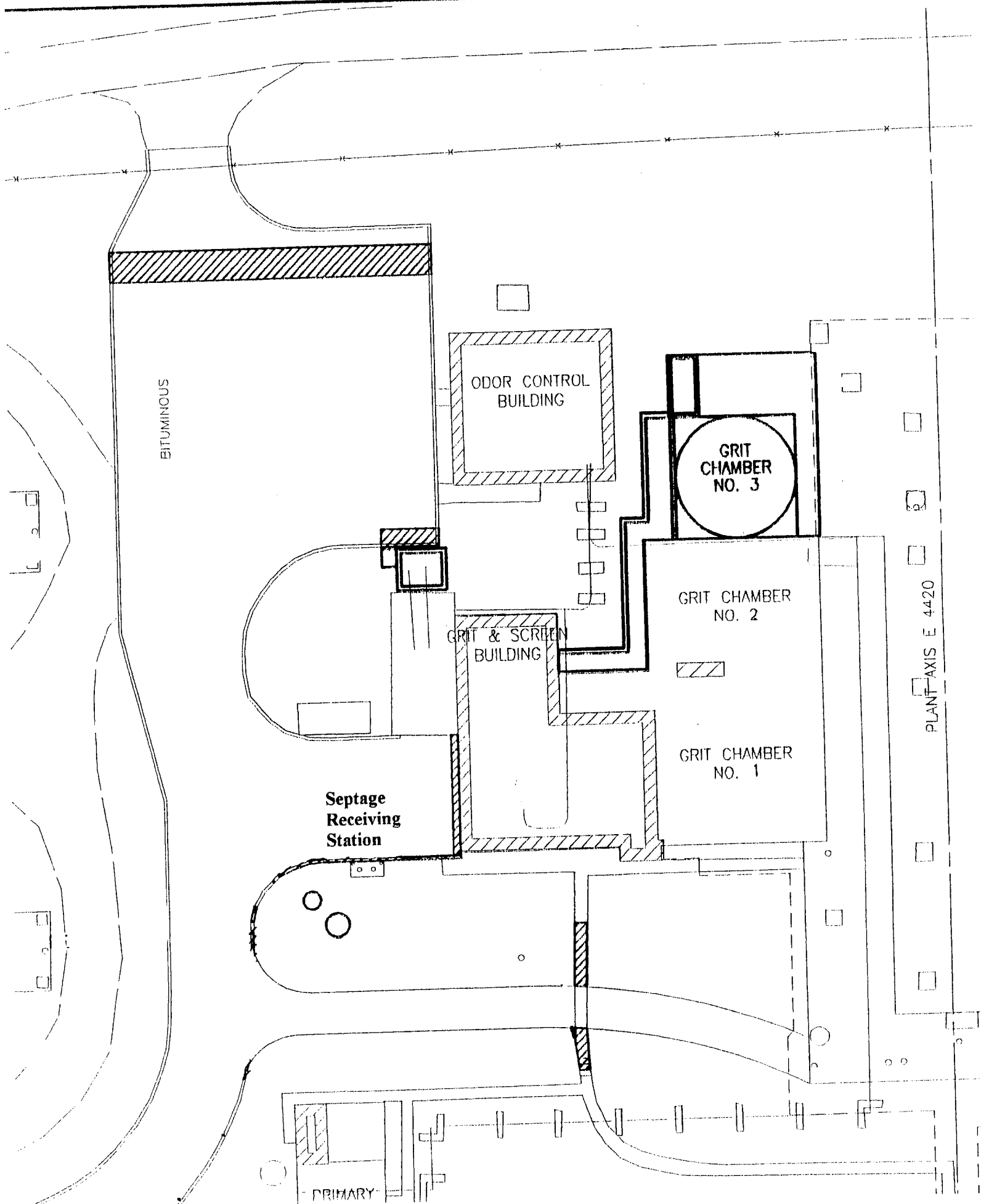

YPSILANTI COMMUNITY UTILITIES AUTHORITY  
INDUSTRIAL PRETREATMENT PROGRAM

**Exhibit IV**

SEPTIC HAULER PERMIT APPLICATION

DATE: \_\_\_\_\_

General Information

1. Permittee Name: \_\_\_\_\_
2. Business Name: \_\_\_\_\_
3. Business Phone Numbers: \_\_\_\_\_  
\_\_\_\_\_
4. Business Address: \_\_\_\_\_  
\_\_\_\_\_
5. Mailing Address: \_\_\_\_\_  
\_\_\_\_\_
6. MDEQ SWQD Business License Number:  
(Attach Current Copy of Certificate) \_\_\_\_\_
7. Business License Expiration Date: \_\_\_\_\_
8. Septic Hauling Vehicle(s) Description Including Vehicle Name,  
Registration, Tank Capacity And License Plate Number :  
(Attach Current Copy OF MDEQ Application For License To Remove And  
Transport Septic Tank Waste Along With A Copy Of Current MDEQ  
Vehicle License's)

NAME:	YEAR/MODEL:	TANK CAPACITY:	LICENSE NUMBER:	PLATE NUMBER:	REGISTRATION NUMBER:

9. Type of waste hauled: \_\_\_\_\_
10. Vehicle Insurance Carrier: \_\_\_\_\_
11. Insurance Policy Number: \_\_\_\_\_
12. Insurance Policy Expiration Date: \_\_\_\_\_

Authorized Representative Statement:

I certify under penalty of law that this document and all attachments were prepared under my direction or supervision in accordance with a system designed to assure that qualified personnel properly gather and evaluate the information submitted. Based on my inquiry of the person or persons who manage the system, or those persons directly responsible for gathering the information, the information submitted is, to the best of my knowledge and belief, true, accurate, and complete. I am aware that there are significant penalties for submitting false information, including the possibility of fines and imprisonment for knowing violations.

\_\_\_\_\_  
Name

\_\_\_\_\_  
Title

\_\_\_\_\_  
Signature

\_\_\_\_\_  
Date

**Septage Receiving Facility Checklist**

Name of Septage Receiving Facility:  
**Ypsilanti Community Utilities Authority**

DEQ Reviewer: MCC  
 Review Date: June 1, 2006

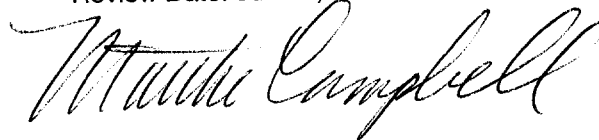

Address of Septage Receiving Facility:  
**2777 State Road**  
**Ypsilanti, MI 48198**

Facility Contact: Mr. Perry Thomas, Chief Compliance Officer  
 Telephone Number: 734-484-4600

The following information must be submitted in the Operation Plan in order to receive DEQ approval:

<u>Requirement</u>	<u>Yes</u>	<u>No</u>	<u>Comments</u>
1. Location of septage RF.	X		
2. Hours of operation.	X		M - F, 8 a.m. through 3:34 p.m. No deliveries on holidays.
3. Categories of septage waste the RF will receive.	X		Home septic tanks, RV holding tanks, cesspool, portable toilet, type III marine sanitation device.
4. If food establishment septage is accepted, how is the RF ensuring that the FES meets the 1:3 ratio mandated by law? (Not OP req't.)		NA	FES is not accepted at this plant.
5. *Fee structure charged to hauler.	X		The hauler fee is \$0.07 per gallon.
6. *Service area (septage acceptance) description of RF defined in detail.	X		15 radial mile area around the plant. There is no mention that they can or will accept septage pumped outside of that area.
7. Notice of proposed operation plan: a) Was it mailed to county HD and legislative body of each city, village and township located in whole or in part of the service area?	X		Wayne County HD and Augusta Township

## Septage Receiving Facility Checklist

Name of Septage Receiving Facility:

<u>Requirement</u>	<u>Yes</u>	<u>No</u>	<u>Comments</u>
7. Notice of proposed op. plan cont:			
b) Was it public noticed in the local newspaper?	X		Ann Arober News on September 9, 10, and 11, 2005.
c) Was it posted on the facility website?	X		It was still posted as of 6/1/06 on www.YCUA.org.
9. Did the notice contain the following?			
a. Statement that the RF proposed to or is currently receiving and will continue to receive septage waste for treatment.	X		
b. Statement in the notice that the proposed operating plan is available for review during normal work hours.	X		M - F, 8 a.m. through 4 p.m.
c. A request for written comments on the proposed operation of the RF and the deadline for receipt of such comments, which shall not be less than 30 days after publication, posting, or mailing of the notice.	X		
d. Receiving facility capacity.			
I) Hydraulic capacity:	X		15,000 gallons per day.
II) Organic capacity:	X		430 lbs. per day (avg.)
*III) Wet weather operation considerations (CSO & SSO)			Not addressed (nor required).
10. Other conditions established for the RF.	X		See operating plan for details on procedures for licensing, payment, unloading, and volume restrictions.

\*5. Fee structure - must be justified and reasonable in accordance with standard accounting practices.

\*6. This should be both written and illustrated on a map of the area. The service area information should include whether or not there is a county ordinance that also defines what they can or can't accept. It should also include whether or not they accept septage pumped outside of the service area.

\*9.(III). CSO-Combined Sewer Overflow and SSO-Sanitary Sewer Overflow.



YPSILANTI COMMUNITY UTILITIES AUTHORITY

2777 STATE ROAD  
YPSILANTI, MICHIGAN 48198-9112  
TELEPHONE: (734) 484-4600  
FAX: (734) 484-3369  
WEBSITE: www.ycua.org

October 7, 2005

Mr. Matt Campbell, Septage Waste Program Coordinator  
Drinking Water and Environmental Health Section, Water Bureau  
Michigan Department of Environmental Quality  
525 West Allegan Street  
Lansing, MI 48909-7773

RECEIVED  
MICH. DEPT. OF ENVIRONMENTAL QUALITY  
OCT 13 2005  
WATER BUREAU  
DWEHS

Dear Mr. Campbell:

The Ypsilanti Community Utilities Authority's (YCUA) NPDES Permit # MI0042676 is hereby submitting the **YCUA Operating Plan for Septage Acceptance**, pursuant to Part 117, as amended.

Please find enclosed the YCUA Operating Plan for Septage Acceptance.

In response to your letter dated June 9, 2005, YCUA offers the following:

1. Please find **Attachment A**, a completed page 2. The name of the facility and the name of the YCUA Chief Compliance Officer and the name of the YCUA Director of Wastewater Operations are provided.
  - (a) The public notice of the proposed operating plan, see **Attachment B**, was published in the Ann Arbor Newspaper on Friday September 9, 2005, Saturday September 10, 2005, and Sunday September 11, 2005.
  - (b) YCUA maintains a website: [www.YCUA.org](http://www.YCUA.org). Notice of the proposed operating plan and information for obtaining a copy of the plan was posted on the YCUA website.
  - (c) YCUA submitted notice of the proposed operating plan by first-class mail to the county health department and the legislative body of each city, village, and township located in whole or in part within the service area of the wastewater treatment plant as identified in **Exhibit I** of the Operating Plan for Septage Receiving. **Attachment C** is a typical notice to the county health departments and **Attachment D** is a typical notice to a legislative body.

The notice of the proposed operating plan contained all of the elements listed on page 3 of your letter dated June 9, 2005.

2. The category of septage waste that receiving facility, YCUA, will accept for treatment is **Domestic Septage**.
3. Receiving Facility Capacity:
  - (a) The hydraulic capacity (gallons per day) for septage waste is **15,000** gallons per day (average).
  - (b) The organic capacity (pounds per day of 5-day biochemical oxygen demand) for septage waste is **430** lbs. per day (average).
  - (c) The current approximate daily average flow for the fiscal year (fiscal year 2004 -2005: September 1 to August 31) is seven thousand (**7,000**) gallons per day.

(d) The peak daily flow for septage in gallons per day for the fiscal year 2004-2005 was twenty-five thousand (25,000) gallons.

4. A detailed description of the YCUA Receiving Facility Service Area is identified on **Exhibit I** of the Operating Plan for Septage Receiving. The circle on **Exhibit I** is found by striking an arc with a radius of fifteen-miles from the YCUA WWTP.
5. The hours of operation are 8:00 AM – 3:45 PM Monday – Friday. The hours of operation are stated on page 4 of the Operating Plan for Septage Receiving.
6. The Operating Plan for Septage Receiving state the General Conditions and General Prohibitive Discharge Standards for septage receiving.

If you have any questions or if I can be of any assistance, please contact me.

Sincerely,



Perry M. Thomas  
YCUA Chief Compliance Officer

RECEIVED  
MICH. DEPT. OF ENVIRONMENTAL QUALITY  
OCT 13 2005  
WATER BUREAU  
DWEHS

PMT: pt

Enclosures: **Attachments A – D**

**Operating Plan for Septage Receiving w/ Exhibits I - IV**

cc: Mr. Romulo Aquino, YCUA Chemist  
Mr. T.M. Jessee, YCUA Assistant Director  
Mr. Kurian Joychan, YCUA Director of Wastewater Operations/Certified Stormwater Operator  
Mr. John Nowling, YCUA Director of Maintenance Operations  
Mr. Larry R. Thomas, YCUA Director  
Mr. William Woodward, YCUA Industrial Pretreatment Program Supervisor  
YCUA Wastewater File

Septage Receiving Facility  
Operating Plan

June 9, 2005

- any other conditions for receiving septage waste established by the receiving facility

Conditions regarding septage acceptance at your wastewater treatment plant may include receiving facility capacity (hydraulic and organic), volume of septage received, odor control, and other information required under Part 41, Sewerage Systems, of the Natural Resources and Environmental Protection Act, 1994 PA 451.

We must also advise you of the requirement to provide public notification before you submit your operating plan to the DEQ for review and approval, pursuant to section 11715b of Part 117. For more details on this requirement, please see item 1 on pages 2 and 3.

We hope that you decide to continue to accept septage waste for treatment. If so, please fill out and submit the attached information to the address listed below. This is the basic information that must be contained in your Operating Plan as mandated by Part 117. The DEQ will review your Operating Plan, and when we determine that it is complete, we will approve your receiving facility for continued septage acceptance and treatment.

We request that your Operating Plan be submitted by September 1, 2005, so we may have time to review and approve it by the October 12, 2005, deadline. Doing this will ensure that you may continue the acceptance of septage at your receiving facility. The DEQ will post the approved operating plans on the DEQ Septage Program website.

**YPSILANTI COMMUNITY UTILITIES AUTHORITY (YCUA)**

Name of receiving facility (wastewater treatment plant)

**PERRY M. THOMAS**

**KURLAN JOYCHAN**

**SEPT. 29, 2005**

Name of ~~Superintendent/Chief Operator~~ of receiving facility Date  
**CHIEF COMPLIANCE OFFICER** , **DIRECTOR OF WASTEWATER OPERATIONS**

Check this box if domestic septage is not accepted at your receiving facility (WWTP) and mail back to the address listed below.

1. If you plan to continue receiving septage waste for treatment at your receiving facility you are required to do the following (see Sec. 11715b. of Part 117) before submitting your proposed operating plan to the DEQ for review and approval:

(a) Publish notice of the proposed operating plan in a newspaper of general circulation in the area where the receiving facility is located.

(b) If the person maintains a website, post notice of the proposed operating plan on its website.

**RECEIVED**  
MICH. DEPT. OF ENVIRONMENTAL QUALITY  
OCT 13 2005  
WATER BUREAU  
DWEHS

**Ypsilanti Community Utilities Authority (YCUA)  
Wastewater Treatment Plant  
2777 State Rd.  
Ypsilanti, Michigan 48198  
(734) 484-4600 ext 121 or ext 119**

**The YCUA Wastewater Treatment Plant (WWTP) is a receiving facility for septage waste. The YCUA will continue to receive septage waste. To comply with Part 117, Septage Waste Servicers, of the Natural Resources and Environmental Protection Act, 1994 PA 451, the YCUA developed a proposed Operating Plan for Septage Receiving. The Operating Plan is available for review during normal business hours at the YCUA WWTP Administration Office: Monday- Friday 8AM – 4PM. YCUA is requesting written comments on the proposed operation of the receiving facility. The deadline for receipt of written comments is October 9, 2005 at 4PM.**

**RECEIVED**  
MICH. DEPT. OF ENVIRONMENTAL QUALITY  
OCT 13 2005  
WATER BUREAU  
DWEHS



YPSILANTI COMMUNITY UTILITIES AUTHORITY

2777 STATE ROAD  
YPSILANTI, MICHIGAN 48198-9112  
TELEPHONE: (734) 484-4600  
FAX: (734) 484-3369  
WEBSITE: www.ycua.org

September 8, 2005

Mr. Steve Tackitt  
Wayne County Department of Environmental Health  
5454 S. Venoy Road  
Wayne, MI 48184

Dear Mr. Tackitt:

To comply with Part 117, Septage Waste Servicers, of the Natural Resources and Environmental Protection Act, 1994 PA 451, the YCUA developed a proposed Operating Plan for Septage Receiving.

The YCUA Wastewater Treatment Plant (WWTP) is a receiving facility for septage waste. The YCUA will continue to receive septage waste.

The Operating Plan is available for review during normal business hours at the YCUA WWTP Administration Office: Monday- Friday 8AM – 4PM.

YCUA is requesting written comments on the proposed operation of the receiving facility. The deadline for receipt of written comments is Monday, October 9, 2005 at 4:00 p.m.

The attached Public Notice is being published in the Ann Arbor Newspaper on Friday, Sept. 9, Saturday, Sept. 10, and Sunday, Sept. 11, 2005.

If you have any questions, or if I can be of any assistance please contact me.

Sincerely,

A handwritten signature in black ink, appearing to read 'Perry M. Thomas', is written over a light-colored background.

Perry M. Thomas  
YCUA Chief Compliance Officer

Attachment – Public Notice

cc: YCUA Wastewater Dept. File

**Ypsilanti Community Utilities Authority (YCUA)  
Wastewater Treatment Plant  
2777 State Rd.  
Ypsilanti, Michigan 48198  
(734) 484-4600 ext 121 or ext 119**

**The YCUA Wastewater Treatment Plant (WWTP) is a receiving facility for septage waste. The YCUA will continue to receive septage waste. To comply with Part 117, Septage Waste Servicers, of the Natural Resources and Environmental Protection Act, 1994 PA 451, the YCUA developed a proposed Operating Plan for Septage Receiving. The Operating Plan is available for review during normal business hours at the YCUA WWTP Administration Office: Monday- Friday 8AM – 4PM. YCUA is requesting written comments on the proposed operation of the receiving facility. The deadline for receipt of written comments is October 9, 2005 at 4PM.**



YPSILANTI COMMUNITY UTILITIES AUTHORITY

2777 STATE ROAD  
YPSILANTI, MICHIGAN 48198-9112  
TELEPHONE: (734) 484-4600  
FAX: (734) 484-3369  
WEBSITE: www.ycua.org

September 8, 2005

Ms. Kathy Jackson, Supervisor  
Augusta Township  
8021 Talladay Road – P O Box 100  
Whittaker, MI 48190

Dear Ms. Jackson:

To comply with Part 117, Septage Waste Servicers, of the Natural Resources and Environmental Protection Act, 1994 PA 451, the YCUA developed a proposed Operating Plan for Septage Receiving.

The YCUA Wastewater Treatment Plant (WWTP) is a receiving facility for septage waste. The YCUA will continue to receive septage waste.

The Operating Plan is available for review during normal business hours at the YCUA WWTP Administration Office: Monday- Friday 8AM – 4PM.

YCUA is requesting written comments on the proposed operation of the receiving facility. The deadline for receipt of written comments is Monday October 9, 2005 at 4:00 p.m.

The attached Public Notice is being published in the Ann Arbor Newspaper on Friday, Sept. 9, Saturday, Sept. 10, and Sunday, Sept. 11, 2005.

If you have any questions, or if I can be of any assistance please contact me.

Sincerely,

A handwritten signature in black ink, appearing to read 'Perry M. Thomas', written in a cursive style.

Perry M. Thomas  
YCUA Chief Compliance Officer

Attachment – Public Notice

Cc: YCUA Wastewater Dept. File

**Ypsilanti Community Utilities Authority (YCUA)  
Wastewater Treatment Plant  
2777 State Rd.  
Ypsilanti, Michigan 48198  
(734) 484-4600 ext 121 or ext 119**

**The YCUA Wastewater Treatment Plant (WWTP) is a receiving facility for septage waste. The YCUA will continue to receive septage waste. To comply with Part 117, Septage Waste Servicers, of the Natural Resources and Environmental Protection Act, 1994 PA 451, the YCUA developed a proposed Operating Plan for Septage Receiving. The Operating Plan is available for review during normal business hours at the YCUA WWTP Administration Office: Monday- Friday 8AM – 4PM. YCUA is requesting written comments on the proposed operation of the receiving facility. The deadline for receipt of written comments is October 9, 2005 at 4PM.**



# Standard Operating Procedure

---

Date: October 7, 2005

2777 STATE ROAD  
YPSILANTI, MI 48198-9112  
Telephone No.: 734.484.4600  
Fax No.: 734.484.4699

**Ypsilanti Community Utilities Authority (YCUA)**  
**Wastewater Treatment Plant (WWTP)**  
**2777 State Road**  
**Ypsilanti, Michigan 48198**  
**(734) 484-4600**

## Operating Plan for Septage Receiving

**RECEIVED**  
MICH. DEPT. OF ENVIRONMENTAL QUALITY

OCT 13 2005

WATER BUREAU  
DWEHS

**RECEIVED**  
MICH. DEPT. OF ENVIRONMENTAL QUALITY

OCT 13 2005

WATER BUREAU  
DWEHS

**August 2005**

## Table of Contents

	<b>Page</b>
<b>Operating Plan</b>	<b>3</b>
<b>Introduction</b>	<b>3</b>
<b>Applicability</b>	<b>3</b>
<b>Service Area</b>	<b>3</b>
<b>Wastewater Treatment Plant Location</b>	<b>4</b>
<b>Septage Receiving Station Location</b>	<b>4</b>
<b>Hours of Operation</b>	<b>4</b>
<b>Volume Restrictions</b>	<b>4</b>
<b>Fee Structure</b>	<b>4</b>
<b>Invoicing</b>	<b>4</b>
<b>Acceptance Procedure</b>	<b>4 - 5</b>
<b>Unloading Procedure</b>	<b>5</b>
<b>General Conditions</b>	<b>6 - 11</b>
<b>General Prohibitive Discharge Standards</b>	<b>11 - 12</b>

**RECEIVED**  
MICH. DEPT. OF ENVIRONMENTAL QUALITY  
OCT 13 2005  
WATER BUREAU  
DWEHS

# **OPERATING PLAN FOR SEPTAGE ACCEPTANCE AT THE YPSILANTI COMMUNITY UTILITIES AUTHORITY WASTEWATER TREATMENT PLANT**

**Introduction** – Part 117, Septage Waste Servicers, of the Natural Resources and Environmental Protection Act, 1994 PA 451, regulates the pumping, disposal, and land application of septage waste. To comply with Part 117, Septage Waste Servicers, of the Natural Resources and Environmental Protection Act, 1994 PA 451, a Receiving Facility must develop an Operating Plan for Septage Receiving.

**Applicability** – A Wastewater Treatment Plan (WWTP) that accepts domestic septage are now defined as a “receiving facility” in Part 117, Septage Waste Servicers, of the Natural Resources and Environmental Protection Act, 1994 PA 451, as amended. Receiving Facility must develop an Operating Plan for Septage Receiving.

The Ypsilanti Community Utilities Authority (YCUA) Wastewater Treatment Plant (WWTP) is currently a receiving facility and will continue to be a receiving facility.

The YCUA WWTP has developed and adopted this Operating Plan for Septage Receiving.

**Domestic Septage**, as defined below is the category of septage that YCUA will accept for treatment.

**Domestic Septage** – The septage pumped from home septic tanks, recreational vehicles (RV), cesspool, portable toilet, type III marine sanitation device, or similar storage or treatment works that receives only domestic sewage.

**Service Area** – The Service Area can be up to fifteen (15) radial miles from the receiving facility beginning October 12, 2005 through October 12, 2010. On October 12, 2010, the receiving facility’s service area can be as large as twenty-five (25) radial miles from the center of the wastewater treatment plant. **Exhibit I** shows the area encompassed by a fifteen (15) mile radius around the receiving facility (YCUA WWTP). The encompassed area is the **service area** for the YCUA receiving facility. The Septage Haulers must discharge into a WWTP Receiving Facility if the septage is collected within this service area. The Septage Hauler do not have to discharge into the YCUA Receiving Facility, but because there is a receiving facility within this area, the Septage Haulers cannot land apply septage that is collected within the fifteen mile service area.

**YCUA Wastewater Treatment Plant Location** - The Ypsilanti Community Utilities Authority (YCUA) Wastewater Treatment Plant (WWTP) is located at 2777 State Road, Ypsilanti, Michigan. The attached map, see **Exhibit I**, shows the location of the YCUA WWTP.

The YCUA WWTP is located in the center of the service area and is marked with the label "YCUA".

**YCUA WWTP Septage Receiving Station Location** – The location of the Septage Receiving Facility at the YCUA WWTP is marked on **Exhibit II**. A zoomed-in view of the Septage Receiving Station location at the YCUA WWTP is shown on **Exhibit III**. In the event that the Septage Receiving Station is inoperable an alternative facility for discharging septage is available.

**Hours of Operation** - Delivery of all septic waste at the YCUA WWTP shall occur Monday through Friday between the hours of 8:00 A.M. and 3:45 P.M. (No septic deliveries on Holidays). Drivers bringing loads before or after these hours will be turned away unless pre-arrangements have been made. Any driver found discharging outside of these times would forfeit the company's privileges for future discharge. This information must be presented to all of drivers that bring septage to the YCUA WWTP.

**Volume Restrictions** – The YCUA Wastewater Treatment Plant will accept seventy-five thousand (75,000) gallons of septage per week (Monday – Friday). There is no daily volume limitation for septage waste. The running total of gallons discharged at the WWTP for the day and week is maintained by the Maintenance Stockroom Personnel. If and when thirty thousand (30,000) gallons are received in a day or seventy-five thousand (75,000) gallons are received in a week, no additional septage is accepted unless authorized by YCUA Management.

**Fee Structure** –The current charge for septage discharged to the YCUA Wastewater Treatment facility is **\$0.07 per gallon**.

**Invoicing** - All permitted Septage Haulers will have an account established with the YCUA Accounts Receivable Department. The information necessary for monthly invoicing of the Septage Hauler will be maintained and updated as necessary.

Maintenance Stockroom personnel forwards YCUA WWTP Septage Hauling Records to the Industrial Pretreatment Supervisor monthly for review.

Industrial Pretreatment Supervisor totalizes the gallons discharged by each company monthly and provides the YCUA Accounts Receivable Department with a monthly summary.

YCUA Accounts Receivable Department invoices each Septage Hauler monthly.

Failure by the Septage Hauler to compensate the YCUA within **thirty days of invoice date** may result in loss of unloading privileges at the YCUA WWTP or be required to maintain a deposited amount with the YCUA equal to the largest outstanding balance on YCUA records.

**Acceptance Procedure** – The YCUA utilizes a formal application (see **Exhibit IV**) and permitting process to authorize a Septage Hauler Company to discharge septage waste into the YCUA WWTP. The YCUA Industrial Pretreatment Program (IPP) administers the Septage Acceptance Program at the YCUA.

Septage Haulers with a current Septage License from the Michigan Department of Environmental Quality (MDEQ) is eligible to complete an application for a YCUA Septage Permit. The IPP Supervisor evaluates the permit applications and verifies the authenticity of the Septage License. If all of the credentials are acceptable a YCUA Septage Permit is generated. The Septage Hauler is scheduled for an orientation at the YCUA WWTP Administration Building and the Operating Plan for Septage Acceptance is presented.

**Unloading Procedure:**

The Licensed Septage Hauler arrives at YCUA WWTP and goes to the Maintenance Department Stockroom. The Stockroom Personnel oversee the Driver's entry of information onto the Septage Hauler Record Form, whereby the date, time of arrival, truck ID number, gallons to discharge, and signature are recorded. Failure by driver to properly fill out Septage Hauler Record Form may result in loss of unloading privileges.

The Driver obtains an empty sample bottle from Maintenance Stockroom, labels bottle with date, time, and Driver's name and proceeds to septage unloading station.

YCUA personnel may perform an audit, which involves inspecting the septage load during delivery for verification of volume and content of discharge. Verification of Truck Identification Number and Drivers Signature may also be required. Discrepancies from volume or any other information provided on Septage Hauler Record Form may result in loss of discharge privileges at the YCUA.

Driver unloads at septage unloading station. A representative sample is obtained from load approximately halfway through discharge.

After completion of discharge, driver hoses off back end of truck and receiving area as necessary to reduce unsanitary conditions.

Filled, properly labeled sample bottle is returned to sample refrigerator near Maintenance Stockroom for analysis by the YCUA.

## GENERAL CONDITIONS

### Severability

The provisions of this permit are severable, and if any provision of this permit, or the application of any provision of this permit to any circumstance, is held invalid, the application of such provision to other circumstances, and the remainder of this permit, shall not be affected thereby.

### Duty to Comply

The permittee must comply with all conditions of this permit. Failure to comply with the requirements of this permit may be grounds for administrative action, or enforcement proceedings including civil or criminal penalties, injunctive relief, and summary abatement.

### Duty to Mitigate

The permittee shall take all reasonable steps to minimize or correct any adverse impact to the public treatment plant or the environment resulting from noncompliance with this permit, or any other federal, state, or local laws, ordinances or standards.

### Permit Modification and Termination

This permit may be modified or terminated for good causes including, but not limited to, the following:

- a. To incorporate any new or revised Federal, State, or local laws, standards, ordinances or requirements
- b. Material or substantial alterations or additions to the discharger's operation, or discharge volume or character, which were not considered in drafting the effective permit
- c. A change in any condition in either the septage hauler or the POTW that requires either a temporary or permanent reduction or elimination of the authorized discharge
- d. Information indicating that the permitted discharge poses a threat to the Control Authority's collection and treatment systems, POTW personnel or the receiving waters
- e. Violation of any terms or conditions of the permit
- f. Misrepresentation or failure to disclose fully all-relevant facts in the permit application or in any required reporting
- g. Revision of or a grant of variance from any federal, state, or local laws, standards, or ordinances
- h. To correct typographical or other errors in the permit
- i. To reflect transfer of the facility ownership and/or operation to a new owner/operator
- j. Upon request of the permittee, provided such request does not create a violation of any applicable requirements, standards, laws, ordinances or rules and regulations
- k. Falsifying any reports
- l. Refusing to allow timely access to the facility premises and records
- m. Failure to meet discharge limitations
- n. Failure to pay fines

- o. Failure to pay septage-billing charges
- p. Failure to meet compliance schedules

The filing of a request by the permittee for a permit modification, revocation and re-issuance, or termination, or a notification of planned changes or anticipated noncompliance, does not stay any permit condition.

### Permit Appeals

The permittee may petition to appeal the terms of this permit within thirty (30) days of the notice. This petition must be in writing; failure to submit a petition for review shall be deemed to be a waiver of the appeal. In its petition, the permittee must indicate the permit provisions objected to, the reasons for this objection, and the alternative condition, if any, it seeks to be placed in the permit.

The effectiveness of this permit shall not be stayed pending reconsideration by the Board. If, after considering the petition and any arguments put forth by the Director, the Board determines that reconsideration is proper, it shall remand the permit back to the Director for re-issuance. Those permit provisions being reconsidered by the Director shall be stayed pending re-issuance.

A Board of Director's decision not to reconsider a final permit shall be considered final administrative action for purposes of judicial review.

### Property Rights

The issuance of this permit does not convey any property rights of any sort, or any exclusive privileges, nor does it authorize any injury to private property or any invasion of personal rights, nor any violation of Federal, State, or local laws or regulations.

### Limitation on Permit Transfer

Permits may be reassigned or transferred to a new owner and/or operator with prior approval of the Director:

- a. The permittee must give at least thirty (30) days advance notice to the Director
- b. The notice must include a written certification by the new owner which:
  - (i) States that the new owner has no immediate intent to change the facility's operation or discharge
  - (ii) Identifies the specific date on which the transfer is to occur
  - (iii) Acknowledges full responsibility for complying with the existing permit.

### Duty to Reapply

If the permittee wishes to continue an activity regulated by this permit after the expiration date of this permit, the permittee must submit an application for a new permit at least ninety (90) days before the expiration date of this permit.

### Continuation of Expired Permits

An expired permit will continue to be effective and enforceable until the permit is reissued if:

- a. The permittee has submitted a complete permit application at least ninety (90) days prior to the expiration date of the users existing permit.
- b. The failure to reissue the permit, prior to expiration of the previous permit, is not due to any act or failure to act on the part of the permittee.

### Dilution

The permittee shall not increase the use of potable or, in any way; attempt to dilute to achieve compliance with the limitations contained in this permit.

### Compliance with Applicable Pretreatment Standards and Requirements

Compliance with this permit does not relieve the permittee from its obligations regarding compliance with any and all applicable local, State and Federal pretreatment standards and requirements including any such standards or requirements that may become effective during the term of this permit.

### Representative Sampling

Samples and measurements taken as required herein shall be representative of the volume and nature of the monitored discharge. All samples shall be taken at the monitoring points specified in this permit. Monitoring points and procedures shall not be changed without notification to and the approval of the Ypsilanti Community Utilities Authority.

### Volume Measurements

If this permit requires volume measurement, the appropriate volume measurement devices and methods consistent with approved scientific practices shall be selected and used to ensure the accuracy and reliability of measurements of the volume of monitored discharges. The devices shall be installed, calibrated, and maintained to ensure that the accuracy of the measurements is consistent with the accepted capability of that type of device. Devices selected shall be capable of measuring volumes with a maximum deviation of less than 10 percent from true volume rates throughout the range of expected discharge volumes.

### Analytical Methods to Demonstrate Continued Compliance

All sampling and analysis required by this permit shall be performed in accordance with the techniques prescribed in 40 CFR Part 136 and amendments thereto, otherwise approved by EPA, or as specified in this permit.

### Inspection and Entry

The permittee shall allow the Ypsilanti Community Utilities Authority, or an authorized representative, upon the presentation of credentials and other documents as may be required by law, too:

- a. Enter upon the permittee's premises where a regulated activity is located or conducted, or where records must be kept under the conditions of this permit;
- b. Have access to and copy, at reasonable times, any records that must be kept under the conditions of this permit;

- c. Inspect at reasonable times any facilities, equipment, including monitoring and control equipment, practices, or operations regulated or required under this permit;
- d. Sample or monitor, for the purposes of assuring permit compliance, any substances or parameters at any location; and
- e. Inspect any production, manufacturing, fabricating, or storage area where pollutants, regulated under the permit, could originate, be stored, or be discharged to the sewer system.

#### Retention of Record

All records that pertain to matters that are the subject of special orders or any other enforcement or litigation activities brought by the Ypsilanti Community Utilities Authority, or any other federal, state or local governing agency, shall be retained and preserved by the permittee until all enforcement activities have concluded and all periods of limitation with respect to any and all appeals have expired.

#### Falsifying Information

Knowingly making any false statement on any report or other document required by this permit or knowingly rendering any monitoring device or method inaccurate, is a crime and may result in the imposition of criminal sanctions and/or civil penalties.

#### Planned Changes

The permittee shall give thirty days notice, to the Ypsilanti Community Utilities Authority, of any truck modifications, truck volumes or truck fleet changes which result in new or substantially increased discharges, or if there is a change in the nature of the discharge.

#### Anticipated Noncompliance

The permittee shall give advance notice to the Ypsilanti Community Utilities Authority of any planned changes, which may result in noncompliance with permit requirements.

#### Duty to Provide Information

The permittee shall furnish to the Ypsilanti Community Utilities Authority, within ten (10) days any information which the Ypsilanti Community Utilities Authority may request to determine whether cause exists for modifying, revoking and reissuing, or terminating this permit, or to determine compliance with this permit. The permittee shall also, upon request, furnish to the Ypsilanti Community Utilities Authority within ten (10) days copies of any records required to be kept by this permit.

#### Signatory Requirements

All applications, reports, or information submitted to the Ypsilanti Community Utilities Authority must contain the following certification statement and be signed by the owner(s) of the septic hauling company.

*" I certify under penalty of law that this document and all attachments were prepared under my direction or supervision in accordance with a system designed to assure that qualified personnel properly gather and evaluate the information submitted. Based on my inquiry of the person or persons who manage the system, or those persons directly responsible for gathering the information, the information submitted is, to the best of my knowledge and belief, true, accurate, and complete. I am aware that there are significant penalties for submitting false information, including the possibility of fine and imprisonment for knowing violations."*

Civil and Criminal Liability

Nothing in this permit shall be construed to relieve the permittee from civil and/or criminal penalties for noncompliance under sewer use ordinance or State or Federal laws or regulations.

Penalties for Violations of Permit Conditions

The sewer use ordinance provides that any person who violates a permit condition may be subject to a civil penalty of \$1000 per day of such violation. Any person who willfully or negligently violates permit conditions is subject to criminal penalties of a fine of up to \$500 per day of violation, or by imprisonment for 90 days(s), or both. The permittee may also be subject to sanctions under State and/or Federal law.

Recovery of Costs Incurred

In addition to civil and criminal liability, the permittee violating any of the provisions of this permit or sewer use ordinance or causing damage to or otherwise inhibiting the Ypsilanti Community Utilities Authority wastewater disposal system shall be liable to the Ypsilanti Community Utilities Authority for any expense, loss, or damage caused by such violation or discharge. The Ypsilanti Community Utilities Authority shall bill the permittee for the costs incurred by the Ypsilanti Community Utilities Authority for any cleaning, repairing, or replacement work caused by the violation or discharge. Refusal to pay the assessed costs shall constitute a separate violation of the sewer use ordinance.

**RECEIVED**  
MICH. DEPT. OF ENVIRONMENTAL QUALITY  
OCT 13 2005  
WATER BUREAU  
DWEHS

## **GENERAL PROHIBITIVE DISCHARGE STANDARDS**

The permittee shall comply with all the general prohibitive discharge standards in the sewer use ordinance. Namely, the septage hauler shall not discharge to the YCUA WWTP:

- A. Any liquids, solids or gases which by reason of their nature or quantity are, or may be, sufficient either alone or by interaction with other substances to cause fire or explosion or be injurious in any other way to the sewage works or to the operation of the sewage works.
- B. Solids or viscous substances, which may cause obstruction to the flow or other interference with the operation of the wastewater treatment facilities.
- C. Any wastewater having a pH less than 5.0 or greater than 11.0; or wastewater having any other corrosive property capable of causing damage or hazard to structure, equipment, or personnel of the YCUA WWTP.
- D. Any wastewater containing toxic pollutants or of high chlorine demand in sufficient quantity, either singly or by interaction with other pollutants, to injure or interfere with any wastewater treatment process, constitute a hazard to humans or animals, create a toxic effect in the receiving waters of the YCUA WWTP, or exceed the limitation set forth in the EPA Categorical Pretreatment Standard, or any other Federal, State or Local standards.
- E. Any noxious or malodorous liquids, gases, or solids which either singly or by interaction with other wastes are sufficient to create a public nuisance or hazard to life or are sufficient to prevent entry into any YCUA WWTP process for maintenance and repair.
- F. Any substance such as residues, sludges, or scums, which may cause the sewage, works to be unsuitable for land application or reclamation and reuse or to interfere with the reclamation process.
- G. Any substance, which will cause the sewage, works to violate its NPDES Permit or the receiving water quality standards.
- H. Any wastewater with color or sufficient light absorbance to interfere with treatment plant process, prevent analytical determinations, or create any aesthetic effect on the treatment plant effluent, such as, but not limited to, dye wastes and vegetable tanning solutions.
- I. Any wastewater having a temperature which will inhibit biological activity in the sewage works resulting in Interference, but in no case wastewater with a temperature at the introduction into the sewage works which exceeds 60 degrees Celsius (140F) or is lower than 0 degree Celsius (32F).
- J. Any wastewater containing any radioactive wastes or isotopes of such half-life or concentration as may exceed limits established by applicable State or Federal regulations.
- K. Any wastewater that causes a hazard to human life or creates a public nuisance.

**RECEIVED**  
MICH. DEPT. OF ENVIRONMENTAL QUALITY

OCT 13 2005

WATER BUREAU  
DWEHS

- L. Containing Freon extractable substances such as fats, wax, grease, or oils of petroleum origin, whether emulsified or not, in excess of 100 mg/l or containing substances which may solidify or become viscous at temperatures between 32 degrees F and at 140 degrees F.
- M. Gasoline, benzene, naphtha, fuel oil or other flammable or explosive liquids, solids, gases or other pollutants which cause the wastewater to have a closed cup flashpoint of less than 140 degrees F, or pollutants which cause an exceedance of 10 percent of the Lower Explosive Limit (LEL) at any point within the POTW, or containing gasoline, benzene, xylene or toluene which causes the wastewater to exceed the State of Michigan Surface Water Quality Standards.
- N. Any garbage that has not been ground by household type or other suitable garbage grinders.
- O. Any ashes, cinders, sand, mud, straw, shavings, metal, glass, rags, feathers, tar, plastics, wood, paunch, manure, or any other solids or viscous substances capable of causing obstructions or other interferences with proper operation of the sewer system.
- P. Toxic or poisonous substances in sufficient quantity to injure or interfere with any wastewater treatment process, to constitute hazards to humans or animals, or to create any hazard in waters that receive treated effluent from the sewer system treatment plant. Toxic wastes shall include, but are not limited to wastes containing cyanide, chromium, cadmium, mercury, copper, and nickel ions.
- Q. Solids of such character and quantity that special and unusual attention required for their handling.
- R. Any substance which would cause the treatment plant to be in noncompliance with sludge use, recycle or disposal criteria pursuant to guidelines or regulations developed under section 405 of the Federal Act, the Solid Waste Disposal Act, the Clean Air Act, the Toxic Substances Control Act or other regulations or criteria for sludge management and disposal as required by the State.
- S. Any medical or infectious wastes prohibited from being discharged under Federal or State law and regulations.
- T. Any pollutant, including BOD pollutants, released at a volume rate and/or pollutant concentration, which would cause interference with the treatment plant.
- U. Material considered a hazardous waste under the Resource Conservation and Recovery Act (RCRA).
- V. Any commercial or industrial waste that may cause pass through of pollutants or interference with the wastewater treatment plant operations or that violates Federal, State, or local restrictions.
- W. Trucked and hauled wastes, except by permit and only at discharge points designated by YCUA.
- X. Pollutants causing toxic gases, vapors, and fumes.
- Y. Any untreated landfill leachate from any site classified as a 201 Site by the DEQ.
- Z. Any leachate from a hazardous waste landfill or one containing polychlorinated biphenyls.



YPSILANTI COMMUNITY UTILITIES AUTHORITY

September 28, 2006

Mr. Matt Campbell, Septage Waste Program Coordinator  
Drinking Water and Environmental Health Section, Water Bureau  
Michigan Department of Environmental Quality  
525 West Allegan Street  
Lansing, MI 48909-7773

2777 STATE ROAD  
YPSILANTI, MICHIGAN 48198-9112  
TELEPHONE: (734) 484-4600  
FAX: (734) 484-3369  
WEBSITE: www.ycua.org

RECEIVED  
MICH DEPT OF ENVIRONMENTAL QUALITY

SEP 29 2006

Water Division  
Groundwater Section  
WELL CONSTRUCTION UNIT

Dear Mr. Campbell:

The Ypsilanti Community Utilities Authority's (YCUA) NPDES Permit # MI0042676 is hereby submitting notification of a proposed amendment to the **YCUA Wastewater Treatment Plant (WWTP) Operating Plan for Septage Receiving.**

The YCUA propose to amend the area that YCUA will accept domestic only septage from in the YCUA Operating Plan for Septage Receiving. The service area section of the YCUA Wastewater Treatment Plant (WWTP) Operating Plan for Septage Receiving will be amended as shown below:

**Service Area** – By the Michigan Department of Environmental Quality (MDEQ) definition the “Service Area” is the area that is up to fifteen (15) radial miles from a Septage Receiving Facility beginning October 12, 2005 through October 12, 2010. The Septage Haulers must discharge any septage collected in this service area into a WWTP Septage Receiving Facility. The Septage Hauler do not have to discharge the collected septage into the Septage Receiving Facility that is at the center of the service area, but because there is a Septage Receiving Facility within this service area, the Septage Haulers cannot land apply septage that is collected within the fifteen mile service area. **Exhibit I** shows the area encompassed by a fifteen (15) mile radius around the YCUA WWTP Septage Receiving Facility. Due to the current available treatment capacity at the YCUA Wastewater Treatment Plant (WWTP), YCUA will accept domestic septage collected from areas inside and outside of the fifteen-mile radial area. **The septage discharge at the YCUA WWTP must be from domestic (residential) sources only.**

If you have any questions or if I can be of any assistance, please contact me.

Sincerely,

Perry M. Thomas  
YCUA Chief Compliance Officer

PMT: pt

Cc: Luther Blackburn, YCUA Industrial Pretreatment Program Supervisor  
YCUA Wastewater File