

MARQUETTE COUNTY
POWELL TOWNSHIP; WEST PART
T.52N R.28 and 29W

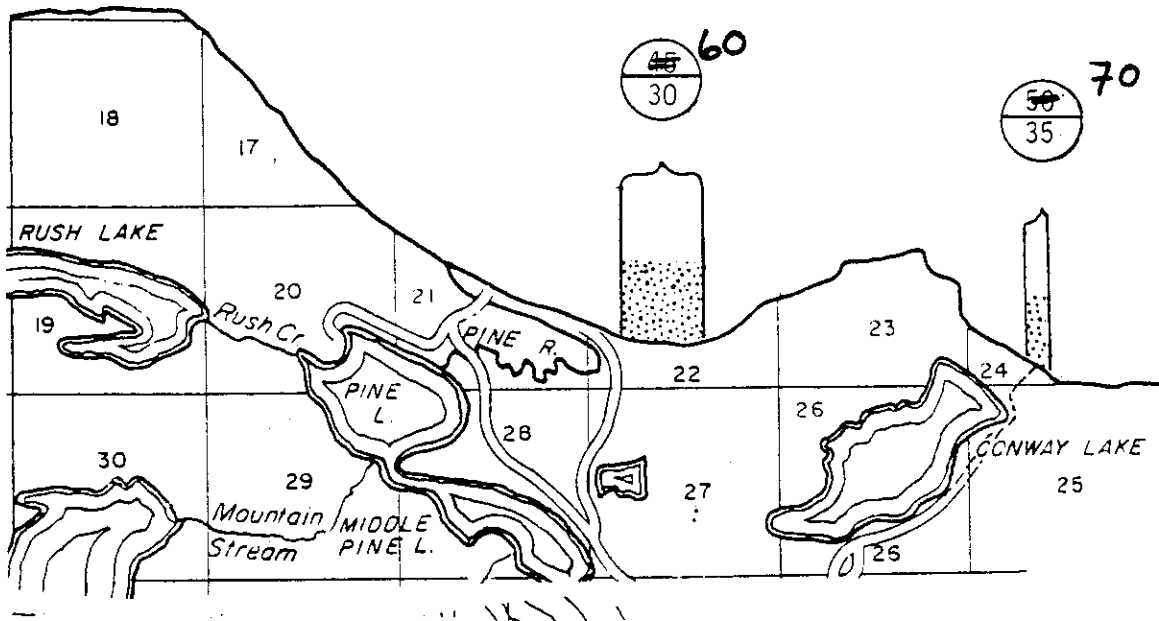

 60-year projected recession distance
 30-year projected recession distance

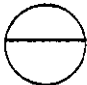

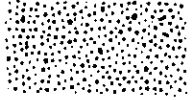

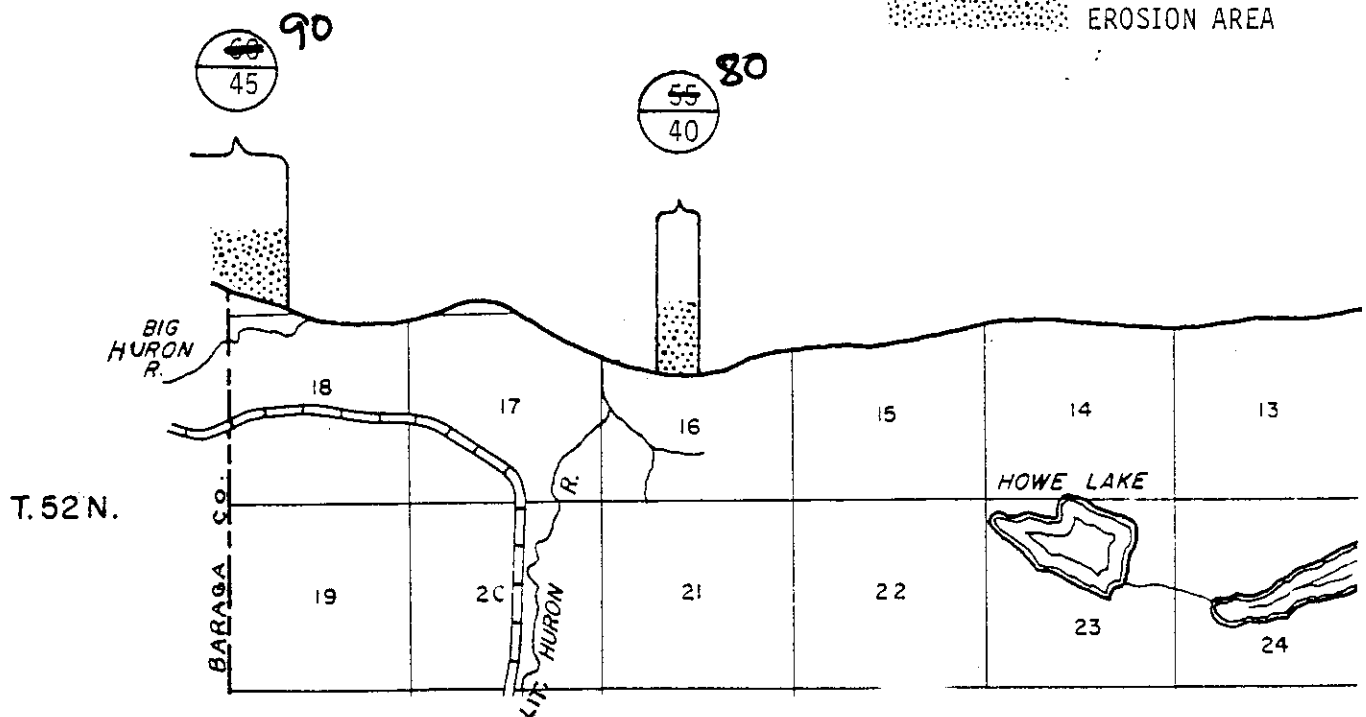
 WIDE SHADED BAND
 DEMARKS HIGH RISK
 EROSION AREA

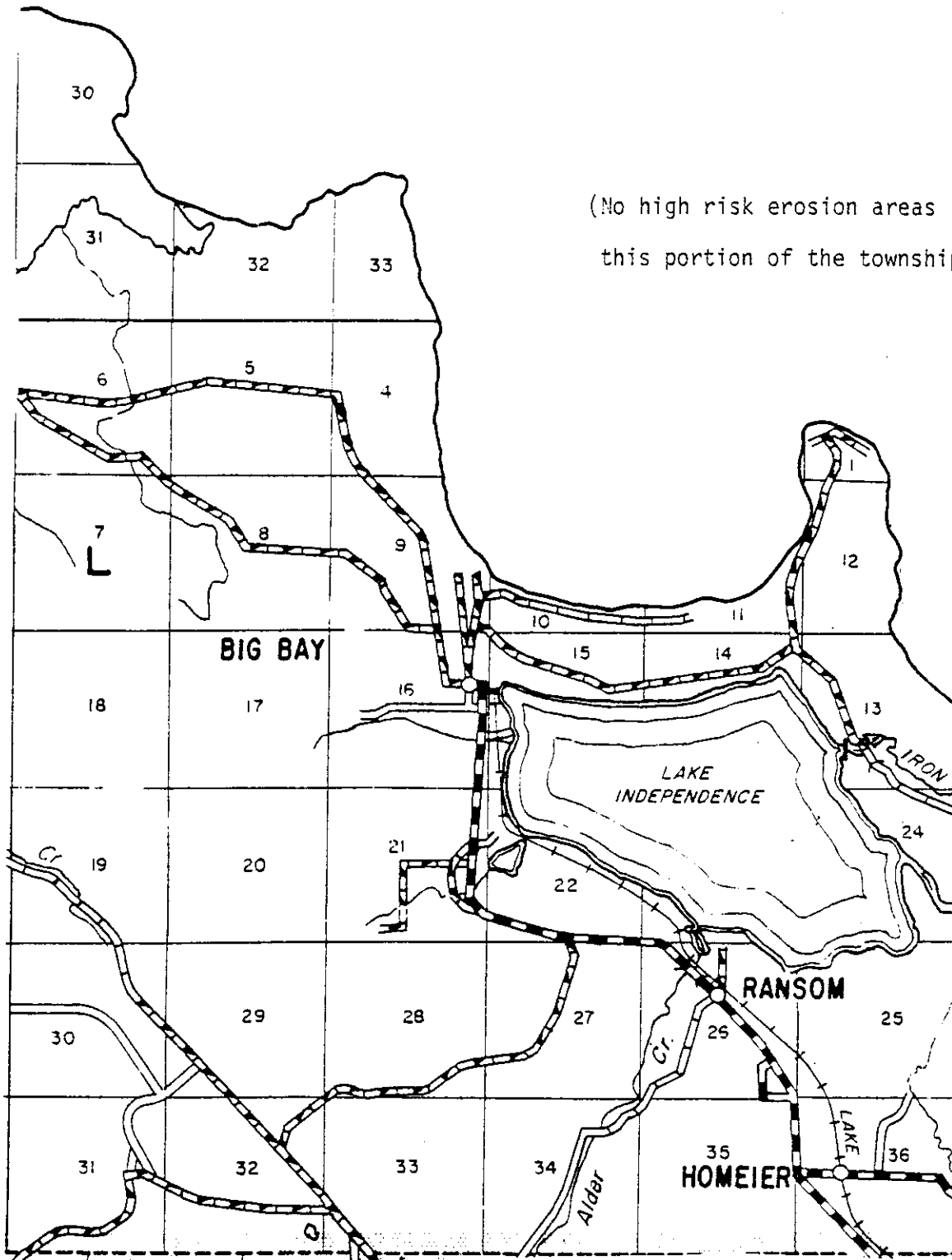

MARQUETTE COUNTY
POWELL TOWNSHIP: CENTRAL PART
T.51 and 52N R.27W

(No high risk erosion areas in
this portion of the township.)



MARQUETTE COUNTY
POWELL TOWNSHIP: EAST PART
T. 50 and 51N R. 26 and 27W

