

GENERAL DESIGN GUIDELINES

- 1 CONTACT TRAFFIC AND SAFETY SIGNALS UNIT FOR QUESTIONS CONCERNING SIGNAL PLANS
- 2 VERIFY THE EX ROW TO MAKE SURE ALL POLES ARE PLACED WITHIN THE EXISTING ROW.
IF EXISTING ROW IS NOT AVAILABLE, THEN PROPOSED ROW WILL BE REQUIRED IF A POLE
IS PLACED OUTSIDE EXISTING ROW.
- 3 VERIFY THE LOCATION OF ALL UTILITIES BOTH UNDERGROUND AND AERIAL. LABEL & FLAG
UNDERGROUND UTILITIES.

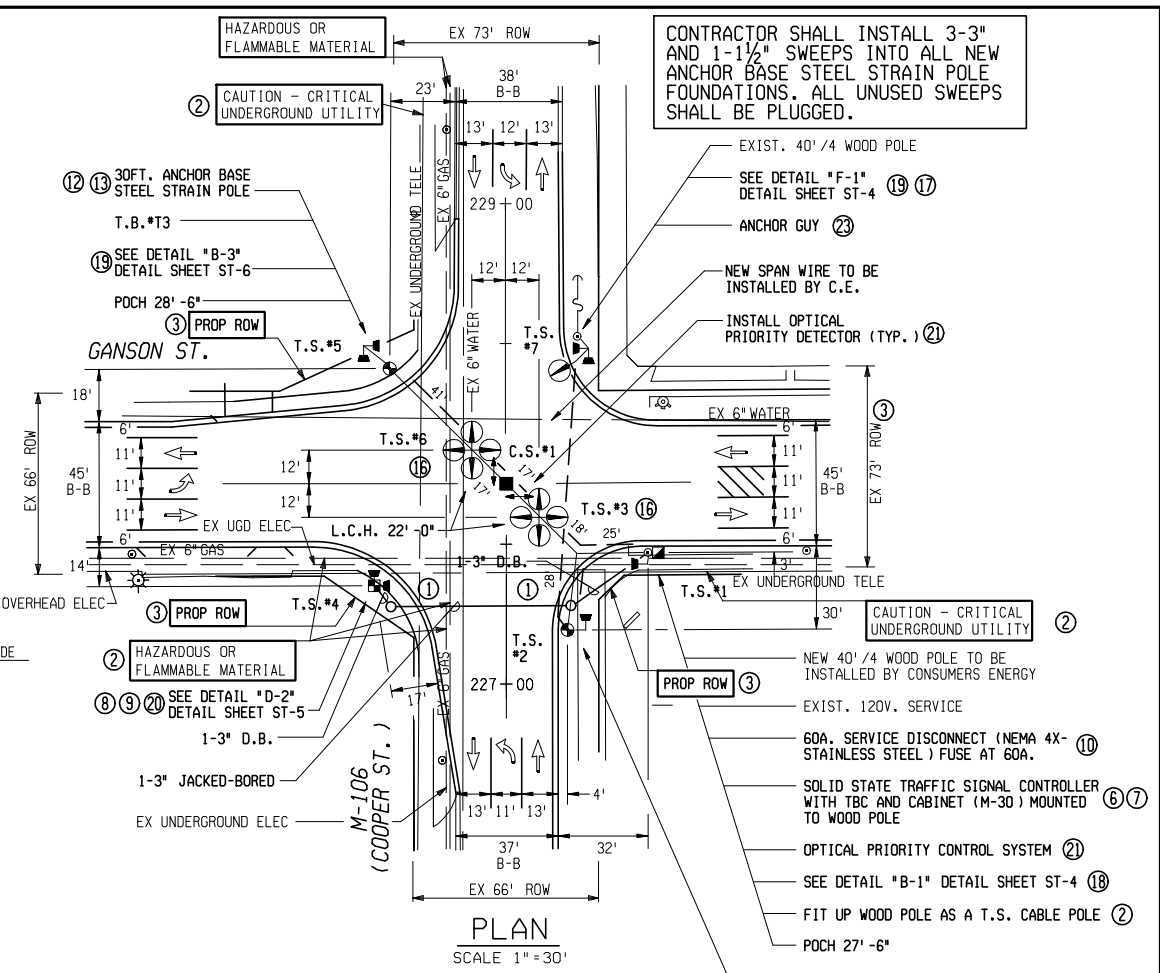
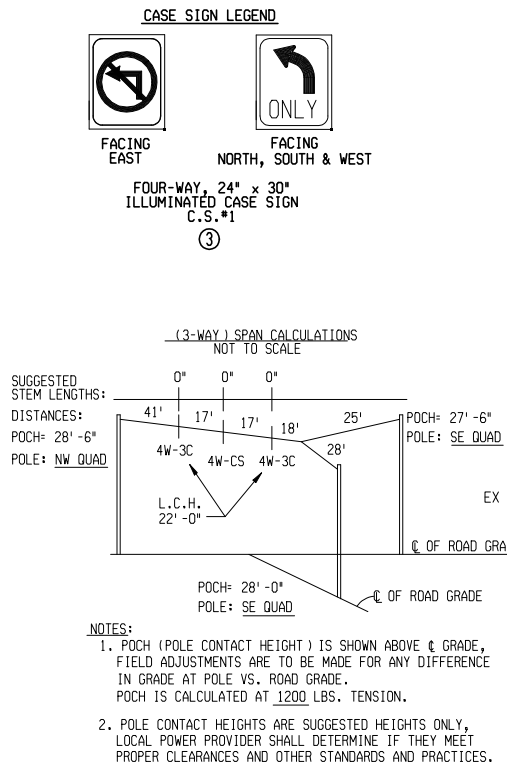
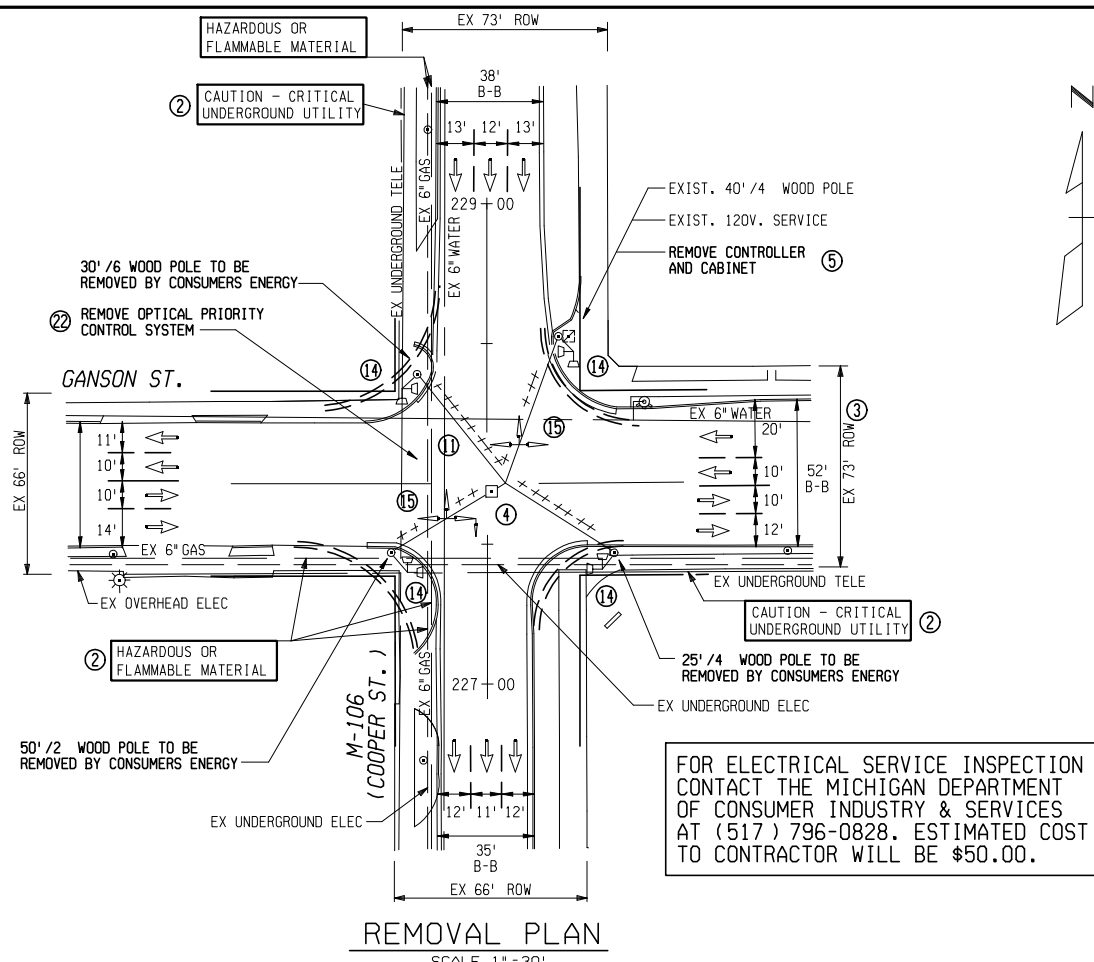

FOR ELECTRICAL SERVICE INSPECTION CONTACT THE MICHIGAN DEPARTMENT OF CONSUMER INDUSTRY & SERVICES AT (517) 796-0828. ESTIMATED COST TO CONTRACTOR WILL BE \$50.00.

NEW SPAN WIRE, 40' / 4 WOOD POLE & 120V. SERVICE BY CONSUMERS ENERGY. CONTACT MR. LARRY ARTHUR (517) 788-0161 EST. COST TO CONTRACTOR WILL BE \$2000.00

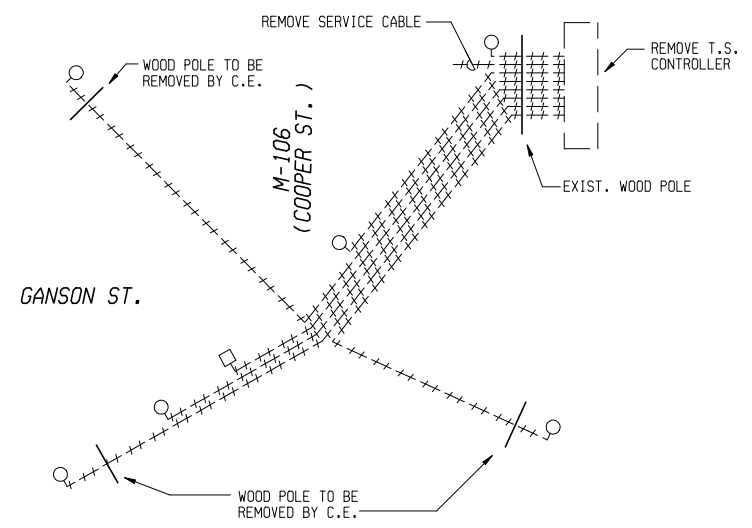

NO.	ITEM	MOQT QUANTITIES	JACKSON QUANTITIES	ITEM CODE
1	Hh, Round	2 Ea	Ea	8190260
2	Wood Pole, Fit Up, TS Cable Pole	1 Ea	Ea	8190501
3	Case Sign, Four Way, 24 inch by 30 inch	1 Ea	Ea	8200013
4	Case Sign, Rem	1 Ea	Ea	8200020
5	Controller and Cabinet, Rem	1 Ea	Ea	8200030
6	Controller and Cabinet, Solid State, TBC	1 Ea	Ea	8200040
7	Controller and Cabinet, Solid State, TBC, Delivered	1 Ea	Ea	8200041
8	Pedestal, Alum	1 Ea	Ea	8200100
9	Pedestal, Fdn	1 Ea	Ea	8200105
10	Serv Disconnect	1 Ea	Ea	8200135
11	Span Wire, Rem	1 Ea	Ea	8200141
12	Strain Pole Fdn, Cased	Ft	24 Ft	8200150
13	Strain Pole, Steel, Anchor Base, 30 foot	Ea	2 Ea	8200155
14	TS, Pedestrian, Bracket Arm Mtd, Rem	4 Ea	Ea	8200180
15	TS, Span Wire Mtd, Rem	2 Ea	Ea	8200182
16	TS, Four Way Span Wire Mtd	2 Ea	Ea	8200207
17	TS, One Way Bracket Arm Mtd	1 Ea	Ea	8200220
18	TS, Pedestrian, One Way Bracket Arm Mtd	2 Ea	Ea	8200225
19	TS, Pedestrian, Two Way Bracket Arm Mtd	2 Ea	Ea	8200227
20	TS, Pedestrian, Two Way Pedestal Mtd	1 Ea	Ea	8200237
21	Optical Priority Control System	Ea	1 Ea	8207050
22	Optical Priority Control System, Rem	Ea	1 Ea	8207050
23	Anchor Guy	1 Ea	Ea	8200001
24	Conduit, DB, 1, 3 inch	40 Ft	Ft	8190029
25	Conduit, Jacked Bored	65 Ft	Ft	8190135

* PHASE SELECTOR SHALL BE MODEL 452 AND DETECTORS SHALL BE MODEL 721 (OR APPROVED EQUAL.)

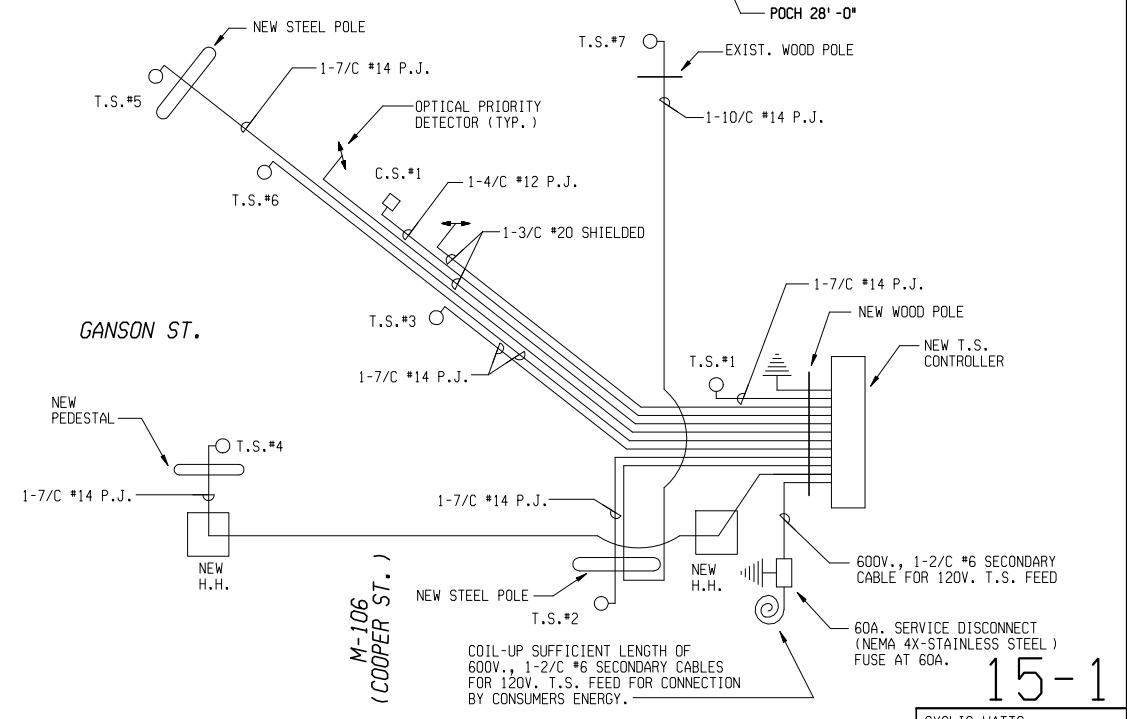

REMOVAL WIRING DIAGRAM

WIRING DIAGRAM

15-1

CYCLIC WATTS 5650
STEADY WATTS 275

CONTROL SECTION NHG 38051	JOB NUMBER 74578A	FEDERAL NUMBERS		MICHIGAN DEPARTMENT OF TRANSPORTATION	AUTH. NO. CONT. SEC. 38051	DRAWN AWS	DATE 5-15-03	M-106 (COOPER) AT GANSON CITY OF JACKSON JACKSON COUNTY	CONST SHEET NO. 61
		PROJECT	ITEM						