

NUNICA, HAT FIELD (5N7)

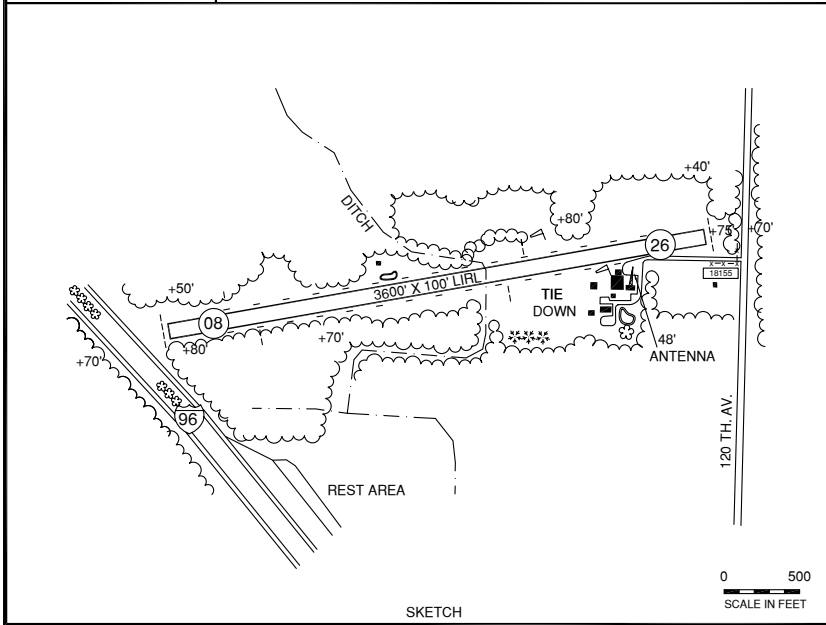
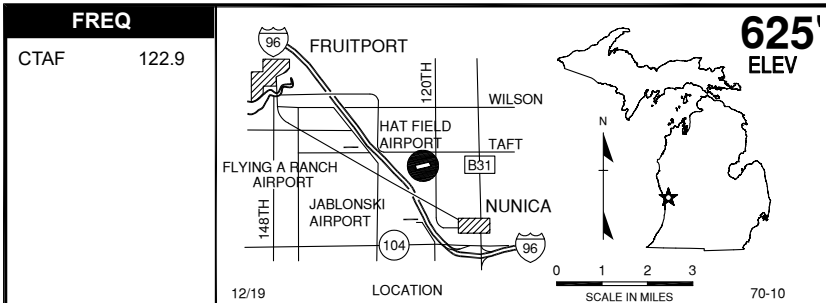

RWY LENGTH BEYOND DISPLACED THR
 08/ 3000'
 26/ 2400'

COORDINATES
 43° 05.83'N
 86° 05.68'W

License
 Basic Utility

FM CITY: 2 mi NW
LG T: Not for public use.
MGR: William G. Hatfield
 Nancy Hatfield, Asst
PH: 616-837-6979
FBO: Hatfield Spraying Svc & Turbine
 Conversions, Ltd 616-837-6979
ATND: Ireg - arpt CLSD Nov-Mar

NAV AIDS: 115.2 (MKG) 223° 4.6 NM to fld
FUEL: None
RPR: None
WX: None
SNW RMVL: None
TRNSP: None
MEALS: In town, 2 mi
RON: 8.0 mi

- TPA 1425 (800)
- Extensive ag opns.
- Deer & birds on & invof arpt.
- 48' antenna, 145' S of rwy centerline near hgrs/windsock .