

PINCONNING, GROSS (52I)

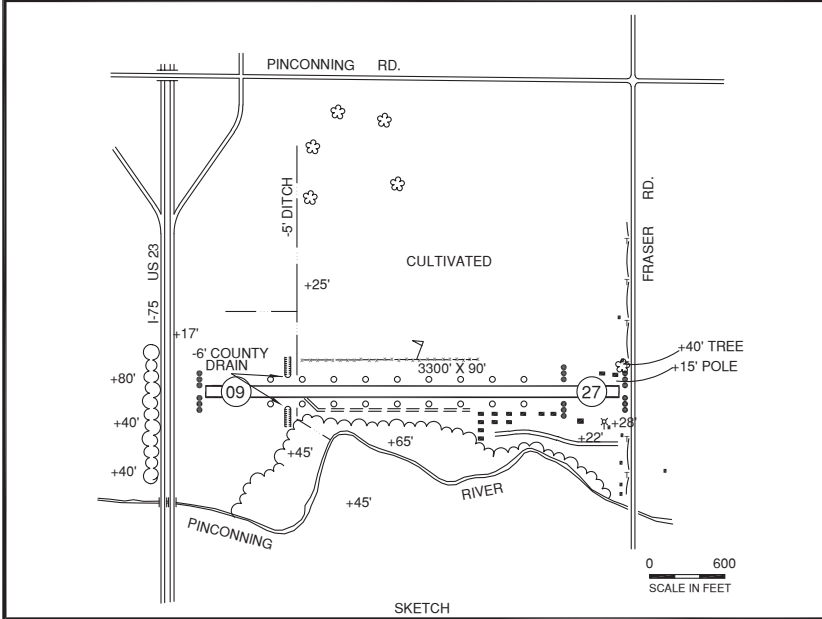
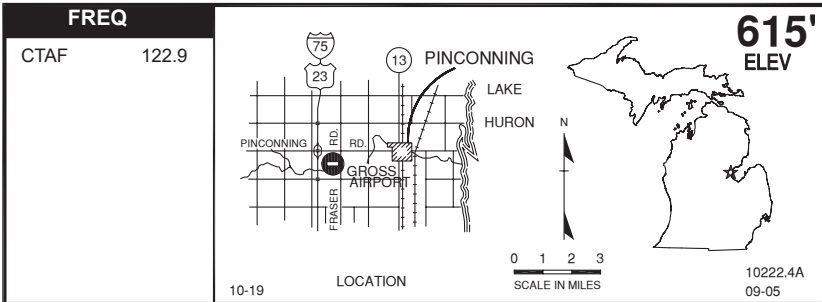

RWY LENGTH BEYOND DISPLACED THR

09/ 3100'
27/ 2858'

COORDINATES

43° 50.81'N
084° 00.68'W

License
Basic Utility

FM CITY: 3.0 mi W

LGT: LIRL* PCL—key mic 5X CTAF.

MGR: James M. Klein
Michael Hartman, Asst

PH: 989-239-9878

FBO: None

ATND: Intmt or by ph req**

NAV AIDS: 112.9 (MBS) 013° 18.0 NM to fld.

FUEL: None, Fuel avbl emerg only.

RPR: None

WX: None

SNW RMVL: Ireg***

TRNSP: By prior arngmt

MEALS: 0.5 mi, CC

RON: In town, 2.0 mi, CC

- *Lights avbl only when field usable.
- Admin bldg access—depress V, then simultaneous III-II, then I.
- **For arpt atndt call 989-239-9878.
- *** For snow rmvl call 989-708-7583.
- Ultralights use left t/c rwy 9/27 with a 500' agl TPA.
- -6' ditch 15' west of rwy 09.
- Ag ops summer mos.