



Belle Isle Park Advisory Committee

Meeting Minutes

Date: June 20, 2024

Location: 99 Pleasure Dr., Detroit, MI 48207

Meeting began at 9:00 a.m.

Quorum established at 9:00 a.m.

Roll Call

Present for BIPAC

Michele Hodges, Chair

Michael Curis

Angela Lugo-Thomas

Virtual:

Sommer Woods; Detroit, Michigan

Dr. Lonnie Peek; Detroit, Michigan

Absent

Meagan Elliott; Grosse Pointe, Michigan

DNR Staff Present

Tom Bissett

Gail Fitch

Amanda Treadwell

Marie Kaphengst

Darlisa Terrell

Cyntha Boggerty-Craft

Erika Compton

Others Present

Duncan Campbell, Oudolf Garden

Nancy Vella, Belle Isle Conservancy

Chair Hodges called the meeting to order at 9:00 a.m. and roll was taken. She congratulated Dr. Peek on his attainment of a doctorate. She then began with a mission moment with how important the island is to Detroiters. She took a moment to note that today is the anniversary of the beginnings of the 1943 race riot on Belle Isle and asked that they all reflect on the circumstances that may have led to it and to keep in mind the 30 lives that

were lost as a result of that riot. She also thanked Jeremy and his team for making the clock look beautiful this year.

Chair Hodges then asked for a motion to approve the May 16, 2024, meeting minutes. The motion to approve the minutes was made by Member Curis, supported by Member Peek, and passed unanimously.

The next item on the agenda was the Oudolf Garden Update. Present to give the update was grounds crew member, Duncan Campbell, who spoke about the garden's designer, Piet Oudolf, the site structure, an overview of the garden, and the QR code that takes you to the landing page where you can find an interactive garden map. His presentation is attached.

Tom Bissett, Urban District Supervisor, then provided the Parks and Recreation and park updates on the Recreation Passport Opt Out, boathouse, Scott Fountain, the slide, the reopening of the Flynn pavilion and park closures.

Tom Bissett also provided the Law update as Lt. Szyska was not available. He said more officers in the park have been certified on radar and there have been tickets written to enforce the speed limit. He also reminded everyone that there are no fireworks and no alcohol allowed in the park and his team is working with the City of Detroit and the Michigan State Police to coordinate the fireworks on Monday.

Amanda Treadwell then provided an infrastructure update, covering the Conservatory, ARPA projects, casino, and pavilion. Her report presentation is attached.

Amy Emmert, Director of Education and Engagement at the Belle Isle Conservancy, then provided the group with a presentation of the many community science projects taking place on the island. Of them, vernal pool monitoring, frog watching, butterfly monitoring, and examples of their partnerships. Her presentation is attached.

Public Comment

David – Questions about the update of the tennis courts and the upkeep of the grounds around the athletic area.

With no further business the meeting adjourned at 10:14 a.m.

Next regular meeting: Thursday, July 18, 2024.



Oudolf Garden Detroit Belle Isle Park Advisory Committee

06-20-2024

green space | community | economic impact | education | design

Duncan Campbell
Oudolf Garden Grounds Crew

duncan@oudolfgardendetroit.org

info@oudolfgardendetroit.org

A photograph of a garden landscape. In the foreground, a light-colored gravel path winds through a dense garden. The garden is filled with various plants, including tall, feathery grasses in shades of green and gold, clusters of small purple flowers, and some red-flowered plants. In the background, a dense forest of tall evergreen trees rises up a hillside. The overall scene is vibrant and naturalistic.

Piet Oudolf

Garden Club of Michigan: A Love Letter from Detroit



December 2016

This is a love letter from Detroit...

Dear Mr. Oudolf,

You have many fans in the Great Lakes State of Michigan and its Motor City of Detroit. We are writing to ask you to consider a commission in Detroit for a public natural perennial garden on Detroit's Belle Isle Park.



Historic View

New Queen Elizabeth Medal of Honor 2023



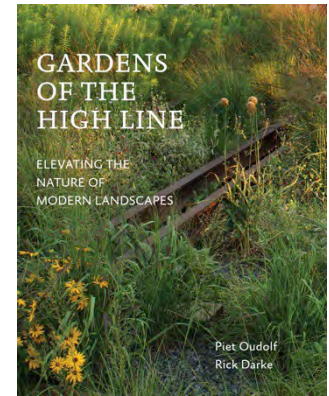
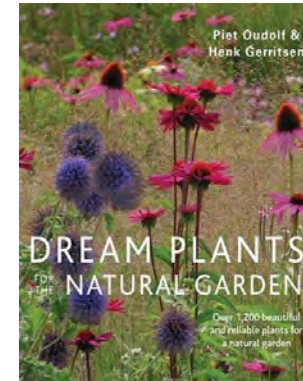
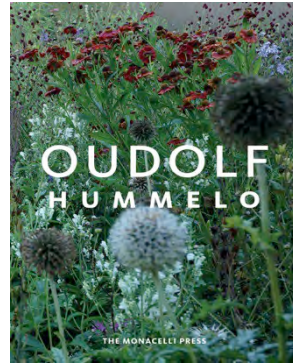
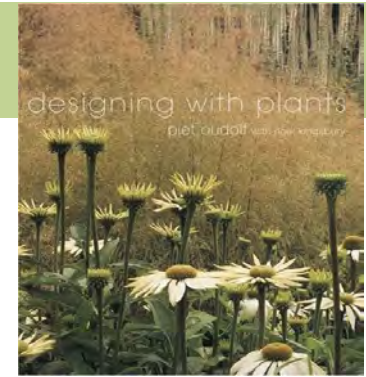
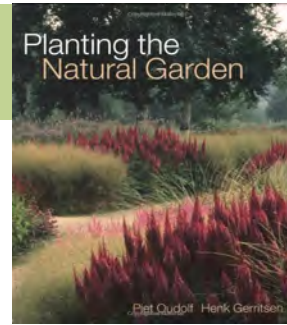

Books by Piet Oudolf



The Numbers

3 Acre Site

95,000 plants

\$5 Million Project

20 Year DNR Agreement with Two 15 Year Options

28,000 Volunteer Hours since 1-1-2020

401 Unique Volunteers

1 Paid Employee

A vibrant garden scene featuring a variety of plants. In the foreground, there are tall, thin stalks with dark, elongated seed heads. Behind them, a dense cluster of purple flowers is prominent, surrounded by green foliage. To the right, there are more purple flowers, some with a darker, almost black center. In the background, there are red flowers and yellow ones, all interspersed with tall, thin grasses. The overall scene is a lush, colorful garden.

Garden Overview

Garden Overview

Garden overview

Main Garden

Rain Garden

Bird Border

The Triangles

The Meadows

Planting & Boardwalk

Garden Overview



Oudolf Garden Detroit

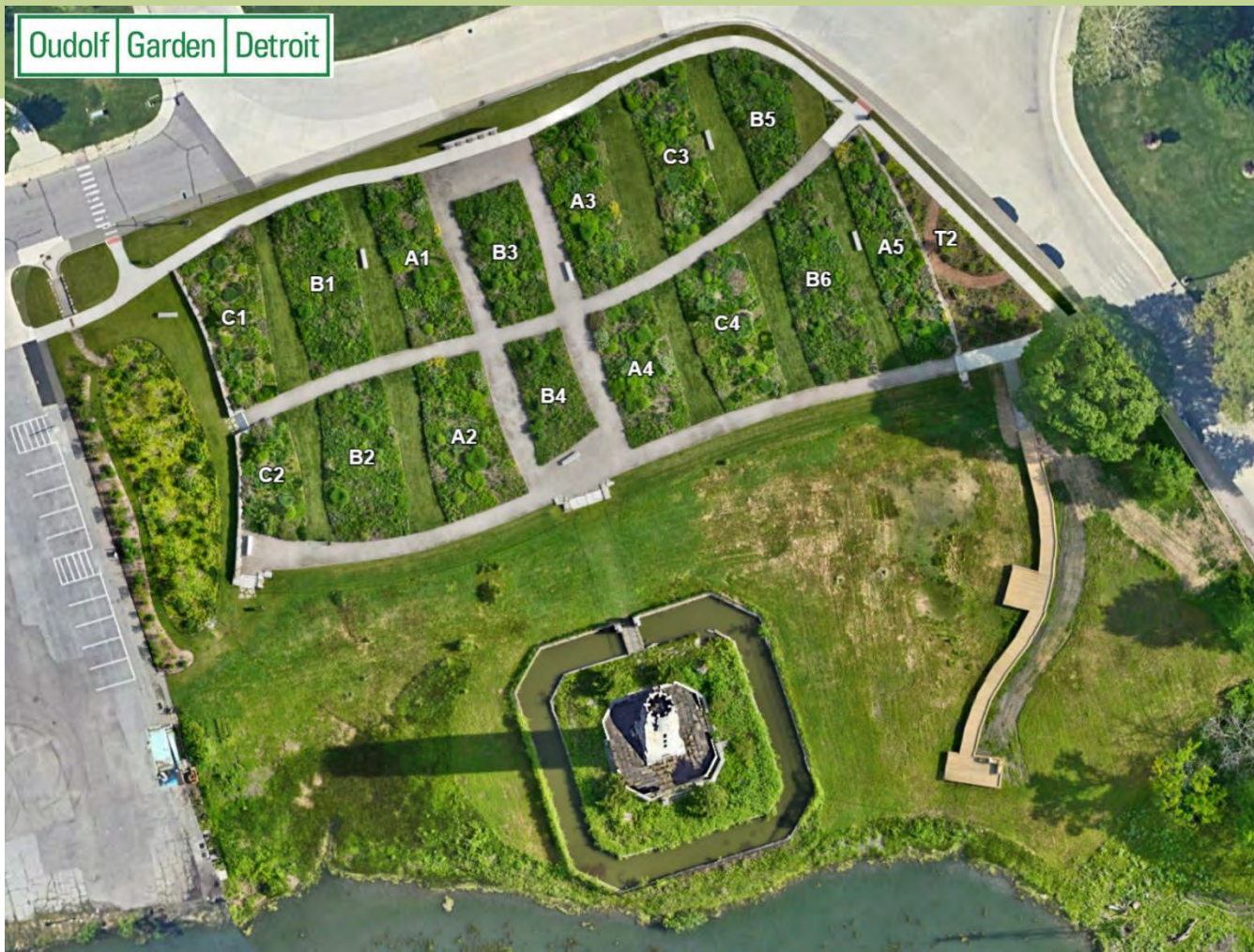





QR Code

QR Code-



QR Code Landing Page

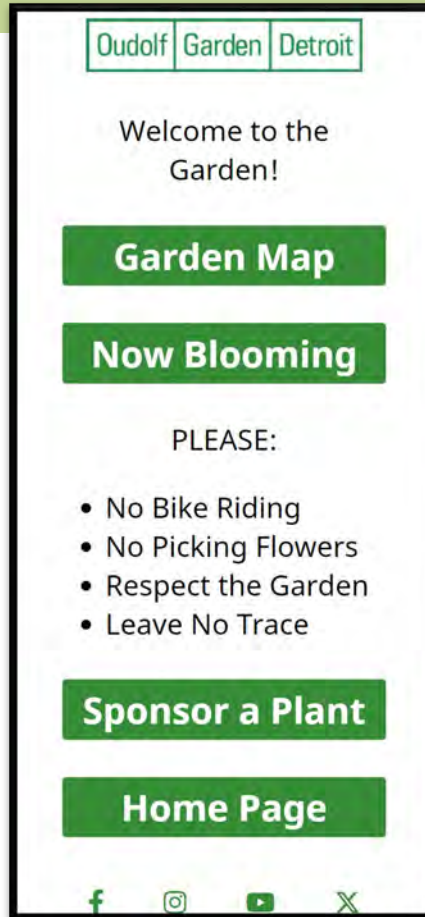



Challenges



Challenges in the Garden

Picking the Flowers

Stepping in the Beds

Photographers in the Beds

Bike Riding in the Garden

Deer Eating our Bulbs



Funding

Funding

Funding

No Public Money went to the Garden

Foundations

Large Donors

General Donations-2392 Total Donations

Sponsor A Plant

Endowment - Community Foundation for Southeast Michigan

What is Oudolf Garden Detroit?

An Independent All Volunteer Start Up Group who works with

Design Phase Sponsor:

Garden Club of Michigan 501(c)(3) Sponsor

Installation Phase Sponsor:

Belle Isle Conservancy 501(c)(3) Sponsor

Endowment Maintenance Phase Sponsor:

Community Foundation for Southeast Michigan 501(c)(3) Sponsor

Maintenance Group

Oudolf Garden Detroit (**Friends of the Oudolf Garden, Inc.**) is now a 501(c)(3)





Questions?

Duncan Campbell
Duncan@oudolfgardendetroit.org

green space | community | economic impact | education | design

Belle Isle Park Advisory Committee Infrastructure Updates

June 20, 2024



Anna Scripps Whitcomb Conservatory

Project Status

- Low Houses – Scaffolding being erected over the cactus house.
- Showroom – Floor Drains and floor being prepped for new concrete surfacing.
- Exterior sidewalks – Perimeter sidewalk replacement underway and Conservatory Garden sidewalks along front of Conservatory and at Gazebo to also be replaced.



Floor replacement in Showroom underway.

Anna Scripps Whitcomb Conservatory

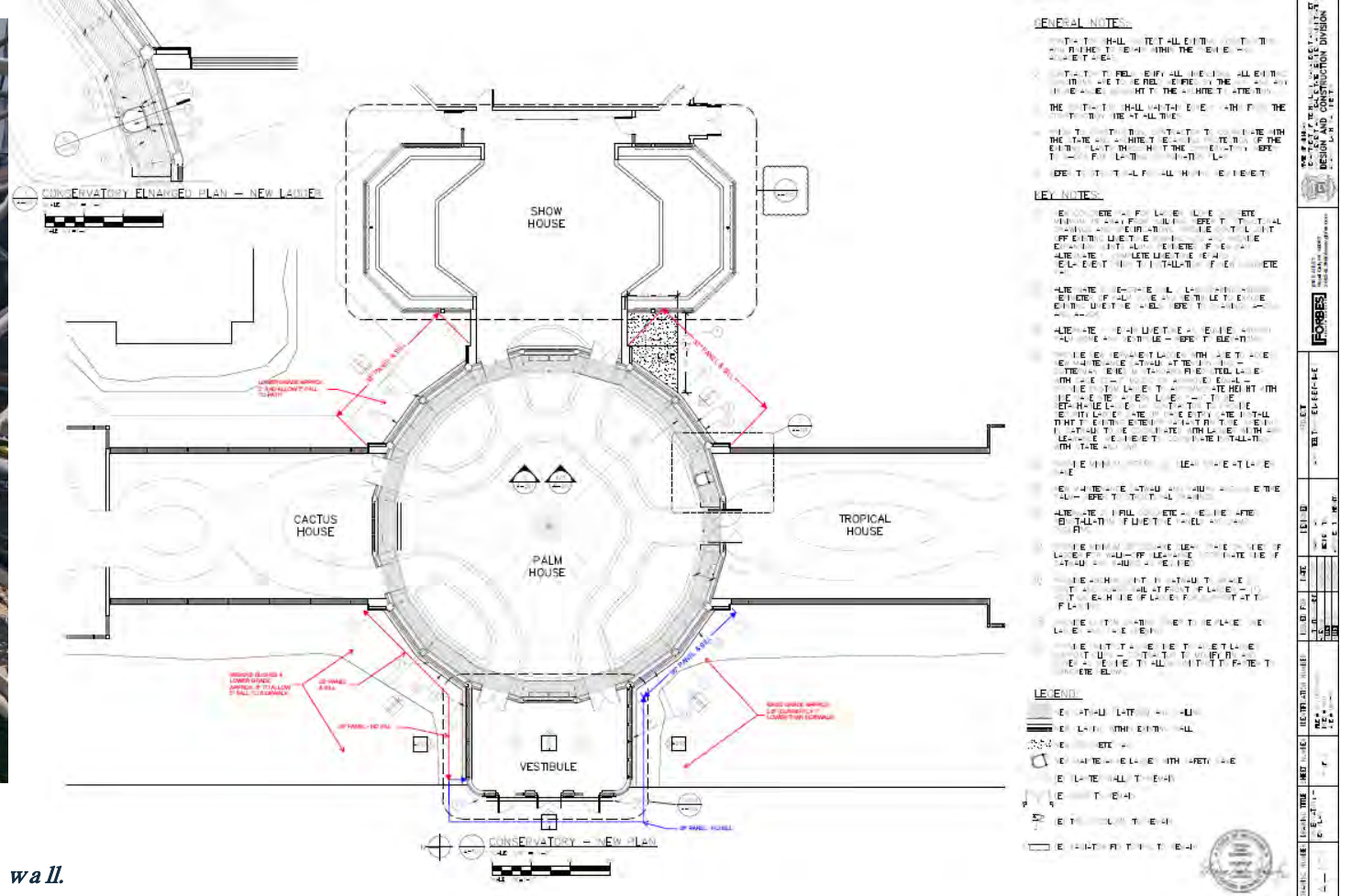

New Limestone Panels and Sill to be installed, Grading will drain in a way from wall.

Anna Scripps Whitcomb Conservatory



05) View of the installed scaffolding for the preparation of the lower glass.



06) View of the installed scaffolding for the preparation of the lower glass.

Anna Scripps Whitcomb Conservatory

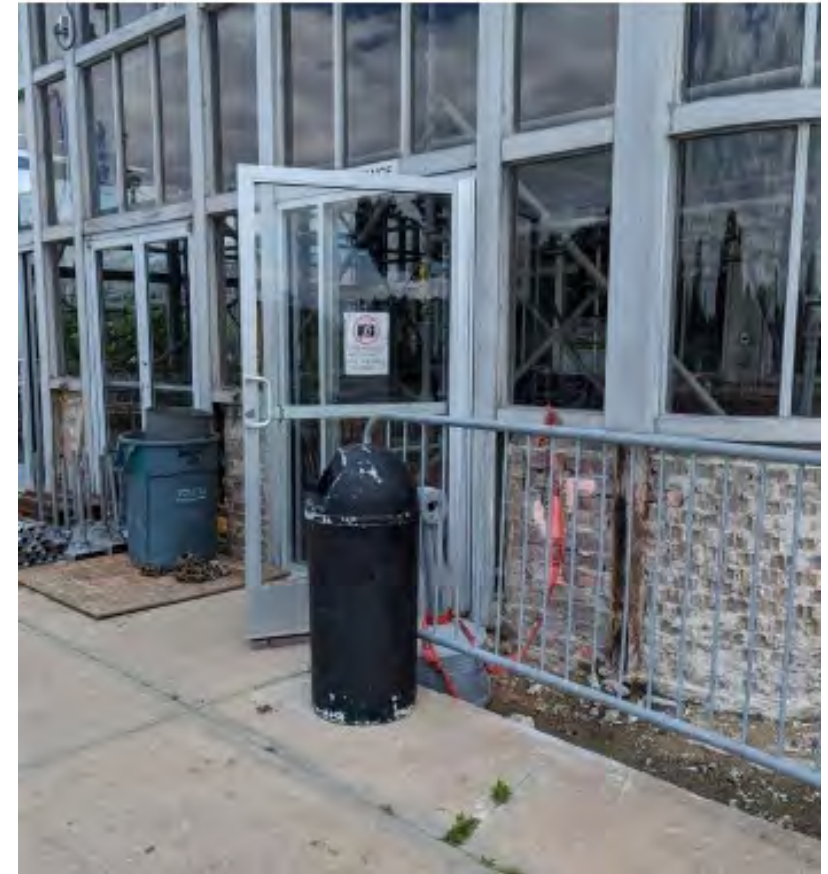

Limestone caps and sills removed. Will be replaced with new limestone on new level concrete base.

Anna Scripps Whitcomb Conservatory



01) View of the floor and railing supports for the lower catwalk area



02) View for the entire installed Copula catwalk system with hand railings

Anna Scripps Whitcomb Conservatory



Sidewalk replacement underway along front of facility at entrance and parking area.



American Rescue Plan Act Projects

	Project	Budget
➤	Scott Fountain structural stabilization	\$6,000,000.00
➤	Belle Isle Aquarium and Conservatory Facility Development plan and ADA access improvements	\$1,075,000.00
➤	Belle Isle Aquarium HVAC Construction	\$10,000,000.00
	Parkwide hazardous material abatement, structural repairs at multiple sites and removals	\$5,000,000.00
➤	Park Strategic Development Plan	\$525,000.00
➤	Park wayfinding signage	\$400,000.00
	TOTAL	\$23,000,000.00



Scope area of Belle Isle Aquarium, Anna Scripps Whitcomb Conservatory and Greenhouse facility Plan.

Belle Isle Casino



Construction crew working on gutters.



Flynn Pavilion



Community Science

Amy Emmert
Director of Education and
Engagement



Community Science Programs (AKA Citizen Science)

Slideshow of what a Citizen Science Program looks like.

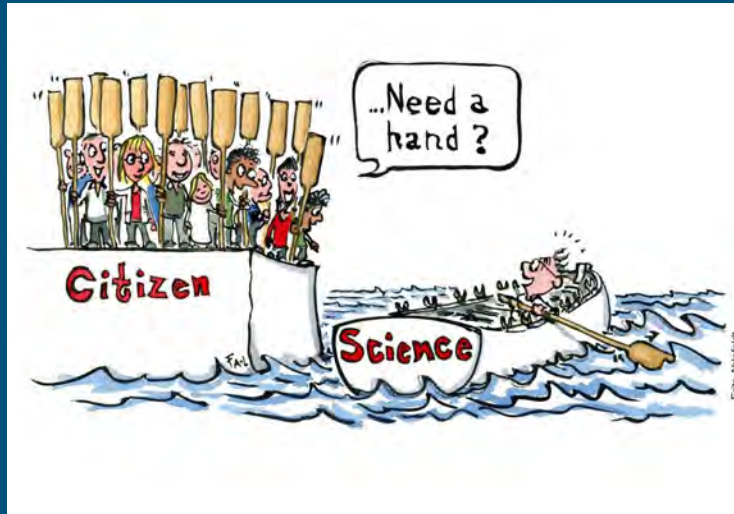

Vernal Pool Monitoring



Vernal Pool Training

Sunday, April 8, 2018

10:00 am – 3:00 pm

Leslie Science & Nature Center

1831 Traver Road, Ann Arbor, MI



Learn more about vernal pools and how you can help monitor and protect these important wetlands!

WHY: Vernal pools are small, isolated, temporary wetlands important for maintaining healthy forest ecosystems. Because these wetlands dry up and are fishless, they provide critical breeding habitats for amphibians and invertebrates. Because of their small size and temporary nature, vernal pools are vulnerable. Conservation of vernal pools requires increased awareness and protection.

WHAT: We will provide information on vernal pool ecology in the classroom, and then we will visit a vernal pool in the field and practice standard methods for monitoring a vernal pool in your area.

BRING: Dress for walking in the woods. Bring rubber boots or waders or old tennis shoes. Bring your own lunch. Beverages provided.

Workshop is free. Please ask us about acquiring a vernal pool monitoring kit when you register for the event.

Register: Phyllis Higman: higman@msu.edu 517-242-3269

Training provided by Michigan Natural Features Inventory, MSU Extension.



**MICHIGAN STATE
UNIVERSITY**

Extension



With support from the Leslie Science and Nature Center and Ann Arbor Natural Area Preservation.

Why are vernal pools important?

- **Habitat (breeding and otherwise)**
- Water and food source
- Habitat connectivity
- Flood buffering, runoff mitigation
- Nutrient cycling

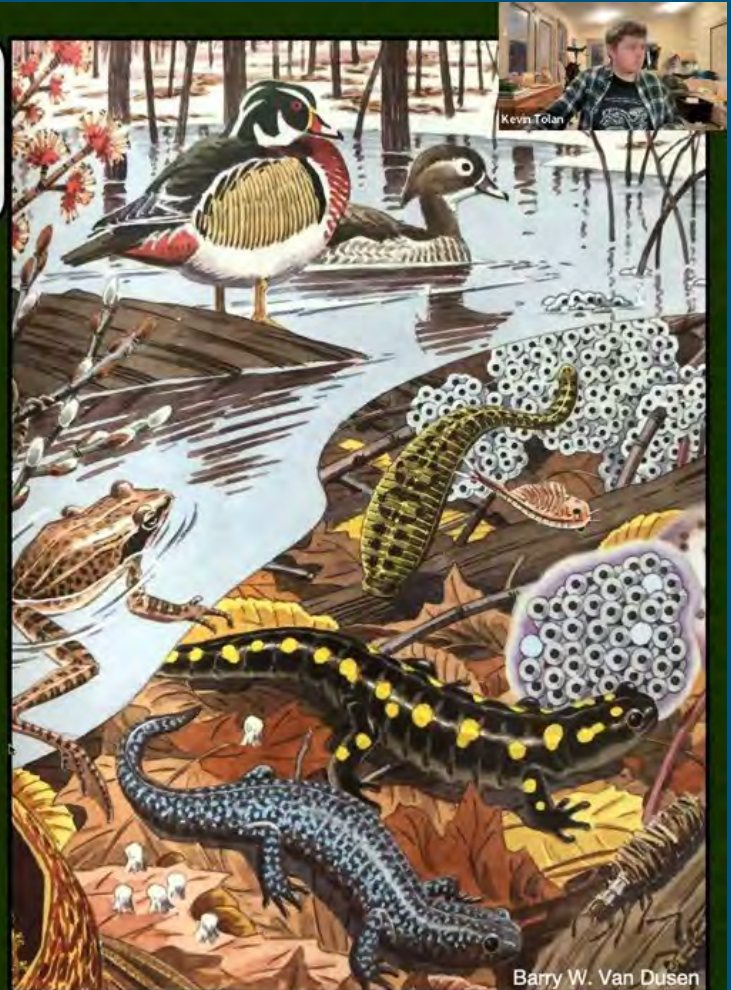

Vernal Pool FUN!



Frog Watch



VIRTUAL FROGWATCH



USA TRAINING



March 16th 6:30-8:30PM

FrogWatch USA is a citizen science program of the Association of Zoos and Aquariums (AZA). During the training you'll learn about wetlands and how to report data on the calls of local frogs and toads to assist herpetologists and their research. A fun activity for adults and families! Once again, we are teaming with Up Yonda Nature Center to put on the training. *Registration is required via website at wiltonpreserve.org or calling the office at 518-450-0321.*



Frog Watch FUN!

Frogs & Toads in Michigan

Animal Spot

Tree Frogs and Their Allies



Blanchard's
Cricket Frog



Boreal
Chorus Frog



Cope's Gray
Treefrog



Eastern
Gray Treefrog



Midland
Chorus Frog



Spring
Peeper



Northern
Cricket Frog



Northern
Spring Peeper



Gray Treefrog



Western
Chorus Frog

True Frogs



Green Frog



Mink Frog



Pickerel Frog



Northern
Leopard Frog



Wood Frog



American
Bullfrog

True Toads



American
Toad



Eastern
American Toad



Fowler's Toad

Toad



Butterfly Monitoring

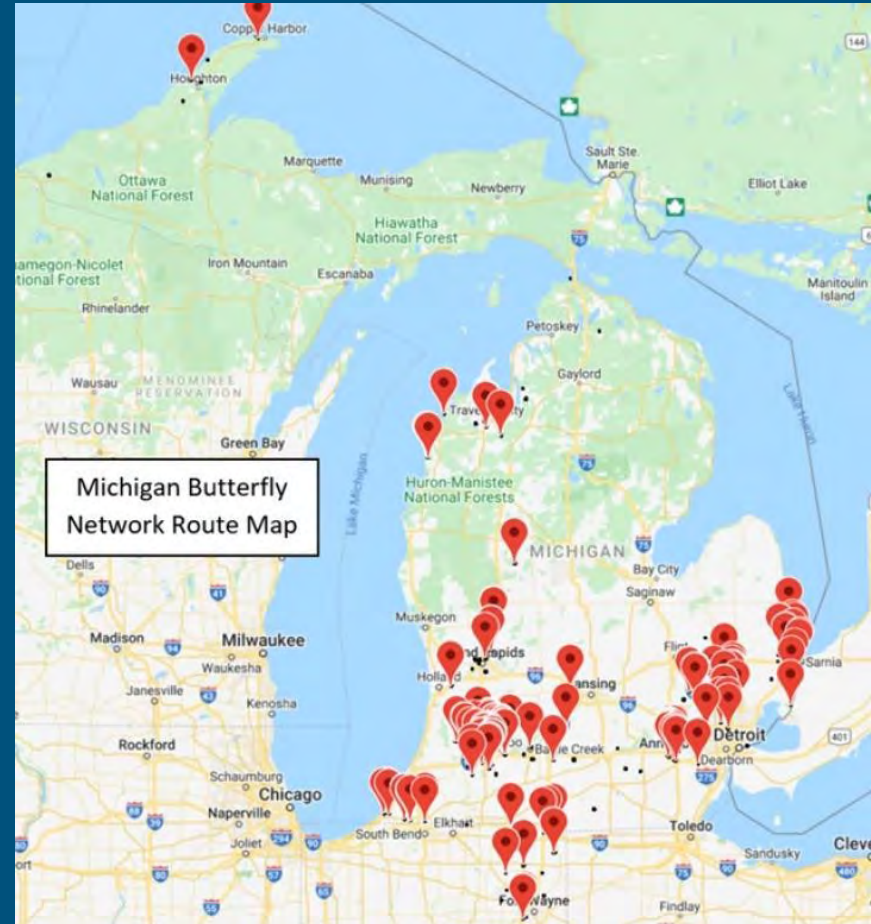

Butterfly Monitoring FUN!



Other Partner Examples:

- Christmas Bird Count
- Litter journal Kayak Program
- BIOBlitz
- INaturalist
- Aquatic Invasive SPecies