

BAD AXE, ENGLER FIELD (E53)

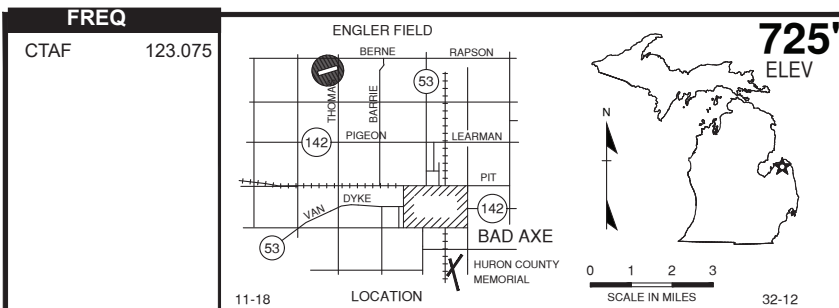

B

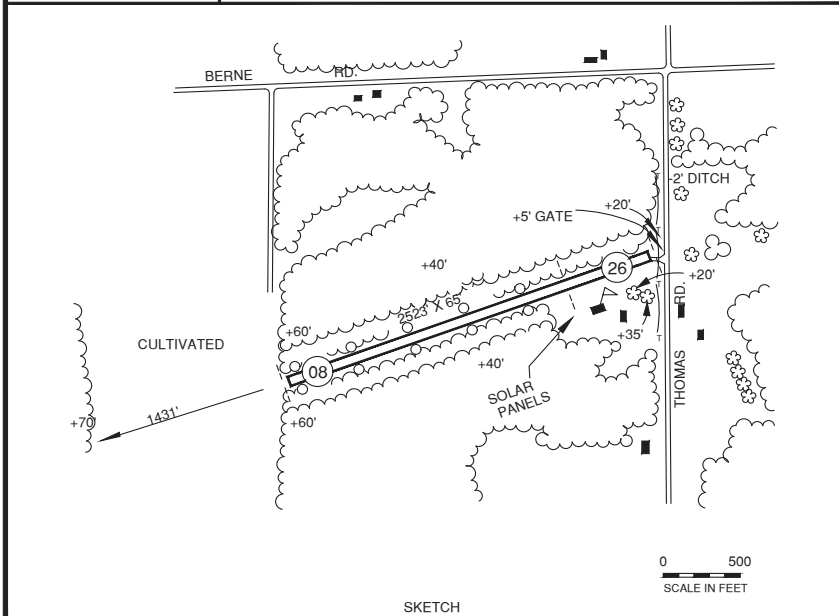

RWY LENGTH BEYOND DISPLACED THR
 07/ —
 25/ 1948

COORDINATES
 43° 50.77' N
 083° 02.81' W

License
 Basic Utility

FM CITY: 4.0 mi NW
LGT: LIRL (NSTD*) not for public use
MGR: Alan Engler
PH: 989-269-8815
FBO: None
ATND: Intmt, owner resides at arpt

NAV AIDS: 112.9 (MBS) 075° 070° 48 NM to fld.
FUEL: None
RPR: None
WX: None
SNW RMVL: lreg-vfy
TRNSP: None
MEALS: In town, 4.0 mi
RON: In town, 4.0 mi

- Caution, 20' P-Lines in NE 25 apch.
- Crops W of rwy 07/25 can grow to 7 ft during growing season.
- *NSTD LIRL. first 575' rwy 25 not lighted.
- +5' gate 40 ft east of rwy.
- Wind turbine farm west of airport.