

BROWN CITY, BURGESS FIELD

B

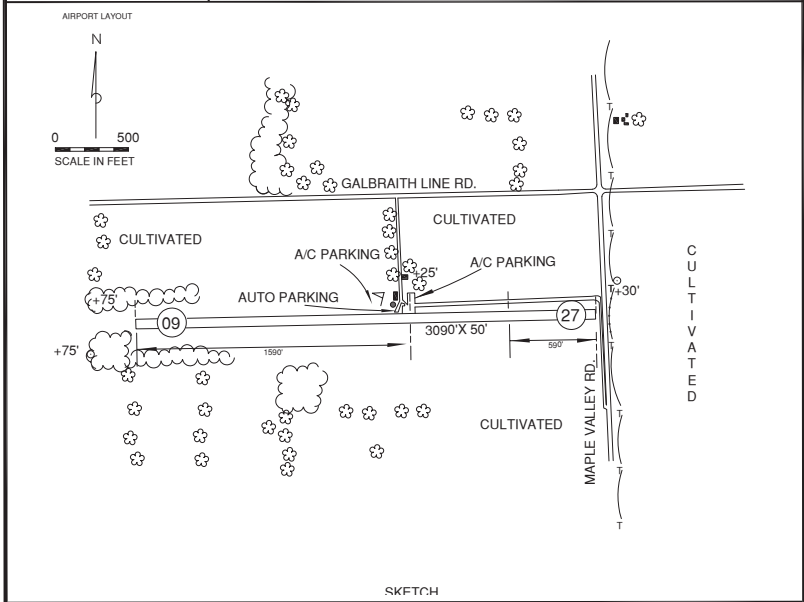
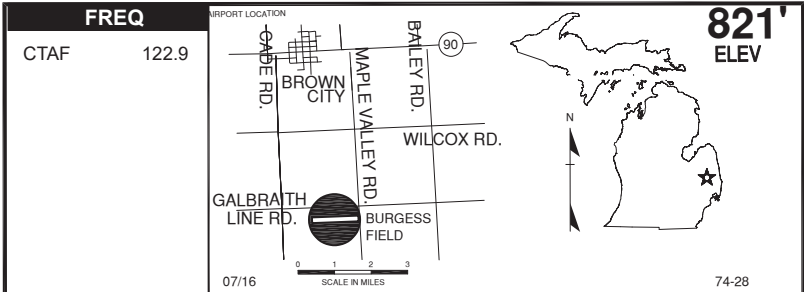

RWY LENGTH BEYOND DISPLACED THR
 09/ 1500'
 27/ 2500'

COORDINATES
 43° 10.83'N
 082° 59.017'W

License
 Basic Utility

FM CITY: 2 mi S
LG T: None
MGR: Wayne Burgess
PH: 810-346-3577
 810-614-8835 (Mgr cell)
FBO: None
ATND: Ireg - Mgr resides at arpt

NAV AIDS: 116 (FNT) 074° 36.0 NM to fld.
FUEL: None - emg only
RPR: Minor
WX: None
SNW RMVL: None - on request
TRNSP: By prior arrangement
MEALS: In town, 2 mi
RON: In town, 2 mi

- Seasonal Crop Dusting Operations.
- Opposite rwy end not visible from thr.
- Deer on & invof arpt.
- Friendly dog may run toward propeller.