

CHARLOTTE, FITCH H. BEACH MUNI (FPK)

C

FREQ	
AWOS	118.075
CTAF/U	123.0
GREAT LAKES APP/DEP (R) 118.65	

CHARLOTTE

LOCATION

891 ELEV

0 1 2 SCALE IN MILES

09657.A
23-02

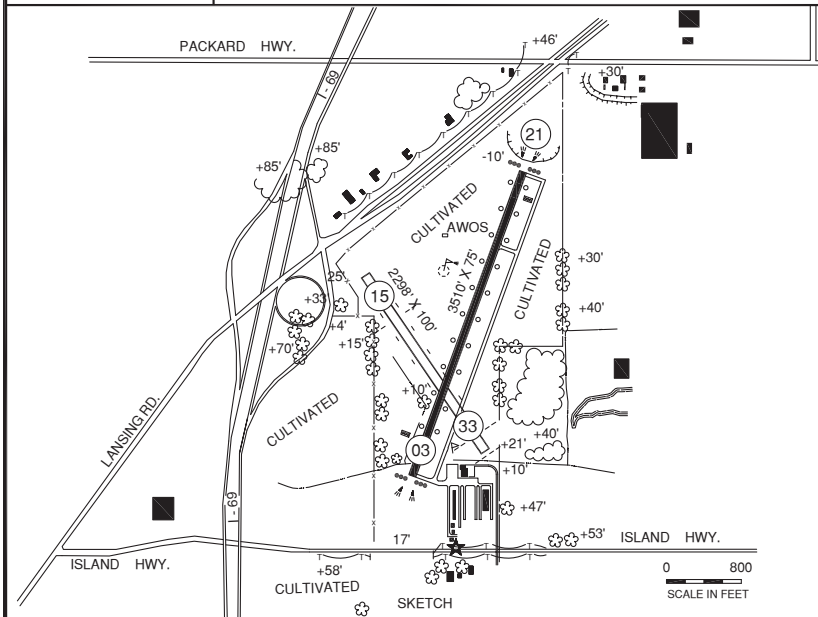

RWY LENGTH BEYOND DISPLACED THR

03/ — * 15/ 1730'
21/ — * 33/ 2109'

COORDINATES

42° 34.45'N
084° 48.73'W

License
General Utility

FM CITY: 2.0 mi NE

LG: ROTG BCN, MIRL, PAPI, REIL—STD
PCL CTAF.

MGR: Todd Cotter

PH: 517-712-8177 (Mgr cell)
517-543-0241 (Fire Dep)

FBO: Charlotte Air Svc
517-712-8177
517-543-2299 (lobby)

ATND: 0800-1700 Mon-Fri (Aft hrs on req)
unatnd major holidays

NAV AIDS: IAP, 109.6 (JXN) 326° 24.3 NM
to fld.

FUEL: 100LL 24 hr self svc.

RPR: Major A&P

WX: AWOS 517-543-2288, WSI

SNW RMVL: Yes, 03/21 only*

TRNSP: CC, by arngmt w/mgr, Rntl car in
town.

MEALS: In town, 0.3 mi, cc

RON: In town, 0.3 mi

- Non-rdo acft invof arpt.
- Birds & deer on & invof rwy.
- Military heli opn(s) on & invof arpt, esp ngjt.
- **Helicopter ops avoid the flow of fixed wing acft (FAR 91.126)**
- *Rwy 15/33 clsd Dec-Mar & when snw covered.
- Admin bldg access 5,3,2,1.