

DETROIT, WILLOW RUN (YIP)

D

FREQ	
ASOS	132.35
ATIS*	127.425
DETROIT APP/DEP	118.95
TWR	125.275
GND	119.975
UNICOM	122.95

YPSILANTI

WILLOW RUN AIRPORT

716'
ELEV

11-17

LOCATION

SCALE IN MILES

09750.A
82-18

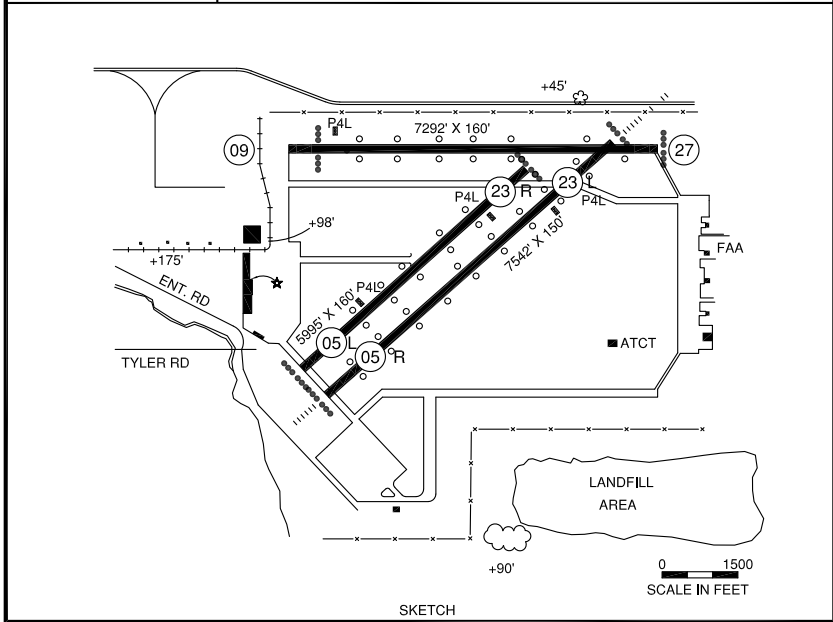

RWY LENGTH BEYOND DISPLACED THR
 05L/ — * 05R/ — * 09/ 6718'
 23R/ — * 23L/ — * 27/ —

COORDINATES
 42° 14.40'N
 083° 31.85'W

License
 Air Carrier

FM CITY: 3 mi E. of Ypsilanti
LGT: ROTG BCN, HIRL, MIRL, MALSR, PAPI.
MGR: Rick Taig, Director
PH: 734-485-6669 (Arprt)
FBO: Odyssey 734-547-7359
 Avflight West 734-483-3531
 Avflight East 734-482-2621
ATND: 24 Hrs

NAV AIDS: IAP, 113.4 (DXO) 288° 7.5 NM to fld, ILS.
FUEL: 100LL, JET A
RPR: Major A&P
WX: LAWRS, ASOS 734-485-9056
SNW RMVL: Yes
TRNSP: Taxi, Rntl car (on call)
MEALS: In town, 2-3.0 mi
RON: In town, 2-3.0 mi

- FAA Class "D" Airspace.
- *ATIS 734-482-6590.
- Lndg fee for coml opns based on gross weight.
- Deer & birds invof arprt.
- LRA, 1 hr adv notice req 734-942-9000. Pilots ctc customs 313-226-3140. Customs Req by FAA flight plan is not accepted.

DETROIT, WILLOW RUN TAXIWAY

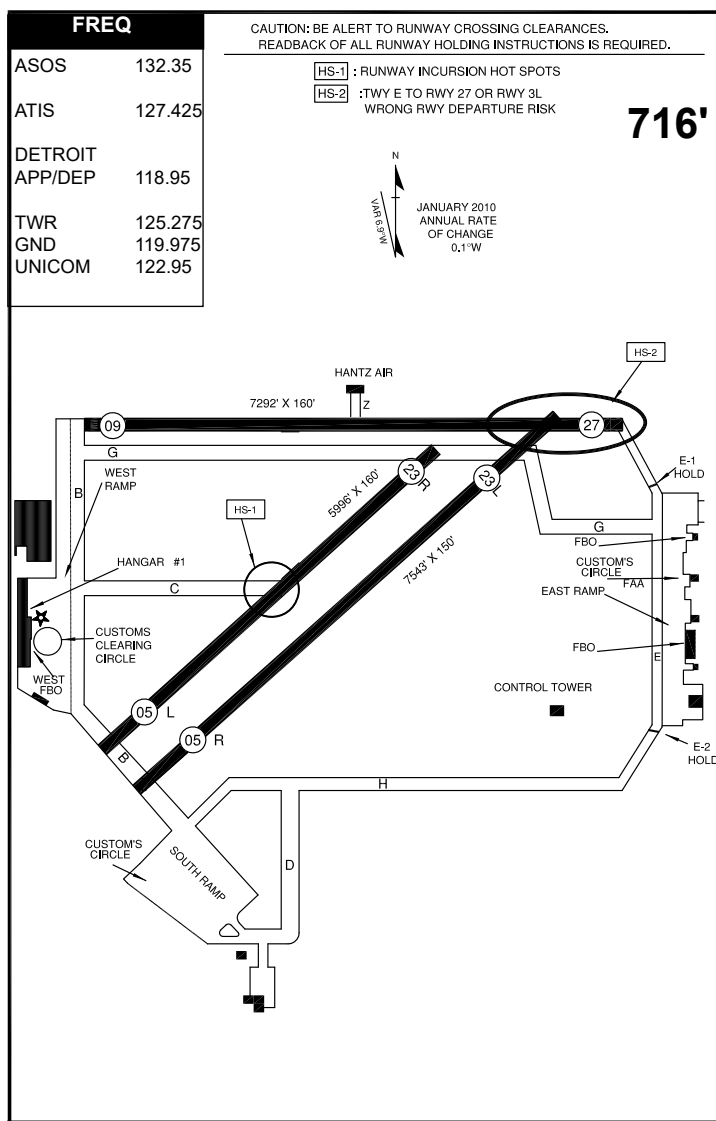

D

Runway Incursion Hot Spots

For information only, not to be construed as ATC instructions.

HS Pilots instructed to taxi on TWY E1, connecting to RWY 27-9, connecting to RWY 23L-5R, should be careful. Pilots often mistake runway markings beginning with the same number. This applies to taxi and airborne phases of flight. Wrong rwy departure risk.

HS 1 Complex rwys/twy int.

HS 2 Twy E1 to rwy 27 or 23L wrong rwy departure risk.