

# EATON RAPIDS, SKYWAY ESTATES (60G)

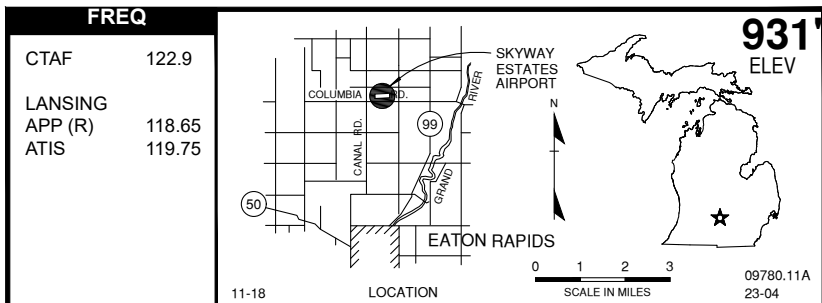

E

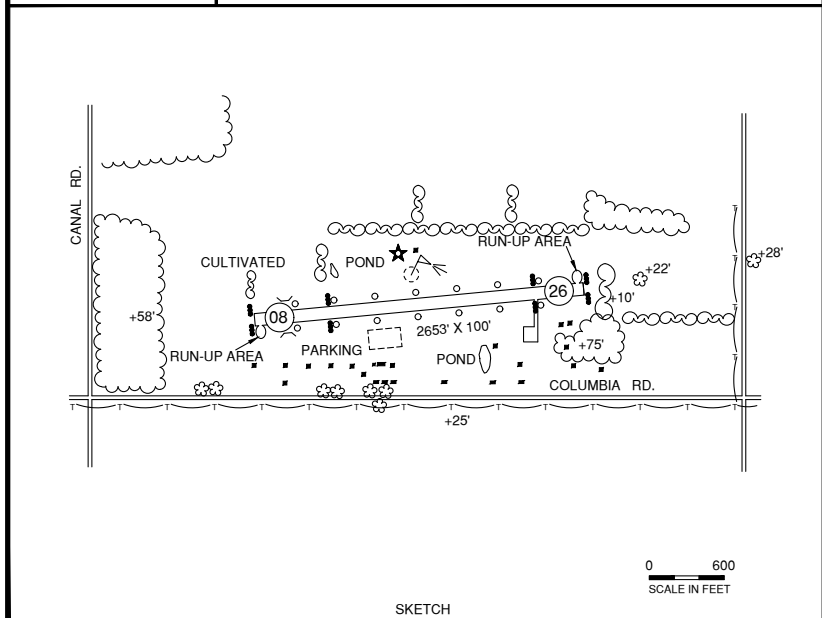

**RWY LENGTH BEYOND DISPLACED THR**  
08/ 1968'  
26/ 2253'

**COORDINATES**  
42° 35.03'N  
084° 39.09'W

**License**  
Basic Utility

**FM CITY:** 4.0 mi N  
**LGT:** ROTG BCN, MIRL-122.9 5X on.  
**MGR:** Keith Gibbs  
Kenneth Drewyor  
**PH:** 517-667-0182 (Mgr cell, txt)  
517-712-7356 (Asst Res)  
**FBO:** None  
**ATND:** Days, intmt

**NAV AIDS:** 109.6 (JXN) 344° 21 NM to fld.  
**FUEL:** None  
**RPR:** None  
**WX:** None  
**SNW RMVL:** Yes  
**TRNSP:** Taxi  
**MEALS:** In town  
**RON:** In town

- Red circles mark the runup areas.
- Vfy arpt cond fall, winter & spring.
- Ultralight activity.
- RC Model airplanes invof arpt.