

# FRUITPORT, FLYING-A-RANCH (39Z)

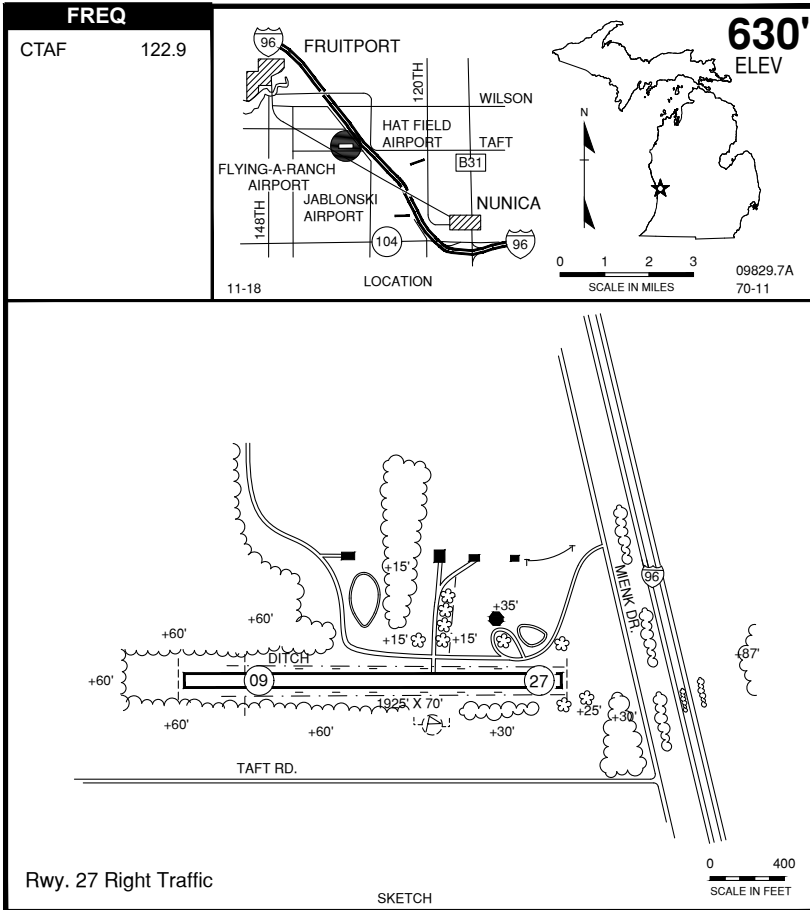

F

**RWY LENGTH BEYOND DISPLACED THR**  
09/ 1598'  
27/ —

**COORDINATES**  
43° 06.30N  
86° 07.42' W

**License**  
General Utility

**FM CITY:** 02 mi SE  
**LGT:** LIRL - not for pub use  
**MGR:** Michael C. Alman  
**PH:** 616-846-3977  
**FBO:** Aero Marine Svcs 616-846-3977  
**ATND:** Dawn-Dusk; clsd Nov-Mar

**NAV AIDS:** 115.2 (MKG) 232° 5.1 NM to fld  
**FUEL:** None - emg only  
**RPR:** Major A&P  
**WX:** None  
**SNW RMVL:** No  
**TRNSP:** CC  
**MEALS:** In town, 1.5 mi  
**RON:** 7.0 mi

- Rwy 27 right traffic.
- TPA 1430' MSL (800').
- LIRL not for pub use.