

LAMBERTVILLE, TOLEDO SUBURBAN (DUH)

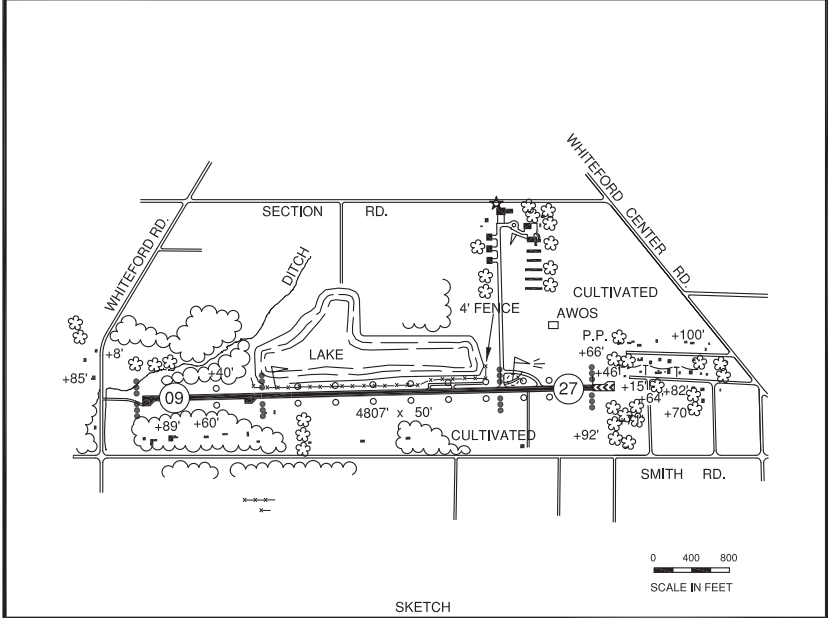
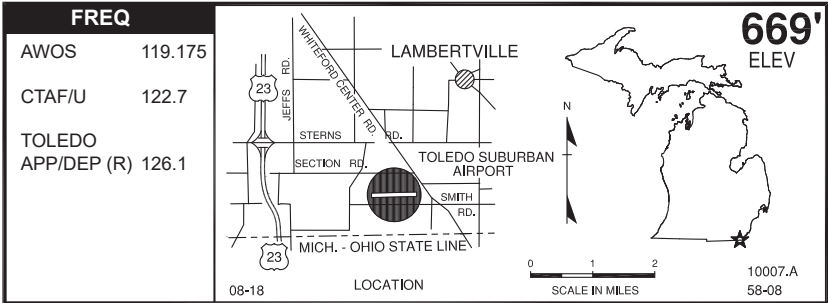

RWY LENGTH BEYOND DISPLACED THR

09/ 3533'
27*/ 3815'

COORDINATES

41° 44.15N
083° 39.35W

License
Basic Utility

FM CITY: 2.0 mi SW
LG: ROTG BCN, NSTD MIRL PCL 7X
MGR: Thomas Trumbull
PH: 734-856-6103
FBO: Suburban Avn 734-856-6103
ATND: 0800 - 1700

NAV AIDS: IAP, 113.1 (VWV) 359° 17.1 NM to fld.
FUEL: 100LL
RPR: Major A&P
WX: AWOS 734-856-1563, Wx briefing system
SNW RMVL: Yes
TRNSP: Taxi
MEALS: In town, 1.0 mi
RON: In town, 2.0 mi

- Aft hr restroom by fuel pumps *1227
- Noise sensitive area nearby, climb to 1200' MSL prior to turn out.
- Deer on & invof arpt.