

LINDEN, PRICE'S (9G2)

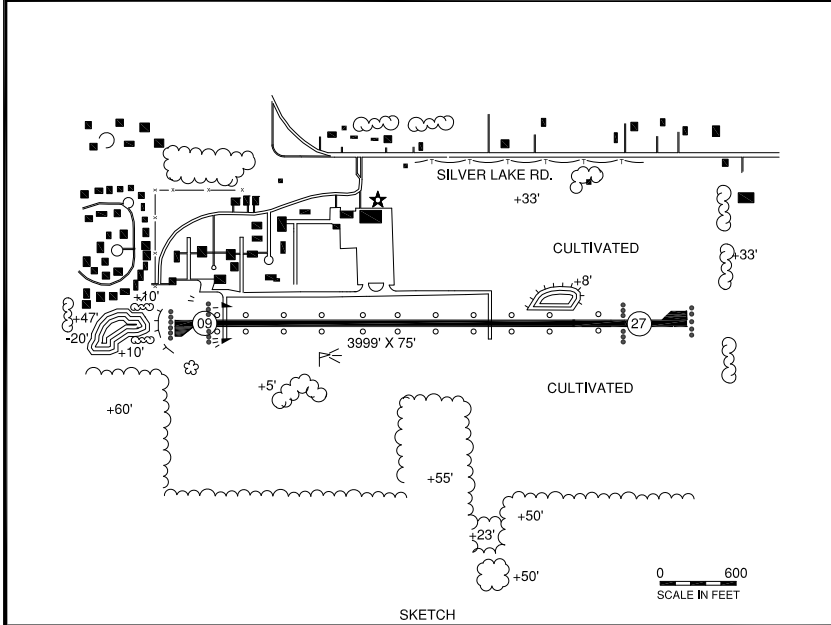
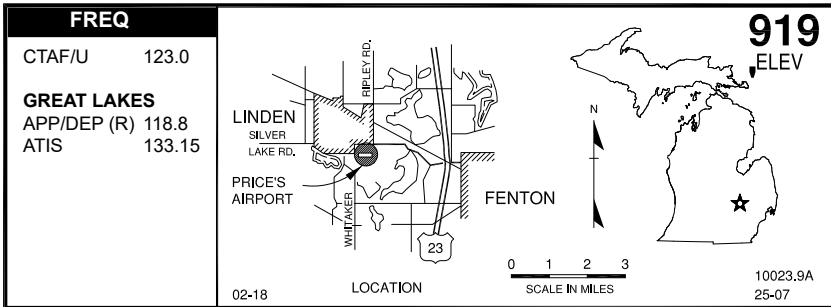

RWY LENGTH BEYOND DISPLACED THR
 09/ 3732'
 27/ 3199'

COORDINATES
 42° 48.46'N
 083° 46.14'W

License
 General Utility

FM CITY: 1.0 mi S
LGT: MIRL rwy 09/27, REIL rwy 09 - std pcl CTAF.

MGR: Cody Welch
 Nick Nicolay, Asst.
 Mike Bezzeg, Asst.
 Geoffrey Geisz, Asst.

PH: 586-946-5381 (Ofc/ Mgr cell)
 248-459-4656 (Asst mgr)

FBO: Linden Airport Leasing 586-946-5381

ATND: Ireg

NAV AIDS: IAP, 116.9 (FNT) 192° 9.6 NM to fld
FUEL: 100LL*
RPR: Minor A&P by prior arngmt
WX: None
SNW RMVL: Yes
TRNSP: Taxi 810-629-7080
MEALS: In town, .5 mi
RON: In town, 3.0 mi

- Admin bldg access-depress 5-2-3-1.
- Trees apch end rwy 9 & 27.
- Rwy 09/27 designation changing to 10-28 summer 2018.
- *Fuel 24 hr self serve.
- Deer & birds on invof arpt.
- Residential airpark.