

# LOWELL CITY (24C)

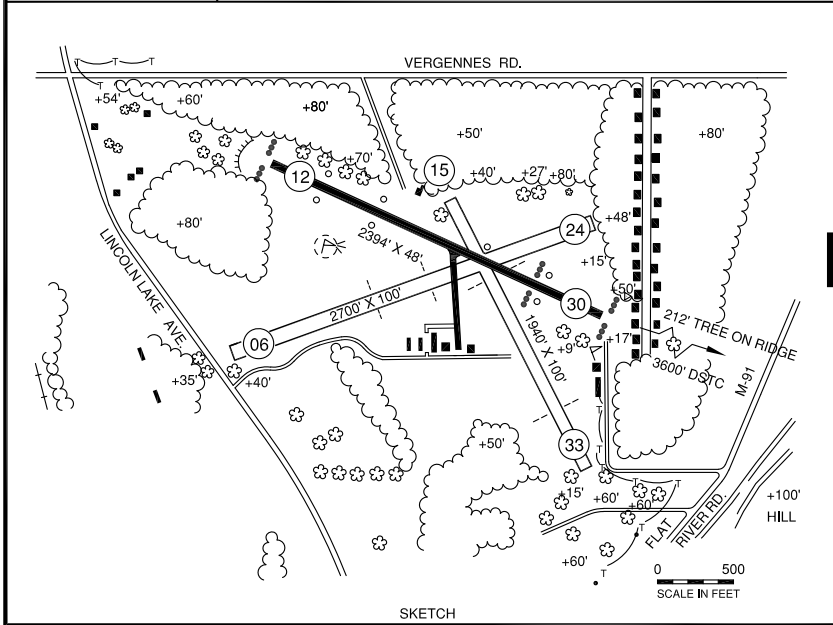
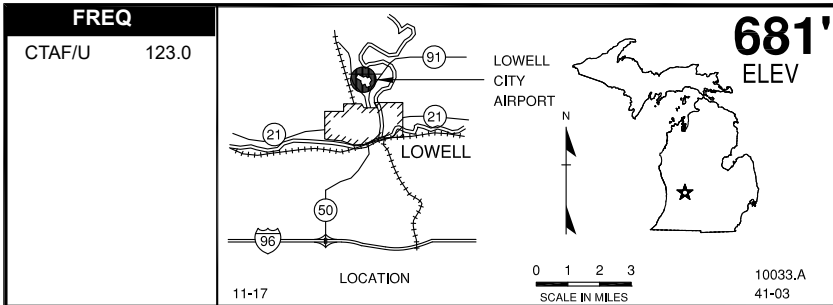

**RWY LENGTH BEYOND DISPLACED THR**  
 06/ 1600 \* 12/ ---- \* 15/ 1358'  
 24/ 1500 \* 30/ 1794' \* 33/ 1552'

**COORDINATES**  
 42° 57.24'N  
 085° 20.63'W

**License**  
 Basic Utility

**FM CITY:** 1.0 mi N  
**LGT:** LIRL - CTAF  
**MGR:** Casey K. Brown  
**PH:** 616-987-0821  
**FBO:** None\*\*  
**ATND:** M-S 0900-1700  
 Unatnd Sun & maj hol

**NAV AIDS:** 115.95 (GRR) 035° 12.3 NM to fld.  
**FUEL:** 100LL\*  
**RPR:** Avbl on call\*\*  
**WX:** None  
**SNW RMVL:** Rwy 12/30 only  
**TRNSP:** None  
**MEALS:** In town, 1.0 mi  
**RON:** In town 1.0 mi

- Admin bldg access depress 5-3-2-1
- \*Fuel 24 hr self serve.
- \*\*Call arpt mgr for service 616-987-0821.
- powered para glider activity in the area.