

MANISTIQUE, SCHOOLCRAFT CO (ISQ)

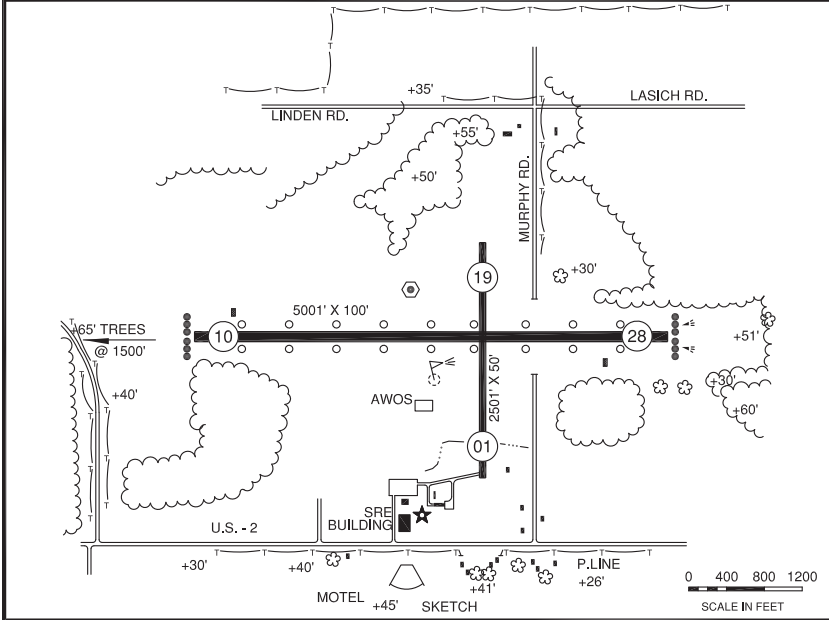
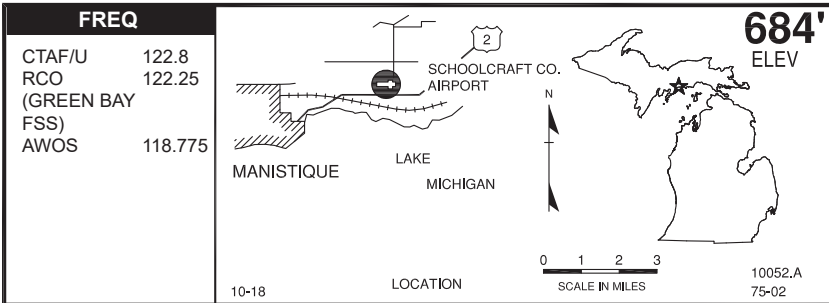

RWY LENGTH BEYOND DISPLACED THR

10/ — * 01/ —
28/ — * 19/ —

COORDINATES

45° 58.48'N
086° 10.31'W

License
General Utility

FM CITY: 3.0 mi NE

LGT: ROTG BCN. MIRL 10/28, PAPI,
rwy 28 REIL'S-STD PCL CTAF

MGR: Steve Videtich

PH: 906-341-5522 (Arpt)
906-341-3662 (Mgr)

FBO: County operated

ATND: Jun-Oct Mon-Fri 0900-1700
Sat-Sun Unatnd
Nov-May Mon-Fri 0900-1500
Sat-Sun Unatnd

RDO NAV AIDS: IAP, 110.4 (ISQ) at fld

FUEL: 100LL, JET A

RPR: None

WX: AWOS 906-341-8585,
WX briefing system

SNW RMVL: Yes-vfy cond

TRNSP: Public Transit 906-341-2111

MEALS: 0.5 mi

RON: Adj

- Birds & deer invof arpt.
- Admin bldg access-depress V, then simultaneous III II, then I.
- Camping permitted.
- Wi-Fi.
- Fuel self serv.
- Unmarked P-line 1 mi N of rwy 19 end.