

MARINE CITY (76G)

FREQ		613' ELEV	
CTAF/U	123.0		
SELFREDGE			
APP/DEP	119.6		
05-17		LOCATION	
			10058.A 77-06

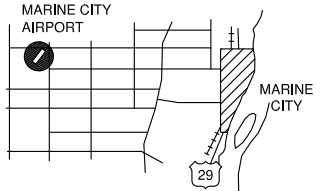
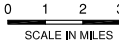
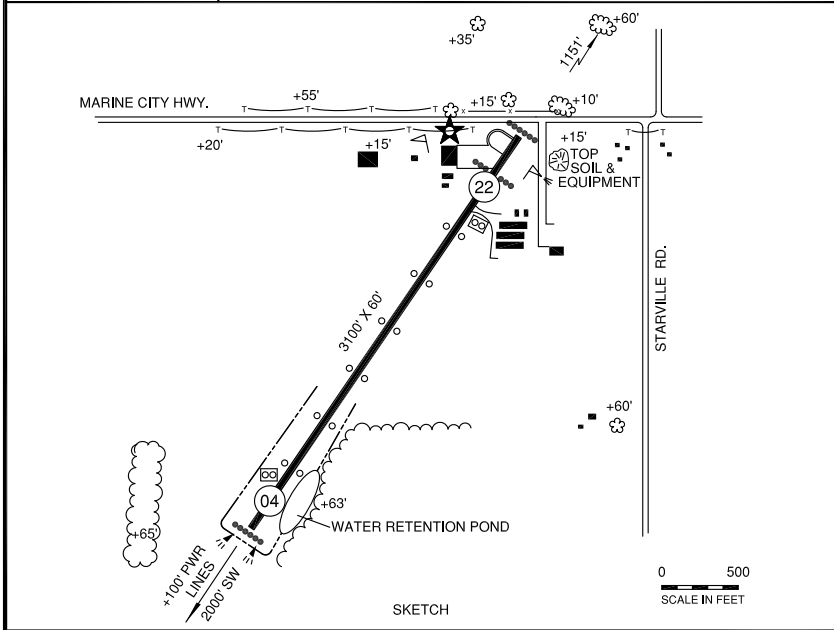

M

RWY LENGTH BEYOND DISPLACED THR
 04/ —
 22/ 2805'

COORDINATES
 42° 43.28'N
 082° 35.78'W

License
 General Utility

FM CITY: 4.0 mi W
LGT: ROTG BCN, MIRL (NSTD)* SS-SR.
 PAPI's 4/22, REILS 4, PCL
MGR: Nancy Manter
PH: 810-765-8289
FBO: Marine City Avn 810-765-8289
ATND: Unatnd*

RDO NAV AIDS: 116.9 (FNT) 295° 61 NM
 to fld.
FUEL: 100LL
RPR: Major A&P
WX: DTN terminal.
SNW RMVL: Yes
TRNSP: Taxi in town, CC
MEALS: In town, 5.0 mi
RON: In town, 5.0 mi

- *For airport services call 810-650-7519.
- Rwy 04/22 *MIRL lctd nstd 23' fm rwy edge.
- Rwy 04 apch +100' pwr line, 2000' SW.
- TPA 1613 (1000 AGL)
- For IFR clearance ctc CLE CTR 126.52 or 440-774-0386