

NEWBERRY, LUCE COUNTY (ERY)

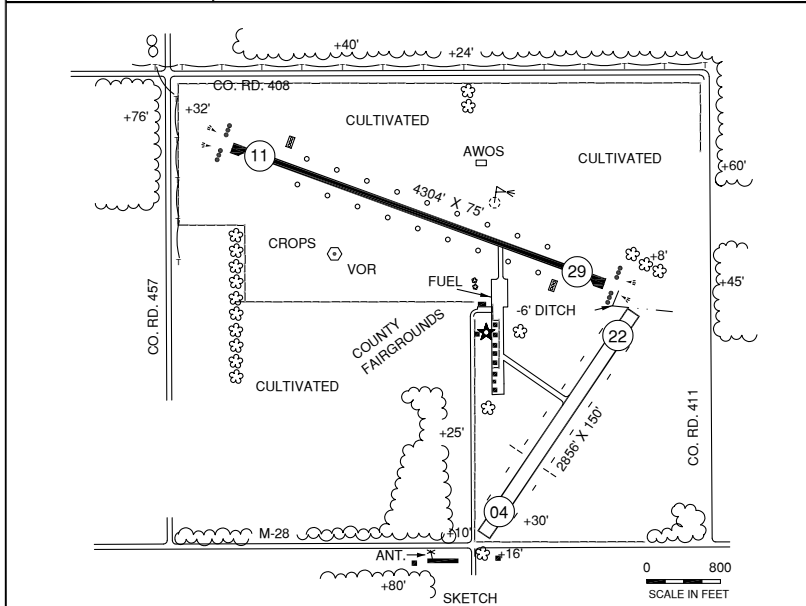
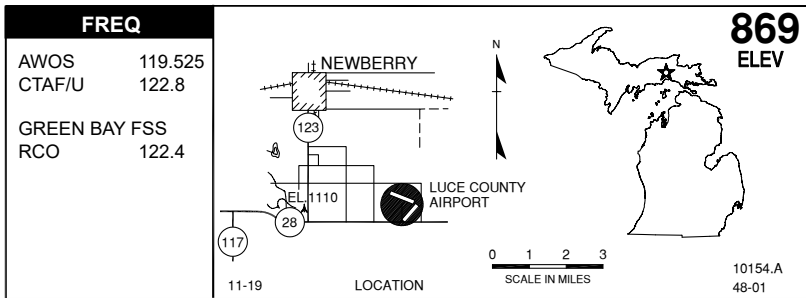

RWY LENGTH BEYOND DISPLACED THR

11/ — * 04/ 1920'
29/ — * 22/ —

COORDINATES

46° 18.66'N
085° 27.43'W

License

General Utility

FM CITY: 3.0 mi SE

LGT: ROTG BCN SS-SR. MIRL, PAPI rwy 11/29, REIL rwy 11/29, wind cone & apron lgt—key mike 5X CTAF; 7X REILS.

MGR: Jay Hollnagel
Kenneth G. Gill, Asst

PH: 906-293-2926
906-291-0570 (Mgr cell)

FBO: None

ATND: Mon-Fri 0800-1600, Sat, Sun on req

NAV AIDS: IAP, 112.2 (SSM) 267° 48 NM to fld

FUEL: 100LL* 24 hr Self Serve, Jet A

RPR: None

WX: AWOS 906-293-2979,

WX Briefing system

SNW RMVL: Rwy 11/29, vfy cond

TRNSP: Rntl car (in town) on req

MEALS: 0.4 mi , in town 4.5 mi

RON: In town, 1.0 mi

- Admin bldg access—5,3,2,1.
- Rwy 4/22 clsd Nov-Mar & when snw covered, except for ski equipped acft.
- Transient hgr avbl.