

# OWOSSO COMMUNITY (RNP)

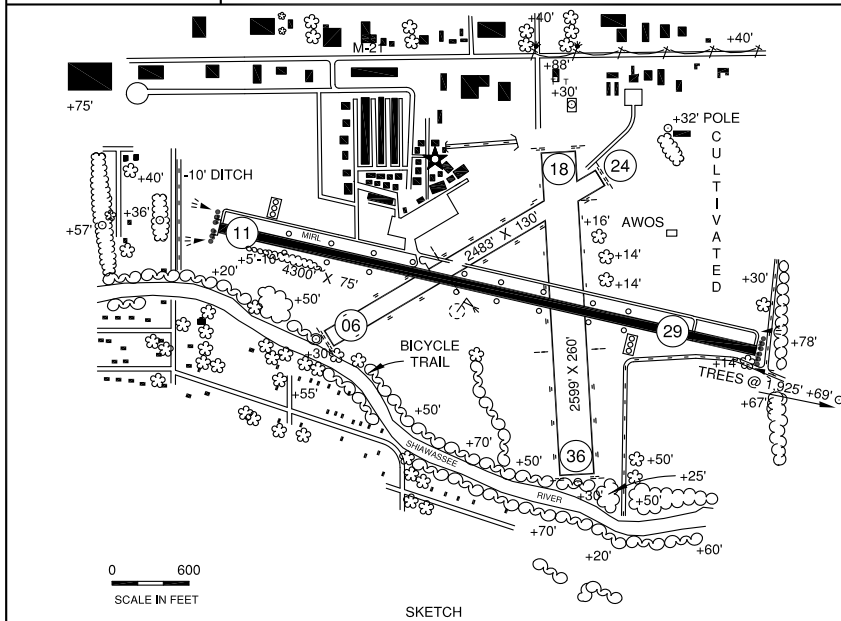
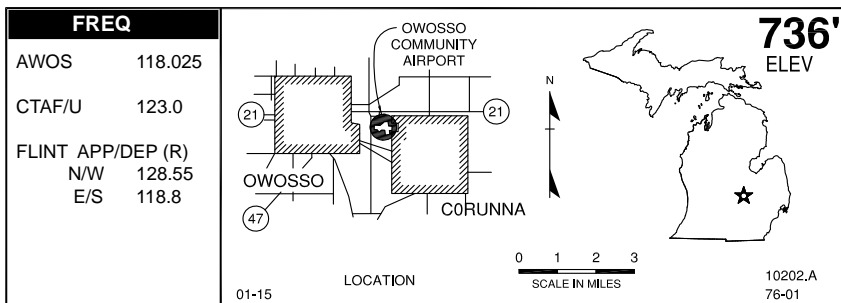

### RWY LENGTH BEYOND DISPLACED THR

06/ 1426' \* 11/ — \* 18/ 2203'  
24/ — \* 29/ — \* 36/ 1609'

### COORDINATES

42° 59.58'N  
084° 08.32'W

**License**  
General Utility

**FM CITY:** 1.7 mi E

**LGT:** ROTG BCN. MIRL, REIL, PAPI—STD PCL  
CTAF.

**MGR:** Tim Harwood  
Garry Csapos, Asst

**PH:** 989-725-1969  
810-9649827 (Emerg mgr cell)

**FBO:** Mid-Michigan Avn 989-494-2077  
RNP Avn 810-444-3458  
Skydive Owosso 989-272-3235

**ATND:** Mon-Fri 0900-1700

**NAV AIDS:** IAP, 116.9 (FNT) 281° 17.3 NM  
to fld.

**FUEL:** 100LL\*

**RPR:** Major A&P

**WX:** WSI, AWOS 989-729-2967,  
Wx briefing system

**SNW RMVL:** Rwy 11/29

**TRNSP:** Dial-a-Ride 989-729-2687, Taxi, bus

**MEALS:** Adj

**RON:** Adj (w/ taxiway & acft pkg)

- Admin bldg access—depress V, then III-II simultaneous, then I.
- Rwy 6/24 & 18/36 CLSD Dec - Mar & when snow covered.
- \*Fuel 24 hr self serve, major credit cards & Smart Card accepted.
- Skydiving & glider actvt at arpt.
- Deer & birds on & invof arpt.
- Bike trail S side of arpt follows river.