

SAINT JOHNS, GLOWACKI (97G)

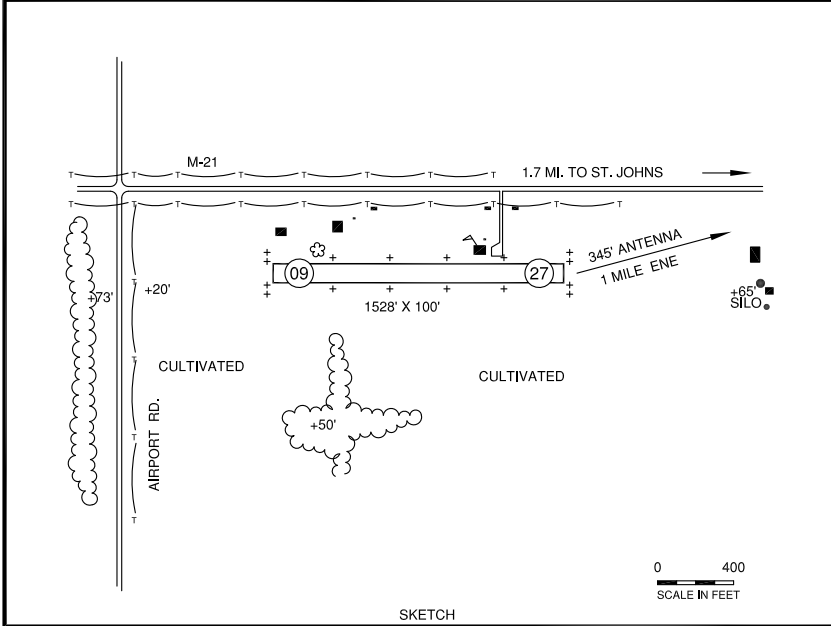
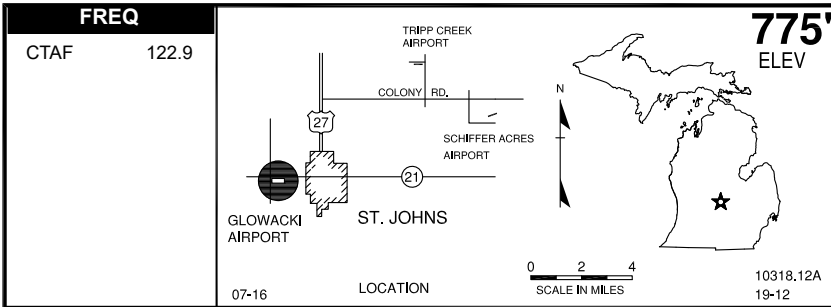

RWY LENGTH BEYOND DISPLACED THR

09/ —
27/ —

COORDINATES

43° 00.00'N
084° 35.75'W

License

Basic Utility

FM CITY: 2.0 mi W

LGT: None

MGR: Greg Glowacki

PH: 989-224-2759

FBO: None

ATND: Intmt, Owner resides at arpt

NAV AIDS: 116.9 (FNT) 279° 37 NM to fld

FUEL: None

RPR: None

WX: None

SNW RMVL: No-vfy cond

TRNSP: None

MEALS: In town

RON: In town

- Terrain slopes downward E to W, rwy soft in spring.
- + 345' ant AGL 1.0 mi ENE.
- RC & ultralight acft opns on arpt.
- 120' antenna 1/2 mile from 27 end.
- +20' P-Lines W of RWY 09.