

STURGIS, KIRSCH MUNICIPAL (IRS)

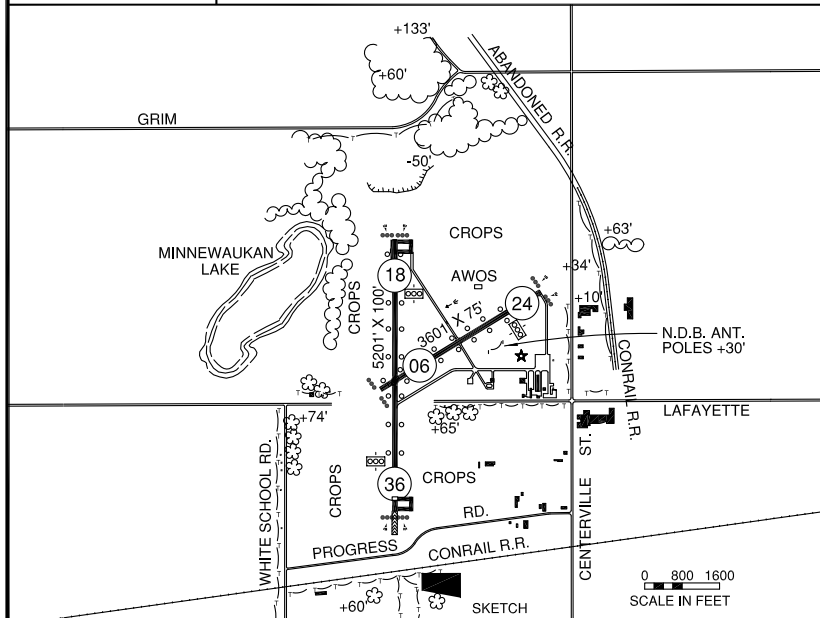
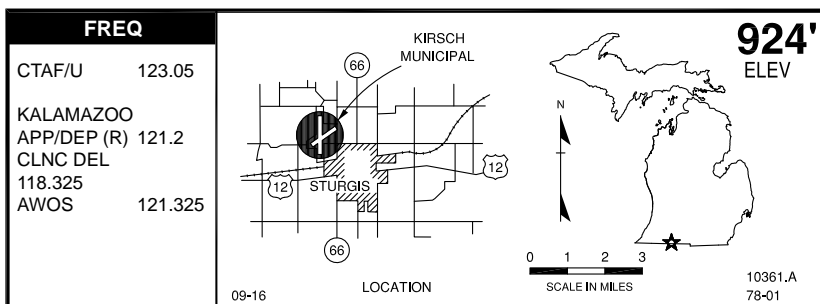

RWY LENGTH BEYOND DISPLACED THR

06/ — * 18/ —
24/ — * 36/ —

COORDINATES

41° 48.80'N
085° 26.34'W

License
General Utility

FM CITY: 2.0 mi NW

LGT: ROTG BCN. MiRL, PAPI rwys 18/36 & 24; REIL'S 18/ 36 & 24 —STD PCL CTAF.

MGR: Michael Hughes, City Mgr
Brian Riley, Asst

PH: 269-651-2821 (Arprt)
269-651-2321 (City/Arprt Mgr)

FBO: Bartelt Avn 269-651-5431
RAI Jets 269-651-2821, 800-247-2834
Sturgis Aviation 269-659-3773

ATND: Mon-Fri 0800-1700

NAV AIDS: IAP, 109.0 (AZO) 170° 25.9 NM to fld, NDB (IRS) 382 KHz at fld.

FUEL: 100LL, JET A*

RPR: Major A&P

WX: AWOS 269-659-8715,
WX briefing system

SNW RMVL: Yes

TRNSP: cc by prior agmt

MEALS: In town

RON: In town, 1.0 mi

- GPU (RAI Jets).
- For aft hrs attendant call 269-651-2821. Call in fee.
- Admin bldg access—5-3-2-1.