



**Michigan Department of Environment, Great Lakes, and Energy
Materials Management Division**

SOLID WASTE DISPOSAL AREA CONSTRUCTION PERMIT

Effective April 22, 2019, the Michigan Department of Environmental Quality, by Executive Order Number 2019-06, became the Michigan Department of Environment, Great Lakes, and Energy (EGLE). Effective April 22, 2019, the Waste Management and Radiological Protection Division became the Materials Management Division (MMD).

This construction permit is issued under the provisions of Part 115, Solid Waste Management, of the Natural Resources and Environmental Protection Act, 1994 PA 451, as amended, (Act 451), MCL 324.11501 et seq., to permit the construction of a solid waste disposal area (Facility) in the state of Michigan. This permit does not obviate the necessity of obtaining other authorization as may be required by state law.

FACILITY NAME: Woodland Meadows RDF- Van Buren

PERMITTEE/FACILITY OWNER: Waste Management of Michigan, Inc.

PROPERTY OWNER: Waste Management of Michigan, Inc.

TYPE OF FACILITY: Municipal Solid Waste Landfill

FACILITY ID: 412717

COUNTY: Wayne

PERMIT NUMBER: 4171

ISSUE DATE: March 5, 2021

EXPIRATION DATE: One year from date of issuance unless development of the Facility begins within the year.

FACILITY DESCRIPTION: The Woodland Meadows RDF-Van Buren, a municipal solid waste landfill consists of 464.9 acres located in Section 1, T3S, R8E, Van Buren Township, Wayne County, Michigan. The Facility is identified in Attachment A and is fully described in this permit.

RESPONSIBLE PARTY: Mr. James Hamann
Waste Management of Michigan, Inc.
5900 Hannan Road
Wayne, Michigan 48184
(330) 316-0707

This permit is subject to revocation by the Director of the Michigan Department of Environment, Great Lakes, and Energy (Director) if the Director finds that the disposal area is not being constructed or operated in accordance with the approved plans, the conditions of a permit or license, Part 115, or the rules promulgated under Part 115. This permit shall be available through the applicant during its term and remains the property of the Director. Failure to comply with the terms and provisions of this permit may result in legal action leading to civil and/or criminal penalties as stipulated in Part 115.

THIS PERMIT IS NOT TRANSFERABLE UNLESS PRIOR AUTHORIZATION HAS BEEN OBTAINED FROM THE DIRECTOR.

Elizabeth M. Browne, Director
Materials Management Division
Michigan Department of Environment, Great Lakes, and Energy

Permittee/Facility Owner: Waste Management of Michigan, Inc.
Facility Name: Woodland Meadows RDF – Van Buren
Construction Permit Number: 4171
Issue Date: March 5, 2021

The permittee shall comply with all terms of this permit and the provisions of Part 115 and its rules. This permit includes the permit application and any attachments to this permit.

1. The permittee shall construct the Facility in a manner that will not violate any state or federal law.
2. This permit authorizes the construction of the disposal area as defined in the Application for Permit to Construct a Solid Waste Disposal Area (Application) documents dated September 9, 2020, and received by the EGLE on September 10, 2020. The new disposal area authorized by this permit shall not be utilized for the disposal of solid waste until an operating license for the disposal area is issued by EGLE.
3. The attached map (Attachment A) shows the Facility, the area permitted for construction, area(s) authorized for the placement and/or acceptance of solid waste, monitoring points, leachate storage units, site roads, and related appurtenances.
4. Issuance of this permit is based on the assumption that the information submitted by the Applicant in the Application dated September 9, 2020, received by EGLE on September 10, 2020, and any subsequent amendments is accurate. Any inaccuracies or deviations found in this information may be grounds for the revocation or modification of this permit and/or other enforcement action. The permittee shall inform EGLE's MMD Warren District Supervisor, of any known inaccuracies and/or any deviation in the information of the Application that would affect the permittee's ability to comply with the applicable rules or permit conditions. This permit is issued based on EGLE review of the Application, EQP 5506. The Application includes the following documents or their approved revisions that are incorporated by reference and become enforceable portions of this permit:
 - a. Application Form EQP 5506.
 - b. Fee in the amount of \$1,750.
 - c. Documents titled Landfill Expansion Construction Permit Application, Woodland Meadows Recycling and Disposal Facility Van Buren, Volumes 1-4, dated September 2020, revised February 2, 2021, February 23, 2021, and February 26, 2021, prepared by Golder Associates Inc.
 - i. Volume 1 of 4: Section A-Introduction, Section B- Environmental Assessment prepared by ASTI Environmental.
 - ii. Volume 2 of 4: Section C- Hydrogeologic Investigation Report.
 - iii. Volume 3 of 4: Section D-Hydrogeological Monitoring Plan revised February 2, 2021.
 - iv. Volume 4 of 4: Section E-Topographic Maps Report, Section F- Engineering Design Report, Section G-Operations Plan, Section H- Construction Quality Assurance Plan.
 - d. Engineering plans titled Waste Management of Michigan Inc., Woodland Meadows Recycling and Disposal Facility Van Buren Southern Expansion, Van Buren Township, Wayne County, Michigan, Type II Landfill Expansion Construction Permit Application, dated September 9, 2020, prepared by Golder Associates Inc., and consisting of fifty-three drawings.
5. The sampling parameters and monitoring frequencies are outlined in the Hydrogeological Monitoring Plan. The sampling results shall be submitted to EGLE's MMD Warren District Office.
6. **VARIANCES:** The permittee is granted the following variance(s) from Part 115 and/or its rules: None.

Permittee/Facility Owner: Waste Management of Michigan, Inc.
Facility Name: Woodland Meadows RDF – Van Buren
Construction Permit Number: 4171
Issue Date: March 5, 2021

7. SPECIAL CONDITIONS:

- a. R 299.4416 of the administrative rules promulgated pursuant to Part 115 requires, in part, that a type II landfill unit shall not be located in wetlands unless the owner/operator has obtained a permit under Part 303, Wetlands Protection, of Act 451. This Part 115 permit has been issued, in part, on the basis that landfill development in wetlands located at the permittee's property is authorized by and subject to the provisions of Permit No. WRP022544 issued to Waste Management of Michigan, Inc., pursuant to Part 303, on October 9, 2020. A petition for a contested case challenging the Part 303 permit was filed on December 7, 2020, by a third party (Wayne County Conservation District). Resolution of the contested case did not occur prior to the Department's decision deadline on this Part 115 permit as required under Part 13, Permits, of Act 451. If the Part 303 Permit No. WRP022544 is voided because of the contested case, the permittee will no longer have authority to locate a landfill in the regulated wetland areas that were the subject of the Part 303 permit. If the Part 303 Permit No. WRP022544 is modified because of the contested case, it may impact where the landfill unit can be developed at the property. In the event of voiding or modification of the prerequisite Part 303 permit, the permittee may no longer be authorized to develop the landfill unit as designed and permitted under this Part 115 permit and a new Part 115 construction permit or permit modification may be required for landfill development in the area covered by this permit.
 - b. This construction permit authorizes an alternative final cover design which incorporates additional engineered soils in lieu of a flexible membrane liner. Waste Management will provide an extra \$15,000 per acre as a supplemental cost for calculating the required financial assurance for closure. For financial assurance calculations, this value will be entered on Line 11 of Form B (Closure Cost Estimate) and adjusted for inflation with each financial assurance update.
8. **TERM:** This construction permit shall expire one year after the date of issuance, unless development under the construction permit is initiated within that year.

END OF PERMIT

ATTACHMENT "A"

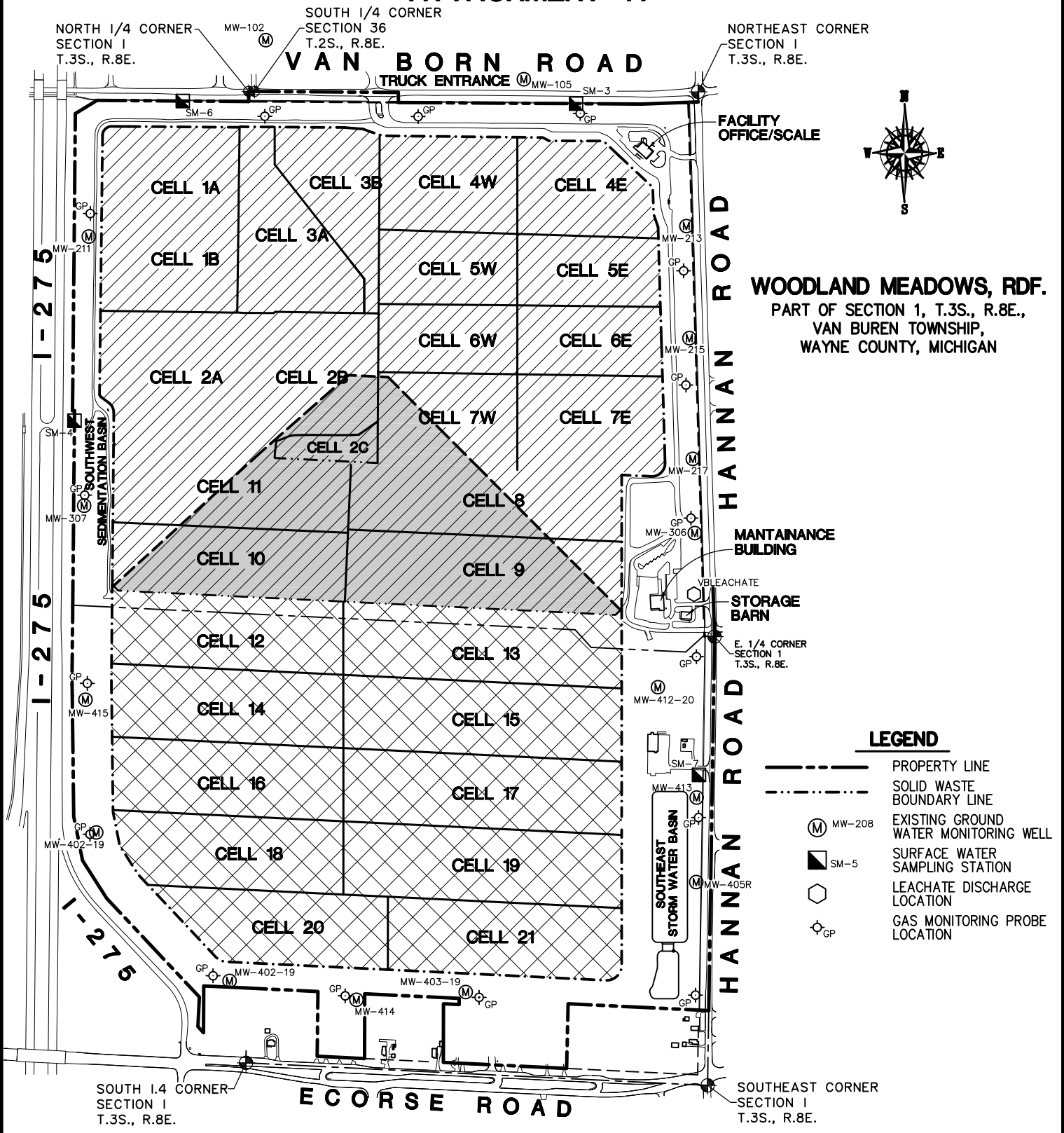

WOODLAND MEADOWS, RDF.
 PART OF SECTION 1, T.3S., R.8E.,
 VAN BUREN TOWNSHIP,
 WAYNE COUNTY, MICHIGAN

- LEGEND**
- PROPERTY LINE
 - - - SOLID WASTE BOUNDARY LINE
 - ⊙ (M) MW-208 EXISTING GROUND WATER MONITORING WELL
 - ⊙ (SM-5) SURFACE WATER SAMPLING STATION
 - ⬡ LEACHATE DISCHARGE LOCATION
 - ⊙ (GP) GAS MONITORING PROBE LOCATION

REVISED: 03/01/2021
 DATE: 08/31/2020
 JOB NO: 7750.202
 SCALE: 1"=800'
 DWG NAME: 7750.202 08-2020 Attach A.dwg

MCNEELY & LINCOLN
Associates, Inc.
 CIVIL ENGINEERING & LAND SURVEYING
 PH. (734)432-9777 FAX (734)432-9786
 37741 PEMBROKE, LIVONIA, MICHIGAN 48152

▨	ACTIVE FILL AREA	206.2 AC.
▧	LATERAL EXPANSION	+ 146.5 AC.
▩	ISOLATION AND ANCILARY AREA	+ 112.2 AC.
▭	FACILITY AREA	464.9 AC.
▬	VERTICAL EXPANSION	50.9 AC.