

Michigan Department of Environmental Quality  
Oil, Gas and Minerals Division

PERMIT APPLICATIONS

2/18/2019 THRU 2/22/2019



Application Number

Date Received

Permittee  
Number

Permittee  
Name

Page 1

308                      02/20/2019                      5320                      SAVOY ENERGY LP  
920 HASTINGS STREET, SUITE A  
PO BOX 1560  
TRAVERSE CITY, MI49685-1560

Prev Permit:

Well Name: WEEKS 3-34 SWD

Surface Owner: EUGENE WEEKS  
SR. SHIRLEY WEEKS

Well Type: BDW

True Vertical Depth: 2785

Permit Type: Drill

Target Formation: NIAGARAN

H2S Present? No

Deepest Formation: CABOT HEAD

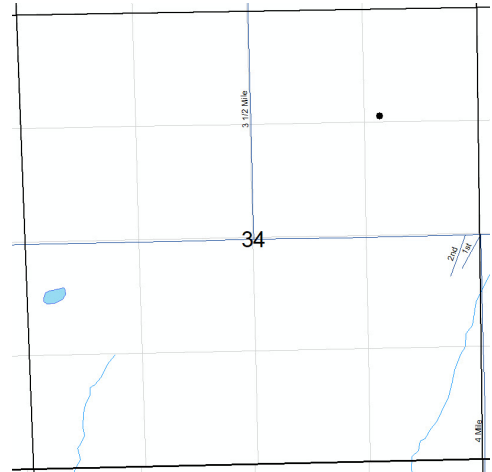

SWD: No drilling unit

Location:	QT QT QT	Sec	Township	Range	Township Name	County	Feet From Section Line	Feet From DRLG Unit Line
SL:	SWNE	34	3S	8W	LEROY	CALHOUN	1239 N 1154 E	
BHL:	SWNE	34	3S	8W	LEROY	CALHOUN	1239 N 1154 E	

Michigan Department of Environmental Quality  
Oil, Gas and Minerals Division

Updated Permits

2/18/2019 THRU 2/22/2019



Permit Number      Permittee Number      Permittee Name

**PLUGGING INSTRUCTIONS ISSUED:**

61372            5320            SAVOY ENERGY LP  
920 HASTINGS STREET, SUITE A  
PO BOX 1560  
TRAVERSE CITY, MI49685-1560

API Well Number: 21-025-62005-00-00

Well Name: WEEKS 2-34

Plug Inst. Issue Date: 10/27/2018

Location	QT QT QT	Sec	Township	Range	Township Name	County	Feet From Section Line	Feet From DRLG Unit
SL:	SESENE	34	3S	8W	LEROY	CALHOUN	2096 N 250 E	
BHL:	SESENE	34	3S	8W	LEROY	CALHOUN	2096 N 250 E	560 S 412 W

Comment: App. to P&A expires 10/27/19.

61384            70            TRENDWELL ENERGY CORPORATION  
10 E BRIDGE ST STE 200  
PO BOX 560  
ROCKFORD, MI 49341

API Well Number: 21-139-62000-00-00

Well Name: RIVER RIDGE FARMS 1-27

Plug Inst. Issue Date: 1/24/2019

Location	QT QT QT	Sec	Township	Range	Township Name	County	Feet From Section Line	Feet From DRLG Unit
SL:	SWNESW	27	8N	14W	POLKTON	OTTAWA	1550 S 1740 W	1114 N 937 E
BHL:	SWNESW	27	8N	14W	POLKTON	OTTAWA	1550 S 1740 W	1114 N 937 E

Comment: App. to P&A expires 1/24/20.

Michigan Department of Environmental Quality  
Oil, Gas and Minerals Division

Updated Permits

2/18/2019 THRU 2/22/2019



Permit Number      Permittee Number      Permittee Name

**RECORD OF WELL PLUGGING:**

61372      5320      SAVOY ENERGY LP  
920 HASTINGS STREET, SUITE A  
PO BOX 1560  
TRAVERSE CITY, MI49685-1560

API Well Number: 21-025-62005-00-00

Well Name: WEEKS 2-34

Plugging Date: 10/28/2018

Location	QT QT QT	Sec	Township	Range	Township Name	County	Feet From Section Line	Feet From DRLG Unit
SL:	SESENE	34	3S	8W	LEROY	CALHOUN	2096 N 250 E	
BHL:	SESENE	34	3S	8W	LEROY	CALHOUN	2096 N 250 E	560 S 412 W

**APPLICATIONS TO CHANGE WELL STATUS:**

13390      491      CONSUMERS ENERGY CO  
  
1945 W PARNALL RD  
JACKSON, MI 49201

API Well Number: 21-035-13390-00-00

Well Name: MICHIGAN GAS STORAGE CO  
318

Approval Date: 1/16/2019

Location	QT QT QT	Sec	Township	Range	Township Name	County	Feet From Section Line	Feet From DRLG Unit
SL:	CNSESE	19	20N	6W	WINTERFIELD	CLARE	660 S 660 E	660 S 660 E

Proposed Rework: ACOWS to Plugback

Comment: ACOWS to plugback to 1350' and return well back to service, expires 1/16/20.

Michigan Department of Environmental Quality  
Oil, Gas and Minerals Division

Updated Permits

2/18/2019 THRU 2/22/2019



Permit Number      Permittee Number      Permittee Name

Page 3

13416      491      CONSUMERS ENERGY CO  
  
1945 W PARNALL RD  
JACKSON, MI 49201

API Well Number: 21-035-13416-00-00

Well Name: MICHIGAN GAS STORAGE CO  
330

Approval Date: 1/14/2019

Location	QT QT QT	Sec	Township	Range	Township Name	County	Feet From Section Line	Feet From DRLG Unit
SL:	CNNENW	30	20N	6W	WINTERFIELD	CLARE	660 N 660 E	660 N 660 E

Proposed Rework: ACOWS to Plugback

Comment: ACOWS to plugback to 1365' and return well back to service, expires 1/16/20.

14322      491      CONSUMERS ENERGY CO  
  
1945 W PARNALL RD  
JACKSON, MI 49201

API Well Number: 21-035-14322-00-00

Well Name: MICHIGAN GAS STORAGE CO  
395

Approval Date: 2/1/2019

Location	QT QT QT	Sec	Township	Range	Township Name	County	Feet From Section Line	Feet From DRLG Unit
SL:	CNNENW	6	19N	6W	REDDING	CLARE	660 N 660 E	660 N 660 E

Proposed Rework: ACOWS to Plugback

Comment: ACOWS to plugback to 1310' and return well back to service, expires 1/16/20.

Michigan Department of Environmental Quality  
Oil, Gas and Minerals Division

Updated Permits

2/18/2019 THRU 2/22/2019



Permit Number      Permittee Number      Permittee Name

Page 4

20971      491      CONSUMERS ENERGY CO  
  
1945 W PARNALL RD  
JACKSON, MI 49201

API Well Number: 21-035-20971-00-00

Well Name: M G S C 947

Approval Date: 2/20/2019

Location	QT QT QT	Sec	Township	Range	Township Name	County	Feet From Section Line	Feet From DRLG Unit
SL:	SESWSW	30	20N	6W	WINTERFIELD	CLARE	165 S 1140 W	132 S 1140 W

Proposed Rework: ACOWS to Plugback

Comment: ACOWS to plugback to 1320' and return well back to service, expires 1/16/20.

13424      491      CONSUMERS ENERGY CO  
  
1945 W PARNALL RD  
JACKSON, MI 49201

API Well Number: 21-133-13424-00-00

Well Name: MICHIGAN GAS STORAGE CO  
324

Approval Date: 1/16/2019

Location	QT QT QT	Sec	Township	Range	Township Name	County	Feet From Section Line	Feet From DRLG Unit
SL:	CNSENE	25	20N	7W	MARION	OSCEOLA	760 S 660 E	760 S 660 E

Proposed Rework: ACOWS to Plugback

Comment: ACOWS to plugback to 1350' and return well back to service, expires 1/16/20.

Michigan Department of Environmental Quality  
Oil, Gas and Minerals Division

Updated Permits

2/18/2019 THRU 2/22/2019



Permit Number      Permittee Number      Permittee Name

Page 5

**RECORD OF CHANGE OF WELL STATUS:**

39748                  6310                          CORE ENERGY LLC  
  
1011 NOTEWARE DRIVE  
TRAVERSE CITY, MI49686

API Well Number: 21-137-39748-00-00

Well Name: JANIK & STRAPPAZON 3-14

Change Date: 1/31/2019

Location	QT QT QT	Sec	Township	Range	Township Name	County	Feet From Section Line	Feet From DRLG Unit
SL:	SENWSW	14	30N	3W	BAGLEY	OTSEGO	855 N 1250 W	460 S 1250 W

Proposed Rework: Reworked to Oil Producing Well

Comment: RCOWS for converting from an observation well to an oil well.

**PERMIT TERMINATIONS:**

61067                  6559                          TRIMONT ENERGY MICHIGAN LLC  
1305 GRANDVIEW AVE, SUITE 450  
  
PITTSBURGH, PA 15221

API Well Number: 21-101-35479-01-00

Well Name: GILLESPIE 4-36A

Termination Date: 2/21/2019

Location	QT QT QT	Sec	Township	Range	Township Name	County	Feet From Section Line	Feet From DRLG Unit
SL:	SENESEW	36	22N	17W	MANISTEE	MANISTEE	1934 S 2232 W	
BHL:	NWNESW	36	22N	17W	MANISTEE	MANISTEE	2186 S 1798 W	480 N 499 W

Michigan Department of Environmental Quality  
Oil, Gas and Minerals Division

Updated Permits

2/18/2019 THRU 2/22/2019



Permit  
Number

Permittee  
Number

Permittee  
Name

Page 6

---

61082      6559      TRIMONT ENERGY MICHIGAN LLC  
1305 GRANDVIEW AVE, SUITE 450  
PITTSBURGH, PA 15221

API Well Number: 21-101-61082-00-00

Well Name: MILLER ANTRIM D3-30

Termination Date: 2/21/2019

Location	QT QT QT	Sec	Township	Range	Township Name	County	Feet From Section Line	Feet From DRLG Unit
SL:	NWSWSE	30	22N	16W	MANISTEE	MANISTEE	921 S 2298 E	921 S 332 W

---