

Michigan Department of Environmental Quality
 Oil, Gas and Minerals Division
 PERMIT APPLICATIONS
 2/19/2018 THRU 2/23/2018

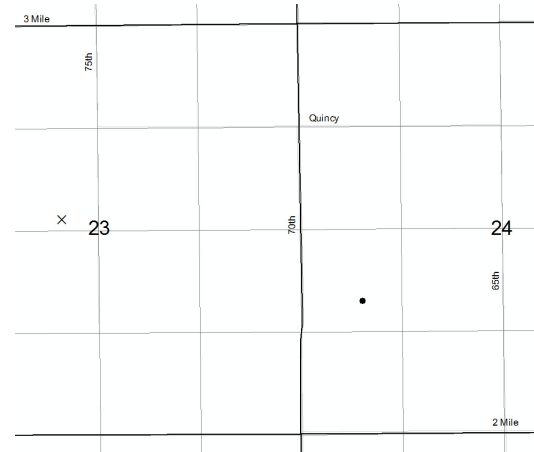

Application Number Date Received Permittee Number Permittee Name Page 1

162 02/22/2018 14 D T E GAS COMPANY
 ONE ENERGY PLAZA, WCB 1782
 DETROIT, MI 48226



Prev Permit:

Well Name: SIX LAKES 463 HD1

Well Type: GS

Permit Type: Drill

H2S Present? No

Surface Owner: D T E GAS COMPANY

True Vertical Depth: 1335

Target Formation: MICHIGAN STRAY

Deepest Formation: MICHIGAN STRAY SANDSTONE

Six Lakes GSF. No drilling unit

Location:	QT QT QT	Sec	Township	Range	Township Name	County	Feet From Section Line	Feet From DRLG Unit Line
SL:	SESENW	23	13N	8W	HINTON	MECOSTA	2499 N 2155 W	
BHL:	SENWSW	24	13N	8W	HINTON	MECOSTA	1658 S 744 W	

Michigan Department of Environmental Quality
 Oil, Gas and Minerals Division
 PERMIT APPLICATIONS
 2/19/2018 THRU 2/23/2018



Application Number Date Received Permittee Number Permittee Name Page 2

163 02/23/2018 6418 W B OSBORN OIL AND GAS OPERATIONS LTD
 P O BOX 8C
 1250 N. E. LOOP 410, STE 600
 SAN ANTONIO, TX 78217

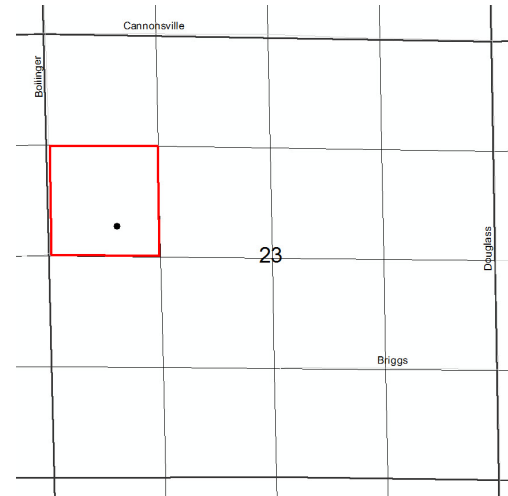

Prev Permit: NONE

Well Name: WILSON 1-23

Surface Owner: JAMES & DIANE WILSON

Well Type: OIL

True Vertical Depth: 3060

Permit Type: Drill

Target Formation: TRAVERSE LIMESTONE

H2S Present? No

Deepest Formation: TRAVERSE LIMESTONE

Drilling Unit: 40A. SW/4 NW/4 Section 23.

Location:	QT QT QT	Sec	Township	Range	Township Name	County	Feet From Section Line	Feet From DRLG Unit Line
SL:	SESWNW	23	11N	5W	FERRIS	MONTCALM	2332 N 884 W	
BHL:	SESWNW	23	11N	5W	FERRIS	MONTCALM	2332 N 884 W	330 S 453 E

Michigan Department of Environmental Quality
Oil, Gas and Minerals Division
Updated Permits
2/19/2018 THRU 2/23/2018



Permit Number Permittee Number Permittee Name

RECORD OF WELL PLUGGING:

61271 100 APOLLO EXPLORATION AND DEVELOPMENT INC
1710 E REMUS ROAD
PO BOX 190
MOUNT PLEASANT, MI 48804-0190

API Well Number: 21-011-62001-00-00

Well Name: HERTZLER 1-10

Plugging Date: 12/6/2017

Location	QT QT QT	Sec	Township	Range	Township Name	County	Feet From Section Line	Feet From DRLG Unit
SL:	NESWNW	10	19N	4E	DEEP RIVER	ARENAC	836 S 700 W	482 N 602 E
BHL:	NESWNW	10	19N	4E	DEEP RIVER	ARENAC	836 S 700 W	482 N 602 E

53268 5320 SAVOY ENERGY LP
920 HASTINGS STREET, SUITE A
PO BOX 1560
TRAVERSE CITY, MI49685-1560

API Well Number: 21-059-53268-00-00

Well Name: HEFFELFINGER 1-25

Plugging Date: 9/29/2017

Location	QT QT QT	Sec	Township	Range	Township Name	County	Feet From Section Line	Feet From DRLG Unit
SL:	SESWSE	25	7S	4W	READING	HILLSDALE	331 S 1636 E	331 S 330 E

Michigan Department of Environmental Quality
Oil, Gas and Minerals Division
Updated Permits
2/19/2018 THRU 2/23/2018



Permit Number Permittee Number Permittee Name

60398 5320 SAVOY ENERGY LP
920 HASTINGS STREET, SUITE A
PO BOX 1560
TRAVERSE CITY, MI49685-1560

API Well Number: 21-091-60398-00-00

Well Name: RUESINK 8-16

Plugging Date: 10/12/2017

Location	QT QT QT	Sec	Township	Range	Township Name	County	Feet From Section Line	Feet From DRLG Unit
SL:	SENWSW	16	6S	3E	ADRIAN	LENAWEE	1877 S 1031 W	563 S 364 W

60398 5320 SAVOY ENERGY LP
920 HASTINGS STREET, SUITE A
PO BOX 1560
TRAVERSE CITY, MI49685-1560

API Well Number: 21-091-60398-01-00

Well Name: RUESINK 8-16 HD1

True Vertical Depth: 3622

Plugging Date: 10/12/2017

Location	QT QT QT	Sec	Township	Range	Township Name	County	Feet From Section Line	Feet From DRLG Unit
SL:	SENWSW	16	6S	3E	ADRIAN	LENAWEE	1877 S 1031 W	750 N 1031 W
BHL:	NWNESW	16	6S	3E	ADRIAN	LENAWEE	2301 S 1668 W	332 N 332 E

Michigan Department of Environmental Quality
Oil, Gas and Minerals Division
Updated Permits
2/19/2018 THRU 2/23/2018



Permit Number Permittee Number Permittee Name

60398 5320 SAVOY ENERGY LP
920 HASTINGS STREET, SUITE A
PO BOX 1560
TRAVERSE CITY, MI49685-1560

API Well Number: 21-091-60398-02-00

Well Name: RUESINK 8-16 HD2

True Vertical Depth: 3629

Plugging Date: 10/12/2017

Location	QT QT QT	Sec	Township	Range	Township Name	County	Feet From Section Line	Feet From DRLG Unit
SL:	SENWSW	16	6S	3E	ADRIAN	LENAWEE	1877 S 1031 W	750 N 1031 W
BHL:	SWNESW	16	6S	3E	ADRIAN	LENAWEE	1652 S 1452 W	338 S 547 E

61141 6531 AMPLIFY DEVELOPMENT LLC
13907 CARROLLWOOD VILLAGE RUN
TAMPA, FL33618

API Well Number: 21-117-61141-00-00

Well Name: PAULEN 1-25

Plugging Date: 2/6/2018

Location	QT QT QT	Sec	Township	Range	Township Name	County	Feet From Section Line	Feet From DRLG Unit
SL:	SWSENE	25	12N	10W	REYNOLDS	MONTCALM	2137 N 1160 E	822 N 1160 E

Michigan Department of Environmental Quality
Oil, Gas and Minerals Division
Updated Permits
2/19/2018 THRU 2/23/2018



Permit Number Permittee Number Permittee Name

60788 6522 UNION GAS OPERATING COMPANY
14505 TORREY CHASE BLDV
SUITE 205
HOUSTON, TX 77014

API Well Number: 21-127-60787-01-00

Well Name: MERTEN 1-24 HD1

True Vertical Depth: 4221

Plugging Date: 12/28/2017

Location	QT QT QT	Sec	Township	Range	Township Name	County	Feet From Section Line	Feet From DRLG Unit
SL:	SESESE	24	15N	17W	HART	OCEANA	125 S 461 E	
BHL:	SENENE	24	15N	17W	HART	OCEANA	943 N 479 E	943 N 479 E

Michigan Department of Environmental Quality
 Oil, Gas and Minerals Division
 Updated Permits
 2/19/2018 THRU 2/23/2018



Permit Number Permittee Number Permittee Name

APPLICATIONS TO CHANGE WELL STATUS:

60901 6312 ARBOR OPERATING LLC
 104 S UNION STREET SUITE 202
 TRAVERSE CITY, MI49684

API Well Number: 21-115-60840-01-00

Well Name: RHINESS 1-6HD1

True Vertical Depth: 2085

Approval Date: 2/15/2018

Location	QT QT QT	Sec	Township	Range	Township Name	County	Feet From Section Line	Feet From DRLG Unit
SL:	NESWNE	6	7S	6E	SUMMERFIELD	MONROE	1505 N 1962 E	
BHL:	NWNWNE	6	7S	6E	SUMMERFIELD	MONROE	531 N 2274 E	531 N 963 E

Proposed Rework: ACOWS to Continue Drilling - HDH

Comment: ACOWS to drill HD2 open hole lateral, expires 12/31/18.