

Michigan Department of Environmental Quality  
Oil, Gas and Minerals Division

PERMIT APPLICATIONS

3/4/2019 THRU 3/8/2019



Application Number      Date Received      Permittee Number      Permittee Name      Page 1

301      03/04/2019      6498

WOLVERINE GAS AND OIL  
COMPANY OF MICHIGAN LLC  
ONE RIVERFRONT PLAZA  
55 CAMPAU, NW  
GRAND RAPIDS, MI 49503

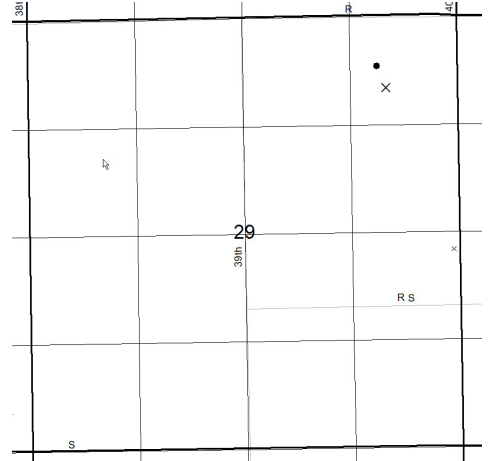

Prev Permit: 61264 (Miller 29-2) &  
61286 (29-2A)

Well Name: MILLER 29-2A SWD

Well Type: BDW

Permit Type: Convert

H2S Present? No

Surface Owner: Clarence and  
Maxine Miller Living Revocable Trust

True Vertical Depth: 3878

Target Formation: NIAGARAN GRAY

Deepest Formation: GLENWOOD

Non-producing well: No drilling unit

Location:	QT QT QT	Sec	Township	Range	Township Name	County	Feet From Section Line	Feet From DRLG Unit Line
SL:	SWNENE	29	3S	9W	CLIMAX	KALAMAZOO	880 N 872 E	
BHL:	NWNENE	29	3S	9W	CLIMAX	KALAMAZOO	587 N 1000 E	

Michigan Department of Environmental Quality  
Oil, Gas and Minerals Division

PERMIT APPLICATIONS

3/4/2019 THRU 3/8/2019



Application Number      Date Received      Permittee Number      Permittee Name      Page 2

316      03/04/2019      5320      SAVOY ENERGY LP  
920 HASTINGS STREET, SUITE A  
PO BOX 1560  
TRAVERSE CITY, MI 49685-1560

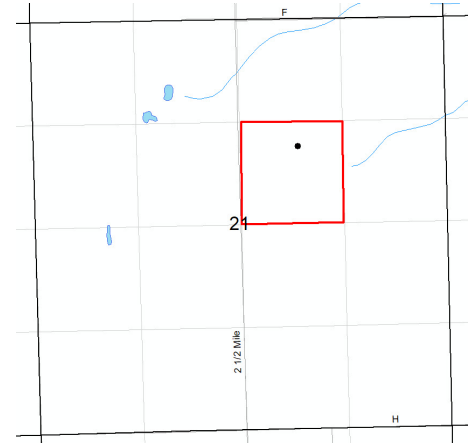

Prev Permit:

Well Name: Traister 1-21

Surface Owner: Traister, Timothy J.

Well Type: OIL

True Vertical Depth: 4100

Permit Type: Drill

Target Formation: TRENTON-BLACK RIVER

H2S Present? No

Deepest Formation: PRAIRIE DU CHIEN

Drilling Unit: 40ac SW/4 NE/4 SEC 21

Location:	QT QT QT	Sec	Township	Range	Township Name	County	Feet From Section Line	Feet From DRLG Unit Line
SL:	NESWNE	21	3S	8W	LEROY	CALHOUN	1730 N 1970 W	400 N 635 E
BHL:	NESWNE	21	3S	8W	LEROY	CALHOUN	1730 N 1970 W	400 N 635 E

317      03/07/2019      6498      WOLVERINE GAS AND OIL  
COMPANY OF MICHIGAN LLC  
ONE RIVERFRONT PLAZA  
55 CAMPAU, NW  
GRAND RAPIDS, MI 49503

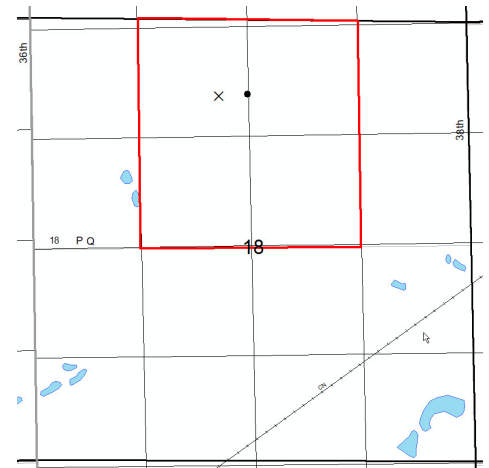

Prev Permit:

Surface Owner: Phyllis J. Simmons

Well Name: Simmons 18-1

True Vertical Depth: 3900

Well Type: OIL

Target Formation: TRENTON

Permit Type: Drill

Deepest Formation: GLENWOOD

H2S Present? Yes

Drilling unit: 160A R 303 exception request. E/2 NW/4, W/2 NE/4 SEC 18

Location:	QT QT QT	Sec	Township	Range	Township Name	County	Feet From Section Line	Feet From DRLG Unit Line
SL:	SENENW	18	3S	9W	CLIMAX	KALAMAZOO	1112 N 2091 W	1112 N 852 W
BHL:	SENENW	18	3S	9W	CLIMAX	KALAMAZOO	1020 N 2559 W	1020 N 1321 W

Michigan Department of Environmental Quality  
Oil, Gas and Minerals Division

PERMIT LIST

3/4/2019 THRU 3/8/2019



Permit Number      Issue Date      Permittee Number      Permittee Name      Page 1

61395      3/7/2019      5320      SAVOY ENERGY LP  
920 HASTINGS STREET, SUITE A  
PO BOX 1560  
TRAVERSE CITY, MI 49685-1560

API Well No: 21-133-62017-00-00

Prev Permit:

Well Name: WEBER 1-36

Surface Owner: Weber, Daniel W.  
and Betsy

Well Type: Oil Well

True Vertical Depth: 3925FT

Permit Type: Drill

Target Formation: DUNDEE

H2S Present? Yes

Deepest Formation: LUCAS

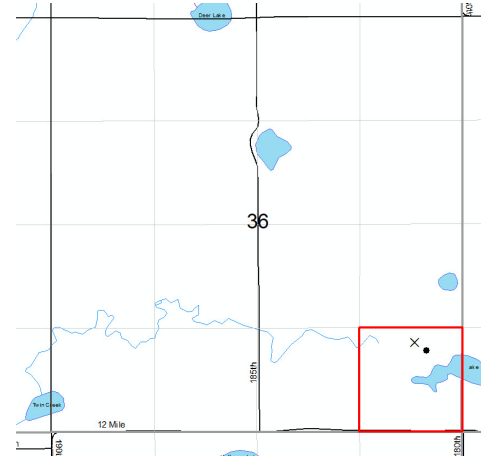

Drilling unit: 40 ac SE/4 SE/4 Sec 36

Location:	QT QT QT	Sec	Township	Range	Township Name	County	Feet From Section Line	Feet From DRLG Unit Line
SL:	NESESE	36	19N	10W	LEROY	OSCEOLA	1117 S 610 E	
BHL:	NESESE	36	19N	10W	LEROY	OSCEOLA	929 S 451 E	382 N 451 E

Michigan Department of Environmental Quality  
Oil, Gas and Minerals Division

Updated Permits

3/4/2019 THRU 3/8/2019



Permit Number      Permittee Number      Permittee Name

**RECORD OF WELL PLUGGING:**

61391      5320      SAVOY ENERGY LP  
920 HASTINGS STREET, SUITE A  
PO BOX 1560  
TRAVERSE CITY, MI 49685-1560

API Well Number: 21-025-62006-01-00

Well Name: LILLY 1-3 HD1

Plugging Date: 11/23/2018

Location	QT QT QT	Sec	Township	Range	Township Name	County	Feet From Section Line	Feet From DRLG Unit
SL:		3	4S	8W	ATHENS	CALHOUN	620 N 1645 E	
BHL:	NESESW	34	3S	8W	LEROY	CALHOUN	993 S 2266 E	331 N 930 W

61211      5934      MERIDIAN PRODUCTION SERVICES  
LLC  
6009 MARSH ROAD  
PO BOX 610  
HASLETT, MI 48840

API Well Number: 21-075-61211-00-00

Well Name: POTTS 1-29 P

Plugging Date: 5/26/2018

Location	QT QT QT	Sec	Township	Range	Township Name	County	Feet From Section Line	Feet From DRLG Unit
SL:	SENENW	29	4S	3W	PULASKI	JACKSON	794 N 2258 W	
BHL:	SWNENW	29	4S	3W	PULASKI	JACKSON	930 N 1586 W	930 N 1586 W

Michigan Department of Environmental Quality  
Oil, Gas and Minerals Division

Updated Permits

3/4/2019 THRU 3/8/2019



Permit Number      Permittee Number      Permittee Name

Page 2

59920      5312      PAXTON RESOURCES LLC  
132 N OTSEGO AVE  
GAYLORD, MI 49735

API Well Number: 21-161-59920-00-00

Well Name: COOK 1-27

Plugging Date: 1/23/2015

Location	QT QT QT	Sec	Township	Range	Township Name	County	Feet From Section Line	Feet From DRLG Unit
SL:	NWNENW	27	4S	5E	SALINE	WASHTENAW	387 N 1696 W	387 N 361 W

**PERMIT TERMINATIONS:**

61188      5320      SAVOY ENERGY LP  
920 HASTINGS STREET, SUITE A  
PO BOX 1560  
TRAVERSE CITY, MI 49685-1560

API Well Number: 21-115-61188-00-00

Well Name: STANGER 1-7

Termination Date: 9/8/2018

Location	QT QT QT	Sec	Township	Range	Township Name	County	Feet From Section Line	Feet From DRLG Unit
SL:	SEWNNE	7	6S	6E	DUNDEE	MONROE	1300 N 1410 E	1300 N 1328 W