

Michigan Department of Environmental Quality
Oil, Gas and Minerals Division

PERMIT LIST

3/25/2019 THRU 3/29/2019



Permit Number Issue Date Permittee Number Permittee Name Page 1

61397 3/29/2019 104 WEST BAY EXPLORATION COMPANY
13685 S WEST BAYSHORE DR
TRAVERSE CITY, MI 49684

API Well No: 21-051-62016-00-00

Prev Permit:

Well Name: Giegler 1-13 Surface Owner: Kimberly Giegler
Gerald Glasco Lisa Giegler-Glasco

Well Type: Oil Well True Vertical Depth: 4200FT

Permit Type: Drill Target Formation: DUNDEE

H2S Present? Yes Deepest Formation: DUNDEE

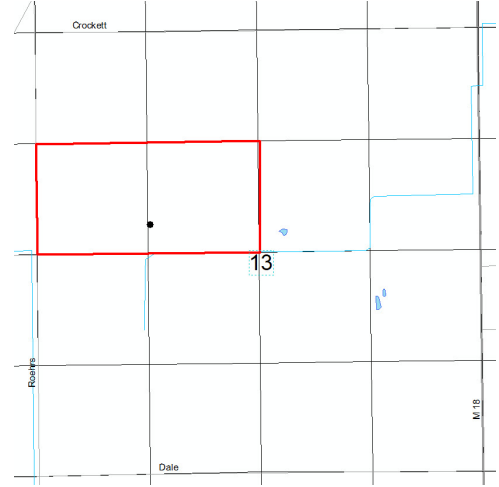

80 Acre R303 Drilling Unit S/2 NW/4:

Location:	QT QT QT	Sec	Township	Range	Township Name	County	Feet From Section Line	Feet From DRLG Unit Line
SL:	SWSENW	13	17N	2W	BEAVERTON	GLADWIN	2308 N 1350 W	330 S 1287 E
BHL:	SWSENW	13	17N	2W	BEAVERTON	GLADWIN	2308 N 1350 W	330 S 1287 E