

Michigan Department of Environmental Quality  
Oil, Gas and Minerals Division

PERMIT LIST

4/8/2019 THRU 4/12/2019



Permit Number      Issue Date      Permittee Number      Permittee Name      Page 1

61401      4/9/2019      5320      SAVOY ENERGY LP  
920 HASTINGS STREET, SUITE A  
PO BOX 1560  
TRAVERSE CITY, MI 49685-1560

API Well No: 21-025-62007-00-00

Prev Permit:

Well Name: Traister 1-21

Surface Owner: Traister, Timothy J.

Well Type: Oil Well

True Vertical Depth: 4100FT

Permit Type: Drill

Target Formation: TRENTON-BLACK RIVER

H2S Present? No

Deepest Formation: PRAIRIE DU CHIEN

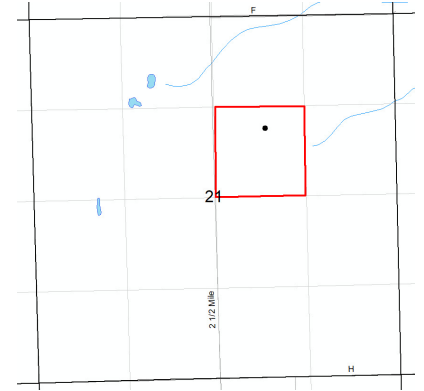

40 Acre Drilling Unit: SW/4 NE/4, Sec 24

Location:	QT QT QT	Sec	Township	Range	Township Name	County	Feet From Section Line	Feet From DRLG Unit Line
SL:	NESWNE	21	3S	8W	LEROY	CALHOUN	1730 N 1970 E	
BHL:	NESWNE	21	3S	8W	LEROY	CALHOUN	1730 N 1970 E	400 N 635 E

Michigan Department of Environmental Quality  
Oil, Gas and Minerals Division

PERMIT APPLICATIONS

4/8/2019 THRU 4/12/2019



Application Number      Date Received      Permittee Number      Permittee Name      Page 1

319      04/09/2019      5320      SAVOY ENERGY LP  
920 HASTINGS STREET, SUITE A  
PO BOX 1560  
TRAVERSE CITY, MI 49685-1560

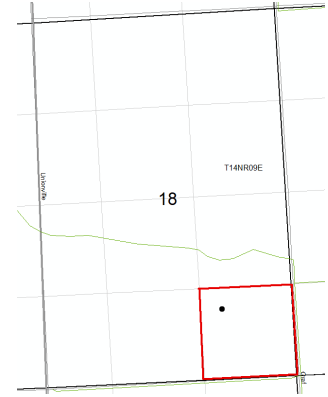

40 Acre Drilling Unit: SE/4 SE/4, Sec 18 (Irregular Section)

Prev Permit:

Well Name: Abke 1-18

Surface Owner: Abke, Lynn and Kathleen

Well Type: OIL

True Vertical Depth: 3250

Permit Type: Drill

Target Formation: DUNDEE

H2S Present? No

Deepest Formation: LUCAS

Location:	QT QT QT	Sec	Township	Range	Township Name	County	Feet From Section Line	Feet From DRLG Unit Line
SL:	NWSESE	18	14N	9E	COLUMBIA	TUSCOLA	995 S 991 E	
BHL:	NWSESE	18	14N	9E	COLUMBIA	TUSCOLA	995 S 991 E	331 N 331 W

323      04/12/2019      6498      WOLVERINE GAS AND OIL COMPANY OF MICHIGAN LLC  
ONE RIVERFRONT PLAZA  
55 CAMPAU, NW  
GRAND RAPIDS, MI 49503

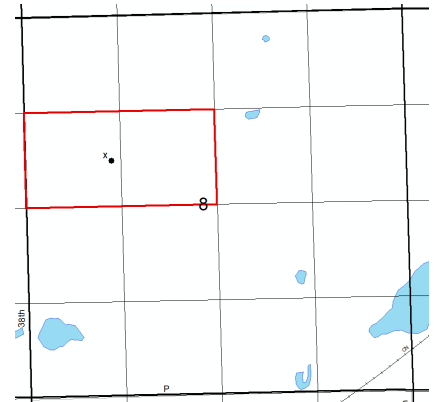

80 Acre R303 Unit: S/2 NW/4, Sec 8

Prev Permit:

Well Name: McMichael 8-1

Surface Owner: Mike M. McMichael Rev. Trust

Well Type: OIL

True Vertical Depth: 3997

Permit Type: Drill

Target Formation: TRENTON

H2S Present? Yes

Deepest Formation: GLENWOOD

Location:	QT QT QT	Sec	Township	Range	Township Name	County	Feet From Section Line	Feet From DRLG Unit Line
SL:	SESWNW	8	3S	9W	CLIMAX	KALAMAZOO	2008 N 1188 W	
BHL:	SESWNW	8	3S	9W	CLIMAX	KALAMAZOO	2119 N 1262 W	538 S 1262 W

Michigan Department of Environmental Quality  
Oil, Gas and Minerals Division

Updated Permits

4/8/2019 THRU 4/12/2019



Permit Number      Permittee Number      Permittee Name

Page 1

**PLUGGING INSTRUCTIONS ISSUED:**

52011      6042      HARDY AND HARDY CONSULTING  
LLC  
  
PO BOX 332  
DEWITT, MI 48820

API Well Number: 21-017-52011-00-00

Well Name: STATE FRASER 2-18      True Vertical Depth: 12328

Plug Inst. Issue Date: 4/9/2019

Location	QT QT QT	Sec	Township	Range	Township Name	County	Feet From Section Line	Feet From DRLG Unit
SL:	SESWSE	12	16N	4E	FRASER	BAY	225 S 924 W	
BHL:	SENWSE	18	16N	5E	FRASER	BAY	1043 N 1266 W	1043 N 1374 E

Comment: App. to P&A expires 11/30/19.

11600      491      CONSUMERS ENERGY CO  
  
1945 W PARNALL RD  
JACKSON, MI 49201

API Well Number: 21-035-11600-00-00

Well Name: M G S C 792

Plug Inst. Issue Date: 4/5/2019

Location	QT QT QT	Sec	Township	Range	Township Name	County	Feet From Section Line	Feet From DRLG Unit
SL:	CNSE	3	20N	6W	WINTERFIELD	CLARE	1320 S 1320 W	1320 N 1320 E

Comment: App. to P&A expires 4/5/20.

Michigan Department of Environmental Quality  
Oil, Gas and Minerals Division

Updated Permits

4/8/2019 THRU 4/12/2019



Permit Number      Permittee Number      Permittee Name

Page 2

46270      25      DELTA OIL CO INC  
125 WINDSOR DR STE 101  
OAK BROOK, IL 60523

API Well Number: 21-119-46270-00-00

Well Name: VIENNA A4-10

Plug Inst. Issue Date: 4/2/2019

Location	QT QT QT	Sec	Township	Range	Township Name	County	Feet From Section Line	Feet From DRLG Unit
SL:	SWNE	10	31N	1E	VIENNA	MONTMORENCY	675 N 870 E	443 S 436 W

Comment: App. to P&A expires 4/2/20.

50871      25      DELTA OIL CO INC  
125 WINDSOR DR STE 101  
OAK BROOK, IL 60523

API Well Number: 21-119-50871-00-00

Well Name: SNOOK 8-15

Plug Inst. Issue Date: 4/2/2019

Location	QT QT QT	Sec	Township	Range	Township Name	County	Feet From Section Line	Feet From DRLG Unit
SL:	NWSE	15	31N	1E	VIENNA	MONTMORENCY	828 S 974 E	828 S 338 W

Comment: App. to P&A expires 4/2/20.

Michigan Department of Environmental Quality  
Oil, Gas and Minerals Division

Updated Permits

4/8/2019 THRU 4/12/2019



Permit Number      Permittee Number      Permittee Name

Page 3

50873      25      DELTA OIL CO INC  
125 WINDSOR DR STE 101  
OAK BROOK, IL 60523

API Well Number: 21-119-50873-00-00

Well Name: CRALL C4-10

Plug Inst. Issue Date: 4/2/2019

Location	QT QT QT	Sec	Township	Range	Township Name	County	Feet From Section Line	Feet From DRLG Unit
SL:	NWNESE	10	31N	1E	VIENNA	MONTMORENCY	651 N 766 E	651 N 548 W

Comment: App. to P&A expires 4/2/20.

52510      25      DELTA OIL CO INC  
125 WINDSOR DR STE 101  
OAK BROOK, IL 60523

API Well Number: 21-119-52510-00-00

Well Name: O.K. BET A4-3

Plug Inst. Issue Date: 4/2/2019

Location	QT QT QT	Sec	Township	Range	Township Name	County	Feet From Section Line	Feet From DRLG Unit
SL:	NWNENE	3	31N	1E	VIENNA	MONTMORENCY	335 N 778 E	335 N 778 E

Comment: App. to P&A expires 4/2/20.

Michigan Department of Environmental Quality  
Oil, Gas and Minerals Division

Updated Permits

4/8/2019 THRU 4/12/2019



Permit Number      Permittee Number      Permittee Name

Page 4

52632      25      DELTA OIL CO INC  
125 WINDSOR DR STE 101  
OAK BROOK, IL 60523

API Well Number: 21-119-52632-00-00

Well Name: O.K. BET D3-3

Plug Inst. Issue Date: 4/2/2019

Location	QT QT QT	Sec	Township	Range	Township Name	County	Feet From Section Line	Feet From DRLG Unit
SL:	SWSWSE	3	31N	1E	VIENNA	MONTMORENCY	330 S 601 W	330 S 601 W

Comment: App. to P&A expires 4/2/20.

59381      6361      RIVERSIDE ENERGY MICHIGAN LLC  
10691 EAST CARTER ROAD  
SUITE 201  
TRAVERSE CITY, MI 49684

API Well Number: 21-119-59381-00-00

Well Name: STATE MONTMORENCY C1-19

Plug Inst. Issue Date: 4/2/2019

Location	QT QT QT	Sec	Township	Range	Township Name	County	Feet From Section Line	Feet From DRLG Unit
SL:	NWNWSW	19	32N	2E	MONTMORENCY	MONTMORENCY	2250 S 660 W	350 N 660 W

Comment: App. to P&A expires 4/2/20.

Michigan Department of Environmental Quality  
Oil, Gas and Minerals Division

Updated Permits

4/8/2019 THRU 4/12/2019



Permit Number      Permittee Number      Permittee Name

Page 5

34339      6361      RIVERSIDE ENERGY MICHIGAN LLC  
10691 EAST CARTER ROAD  
SUITE 201  
TRAVERSE CITY, MI 49684

API Well Number: 21-137-34339-00-00

Well Name: STATE CHESTER 2-31 SWD

Plug Inst. Issue Date: 4/4/2019

Location	QT QT QT	Sec	Township	Range	Township Name	County	Feet From Section Line	Feet From DRLG Unit
SL:	SENENE	31	30N	2W	CHESTER	OTSEGO	1100 N 460 E	1100 N 460 E

Comment: App. to P&A expires 4/4/20.

43449      6361      RIVERSIDE ENERGY MICHIGAN LLC  
10691 EAST CARTER ROAD  
SUITE 201  
TRAVERSE CITY, MI 49684

API Well Number: 21-137-43449-00-00

Well Name: STATE CHESTER C1-31

Plug Inst. Issue Date: 4/9/2019

Location	QT QT QT	Sec	Township	Range	Township Name	County	Feet From Section Line	Feet From DRLG Unit
SL:	NENWNE	31	30N	2W	CHESTER	OTSEGO	654 N 687 W	654 N 618 E

Comment: App. to P&A expires 4/9/20.

Michigan Department of Environmental Quality  
Oil, Gas and Minerals Division

Updated Permits

4/8/2019 THRU 4/12/2019



Permit Number      Permittee Number      Permittee Name

Page 6

43451      6361      RIVERSIDE ENERGY MICHIGAN LLC  
10691 EAST CARTER ROAD  
SUITE 201  
TRAVERSE CITY, MI 49684

API Well Number: 21-137-43451-00-00

Well Name: STATE CHESTER D1-31

Plug Inst. Issue Date: 4/4/2019

Location	QT QT QT	Sec	Township	Range	Township Name	County	Feet From Section Line	Feet From DRLG Unit
SL:	NWNENE	31	30N	2W	CHESTER	OTSEGO	660 N 742 E	660 N 412 W

Comment: App. to P&A expires 4/4/20.

43452      6361      RIVERSIDE ENERGY MICHIGAN LLC  
10691 EAST CARTER ROAD  
SUITE 201  
TRAVERSE CITY, MI 49684

API Well Number: 21-137-43452-00-00

Well Name: STATE CHESTER C2-31

Plug Inst. Issue Date: 4/9/2019

Location	QT QT QT	Sec	Township	Range	Township Name	County	Feet From Section Line	Feet From DRLG Unit
SL:	SESWNE	31	30N	2W	CHESTER	OTSEGO	556 S 810 W	556 S 500 E

Comment: App. to P&A expires 4/9/20.



Michigan Department of Environmental Quality  
Oil, Gas and Minerals Division

Updated Permits

4/8/2019 THRU 4/12/2019



Permit Number      Permittee Number      Permittee Name

Page 7

43511      6361      RIVERSIDE ENERGY MICHIGAN LLC  
10691 EAST CARTER ROAD  
SUITE 201  
TRAVERSE CITY, MI 49684

API Well Number: 21-137-43511-00-00

Well Name: STYLES, ET AL 33-31      True Vertical Depth: 1685

Plug Inst. Issue Date: 4/4/2019

Location	QT QT QT	Sec	Township	Range	Township Name	County	Feet From Section Line	Feet From DRLG Unit
SL:	NWNWSE	31	30N	2W	CHESTER	OTSEGO	200 N 137 W	
BHL:	NWNWSE	31	30N	2W	CHESTER	OTSEGO	395 N 435 W	395 N 435 W

Comment: App. to P&A expires 4/4/20.

57404      6361      RIVERSIDE ENERGY MICHIGAN LLC  
10691 EAST CARTER ROAD  
SUITE 201  
TRAVERSE CITY, MI 49684

API Well Number: 21-137-57404-00-00

Well Name: RECKKER B2-26

Plug Inst. Issue Date: 4/5/2019

Location	QT QT QT	Sec	Township	Range	Township Name	County	Feet From Section Line	Feet From DRLG Unit
SL:	SESENW	26	31N	4W	ELMIRA	OTSEGO	2320 N 2268 W	359 S 361 E

Comment: App. to P&A expires 4/5/20.

Michigan Department of Environmental Quality  
Oil, Gas and Minerals Division

Updated Permits

4/8/2019 THRU 4/12/2019



Permit Number      Permittee Number      Permittee Name

Page 8

61361      6042      HARDY AND HARDY CONSULTING  
LLC  
  
PO BOX 332  
DEWITT, MI 48820

API Well Number: 21-111-62000-01-00

Well Name: CITY OF MASON 11-2A

Plugging Date: 11/15/2018

Location	QT QT QT	Sec	Township	Range	Township Name	County	Feet From Section Line	Feet From DRLG Unit
SL:	NENWNW	2	13N	2W	JASPER	MIDLAND	330 N 972 W	
BHL:	NENWNW	2	13N	2W	JASPER	MIDLAND	330 N 972 W	330 N 330 E

Michigan Department of Environmental Quality  
Oil, Gas and Minerals Division

Updated Permits

4/8/2019 THRU 4/12/2019



Permit Number      Permittee Number      Permittee Name

**APPLICATIONS TO CHANGE WELL STATUS:**

59874      6312      ARBOR OPERATING LLC  
104 S UNION STREET SUITE 202  
TRAVERSE CITY, MI 49684

API Well Number: 21-015-59874-00-00

Well Name: HALBERT 1-7

Approval Date: 4/2/2019

Location	QT QT QT	Sec	Township	Range	Township Name	County	Feet From Section Line	Feet From DRLG Unit
SL:	NENESW	7	1N	8W	JOHNSTOWN	BARRY	2298 S 2333 W	330 N 330 E

Proposed Rework: ACOWS to Perforate and Test Current Formation

Comment: ACOWS to plugback existing perms, and recompleat higher in the Traverse Lime, expires 4/2/20.

9192      491      CONSUMERS ENERGY CO  
1945 W PARNALL RD  
JACKSON, MI 49201

API Well Number: 21-035-09192-00-00

Well Name: M G S C 603

Approval Date: 3/29/2019

Location	QT QT QT	Sec	Township	Range	Township Name	County	Feet From Section Line	Feet From DRLG Unit
SL:	CNNE	33	20N	6W	WINTERFIELD	CLARE	1320 S 1320 W	1320 N 1320 E

Proposed Rework: ACOWS for Miscellaneous

Comment: ACOWS to plugback well to 1300', add perms, and return well back to service, expires 3/29/20.

Michigan Department of Environmental Quality  
Oil, Gas and Minerals Division

Updated Permits

4/8/2019 THRU 4/12/2019



Permit Number      Permittee Number      Permittee Name

9237                      491                      CONSUMERS ENERGY CO  
  
1945 W PARNALL RD  
JACKSON, MI 49201

API Well Number: 21-035-09237-00-00

Well Name: M G S C 617

Approval Date: 3/28/2019

Location	QT QT QT	Sec	Township	Range	Township Name	County	Feet From Section Line	Feet From DRLG Unit
SL:	CNSW	20	20N	6W	WINTERFIELD	CLARE	1320 S 1320 W	1320 N 1320 E

Proposed Rework: ACOWS for Miscellaneous

Comment: ACOWS to plugback well to 1345', add perfs, and return well back to service, expires 3/28/20.

9238                      491                      CONSUMERS ENERGY CO  
  
1945 W PARNALL RD  
JACKSON, MI 49201

API Well Number: 21-035-09238-00-00

Well Name: M G S C 626

Approval Date: 3/29/2019

Location	QT QT QT	Sec	Township	Range	Township Name	County	Feet From Section Line	Feet From DRLG Unit
SL:	CNNW	30	20N	6W	WINTERFIELD	CLARE	1320 S 1320 W	1320 N 1320 E

Proposed Rework: ACOWS for Miscellaneous

Comment: ACOWS to add perfs and return well back to service, expires 3/29/20.

Michigan Department of Environmental Quality  
Oil, Gas and Minerals Division

Updated Permits

4/8/2019 THRU 4/12/2019



Permit Number      Permittee Number      Permittee Name

Page 11

12718      491      CONSUMERS ENERGY CO  
1945 W PARNALL RD  
JACKSON, MI 49201

API Well Number: 21-035-12718-00-00

Well Name: MICHIGAN GAS STORAGE CO  
220

Approval Date: 3/28/2019

Location	QT QT QT	Sec	Township	Range	Township Name	County	Feet From Section Line	Feet From DRLG Unit
SL:	CNNWSE	32	20N	6W	WINTERFIELD	CLARE	660 N 660 W	660 N 660 W

Proposed Rework: ACOWS for Miscellaneous

Comment: ACOWS to plugback well to 1305', add perfs, and return well back to service, expires 3/29/20.

12824      491      CONSUMERS ENERGY CO  
1945 W PARNALL RD  
JACKSON, MI 49201

API Well Number: 21-035-12824-00-00

Well Name: MICHIGAN GAS STORAGE CO  
242

Approval Date: 3/28/2019

Location	QT QT QT	Sec	Township	Range	Township Name	County	Feet From Section Line	Feet From DRLG Unit
SL:	CNNESE	30	20N	6W	WINTERFIELD	CLARE	660 N 660 E	660 N 660 E

Proposed Rework: ACOWS for Miscellaneous

Comment: ACOWS to plugback well to 1340', add perfs, and return well back to service, expires 3/28/20.

Michigan Department of Environmental Quality  
Oil, Gas and Minerals Division

Updated Permits

4/8/2019 THRU 4/12/2019



Permit Number      Permittee Number      Permittee Name

Page 12

13217      491      CONSUMERS ENERGY CO  
1945 W PARNALL RD  
JACKSON, MI 49201

API Well Number: 21-035-13217-00-00

Well Name: MICHIGAN GAS STORAGE CO  
284

Approval Date: 3/28/2019

Location	QT QT QT	Sec	Township	Range	Township Name	County	Feet From Section Line	Feet From DRLG Unit
SL:	CNNWNE	29	20N	6W	WINTERFIELD	CLARE	660 N 660 W	660 N 660 W

Proposed Rework: ACOWS for Miscellaneous

Comment: ACOWS to plugback well to 1345' and return well back to service, expires 3/28/20.

13219      491      CONSUMERS ENERGY CO  
1945 W PARNALL RD  
JACKSON, MI 49201

API Well Number: 21-035-13219-00-00

Well Name: MGSC 286

Approval Date: 3/28/2019

Location	QT QT QT	Sec	Township	Range	Township Name	County	Feet From Section Line	Feet From DRLG Unit
SL:	CNSENW	20	20N	6W	WINTERFIELD	CLARE	660 S 690 E	660 S 690 E

Proposed Rework: ACOWS for Miscellaneous

Comment: ACOWS to plugback well to 1320' and return well back to service, expires 3/28/20.

Michigan Department of Environmental Quality  
Oil, Gas and Minerals Division

Updated Permits

4/8/2019 THRU 4/12/2019



Permit Number      Permittee Number      Permittee Name

13220      491      CONSUMERS ENERGY CO  
1945 W PARNALL RD  
JACKSON, MI 49201

API Well Number: 21-035-13220-00-00

Well Name: MICHIGAN GAS STORAGE CO  
287

Approval Date: 3/28/2019

Location	QT QT QT	Sec	Township	Range	Township Name	County	Feet From Section Line	Feet From DRLG Unit
SL:	CNSWNW	20	20N	6W	WINTERFIELD	CLARE	660 S 660 W	660 S 660 W

Proposed Rework: ACOWS for Miscellaneous

Comment: ACOWS to plugback well to 1335' and return well back to service, expires 3/28/20.

13221      491      CONSUMERS ENERGY CO  
1945 W PARNALL RD  
JACKSON, MI 49201

API Well Number: 21-035-13221-00-00

Well Name: MICHIGAN GAS STORAGE CO  
288

Approval Date: 3/28/2019

Location	QT QT QT	Sec	Township	Range	Township Name	County	Feet From Section Line	Feet From DRLG Unit
SL:	CNSWNW	29	20N	6W	WINTERFIELD	CLARE	660 S 660 W	660 S 660 W

Proposed Rework: ACOWS for Miscellaneous

Comment: ACOWS to plugback well to 1330' and return well back to service, expires 3/28/20.

Michigan Department of Environmental Quality  
Oil, Gas and Minerals Division

Updated Permits

4/8/2019 THRU 4/12/2019



Permit Number      Permittee Number      Permittee Name

Page 14

13248      491      CONSUMERS ENERGY CO  
1945 W PARNALL RD  
JACKSON, MI 49201

API Well Number: 21-035-13248-00-00

Well Name: MICHIGAN GAS STORAGE CO  
292

Approval Date: 3/28/2019

Location	QT QT QT	Sec	Township	Range	Township Name	County	Feet From Section Line	Feet From DRLG Unit
SL:	CNNESW	30	20N	6W	WINTERFIELD	CLARE	660 N 660 E	660 N 660 E

Proposed Rework: ACOWS for Miscellaneous

Comment: ACOWS to plugback well to 1335' and return well back to service, expires 3/28/20.

13251      491      CONSUMERS ENERGY CO  
1945 W PARNALL RD  
JACKSON, MI 49201

API Well Number: 21-035-13251-00-00

Well Name: MGSC 296

Approval Date: 3/28/2019

Location	QT QT QT	Sec	Township	Range	Township Name	County	Feet From Section Line	Feet From DRLG Unit
SL:	CNSENW	34	20N	6W	WINTERFIELD	CLARE	660 S 660 E	660 S 660 E

Proposed Rework: ACOWS for Miscellaneous

Comment: ACOWS to plugback well to 1290' and return well back to service, expires 3/28/20.



Michigan Department of Environmental Quality  
Oil, Gas and Minerals Division

Updated Permits

4/8/2019 THRU 4/12/2019



Permit Number      Permittee Number      Permittee Name

Page 15

13257      491      CONSUMERS ENERGY CO  
1945 W PARNALL RD  
JACKSON, MI 49201

API Well Number: 21-035-13257-00-00

Well Name: MICHIGAN GAS STORAGE CO  
289

Approval Date: 3/28/2019

Location	QT QT QT	Sec	Township	Range	Township Name	County	Feet From Section Line	Feet From DRLG Unit
SL:	CNNWNW	29	20N	6W	WINTERFIELD	CLARE	660 N 760 W	660 N 760 W

Proposed Rework: ACOWS for Miscellaneous

Comment: ACOWS to plugback well to 1332', add perfs, and return well back to service, expires 3/28/20.

13259      491      CONSUMERS ENERGY CO  
1945 W PARNALL RD  
JACKSON, MI 49201

API Well Number: 21-035-13259-00-00

Well Name: MGSC 295

Approval Date: 3/28/2019

Location	QT QT QT	Sec	Township	Range	Township Name	County	Feet From Section Line	Feet From DRLG Unit
SL:	CNSWSW	34	20N	6W	WINTERFIELD	CLARE	660 S 660 W	660 S 660 W

Proposed Rework: ACOWS for Miscellaneous

Comment: ACOWS to plugback well to 1287', add perfs. and return well back to service, expires 3/28/20.

Michigan Department of Environmental Quality  
Oil, Gas and Minerals Division

Updated Permits

4/8/2019 THRU 4/12/2019



Permit Number      Permittee Number      Permittee Name

Page 16

13262      491      CONSUMERS ENERGY CO  
1945 W PARNALL RD  
JACKSON, MI 49201

API Well Number: 21-035-13262-00-00

Well Name: MICHIGAN GAS STORAGE CO  
302

Approval Date: 3/28/2019

Location	QT QT QT	Sec	Township	Range	Township Name	County	Feet From Section Line	Feet From DRLG Unit
SL:	CNSWSE	33	20N	6W	WINTERFIELD	CLARE	660 S 660 W	660 S 660 W

Proposed Rework: ACOWS for Miscellaneous

Comment: ACOWS to plugback well to 1280' and return well back to service, expires 3/28/20.

13322      491      CONSUMERS ENERGY CO  
1945 W PARNALL RD  
JACKSON, MI 49201

API Well Number: 21-035-13322-00-00

Well Name: MICHIGAN GAS STORAGE CO  
309

Approval Date: 3/28/2019

Location	QT QT QT	Sec	Township	Range	Township Name	County	Feet From Section Line	Feet From DRLG Unit
SL:	CNSWSW	29	20N	6W	WINTERFIELD	CLARE	660 S 660 W	660 S 660 W

Proposed Rework: ACOWS for Miscellaneous

Comment: ACOWS to plugback well to 1330', add perfs, and return well back to service, expires 3/28/20.

Michigan Department of Environmental Quality  
Oil, Gas and Minerals Division

Updated Permits

4/8/2019 THRU 4/12/2019



Permit Number      Permittee Number      Permittee Name

Page 17

13323      491      CONSUMERS ENERGY CO  
1945 W PARNALL RD  
JACKSON, MI 49201

API Well Number: 21-035-13323-00-00

Well Name: MICHIGAN GAS STORAGE CO  
310

Approval Date: 3/28/2019

Location	QT QT QT	Sec	Township	Range	Township Name	County	Feet From Section Line	Feet From DRLG Unit
SL:	CNNWSW	29	20N	6W	WINTERFIELD	CLARE	660 N 660 W	660 N 660 W

Proposed Rework: ACOWS for Miscellaneous

Comment: ACOWS to plugback well to 1335' and return well back to service, expires 3/28/20.

13358      491      CONSUMERS ENERGY CO  
1945 W PARNALL RD  
JACKSON, MI 49201

API Well Number: 21-035-13358-00-00

Well Name: MICHIGAN GAS STORAGE CO  
307

Approval Date: 3/28/2019

Location	QT QT QT	Sec	Township	Range	Township Name	County	Feet From Section Line	Feet From DRLG Unit
SL:	CNSESE	29	20N	6W	WINTERFIELD	CLARE	660 S 610 E	660 S 610 E

Proposed Rework: ACOWS for Miscellaneous

Comment: ACOWS to plugback well to 1285', add perfs, and return well back to service, expires 3/28/20.

Michigan Department of Environmental Quality  
Oil, Gas and Minerals Division

Updated Permits

4/8/2019 THRU 4/12/2019



Permit Number      Permittee Number      Permittee Name

Page 18

13359      491      CONSUMERS ENERGY CO  
1945 W PARNALL RD  
JACKSON, MI 49201

API Well Number: 21-035-13359-00-00

Well Name: MICHIGAN GAS STORAGE CO  
311

Approval Date: 3/28/2019

Location	QT QT QT	Sec	Township	Range	Township Name	County	Feet From Section Line	Feet From DRLG Unit
SL:	CNNESW	20	20N	6W	WINTERFIELD	CLARE	660 N 660 E	660 N 660 E

Proposed Rework: ACOWS for Miscellaneous

Comment: ACOWS to plugback well to 1342', add perfs, and return well back to service, expires 3/28/20.

13362      491      CONSUMERS ENERGY CO  
1945 W PARNALL RD  
JACKSON, MI 49201

API Well Number: 21-035-13362-00-00

Well Name: MICHIGAN GAS STORAGE CO  
316

Approval Date: 3/28/2019

Location	QT QT QT	Sec	Township	Range	Township Name	County	Feet From Section Line	Feet From DRLG Unit
SL:	CNSWSW	20	20N	6W	WINTERFIELD	CLARE	660 S 660 W	660 S 660 W

Proposed Rework: ACOWS for Miscellaneous

Comment: ACOWS to plugback well to 1348' and return well back to service, expires 3/28/20.

Michigan Department of Environmental Quality  
Oil, Gas and Minerals Division

Updated Permits

4/8/2019 THRU 4/12/2019



Permit Number      Permittee Number      Permittee Name

Page 19

13363      491      CONSUMERS ENERGY CO  
1945 W PARNALL RD  
JACKSON, MI 49201

API Well Number: 21-035-13363-00-00

Well Name: MICHIGAN GAS STORAGE CO  
319

Approval Date: 3/28/2019

Location	QT QT QT	Sec	Township	Range	Township Name	County	Feet From Section Line	Feet From DRLG Unit
SL:	CNNESE	19	20N	6W	WINTERFIELD	CLARE	660 N 660 E	660 N 660 E

Proposed Rework: ACOWS for Miscellaneous

Comment: ACOWS to plugback well to 1370' and return well back to service, expires 3/28/20.

13387      491      CONSUMERS ENERGY CO  
1945 W PARNALL RD  
JACKSON, MI 49201

API Well Number: 21-035-13387-00-00

Well Name: MICHIGAN GAS STORAGE CO  
313

Approval Date: 3/28/2019

Location	QT QT QT	Sec	Township	Range	Township Name	County	Feet From Section Line	Feet From DRLG Unit
SL:	CNSES	29	20N	6W	WINTERFIELD	CLARE	560 S 660 E	560 S 660 E

Proposed Rework: ACOWS for Miscellaneous

Comment: ACOWS to plugback well to 1310', add perfs and return well back to service, expires 3/28/20.

Michigan Department of Environmental Quality  
Oil, Gas and Minerals Division

Updated Permits

4/8/2019 THRU 4/12/2019



Permit Number      Permittee Number      Permittee Name

Page 20

13388      491      CONSUMERS ENERGY CO  
1945 W PARNALL RD  
JACKSON, MI 49201

API Well Number: 21-035-13388-00-00

Well Name: MICHIGAN GAS STORAGE CO  
314

Approval Date: 3/28/2019

Location	QT QT QT	Sec	Township	Range	Township Name	County	Feet From Section Line	Feet From DRLG Unit
SL:	CNNENW	29	20N	6W	WINTERFIELD	CLARE	600 N 660 E	600 N 660 E

Proposed Rework: ACOWS for Miscellaneous

Comment: ACOWS to plugback well to 1345', add perfs, and return well back to service, expires 3/28/20.

13389      491      CONSUMERS ENERGY CO  
1945 W PARNALL RD  
JACKSON, MI 49201

API Well Number: 21-035-13389-00-00

Well Name: MGSC 317

Approval Date: 3/28/2019

Location	QT QT QT	Sec	Township	Range	Township Name	County	Feet From Section Line	Feet From DRLG Unit
SL:	CNNWSW	20	20N	6W	WINTERFIELD	CLARE	660 N 660 W	660 N 660 W

Proposed Rework: ACOWS for Miscellaneous

Comment: ACOWS to plugback well to 1350' and return well back to service, expires 3/28/20.

Michigan Department of Environmental Quality  
Oil, Gas and Minerals Division

Updated Permits

4/8/2019 THRU 4/12/2019



Permit Number      Permittee Number      Permittee Name

Page 21

13390      491      CONSUMERS ENERGY CO  
1945 W PARNALL RD  
JACKSON, MI 49201

API Well Number: 21-035-13390-00-00

Well Name: MICHIGAN GAS STORAGE CO  
318

Approval Date: 3/29/2019

Location	QT QT QT	Sec	Township	Range	Township Name	County	Feet From Section Line	Feet From DRLG Unit
SL:	CNSESE	19	20N	6W	WINTERFIELD	CLARE	660 S 660 E	660 S 660 E

Proposed Rework: ACOWS for Miscellaneous

Comment: ACOWS to plugback well to 1350' and return well back to service, expires 3/29/20.

13408      491      CONSUMERS ENERGY CO  
1945 W PARNALL RD  
JACKSON, MI 49201

API Well Number: 21-035-13408-00-00

Well Name: MICHIGAN GAS STORAGE CO  
327

Approval Date: 3/29/2019

Location	QT QT QT	Sec	Township	Range	Township Name	County	Feet From Section Line	Feet From DRLG Unit
SL:	CNSWSE	19	20N	6W	WINTERFIELD	CLARE	660 S 660 W	660 S 660 W

Proposed Rework: ACOWS for Miscellaneous

Comment: ACOWS to plugback well to 1375' and return well back to service, expires 3/29/20.

Michigan Department of Environmental Quality  
Oil, Gas and Minerals Division

Updated Permits

4/8/2019 THRU 4/12/2019



Permit Number      Permittee Number      Permittee Name

Page 22

13409      491      CONSUMERS ENERGY CO  
1945 W PARNALL RD  
JACKSON, MI 49201

API Well Number: 21-035-13409-00-00

Well Name: MICHIGAN GAS STORAGE CO  
328

Approval Date: 3/29/2019

Location	QT QT QT	Sec	Township	Range	Township Name	County	Feet From Section Line	Feet From DRLG Unit
SL:	CNSES	19	20N	6W	WINTERFIELD	CLARE	660 S 660 E	660 S 660 E

Proposed Rework: ACOWS for Miscellaneous

Comment: ACOWS to plugback well to 1380' and return well back to service, expires 3/29/20.

13415      491      CONSUMERS ENERGY CO  
1945 W PARNALL RD  
JACKSON, MI 49201

API Well Number: 21-035-13415-00-00

Well Name: MICHIGAN GAS STORAGE CO  
329

Approval Date: 3/29/2019

Location	QT QT QT	Sec	Township	Range	Township Name	County	Feet From Section Line	Feet From DRLG Unit
SL:	CNNENE	30	20N	6W	WINTERFIELD	CLARE	660 N 660 E	660 N 660 E

Proposed Rework: ACOWS for Miscellaneous

Comment: ACOWS to plugback well to 1350' and return well back to service, expires 3/29/20.



Michigan Department of Environmental Quality  
Oil, Gas and Minerals Division

Updated Permits

4/8/2019 THRU 4/12/2019



Permit Number      Permittee Number      Permittee Name

13426      491      CONSUMERS ENERGY CO  
1945 W PARNALL RD  
JACKSON, MI 49201

API Well Number: 21-035-13426-00-00

Well Name: MICHIGAN GAS STORAGE CO  
326

Approval Date: 3/29/2019

Location	QT QT QT	Sec	Township	Range	Township Name	County	Feet From Section Line	Feet From DRLG Unit
SL:	CNSENW	30	20N	6W	WINTERFIELD	CLARE	660 S 660 E	660 S 660 E

Proposed Rework: ACOWS for Miscellaneous

Comment: ACOWS to plugback well to 1330' and return well back to service, expires 3/29/20.

14326      491      CONSUMERS ENERGY CO  
1945 W PARNALL RD  
JACKSON, MI 49201

API Well Number: 21-035-14326-00-00

Well Name: MICHIGAN GAS STORAGE CO  
399

Approval Date: 3/28/2019

Location	QT QT QT	Sec	Township	Range	Township Name	County	Feet From Section Line	Feet From DRLG Unit
SL:	CNSWNW	32	20N	6W	WINTERFIELD	CLARE	660 S 660 W	660 S 660 W

Proposed Rework: ACOWS for Miscellaneous

Comment: ACOWS to plugback well to 1300', add perfs, and return well back to service, expires 3/29/20.

Michigan Department of Environmental Quality  
Oil, Gas and Minerals Division

Updated Permits

4/8/2019 THRU 4/12/2019



Permit Number      Permittee Number      Permittee Name

Page 24

29791      7772      LAMBDA ENERGY RESOURCES LLC  
12012 Wickchester  
Suite 300  
Houston, TX 77055 USA

API Well Number: 21-055-29791-00-00

Well Name: WOLF & OLSZEWSKI 2-17

Approval Date: 4/11/2019

Location	QT QT QT	Sec	Township	Range	Township Name	County	Feet From Section Line	Feet From DRLG Unit
SL:	NWSWNE	17	25N	11W	MAYFIELD	GRAND TRAVERSE	846 S 116 W	468 N 1204 E

Proposed Rework: ACOWS to Continue Drilling - HDH

Comment: ACOWS to drill open lateral HD, expires 4/11/20.

12692      491      CONSUMERS ENERGY CO  
1945 W PARNALL RD  
JACKSON, MI 49201

API Well Number: 21-133-12692-00-00

Well Name: MICHIGAN GAS STORAGE CO  
214

Approval Date: 4/2/2019

Location	QT QT QT	Sec	Township	Range	Township Name	County	Feet From Section Line	Feet From DRLG Unit
SL:	CNSESE	25	20N	7W	MARION	OSCEOLA	660 S 660 E	660 S 660 E

Proposed Rework: ACOWS for Miscellaneous

Comment: ACOWS to plug well back to 1345', underream open hole section, and return well back to service, expires 4/2/20.

Michigan Department of Environmental Quality  
Oil, Gas and Minerals Division

Updated Permits

4/8/2019 THRU 4/12/2019



Permit Number      Permittee Number      Permittee Name

Page 25

13424      491      CONSUMERS ENERGY CO  
1945 W PARNALL RD  
JACKSON, MI 49201

API Well Number: 21-133-13424-00-00

Well Name: MICHIGAN GAS STORAGE CO  
324

Approval Date: 4/2/2019

Location	QT QT QT	Sec	Township	Range	Township Name	County	Feet From Section Line	Feet From DRLG Unit
SL:	CNSENE	25	20N	7W	MARION	OSCEOLA	760 S 660 E	760 S 660 E

Proposed Rework: ACOWS for Miscellaneous

Comment: ACOWS to plug well back to 1350', underream open hole section, and return well back to service, expires 4/2/20.

14176      491      CONSUMERS ENERGY CO  
1945 W PARNALL RD  
JACKSON, MI 49201

API Well Number: 21-133-14176-00-00

Well Name: MICHIGAN GAS STORAGE CO  
381

Approval Date: 4/2/2019

Location	QT QT QT	Sec	Township	Range	Township Name	County	Feet From Section Line	Feet From DRLG Unit
SL:	CNSESE	24	20N	7W	MARION	OSCEOLA	660 S 710 E	660 S 710 E

Proposed Rework: ACOWS for Miscellaneous

Comment: ACOWS to plug well back to 1370', perforate, and return well back to service, expires 4/2/20.

Michigan Department of Environmental Quality  
Oil, Gas and Minerals Division

Updated Permits

4/8/2019 THRU 4/12/2019



Permit Number      Permittee Number      Permittee Name

Page 26

15229      491      CONSUMERS ENERGY CO  
1945 W PARNALL RD  
JACKSON, MI 49201

API Well Number: 21-133-15229-00-00

Well Name: MICH GAS STORAGE 437

Approval Date: 4/2/2019

Location	QT QT QT	Sec	Township	Range	Township Name	County	Feet From Section Line	Feet From DRLG Unit
SL:	CNNENE	1	19N	7W	MIDDLE BRANCH	OSCEOLA	660 N 660 E	660 N 660 E

Proposed Rework: ACOWS for Miscellaneous

Comment: ACOWS to plug well back to 1325', perforate, and return well back to service, expires 4/2/20.

20619      491      CONSUMERS ENERGY CO  
1945 W PARNALL RD  
JACKSON, MI 49201

API Well Number: 21-133-20619-00-00

Well Name: M G S C 905

Approval Date: 4/2/2019

Location	QT QT QT	Sec	Township	Range	Township Name	County	Feet From Section Line	Feet From DRLG Unit
SL:	SENENE	36	20N	7W	MARION	OSCEOLA	1220 N 100 E	1220 N 100 E

Proposed Rework: ACOWS for Miscellaneous

Comment: ACOWS to plug well back to 1330', underream open hole section, and return well back to service, expires 4/2/20.

Michigan Department of Environmental Quality  
Oil, Gas and Minerals Division

Updated Permits

4/8/2019 THRU 4/12/2019



Permit Number      Permittee Number      Permittee Name

Page 27

20648      491      CONSUMERS ENERGY CO  
1945 W PARNALL RD  
JACKSON, MI 49201

API Well Number: 21-133-20648-00-00

Well Name: M G S C 902

Approval Date: 4/2/2019

Location	QT QT QT	Sec	Township	Range	Township Name	County	Feet From Section Line	Feet From DRLG Unit
SL:	SESESE	24	20N	7W	MARION	OSCEOLA	165 S 100 E	165 S 100 E

Proposed Rework: ACOWS for Miscellaneous

Comment: ACOWS to plug well back to 1375', perforate, and return well back to service, expires 4/2/20.



Michigan Department of Environmental Quality  
Oil, Gas and Minerals Division

Updated Permits

4/8/2019 THRU 4/12/2019



Permit Number      Permittee Number      Permittee Name

**RECORD OF CHANGE OF WELL STATUS:**

29537      7772      LAMBDA ENERGY RESOURCES LLC  
12012 Wickchester  
Suite 300  
Houston, TX 77055 USA

API Well Number: 21-101-29537-01-00

Well Name: SEDELMAIER OHAGAN 1-33 HD1      True Vertical Depth:

Change Date: 2/23/2019

Location	QT QT QT	Sec	Township	Range	Township Name	County	Feet From Section Line	Feet From DRLG Unit
SL:		33	23N	15W	BEAR LAKE	MANISTEE	462 N 417 W	
BHL:	SWSENW	28	23N	15W	BEAR LAKE	MANISTEE	2602 N 1381 W	1282 N 1267 E

Proposed Rework: Reworked to Continue Drilling - HDH

Comment: RCOWS documenting well drilling and well completion activities of the HD1 lateral leg.

39750      6042      HARDY AND HARDY CONSULTING  
LLC  
PO BOX 332  
DEWITT, MI 48820

API Well Number: 21-133-39750-00-00

Well Name: BADERSCHNEIDER 1-30      True Vertical Depth:

Change Date: 7/31/2016

Location	QT QT QT	Sec	Township	Range	Township Name	County	Feet From Section Line	Feet From DRLG Unit
SL:	SESENW	30	18N	10W	LINCOLN	OSCEOLA	545 S 474 E	2060 N 2120 W

Proposed Rework: Reworked for Miscellaneous

Comment: RCOWS for setting a cement retainer, and recompleting higher uphole in the Richfield Fmn.