

Michigan Department of Environmental Quality  
 Oil, Gas and Minerals Division  
 PERMIT APPLICATIONS  
 6/18/2018 THRU 6/22/2018

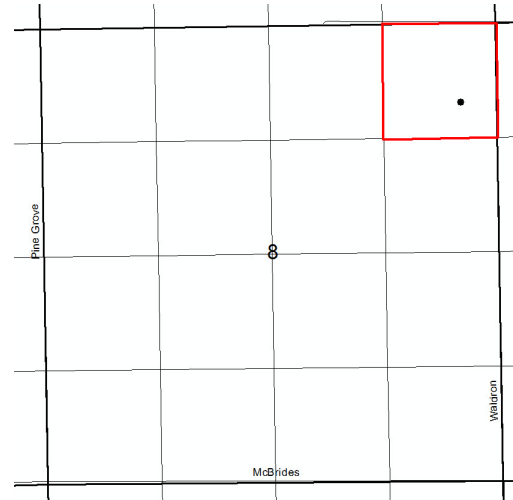

Application Number      Date Received      Permittee Number      Permittee Name      Page 1

211      06/18/2018      6418      W B OSBORN OIL AND GAS OPERATIONS LTD  
 P O BOX 8C  
 1250 N. E. LOOP 410, STE 600  
 SAN ANTONIO, TX 78217



Prev Permit:      Surface Owner: Charles E Furr and Duane L Venton, Trustees  
 Well Name: VENTON TRUST 1-8      True Vertical Depth: 3550  
 Well Type: OIL      Target Formation: DUNDEE  
 Permit Type: Drill      Deepest Formation: DUNDEE  
 H2S Present? Yes

Drilling unit: 40A. NW/4 NW/4 Sec 8.

Location:	QT QT QT	Sec	Township	Range	Township Name	County	Feet From Section Line	Feet From DRLG Unit Line
SL:	SENE	8	11N	5W	FERRIS	MONTCALM	992 N 330 E	992 N 330 E
BHL:	SENE	8	11N	5W	FERRIS	MONTCALM	330 S 330 E	330 S 330 E

Michigan Department of Environmental Quality  
Oil, Gas and Minerals Division  
PERMIT LIST  
6/18/2018 THRU 6/22/2018



Permit Number      Issue Date      Permittee Number      Permittee Name      Page 1

61338      6/18/2018      6418      W B OSBORN OIL AND GAS OPERATIONS LTD  
P O BOX 8C  
1250 N. E. LOOP 410, STE 600  
SAN ANTONIO, TX 78217

API Well No: 21-117-61208-01-00

Prev Permit: 61208

Well Name: WING 1-23A

Well Type: Oil Well

Permit Type: Re-entry

H2S Present? No

Surface Owner: KENNETH D. WING

True Vertical Depth: 2860FT

Target Formation: TRAVERSE LIMESTONE

Deepest Formation: TRAVERSE LIMESTONE

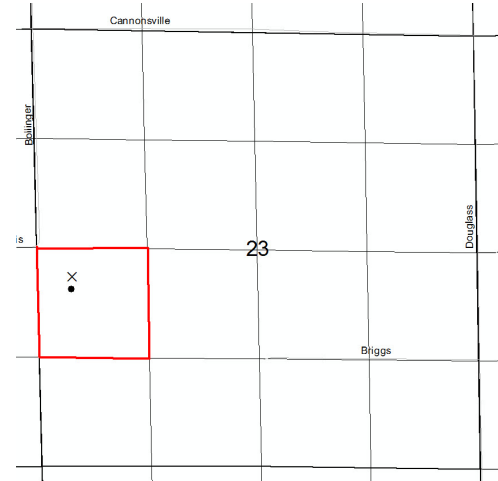

Drilling unit: 40A. NW/4 SW/4 Sec. 23

Location:	QT QT QT	Sec	Township	Range	Township Name	County	Feet From Section Line	Feet From DRLG Unit Line
SL:	NWNWSW	23	11N	5W	FERRIS	MONTCALM	2318 S 430 W	
BHL:	NWNWSW	23	11N	5W	FERRIS	MONTCALM	2218 S 430 W	430 N 430 W

Michigan Department of Environmental Quality  
Oil, Gas and Minerals Division  
Updated Permits  
6/18/2018 THRU 6/22/2018



Permit Number      Permittee Number      Permittee Name

**RECORD OF CHANGE OF WELL STATUS:**

13815                  6371                  BREITBURN OPERATING LIMITED  
PARTNERSHIP  
  
515 S. FLOWER STREET STE 4800  
LOS ANGELES, CA 90071

API Well Number: 21-079-13815-01-00

Well Name: BEAVER CREEK UNIT GARDEN,  
GEORGE "A" 1 HD-INTERSECT

Change Date: 11/10/2017

Location	QT QT QT	Sec	Township	Range	Township Name	County	Feet From Section Line	Feet From DRLG Unit
SL:		12	25N	5W	GARFIELD	KALKASKA	1944 S 987 E	
BHL:	SENWSE	12	25N	5W	GARFIELD	KALKASKA	1410 S 1640 E	3830 N 3672 W

Proposed Rework:                  Reworked to Continue Drilling - HDH

Comment:      RCOWS for HD intersect with PN 41172 wellbore.

Michigan Department of Environmental Quality  
Oil, Gas and Minerals Division  
Updated Permits  
6/18/2018 THRU 6/22/2018



Permit Number      Permittee Number      Permittee Name

**PERMIT TERMINATIONS:**

61121            6564            WYOTEX DRILLING VENTURES LLC  
PO BOX 280969  
5360 SOUTH MARSHALL ST  
LAKEWOOD, CO 80228-0969

API Well Number: 21-055-61121-00-00

Well Name: STATE WHITEWATER 3-34 P

Termination Date: 1/30/2017

Location	QT QT QT	Sec	Township	Range	Township Name	County	Feet From Section Line	Feet From DRLG Unit
SL:	SWSWSW	34	27N	9W	WHITEWATER	GRAND TRAVERSE	386 S 413 W	386 S 413 W

60940            5280            JORDAN DEVELOPMENT COMPANY  
LLC  
1503 GARFIELD RD NORTH  
TRAVERSE CITY, MI 49696

API Well Number: 21-093-60940-00-00

Well Name: STATE GREEN OAK & PLEASANT  
VALLEY 2-3

Termination Date: 4/25/2016

Location	QT QT QT	Sec	Township	Range	Township Name	County	Feet From Section Line	Feet From DRLG Unit
SL:	NWNWNE	3	1N	6E	GREEN OAK	LIVINGSTON	75 N 2205 E	
BHL:	SWSWNE	3	1N	6E	GREEN OAK	LIVINGSTON	2438 N 2198 E	995 N 363 W

Michigan Department of Environmental Quality  
Oil, Gas and Minerals Division  
Updated Permits  
6/18/2018 THRU 6/22/2018



Permit Number      Permittee Number      Permittee Name

61073      6564      WYOTEX DRILLING VENTURES LLC  
PO BOX 280969  
5360 SOUTH MARSHALL ST  
LAKEWOOD, CO 80228-0969

API Well Number: 21-101-61073-00-00

Well Name: STATE MANISTEE & ANDERSON  
1-3 P

Termination Date: 1/30/2017

Location	QT QT QT	Sec	Township	Range	Township Name	County	Feet From Section Line	Feet From DRLG Unit
SL:	SWSWSE	3	22N	16W	MANISTEE	MANISTEE	460 S 2255 E	460 S 330 W

61099      6564      WYOTEX DRILLING VENTURES LLC  
PO BOX 280969  
5360 SOUTH MARSHALL ST  
LAKEWOOD, CO 80228-0969

API Well Number: 21-101-61099-00-00

Well Name: STATE SPRINGDALE 1-26 P

Termination Date: 1/30/2017

Location	QT QT QT	Sec	Township	Range	Township Name	County	Feet From Section Line	Feet From DRLG Unit
SL:	SEENW	26	24N	14W	SPRINGDALE	MANISTEE	943 N 2322 W	372 S 330 E

Michigan Department of Environmental Quality  
Oil, Gas and Minerals Division  
Updated Permits  
6/18/2018 THRU 6/22/2018



Permit Number      Permittee Number      Permittee Name

61101      6564      WYOTEX DRILLING VENTURES LLC  
PO BOX 280969  
5360 SOUTH MARSHALL ST  
LAKEWOOD, CO 80228-0969

API Well Number: 21-101-61101-00-00

Well Name: STATE SPRINGDALE 2-26 P

Termination Date: 1/30/2017

Location	QT QT QT	Sec	Township	Range	Township Name	County	Feet From Section Line	Feet From DRLG Unit
SL:	NENENE	26	24N	14W	SPRINGDALE	MANISTEE	330 N 360 E	330 N 360 E

61144      6564      WYOTEX DRILLING VENTURES LLC  
PO BOX 280969  
5360 SOUTH MARSHALL ST  
LAKEWOOD, CO 80228-0969

API Well Number: 21-101-61144-00-00

Well Name: PCA 17-2 P

Termination Date: 1/30/2017

Location	QT QT QT	Sec	Township	Range	Township Name	County	Feet From Section Line	Feet From DRLG Unit
SL:	NWNWSE	2	23N	15W	BEAR LAKE	MANISTEE	2284 S 2022 E	330 N 620 W

Michigan Department of Environmental Quality  
Oil, Gas and Minerals Division  
Updated Permits  
6/18/2018 THRU 6/22/2018



Permit Number      Permittee Number      Permittee Name

61147      6564      WYOTEX DRILLING VENTURES LLC  
PO BOX 280969  
5360 SOUTH MARSHALL ST  
LAKEWOOD, CO 80228-0969

API Well Number: 21-101-61147-00-00

Well Name: PCA 17-11 P

Termination Date: 10/5/2017

Location	QT QT QT	Sec	Township	Range	Township Name	County	Feet From Section Line	Feet From DRLG Unit
SL:	SWSESE	11	23N	15W	BEAR LAKE	MANISTEE	330 S 675 E	330 S 665 W

61124      5312      PAXTON RESOURCES LLC  
132 N OTSEGO AVE  
GAYLORD, MI 49735

API Well Number: 21-161-61124-00-00

Well Name: FINKBEINER C4-5 P and HD1

Termination Date: 6/19/2018

Location	QT QT QT	Sec	Township	Range	Township Name	County	Feet From Section Line	Feet From DRLG Unit
SL:	NENWNW	9	4S	5E	SALINE	WASHTENAW	355 N 1120 W	
BHL:	SESESE	5	4S	5E	SALINE	WASHTENAW	533 S 112 E	533 S 1148 W

Michigan Department of Environmental Quality  
Oil, Gas and Minerals Division  
Updated Permits  
6/18/2018 THRU 6/22/2018



Permit Number      Permittee Number      Permittee Name

61126      5312      PAXTON RESOURCES LLC  
132 N OTSEGO AVE  
GAYLORD, MI 49735

API Well Number: 21-161-61126-00-00

Well Name: FINKBEINER B4-5 P and HD1

Termination Date: 6/19/2018

Location	QT QT QT	Sec	Township	Range	Township Name	County	Feet From Section Line	Feet From DRLG Unit
SL:	NENWNW	9	4S	5E	SALINE	WASHTENAW	330 N 1120 W	
BHL:	SENWSW	4	4S	5E	SALINE	WASHTENAW	1890 S 921 W	755 N 416 E



Michigan Department of Environmental Quality  
 Oil, Gas and Minerals Division  
 Updated Permits  
 6/18/2018 THRU 6/22/2018



Permit Number      Permittee Number      Permittee Name

**BOTTOM HOLE LOCATION CORRECTIONS:**

13815      6371      BREITBURN OPERATING LIMITED PARTNERSHIP  
 515 S. FLOWER STREET STE 4800  
 LOS ANGELES, CA 90071

API Well Number: 21-079-13815-01-00

Well Name: BEAVER CREEK UNIT GARDEN,  
 GEORGE "A" 1 HD-INTERSECT

Correction Date: 6/20/2018

Location	QT QT QT	Sec	Township	Range	Township Name	County	Feet From Section Line	Feet From DRLG Unit
SL:		12	25N	5W	GARFIELD	KALKASKA	1944 S 987 E	
BHL:	SENWSE	12	25N	5W	GARFIELD	KALKASKA	1410 S 1640 E	3830 N 3672 W

Michigan Department of Environmental Quality  
Oil, Gas and Minerals Division  
Updated Permits  
6/18/2018 THRU 6/22/2018



Permit Number      Permittee Number      Permittee Name

**TRANSFER OF OWNERSHIP:**

8405                      7739                      LAYLINE OIL AND GAS LLC  
820 GESSNER ROAD, SUITE 1145  
HOUSTON, TX 77024 USA

API Well Number: 21-035-08405-00-00

Well Name: THAYER, DELMER L 2

Transfer Date: 6/19/2018

Previous Owner: DART OIL AND GAS CORP

Location	QT QT QT	Sec	Township	Range	Township Name	County	Feet From Section Line	Feet From DRLG Unit
SL:	W2SESW	29	20N	6W	WINTERFIELD	CLARE	660 S 990 E	

10145                      7739                      LAYLINE OIL AND GAS LLC  
820 GESSNER ROAD, SUITE 1145  
HOUSTON, TX 77024 USA

API Well Number: 21-035-10145-00-00

Well Name: MILTNER, HENRY 1

Transfer Date: 6/18/2018

Previous Owner: DART OIL AND GAS CORP

Location	QT QT QT	Sec	Township	Range	Township Name	County	Feet From Section Line	Feet From DRLG Unit
SL:	S2SWSE	1	20N	6W	WINTERFIELD	CLARE	330 S 660 W	330 S 660 E

Michigan Department of Environmental Quality  
Oil, Gas and Minerals Division  
Updated Permits  
6/18/2018 THRU 6/22/2018



Permit Number      Permittee Number      Permittee Name

16747      7739      LAYLINE OIL AND GAS LLC  
820 GESSNER ROAD, SUITE 1145  
HOUSTON, TX 77024 USA

API Well Number: 21-035-16747-00-00  
Well Name: BROCHT FRANK 1  
Transfer Date: 6/18/2018  
Previous Owner: DART OIL AND GAS CORP

Location	QT QT QT	Sec	Township	Range	Township Name	County	Feet From Section Line	Feet From DRLG Unit
SL:	N2NESE	2	20N	6W	WINTERFIELD	CLARE	330 N 660 E	

17348      7739      LAYLINE OIL AND GAS LLC  
820 GESSNER ROAD, SUITE 1145  
HOUSTON, TX 77024 USA

API Well Number: 21-035-17348-00-00  
Well Name: BLANEY 1  
Transfer Date: 6/18/2018  
Previous Owner: DART OIL AND GAS CORP

Location	QT QT QT	Sec	Township	Range	Township Name	County	Feet From Section Line	Feet From DRLG Unit
SL:	SENWNW	12	20N	6W	WINTERFIELD	CLARE	990 N 990 W	330 S 330 E

Michigan Department of Environmental Quality  
Oil, Gas and Minerals Division  
Updated Permits  
6/18/2018 THRU 6/22/2018



Permit Number      Permittee Number      Permittee Name

17373      7739      LAYLINE OIL AND GAS LLC  
820 GESSNER ROAD, SUITE 1145  
HOUSTON, TX 77024 USA

API Well Number: 21-035-17373-00-00

Well Name: TOPE, HARRY 2

Transfer Date: 6/18/2018

Previous Owner: DART OIL AND GAS CORP

Location	QT QT QT	Sec	Township	Range	Township Name	County	Feet From Section Line	Feet From DRLG Unit
SL:	NWSWNE	12	20N	6W	WINTERFIELD	CLARE	990 S 330 W	990 S 330 W

17523      7739      LAYLINE OIL AND GAS LLC  
820 GESSNER ROAD, SUITE 1145  
HOUSTON, TX 77024 USA

API Well Number: 21-035-17523-00-00

Well Name: MILTNER, HENRY ESTATE OF  
ET AL "D" 1

Transfer Date: 6/19/2018

Previous Owner: DART OIL AND GAS CORP

Location	QT QT QT	Sec	Township	Range	Township Name	County	Feet From Section Line	Feet From DRLG Unit
SL:	NWSWSW	1	20N	6W	WINTERFIELD	CLARE	990 S 330 W	330 N 330 W

Michigan Department of Environmental Quality  
Oil, Gas and Minerals Division  
Updated Permits  
6/18/2018 THRU 6/22/2018



Permit Number      Permittee Number      Permittee Name

17729      7739      LAYLINE OIL AND GAS LLC  
820 GESSNER ROAD, SUITE 1145  
HOUSTON, TX 77024 USA

API Well Number: 21-035-17729-00-00  
Well Name: STATE WINTERFIELD 1  
Transfer Date: 6/19/2018  
Previous Owner: DART OIL AND GAS CORP

Location	QT QT QT	Sec	Township	Range	Township Name	County	Feet From Section Line	Feet From DRLG Unit
SL:	NWSEW	12	20N	6W	WINTERFIELD	CLARE	990 S 990 E	330 N 330 W

17737      7739      LAYLINE OIL AND GAS LLC  
820 GESSNER ROAD, SUITE 1145  
HOUSTON, TX 77024 USA

API Well Number: 21-035-17737-00-00  
Well Name: STATE WINTERFIELD A-1  
Transfer Date: 6/19/2018  
Previous Owner: DART OIL AND GAS CORP

Location	QT QT QT	Sec	Township	Range	Township Name	County	Feet From Section Line	Feet From DRLG Unit
SL:	NWSESE	2	20N	6W	WINTERFIELD	CLARE	990 S 990 E	990 S 990 E

Michigan Department of Environmental Quality  
Oil, Gas and Minerals Division  
Updated Permits  
6/18/2018 THRU 6/22/2018



Permit Number      Permittee Number      Permittee Name

31186      7739      LAYLINE OIL AND GAS LLC  
820 GESSNER ROAD, SUITE 1145  
HOUSTON, TX 77024 USA

API Well Number: 21-035-22684-01-00  
Well Name: BENCHLEY, ELMER R &  
VIRGINIA M 1-29  
Transfer Date: 6/19/2018  
Previous Owner: DART OIL AND GAS CORP

Location	QT QT QT	Sec	Township	Range	Township Name	County	Feet From Section Line	Feet From DRLG Unit
SL:	SENWNW	29	20N	6W	WINTERFIELD	CLARE	990 N 990 W	330 S 330 E

27451      7739      LAYLINE OIL AND GAS LLC  
820 GESSNER ROAD, SUITE 1145  
HOUSTON, TX 77024 USA

API Well Number: 21-035-27451-00-00  
Well Name: JACKSON & MOSHER 7-30  
Transfer Date: 6/19/2018  
Previous Owner: DART OIL AND GAS CORP

Location	QT QT QT	Sec	Township	Range	Township Name	County	Feet From Section Line	Feet From DRLG Unit
SL:	E2SESW	30	20N	6W	WINTERFIELD	CLARE	710 S 330 E	710 S 330 E

Michigan Department of Environmental Quality  
Oil, Gas and Minerals Division  
Updated Permits  
6/18/2018 THRU 6/22/2018



Permit Number      Permittee Number      Permittee Name

27530      7739      LAYLINE OIL AND GAS LLC  
820 GESSNER ROAD, SUITE 1145  
HOUSTON, TX 77024 USA

API Well Number: 21-035-27530-00-00

Well Name: BENCHLEY, ELMER R &  
HOTCHKISS, WM P ET AL 1

Transfer Date: 6/19/2018

Previous Owner: DART OIL AND GAS CORP

Location	QT QT QT	Sec	Township	Range	Township Name	County	Feet From Section Line	Feet From DRLG Unit
SL:	E2NENW	31	20N	6W	WINTERFIELD	CLARE	660 N 330 E	660 N 330 E

27575      7739      LAYLINE OIL AND GAS LLC  
820 GESSNER ROAD, SUITE 1145  
HOUSTON, TX 77024 USA

API Well Number: 21-035-27575-00-00

Well Name: MOSHER ET AL 5-30

Transfer Date: 6/19/2018

Previous Owner: DART OIL AND GAS CORP

Location	QT QT QT	Sec	Township	Range	Township Name	County	Feet From Section Line	Feet From DRLG Unit
SL:	E2NESW	30	20N	6W	WINTERFIELD	CLARE	780 N 370 E	780 N 370 E

Michigan Department of Environmental Quality  
Oil, Gas and Minerals Division  
Updated Permits  
6/18/2018 THRU 6/22/2018



Permit Number      Permittee Number      Permittee Name

37480      7739      LAYLINE OIL AND GAS LLC  
820 GESSNER ROAD, SUITE 1145  
HOUSTON, TX 77024 USA

API Well Number: 21-035-37480-00-00

Well Name: SNEARY 4-31

Transfer Date: 6/18/2018

Previous Owner: DART OIL AND GAS CORP

Location	QT QT QT	Sec	Township	Range	Township Name	County	Feet From Section Line	Feet From DRLG Unit
SL:	SESESE	31	20N	6W	WINTERFIELD	CLARE	545 S 485 E	545 S 485 E

37719      7739      LAYLINE OIL AND GAS LLC  
820 GESSNER ROAD, SUITE 1145  
HOUSTON, TX 77024 USA

API Well Number: 21-035-37719-00-00

Well Name: STATE FEDERAL 1-6

Transfer Date: 6/18/2018

Previous Owner: DART OIL AND GAS CORP

Location	QT QT QT	Sec	Township	Range	Township Name	County	Feet From Section Line	Feet From DRLG Unit
SL:	SEWNE	6	19N	6W	REDDING	CLARE	780 N 945 W	542 S 330 E