

Michigan Department of Environmental Quality
 Oil, Gas and Minerals Division
 PERMIT LIST
 6/25/2018 THRU 6/29/2018



Permit Number Issue Date Permittee Number Permittee Name Page 1

61339 6/29/2018 104

WEST BAY EXPLORATION
 COMPANY

13685 S WEST BAYSHORE DR
 TRAVERSE CITY, MI 49684

API Well No: 21-035-62006-00-00

Prev Permit:

Surface Owner: Gregory L. Arnold
 Living Trust

Well Name: STATE GRANT & ARNOLD 1-
 22

True Vertical Depth: 4150FT

Well Type: Oil Well

Target Formation: DUNDEE

Permit Type: Drill

Deepest Formation: DUNDEE

H2S Present? Yes

Drilling unit: 160A R 303 voluntary pooling. SW/4 SW/4
 Sec. 14, SE/4 SE/4 Sec. 15, NE/4 NE/4 Sec. 22, and
 NW/4 NW/4 Sec. 23.

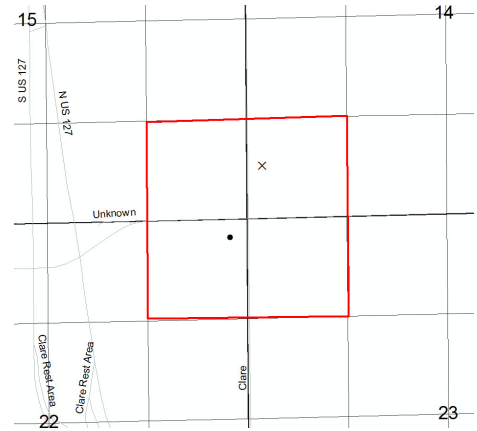

Location:	QT QT QT	Sec	Township	Range	Township Name	County	Feet From Section Line	Feet From DRLG Unit Line
SL:	NWSWSW	14	17N	4W	GRANT	CLARE	684 S 318 W	
BHL:	NENENE	22	17N	4W	GRANT	CLARE	235 N 270 E	1086 S 1056 W

Michigan Department of Environmental Quality
Oil, Gas and Minerals Division
Updated Permits
6/25/2018 THRU 6/29/2018



Permit Number Permittee Number Permittee Name

PLUGGING INSTRUCTIONS ISSUED:

50238 6361 RIVERSIDE ENERGY MICHIGAN LLC
10691 EAST CARTER ROAD
SUITE 201
TRAVERSE CITY, MI 49684

API Well Number: 21-009-50238-00-00

Well Name: STATE WARNER & KERLY A2-11

Plug Inst. Issue Date: 6/11/2018

Location	QT QT QT	Sec	Township	Range	Township Name	County	Feet From Section Line	Feet From DRLG Unit
SL:	SWNENW	11	31N	5W	WARNER	ANTRIM	800 N 920 E	520 S 400 W

Comment: App. to P&A (for brine disposal portion of well), expires 6/11/19.

60276 6361 RIVERSIDE ENERGY MICHIGAN LLC
10691 EAST CARTER ROAD
SUITE 201
TRAVERSE CITY, MI 49684

API Well Number: 21-009-60276-00-00

Well Name: WONDERLAND B2-29

Plug Inst. Issue Date: 6/13/2018

Location	QT QT QT	Sec	Township	Range	Township Name	County	Feet From Section Line	Feet From DRLG Unit
SL:	SESENW	29	30N	7W	KEARNEY	ANTRIM	2531 N 2280 W	1192 N 364 E
BHL:	SWSESW	29	30N	7W	KEARNEY	ANTRIM	532 S 1776 W	532 S 453 W

Comment: App. to P&A expires 6/13/19.

Michigan Department of Environmental Quality
Oil, Gas and Minerals Division
Updated Permits
6/25/2018 THRU 6/29/2018



Permit Number Permittee Number Permittee Name

48775 6361 RIVERSIDE ENERGY MICHIGAN LLC
10691 EAST CARTER ROAD
SUITE 201
TRAVERSE CITY, MI 49684

API Well Number: 21-029-48775-00-00

Well Name: KORTHASE B1-31

Plug Inst. Issue Date: 6/13/2018

Location	QT QT QT	Sec	Township	Range	Township Name	County	Feet From Section Line	Feet From DRLG Unit
SL:	SWSWNW	31	32N	5W	BOYNE VALLEY	CHARLEVOIX	334 S 334 W	334 S 334 W

Comment: App. to P&A expires 6/13/19.

50996 6361 RIVERSIDE ENERGY MICHIGAN LLC
10691 EAST CARTER ROAD
SUITE 201
TRAVERSE CITY, MI 49684

API Well Number: 21-029-50996-00-00

Well Name: KORTHASE B3-36

Plug Inst. Issue Date: 6/13/2018

Location	QT QT QT	Sec	Township	Range	Township Name	County	Feet From Section Line	Feet From DRLG Unit
SL:	SWSWNE	36	32N	6W	WILSON	CHARLEVOIX	370 S 600 W	370 S 600 W

Comment: App. to P&A expires 6/13/19.

Michigan Department of Environmental Quality
Oil, Gas and Minerals Division
Updated Permits
6/25/2018 THRU 6/29/2018



Permit Number Permittee Number Permittee Name

50997 6361 RIVERSIDE ENERGY MICHIGAN LLC
10691 EAST CARTER ROAD
SUITE 201
TRAVERSE CITY, MI 49684

API Well Number: 21-029-50997-00-00

Well Name: KORTHASE B2-36

Plug Inst. Issue Date: 6/13/2018

Location	QT QT QT	Sec	Township	Range	Township Name	County	Feet From Section Line	Feet From DRLG Unit
SL:	NESEW	36	32N	6W	WILSON	CHARLEVOIX	1063 S 588 E	1063 S 588 E

Comment: App. to P&A expires 6/13/19.

51467 6361 RIVERSIDE ENERGY MICHIGAN LLC
10691 EAST CARTER ROAD
SUITE 201
TRAVERSE CITY, MI 49684

API Well Number: 21-029-51467-00-00

Well Name: KORTHASE D1-31

Plug Inst. Issue Date: 6/13/2018

Location	QT QT QT	Sec	Township	Range	Township Name	County	Feet From Section Line	Feet From DRLG Unit
SL:	NWSWSW	31	32N	5W	BOYNE VALLEY	CHARLEVOIX	750 S 450 W	750 S 450 W

Comment: App. to P&A expires 6/13/19.

Michigan Department of Environmental Quality
Oil, Gas and Minerals Division
Updated Permits
6/25/2018 THRU 6/29/2018



Permit Number Permittee Number Permittee Name

51473 6361 RIVERSIDE ENERGY MICHIGAN LLC
10691 EAST CARTER ROAD
SUITE 201
TRAVERSE CITY, MI 49684

API Well Number: 21-029-51473-00-00

Well Name: KORTHASE A3-31

Plug Inst. Issue Date: 6/13/2018

Location	QT QT QT	Sec	Township	Range	Township Name	County	Feet From Section Line	Feet From DRLG Unit
SL:	NWNWNE	31	32N	5W	BOYNE VALLEY	CHARLEVOIX	535 N 550 W	535 N 550 W

Comment: App. to P&A expires 6/13/19.

51474 6361 RIVERSIDE ENERGY MICHIGAN LLC
10691 EAST CARTER ROAD
SUITE 201
TRAVERSE CITY, MI 49684

API Well Number: 21-029-51474-00-00

Well Name: MATELSKI A4-35

Plug Inst. Issue Date: 6/13/2018

Location	QT QT QT	Sec	Township	Range	Township Name	County	Feet From Section Line	Feet From DRLG Unit
SL:	NENENE	35	32N	6W	WILSON	CHARLEVOIX	350 N 376 E	350 N 376 E

Comment: App. to P&A expires 6/13/19.

Michigan Department of Environmental Quality
Oil, Gas and Minerals Division
Updated Permits
6/25/2018 THRU 6/29/2018



Permit Number Permittee Number Permittee Name

51494 6361 RIVERSIDE ENERGY MICHIGAN LLC
10691 EAST CARTER ROAD
SUITE 201
TRAVERSE CITY, MI 49684

API Well Number: 21-029-51494-00-00

Well Name: MARVIN D2-35

Plug Inst. Issue Date: 6/13/2018

Location	QT QT QT	Sec	Township	Range	Township Name	County	Feet From Section Line	Feet From DRLG Unit
SL:	NWSEW	35	32N	6W	WILSON	CHARLEVOIX	700 S 920 E	620 N 920 E

Comment: App. to P&A expires 6/13/19.

51579 6361 RIVERSIDE ENERGY MICHIGAN LLC
10691 EAST CARTER ROAD
SUITE 201
TRAVERSE CITY, MI 49684

API Well Number: 21-029-51579-00-00

Well Name: BRANNON & DARBEE D3-36

Plug Inst. Issue Date: 6/13/2018

Location	QT QT QT	Sec	Township	Range	Township Name	County	Feet From Section Line	Feet From DRLG Unit
SL:	SESWE	36	32N	6W	WILSON	CHARLEVOIX	500 S 770 W	500 S 550 E

Comment: App. to P&A expires 6/13/19.

Michigan Department of Environmental Quality
Oil, Gas and Minerals Division
Updated Permits
6/25/2018 THRU 6/29/2018



Permit Number Permittee Number Permittee Name

51685 6361 RIVERSIDE ENERGY MICHIGAN LLC
10691 EAST CARTER ROAD
SUITE 201
TRAVERSE CITY, MI 49684

API Well Number: 21-029-51685-00-00

Well Name: DARBEE & BRANNON C1-36

Plug Inst. Issue Date: 6/13/2018

Location	QT QT QT	Sec	Township	Range	Township Name	County	Feet From Section Line	Feet From DRLG Unit
SL:	SWNWSW	36	32N	6W	WILSON	CHARLEVOIX	700 N 600 W	620 S 600 W

Comment: App. to P&A expires 6/13/19.

51686 6361 RIVERSIDE ENERGY MICHIGAN LLC
10691 EAST CARTER ROAD
SUITE 201
TRAVERSE CITY, MI 49684

API Well Number: 21-029-51686-00-00

Well Name: DARBEE & BRANNON 1-36 SWD

Plug Inst. Issue Date: 6/13/2018

Location	QT QT QT	Sec	Township	Range	Township Name	County	Feet From Section Line	Feet From DRLG Unit
SL:	SWNWSW	36	32N	6W	WILSON	CHARLEVOIX	740 N 600 W	

Comment: App. to P&A expires 6/13/19.

Michigan Department of Environmental Quality
Oil, Gas and Minerals Division
Updated Permits
6/25/2018 THRU 6/29/2018



Permit Number Permittee Number Permittee Name

51687 6361 RIVERSIDE ENERGY MICHIGAN LLC
10691 EAST CARTER ROAD
SUITE 201
TRAVERSE CITY, MI 49684

API Well Number: 21-029-51687-00-00

Well Name: PATTON B1-35

Plug Inst. Issue Date: 6/13/2018

Location	QT QT QT	Sec	Township	Range	Township Name	County	Feet From Section Line	Feet From DRLG Unit
SL:	NESWNW	35	32N	6W	WILSON	CHARLEVOIX	670 S 1140 W	650 N 1140 W

Comment: App. to P&A expires 6/13/19.

51690 6361 RIVERSIDE ENERGY MICHIGAN LLC
10691 EAST CARTER ROAD
SUITE 201
TRAVERSE CITY, MI 49684

API Well Number: 21-029-51690-00-00

Well Name: FIEMA C3-35

Plug Inst. Issue Date: 6/13/2018

Location	QT QT QT	Sec	Township	Range	Township Name	County	Feet From Section Line	Feet From DRLG Unit
SL:	SWNWSE	35	32N	6W	WILSON	CHARLEVOIX	1125 N 335 W	1125 N 335 W

Comment: App. to P&A expires 6/13/19.

Michigan Department of Environmental Quality
Oil, Gas and Minerals Division
Updated Permits
6/25/2018 THRU 6/29/2018



Permit Number Permittee Number Permittee Name

32498 6352 CHRISTIAN OIL CO INC
2589 30TH STREET
ALLEGAN, MI 49010

API Well Number: 21-073-32498-00-00

Well Name: MAIN 1

Plug Inst. Issue Date: 6/20/2018

Location	QT QT QT	Sec	Township	Range	Township Name	County	Feet From Section Line	Feet From DRLG Unit
SL:	SWSWNE	24	13N	6W	ROLLAND	ISABELLA	330 S 330 W	330 S 330 W

Comment: App. to P&A expires 6/20/19.

48459 5512 MERIT ENERGY CO
13727 NOEL RD, STE 1200
DALLAS, TX 75240

API Well Number: 21-079-48038-01-00

Well Name: STATE BLUE LAKE ET AL 1-14A True Vertical Depth: 7324

Plug Inst. Issue Date: 6/18/2018

Location	QT QT QT	Sec	Township	Range	Township Name	County	Feet From Section Line	Feet From DRLG Unit
SL:	SESWSW	14	28N	5W	BLUE LAKE	KALKASKA	330 S 1020 W	
BHL:	SESWSW	14	28N	5W	BLUE LAKE	KALKASKA	28 S 1073 W	1292 N 1073 W

Comment: App. to P&A expires 6/18/19.

Michigan Department of Environmental Quality
Oil, Gas and Minerals Division
Updated Permits
6/25/2018 THRU 6/29/2018



Permit Number Permittee Number Permittee Name

29980 5512 MERIT ENERGY CO
13727 NOEL RD, STE 1200
DALLAS, TX 75240

API Well Number: 21-101-29980-00-00
Well Name: STATE MANISTEE & RYDER 1-24
Plug Inst. Issue Date: 6/27/2018

Location	QT QT QT	Sec	Township	Range	Township Name	County	Feet From Section Line	Feet From DRLG Unit
SL:	CNE2SW	24	22N	16W	MANISTEE	MANISTEE	1250 N 860 E	1250 N 460 W

Comment: App. to P&A expires 6/27/19.

30613 5512 MERIT ENERGY CO
13727 NOEL RD, STE 1200
DALLAS, TX 75240

API Well Number: 21-101-30613-00-00
Well Name: RECKOW ET AL 2-25
Plug Inst. Issue Date: 6/18/2018

Location	QT QT QT	Sec	Township	Range	Township Name	County	Feet From Section Line	Feet From DRLG Unit
SL:	SESWNW	25	23N	15W	BEAR LAKE	MANISTEE	643 S 756 W	643 S 555 E

Comment: App. to P&A expires 12/05/18.

Michigan Department of Environmental Quality
Oil, Gas and Minerals Division
Updated Permits
6/25/2018 THRU 6/29/2018



Permit Number Permittee Number Permittee Name

28587 6501 MARYSVILLE HYDROCARBONS LLC

2510 BUSHA HWY.
MARYSVILLE, MI 48040

API Well Number: 21-147-28587-00-00

Well Name: FB 7006W

True Vertical Depth:

Plug Inst. Issue Date: 6/20/2018

Location	QT QT QT	Sec	Township	Range	Township Name	County	Feet From Section Line	Feet From DRLG Unit
SL:	NWNWNW	7	5N	17E	SAINT CLAIR	SAINT CLAIR	230 N 250 W	230 N 250 W

Comment: App. to P&A expires 6/19/19.

Michigan Department of Environmental Quality
Oil, Gas and Minerals Division
Updated Permits
6/25/2018 THRU 6/29/2018



Permit Number Permittee Number Permittee Name

RECORD OF WELL PLUGGING:

49110 4745 BELDEN AND BLAKE CORP DBA
WARD LAKE ENERGY

685 EAST M-32 SUITE 201
GAYLORD, MI 49735

API Well Number: 21-009-49110-00-00

Well Name: KITCHEN C1-17

Plugging Date: 5/21/2018

Location	QT QT QT	Sec	Township	Range	Township Name	County	Feet From Section Line	Feet From DRLG Unit
SL:	SWNWSW	17	29N	5W	MANCELONA	ANTRIM	990 N 330 W	330 S 330 W

49111 4745 BELDEN AND BLAKE CORP DBA
WARD LAKE ENERGY

685 EAST M-32 SUITE 201
GAYLORD, MI 49735

API Well Number: 21-009-49111-00-00

Well Name: KITCHEN A4-17

Plugging Date: 5/22/2018

Location	QT QT QT	Sec	Township	Range	Township Name	County	Feet From Section Line	Feet From DRLG Unit
SL:	NENENE	17	29N	5W	MANCELONA	ANTRIM	330 N 330 E	330 N 330 E

Michigan Department of Environmental Quality
Oil, Gas and Minerals Division
Updated Permits
6/25/2018 THRU 6/29/2018



Permit Number Permittee Number Permittee Name

49113 4745 BELDEN AND BLAKE CORP DBA
WARD LAKE ENERGY
685 EAST M-32 SUITE 201
GAYLORD, MI 49735

API Well Number: 21-009-49113-00-00

Well Name: KITCHEN A1-17

Plugging Date: 6/6/2018

Location	QT QT QT	Sec	Township	Range	Township Name	County	Feet From Section Line	Feet From DRLG Unit
SL:	NWNWNW	17	29N	5W	MANCELONA	ANTRIM	330 N 330 W	330 N 330 W

49114 4745 BELDEN AND BLAKE CORP DBA
WARD LAKE ENERGY
685 EAST M-32 SUITE 201
GAYLORD, MI 49735

API Well Number: 21-009-49114-00-00

Well Name: KITCHEN D3-8

Plugging Date: 5/21/2018

Location	QT QT QT	Sec	Township	Range	Township Name	County	Feet From Section Line	Feet From DRLG Unit
SL:	NWSWSE	8	29N	5W	MANCELONA	ANTRIM	986 S 330 W	330 N 330 W

Michigan Department of Environmental Quality
Oil, Gas and Minerals Division
Updated Permits
6/25/2018 THRU 6/29/2018



Permit Number Permittee Number Permittee Name

49115 4745 BELDEN AND BLAKE CORP DBA
WARD LAKE ENERGY

685 EAST M-32 SUITE 201
GAYLORD, MI 49735

API Well Number: 21-009-49115-00-00

Well Name: KITCHEN B1-17

Plugging Date: 5/22/2018

Location	QT QT QT	Sec	Township	Range	Township Name	County	Feet From Section Line	Feet From DRLG Unit
SL:	SWSWNW	17	29N	5W	MANCELONA	ANTRIM	330 S 330 W	330 S 330 W

49116 4745 BELDEN AND BLAKE CORP DBA
WARD LAKE ENERGY

685 EAST M-32 SUITE 201
GAYLORD, MI 49735

API Well Number: 21-009-49116-00-00

Well Name: KITCHEN C4-17

Plugging Date: 6/1/2018

Location	QT QT QT	Sec	Township	Range	Township Name	County	Feet From Section Line	Feet From DRLG Unit
SL:	SENESE	17	29N	5W	MANCELONA	ANTRIM	660 N 340 E	645 S 340 E

Michigan Department of Environmental Quality
Oil, Gas and Minerals Division
Updated Permits
6/25/2018 THRU 6/29/2018



Permit Number Permittee Number Permittee Name

49170 4745 BELDEN AND BLAKE CORP DBA
WARD LAKE ENERGY

685 EAST M-32 SUITE 201
GAYLORD, MI 49735

API Well Number: 21-009-49170-00-00

Well Name: KITCHEN C3-17

Plugging Date: 5/29/2018

Location	QT QT QT	Sec	Township	Range	Township Name	County	Feet From Section Line	Feet From DRLG Unit
SL:	NWNWSE	17	29N	5W	MANCELONA	ANTRIM	628 N 484 W	628 N 484 W

49179 4745 BELDEN AND BLAKE CORP DBA
WARD LAKE ENERGY

685 EAST M-32 SUITE 201
GAYLORD, MI 49735

API Well Number: 21-009-49179-00-00

Well Name: KITCHEN A3-17

Plugging Date: 5/22/2018

Location	QT QT QT	Sec	Township	Range	Township Name	County	Feet From Section Line	Feet From DRLG Unit
SL:	NWNWNE	17	29N	5W	MANCELONA	ANTRIM	330 N 330 W	330 N 330 W

Michigan Department of Environmental Quality
Oil, Gas and Minerals Division
Updated Permits
6/25/2018 THRU 6/29/2018



Permit Number Permittee Number Permittee Name

60137 6361 RIVERSIDE ENERGY MICHIGAN LLC
10691 EAST CARTER ROAD
SUITE 201
TRAVERSE CITY, MI 49684

API Well Number: 21-009-60137-00-00

Well Name: STATE MANCELONA 1-28

Plugging Date: 6/13/2018

Location	QT QT QT	Sec	Township	Range	Township Name	County	Feet From Section Line	Feet From DRLG Unit
SL:	NWNENW	28	29N	5W	MANCELONA	ANTRIM	330 N 1885 W	330 N 574 W

61243 70 TRENDWELL ENERGY CORPORATION
10 E BRIDGE ST STE 200
PO BOX 560
ROCKFORD, MI 49341

API Well Number: 21-051-62010-00-00

Well Name: WEAVER 14-17

Plugging Date: 6/15/2018

Location	QT QT QT	Sec	Township	Range	Township Name	County	Feet From Section Line	Feet From DRLG Unit
SL:	SENESEW	17	19N	1W	GLADWIN	GLADWIN	1486 S 2378 W	
BHL:	SWSESEW	17	19N	1W	GLADWIN	GLADWIN	169 S 1655 W	1163 N 347 W

Michigan Department of Environmental Quality
Oil, Gas and Minerals Division
Updated Permits
6/25/2018 THRU 6/29/2018



Permit Number Permittee Number Permittee Name

38365 6312 ARBOR OPERATING LLC
104 S UNION STREET SUITE 202
TRAVERSE CITY, MI 49684

API Well Number: 21-055-38365-00-00

Well Name: STATE UNION 1-19

Plugging Date: 5/15/2018

Location	QT QT QT	Sec	Township	Range	Township Name	County	Feet From Section Line	Feet From DRLG Unit
SL:	SWNWNE	19	26N	9W	UNION	GRAND TRAVERSE	1319 N 1 W	1319 N 1321 E

58779 5320 SAVOY ENERGY LP
920 HASTINGS STREET, SUITE A
PO BOX 1560
TRAVERSE CITY, MI 49685-1560

API Well Number: 21-059-58779-00-00

Well Name: CLARK 1-36

Plugging Date: 5/10/2018

Location	QT QT QT	Sec	Township	Range	Township Name	County	Feet From Section Line	Feet From DRLG Unit
SL:	NESENW	36	6S	2W	ADAMS	HILLSDALE	1718 N 2312 W	394 N 330 E

Michigan Department of Environmental Quality
Oil, Gas and Minerals Division
Updated Permits
6/25/2018 THRU 6/29/2018



Permit Number Permittee Number Permittee Name

10639 47 SUMMIT PETROLEUM CORP
1315 S MISSION RD
PO BOX 365
MOUNT PLEASANT, MI 48804-0365

API Well Number: 21-073-10639-00-00

Well Name: METHNER, OTTO 1-B

Plugging Date: 10/9/2015

Location	QT QT QT	Sec	Township	Range	Township Name	County	Feet From Section Line	Feet From DRLG Unit
SL:	NWSENW	33	16N	3W	WISE	ISABELLA	990 S 990 E	330 N 330 W

39131 47 SUMMIT PETROLEUM CORP
1315 S MISSION RD
PO BOX 365
MOUNT PLEASANT, MI 48804-0365

API Well Number: 21-111-39131-00-00

Well Name: SIEBERT 1-1

Plugging Date: 11/30/2015

Location	QT QT QT	Sec	Township	Range	Township Name	County	Feet From Section Line	Feet From DRLG Unit
SL:	SEENW	1	14N	2E	MIDLAND	MIDLAND	638 N 330 E	330 S 330 E

Michigan Department of Environmental Quality
Oil, Gas and Minerals Division
Updated Permits
6/25/2018 THRU 6/29/2018



Permit Number Permittee Number Permittee Name

42678 6371 BREITBURN OPERATING LIMITED PARTNERSHIP
515 S. FLOWER STREET STE 4800
LOS ANGELES, CA 90071

API Well Number: 21-137-42678-00-00

Well Name: STATE CHARLTON 6-8

Plugging Date: 10/2/2017

Location	QT QT QT	Sec	Township	Range	Township Name	County	Feet From Section Line	Feet From DRLG Unit
SL:	NWSENE	8	29N	1W	CHARLTON	OTSEGO	800 S 760 E	516 N 574 W

42678 6371 BREITBURN OPERATING LIMITED PARTNERSHIP
1111 BAGBY STREET, SUITE 1600
HOUSTON, TX 77002

API Well Number: 21-137-42678-00-00

Well Name: STATE CHARLTON 6-8

Plugging Date: 10/2/2017

Location	QT QT QT	Sec	Township	Range	Township Name	County	Feet From Section Line	Feet From DRLG Unit
SL:	NWSENE	8	29N	1W	CHARLTON	OTSEGO	800 S 760 E	516 N 574 W

Michigan Department of Environmental Quality
Oil, Gas and Minerals Division
Updated Permits
6/25/2018 THRU 6/29/2018



Permit Number Permittee Number Permittee Name

47802 5995 WHITING OIL AND GAS CORP
MILE HIGH CENTER
1700 BROADWAY STE 2300
DENVER, CO 80290-2300

API Well Number: 21-141-40808-03-00

Well Name: STATE ALLIS 2-26A

True Vertical Depth: 3586

Plugging Date: 6/14/2018

Location	QT QT QT	Sec	Township	Range	Township Name	County	Feet From Section Line	Feet From DRLG Unit
SL:	SWNE	26	34N	2E	ALLIS	PRESQUE ISLE	1270 N 831 E	
BHL:	NESWNE	26	34N	2E	ALLIS	PRESQUE ISLE	504 S 1188 W	504 S 1188 W

49448 5995 WHITING OIL AND GAS CORP
MILE HIGH CENTER
1700 BROADWAY STE 2300
DENVER, CO 80290-2300

API Well Number: 21-141-48036-02-00

Well Name: STATE ALLIS 3-26B HD

True Vertical Depth: 3465

Plugging Date: 6/14/2018

Location	QT QT QT	Sec	Township	Range	Township Name	County	Feet From Section Line	Feet From DRLG Unit
SL:	NENWSE	26	34N	2E	ALLIS	PRESQUE ISLE	496 N 973 W	
BHL:	SWSENE	26	34N	2E	ALLIS	PRESQUE ISLE	611 S 875 E	681 N 875 E

Michigan Department of Environmental Quality
Oil, Gas and Minerals Division
Updated Permits
6/25/2018 THRU 6/29/2018



Permit Number Permittee Number Permittee Name

51446 5995 WHITING OIL AND GAS CORP
MILE HIGH CENTER
1700 BROADWAY STE 2300
DENVER, CO 80290-2300

API Well Number: 21-141-50703-04-00

Well Name: STATE ALLIS & FALCON 1-34A True Vertical Depth: 3491
HD3

Plugging Date: 6/14/2018

Location	QT QT QT	Sec	Township	Range	Township Name	County	Feet From Section Line	Feet From DRLG Unit
SL:	SWSWNE	34	34N	2E	ALLIS	PRESQUE ISLE	2435 N 2172 E	
BHL:	SWNWNE	34	34N	2E	ALLIS	PRESQUE ISLE	712 N 2132 E	712 N 825 E

54686 5995 WHITING OIL AND GAS CORP
MILE HIGH CENTER
1700 BROADWAY STE 2300
DENVER, CO 80290-2300

API Well Number: 21-141-54686-00-00

Well Name: STATE ALLIS ET AL 1-36 HD1 True Vertical Depth: 3606

Plugging Date: 6/14/2018

Location	QT QT QT	Sec	Township	Range	Township Name	County	Feet From Section Line	Feet From DRLG Unit
SL:	SESESE	36	34N	2E	ALLIS	PRESQUE ISLE	198 S 550 E	
BHL:	SWNESE	36	34N	2E	ALLIS	PRESQUE ISLE	1840 S 1034 E	810 N 1034 E

Michigan Department of Environmental Quality
Oil, Gas and Minerals Division
Updated Permits
6/25/2018 THRU 6/29/2018



Permit Number Permittee Number Permittee Name

APPLICATIONS TO CHANGE WELL STATUS:

12991 491 CONSUMERS ENERGY CO

1945 W PARNALL RD
JACKSON, MI 49201

API Well Number: 21-035-12991-00-00
Well Name: MICHIGAN GAS STORAGE CO
244

Approval Date: 6/13/2018

Location	QT QT QT	Sec	Township	Range	Township Name	County	Feet From Section Line	Feet From DRLG Unit
SL:	CNNENW	17	20N	5W	SUMMERFIELD	CLARE	660 N 660 E	660 N 660 E

Proposed Rework: ACOWS for Miscellaneous Comment: ACOWS to install and cement 5 1/2" csg./liner string inside 8 5/8" production string. Expires 6/13/19.

13086 491 CONSUMERS ENERGY CO

1945 W PARNALL RD
JACKSON, MI 49201

API Well Number: 21-035-13086-00-00
Well Name: MICHIGAN GAS STORAGE CO
256

Approval Date: 6/13/2018

Location	QT QT QT	Sec	Township	Range	Township Name	County	Feet From Section Line	Feet From DRLG Unit
SL:	CNNWSW	16	20N	5W	SUMMERFIELD	CLARE	660 N 760 W	660 N 560 E

Proposed Rework: ACOWS for Miscellaneous Comment: ACOWS to install and cement 5 1/2" csg./liner string inside 8 5/8" production string. Expires 6/13/19.

Michigan Department of Environmental Quality
Oil, Gas and Minerals Division
Updated Permits
6/25/2018 THRU 6/29/2018



Permit Number Permittee Number Permittee Name

13092 491 CONSUMERS ENERGY CO
1945 W PARNALL RD
JACKSON, MI 49201

API Well Number: 21-035-13092-00-00

Well Name: MICHIGAN GAS STORAGE CO
265

Approval Date: 6/13/2018

Location	QT QT QT	Sec	Township	Range	Township Name	County	Feet From Section Line	Feet From DRLG Unit
SL:	CNSENE	3	20N	6W	WINTERFIELD	CLARE	660 S 660 E	660 S 660 E

Proposed Rework: ACOWS for Miscellaneous

Comment: ACOWS to install and cement 5 1/2" csg./liner string inside 8 5/8" production string. Expires 6/13/19.

13099 491 CONSUMERS ENERGY CO
1945 W PARNALL RD
JACKSON, MI 49201

API Well Number: 21-035-13099-00-00

Well Name: MICHIGAN GAS STORAGE CO
263

Approval Date: 6/13/2018

Location	QT QT QT	Sec	Township	Range	Township Name	County	Feet From Section Line	Feet From DRLG Unit
SL:	CNSWNE	2	20N	6W	WINTERFIELD	CLARE	660 S 660 W	660 S 660 W

Proposed Rework: ACOWS for Miscellaneous

Comment: ACOWS to install and cement 5 1/2" csg./liner string inside 8 5/8" production string. Expires 6/13/19.

Michigan Department of Environmental Quality
Oil, Gas and Minerals Division
Updated Permits
6/25/2018 THRU 6/29/2018



Permit Number Permittee Number Permittee Name

13994 491 CONSUMERS ENERGY CO

1945 W PARNALL RD
JACKSON, MI 49201

API Well Number: 21-035-13994-00-00

Well Name: MICHIGAN GAS STORAGE
COMPANY 354

Approval Date: 6/13/2018

Location	QT QT QT	Sec	Township	Range	Township Name	County	Feet From Section Line	Feet From DRLG Unit
SL:	CNSESE	1	20N	6W	WINTERFIELD	CLARE	660 S 660 E	660 S 660 E

Proposed Rework: ACOWS for Miscellaneous

Comment: ACOWS to install and cement 5 1/2" csg./liner string inside 8 5/8" production string. Expires 6/13/19.

Michigan Department of Environmental Quality
Oil, Gas and Minerals Division
Updated Permits
6/25/2018 THRU 6/29/2018



Permit Number Permittee Number Permittee Name

PERMIT TERMINATIONS:

60940 5280 JORDAN DEVELOPMENT COMPANY
LLC

1503 GARFIELD RD NORTH
TRAVERSE CITY, MI 49696

API Well Number: 21-093-60940-00-00

Well Name: STATE GREEN OAK & PLEASANT
VALLEY 2-3

Termination Date: 6/27/2018

Location	QT QT QT	Sec	Township	Range	Township Name	County	Feet From Section Line	Feet From DRLG Unit
SL:	NWNWNE	3	1N	6E	GREEN OAK	LIVINGSTON	75 N 2205 E	
BHL:	SWSWNE	3	1N	6E	GREEN OAK	LIVINGSTON	2438 N 2198 E	995 N 363 W

Michigan Department of Environmental Quality
Oil, Gas and Minerals Division
Updated Permits
6/25/2018 THRU 6/29/2018



Permit Number Permittee Number Permittee Name

TRANSFER OF OWNERSHIP:

17739 7739 LAYLINE OIL AND GAS LLC
820 GESSNER ROAD, SUITE 1145
HOUSTON, TX 77024 USA

API Well Number: 21-035-17739-00-00

Well Name: TOPE, HARRY 3

Transfer Date: 6/25/2018

Previous Owner: DART OIL AND GAS CORP

Location	QT QT QT	Sec	Township	Range	Township Name	County	Feet From Section Line	Feet From DRLG Unit
SL:	SEWNW	12	20N	6W	WINTERFIELD	CLARE	990 N 990 W	990 N 330 E

17772 7739 LAYLINE OIL AND GAS LLC
820 GESSNER ROAD, SUITE 1145
HOUSTON, TX 77024 USA

API Well Number: 21-035-17772-00-00

Well Name: STATE WINTERFIELD 2

Transfer Date: 6/25/2018

Previous Owner: DART OIL AND GAS CORP

Location	QT QT QT	Sec	Township	Range	Township Name	County	Feet From Section Line	Feet From DRLG Unit
SL:	SENE	12	20N	6W	WINTERFIELD	CLARE	990 N 330 E	330 S 330 E

Michigan Department of Environmental Quality
Oil, Gas and Minerals Division
Updated Permits
6/25/2018 THRU 6/29/2018



Permit Number Permittee Number Permittee Name

17876 7739 LAYLINE OIL AND GAS LLC
820 GESSNER ROAD, SUITE 1145
HOUSTON, TX 77024 USA

API Well Number: 21-035-17876-00-00
Well Name: BONNINGHAUSEN, A 1
Transfer Date: 6/25/2018
Previous Owner: DART OIL AND GAS CORP

Location	QT QT QT	Sec	Township	Range	Township Name	County	Feet From Section Line	Feet From DRLG Unit
SL:	NWSWSE	2	20N	6W	WINTERFIELD	CLARE	990 S 330 W	990 S 330 W

17915 7739 LAYLINE OIL AND GAS LLC
820 GESSNER ROAD, SUITE 1145
HOUSTON, TX 77024 USA

API Well Number: 21-035-17915-00-00
Well Name: STATE WINTERFIELD 1
Transfer Date: 6/25/2018
Previous Owner: DART OIL AND GAS CORP

Location	QT QT QT	Sec	Township	Range	Township Name	County	Feet From Section Line	Feet From DRLG Unit
SL:	NWSWNW	12	20N	6W	WINTERFIELD	CLARE	990 S 330 W	330 N 330 W

Michigan Department of Environmental Quality
Oil, Gas and Minerals Division
Updated Permits
6/25/2018 THRU 6/29/2018



Permit Number Permittee Number Permittee Name

18303 7739 LAYLINE OIL AND GAS LLC
820 GESSNER ROAD, SUITE 1145
HOUSTON, TX 77024 USA

API Well Number: 21-035-18303-00-00

Well Name: THROOP, A 1

Transfer Date: 6/25/2018

Previous Owner: DART OIL AND GAS CORP

Location	QT QT QT	Sec	Township	Range	Township Name	County	Feet From Section Line	Feet From DRLG Unit
SL:	NWNE	11	20N	6W	WINTERFIELD	CLARE	330 N 990 E	330 N 990 E

31596 7739 LAYLINE OIL AND GAS LLC
820 GESSNER ROAD, SUITE 1145
HOUSTON, TX 77024 USA

API Well Number: 21-035-31596-00-00

Well Name: MOSHER, ALLIE L 1-30

Transfer Date: 6/26/2018

Previous Owner: DART OIL AND GAS CORP

Location	QT QT QT	Sec	Township	Range	Township Name	County	Feet From Section Line	Feet From DRLG Unit
SL:	E2SENE	30	20N	6W	WINTERFIELD	CLARE	660 S 330 E	660 N 330 E

Michigan Department of Environmental Quality
Oil, Gas and Minerals Division
Updated Permits
6/25/2018 THRU 6/29/2018



Permit Number Permittee Number Permittee Name

31654 7739 LAYLINE OIL AND GAS LLC
820 GESSNER ROAD, SUITE 1145
HOUSTON, TX 77024 USA

API Well Number: 21-035-31654-00-00
Well Name: BLANEY (CRANBERRY LAKE RICHFIELD UNIT) 2-12
Transfer Date: 6/26/2018
Previous Owner: DART OIL AND GAS CORP

Location	QT QT QT	Sec	Township	Range	Township Name	County	Feet From Section Line	Feet From DRLG Unit
SL:	NWNWNW	12	20N	6W	WINTERFIELD	CLARE	200 N 100 W	

31697 7739 LAYLINE OIL AND GAS LLC
820 GESSNER ROAD, SUITE 1145
HOUSTON, TX 77024 USA

API Well Number: 21-035-31697-00-00
Well Name: JOHNSON, GERALD L & ELAINE 3-30
Transfer Date: 6/26/2018
Previous Owner: DART OIL AND GAS CORP

Location	QT QT QT	Sec	Township	Range	Township Name	County	Feet From Section Line	Feet From DRLG Unit
SL:	E2NESE	30	20N	6W	WINTERFIELD	CLARE	460 N 530 E	460 N 530 E

Michigan Department of Environmental Quality
Oil, Gas and Minerals Division
Updated Permits
6/25/2018 THRU 6/29/2018



Permit Number Permittee Number Permittee Name

31698 7739 LAYLINE OIL AND GAS LLC
820 GESSNER ROAD, SUITE 1145
HOUSTON, TX 77024 USA

API Well Number: 21-035-31698-00-00

Well Name: BENCHLEY 2-29

Transfer Date: 6/27/2018

Previous Owner: DART OIL AND GAS CORP

Location	QT QT QT	Sec	Township	Range	Township Name	County	Feet From Section Line	Feet From DRLG Unit
SL:	E2SWNW	29	20N	6W	WINTERFIELD	CLARE	660 S 990 W	660 S 330 E

32227 7739 LAYLINE OIL AND GAS LLC
820 GESSNER ROAD, SUITE 1145
HOUSTON, TX 77024 USA

API Well Number: 21-035-32227-00-00

Well Name: BENCHLEY 3-29

Transfer Date: 6/26/2018

Previous Owner: DART OIL AND GAS CORP

Location	QT QT QT	Sec	Township	Range	Township Name	County	Feet From Section Line	Feet From DRLG Unit
SL:	E2SENE	29	20N	6W	WINTERFIELD	CLARE	655 S 530 E	655 S 530 E

Michigan Department of Environmental Quality
 Oil, Gas and Minerals Division
 Updated Permits
 6/25/2018 THRU 6/29/2018



Permit Number Permittee Number Permittee Name

32296 7739 LAYLINE OIL AND GAS LLC
 820 GESSNER ROAD, SUITE 1145
 HOUSTON, TX 77024 USA

API Well Number: 21-035-32296-00-00
 Well Name: BLACKLEDGE, RICHARD W AND THORA J 4-29
 Transfer Date: 6/26/2018
 Previous Owner: DART OIL AND GAS CORP

Location	QT QT QT	Sec	Township	Range	Township Name	County	Feet From Section Line	Feet From DRLG Unit
SL:	SEENW	29	20N	6W	WINTERFIELD	CLARE	660 N 480 E	655 S 480 E

32297 7739 LAYLINE OIL AND GAS LLC
 820 GESSNER ROAD, SUITE 1145
 HOUSTON, TX 77024 USA

API Well Number: 21-035-32297-00-00
 Well Name: MOSHER, ALLIE L 2-30
 Transfer Date: 6/26/2018
 Previous Owner: DART OIL AND GAS CORP

Location	QT QT QT	Sec	Township	Range	Township Name	County	Feet From Section Line	Feet From DRLG Unit
SL:	NENENE	30	20N	6W	WINTERFIELD	CLARE	660 N 485 E	660 N 485 E

Michigan Department of Environmental Quality
Oil, Gas and Minerals Division
Updated Permits
6/25/2018 THRU 6/29/2018



Permit Number Permittee Number Permittee Name

32334 7739 LAYLINE OIL AND GAS LLC
820 GESSNER ROAD, SUITE 1145
HOUSTON, TX 77024 USA

API Well Number: 21-035-32334-00-00
Well Name: BLACKLEDGE, E 1-19
Transfer Date: 6/26/2018
Previous Owner: DART OIL AND GAS CORP

Location	QT QT QT	Sec	Township	Range	Township Name	County	Feet From Section Line	Feet From DRLG Unit
SL:	SESESE	19	20N	6W	WINTERFIELD	CLARE	460 S 330 E	460 S 330 E

32372 7739 LAYLINE OIL AND GAS LLC
820 GESSNER ROAD, SUITE 1145
HOUSTON, TX 77024 USA

API Well Number: 21-035-32372-00-00
Well Name: BLACKLEDGE, RICHARD 4-30
Transfer Date: 6/26/2018
Previous Owner: DART OIL AND GAS CORP

Location	QT QT QT	Sec	Township	Range	Township Name	County	Feet From Section Line	Feet From DRLG Unit
SL:	NENWNE	30	20N	6W	WINTERFIELD	CLARE	585 N 982 W	585 N 330 E

Michigan Department of Environmental Quality
Oil, Gas and Minerals Division
Updated Permits
6/25/2018 THRU 6/29/2018



Permit Number Permittee Number Permittee Name

32384 7739 LAYLINE OIL AND GAS LLC
820 GESSNER ROAD, SUITE 1145
HOUSTON, TX 77024 USA

API Well Number: 21-035-32384-00-00

Well Name: BEULAH JUNE 5-29

Transfer Date: 6/26/2018

Previous Owner: DART OIL AND GAS CORP

Location	QT QT QT	Sec	Township	Range	Township Name	County	Feet From Section Line	Feet From DRLG Unit
SL:	NESWNE	29	20N	6W	WINTERFIELD	CLARE	712 S 983 W	600 N 330 E

32385 7739 LAYLINE OIL AND GAS LLC
820 GESSNER ROAD, SUITE 1145
HOUSTON, TX 77024 USA

API Well Number: 21-035-32385-00-00

Well Name: BRAY, DALE ET AL 1-30

Transfer Date: 6/26/2018

Previous Owner: DART OIL AND GAS CORP

Location	QT QT QT	Sec	Township	Range	Township Name	County	Feet From Section Line	Feet From DRLG Unit
SL:	NESWNE	30	20N	6W	WINTERFIELD	CLARE	753 S 969 W	553 N 330 E

Michigan Department of Environmental Quality
Oil, Gas and Minerals Division
Updated Permits
6/25/2018 THRU 6/29/2018



Permit Number Permittee Number Permittee Name

32392 7739 LAYLINE OIL AND GAS LLC
820 GESSNER ROAD, SUITE 1145
HOUSTON, TX 77024 USA

API Well Number: 21-035-32392-00-00
Well Name: BRAY, DALE L ET AL 2-30
Transfer Date: 6/26/2018
Previous Owner: DART OIL AND GAS CORP

Location	QT QT QT	Sec	Township	Range	Township Name	County	Feet From Section Line	Feet From DRLG Unit
SL:	SESENW	30	20N	6W	WINTERFIELD	CLARE	553 S 330 E	553 S 330 E

32477 7739 LAYLINE OIL AND GAS LLC
820 GESSNER ROAD, SUITE 1145
HOUSTON, TX 77024 USA

API Well Number: 21-035-32477-00-00
Well Name: EGTS, HUGH DESMOND 7-29
Transfer Date: 6/26/2018
Previous Owner: DART OIL AND GAS CORP

Location	QT QT QT	Sec	Township	Range	Township Name	County	Feet From Section Line	Feet From DRLG Unit
SL:	SENWSW	29	20N	6W	WINTERFIELD	CLARE	800 N 907 W	511 S 408 E

Michigan Department of Environmental Quality
Oil, Gas and Minerals Division
Updated Permits
6/25/2018 THRU 6/29/2018



Permit Number Permittee Number Permittee Name

32880 7739 LAYLINE OIL AND GAS LLC
820 GESSNER ROAD, SUITE 1145
HOUSTON, TX 77024 USA

API Well Number: 21-035-32880-00-00

Well Name: BENCHLEY 1-31

Transfer Date: 6/26/2018

Previous Owner: DART OIL AND GAS CORP

Location	QT QT QT	Sec	Township	Range	Township Name	County	Feet From Section Line	Feet From DRLG Unit
SL:	E2NENE	31	20N	6W	WINTERFIELD	CLARE	660 N 330 E	655 S 330 E

32890 7739 LAYLINE OIL AND GAS LLC
820 GESSNER ROAD, SUITE 1145
HOUSTON, TX 77024 USA

API Well Number: 21-035-32890-00-00

Well Name: BENCHLEY "A" 2-31

Transfer Date: 6/26/2018

Previous Owner: DART OIL AND GAS CORP

Location	QT QT QT	Sec	Township	Range	Township Name	County	Feet From Section Line	Feet From DRLG Unit
SL:	NENWNE	31	20N	6W	WINTERFIELD	CLARE	545 N 949 W	545 N 353 E

Michigan Department of Environmental Quality
Oil, Gas and Minerals Division
Updated Permits
6/25/2018 THRU 6/29/2018



Permit Number Permittee Number Permittee Name

32902 7739 LAYLINE OIL AND GAS LLC
820 GESSNER ROAD, SUITE 1145
HOUSTON, TX 77024 USA

API Well Number: 21-035-32902-00-00
Well Name: BARHITTE, FAY E 6-30
Transfer Date: 6/26/2018
Previous Owner: DART OIL AND GAS CORP

Location	QT QT QT	Sec	Township	Range	Township Name	County	Feet From Section Line	Feet From DRLG Unit
SL:	SENWSE	30	20N	6W	WINTERFIELD	CLARE	680 N 976 W	640 S 330 E

32966 7739 LAYLINE OIL AND GAS LLC
820 GESSNER ROAD, SUITE 1145
HOUSTON, TX 77024 USA

API Well Number: 21-035-32966-00-00
Well Name: FOX, JOE 2-32
Transfer Date: 6/26/2018
Previous Owner: DART OIL AND GAS CORP

Location	QT QT QT	Sec	Township	Range	Township Name	County	Feet From Section Line	Feet From DRLG Unit
SL:	SENWNW	32	20N	6W	WINTERFIELD	CLARE	765 N 870 W	549 S 441 E

Michigan Department of Environmental Quality
Oil, Gas and Minerals Division
Updated Permits
6/25/2018 THRU 6/29/2018



Permit Number Permittee Number Permittee Name

32971 7739 LAYLINE OIL AND GAS LLC
820 GESSNER ROAD, SUITE 1145
HOUSTON, TX 77024 USA

API Well Number: 21-035-32971-00-00

Well Name: FOX, JOE 3-32

Transfer Date: 6/26/2018

Previous Owner: DART OIL AND GAS CORP

Location	QT QT QT	Sec	Township	Range	Township Name	County	Feet From Section Line	Feet From DRLG Unit
SL:	NESWNW	32	20N	6W	WINTERFIELD	CLARE	810 S 978 W	504 N 330 E

32991 7739 LAYLINE OIL AND GAS LLC
820 GESSNER ROAD, SUITE 1145
HOUSTON, TX 77024 USA

API Well Number: 21-035-32991-00-00

Well Name: D L THAYER 9

Transfer Date: 6/26/2018

Previous Owner: DART OIL AND GAS CORP

Location	QT QT QT	Sec	Township	Range	Township Name	County	Feet From Section Line	Feet From DRLG Unit
SL:	NWSESW	29	20N	6W	WINTERFIELD	CLARE	890 S 760 E	430 N 560 W

Michigan Department of Environmental Quality
Oil, Gas and Minerals Division
Updated Permits
6/25/2018 THRU 6/29/2018



Permit Number Permittee Number Permittee Name

32992 7739 LAYLINE OIL AND GAS LLC
820 GESSNER ROAD, SUITE 1145
HOUSTON, TX 77024 USA

API Well Number: 21-035-32992-00-00

Well Name: BENCHLEY 3-31

Transfer Date: 6/26/2018

Previous Owner: DART OIL AND GAS CORP

Location	QT QT QT	Sec	Township	Range	Township Name	County	Feet From Section Line	Feet From DRLG Unit
SL:	E2SENE	31	20N	6W	WINTERFIELD	CLARE	655 S 330 E	655 S 330 E

33011 7739 LAYLINE OIL AND GAS LLC
820 GESSNER ROAD, SUITE 1145
HOUSTON, TX 77024 USA

API Well Number: 21-035-33011-00-00

Well Name: BENCHLEY "A" 4-31

Transfer Date: 6/26/2018

Previous Owner: DART OIL AND GAS CORP

Location	QT QT QT	Sec	Township	Range	Township Name	County	Feet From Section Line	Feet From DRLG Unit
SL:	NESWNE	31	20N	6W	WINTERFIELD	CLARE	970 S 940 W	345 N 355 E

Michigan Department of Environmental Quality
Oil, Gas and Minerals Division
Updated Permits
6/25/2018 THRU 6/29/2018



Permit Number Permittee Number Permittee Name

33467 7739 LAYLINE OIL AND GAS LLC
820 GESSNER ROAD, SUITE 1145
HOUSTON, TX 77024 USA

API Well Number: 21-035-33467-00-00
Well Name: MOSHER, ROLAND 8-30
Transfer Date: 6/26/2018
Previous Owner: DART OIL AND GAS CORP

Location	QT QT QT	Sec	Township	Range	Township Name	County	Feet From Section Line	Feet From DRLG Unit
SL:	SESWSE	30	20N	6W	WINTERFIELD	CLARE	610 S 977 W	610 S 330 E

33492 7739 LAYLINE OIL AND GAS LLC
820 GESSNER ROAD, SUITE 1145
HOUSTON, TX 77024 USA

API Well Number: 21-035-33492-00-00
Well Name: WINTERFIELD SWD 8-29 True Vertical Depth:
Transfer Date: 6/26/2018
Previous Owner: DART OIL AND GAS CORP

Location	QT QT QT	Sec	Township	Range	Township Name	County	Feet From Section Line	Feet From DRLG Unit
SL:	SESWNW	29	20N	6W	WINTERFIELD	CLARE	384 S 665 W	

Michigan Department of Environmental Quality
Oil, Gas and Minerals Division
Updated Permits
6/25/2018 THRU 6/29/2018



Permit Number Permittee Number Permittee Name

33508 7739 LAYLINE OIL AND GAS LLC
820 GESSNER ROAD, SUITE 1145
HOUSTON, TX 77024 USA

API Well Number: 21-035-33508-00-00

Well Name: STATE A 2

Transfer Date: 6/26/2018

Previous Owner: DART OIL AND GAS CORP

Location	QT QT QT	Sec	Township	Range	Township Name	County	Feet From Section Line	Feet From DRLG Unit
SL:	SWSESE	2	20N	6W	WINTERFIELD	CLARE	330 S 990 E	

33633 7739 LAYLINE OIL AND GAS LLC
820 GESSNER ROAD, SUITE 1145
HOUSTON, TX 77024 USA

API Well Number: 21-035-33633-00-00

Well Name: CALVERT ET AL 2-31

Transfer Date: 6/26/2018

Previous Owner: DART OIL AND GAS CORP

Location	QT QT QT	Sec	Township	Range	Township Name	County	Feet From Section Line	Feet From DRLG Unit
SL:	NESENW	31	20N	6W	WINTERFIELD	CLARE	660 S 330 E	654 N 330 E

Michigan Department of Environmental Quality
Oil, Gas and Minerals Division
Updated Permits
6/25/2018 THRU 6/29/2018



Permit Number Permittee Number Permittee Name

00390 7739 LAYLINE OIL AND GAS LLC
820 GESSNER ROAD, SUITE 1145
HOUSTON, TX 77024 USA

API Well Number: 21-035-33680-70-00
Well Name: Winterfield Deep Unit "A" 1
Transfer Date: 6/26/2018
Previous Owner: DART OIL AND GAS CORP

Location	QT QT QT	Sec	Township	Range	Township Name	County	Feet From Section Line	Feet From DRLG Unit
SL:	NESENW	30	20N	6W	WINTERFIELD	CLARE	847 S 520 E	

34370 7739 LAYLINE OIL AND GAS LLC
820 GESSNER ROAD, SUITE 1145
HOUSTON, TX 77024 USA

API Well Number: 21-035-34370-00-00
Well Name: BLACKLEDGE, DAN 1-20 True Vertical Depth:
Transfer Date: 6/25/2018
Previous Owner: DART OIL AND GAS CORP

Location	QT QT QT	Sec	Township	Range	Township Name	County	Feet From Section Line	Feet From DRLG Unit
SL:	NESESW	20	20N	6W	WINTERFIELD	CLARE	660 S 370 E	650 N 370 E

Michigan Department of Environmental Quality
Oil, Gas and Minerals Division
Updated Permits
6/25/2018 THRU 6/29/2018



Permit Number Permittee Number Permittee Name

36333 7739 LAYLINE OIL AND GAS LLC
820 GESSNER ROAD, SUITE 1145
HOUSTON, TX 77024 USA

API Well Number: 21-035-36333-00-00

Well Name: LAUGHLIN 2-20

Transfer Date: 6/25/2018

Previous Owner: DART OIL AND GAS CORP

Location	QT QT QT	Sec	Township	Range	Township Name	County	Feet From Section Line	Feet From DRLG Unit
SL:	SENWSW	20	20N	6W	WINTERFIELD	CLARE	742 N 980 W	570 S 330 E

36565 7739 LAYLINE OIL AND GAS LLC
820 GESSNER ROAD, SUITE 1145
HOUSTON, TX 77024 USA

API Well Number: 21-035-36565-00-00

Well Name: AUSTIN 3-31

Transfer Date: 6/25/2018

Previous Owner: DART OIL AND GAS CORP

Location	QT QT QT	Sec	Township	Range	Township Name	County	Feet From Section Line	Feet From DRLG Unit
SL:	CNNESE	31	20N	6W	WINTERFIELD	CLARE	660 N 330 E	656 S 330 E

Michigan Department of Environmental Quality
Oil, Gas and Minerals Division
Updated Permits
6/25/2018 THRU 6/29/2018



Permit Number Permittee Number Permittee Name

36751 7739 LAYLINE OIL AND GAS LLC
820 GESSNER ROAD, SUITE 1145
HOUSTON, TX 77024 USA

API Well Number: 21-035-36751-00-00

Well Name: BASS 3-33

Transfer Date: 6/25/2018

Previous Owner: DART OIL AND GAS CORP

Location	QT QT QT	Sec	Township	Range	Township Name	County	Feet From Section Line	Feet From DRLG Unit
SL:	E2SWNW	33	20N	6W	WINTERFIELD	CLARE	595 S 971 W	595 S 330 E

37369 7739 LAYLINE OIL AND GAS LLC
820 GESSNER ROAD, SUITE 1145
HOUSTON, TX 77024 USA

API Well Number: 21-035-37369-00-00

Well Name: BWAB MARION 33-22-1

Transfer Date: 6/25/2018

Previous Owner: DART OIL AND GAS CORP

Location	QT QT QT	Sec	Township	Range	Township Name	County	Feet From Section Line	Feet From DRLG Unit
SL:	SWSENW	33	20N	6W	WINTERFIELD	CLARE	569 S 973 E	569 S 321 E