

Michigan Department of Environmental Quality  
Oil, Gas and Minerals Division  
PERMIT APPLICATIONS  
7/9/2018 THRU 7/13/2018

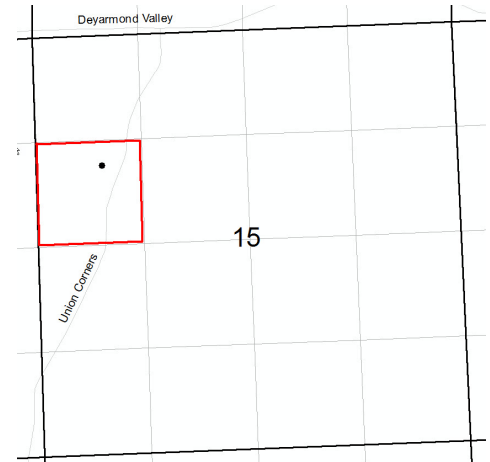

Application Number                      Date Received                      Permittee Number                      Permittee Name                      Page 1

220                      07/09/2018                      5512                      MERIT ENERGY CO  
13727 NOEL RD, STE 1200  
DALLAS, TX 75240



Prev Permit: 61084                      Surface Owner: USDA-Manistee National Forest  
Well Name: U.S.A. BIG CREEK 3-15                      True Vertical Depth: 4400

Well Type: OIL                      Target Formation: RICHFIELD  
Permit Type: Drill                      Deepest Formation: AMHERSTBURG  
H2S Present? Yes

Drilling Unit: 40A SW/4 NW/4 Sec.15.Re-permit of timed out PN54227/61084, re-application of withdrawn APD42

Location:	QT QT QT	Sec	Township	Range	Township Name	County	Feet From Section Line	Feet From DRLG Unit Line
SL:	NESWNW	15	25N	2E	BIG CREEK	OSCODA	1642 N 829 W	
BHL:	NESWNW	15	25N	2E	BIG CREEK	OSCODA	1642 N 829 W	330 N 495 E

221                      07/09/2018                      5512                      MERIT ENERGY CO  
13727 NOEL RD, STE 1200  
DALLAS, TX 75240

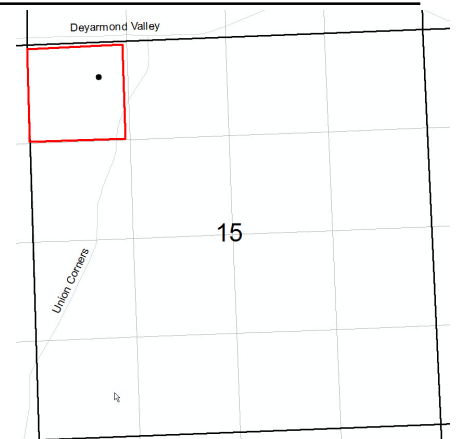

Prev Permit: 61085                      Surface Owner: USDA-Manistee National Forest  
Well Name: U.S.A. BIG CREEK 4-15                      True Vertical Depth: 4400

Well Type: OIL                      Target Formation: RICHFIELD  
Permit Type: Drill                      Deepest Formation: AMHERSTBURG  
H2S Present? Yes

Drilling Unit: 40A NW/4 NW/4 Sec.15.Re-permit of timed out PN54228/61085, re-application of withdrawn APD43

Location:	QT QT QT	Sec	Township	Range	Township Name	County	Feet From Section Line	Feet From DRLG Unit Line
SL:	NENWNW	15	25N	2E	BIG CREEK	OSCODA	471 N 944 W	
BHL:	NENWNW	15	25N	2E	BIG CREEK	OSCODA	471 N 944 W	471 N 380 E

Michigan Department of Environmental Quality  
Oil, Gas and Minerals Division  
PERMIT APPLICATIONS  
7/9/2018 THRU 7/13/2018



Application Number                      Date Received                      Permittee Number                      Permittee Name                      Page 2

222                      07/09/2018                      5512                      MERIT ENERGY CO  
13727 NOEL RD, STE 1200  
DALLAS, TX 75240

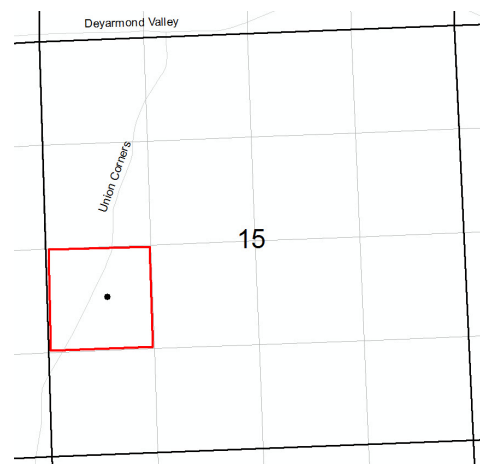

Prev Permit: 61091                      Surface Owner: USDA-Manistee  
National Forest  
Well Name: U.S.A. BIG CREEK 5-15                      True Vertical Depth: 4400

Well Type: OIL                      Target Formation: RICHFIELD  
Permit Type: Drill                      Deepest Formation: AMHERSTBURG  
H2S Present? Yes

Drilling Unit: 40A NW/4 SW/4 Sec.15.Re-permit of timed  
out PN54229/61091, re-application of withdrawn APD45

Location:	QT QT QT	Sec	Township	Range	Township Name	County	Feet From Section Line	Feet From DRLG Unit Line
SL:	NENWSW	15	25N	2E	BIG CREEK	OSCODA	2002 S 767 W	
BHL:	NENWSW	15	25N	2E	BIG CREEK	OSCODA	2002 N 767 W	622 N 558 E

224                      07/13/2018                      7716                      MAVERICK BROTHERS RESOURCES LLC  
PO BOX 392  
ENID, OK 73703

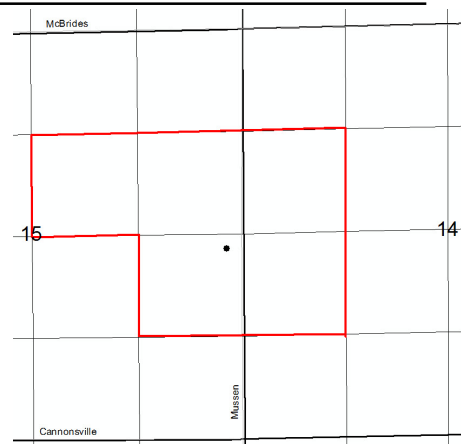

Prev Permit:                      Surface Owner: David and Elizabeth  
Wickes  
Well Name: WICKES TRUST 1-15                      True Vertical Depth: 3600

Well Type: OIL                      Target Formation: DUNDEE  
Permit Type: Drill                      Deepest Formation: DUNDEE

Drilling Unit: 200A R303 Vol Pool request. S/2 NE/4,  
NE/4 SE/4 Sec.15 & SW/4 NW/4, NW/4 SW/4 Sec. 14

Location:	QT QT QT	Sec	Township	Range	Township Name	County	Feet From Section Line	Feet From DRLG Unit Line
SL:	NENESE	15	11N	7W	DOUGLASS	MONTCALM	2490 S 174 E	
BHL:	NENESE	15	11N	7W	DOUGLASS	MONTCALM	2490 S 174 E	1173 S 1177 W

Michigan Department of Environmental Quality  
Oil, Gas and Minerals Division  
PERMIT LIST  
7/9/2018 THRU 7/13/2018



Permit Number      Issue Date      Permittee Number      Permittee Name      Page 1

61341      7/12/2018      5312      PAXTON RESOURCES LLC  
132 N OTSEGO AVE  
GAYLORD, MI 49735  
Surface Owner: Max Finkbeiner  
True Vertical Depth: 3256FT  
Target Formation: TRENTON-BLACK RIVER  
Deepest Formation: TRENTON-BLACK RIVER

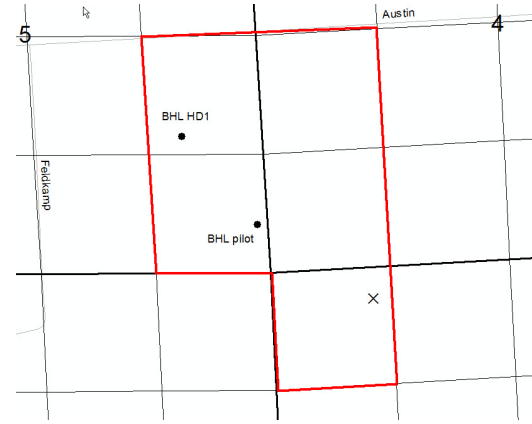

Drilling unit: 200-A, two well, R303 voluntary pooling. Re-permit of timed out PN61124. Pilot and HD1.

Location:	QT QT QT	Sec	Township	Range	Township Name	County	Feet From Section Line	Feet From DRLG Unit Line
SL:	NENWNW		9 4S	5E	SALINE	WASHTENAW	355 N 1120 W	
BHL PILOT:	SESESE		5 4S	5E	SALINE	WASHTENAW	533 S 112 E	533 S 1148 W
BHL HD1:	SWNESE		5 4S	5E	SALINE	WASHTENAW	1518 S 891 E	1077 N 365 W

61342      7/12/2018      5312      PAXTON RESOURCES LLC  
132 N OTSEGO AVE  
GAYLORD, MI 49735  
Surface Owner: Max Finkbeiner  
True Vertical Depth: 3256FT  
Target Formation: TRENTON-BLACK RIVER  
Deepest Formation: TRENTON-BLACK RIVER

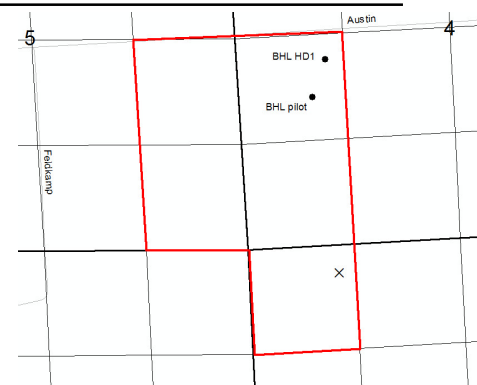

Drilling unit: 200-A, two well, R303 voluntary pooling. Re-permit of timed out PN61126. Pilot and HD1.

Location:	QT QT QT	Sec	Township	Range	Township Name	County	Feet From Section Line	Feet From DRLG Unit Line
SL:	NENWNW		9 4S	5E	SALINE	WASHTENAW	330 N 1120 W	
BHL PILOT:	SENWSW		4 4S	5E	SALINE	WASHTENAW	1890 S 921 W	755 N 416 E
BHL HD1:	NENWNW		4 4S	5E	SALINE	WASHTENAW	2313 S 765 W	331 N 574 E

Michigan Department of Environmental Quality  
Oil, Gas and Minerals Division  
Updated Permits  
7/9/2018 THRU 7/13/2018



Permit Number      Permittee Number      Permittee Name

**PLUGGING INSTRUCTIONS ISSUED:**

47722                      5512                      MERIT ENERGY CO  
  
13727 NOEL RD, STE 1200  
DALLAS, TX 75240

API Well Number: 21-079-47672-02-00

Well Name: STATE BLUE LAKE 2-13B                      True Vertical Depth: 7171

Plug Inst. Issue Date: 7/3/2018

Location	QT QT QT	Sec	Township	Range	Township Name	County	Feet From Section Line	Feet From DRLG Unit
SL:	SESWNE	13	28N	5W	BLUE LAKE	KALKASKA	500 S 820 W	
BHL:	NWSWNE	13	28N	5W	BLUE LAKE	KALKASKA	1214 S 471 W	1214 S 471 W

Comment: App. to P&A 7/3/19.

41505                      6361                      RIVERSIDE ENERGY MICHIGAN LLC  
10691 EAST CARTER ROAD  
SUITE 201  
TRAVERSE CITY, MI 49684

API Well Number: 21-137-41505-00-00

Well Name: BAGLEY WEST A2-17

Plug Inst. Issue Date: 7/2/2018

Location	QT QT QT	Sec	Township	Range	Township Name	County	Feet From Section Line	Feet From DRLG Unit
SL:	NENENW	17	30N	3W	BAGLEY	OTSEGO	602 N 626 E	602 N 626 E

Comment: App. to P&A expires 7/2/19.

Michigan Department of Environmental Quality  
Oil, Gas and Minerals Division  
Updated Permits  
7/9/2018 THRU 7/13/2018



Permit Number      Permittee Number      Permittee Name

41687      6361      RIVERSIDE ENERGY MICHIGAN LLC  
10691 EAST CARTER ROAD  
SUITE 201  
TRAVERSE CITY, MI 49684

API Well Number: 21-137-41687-00-00

Well Name: BAGLEY WEST B1-17

Plug Inst. Issue Date: 7/2/2018

Location	QT QT QT	Sec	Township	Range	Township Name	County	Feet From Section Line	Feet From DRLG Unit
SL:	NESWNW	17	30N	3W	BAGLEY	OTSEGO	660 S 726 W	651 N 600 E

Comment: App. to P&A expires 7/2/19.

41688      6361      RIVERSIDE ENERGY MICHIGAN LLC  
10691 EAST CARTER ROAD  
SUITE 201  
TRAVERSE CITY, MI 49684

API Well Number: 21-137-41688-00-00

Well Name: BAGLEY WEST B2-17

Plug Inst. Issue Date: 7/2/2018

Location	QT QT QT	Sec	Township	Range	Township Name	County	Feet From Section Line	Feet From DRLG Unit
SL:	NESENW	17	30N	3W	BAGLEY	OTSEGO	983 S 385 E	330 N 385 E

Comment: App. to P&A expires 7/2/19.

Michigan Department of Environmental Quality  
Oil, Gas and Minerals Division  
Updated Permits  
7/9/2018 THRU 7/13/2018



Permit Number      Permittee Number      Permittee Name

41731      6361      RIVERSIDE ENERGY MICHIGAN LLC  
10691 EAST CARTER ROAD  
SUITE 201  
TRAVERSE CITY, MI 49684

API Well Number: 21-137-41731-01-00

Well Name: BAGLEY WEST C2-18

Plug Inst. Issue Date: 7/2/2018

Location	QT QT QT	Sec	Township	Range	Township Name	County	Feet From Section Line	Feet From DRLG Unit
SL:	SESW	18	30N	3W	BAGLEY	OTSEGO	664 N 650 E	660 S 650 E

Comment: App. to P&A expires 7/2/19.

41732      6361      RIVERSIDE ENERGY MICHIGAN LLC  
10691 EAST CARTER ROAD  
SUITE 201  
TRAVERSE CITY, MI 49684

API Well Number: 21-137-41732-00-00

Well Name: BAGLEY WEST B2-18

Plug Inst. Issue Date: 7/2/2018

Location	QT QT QT	Sec	Township	Range	Township Name	County	Feet From Section Line	Feet From DRLG Unit
SL:	SESENW	18	30N	3W	BAGLEY	OTSEGO	660 S 340 E	660 S 340 E

Comment: App. to P&A expires 7/2/19.

Michigan Department of Environmental Quality  
Oil, Gas and Minerals Division  
Updated Permits  
7/9/2018 THRU 7/13/2018



Permit Number      Permittee Number      Permittee Name

41734      6361      RIVERSIDE ENERGY MICHIGAN LLC  
10691 EAST CARTER ROAD  
SUITE 201  
TRAVERSE CITY, MI 49684

API Well Number: 21-137-41734-00-00

Well Name: BAGLEY WEST C2-17

Plug Inst. Issue Date: 7/2/2018

Location	QT QT QT	Sec	Township	Range	Township Name	County	Feet From Section Line	Feet From DRLG Unit
SL:	NENSW	17	30N	3W	BAGLEY	OTSEGO	660 N 360 E	660 N 360 E

Comment: App. to P&A expires 7/2/19.

41736      6361      RIVERSIDE ENERGY MICHIGAN LLC  
10691 EAST CARTER ROAD  
SUITE 201  
TRAVERSE CITY, MI 49684

API Well Number: 21-137-41736-00-00

Well Name: BAGLEY WEST B3-18

Plug Inst. Issue Date: 7/2/2018

Location	QT QT QT	Sec	Township	Range	Township Name	County	Feet From Section Line	Feet From DRLG Unit
SL:	NESWNE	18	30N	3W	BAGLEY	OTSEGO	964 S 664 W	360 N 660 E

Comment: App. to P&A expires 7/2/19.

Michigan Department of Environmental Quality  
Oil, Gas and Minerals Division  
Updated Permits  
7/9/2018 THRU 7/13/2018



Permit Number      Permittee Number      Permittee Name

41737      6361      RIVERSIDE ENERGY MICHIGAN LLC  
10691 EAST CARTER ROAD  
SUITE 201  
TRAVERSE CITY, MI 49684

API Well Number: 21-137-41737-01-00

Well Name: BAGLEY WEST B4-18

Plug Inst. Issue Date: 7/2/2018

Location	QT QT QT	Sec	Township	Range	Township Name	County	Feet From Section Line	Feet From DRLG Unit
SL:	NESENE	18	30N	3W	BAGLEY	OTSEGO	950 S 660 E	365 N 660 E

Comment: App. to P&A expires 7/2/19.

41967      6361      RIVERSIDE ENERGY MICHIGAN LLC  
10691 EAST CARTER ROAD  
SUITE 201  
TRAVERSE CITY, MI 49684

API Well Number: 21-137-41967-00-00

Well Name: BAGLEY WEST A3-17

Plug Inst. Issue Date: 7/2/2018

Location	QT QT QT	Sec	Township	Range	Township Name	County	Feet From Section Line	Feet From DRLG Unit
SL:	SWNWNE	17	30N	3W	BAGLEY	OTSEGO	675 N 330 W	638 S 330 W

Comment: App. to P&A expires 7/2/19.



Michigan Department of Environmental Quality  
Oil, Gas and Minerals Division  
Updated Permits  
7/9/2018 THRU 7/13/2018



Permit Number      Permittee Number      Permittee Name

41968      6361      RIVERSIDE ENERGY MICHIGAN LLC  
10691 EAST CARTER ROAD  
SUITE 201  
TRAVERSE CITY, MI 49684

API Well Number: 21-137-41968-00-00

Well Name: BAGLEY WEST A1-18

Plug Inst. Issue Date: 7/2/2018

Location	QT QT QT	Sec	Township	Range	Township Name	County	Feet From Section Line	Feet From DRLG Unit
SL:	SWNWNW	18	30N	3W	BAGLEY	OTSEGO	740 N 350 W	589 S 350 W

Comment: App. to P&A expires 7/2/19.

41969      6361      RIVERSIDE ENERGY MICHIGAN LLC  
10691 EAST CARTER ROAD  
SUITE 201  
TRAVERSE CITY, MI 49684

API Well Number: 21-137-41969-00-00

Well Name: BAGLEY WEST A3-8

Plug Inst. Issue Date: 7/2/2018

Location	QT QT QT	Sec	Township	Range	Township Name	County	Feet From Section Line	Feet From DRLG Unit
SL:	NENWNE	8	30N	3W	BAGLEY	OTSEGO	330 N 834 W	330 N 510 E

Comment: App. to P&A expires 7/2/19.

Michigan Department of Environmental Quality  
Oil, Gas and Minerals Division  
Updated Permits  
7/9/2018 THRU 7/13/2018



Permit Number      Permittee Number      Permittee Name

41970                  6361                  RIVERSIDE ENERGY MICHIGAN LLC  
10691 EAST CARTER ROAD  
SUITE 201  
TRAVERSE CITY, MI 49684

API Well Number: 21-137-41970-00-00

Well Name: BAGLEY WEST A2-8

Plug Inst. Issue Date: 7/2/2018

Location	QT QT QT	Sec	Township	Range	Township Name	County	Feet From Section Line	Feet From DRLG Unit
SL:	NENENW	8	30N	3W	BAGLEY	OTSEGO	330 N 330 E	330 N 330 E

Comment: App. to P&A expires 7/2/19.

41971                  6361                  RIVERSIDE ENERGY MICHIGAN LLC  
10691 EAST CARTER ROAD  
SUITE 201  
TRAVERSE CITY, MI 49684

API Well Number: 21-137-41971-00-00

Well Name: BAGLEY WEST B2-8

Plug Inst. Issue Date: 7/2/2018

Location	QT QT QT	Sec	Township	Range	Township Name	County	Feet From Section Line	Feet From DRLG Unit
SL:	SESENW	8	30N	3W	BAGLEY	OTSEGO	330 S 330 E	330 S 330 E

Comment: App. to P&A expires 7/2/19.

Michigan Department of Environmental Quality  
Oil, Gas and Minerals Division  
Updated Permits  
7/9/2018 THRU 7/13/2018



Permit Number      Permittee Number      Permittee Name

41972      6361      RIVERSIDE ENERGY MICHIGAN LLC  
10691 EAST CARTER ROAD  
SUITE 201  
TRAVERSE CITY, MI 49684

API Well Number: 21-137-41972-00-00

Well Name: BAGLEY WEST D1-8

Plug Inst. Issue Date: 7/2/2018

Location	QT QT QT	Sec	Township	Range	Township Name	County	Feet From Section Line	Feet From DRLG Unit
SL:	SWSWSW	8	30N	3W	BAGLEY	OTSEGO	660 S 660 W	660 S 660 W

Comment: App. to P&A expires 7/2/19.

42028      6361      RIVERSIDE ENERGY MICHIGAN LLC  
10691 EAST CARTER ROAD  
SUITE 201  
TRAVERSE CITY, MI 49684

API Well Number: 21-137-42028-00-00

Well Name: BAGLEY WEST B3-17      True Vertical Depth: 1423

Plug Inst. Issue Date: 7/2/2018

Location	QT QT QT	Sec	Township	Range	Township Name	County	Feet From Section Line	Feet From DRLG Unit
SL:	SWSWNE	17	30N	3W	BAGLEY	OTSEGO	212 S 119 W	
BHL:	SWSWNE	17	30N	3W	BAGLEY	OTSEGO	438 S 488 W	438 S 488 W

Comment: App. to P&A expires 7/2/19.

Michigan Department of Environmental Quality  
Oil, Gas and Minerals Division  
Updated Permits  
7/9/2018 THRU 7/13/2018



Permit Number      Permittee Number      Permittee Name

42399      6361      RIVERSIDE ENERGY MICHIGAN LLC  
10691 EAST CARTER ROAD  
SUITE 201  
TRAVERSE CITY, MI 49684

API Well Number: 21-137-42399-00-00

Well Name: STATE BAGLEY WEST D3-7

Plug Inst. Issue Date: 7/2/2018

Location	QT QT QT	Sec	Township	Range	Township Name	County	Feet From Section Line	Feet From DRLG Unit
SL:	NWSWSE	7	30N	3W	BAGLEY	OTSEGO	657 S 659 W	657 S 659 W

Comment: App. to P&A expires 7/2/19.

42400      6361      RIVERSIDE ENERGY MICHIGAN LLC  
10691 EAST CARTER ROAD  
SUITE 201  
TRAVERSE CITY, MI 49684

API Well Number: 21-137-42400-00-00

Well Name: STATE BAGLEY WEST A4-7

Plug Inst. Issue Date: 7/2/2018

Location	QT QT QT	Sec	Township	Range	Township Name	County	Feet From Section Line	Feet From DRLG Unit
SL:	NWNENE	7	30N	3W	BAGLEY	OTSEGO	509 N 673 E	509 N 643 W

Comment: App. to P&A expires 7/2/19.

Michigan Department of Environmental Quality  
Oil, Gas and Minerals Division  
Updated Permits  
7/9/2018 THRU 7/13/2018



Permit Number      Permittee Number      Permittee Name

42402      6361      RIVERSIDE ENERGY MICHIGAN LLC  
10691 EAST CARTER ROAD  
SUITE 201  
TRAVERSE CITY, MI 49684

API Well Number: 21-137-42402-00-00

Well Name: STATE BAGLEY WEST A1-8

Plug Inst. Issue Date: 7/2/2018

Location	QT QT QT	Sec	Township	Range	Township Name	County	Feet From Section Line	Feet From DRLG Unit
SL:	NWNWNW	8	30N	3W	BAGLEY	OTSEGO	450 N 660 W	450 N 660 W

Comment: App. to P&A expires 7/2/19.

42403      6361      RIVERSIDE ENERGY MICHIGAN LLC  
10691 EAST CARTER ROAD  
SUITE 201  
TRAVERSE CITY, MI 49684

API Well Number: 21-137-42403-00-00

Well Name: STATE BAGLEY WEST B1-8

Plug Inst. Issue Date: 7/2/2018

Location	QT QT QT	Sec	Township	Range	Township Name	County	Feet From Section Line	Feet From DRLG Unit
SL:	SWSWNW	8	30N	3W	BAGLEY	OTSEGO	422 S 653 W	422 S 653 W

Comment: App. to P&A expires 7/2/19.

Michigan Department of Environmental Quality  
Oil, Gas and Minerals Division  
Updated Permits  
7/9/2018 THRU 7/13/2018



Permit Number      Permittee Number      Permittee Name

42404      6361      RIVERSIDE ENERGY MICHIGAN LLC  
10691 EAST CARTER ROAD  
SUITE 201  
TRAVERSE CITY, MI 49684

API Well Number: 21-137-42404-00-00

Well Name: STATE BAGLEY WEST C1-8

Plug Inst. Issue Date: 7/2/2018

Location	QT QT QT	Sec	Township	Range	Township Name	County	Feet From Section Line	Feet From DRLG Unit
SL:	NWNWSW	8	30N	3W	BAGLEY	OTSEGO	648 N 651 W	648 N 651 W

Comment: App. to P&A expires 7/2/19.

42405      6361      RIVERSIDE ENERGY MICHIGAN LLC  
10691 EAST CARTER ROAD  
SUITE 201  
TRAVERSE CITY, MI 49684

API Well Number: 21-137-42405-00-00

Well Name: STATE BAGLEY WEST C2-8

Plug Inst. Issue Date: 7/2/2018

Location	QT QT QT	Sec	Township	Range	Township Name	County	Feet From Section Line	Feet From DRLG Unit
SL:	NENESW	8	30N	3W	BAGLEY	OTSEGO	639 N 330 E	639 N 330 E

Comment: App. to P&A expires 7/2/19.

Michigan Department of Environmental Quality  
Oil, Gas and Minerals Division  
Updated Permits  
7/9/2018 THRU 7/13/2018



Permit Number      Permittee Number      Permittee Name

42406      6361      RIVERSIDE ENERGY MICHIGAN LLC  
10691 EAST CARTER ROAD  
SUITE 201  
TRAVERSE CITY, MI 49684

API Well Number: 21-137-42406-00-00

Well Name: STATE BAGLEY WEST C3-8

Plug Inst. Issue Date: 7/2/2018

Location	QT QT QT	Sec	Township	Range	Township Name	County	Feet From Section Line	Feet From DRLG Unit
SL:	NWNWSE	8	30N	3W	BAGLEY	OTSEGO	395 N 552 W	395 N 552 W

Comment: App. to P&A expires 7/2/19.

42407      6361      RIVERSIDE ENERGY MICHIGAN LLC  
10691 EAST CARTER ROAD  
SUITE 201  
TRAVERSE CITY, MI 49684

API Well Number: 21-137-42407-00-00

Well Name: STATE BAGLEY WEST A3-7

Plug Inst. Issue Date: 7/2/2018

Location	QT QT QT	Sec	Township	Range	Township Name	County	Feet From Section Line	Feet From DRLG Unit
SL:	NWNWNE	7	30N	3W	BAGLEY	OTSEGO	449 N 650 W	449 N 650 W

Comment: App. to P&A expires 7/2/19.

Michigan Department of Environmental Quality  
Oil, Gas and Minerals Division  
Updated Permits  
7/9/2018 THRU 7/13/2018



Permit Number      Permittee Number      Permittee Name

42409      6361      RIVERSIDE ENERGY MICHIGAN LLC  
10691 EAST CARTER ROAD  
SUITE 201  
TRAVERSE CITY, MI 49684

API Well Number: 21-137-42409-01-00

Well Name: STATE BAGLEY WEST B2-7

Plug Inst. Issue Date: 7/2/2018

Location	QT QT QT	Sec	Township	Range	Township Name	County	Feet From Section Line	Feet From DRLG Unit
SL:	SWSNW	7	30N	3W	BAGLEY	OTSEGO	400 S 664 E	400 S 654 W

Comment: App. to P&A expires 7/2/19.

42410      6361      RIVERSIDE ENERGY MICHIGAN LLC  
10691 EAST CARTER ROAD  
SUITE 201  
TRAVERSE CITY, MI 49684

API Well Number: 21-137-42410-00-00

Well Name: STATE BAGLEY WEST B3-7

Plug Inst. Issue Date: 7/2/2018

Location	QT QT QT	Sec	Township	Range	Township Name	County	Feet From Section Line	Feet From DRLG Unit
SL:	SESWNE	7	30N	3W	BAGLEY	OTSEGO	401 S 663 W	401 S 654 E

Comment: App. to P&A expires 7/2/19.



Michigan Department of Environmental Quality  
Oil, Gas and Minerals Division  
Updated Permits  
7/9/2018 THRU 7/13/2018



Permit Number      Permittee Number      Permittee Name

42411      6361      RIVERSIDE ENERGY MICHIGAN LLC  
10691 EAST CARTER ROAD  
SUITE 201  
TRAVERSE CITY, MI 49684

API Well Number: 21-137-42411-00-00

Well Name: STATE BAGLEY WEST B4-7

Plug Inst. Issue Date: 7/2/2018

Location	QT QT QT	Sec	Township	Range	Township Name	County	Feet From Section Line	Feet From DRLG Unit
SL:	SESENE	7	30N	3W	BAGLEY	OTSEGO	402 S 657 E	402 S 657 E

Comment: App. to P&A expires 7/2/19.

42412      6361      RIVERSIDE ENERGY MICHIGAN LLC  
10691 EAST CARTER ROAD  
SUITE 201  
TRAVERSE CITY, MI 49684

API Well Number: 21-137-42412-00-00

Well Name: STATE BAGLEY WEST C3-7

Plug Inst. Issue Date: 7/2/2018

Location	QT QT QT	Sec	Township	Range	Township Name	County	Feet From Section Line	Feet From DRLG Unit
SL:	NWNWSE	7	30N	3W	BAGLEY	OTSEGO	657 N 609 W	657 N 609 W

Comment: App. to P&A expires 7/2/19.

Michigan Department of Environmental Quality  
Oil, Gas and Minerals Division  
Updated Permits  
7/9/2018 THRU 7/13/2018



Permit Number      Permittee Number      Permittee Name

42413      6361      RIVERSIDE ENERGY MICHIGAN LLC  
10691 EAST CARTER ROAD  
SUITE 201  
TRAVERSE CITY, MI49684

API Well Number: 21-137-42413-00-00

Well Name: STATE BAGLEY WEST C4-7

Plug Inst. Issue Date: 7/2/2018

Location	QT QT QT	Sec	Township	Range	Township Name	County	Feet From Section Line	Feet From DRLG Unit
SL:	NWNESE	7	30N	3W	BAGLEY	OTSEGO	656 N 699 E	656 N 619 W

Comment: App. to P&A expires 7/2/19.

55549      6361      RIVERSIDE ENERGY MICHIGAN LLC  
10691 EAST CARTER ROAD  
SUITE 201  
TRAVERSE CITY, MI 49684

API Well Number: 21-137-55549-00-00

Well Name: STATE BAGLEY D3-30      True Vertical Depth: 1998

Plug Inst. Issue Date: 7/2/2018

Location	QT QT QT	Sec	Township	Range	Township Name	County	Feet From Section Line	Feet From DRLG Unit
SL:	SESESW	30	30N	3W	BAGLEY	OTSEGO	106 S 2256 W	
BHL:	SSSWSE	30	30N	3W	BAGLEY	OTSEGO	509 S 1762 E	

Comment: App. to P&A expires 7/2/19.

Michigan Department of Environmental Quality  
Oil, Gas and Minerals Division  
Updated Permits  
7/9/2018 THRU 7/13/2018



Permit Number      Permittee Number      Permittee Name

55550      6361      RIVERSIDE ENERGY MICHIGAN LLC  
10691 EAST CARTER ROAD  
SUITE 201  
TRAVERSE CITY, MI 49684

API Well Number: 21-137-55550-00-00

Well Name: KUCK A4-31

True Vertical Depth: 1752

Plug Inst. Issue Date: 7/2/2018

Location	QT QT QT	Sec	Township	Range	Township Name	County	Feet From Section Line	Feet From DRLG Unit
SL:	NWSENE	31	30N	3W	BAGLEY	OTSEGO	1536 N 1205 E	
BHL:	NENENE	31	30N	3W	BAGLEY	OTSEGO	20 N 405 E	

Comment: App. to P&A expires 7/2/19.

55551      6361      RIVERSIDE ENERGY MICHIGAN LLC  
10691 EAST CARTER ROAD  
SUITE 201  
TRAVERSE CITY, MI 49684

API Well Number: 21-137-55551-00-00

Well Name: KUCK B4-31

True Vertical Depth: 1784

Plug Inst. Issue Date: 7/2/2018

Location	QT QT QT	Sec	Township	Range	Township Name	County	Feet From Section Line	Feet From DRLG Unit
SL:	NWSENE	31	30N	3W	BAGLEY	OTSEGO	1586 N 1205 E	
BHL:	SWSWNW	31	30N	3W	BAGLEY	OTSEGO	2257 N 254 W	

Comment: App. to P&A expires 7/2/19.

Michigan Department of Environmental Quality  
Oil, Gas and Minerals Division  
Updated Permits  
7/9/2018 THRU 7/13/2018



Permit Number      Permittee Number      Permittee Name

**APPLICATIONS TO CHANGE WELL STATUS:**

58830                  7691                  MERIDIAN RESOURCES LLC  
4424 VOGEL ROAD  
SUITE 404  
EVANSVILLE, IN 47715

API Well Number: 21-059-58830-00-00

Well Name: WESSEL 1-6

True Vertical Depth: 4016

Approval Date: 7/9/2018

Location	QT QT QT	Sec	Township	Range	Township Name	County	Feet From Section Line	Feet From DRLG Unit
SL:	SWNWNW	6	7S	1W	PITTSFORD	HILLSDALE	845 N 143 W	
BHL:	SWNENW	6	7S	1W	PITTSFORD	HILLSDALE	1028 N 733 W	329 S 733 W

Proposed Rework: ACOWS to Perforate and Test Current Formation

Comment: ACOWS to set RBP above existing perms, recompleted and test uphole in the Black River Fmn., expires 7/9/19.

58932                  7691                  MERIDIAN RESOURCES LLC  
4424 VOGEL ROAD  
SUITE 404  
EVANSVILLE, IN 47715

API Well Number: 21-059-58932-00-00

Well Name: BOARDMAN ET AL 1-1

Approval Date: 6/29/2018

Location	QT QT QT	Sec	Township	Range	Township Name	County	Feet From Section Line	Feet From DRLG Unit
SL:	NENWNE	1	7S	2W	JEFFERSON	HILLSDALE	330 N 1670 E	

Proposed Rework: ACOWS to Perforate and Test Current Formation

Comment: ACOWS to set RBP above existing perms, recomplete and test uphole in the Black River Fmn., expires 6/29/19.

Michigan Department of Environmental Quality  
 Oil, Gas and Minerals Division  
 Updated Permits  
 7/9/2018 THRU 7/13/2018



Permit Number      Permittee Number      Permittee Name

**RECORD OF CHANGE OF WELL STATUS:**

30762                  5512                  MERIT ENERGY CO  
 13727 NOEL RD, STE 1200  
 DALLAS, TX 75240

API Well Number: 21-101-30762-00-00

Well Name: MEISTER 3-34

Change Date: 10/5/2017

Location	QT QT QT	Sec	Township	Range	Township Name	County	Feet From Section Line	Feet From DRLG Unit
SL:	SENWNW	34	23N	15W	BEAR LAKE	MANISTEE	880 N 871 W	880 N 460 E

Proposed Rework:                  Reworked Repaired, Replace, or Recement Casing

Comment:      RCOWS for cement squeeze for csg. repair

Michigan Department of Environmental Quality  
Oil, Gas and Minerals Division  
Updated Permits  
7/9/2018 THRU 7/13/2018



Permit Number      Permittee Number      Permittee Name

**TRANSFER OF OWNERSHIP:**

39007                      7739                      LAYLINE OIL AND GAS LLC  
820 GESSNER ROAD, SUITE 1145  
HOUSTON, TX 77024 USA

API Well Number: 21-035-08532-01-00

Well Name: THAYER 3

Transfer Date: 7/13/2018

Previous Owner: DART OIL AND GAS CORP

Location	QT QT QT	Sec	Township	Range	Township Name	County	Feet From Section Line	Feet From DRLG Unit
SL:	E2SWSW	29	20N	6W	WINTERFIELD	CLARE	655 S 950 W	655 S 358 E