

Michigan Department of Environmental Quality
 Oil, Gas and Minerals Division
 PERMIT APPLICATIONS
 8/13/2018 THRU 8/17/2018



Application Number Date Received Permittee Number Permittee Name Page 1

249 08/15/2018 6498 WOLVERINE GAS AND OIL COMPANY OF MICHIGAN LLC
 1 RIVERFRONT PLAZA
 55 CAMPAU, NW
 GRAND RAPIDS, MI 49503

Prev Permit:

Well Name: CARNEY 20-1

Well Type: OIL

Permit Type: Drill

H2S Present? Yes

Surface Owner: Richard B.W. Carney, Jr.

True Vertical Depth: 3881

Target Formation: TRENTON

Deepest Formation: GLENWOOD

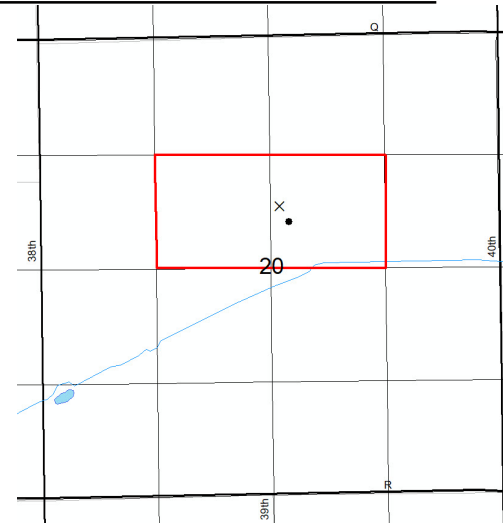

Drilling unit: 80A R 303 voluntary pooling. SW/4 NE/4 & SE/4 NW/4 Sec. 20.

Location:	QT QT QT	Sec	Township	Range	Township Name	County	Feet From Section Line	Feet From DRLG Unit Line
SL:	NWSWNE	20	3S	9W	CLIMAX	KALAMAZOO	1978 N 2464 E	
BHL:	SWSWNE	20	3S	9W	CLIMAX	KALAMAZOO	2268 N 2353 E	387 S 312 W

Michigan Department of Environmental Quality
 Oil, Gas and Minerals Division
 PERMIT LIST
 8/13/2018 THRU 8/17/2018



Permit Number Issue Date Permittee Number Permittee Name Page 1

61348 8/16/2018 40 MUSKEGON DEVELOPMENT CO

1425 S MISSION RD
 MOUNT PLEASANT, MI 48858

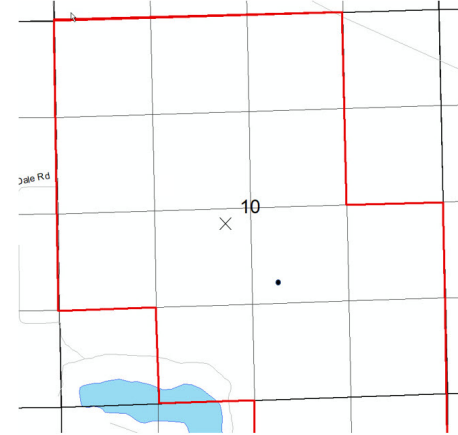

API Well No: 21-035-62007-00-00

Prev Permit:

Well Name: STRAUB UNIT 1-10

Well Type: Oil Well

Permit Type: Drill

H2S Present? Yes

Surface Owner: Muskegon Development Company

True Vertical Depth: 5628FT

Target Formation: RICHFIELD

Deepest Formation: SYLVANIA

UNITIZED SO 03-2015 - STRAUB UNIT

Location:	QT QT QT	Sec	Township	Range	Township Name	County	Feet From Section Line	Feet From DRLG Unit Line
SL:	SWSENW	10	20N	3W	FRANKLIN	CLARE	2295 N 1495 W	
BHL:	SWSENW	10	20N	3W	FRANKLIN	CLARE	2295 N 1495 W	2295 N 1495 W

Michigan Department of Environmental Quality
Oil, Gas and Minerals Division
Updated Permits
8/13/2018 THRU 8/17/2018



Permit Number Permittee Number Permittee Name

PLUGGING INSTRUCTIONS ISSUED:

59956 104 WEST BAY EXPLORATION COMPANY

13685 S WEST BAYSHORE DR
TRAVERSE CITY, MI49684

API Well Number: 21-025-58280-01-00

Well Name: HOFFMAN 1-1 HD1 True Vertical Depth: 4437

Plug Inst. Issue Date: 8/2/2018

Location	QT QT QT	Sec	Township	Range	Township Name	County	Feet From Section Line	Feet From DRLG Unit
SL:	SWSWSW	1	2S	5W	MARENGO	CALHOUN	487 S 330 W	
BHL:	SESWSW	1	2S	5W	MARENGO	CALHOUN	487 S 830 W	487 S 491 E

Comment: App. to P&A expires 8/2/19.

8124 491 CONSUMERS ENERGY CO

1945 W PARNALL RD
JACKSON, MI 49201

API Well Number: 21-035-08124-00-00

Well Name: MICH GAS STORAGE 546

Plug Inst. Issue Date: 8/13/2018

Location	QT QT QT	Sec	Township	Range	Township Name	County	Feet From Section Line	Feet From DRLG Unit
SL:	CNSE	20	20N	6W	WINTERFIELD	CLARE	1320 N 1320 W	

Comment: App. to P&A expires 8/13/19.

Michigan Department of Environmental Quality
Oil, Gas and Minerals Division
Updated Permits
8/13/2018 THRU 8/17/2018



Permit Number Permittee Number Permittee Name

9320 491 CONSUMERS ENERGY CO

1945 W PARNALL RD
JACKSON, MI 49201

API Well Number: 21-035-09320-00-00

Well Name: M G S C 727

Plug Inst. Issue Date: 8/10/2018

Location	QT QT QT	Sec	Township	Range	Township Name	County	Feet From Section Line	Feet From DRLG Unit
SL:	CNNE	18	20N	5W	SUMMERFIELD	CLARE	1320 S 1320 W	1320 N 1320 E

Comment: App. to P&A expires 8/10/19.

13015 491 CONSUMERS ENERGY CO

1945 W PARNALL RD
JACKSON, MI 49201

API Well Number: 21-035-13015-00-00

Well Name: MICHIGAN GAS STORAGE CO 245

Plug Inst. Issue Date: 8/13/2018

Location	QT QT QT	Sec	Township	Range	Township Name	County	Feet From Section Line	Feet From DRLG Unit
SL:	CENWSW	8	20N	5W	SUMMERFIELD	CLARE	660 N 710 W	660 N 610 E

Comment: App. to P&A expires 8/13/19.

Michigan Department of Environmental Quality
Oil, Gas and Minerals Division
Updated Permits
8/13/2018 THRU 8/17/2018



Permit Number Permittee Number Permittee Name

13098 491 CONSUMERS ENERGY CO
1945 W PARNALL RD
JACKSON, MI 49201

API Well Number: 21-035-13098-00-00

Well Name: MICHIGAN GAS STORAGE CO 261

Plug Inst. Issue Date: 8/9/2018

Location	QT QT QT	Sec	Township	Range	Township Name	County	Feet From Section Line	Feet From DRLG Unit
SL:	SWNE	2	20N	6W	WINTERFIELD	CLARE	920 N 660 E	400 S 660 E

Comment: App. to P&A expires 8/9/19.

20652 491 CONSUMERS ENERGY CO
1945 W PARNALL RD
JACKSON, MI 49201

API Well Number: 21-035-20652-00-00

Well Name: M G S C 914

Plug Inst. Issue Date: 8/10/2018

Location	QT QT QT	Sec	Township	Range	Township Name	County	Feet From Section Line	Feet From DRLG Unit
SL:	CNNWNE	20	20N	6W	WINTERFIELD	CLARE	660 N 695 W	660 N 625 E

Comment: App. to P&A expires 8/10/19.

Michigan Department of Environmental Quality
Oil, Gas and Minerals Division
Updated Permits
8/13/2018 THRU 8/17/2018



Permit Number Permittee Number Permittee Name

APPLICATIONS TO CHANGE WELL STATUS:

61116 5320 SAVOY ENERGY LP
920 HASTINGS STREET, SUITE A
PO BOX 1560
TRAVERSE CITY, MI49685-1560

API Well Number: 21-091-60877-01-00

Well Name: DAY 3-27A

True Vertical Depth: 3139

Approval Date: 8/3/2018

Location	QT QT QT	Sec	Township	Range	Township Name	County	Feet From Section Line	Feet From DRLG Unit
SL:	NESESW	27	6S	3E	ADRIAN	LENAWEE	737 S 2258 W	
BHL:	NWSWSE	27	6S	3E	ADRIAN	LENAWEE	859 S 2085 E	470 N 585 W

Proposed Rework: ACOWS to Perforate and Test Current Formation

Comment: ACOWS to perf at 3364'-3384' in the Trenton Fmn. (existing fmn.), and acidize. Expires 8/3/19.

.....

Michigan Department of Environmental Quality
Oil, Gas and Minerals Division

Updated Permits

8/12/2018 THRU 8/18/2018



Permit Number Permittee Number Permittee Name

PERMIT TERMINATIONS:

61169 6042 HARDY AND HARDY CONSULTING
LLC

PO BOX 332
DEWITT, MI 48820

API Well Number: 21-111-41791-01-00

Well Name: STATE JASPER & CONLEY 1-3
SWD

Termination Date: 8/14/2018

Location	QT QT QT	Sec	Township	Range	Township Name	County	Feet From Section Line	Feet From DRLG Unit
SL:	NWSESW	3	13N	2W	JASPER	MIDLAND	930 S 1892 W	

61093 6042 HARDY AND HARDY CONSULTING
LLC

PO BOX 332
DEWITT, MI 48820

API Well Number: 21-111-52014-01-00

Well Name: CITY OF MASON ET AL 1-3

Termination Date: 8/14/2018

Location	QT QT QT	Sec	Township	Range	Township Name	County	Feet From Section Line	Feet From DRLG Unit
SL:	NWNENE	3	13N	2W	JASPER	MIDLAND	679 N 985 E	
BHL:	SWSENE	3	13N	2W	JASPER	MIDLAND	2500 N 987 E	332 S 326 E