

Michigan Department of Environmental Quality
 Oil, Gas and Minerals Division
 PERMIT APPLICATIONS
 8/27/2018 THRU 8/31/2018



Application Number Date Received Permittee Number Permittee Name Page 1

256 08/27/2018 6042 HARDY AND HARDY CONSULTING LLC

Prev Permit: 61307

Well Name: City of Mason 11-2A

Well Type: OIL

Permit Type: Reentry

H2S Present? Yes

PO BOX 332
 DEWITT, MI 48820

Surface Owner: John Sean Blizzard

True Vertical Depth: 4440

Target Formation: RICHFIELD

Deepest Formation: AMHERSTBURG

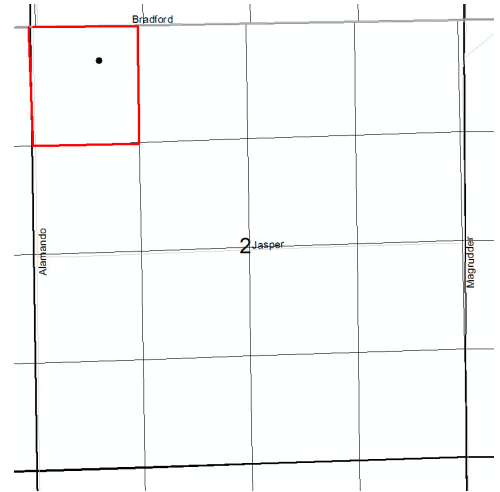

Drilling unit: 40A. NW/4 NW/4 of Section 2.
 Deepening of PN61307

Location:	QT QT QT	Sec	Township	Range	Township Name	County	Feet From Section Line	Feet From DRLG Unit Line
SL:	NENWNW	2	13N	2W	JASPER	MIDLAND	330 N 972 W	
BHL:	NENWNW	2	13N	2W	JASPER	MIDLAND	330 N 972 W	330 N 330 E

258 08/30/2018 5095 OMIMEX ENERGY INC

Prevv Permit:: 34778

Well Name: FARRIS & HOPPER 1-2

Welll Type: GIW

Permit Type: Reentry

H2S Present: Yess

7950 JOHN T. WHITE RD.
 FT. WORTH, TX 76120

Surface Owner: Travis Farris

True Vertical Depth: 3920

Target Formation: NIAGARAN BROWN

Deepest Formation: NIAGARAN GRAY

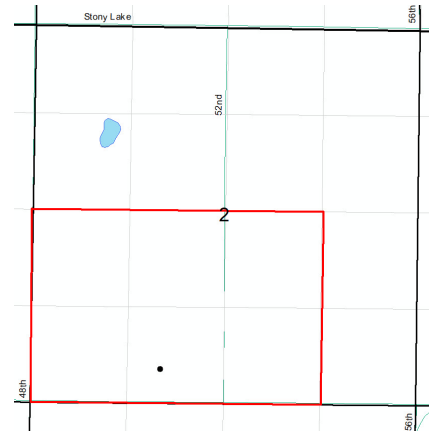

Conversion to injection. 200A unit for enhanced recovery SO (A) 47-12-87. SW/4 AND W/2 SE/4 Sect 2.

Location:	QT QT QT	Sec	Township	Range	Township Name	County	Feet From Section Line	Feet From DRLG Unit Line
SL:	SWSESW	2	13N	18W	CLAYBANKS	OCEANA	460 S 860 E	
BHL:	SWSESW	2	13N	18W	CLAYBANKS	OCEANA	460 S 860 E	460 S 1780 W

Michigan Department of Environmental Quality
 Oil, Gas and Minerals Division
 PERMIT LIST
 8/27/2018 THRU 8/31/2018



Permit Number Issue Date Permittee Number Permittee Name Page 1

61352 8/28/2018 5312 PAXTON RESOURCES LLC
 132 N OTSEGO AVE
 GAYLORD, MI 49735

API Well No: 21-045-62002-00-00

Prev Permit:

Well Name: SCARBRO 1-19

Well Type: Oil Well

Permit Type: Drill

H2S Present? No

Surface Owner: Lawrence J. Scarbro, et ux

True Vertical Depth: 3700FT

Target Formation: NIAGARAN

Deepest Formation: CLINTON

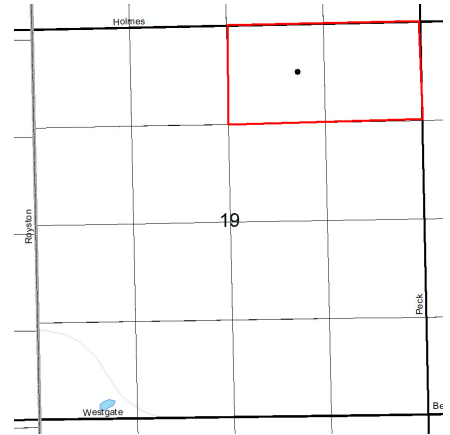

Drilling unit: 80A. N/2 NE/4 Sec. 19

Location:	QT QT QT	Sec	Township	Range	Township Name	County	Feet From Section Line	Feet From DRLG Unit Line
SL:	NENWNE	19	1N	3W	HAMLIN	EATON	587 N 1692 E	
BHL:	NENWNE	19	1N	3W	HAMLIN	EATON	587 N 1692 E	587 N 964 W

Michigan Department of Environmental Quality
Oil, Gas and Minerals Division
Updated Permits
8/27/2018 THRU 8/31/2018



Permit Number Permittee Number Permittee Name

RECORD OF WELL PLUGGING:

42690 6371 BREITBURN OPERATING LIMITED PARTNERSHIP
515 S. FLOWER STREET STE 4800
LOS ANGELES, CA 90071

API Well Number: 21-017-42690-00-00

Well Name: FRANCIS 1-1

Plugging Date: 8/9/2018

Location	QT QT QT	Sec	Township	Range	Township Name	County	Feet From Section Line	Feet From DRLG Unit
SL:	SENWSW	1	14N	4E	MONITOR	BAY	1139 N 985 W	1500 S 985 W

60823 6525 PROVIDENCE OPERATING LLC
P.O. BOX 158
2905 WILSON AVENUE, SUITE 200
GRANDVILLE, MI 49418

API Well Number: 21-075-37550-02-00

Well Name: ALEXANDER 2-19B True Vertical Depth: 4211

Plugging Date: 12/21/2017

Location	QT QT QT	Sec	Township	Range	Township Name	County	Feet From Section Line	Feet From DRLG Unit
SL:	SESENW	19	4S	2W	HANOVER	JACKSON	2317 N 1759 W	
BHL:	SESENW	19	4S	2W	HANOVER	JACKSON	2291 N 1722 W	342 S 361 E

Michigan Department of Environmental Quality
Oil, Gas and Minerals Division
Updated Permits
8/27/2018 THRU 8/31/2018



Permit Number Permittee Number Permittee Name

APPLICATIONS TO CHANGE WELL STATUS:

48782 6361 RIVERSIDE ENERGY MICHIGAN LLC
10691 EAST CARTER ROAD
SUITE 201
TRAVERSE CITY, MI49684

API Well Number: 21-009-48782-00-00

Well Name: KUNZ B4-18

Approval Date: 8/28/2018

Location	QT QT QT	Sec	Township	Range	Township Name	County	Feet From Section Line	Feet From DRLG Unit
SL:	SESENE	18	30N	6W	CHESTONIA	ANTRIM	379 S 429 E	379 S 429 E

Proposed Rework: ACOWS for Miscellaneous Comment: ACOWS to stimulate well with acid and CO2, expires 8/28/19.

33508 7739 LAYLINE OIL AND GAS LLC
820 GESSNER ROAD, SUITE 1145
HOUSTON, TX 77024 USA

API Well Number: 21-035-33508-00-00

Well Name: STATE A 2

Approval Date: 8/27/2018

Location	QT QT QT	Sec	Township	Range	Township Name	County	Feet From Section Line	Feet From DRLG Unit
SL:	SWSESE	2	20N	6W	WINTERFIELD	CLARE	330 S 990 E	330 S 990 E

Proposed Rework: ACOWS to Perforate and Test Current Formation Comment: ACOWS to move uphole to recomplete well by perfing and acidizing in the Detroit River, expires 8/27/19.

Michigan Department of Environmental Quality
 Oil, Gas and Minerals Division
 Updated Permits
 8/27/2018 THRU 8/31/2018



Permit Number Permittee Number Permittee Name

60925 5320 SAVOY ENERGY LP
 920 HASTINGS STREET, SUITE A
 PO BOX 1560
 TRAVERSE CITY, MI49685-1560

API Well Number: 21-045-60681-01-00

Well Name: VANDERMOLEN 1-34A

True Vertical Depth: 5099

Approval Date: 8/30/2018

Location	QT QT QT	Sec	Township	Range	Township Name	County	Feet From Section Line	Feet From DRLG Unit
SL:	SWSESE	34	1N	3W	HAMLIN	EATON	331 S 995 E	
BHL:	SESESE	34	1N	3W	HAMLIN	EATON	345 S 547 E	345 S 547 E

Proposed Rework: ACOWS to Perforate and Test Current Formation

Comment: ACOWS to perf at 5022'-2042' and acidize, expires 8/30/19.

BOTTOM HOLE LOCATION CORRECTIONS:

61332 104 WEST BAY EXPLORATION COMPANY
 13685 S WEST BAYSHORE DR
 TRAVERSE CITY, MI49684

API Well Number: 21-035-62005-00-00

Well Name: HAMPTON 1-24

Correction Date: 8/29/2018

Location	QT QT QT	Sec	Township	Range	Township Name	County	Feet From Section Line	Feet From DRLG Unit
SL:	SWSESE	24	17N	4W	GRANT	CLARE	181 S 1079 E	1141 N 247 W
BHL:	SWSESE	24	17N	4W	GRANT	CLARE	225 S 839 E	1097 N 487 W

Michigan Department of Environmental Quality
Oil, Gas and Minerals Division
Updated Permits
8/27/2018 THRU 8/31/2018



Permit Number Permittee Number Permittee Name

TRANSFER OF OWNERSHIP:

61287 7565 MILLER ENERGY COMPANY LLC
10850 EAST TRAVERSE HWY
SUITE 5595
TRAVERSE CITY, MI49684

API Well Number: 21-011-62002-00-00

Well Name: STATE ADAMS 8-1

Transfer Date: 8/31/2018

Previous Owner: WOLVERINE GAS AND OIL COMPANY LLC

Location	QT QT QT	Sec	Township	Range	Township Name	County	Feet From Section Line	Feet From DRLG Unit
SL:	SWSWNW	8	19N	3E	ADAMS	ARENAC	2505 N 489 W	
BHL:	SWNWNW	8	19N	3E	ADAMS	ARENAC	1311 N 37 W	1311 N 1284 E