

Michigan Department of Environmental Quality
Oil, Gas and Minerals Division

PERMIT LIST

10/15/2018 THRU 10/19/2018



Permit Number Issue Date Permittee Number Permittee Name Page 1

61375 10/16/2018 6310

CORE ENERGY LLC

1011 NOTEWARE DRIVE
TRAVERSE CITY, MI 49686

API Well No: 21-137-29298-01-00

Prev Permit: 29298

Well Name: BUTKA 1-10A

Surface Owner: David Duffield

Well Type: Oil Well

True Vertical Depth: 6238FT

Permit Type: Deepen

Target Formation: NIAGARAN

H2S Present? No

Deepest Formation: NIAGARAN

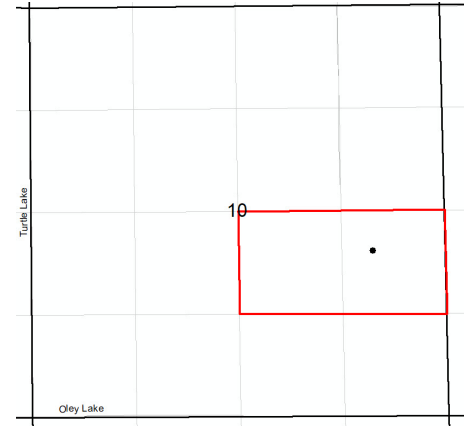

Drilling unit: 80A N/2 SE/4 Sec 10

Location:	QT QT QT	Sec	Township	Range	Township Name	County	Feet From Section Line	Feet From DRLG Unit Line
SL:	NWNESE	10	30N	2W	CHESTER	OTSEGO	2103 S 934 E	
BHL:	NWNESE	10	30N	2W	CHESTER	OTSEGO	2103 S 934 E	507 N 934 E

61376 10/19/2018 6498

WOLVERINE GAS AND OIL
COMPANY OF MICHIGAN LLC
1 RIVERFRONT PLAZA
55 CAMPAU, NW
GRAND RAPIDS, MI 49503

API Well No: 21-077-62018-00-00

Prev Permit:

Surface Owner: Robert and Martha Gibson

Well Name: PEASE 19-2 HD1

True Vertical Depth: 3420FT

Well Type: Oil Well

Target Formation: TRENTON

Permit Type: Drill

Deepest Formation: GLENWOOD

H2S Present? Yes

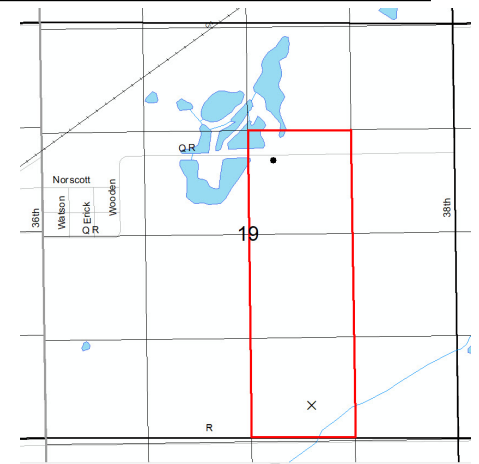

Drilling unit: 120A R 303 voluntary pooling
requested SW/4 NE/4 W/2 SE/4 Sec 19

Location:	QT QT QT	Sec	Township	Range	Township Name	County	Feet From Section Line	Feet From DRLG Unit Line
SL:	SESWSE	19	3S	9W	CLIMAX	KALAMAZOO	391 S 1846 E	
BHL:	NWSWNE	19	3S	9W	CLIMAX	KALAMAZOO	1661 N 2279 E	340 N 365 W

Michigan Department of Environmental Quality
Oil, Gas and Minerals Division

Updated Permits

10/15/2018 THRU 10/19/2018



Permit Number Permittee Number Permittee Name

Page 1

PLUGGING INSTRUCTIONS ISSUED:

50238 6361 RIVERSIDE ENERGY MICHIGAN LLC
10691 EAST CARTER ROAD
SUITE 201
TRAVERSE CITY, MI49684

API Well Number: 21-009-50238-00-00

Well Name: STATE WARNER & KERLY A2-11

Plug Inst. Issue Date: 10/12/2018

Location	QT QT QT	Sec	Township	Range	Township Name	County	Feet From Section Line	Feet From DRLG Unit
SL:	SWNENW	11	31N	5W	WARNER	ANTRIM	800 N 920 E	520 S 400 W

Comment: App. to P&A expires 10/12/19.

49255 25 DELTA OIL CO INC
125 WINDSOR DR STE 101
OAK BROOK, IL 60523

API Well Number: 21-137-34215-01-00

Well Name: STATE DOVER & HOUSE 1-33A True Vertical Depth: 5279

Plug Inst. Issue Date: 10/17/2018

Location	QT QT QT	Sec	Township	Range	Township Name	County	Feet From Section Line	Feet From DRLG Unit
SL:	SWSWSW	28	31N	2W	DOVER	OTSEGO	373 S 630 W	947 N 630 W
BHL:	SWNWNW	33	31N	2W	DOVER	OTSEGO	857 N 208 W	857 N 1101 E

Comment: App. to P&A expires 10/17/19.

Michigan Department of Environmental Quality
Oil, Gas and Minerals Division

Updated Permits

10/15/2018 THRU 10/19/2018



Permit Number Permittee Number Permittee Name

Page 2

44150 25 DELTA OIL CO INC
125 WINDSOR DR STE 101
OAK BROOK, IL 60523

API Well Number: 21-137-44150-00-00

Well Name: AXFORD C1-11

Plug Inst. Issue Date: 10/17/2018

Location	QT QT QT	Sec	Township	Range	Township Name	County	Feet From Section Line	Feet From DRLG Unit
SL:	SENWSW	11	31N	2W	DOVER	OTSEGO	889 N 843 W	425 S 459 E

Comment: App. to P&A expires 10/17/19.

44151 25 DELTA OIL CO INC
125 WINDSOR DR STE 101
OAK BROOK, IL 60523

API Well Number: 21-137-44151-00-00

Well Name: AXFORD C2-11

Plug Inst. Issue Date: 10/17/2018

Location	QT QT QT	Sec	Township	Range	Township Name	County	Feet From Section Line	Feet From DRLG Unit
SL:	SENESW	11	31N	2W	DOVER	OTSEGO	839 N 424 E	472 S 424 E

Comment: App. to P&A expires 10/17/19.

Michigan Department of Environmental Quality
Oil, Gas and Minerals Division

Updated Permits

10/15/2018 THRU 10/19/2018



Permit Number Permittee Number Permittee Name

Page 3

44161 25 DELTA OIL CO INC

125 WINDSOR DR STE 101
OAK BROOK, IL 60523

API Well Number: 21-137-44161-00-00

Well Name: AXFORD B3-11

Plug Inst. Issue Date: 10/17/2018

Location	QT QT QT	Sec	Township	Range	Township Name	County	Feet From Section Line	Feet From DRLG Unit
SL:	NWSWNE	11	31N	2W	DOVER	OTSEGO	701 S 479 W	614 N 479 W

Comment: App. to P&A expires 10/17/19.

44271 25 DELTA OIL CO INC

125 WINDSOR DR STE 101
OAK BROOK, IL 60523

API Well Number: 21-137-44271-00-00

Well Name: COLLITON B1-15

Plug Inst. Issue Date: 10/17/2018

Location	QT QT QT	Sec	Township	Range	Township Name	County	Feet From Section Line	Feet From DRLG Unit
SL:	SESWNW	15	31N	2W	DOVER	OTSEGO	400 S 948 W	400 S 375 E

Comment: App. to P&A expires 10/17/19.

Michigan Department of Environmental Quality
Oil, Gas and Minerals Division

Updated Permits

10/15/2018 THRU 10/19/2018



Permit Number Permittee Number Permittee Name

Page 4

50060 25 DELTA OIL CO INC
125 WINDSOR DR STE 101
OAK BROOK, IL 60523

API Well Number: 21-137-50060-00-00

Well Name: HOWARD D1-35

Plug Inst. Issue Date: 10/17/2018

Location	QT QT QT	Sec	Township	Range	Township Name	County	Feet From Section Line	Feet From DRLG Unit
SL:	SWSWSW	35	32N	2W	CORWITH	OTSEGO	340 S 340 W	340 S 340 W

Comment: App. to P&A expires 10/17/19.

50158 25 DELTA OIL CO INC
125 WINDSOR DR STE 101
OAK BROOK, IL 60523

API Well Number: 21-137-50158-00-00

Well Name: STATE DOVER A2-3

Plug Inst. Issue Date: 10/17/2018

Location	QT QT QT	Sec	Township	Range	Township Name	County	Feet From Section Line	Feet From DRLG Unit
SL:	NENENW	3	31N	2W	DOVER	OTSEGO	390 N 360 E	390 N 360 E

Comment: App. to P&A expires 10/17/19.

Michigan Department of Environmental Quality
Oil, Gas and Minerals Division

Updated Permits

10/15/2018 THRU 10/19/2018



Permit Number Permittee Number Permittee Name

Page 5

54742 25 DELTA OIL CO INC
125 WINDSOR DR STE 101
OAK BROOK, IL 60523

API Well Number: 21-137-54742-00-00

Well Name: HANSEN ET AL B2-35

Plug Inst. Issue Date: 10/17/2018

Location	QT QT QT	Sec	Township	Range	Township Name	County	Feet From Section Line	Feet From DRLG Unit
SL:	NESENW	35	32N	2W	CORWITH	OTSEGO	1690 N 2243 W	369 N 916 W

Comment: App. to P&A expires 10/17/19.

Michigan Department of Environmental Quality
Oil, Gas and Minerals Division

Updated Permits

10/15/2018 THRU 10/19/2018



Permit Number Permittee Number Permittee Name

RECORD OF WELL PLUGGING:

39558 6371 BREITBURN OPERATING LIMITED PARTNERSHIP
515 S. FLOWER STREET STE 4800
LOS ANGELES, CA 90071

API Well Number: 21-017-39558-00-00

Well Name: VERMEESCH 1-21

Plugging Date: 9/25/2018

Location	QT QT QT	Sec	Township	Range	Township Name	County	Feet From Section Line	Feet From DRLG Unit
SL:	NWSEW	21	14N	6E	HAMPTON	BAY	890 S 779 E	428 N 539 W

61303 104 WEST BAY EXPLORATION COMPANY
13685 S WEST BAYSHORE DR
TRAVERSE CITY, MI 49684

API Well Number: 21-035-62003-00-00

Well Name: HILDEN 1-1

Plugging Date: 7/29/2018

Location	QT QT QT	Sec	Township	Range	Township Name	County	Feet From Section Line	Feet From DRLG Unit
SL:	SESWNW	1	19N	3W	HAMILTON	CLARE	2220 N 1190 W	554 S 1190 W
BHL:	SESWNW	1	19N	3W	HAMILTON	CLARE	2220 N 1190 W	554 S 1190 W

Michigan Department of Environmental Quality
Oil, Gas and Minerals Division

Updated Permits

10/15/2018 THRU 10/19/2018



Permit Number Permittee Number Permittee Name

Page 7

41505 6361 RIVERSIDE ENERGY MICHIGAN LLC
10691 EAST CARTER ROAD
SUITE 201
TRAVERSE CITY, MI49684

API Well Number: 21-137-41505-00-00

Well Name: BAGLEY WEST A2-17

Plugging Date: 8/29/2018

Location	QT QT QT	Sec	Township	Range	Township Name	County	Feet From Section Line	Feet From DRLG Unit
SL:	NENENW	17	30N	3W	BAGLEY	OTSEGO	602 N 626 E	602 N 626 E

41687 6361 RIVERSIDE ENERGY MICHIGAN LLC
10691 EAST CARTER ROAD
SUITE 201
TRAVERSE CITY, MI49684

API Well Number: 21-137-41687-00-00

Well Name: BAGLEY WEST B1-17

Plugging Date: 8/28/2018

Location	QT QT QT	Sec	Township	Range	Township Name	County	Feet From Section Line	Feet From DRLG Unit
SL:	NESWNW	17	30N	3W	BAGLEY	OTSEGO	660 S 726 W	651 N 600 E

Michigan Department of Environmental Quality
Oil, Gas and Minerals Division

Updated Permits

10/15/2018 THRU 10/19/2018



Permit Number Permittee Number Permittee Name

41688 6361 RIVERSIDE ENERGY MICHIGAN LLC
10691 EAST CARTER ROAD
SUITE 201
TRAVERSE CITY, MI49684

API Well Number: 21-137-41688-00-00

Well Name: BAGLEY WEST B2-17

Plugging Date: 8/29/2018

Location	QT QT QT	Sec	Township	Range	Township Name	County	Feet From Section Line	Feet From DRLG Unit
SL:	NESENW	17	30N	3W	BAGLEY	OTSEGO	983 S 385 E	330 N 385 E

41690 6361 RIVERSIDE ENERGY MICHIGAN LLC
10691 EAST CARTER ROAD
SUITE 201
TRAVERSE CITY, MI49684

API Well Number: 21-137-41690-00-00

Well Name: BAGLEY 17 SWD

Plugging Date: 10/4/2018

Location	QT QT QT	Sec	Township	Range	Township Name	County	Feet From Section Line	Feet From DRLG Unit
SL:	NENENW	17	30N	3W	BAGLEY	OTSEGO	602 N 526 E	602 N 526 E

Michigan Department of Environmental Quality
Oil, Gas and Minerals Division

Updated Permits

10/15/2018 THRU 10/19/2018



Permit Number Permittee Number Permittee Name

41731 6361 RIVERSIDE ENERGY MICHIGAN LLC
10691 EAST CARTER ROAD
SUITE 201
TRAVERSE CITY, MI49684

API Well Number: 21-137-41731-00-00

Well Name: BAGLEY WEST C2-18

Plugging Date: 8/28/2018

Location	QT QT QT	Sec	Township	Range	Township Name	County	Feet From Section Line	Feet From DRLG Unit
SL:	SENE SW	18	30N	3W	BAGLEY	OTSEGO	664 N 650 E	660 S 650 E

41731 6361 RIVERSIDE ENERGY MICHIGAN LLC
10691 EAST CARTER ROAD
SUITE 201
TRAVERSE CITY, MI49684

API Well Number: 21-137-41731-01-00

Well Name: BAGLEY WEST C2-18

Plugging Date: 8/28/2018

Location	QT QT QT	Sec	Township	Range	Township Name	County	Feet From Section Line	Feet From DRLG Unit
SL:	SENE SW	18	30N	3W	BAGLEY	OTSEGO	664 N 650 E	660 S 650 E

Michigan Department of Environmental Quality
Oil, Gas and Minerals Division

Updated Permits

10/15/2018 THRU 10/19/2018



Permit Number Permittee Number Permittee Name

Page 10

41732 6361 RIVERSIDE ENERGY MICHIGAN LLC
10691 EAST CARTER ROAD
SUITE 201
TRAVERSE CITY, MI49684

API Well Number: 21-137-41732-00-00

Well Name: BAGLEY WEST B2-18

Plugging Date: 8/28/2018

Location	QT QT QT	Sec	Township	Range	Township Name	County	Feet From Section Line	Feet From DRLG Unit
SL:	SESENW	18	30N	3W	BAGLEY	OTSEGO	660 S 340 E	660 S 340 E

41734 6361 RIVERSIDE ENERGY MICHIGAN LLC
10691 EAST CARTER ROAD
SUITE 201
TRAVERSE CITY, MI49684

API Well Number: 21-137-41734-00-00

Well Name: BAGLEY WEST C2-17

Plugging Date: 8/28/2018

Location	QT QT QT	Sec	Township	Range	Township Name	County	Feet From Section Line	Feet From DRLG Unit
SL:	NENESW	17	30N	3W	BAGLEY	OTSEGO	660 N 360 E	660 N 360 E

Michigan Department of Environmental Quality
Oil, Gas and Minerals Division

Updated Permits

10/15/2018 THRU 10/19/2018



Permit Number Permittee Number Permittee Name

41736 6361 RIVERSIDE ENERGY MICHIGAN LLC
10691 EAST CARTER ROAD
SUITE 201
TRAVERSE CITY, MI49684

API Well Number: 21-137-41736-00-00

Well Name: BAGLEY WEST B3-18

Plugging Date: 8/29/2018

Location	QT QT QT	Sec	Township	Range	Township Name	County	Feet From Section Line	Feet From DRLG Unit
SL:	NESWNE	18	30N	3W	BAGLEY	OTSEGO	964 S 664 W	360 N 660 E

41737 6361 RIVERSIDE ENERGY MICHIGAN LLC
10691 EAST CARTER ROAD
SUITE 201
TRAVERSE CITY, MI49684

API Well Number: 21-137-41737-00-00

Well Name: BAGLEY WEST B4-18

Plugging Date: 10/4/2018

Location	QT QT QT	Sec	Township	Range	Township Name	County	Feet From Section Line	Feet From DRLG Unit
SL:	NESENE	18	30N	3W	BAGLEY	OTSEGO	950 S 660 E	365 N 660 E

Michigan Department of Environmental Quality
Oil, Gas and Minerals Division

Updated Permits

10/15/2018 THRU 10/19/2018



Permit Number Permittee Number Permittee Name

Page 12

41737 6361 RIVERSIDE ENERGY MICHIGAN LLC
10691 EAST CARTER ROAD
SUITE 201
TRAVERSE CITY, MI49684

API Well Number: 21-137-41737-01-00

Well Name: BAGLEY WEST B4-18

Plugging Date: 10/4/2018

Location	QT QT QT	Sec	Township	Range	Township Name	County	Feet From Section Line	Feet From DRLG Unit
SL:	NESENE	18	30N	3W	BAGLEY	OTSEGO	950 S 660 E	365 N 660 E

41967 6361 RIVERSIDE ENERGY MICHIGAN LLC
10691 EAST CARTER ROAD
SUITE 201
TRAVERSE CITY, MI49684

API Well Number: 21-137-41967-00-00

Well Name: BAGLEY WEST A3-17

Plugging Date: 8/29/2018

Location	QT QT QT	Sec	Township	Range	Township Name	County	Feet From Section Line	Feet From DRLG Unit
SL:	SWNWNE	17	30N	3W	BAGLEY	OTSEGO	675 N 330 W	638 S 330 W

Michigan Department of Environmental Quality
Oil, Gas and Minerals Division

Updated Permits

10/15/2018 THRU 10/19/2018



Permit Number Permittee Number Permittee Name

41968 6361 RIVERSIDE ENERGY MICHIGAN LLC
10691 EAST CARTER ROAD
SUITE 201
TRAVERSE CITY, MI49684

API Well Number: 21-137-41968-00-00

Well Name: BAGLEY WEST A1-18

Plugging Date: 8/28/2018

Location	QT QT QT	Sec	Township	Range	Township Name	County	Feet From Section Line	Feet From DRLG Unit
SL:	SWNWNW	18	30N	3W	BAGLEY	OTSEGO	740 N 350 W	589 S 350 W

41969 6361 RIVERSIDE ENERGY MICHIGAN LLC
10691 EAST CARTER ROAD
SUITE 201
TRAVERSE CITY, MI49684

API Well Number: 21-137-41969-00-00

Well Name: BAGLEY WEST A3-8

Plugging Date: 10/4/2018

Location	QT QT QT	Sec	Township	Range	Township Name	County	Feet From Section Line	Feet From DRLG Unit
SL:	NENWNE	8	30N	3W	BAGLEY	OTSEGO	330 N 834 W	330 N 510 E

Michigan Department of Environmental Quality
Oil, Gas and Minerals Division

Updated Permits

10/15/2018 THRU 10/19/2018



Permit Number Permittee Number Permittee Name

Page 14

41970 6361 RIVERSIDE ENERGY MICHIGAN LLC
10691 EAST CARTER ROAD
SUITE 201
TRAVERSE CITY, MI49684

API Well Number: 21-137-41970-00-00

Well Name: BAGLEY WEST A2-8

Plugging Date: 9/26/2018

Location	QT QT QT	Sec	Township	Range	Township Name	County	Feet From Section Line	Feet From DRLG Unit
SL:	NENENW	8	30N	3W	BAGLEY	OTSEGO	330 N 330 E	330 N 330 E

41971 6361 RIVERSIDE ENERGY MICHIGAN LLC
10691 EAST CARTER ROAD
SUITE 201
TRAVERSE CITY, MI49684

API Well Number: 21-137-41971-00-00

Well Name: BAGLEY WEST B2-8

Plugging Date: 9/27/2018

Location	QT QT QT	Sec	Township	Range	Township Name	County	Feet From Section Line	Feet From DRLG Unit
SL:	SESENW	8	30N	3W	BAGLEY	OTSEGO	330 S 330 E	330 S 330 E

Michigan Department of Environmental Quality
Oil, Gas and Minerals Division

Updated Permits

10/15/2018 THRU 10/19/2018



Permit Number Permittee Number Permittee Name

Page 15

41972 6361 RIVERSIDE ENERGY MICHIGAN LLC
10691 EAST CARTER ROAD
SUITE 201
TRAVERSE CITY, MI49684

API Well Number: 21-137-41972-00-00

Well Name: BAGLEY WEST D1-8

Plugging Date: 9/27/2018

Location	QT QT QT	Sec	Township	Range	Township Name	County	Feet From Section Line	Feet From DRLG Unit
SL:	SWSWSW	8	30N	3W	BAGLEY	OTSEGO	660 S 660 W	660 S 660 W

42028 6361 RIVERSIDE ENERGY MICHIGAN LLC
10691 EAST CARTER ROAD
SUITE 201
TRAVERSE CITY, MI49684

API Well Number: 21-137-42028-00-00

Well Name: BAGLEY WEST B3-17 True Vertical Depth: 1423

Plugging Date: 8/28/2018

Location	QT QT QT	Sec	Township	Range	Township Name	County	Feet From Section Line	Feet From DRLG Unit
SL:	SWSWNE	17	30N	3W	BAGLEY	OTSEGO	212 S 119 W	
BHL:	SWSWNE	17	30N	3W	BAGLEY	OTSEGO	438 S 488 W	438 S 488 W

Michigan Department of Environmental Quality
Oil, Gas and Minerals Division

Updated Permits

10/15/2018 THRU 10/19/2018



Permit Number Permittee Number Permittee Name

Page 16

42399 6361 RIVERSIDE ENERGY MICHIGAN LLC
10691 EAST CARTER ROAD
SUITE 201
TRAVERSE CITY, MI49684

API Well Number: 21-137-42399-00-00

Well Name: STATE BAGLEY WEST D3-7

Plugging Date: 10/4/2018

Location	QT QT QT	Sec	Township	Range	Township Name	County	Feet From Section Line	Feet From DRLG Unit
SL:	NWSWSE	7	30N	3W	BAGLEY	OTSEGO	657 S 659 W	657 S 659 W

42400 6361 RIVERSIDE ENERGY MICHIGAN LLC
10691 EAST CARTER ROAD
SUITE 201
TRAVERSE CITY, MI 49684

API Well Number: 21-137-42400-00-00

Well Name: STATE BAGLEY WEST A4-7

Plugging Date: 9/26/2018

Location	QT QT QT	Sec	Township	Range	Township Name	County	Feet From Section Line	Feet From DRLG Unit
SL:	NWNENE	7	30N	3W	BAGLEY	OTSEGO	509 N 673 E	509 N 643 W

Michigan Department of Environmental Quality
Oil, Gas and Minerals Division

Updated Permits

10/15/2018 THRU 10/19/2018



Permit Number Permittee Number Permittee Name

Page 17

42402 6361 RIVERSIDE ENERGY MICHIGAN LLC
10691 EAST CARTER ROAD
SUITE 201
TRAVERSE CITY, MI49684

API Well Number: 21-137-42402-00-00

Well Name: STATE BAGLEY WEST A1-8

Plugging Date: 9/26/2018

Location	QT QT QT	Sec	Township	Range	Township Name	County	Feet From Section Line	Feet From DRLG Unit
SL:	NWNWNW	8	30N	3W	BAGLEY	OTSEGO	450 N 660 W	450 N 660 W

42403 6361 RIVERSIDE ENERGY MICHIGAN LLC
10691 EAST CARTER ROAD
SUITE 201
TRAVERSE CITY, MI49684

API Well Number: 21-137-42403-00-00

Well Name: STATE BAGLEY WEST B1-8

Plugging Date: 9/26/2018

Location	QT QT QT	Sec	Township	Range	Township Name	County	Feet From Section Line	Feet From DRLG Unit
SL:	SWSWNW	8	30N	3W	BAGLEY	OTSEGO	422 S 653 W	422 S 653 W

Michigan Department of Environmental Quality
Oil, Gas and Minerals Division

Updated Permits

10/15/2018 THRU 10/19/2018



Permit Number Permittee Number Permittee Name

Page 18

42404 6361 RIVERSIDE ENERGY MICHIGAN LLC
10691 EAST CARTER ROAD
SUITE 201
TRAVERSE CITY, MI49684

API Well Number: 21-137-42404-00-00

Well Name: STATE BAGLEY WEST C1-8

Plugging Date: 9/26/2018

Location	QT QT QT	Sec	Township	Range	Township Name	County	Feet From Section Line	Feet From DRLG Unit
SL:	NWNWSW	8	30N	3W	BAGLEY	OTSEGO	648 N 651 W	648 N 651 W

42405 6361 RIVERSIDE ENERGY MICHIGAN LLC
10691 EAST CARTER ROAD
SUITE 201
TRAVERSE CITY, MI49684

API Well Number: 21-137-42405-00-00

Well Name: STATE BAGLEY WEST C2-8

Plugging Date: 10/4/2018

Location	QT QT QT	Sec	Township	Range	Township Name	County	Feet From Section Line	Feet From DRLG Unit
SL:	NENESW	8	30N	3W	BAGLEY	OTSEGO	639 N 330 E	639 N 330 E

Michigan Department of Environmental Quality
Oil, Gas and Minerals Division

Updated Permits

10/15/2018 THRU 10/19/2018



Permit Number Permittee Number Permittee Name

Page 19

42406 6361 RIVERSIDE ENERGY MICHIGAN LLC
10691 EAST CARTER ROAD
SUITE 201
TRAVERSE CITY, MI 49684

API Well Number: 21-137-42406-00-00

Well Name: STATE BAGLEY WEST C3-8

Plugging Date: 10/4/2018

Location	QT QT QT	Sec	Township	Range	Township Name	County	Feet From Section Line	Feet From DRLG Unit
SL:	NWNWSE	8	30N	3W	BAGLEY	OTSEGO	395 N 552 W	395 N 552 W

42407 6361 RIVERSIDE ENERGY MICHIGAN LLC
10691 EAST CARTER ROAD
SUITE 201
TRAVERSE CITY, MI49684

API Well Number: 21-137-42407-00-00

Well Name: STATE BAGLEY WEST A3-7

Plugging Date: 9/26/2018

Location	QT QT QT	Sec	Township	Range	Township Name	County	Feet From Section Line	Feet From DRLG Unit
SL:	NWNWNE	7	30N	3W	BAGLEY	OTSEGO	449 N 650 W	449 N 650 W

Michigan Department of Environmental Quality
Oil, Gas and Minerals Division

Updated Permits

10/15/2018 THRU 10/19/2018



Permit Number Permittee Number Permittee Name

Page 20

42409 6361 RIVERSIDE ENERGY MICHIGAN LLC
10691 EAST CARTER ROAD
SUITE 201
TRAVERSE CITY, MI49684

API Well Number: 21-137-42409-00-00

Well Name: STATE BAGLEY WEST B2-7

Plugging Date: 9/26/2018

Location	QT QT QT	Sec	Township	Range	Township Name	County	Feet From Section Line	Feet From DRLG Unit
SL:	SWSENW	7	30N	3W	BAGLEY	OTSEGO	400 S 664 E	400 S 654 W

42409 6361 RIVERSIDE ENERGY MICHIGAN LLC
10691 EAST CARTER ROAD
SUITE 201
TRAVERSE CITY, MI 49684

API Well Number: 21-137-42409-01-00

Well Name: STATE BAGLEY WEST B2-7

Plugging Date: 9/26/2018

Location	QT QT QT	Sec	Township	Range	Township Name	County	Feet From Section Line	Feet From DRLG Unit
SL:	SWSENW	7	30N	3W	BAGLEY	OTSEGO	400 S 664 E	400 S 654 W

Michigan Department of Environmental Quality
Oil, Gas and Minerals Division

Updated Permits

10/15/2018 THRU 10/19/2018



Permit Number Permittee Number Permittee Name

42410 6361 RIVERSIDE ENERGY MICHIGAN LLC
10691 EAST CARTER ROAD
SUITE 201
TRAVERSE CITY, MI49684

API Well Number: 21-137-42410-00-00

Well Name: STATE BAGLEY WEST B3-7

Plugging Date: 9/26/2018

Location	QT QT QT	Sec	Township	Range	Township Name	County	Feet From Section Line	Feet From DRLG Unit
SL:	SESWNE	7	30N	3W	BAGLEY	OTSEGO	401 S 663 W	401 S 654 E

42411 6361 RIVERSIDE ENERGY MICHIGAN LLC
10691 EAST CARTER ROAD
SUITE 201
TRAVERSE CITY, MI49684

API Well Number: 21-137-42411-00-00

Well Name: STATE BAGLEY WEST B4-7

Plugging Date: 9/26/2018

Location	QT QT QT	Sec	Township	Range	Township Name	County	Feet From Section Line	Feet From DRLG Unit
SL:	SESENE	7	30N	3W	BAGLEY	OTSEGO	402 S 657 E	402 S 657 E

Michigan Department of Environmental Quality
Oil, Gas and Minerals Division

Updated Permits

10/15/2018 THRU 10/19/2018



Permit Number Permittee Number Permittee Name

Page 22

42412 6361 RIVERSIDE ENERGY MICHIGAN LLC
10691 EAST CARTER ROAD
SUITE 201
TRAVERSE CITY, MI49684

API Well Number: 21-137-42412-00-00

Well Name: STATE BAGLEY WEST C3-7

Plugging Date: 8/29/2018

Location	QT QT QT	Sec	Township	Range	Township Name	County	Feet From Section Line	Feet From DRLG Unit
SL:	NWNWSE	7	30N	3W	BAGLEY	OTSEGO	657 N 609 W	657 N 609 W

42413 6361 RIVERSIDE ENERGY MICHIGAN LLC
10691 EAST CARTER ROAD
SUITE 201
TRAVERSE CITY, MI 49684

API Well Number: 21-137-42413-00-00

Well Name: STATE BAGLEY WEST C4-7

Plugging Date: 8/29/2018

Location	QT QT QT	Sec	Township	Range	Township Name	County	Feet From Section Line	Feet From DRLG Unit
SL:	NWNESE	7	30N	3W	BAGLEY	OTSEGO	656 N 699 E	656 N 619 W

Michigan Department of Environmental Quality
Oil, Gas and Minerals Division

Updated Permits

10/15/2018 THRU 10/19/2018



Permit Number Permittee Number Permittee Name

Page 23

55549 6361 RIVERSIDE ENERGY MICHIGAN LLC
10691 EAST CARTER ROAD
SUITE 201
TRAVERSE CITY, MI 49684

API Well Number: 21-137-55549-00-00

Well Name: STATE BAGLEY D3-30 True Vertical Depth: 1998

Plugging Date: 10/12/2018

Location	QT QT QT	Sec	Township	Range	Township Name	County	Feet From Section Line	Feet From DRLG Unit
SL:	SESESW	30	30N	3W	BAGLEY	OTSEGO	106 S 2256 W	
BHL:	SSSWSE	30	30N	3W	BAGLEY	OTSEGO	509 S 1762 E	

55550 6361 RIVERSIDE ENERGY MICHIGAN LLC
10691 EAST CARTER ROAD
SUITE 201
TRAVERSE CITY, MI49684

API Well Number: 21-137-55550-00-00

Well Name: KUCK A4-31 True Vertical Depth: 1752

Plugging Date: 10/12/2018

Location	QT QT QT	Sec	Township	Range	Township Name	County	Feet From Section Line	Feet From DRLG Unit
SL:	NWSENE	31	30N	3W	BAGLEY	OTSEGO	1536 N 1205 E	
BHL:	NENENE	31	30N	3W	BAGLEY	OTSEGO	20 N 405 E	

Michigan Department of Environmental Quality
Oil, Gas and Minerals Division

Updated Permits

10/15/2018 THRU 10/19/2018



Permit Number Permittee Number Permittee Name

APPLICATIONS TO CHANGE WELL STATUS:

12754 491 CONSUMERS ENERGY CO

1945 W PARNALL RD
JACKSON, MI 49201

API Well Number: 21-035-12754-00-00

Well Name: MICHIGAN GAS STORAGE CO
226

Approval Date: 10/12/2018

Location	QT QT QT	Sec	Township	Range	Township Name	County	Feet From Section Line	Feet From DRLG Unit
SL:	CNNWSE	20	20N	6W	WINTERFIELD	CLARE	660 N 660 W	660 N 660 W

Proposed Rework: ACOWS for Miscellaneous

Comment: ACOWS to plugback to 1315', and return well back to service, expires 10/12/19.

13213 491 CONSUMERS ENERGY CO

1945 W PARNALL RD
JACKSON, MI 49201

API Well Number: 21-035-13213-00-00

Well Name: MICHIGAN GAS STORAGE CO
279

Approval Date: 10/12/2018

Location	QT QT QT	Sec	Township	Range	Township Name	County	Feet From Section Line	Feet From DRLG Unit
SL:	CNNWNW	33	20N	6W	WINTERFIELD	CLARE	660 N 660 W	660 N 660 W

Proposed Rework: ACOWS for Miscellaneous

Comment: ACOWS to plugback to 1300', and return well back to service, expires 10/12/19.

Michigan Department of Environmental Quality
Oil, Gas and Minerals Division

Updated Permits

10/15/2018 THRU 10/19/2018



Permit Number Permittee Number Permittee Name

Page 25

13358 491 CONSUMERS ENERGY CO
1945 W PARNALL RD
JACKSON, MI 49201

API Well Number: 21-035-13358-00-00

Well Name: MICHIGAN GAS STORAGE CO
307

Approval Date: 10/12/2018

Location	QT QT QT	Sec	Township	Range	Township Name	County	Feet From Section Line	Feet From DRLG Unit
SL:	CNSESE	29	20N	6W	WINTERFIELD	CLARE	660 S 610 E	660 S 610 E

Proposed Rework: ACOWS for Miscellaneous

Comment: ACOWS to plugback to 1285', perforate, and return well back to service, expires 10/12/19.

13360 491 CONSUMERS ENERGY CO
1945 W PARNALL RD
JACKSON, MI 49201

API Well Number: 21-035-13360-00-00

Well Name: MICHIGAN GAS STORAGE CO
312

Approval Date: 10/12/2018

Location	QT QT QT	Sec	Township	Range	Township Name	County	Feet From Section Line	Feet From DRLG Unit
SL:	CNNWSE	29	20N	6W	WINTERFIELD	CLARE	660 N 660 W	660 N 660 W

Proposed Rework: ACOWS for Miscellaneous

Comment: ACOWS to plugback to 1310', perforate, and return well back to service, expires 10/12/19.

Michigan Department of Environmental Quality
Oil, Gas and Minerals Division

Updated Permits

10/15/2018 THRU 10/19/2018



Permit Number Permittee Number Permittee Name

Page 26

59995 7691 MERIDIAN RESOURCES LLC
4424 VOGEL ROAD
SUITE 404
EVANSVILLE, IN 47715

API Well Number: 21-059-59995-00-00

Well Name: ABRAHAM 1-6

Approval Date: 10/15/2018

Location	QT QT QT	Sec	Township	Range	Township Name	County	Feet From Section Line	Feet From DRLG Unit
SL:	NWSWSE	6	7S	1W	PITTSFORD	HILLSDALE	1015 S 2315 E	351 S 330 W

Proposed Rework: ACOWS for Miscellaneous

Comment: ACOWS to drill out CIBP at 3775' and test existing Black River perms at 3830'-3840'. Expires 10/15/19.

33112 7772 LAMBDA ENERGY RESOURCES LLC
12012 Wickchester
Suite 300
Houston, TX 77055 USA

API Well Number: 21-079-33112-02-00

Well Name: STATE KALKASKA "F" 2-24 HD-1 True Vertical Depth: 6698

Approval Date: 10/17/2018

Location	QT QT QT	Sec	Township	Range	Township Name	County	Feet From Section Line	Feet From DRLG Unit
SL:	SENWNW	24	27N	8W	KALKASKA	KALKASKA	704 N 707 W	
BHL:	NENWNW	24	27N	8W	KALKASKA	KALKASKA	660 N 925 W	

Proposed Rework: ACOWS to Perforate and Test Current Formation

Comment: ACOWS to temporarily abandon HD1 lateral and add perms in the A-1 Carbonate Fmn., expires 10/17/19.

Michigan Department of Environmental Quality
Oil, Gas and Minerals Division

Updated Permits

10/15/2018 THRU 10/19/2018



Permit Number Permittee Number Permittee Name

Page 27

60233 7772 LAMBDA ENERGY RESOURCES LLC
12012 Wickchester
Suite 300
Houston, TX 77055 USA

API Well Number: 21-079-60121-01-00

Well Name: STATE KALKASKA 3-24A True Vertical Depth: 6939

Approval Date: 10/17/2018

Location	QT QT QT	Sec	Township	Range	Township Name	County	Feet From Section Line	Feet From DRLG Unit
SL:	NESWNW	24	27N	8W	KALKASKA	KALKASKA	1483 N 1105 W	
BHL:	SENWNW	24	27N	8W	KALKASKA	KALKASKA	1230 N 1036 W	1230 N 1036 W

Proposed Rework: ACOWS to Perforate and Test Current Formation

Comment: ACOWS to temporarily abandon current perms, and add perms in the Niagaran Fmn., expires 10/17/19.

Michigan Department of Environmental Quality
Oil, Gas and Minerals Division

Updated Permits

10/15/2018 THRU 10/19/2018



Permit Number Permittee Number Permittee Name

RECORD OF CHANGE OF WELL STATUS:

13092 491 CONSUMERS ENERGY CO

1945 W PARNALL RD
JACKSON, MI 49201

API Well Number: 21-035-13092-00-00

Well Name: MICHIGAN GAS STORAGE CO
265

Change Date: 9/14/2018

Location	QT QT QT	Sec	Township	Range	Township Name	County	Feet From Section Line	Feet From DRLG Unit
SL:	CNSENE	3	20N	6W	WINTERFIELD	CLARE	660 S 660 E	660 S 660 E

Proposed Rework: Reworked for Miscellaneous

Comment: RCOWS for setting 5 1/2" csg. at 1261' and cementing.

13994 491 CONSUMERS ENERGY CO

1945 W PARNALL RD
JACKSON, MI 49201

API Well Number: 21-035-13994-00-00

Well Name: MICHIGAN GAS STORAGE
COMPANY 354

Change Date: 8/21/2018

Location	QT QT QT	Sec	Township	Range	Township Name	County	Feet From Section Line	Feet From DRLG Unit
SL:	CNSESE	1	20N	6W	WINTERFIELD	CLARE	660 S 660 E	660 S 660 E

Proposed Rework: Reworked for Miscellaneous

Comment: RCOWS for cementing 5 1/2" csg/liner inside 8 5/8" production string.

Michigan Department of Environmental Quality
Oil, Gas and Minerals Division

Updated Permits

10/15/2018 THRU 10/19/2018



Permit Number Permittee Number Permittee Name

TRANSFER OF OWNERSHIP:

29638 7772 LAMBDA ENERGY RESOURCES LLC
12012 Wickchester
Suite 300
Houston, TX 77055 USA

API Well Number: 21-055-29638-00-00

Well Name: PERCHA STATE BLAIR 1-25

Transfer Date: 9/1/2018

Previous Owner:

Location	QT QT QT	Sec	Township	Range	Township Name	County	Feet From Section Line	Feet From DRLG Unit
SL:	NWNWNE	25	26N	11W	BLAIR	GRAND TRAVERSE	540 N 117 W	

29638 7772 LAMBDA ENERGY RESOURCES LLC
12012 Wickchester
Suite 300
Houston, TX 77055 USA

API Well Number: 21-055-29638-01-00

Well Name: PERCHA STATE BLAIR 1-25 HD1 True Vertical Depth: 5918

Transfer Date: 9/1/2018

Previous Owner: MERIT ENERGY CO

Location	QT QT QT	Sec	Township	Range	Township Name	County	Feet From Section Line	Feet From DRLG Unit
SL:	NWNWNE	25	26N	11W	BLAIR	GRAND TRAVERSE	540 N 113 W	
BHL:	NENENW	25	26N	11W	BLAIR	GRAND TRAVERSE	582 N 84 E	582 N 1236 W

Michigan Department of Environmental Quality
Oil, Gas and Minerals Division

Updated Permits

10/15/2018 THRU 10/19/2018



Permit Number Permittee Number Permittee Name

29638 7772 LAMBDA ENERGY RESOURCES LLC
12012 Wickchester
Suite 300
Houston, TX 77055 USA

API Well Number: 21-055-29638-02-00

Well Name: PERCHA STATE BLAIR 1-25 HD2

Transfer Date: 9/1/2018

Previous Owner:

Location	QT QT QT	Sec	Township	Range	Township Name	County	Feet From Section Line	Feet From DRLG Unit
SL:	NWNWNE	25	26N	11W	BLAIR	GRAND TRAVERSE	540 N 113 W	
BHL:	SEWNNE	25	26N	11W	BLAIR	GRAND TRAVERSE	768 N 777 W	510 S 540 E

30504 7772 LAMBDA ENERGY RESOURCES LLC
12012 Wickchester
Suite 300
Houston, TX 77055 USA

API Well Number: 21-055-30504-00-00

Well Name: STEVENSON ET AL STATE
MAYFIELD 3-18

Transfer Date: 9/1/2018

Previous Owner: MERIT ENERGY CO

Location	QT QT QT	Sec	Township	Range	Township Name	County	Feet From Section Line	Feet From DRLG Unit
SL:	SWSWSE	18	25N	11W	MAYFIELD	GRAND TRAVERSE	460 S 621 W	460 S 700 E

Michigan Department of Environmental Quality
Oil, Gas and Minerals Division

Updated Permits

10/15/2018 THRU 10/19/2018



Permit Number Permittee Number Permittee Name

Page 31

39884 7772 LAMBDA ENERGY RESOURCES LLC
12012 Wickchester
Suite 300
Houston, TX 77055 USA

API Well Number: 21-055-32177-02-00

Well Name: PARCELS 2-9

Transfer Date: 9/1/2018

Previous Owner: MERIT ENERGY CO

Location	QT QT QT	Sec	Township	Range	Township Name	County	Feet From Section Line	Feet From DRLG Unit
SL:	NESESW	9	25N	12W	GRANT	GRAND TRAVERSE	721 S 487 E	721 S 487 E

37415 7772 LAMBDA ENERGY RESOURCES LLC
12012 Wickchester
Suite 300
Houston, TX 77055 USA

API Well Number: 21-055-37415-00-00

Well Name: STATE GRANT 1-16

Transfer Date: 9/1/2018

Previous Owner: MERIT ENERGY CO

Location	QT QT QT	Sec	Township	Range	Township Name	County	Feet From Section Line	Feet From DRLG Unit
SL:	SWNENW	16	25N	12W	GRANT	GRAND TRAVERSE	1200 N 742 E	1200 N 580 W

Michigan Department of Environmental Quality
Oil, Gas and Minerals Division

Updated Permits

10/15/2018 THRU 10/19/2018



Permit Number Permittee Number Permittee Name

37415 7772 LAMBDA ENERGY RESOURCES LLC
12012 Wickchester
Suite 300
Houston, TX 77055 USA

API Well Number: 21-055-37415-01-00

Well Name: STATE GRANT 1-16 HD1 True Vertical Depth: 5579

Transfer Date: 9/1/2018

Previous Owner: MERIT ENERGY CO

Location	QT QT QT	Sec	Township	Range	Township Name	County	Feet From Section Line	Feet From DRLG Unit
SL:	SWNENW	16	25N	12W	GRANT	GRAND TRAVERSE	1188 N 1899 W	
BHL:	NWNENW	16	25N	12W	GRANT	GRAND TRAVERSE	349 N 1686 W	349 N 366 W

56178 7772 LAMBDA ENERGY RESOURCES LLC
12012 Wickchester
Suite 300
Houston, TX 77055 USA

API Well Number: 21-055-44162-02-00

Well Name: SHUMSKY & STATE BLAIR 2-13B True Vertical Depth: 5823

Transfer Date: 9/1/2018

Previous Owner: MERIT ENERGY CO

Location	QT QT QT	Sec	Township	Range	Township Name	County	Feet From Section Line	Feet From DRLG Unit
SL:	NESESW	13	26N	11W	BLAIR	GRAND TRAVERSE	1004 S 2528 W	
BHL:	NWSESW	13	26N	11W	BLAIR	GRAND TRAVERSE	678 S 1797 W	678 S 485 W

Michigan Department of Environmental Quality
Oil, Gas and Minerals Division

Updated Permits

10/15/2018 THRU 10/19/2018



Permit Number Permittee Number Permittee Name

Page 33

47872 5230 MUZYL OIL CORP
PO BOX 673
GAYLORD, MI 49735

API Well Number: 21-137-47872-00-00

Well Name: KRAMEK B3-8

Transfer Date: 10/17/2018

Previous Owner: PAXTON RESOURCES LLC

Location	QT QT QT	Sec	Township	Range	Township Name	County	Feet From Section Line	Feet From DRLG Unit
SL:	NESWNE	8	30N	2W	CHESTER	OTSEGO	943 S 860 W	377 N 413 E