

**REMARKS:**  
 SHALLOW GROUNDWATER UNDERNEATH SOME PORTIONS OF MICHIGAN OPERATIONS IS KNOWN TO BE CONTAMINATED AS A RESULT OF PAST OPERATIONS AND DISPOSAL PRACTICES, PRIOR TO LICENSING. EXCEPT AS DESCRIBED BELOW, ALL GROUNDWATER CONTAMINATION RESULTING FROM HISTORICAL RELEASES AT THE FACILITY IS CONTAINED WITHIN THE FACILITY BOUNDARY. PURSUANT TO 40CFR 270.14(B)(19) AND R 299.9506(1)(G), THE DELINEATION OF PLUMES OF CONTAMINATION THAT HAVE ENTERED THE GROUNDWATER FROM A HAZARDOUS WASTE MANAGEMENT UNIT OR OTHER REGULATED ACTIVITY AT THE SITE WHERE CONTAMINATION HAS MIGRATED BEYOND THE FACILITY BOUNDARY ARE PRESENTED ON SEPARATE TOPOGRAPHIC MAPS, FIGURES III.67 THROUGH III.74, INCLUDED WITH THE FORM EOP 5111 ATTACHMENT XIV.B3: UPDATE TO THE HYDROGEOLOGIC REPORT DATED JUNE 5, 2013.

AS REQUIRED BYR 299.9506(1)(F), THE LOCATIONS OF ALL OF THE DOMESTIC, MUNICIPAL, INDUSTRIAL, OIL, AND GAS WELLS LISTED IN PUBLIC RECORDS OR OTHERWISE KNOWN TO THE APPLICANT WITHIN 1 MILE OF THE FACILITY BOUNDARY ARE PRESENTED IN THE RCRA PART A MAP (DRAWING B2-010-97122). ALSO INDICATED ON THE MAP ARE LOCATIONS WHERE PROPERTIES ARE CONNECTED TO THE MUNICIPAL WATER SUPPLY, BUT NO WELL CLOSURE RECORD COULD BE LOCATED.

DA/E TWR		JDD		TWR		IN CHARGE		DATE		ISSUED FOR	
DR	CK	APP	DR	CK	APP	DR	CK	APP	DR	CK	APP

SOUTHFIELD, MI  
 27777 FRANKLIN ROAD  
 AMERICAN CENTER BLDG.  
 248 204-3900

**URS**

THE DOW CHEMICAL COMPANY  
 MICHIGAN OPERATIONS

**DOW**

DRAWING  
 B2-004-41569891

FILE  
 41569891

Copyright © 2014 URS Corporation, Inc. All Rights Reserved.

**SITE TOPOGRAPHIC MAP**



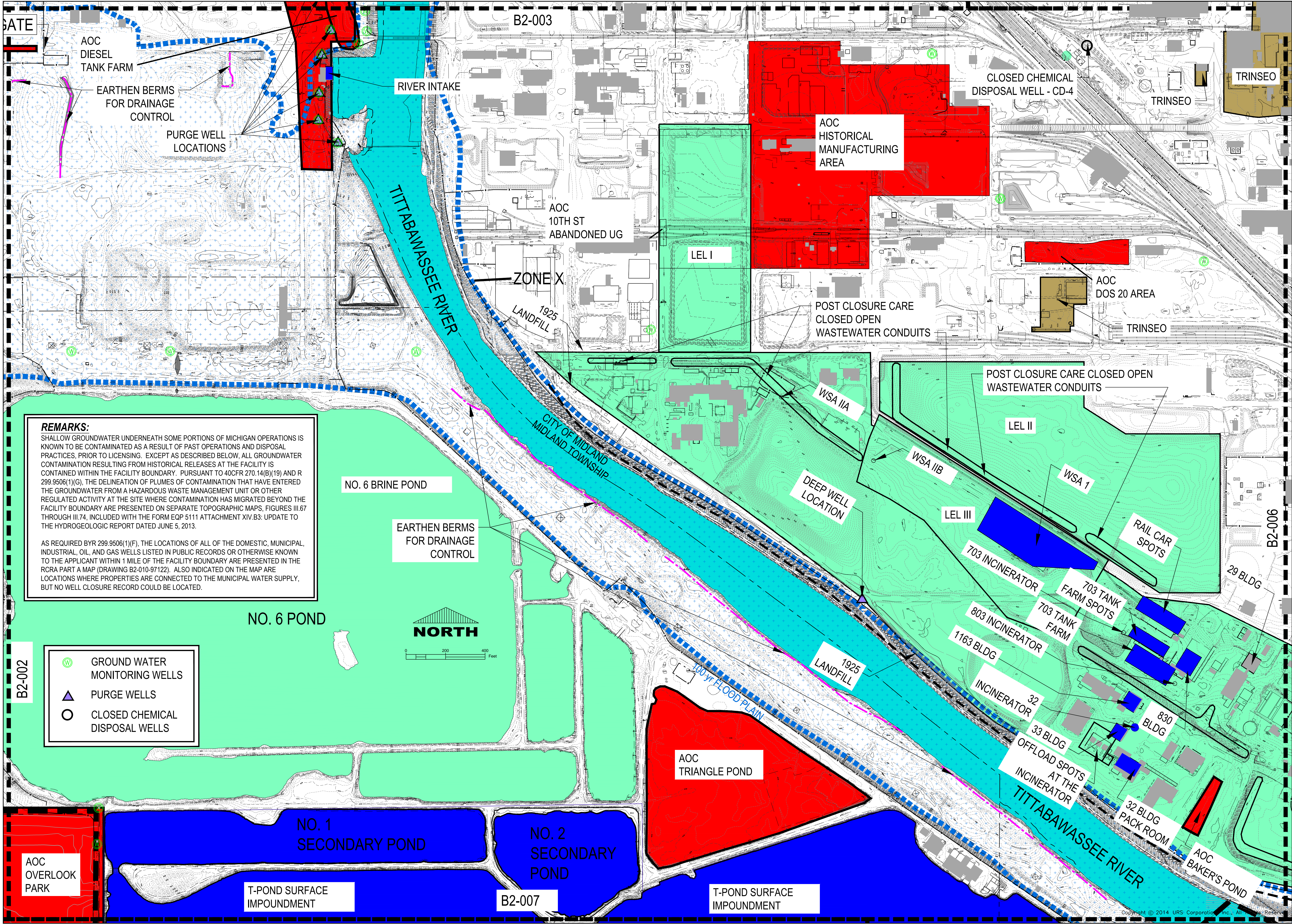

DA/E	TWR	JDD	CK	TWR	APP	IN CHARGE	ISSUED FOR
03/20/2015	03/20/2015	03/20/2015	03/20/2015	03/20/2015	03/20/2015	03/20/2015	03/20/2015
03/20/2015	03/20/2015	03/20/2015	03/20/2015	03/20/2015	03/20/2015	03/20/2015	03/20/2015
03/20/2015	03/20/2015	03/20/2015	03/20/2015	03/20/2015	03/20/2015	03/20/2015	03/20/2015

DA/E	TWR	JDD	CK	TWR	APP	IN CHARGE	ISSUED FOR
03/20/2015	03/20/2015	03/20/2015	03/20/2015	03/20/2015	03/20/2015	03/20/2015	03/20/2015
03/20/2015	03/20/2015	03/20/2015	03/20/2015	03/20/2015	03/20/2015	03/20/2015	03/20/2015
03/20/2015	03/20/2015	03/20/2015	03/20/2015	03/20/2015	03/20/2015	03/20/2015	03/20/2015

SOUTHFIELD, MI  
27777 FRANKLIN ROAD,  
AMERICAN CENTER BLDG.  
248 204-3500

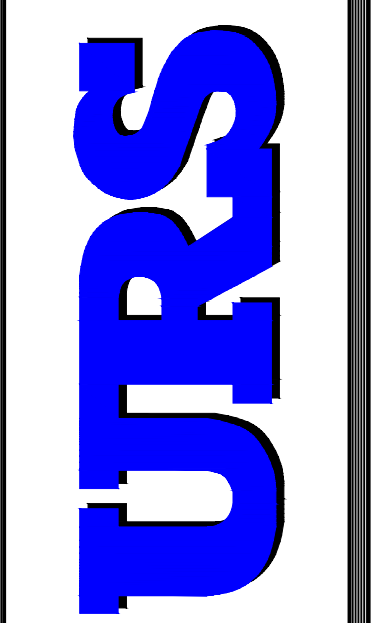

THE DOW CHEMICAL COMPANY  
MICHIGAN OPERATIONS  
SITE TOPOGRAPHIC MAP

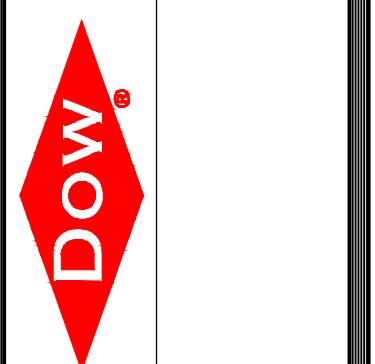

DRAWING  
B2-005-41569891

FILE  
41569891



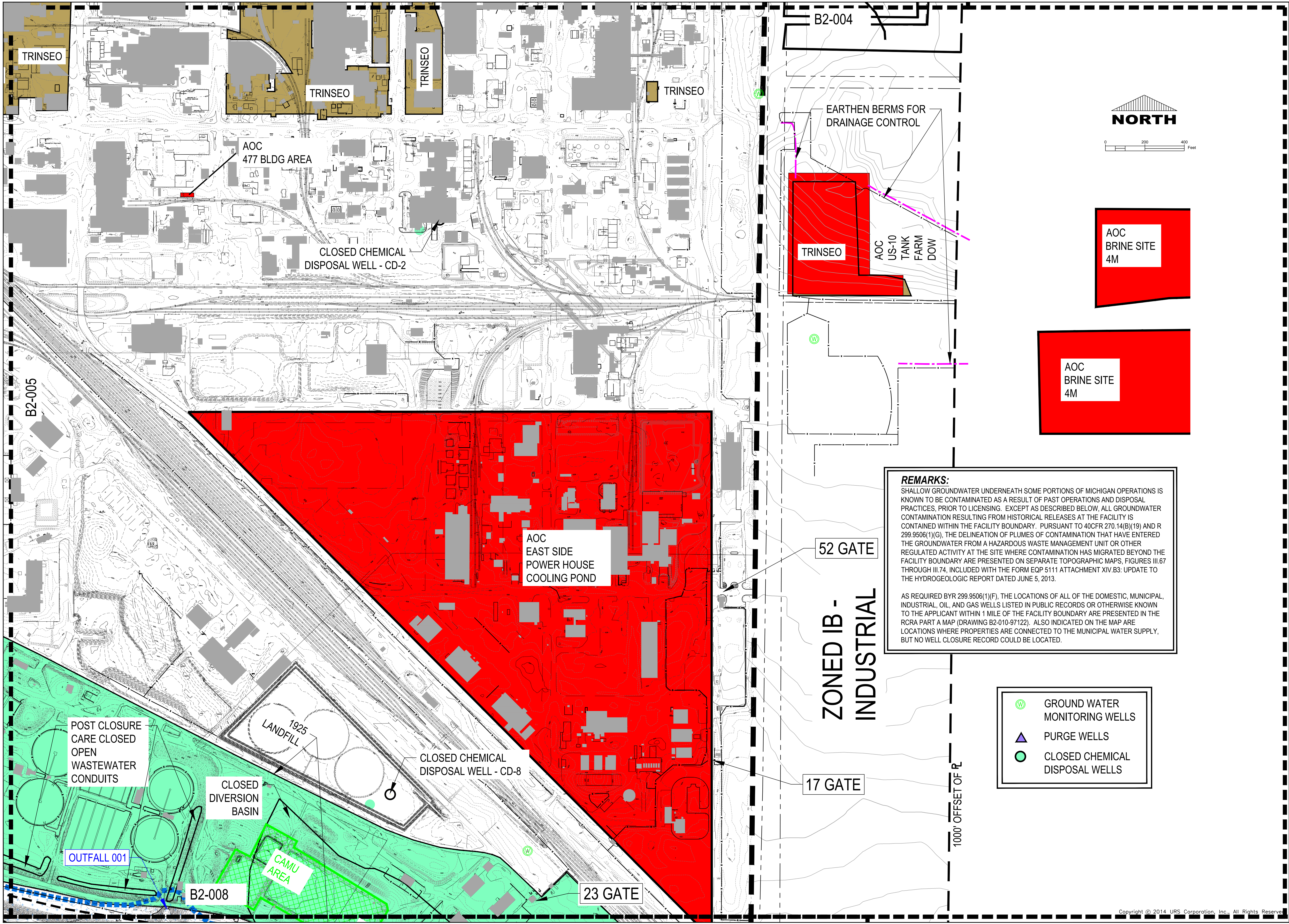

REVISIONS

NO.	DATE	BY	APP.	DESCRIPTION
001	03/20/2014	JDD		ISSUED FOR PERMIT
002	03/20/2014	JDD		ISSUED FOR PERMIT
003	03/20/2014	JDD		ISSUED FOR PERMIT
004	03/20/2014	JDD		ISSUED FOR PERMIT

DATE

ISSUED FOR

DA/E TWR

DR

JDD

CK

TWR

APP

IN CHARGE

SOUTHFIELD, MI  
27777 FRANKLIN ROAD  
AMERICAN CENTER BLDG.  
248 204-3500

**URS**

THE DOW CHEMICAL COMPANY  
MICHIGAN OPERATIONS

**DOW**

SITE TOPOGRAPHIC MAP

DRAWING

B2-006-41569891

FILE

41569891

Copyright © 2014 URS Corporation, Inc., All Rights Reserved