



Parcels in High Risk Erosion Areas of Baraga Township, Baraga County

Date of Designation: March 14, 2018

Parcel Identification No.	Address	HREA*	Rate (feet/year)	30 yr PRD*	60 yr PRD*
07-002-052-005-00	Des Rochers Road	A1	1.3	55	95
07-002-003-002-00	US 41 - State of Michigan	B1	2.4	85	160
07-002-010-004-00	US 41 - State of Michigan	C1	1.7	65	115
07-002-010-005-51	14843 US 41	C1	1.7	65	115

HREA* - Some parcels may be in multiple HREAs due to their large size.

30 yr PRD* is the Projected Recession Distance (feet) landward from the Erosion Hazard Line for readily moveable structures including those structures 3,500 square feet or less and built on a basement, crawlspace or pilings. Additional restrictions may apply per Administrative Rules 281.21-22.

60 yr PRD* is the Projected Recession Distance (feet) landward from the Erosion Hazard Line for non-readily moveable structures such as large structures and septic systems.

Designation runs with the land including subsequent splits. Absence of a property number does not guarantee the property is located outside of an HREA. Contact Great Lakes Shorelands staff, Water Resources Division, EGLE in Lansing or the local EGLE field office for assistance.

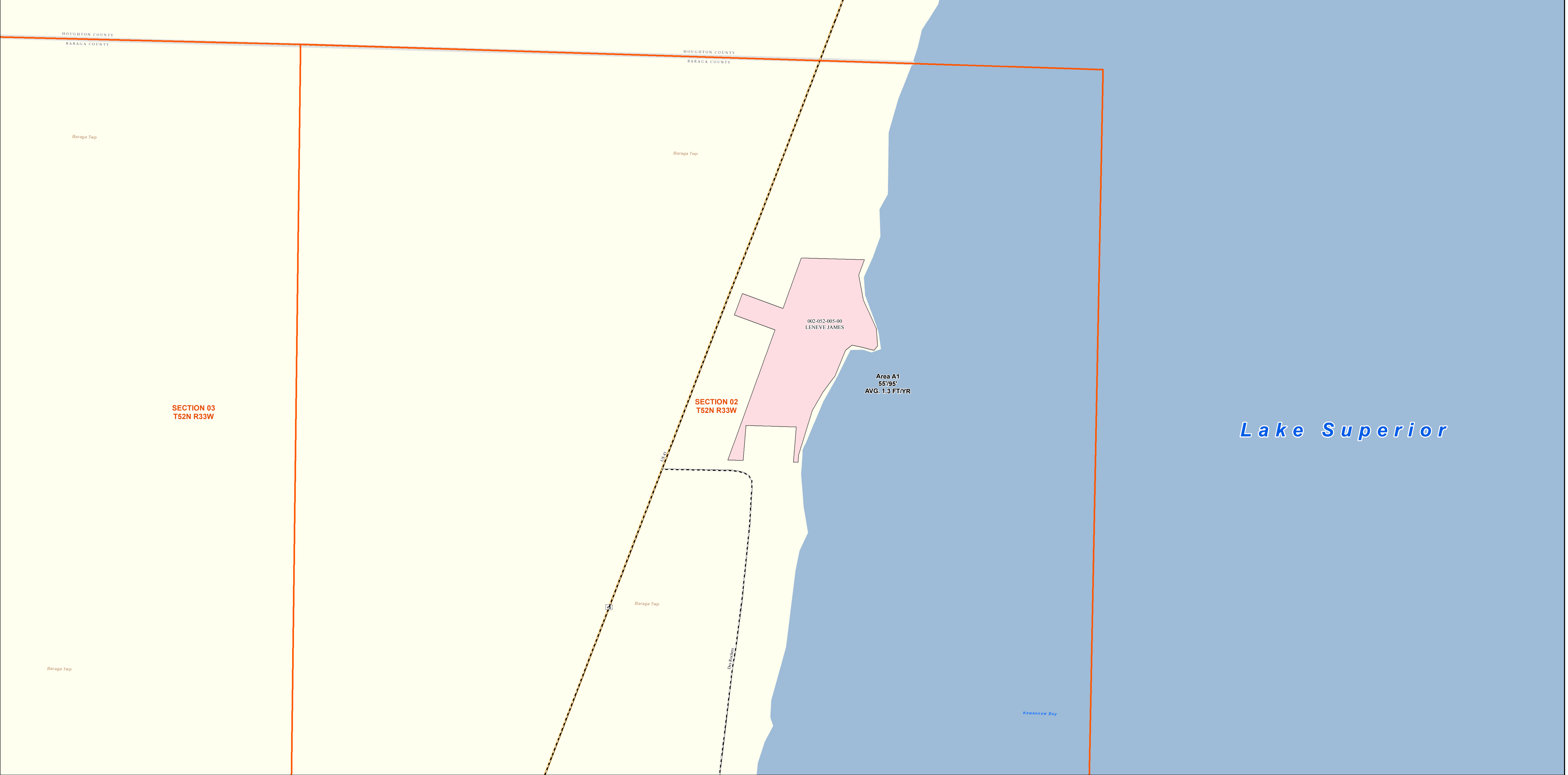

High-Risk Erosion Area Update - 2017

Baraga Township, Baraga County
T52N, R33W Section 02

South of Houghton County Line

High Risk Erosion Areas
30 YR/60 YR Projected Recession Distance (Feet)
Average Annual Rate of Recession (FT/YR)

AREA A1: 55'/95' (Avg. 1.3 FT/YR)

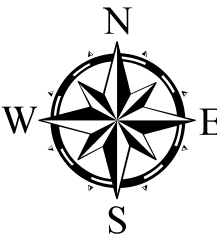

0 280 560 840 Feet

1 inch = 250 feet

--- Roads

Sections

HREA Parcels

MAP INFORMATION:

This map identifies potential High-Risk Erosion Areas under Part 323, Shorelands Protection and Management, of the Natural Resources and Environmental Protection Act, 1994 PA 451, as amended. The shaded areas indicate recession of at least one foot per year.

Background imagery, as well as roads and survey data were provided by the State of Michigan, Center for Shared Solutions and Technology Partnerships.

Questions regarding this map should be directed to the Michigan Department of Environmental Quality at 517-284-5567.

Disclaimer:
The data utilized herein has been obtained and utilized under license from Baraga County, Michigan. Said data is copyright protected and further reproduction without the express, written consent of Baraga County is prohibited by federal and international law. No warranty is offered regarding the accuracy of this data. © Baraga County, Michigan. All rights reserved.

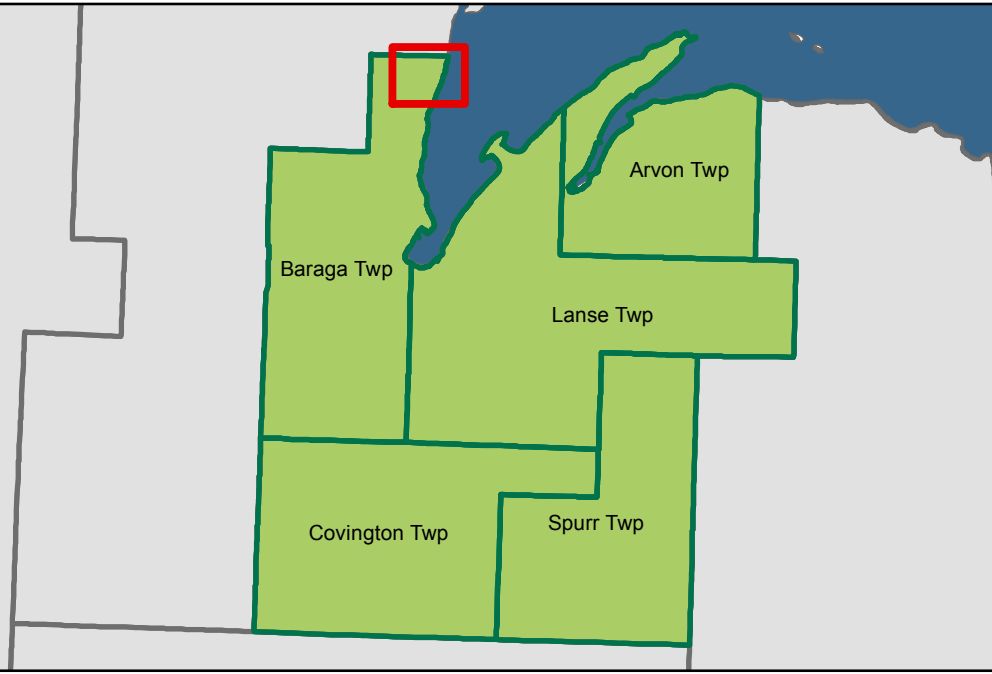

Map Created by: Jeremy Jones
Environmental Quality Analyst
Water Resources Division
Michigan Department Of Environmental Quality
9/14/2017

Recession/Accretion values for each area were calculated using the Digital Shoreline Analysis System from the USGS (Thieler, E.R., Himmelstoss, E.A., Zichichi, J.L., and Ergul, Ayhan, 2009, Digital Shoreline Analysis System (DSAS) version 4.0 - An ArcGIS extension for calculating shoreline change: U.S. Geological Survey Open-File Report 2008-127).

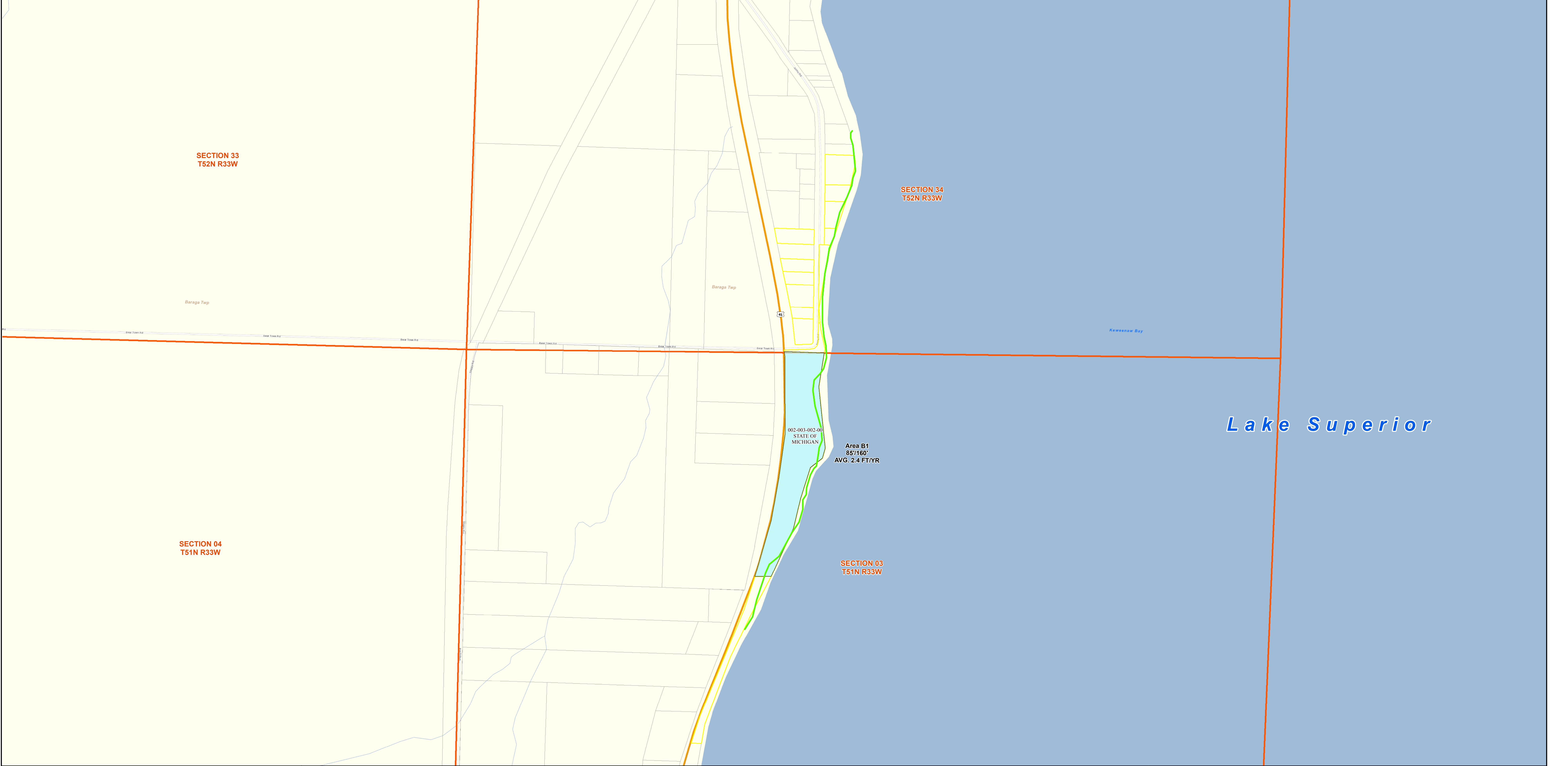

**High-Risk Erosion
Area Update - 2017**





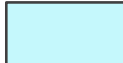

Baraga Township, Baraga County
T51N, R33W Section 03

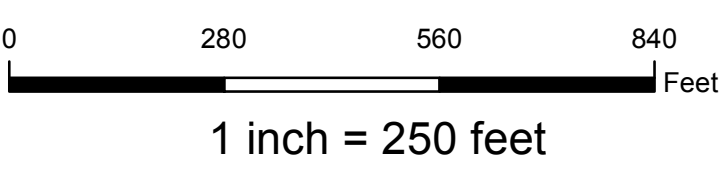
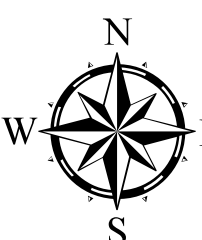
South of Beartown Road

High Risk Erosion Areas
30 YR/60 YR Projected Recession Distance (Feet)
Average Annual Rate of Recession (FT/YR)

 AREA B1: 85°160' (Avg. 2.4 FT/YR)



 Roads	 1983 HREAs (approximate)
 Sections	 De-Designated Parcels
 HREA Parcels	 Parcels

MAP INFORMATION:

This map identifies potential High-Risk Erosion Areas under Part 323, Shorelands Protection and Management, of the Natural Resources and Environmental Protection Act, 1994 PA 451, as amended. The shaded areas indicate recession of at least one foot per year.

Background imagery, as well as roads and survey data were provided by the State of Michigan, Center for Shared Solutions and Technology Partnerships.

Questions regarding this map should be directed to the Michigan Department of Environmental Quality at 517-284-5567.

Disclaimer:
The data utilized herein has been obtained and utilized under license from Baraga County, Michigan. Said data is copyright protected and further reproduction without the express, written consent of Baraga County is prohibited by federal and international law. No warranty is offered regarding the accuracy of this data. © Baraga County, Michigan. All rights reserved.

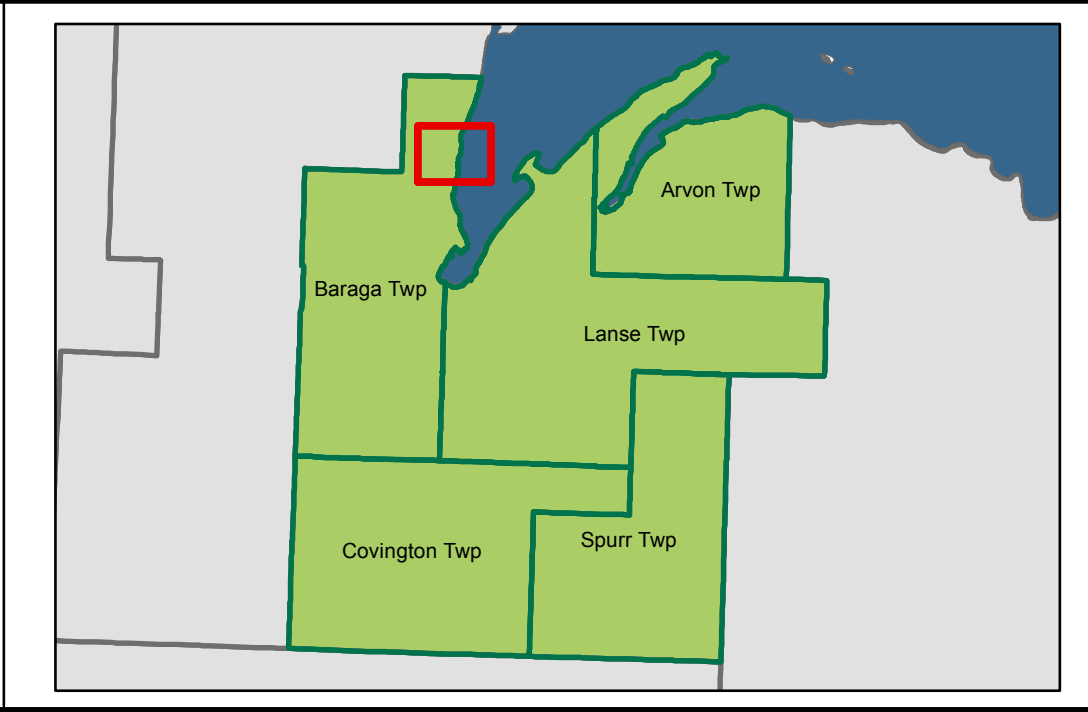



Map Created by: Jeremy Jones
Environmental Quality Analyst
Water Resources Division
Michigan Department Of Environmental Quality
9/14/2017

Recession/Accretion values for each area were calculated using the Digital Shoreline Analysis System from the USGS (Thieler, E.R., Himmelstoss, E.A., Zichichi, J.L., and Ergul, Ayhan, 2009, Digital Shoreline Analysis System (DSAS) version 4.0 - An ArcGIS extension for calculating shoreline change: U.S. Geological Survey Open-File Report 2008-127).

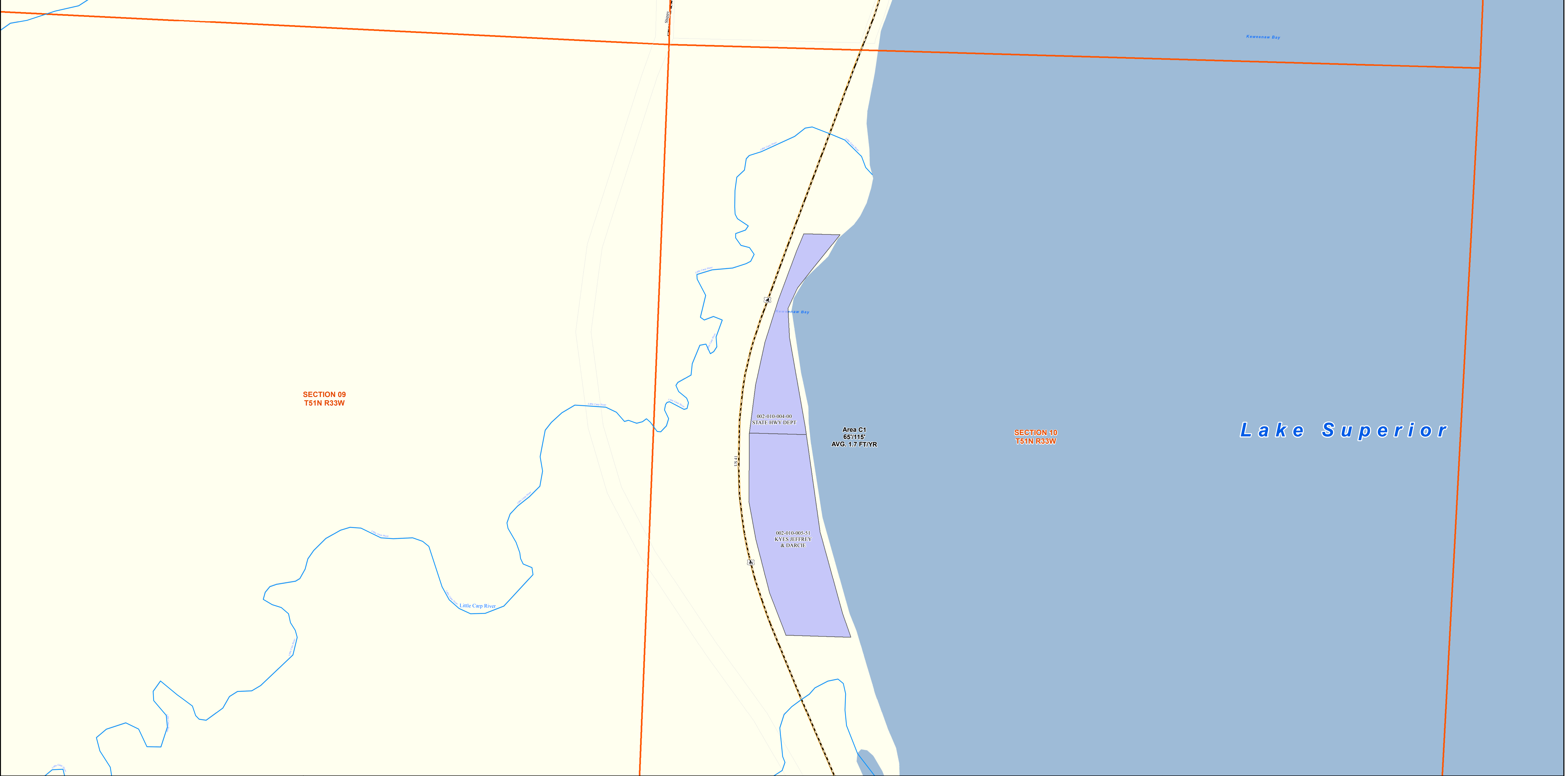

High-Risk Erosion Area Update - 2017

Baraga Township, Baraga County
T51N, R33W Section 10

South of Little Carp Creek

High Risk Erosion Areas
30 YR/60 YR Projected Recession Distance (Feet)
Average Annual Rate of Recession (FT/YR)

AREA C1: 65/115' (Avg. 1.7 FT/YR)

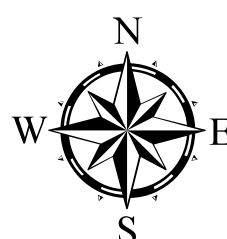

0 280 560 840 Feet

1 inch = 250 feet

--- Roads

Sections

HREA Parcels

MAP INFORMATION:

This map identifies potential High-Risk Erosion Areas under Part 323, Shorelands Protection and Management, of the Natural Resources and Environmental Protection Act, 1994 PA 451, as amended. The shaded areas indicate recession of at least one foot per year.

Background imagery, as well as roads and survey data were provided by the State of Michigan, Center for Shared Solutions and Technology Partnerships.

Questions regarding this map should be directed to the Michigan Department of Environmental Quality at 517-284-5567.

Disclaimer:
The data utilized herein has been obtained and utilized under license from Baraga County, Michigan. Said data is copyright protected and further reproduction without the express, written consent of Baraga County is prohibited by federal and international law. No warranty is offered regarding the accuracy of this data. © Baraga County, Michigan. All rights reserved.

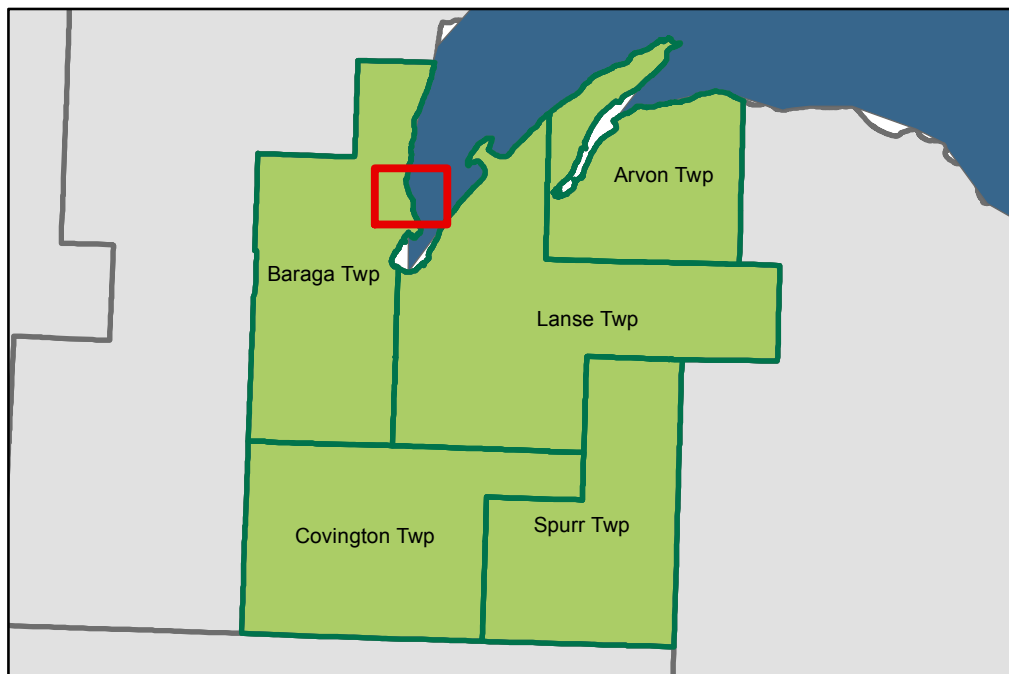

Map Created by: Jeremy Jones
Environmental Quality Analyst
Water Resources Division
Michigan Department Of Environmental Quality
9/14/2017

Recession/Accretion values for each area were calculated using the Digital Shoreline Analysis System from the USGS (Thieler, E.R., Himmelstoss, E.A., Zichichi, J.L., and Ergul, Ayhan, 2009, Digital Shoreline Analysis System (DSAS) version 4.0 - An ArcGIS extension for calculating shoreline change: U.S. Geological Survey Open-File Report 2008-127).