

BLISS TOWNSHIP EAST

HIGH RISK EROSION AREAS & CRITICAL DUNE AREAS

EMMET COUNTY

T39N,R5W

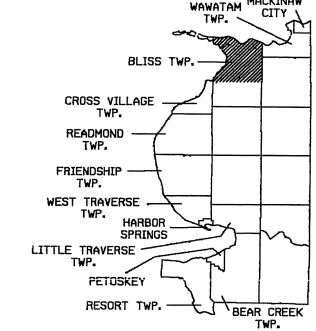

HIGH RISK EROSION AREAS

THE NUMBER REPRESENTS, IN FEET, THE
30 YEAR PROJECTED RECESSION DISTANCE.
THE NUMBER REPRESENTS, IN FEET, THE
60 YEAR PROJECTED RECESSION DISTANCE.

HIGH RISK EROSION AREA
(shading alongshore)

THESE AREAS ARE LEGALLY DEFINED BY THE
SHORELANDS PROTECTION AND MANAGEMENT ACT,
1970 P.A. 245, AS AMENDED, AS BEING GREAT
LAKES SHORELAND AREAS DOCUMENTED TO REcede
AN AVERAGE OF ONE FOOT OR MORE PER YEAR.

CRITICAL DUNE AREAS

BARRIER DUNES
BARRIER DUNE FORMATIONS DESIGNATED
PURSUANT TO 1976 P.A. 222

**AREAS NOT INCLUDED IN DESIGNATED
BARRIER DUNE FORMATIONS THAT ARE
COMPOSED PRIMARILY OF DUNE SAND
AND EXHIBIT SEVERAL DUNE-LIKE
CHARACTERISTICS.**

**EXEMPLARY DUNE ASSOCIATED PLANT
COMMUNITIES OUTSIDE DESIGNATED
DUNE FORMATIONS. MICHIGAN NATURAL
FEATURES INVENTORY REFERENCE CODE
INDICATED.**

SOURCE

STATE OF MICHIGAN ACT 245 RECESSION
RATE MAPS & ATLAS OF CRITICAL DUNE AREAS

INFORMATION

MICHIGAN DEPARTMENT OF NATURAL RESOURCES
LAND AND WATER MANAGEMENT DIVISION
P.O. BOX 30028
LANSING, MI 48909
(517) 373-1950

Gis

GREAT LAKES INFORMATION SYSTEM
MICHIGAN DEPARTMENT OF NATURAL RESOURCES
LAND AND WATER MANAGEMENT DIVISION

02-10-93

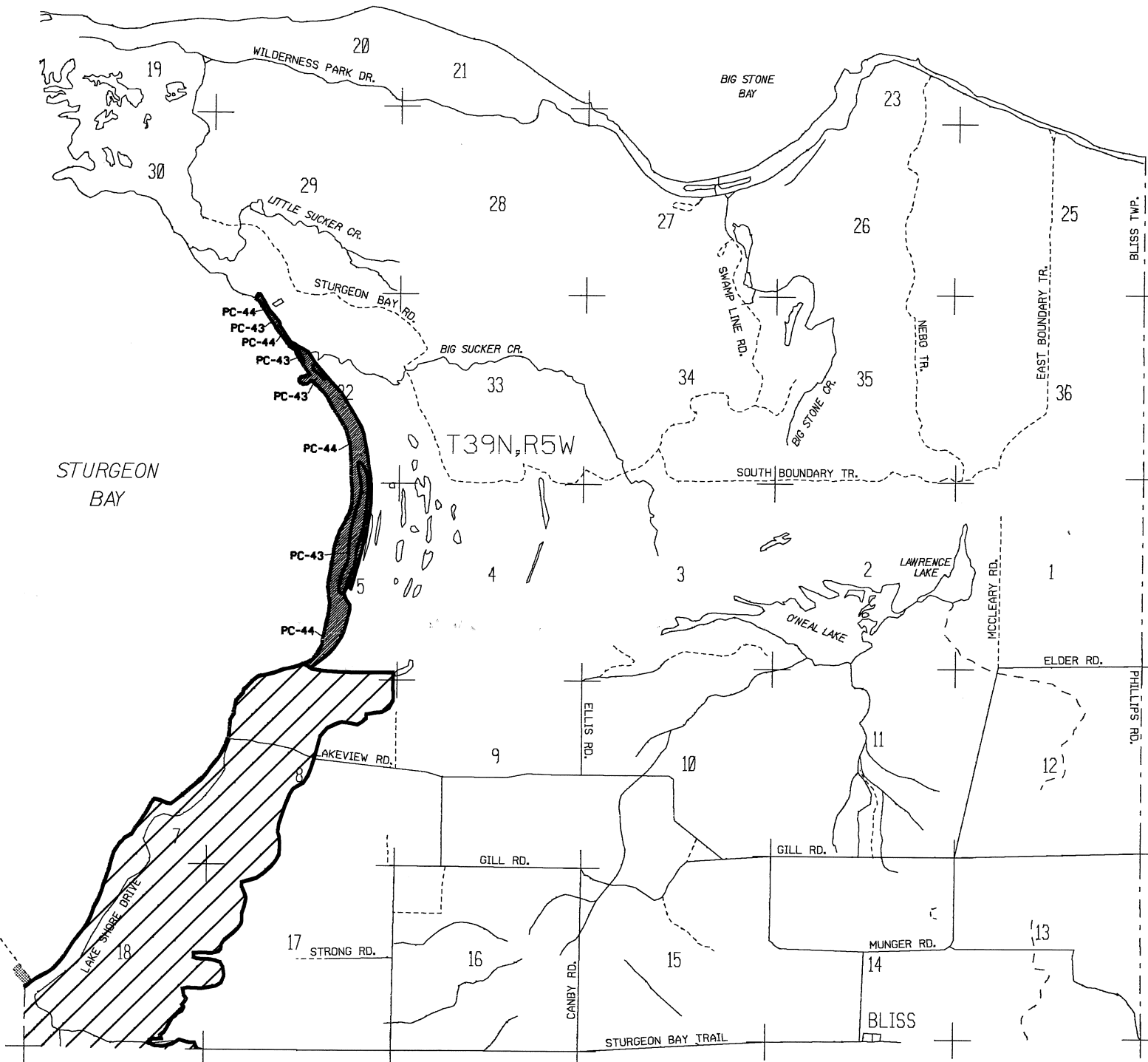
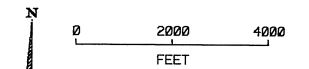

**BLISS
TOWNSHIP WEST**

**HIGH RISK EROSION AREAS &
CRITICAL DUNE AREAS**

EMMET COUNTY

T39N,R6W

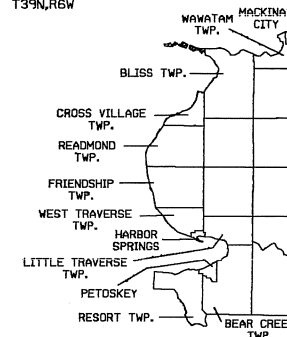

**NO RATE STUDIES
DONE FOR ISLANDS**

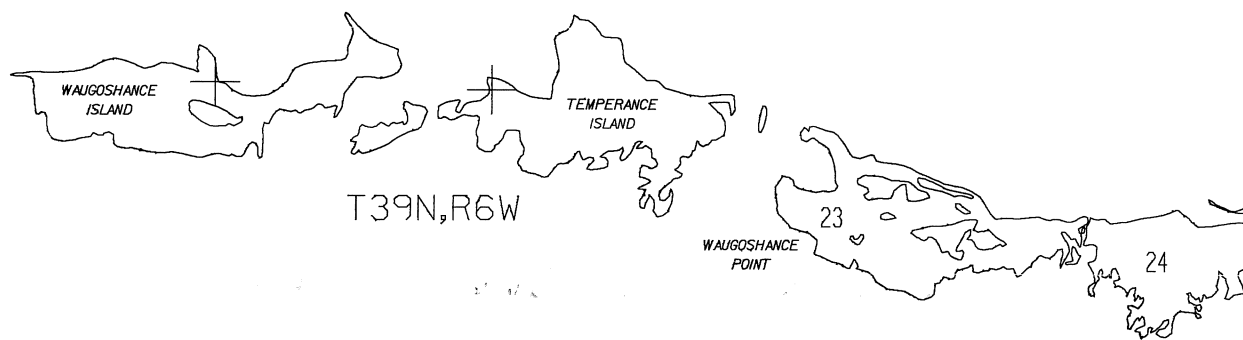

**NO CRITICAL DUNE AREAS
IN THIS PART OF TOWNSHIP**

HIGH RISK EROSION AREAS

THE NUMBER REPRESENTS, IN FEET, THE
60⁺ 30 YEAR PROJECTED RECESSION DISTANCE.
105⁺ THE NUMBER REPRESENTS, IN FEET, THE
60 YEAR PROJECTED RECESSION DISTANCE.

HIGH RISK EROSION AREA
(shading alongshore)

THESE AREAS ARE LEGALLY DEFINED BY THE
SHORELANDS PROTECTION AND MANAGEMENT ACT,
1970 P.A. 245, AS AMENDED, AS BEING GREAT
LAKES SHORELAND AREAS DOCUMENTED TO RECEDE
AN AVERAGE OF ONE FOOT OR MORE PER YEAR.

CRITICAL DUNE AREAS

BARRIER DUNES
BARRIER DUNE FORMATIONS DESIGNATED
PURSUANT TO 1976 P.A. 222

**AREAS NOT INCLUDED IN DESIGNATED
BARRIER DUNE FORMATIONS THAT ARE
COMPOSED PRIMARILY OF DUNE SAND
AND EXHIBIT SEVERAL DUNE-LIKE
CHARACTERISTICS.**

**EXEMPLARY DUNE ASSOCIATED PLANT
COMMUNITIES OUTSIDE DESIGNATED
DUNE FORMATIONS, MICHIGAN NATURAL
FEATURES INVENTORY REFERENCE CODE
INDICATED.**

SOURCE

STATE OF MICHIGAN ACT 245 RECESSION
RATE MAPS & ATLAS OF CRITICAL DUNE AREAS

INFORMATION

MICHIGAN DEPARTMENT OF NATURAL RESOURCES
LAND AND WATER MANAGEMENT DIVISION
P.O. BOX 30028
LANSING, MI 48909
(517) 373-1950

Glis

GREAT LAKES INFORMATION SYSTEM
MICHIGAN DEPARTMENT OF NATURAL RESOURCES
LAND AND WATER MANAGEMENT DIVISION

02-10-93

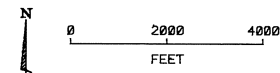

Parcels in High Risk Erosion Areas of Bliss Township, Emmet County

HREAs identified North to South Date of Designation: March 11, 1993

HREA*	Sequence No.	Parcel Identification Number	Rate (feet/year)	30 yr PRD*	60 yr PRD*
A1	1	24-02-05-18-200-003 MDNR - Wilderness State Park	1.3	55	95

HREA* - Some parcels may be in multiple HREAs due to their large size.

30 yr PRD* is the Projected Recession Distance (feet) landward from the Erosion Hazard Line for readily moveable structures including those structures 3,500 square feet or less and built on a basement, crawlspace or pilings. Additional restrictions may apply per Administrative Rules 281.21-22.

60 yr PRD* is the Projected Recession Distance (feet) landward from the Erosion Hazard Line for non-readily moveable structures such as large structures and septic systems.

Designation runs with the land including subsequent splits. Absence of a property number does not guarantee the property is located outside of an HREA. Contact the Great Lakes Shorelands Unit, Water Resources Division, DEQ in Lansing or the local DEQ field office for assistance.