

LEELANAU TOWNSHIP NORTH

HIGH RISK EROSION AREAS & CRITICAL DUNE AREAS

LEELANAU COUNTY

T32N,R11W

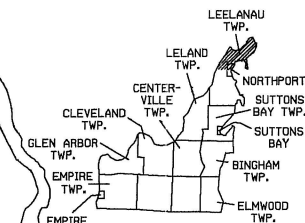

HIGH RISK EROSION AREAS

THE NUMBER REPRESENTS, IN FEET, THE 30 YEAR PROJECTED RECESSION DISTANCE.
 60' 30 YEAR PROJECTED RECESSION DISTANCE.
 105' 60 YEAR PROJECTED RECESSION DISTANCE.

HIGH RISK EROSION AREA
 (shading alongshore)

THESE AREAS ARE LEGALLY DEFINED BY THE SHORELANDS PROTECTION AND MANAGEMENT ACT, 1970 P.A. 245, AS AMENDED, AS BEING GREAT LAKES SHORELAND AREAS DOCUMENTED TO RECEDE AN AVERAGE OF ONE FOOT OR MORE PER YEAR.

CRITICAL DUNE AREAS

BARRIER DUNES
 BARRIER DUNE FORMATIONS DESIGNATED PURSUANT TO 1976 P.A. 222

AREAS NOT INCLUDED IN DESIGNATED BARRIER DUNE FORMATIONS THAT ARE COMPOSED PRIMARILY OF DUNE SAND AND EXHIBIT SEVERAL DUNE-LIKE CHARACTERISTICS.

EXEMPLARY DUNE ASSOCIATED PLANT COMMUNITIES OUTSIDE DESIGNATED DUNE FORMATIONS. MICHIGAN NATURAL FEATURES INVENTORY REFERENCE CODE INDICATED.

SOURCE

STATE OF MICHIGAN ACT 245 RECESSION RATE MAPS & ATLAS OF CRITICAL DUNE AREAS

INFORMATION

MICHIGAN DEPARTMENT OF NATURAL RESOURCES
 LAND AND WATER MANAGEMENT DIVISION
 P.O. BOX 30826
 LANSING, MI 48909
 (517) 373-1950

Gis

GREAT LAKES INFORMATION SYSTEM
 MICHIGAN DEPARTMENT OF NATURAL RESOURCES
 LAND AND WATER MANAGEMENT DIVISION

02-17-93

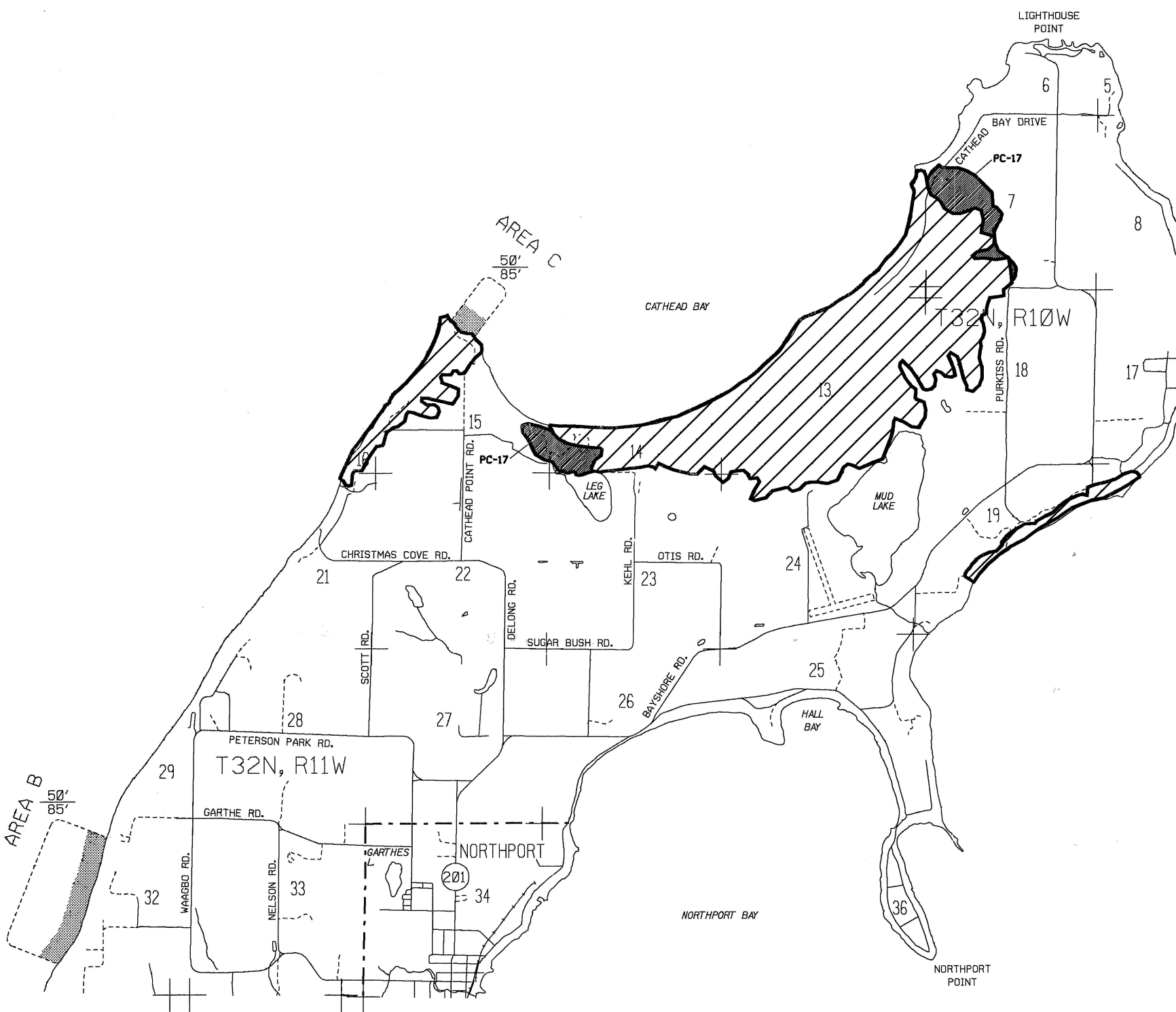
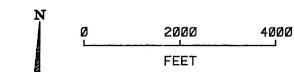

HIGH RISK EROSION AREAS & CRITICAL DUNE AREAS

T31N,R11W

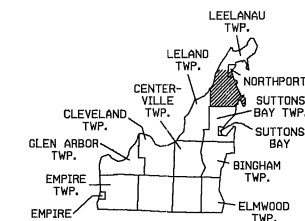

HIGH RISK EROSION AREAS

THE NUMBER REPRESENTS, IN FEET, THE
30 YEAR PROJECTED RECESION DISTANCE.
 $\frac{60'}{105'}$ THE NUMBER REPRESENTS, IN FEET, THE
60 YEAR PROJECTED RECESION DISTANCE.

 HIGH RISK EROSION AREA
(shading alongshore)

THESE AREAS ARE LEGALLY DEFINED BY THE SHORELANDS PROTECTION AND MANAGEMENT ACT, 1970 P.A. 245, AS AMENDED, AS BEING GREAT LAKES SHORELAND AREAS DOCUMENTED TO RECEDE AN AVERAGE OF ONE FOOT OR MORE PER YEAR.

CRITICAL DUNE AREAS



BARRIER DUNES

BARRIER DUNE FORMATIONS DESIGNATED
PURSUANT TO 1976 P.A. 222



AREAS NOT INCLUDED IN DESIGNATED BARRIER DUNE FORMATIONS THAT ARE COMPOSED PRIMARILY OF DUNE SAND AND EXHIBIT SEVERAL DUNE-LIKE CHARACTERISTICS.



EXEMPLARY DUNE ASSOCIATED PLANT COMMUNITIES OUTSIDE DESIGNATED DUNE FORMATIONS. MICHIGAN NATURAL FEATURES INVENTORY REFERENCE CODE INDICATED.

SOURCE

STATE OF MICHIGAN ACT 245 RECESSION
RATE MAPS & ATLAS OF CRITICAL DUNE AREAS

INFORMATION

MICHIGAN DEPARTMENT OF NATURAL RESOURCES
LAND AND WATER MANAGEMENT DIVISION
P.O. BOX 30028
LANSING, MI 48909
(517) 373-1950

Glis

GREAT LAKES INFORMATION SYSTEM
MICHIGAN DEPARTMENT OF NATURAL RESOURCES
LAND AND WATER MANAGEMENT DIVISION

02-17-93

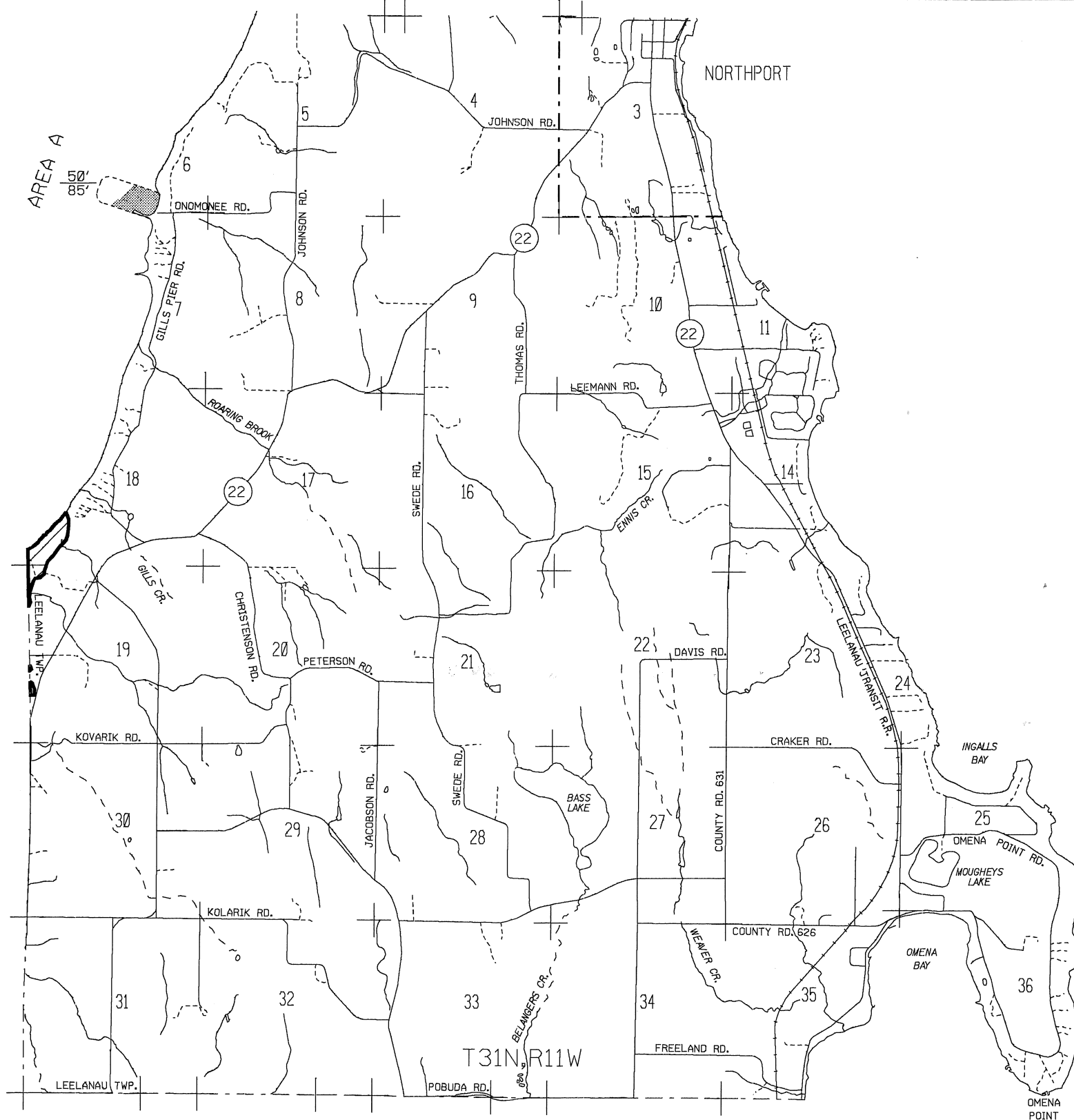
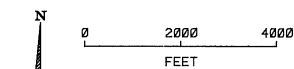



Parcels in High Risk Erosion Areas of Leelanau Township, Leelanau County

Date of Designation: March 11, 1993

Parcel Identification No.	Address	HREA*	Rate (feet/year)	30 yr PRD*	60 yr PRD*
45-008-106-007-00	9155 N Onominese Trail	A1	1.2	50	85
45-008-106-013-00	9121 N Onominese Trail	A1	1.2	50	85
45-008-106-006-00	9071 N Onominese Trail	A1	1.2	50	85
45-008-106-006-10	N Onominese Trail	A1	1.2	50	85
45-008-232-009-00	9600 E Seth Road	B1	1.2	50	85
45-008-232-011-00	9620 E Seth Road	B1	1.2	50	85
45-008-232-010-41	9624 E Seth Road	B1	1.2	50	85
45-008-232-010-40	9632 E Seth Road	B1	1.2	50	85
45-008-232-010-10	9636 E Seth Road	B1	1.2	50	85
45-008-232-010-20	9640 E Seth Road	B1	1.2	50	85
45-008-232-010-30	9656 E Seth Road	B1	1.2	50	85
45-008-232-012-00	9631 E Seth Road	B1	1.2	50	85
45-008-232-012-01	9627 E Seth Road	B1	1.2	50	85
45-008-232-013-00	9615 E Seth Road	B1	1.2	50	85
45-008-232-016-00	E Seth Road	B1	1.2	50	85
45-008-232-014-00	E Seth Road	B1	1.2	50	85
45-008-350-016-00	N Cathead Point Road	C1	1.2	50	85
45-008-350-015-00	N Cathead Point Road	C1	1.2	50	85
45-008-350-014-00	N Cathead Point Road	C1	1.2	50	85

HREA* - Some parcels may be in multiple HREAs due to their large size.

30 yr PRD* is the Projected Recession Distance (feet) landward from the Erosion Hazard Line for readily moveable structures including those structures 3,500 square feet or less and built on a basement, crawlspace or pilings. Additional restrictions may apply per Administrative Rules 281.21-22.

60 yr PRD* is the Projected Recession Distance (feet) landward from the Erosion Hazard Line for non-readily moveable structures such as large structures and septic systems.

Designation runs with the land including subsequent splits. Absence of a property number does not guarantee the property is located outside of an HREA. Contact Great Lakes Shorelands staff, Water Resources Division, EGLE in Lansing or the local EGLE field office for assistance.



Parcels in High Risk Erosion Areas of Leelanau Township, Leelanau County

Date of Designation: March 11, 1993

Parcel Identification No.	Address	HREA*	Rate (feet/year)	30 yr PRD*	60 yr PRD*
45-008-215-008-02	13911 N Cathead Point Road	C1	1.2	50	85

HREA* - Some parcels may be in multiple HREAs due to their large size.

30 yr PRD* is the Projected Recession Distance (feet) landward from the Erosion Hazard Line for readily moveable structures including those structures 3,500 square feet or less and built on a basement, crawlspace or pilings. Additional restrictions may apply per Administrative Rules 281.21-22.

60 yr PRD* is the Projected Recession Distance (feet) landward from the Erosion Hazard Line for non-readily moveable structures such as large structures and septic systems.

Designation runs with the land including subsequent splits. Absence of a property number does not guarantee the property is located outside of an HREA. Contact Great Lakes Shorelands staff, Water Resources Division, EGLE in Lansing or the local EGLE field office for assistance.