



GRETCHEN WHITMER  
GOVERNOR

STATE OF MICHIGAN  
DEPARTMENT OF NATURAL RESOURCES  
LANSING



DANIEL EICHINGER  
DIRECTOR

SUBMITTED: April 16, 2019  
RESUBMITTED: May 13, 2019

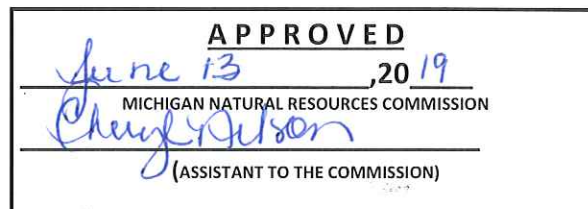

MEMORANDUM TO THE NATURAL RESOURCES COMMISSION

Subject: Antlerless Deer License Quotas in the Upper Peninsula  
Wildlife Conservation Order Amendment No. 6 of 2019

Authority:

The Natural Resources and Environmental Protection Act, 1994 PA 451, authorizes the Director and the Commission to issue orders to manage wild animals in this state.

Discussion and Background:

Since the harsh winters of 2013 and 2014 which had an impact on the Upper Peninsula (UP) deer herd, the Department has seen recovery in the deer herd as evidenced by increasing harvest and hunter success rates. In the southern UP, the Department is observing the highest densities of deer with the highest harvest levels anywhere on the Peninsula. With the recent detection of chronic wasting disease (CWD) in Dickinson County, and the recovering deer numbers in that area, the Department recommends additional opportunities for hunters to manage the local deer herd.

For the 2019 deer hunting season, the Department recommends a moderate liberalization of antlerless harvest opportunity as originally recommended by the Department in 2018. This includes:

- Reopening Deer Management Unit (DMU) 022 to antlerless license issuance.
- Increasing antlerless license quotas, as shown below, for public and private land licenses in each DMU.
  - Increasing antlerless licenses available in DMU 022 to 200 public land and 500 private land for a total of 700.
  - Increasing antlerless licenses available in DMU 055 to 1,000 public land and 7,000 private land for a total of 8,000.
  - Increasing antlerless licenses available in DMU 121 to 400 public land and 800 private land for a total of 1,200.
  - Increasing antlerless licenses available in DMU 122 to 200 public land and 1,000 private land for a total of 1,200.



- Increasing antlerless licenses available in DMU 155 to 300 public land and 1,800 private land for a total of 2,100.
- Increasing antlerless licenses available in DMU 255 to 500 public land and 1,000 private land for a total of 1,500.

UP Antlerless Deer License Quota Recommendations						
	2018			2019		
DMU	Public	Private	Total	Public	Private	Total
022	0	0	0	200	500	700
055	850	6,500	7,350	1,000	7,000	8,000
121	300	600	900	400	800	1,200
122	100	850	950	200	1,000	1,200
155	250	1,650	1,900	300	1,800	2,100
255	375	750	1,125	500	1,000	1,500
<b>Totals</b>	<b>1,875</b>	<b>10,350</b>	<b>12,225</b>	<b>2,600</b>	<b>12,100</b>	<b>14,700</b>

#### *Issues Pros and Cons*

In October 2018, a 4-year old doe harvested on a deer damage shooting permit in Waucedah Township, Dickinson County tested positive for CWD. The Department took immediate action and increased testing and active surveillance to better understand where the disease exists. The Department set up a surveillance area, centered on Waucedah Township, and set a goal to test a minimum of 600 deer to better determine the extent of possibly infected deer. In 2018, the Department tested 1,745 deer from the surveillance area and to date has not found any additional positives. The recommendation to increase antlerless license quotas in the select DMUs in the UP supports continued aggressive CWD surveillance and deer management.

#### *Biological*

Antlerless harvest was highly restricted in the UP during the 2014-16 regulation cycle due to a 3-year span of harsh winters. Only three DMUs were open to antlerless license issuance, and quotas were conservative. Deer numbers in the UP began to rebound by spring 2017 following two consecutive mild winters. Antlerless harvest opportunity was expanded to five DMUs, and antlerless license quotas were increased. With the discovery of CWD in the southern UP, which appears to be in an early stage based on current surveillance, the Department believes that management of the deer population is important in slowing the spread of the disease to new areas.

#### *Social*

Commercial forest managers and The Society of American Foresters have requested new or liberalized tools to address deer browsing impacts to forest regeneration.

The UP CWD Task Force met on March 21, 2019, and drafted recommendations to the Department and the Natural Resources Commission, suggesting measures taken in the UP should

differ from those implemented in the Lower Peninsula, based on a variety of differences including geography and deer-herd dynamics. The UP CWD Task Force supports increased quotas in the southern UP.

#### *Economic*

The number of deer harvested by farmers this past summer on deer damage shooting permits to protect their crops from damage in the south-central UP reached a 5-year high. Antlerless harvest opportunities continue to be important to address agricultural damage and forest regeneration concerns.

#### **Technical Change**

The Department recommends a technical change to DMU 122 public land antlerless deer licenses. The public land antlerless deer license quota for DMU 122 is 100 licenses; however, the Wildlife Conservation Order lists DMU 122 as closed to public land antlerless deer licenses. The Department recommends correcting this oversight by opening up DMU 122 to public land antlerless deer licenses.

e t page is signature page only



Relevant Divisions have contributed to the preparation of this order. This order was submitted for information on May 9, 2019, at the Natural Resources Commission meeting. This item appeared on the Department's April calendar and may be eligible for approval on June 13, 2019.



Russ Mason, Ph.D., Chief  
Wildlife Division



Deb Begalle, Chief  
Forest Resources Division



James Dexter, Chief  
Fisheries Division



Mark Hoffman  
Chief Administrative Officer



Gary Hagler, Chief  
Law Enforcement Division



Ronald A. Olson, Chief  
Parks and Recreation Division



Kristin Phillips, Chief  
Marketing and Outreach Division



Shannon Hanna  
Natural Resources Deputy

I have analyzed and discussed these recommendations with staff and concur as to matters over which the Director has authority.



Daniel Eichinger, Director

6/13/19  
Date

# WILDLIFE CONSERVATION ORDER

## Amendment No. 6 of 2019

By authority conferred on the Natural Resources Commission and the Director of the Department of Natural Resources by sections 40107 and 40113a of 1994 PA 451, MCL 324.40107 and 324.40113a, it is ordered that effective June 14, 2019, the following section(s) of the Wildlife Conservation Order shall read as follows:

### 3.105 Antlerless-only license quotas.

Sec. 3.105 (1) The director in consultation with and concurrence with the natural resources commission may make appropriate minor changes to antlerless deer quotas established in 3.105(2) to meet disease control, population goal, or other management objectives.

(2) Notwithstanding any other provision of this section, the antlerless deer license quotas are as shown in table 3:

**TABLE 3**  
**Deer Management Unit (DMU) License Quotas**

DMU	DMU Name	Public licenses	Private licenses	Total licenses
003	Allegan County	50	4,000	4,050
005	Antrim County	800	7,000	7,800
006	Arenac County	500	7,000	7,500
007	Big Bay Unit	0	0	0
008	Barry County	1,000	7,500	8,500
009	Bay County	200	3,000	3,200
010	Benzie County	400	1,600	2,000
011	Berrien County*	0	0	0
012	Branch County*	0	0	0
013	Calhoun County	100	7,500	7,600
014	Cass County*	0	0	0
015	Charlevoix County	900	6,000	6,900
016	Cheboygan County	800	1,000	1,800
017	Sault Ste. Marie Unit	0	0	0
018	Clare County	1,000	8,000	9,000
019	Clinton County	1,600	***	1,600***
020	Crawford County	1,000	1,100	2,100
021	Manistique Unit	0	0	0
022	Crystal Falls Unit	240	500	740
023	Eaton County	200	***	200***
024	Emmet County	600	2,200	2,800
025	Genesee County	0	7,000	7,000
026	Gladwin County	1,200	8,000	9,200
027	Watersmeet Unit	0	0	0
028	Grand Traverse County	400	1,600	2,000
029	Gratiot County	2,200	***	2,200***
030	Hillsdale County	400	12,000	12,400
031	Nissula Unit	0	0	0
032	Huron County*	0	0	0
033	Ingham County	800	***	800***
034	Ionia County	1,200	***	1,200***
036	Amasa/Michigamme Unit	0	0	0
037	Isabella County	100	***	100***
038	Jackson County	1,600	16,000	17,600
039	Kalamazoo County*	0	0	0
040	Kalkaska County	400	600	1,000

DE  VP

041	Kent County	1,400	***	1,400***
042	Keweenaw Unit	0	0	0
043	Lake County	500	5,000	5,500
044	Lapeer County	2,000	12,000	14,000
045	Leelanau County	200	1,600	1,800
046	Lenawee County	400	7,500	7,900
047	Livingston County	2,000	10,000	12,000
048	Newberry Unit	0	0	0
050	Macomb County	200	4,000	4,200
051	Manistee County	500	3,500	4,000
053	Mason County	400	7,000	7,400
054	Mecosta County	400	***	400***
055	Menominee Unit	1,200	7,000	8,200
056	Midland County	1,500	7,500	9,000
057	Missaukee County	400	3,200	3,600
058	Monroe County	100	1,000	1,100
059	Montcalm County	1,600	***	1,600***
061	Muskegon County	800	***	800***
062	Newaygo County	1,000	***	1,000***
063	Oakland County	2,500	6,000	8,500
064	Oceana County	1,000	5,500	6,500
065	Ogemaw County	700	6,000	6,700
066	Ontonagon County	0	0	0
067	Osceola County	300	9,000	9,300
069	Otsego County	800	1,000	1,800
070	Ottawa County	450	***	450***
072	Roscommon County	600	1,000	1,600
073	Saginaw County	200	6,500	6,700
074	St. Clair County	700	9,500	10,200
075	St. Joseph County*	0	0	0
076	Sanilac County*	0	0	0
078	Shiawassee County	200	***	200
079	Tuscola County*	0	0	0
080	Van Buren County*	0	0	0
081	Washtenaw County	1,500	15,000	16,500
082	Wayne County	100	1,200	1,300
083	Wexford County	1,000	3,700	4,700
115	Beaver Island	200	300	500
117	Drummond Island	0	0	0
121	Bay De Noc	480	800	1,280
122	Norway Unit	240	1,000	1,240
127	Ironwood Unit	0	0	0
131	Twin Lakes Unit	0	0	0
145	North Manitou Island	**	0	**
149	Round/Bois Blanc Island	100	100	200
152	Gwinn Unit	0	0	0
155	Gladstone Unit	360	1,800	2,160
162	South Newaygo County*	0	0	0
174	St. Clair Flats	**	300	300 **
245	South Fox Island	**	0	0
249	Trout Lake Unit	0	0	0
252	Rock Unit	0	0	0
255	LaBranche Unit	600	1,000	1,600
273	Shiawassee Unit	**	0	**
311	Keeler Unit (Berrien - Cass - Van Buren)	560	8,000	8,560
312	Sherwood Unit (Branch - Kalamazoo - St. Joseph)	1,000	16,000	17,000
332	Greenleaf Unit (Huron - Sanilac - Tuscola)	5,200	35,000	40,200

DE  VP 



349	Engadine Unit	0	0	0
452	TB Core Area	3,000	0	3,000
487	Northern Multi-County	21,000	30,000	51,000
-	CWD Management Zone	0	***	***
Total		75,080***	329,600***	404,680***

\*License quotas for these individual units are reflected as part of multi-county units.

\*\*Public land license quotas for these individual units are issued locally as permits for special deer hunts.

\*\*\*License quotas for these units located in the CWD Management Area are unlimited due to active disease surveillance protocols.

### 3.105a Deer management units open to antlerless license quotas.

Sec. 3.105a (1) Notwithstanding any other provision of this section the status of each deer management unit for antlerless deer licenses shall be as shown in table 4:

**TABLE 4**  
**Open and Closed DMU Status**

DMU Number	DMU Name	Private Land License	Public Land License
003	Allegan County	Open	Open
005	Antrim County	Open	Open
006	Arenac County	Open	Open
007	Big Bay Unit	Closed	Closed
008	Barry County	Open	Open
009	Bay County	Open	Open
010	Benzie County	Open	Open
013	Calhoun County	Open	Open
014	Cass County	Open	Open
015	Charlevoix County	Open	Open
016	Cheboygan County	Open	Open
017	Sault Ste. Marie Unit	Closed	Closed
018	Clare County	Open	Open
019	Clinton County	Open	Open
020	Crawford County	Open	Open
021	Manistique Unit	Closed	Closed
022	Crystal Falls Unit	Open	Open
023	Eaton County	Open	Open
024	Emmet County	Open	Open
025	Genesee County	Open	Closed
026	Gladwin County	Open	Open
027	Watersmeet Unit	Closed	Closed
028	Grand Traverse County	Open	Open
029	Gratiot County	Open	Open
030	Hillsdale County	Open	Open
031	Nissula Unit	Closed	Closed
032	Huron County	Open	Open
033	Ingham County	Open	Open
034	Ionia County	Open	Open
036	Amasa/Michigamme Unit	Closed	Closed
037	Isabella County	Open	Open
038	Jackson County	Open	Open
039	Kalamazoo County	Open	Open
040	Kalkaska County	Open	Open
041	Kent County	Open	Open
042	Keweenaw Unit	Closed	Closed
043	Lake County	Open	Open
044	Lapeer County	Open	Open
045	Leelanau County	Open	Open

DMU Number	DMU Name	Private Land License	Public Land License
046	Lenawee County	Open	Open
047	Livingston County	Open	Open
048	Newberry Unit	Closed	Closed
050	Macomb County	Open	Open
051	Manistee County	Open	Open
053	Mason County	Open	Open
054	Mecosta County	Open	Open
055	Menominee Unit	Open	Open
056	Midland County	Open	Open
057	Missaukee County	Open	Open
058	Monroe County	Open	Open
059	Montcalm County	Open	Open
061	Muskegon County	Open	Open
062	Newaygo County	Open	Open
063	Oakland County	Open	Open
064	Oceana County	Open	Open
065	Ogemaw County	Open	Open
066	Ontonagon County	Closed	Closed
067	Osceola County	Open	Open
069	Otsego County	Open	Open
070	Ottawa County	Open	Open
072	Roscommon County	Open	Open
073	Saginaw County	Open	Open
074	St. Clair County	Open	Open
075	St. Joseph County	Open	Open
076	Sanilac County	Open	Open
078	Shiawassee County	Open	Open
079	Tuscola County	Open	Open
080	Van Buren County	Open	Open
081	Washtenaw County	Open	Open
082	Wayne County	Open	Open
083	Wexford County	Open	Open
115	Beaver Island	Open	Open
117	Drummond Island	Closed	Closed
121	Bay De Noc	Open	Open
122	Norway Unit	Open	Open
127	Ironwood Unit	Closed	Closed
131	Twin Lakes Unit	Closed	Closed
145	North Manitou Island	Closed	Open
149	Round/Bois Blanc Island	Open	Open
152	Gwinn Unit	Closed	Closed
155	Gladstone Unit	Open	Open
174	St. Clair Flats	Open	Open
245	South Fox Island	Open	Open
249	Trout Lake Unit	Closed	Closed
252	Rock Unit	Closed	Closed
255	La Branche Unit	Open	Open
273	Shiawassee Unit	Closed	Open
311	Keeler Unit (Berrien - Cass - Van Buren)	Open	Open
312	Sherwood Unit (Branch - Kalamazoo - St. Joseph)	Open	Open
332	Greenleaf Unit (Huron - Sanilac - Tuscola)	Open	Open
349	Engadine Unit	Closed	Closed
452	TB Core Area	Open	Open
487	NLP Multi-County Unit	Open	Open



This page is signature page approved by Chair and Director only.

Issued on this 13th day of June, 2019.

Approved as to matters over which the Natural Resources Commission has authority.

  
Vicki J. Pontz, Chair  
Natural Resources Commission

Approved as to matters over which the Director has authority.

  
Daniel Eichinger  
Director





GRETCHEN WHITMER  
GOVERNOR

STATE OF MICHIGAN  
DEPARTMENT OF NATURAL RESOURCES  
LANSING



DANIEL EICHINGER  
DIRECTOR

May 13, 2019

To: Daniel Eichinger, Director

Information: Natural Resources Commission

Transaction: Oil and Gas Lease Auction – 4,131.88 acres were offered  
May 7, 2019

Authority: Part 5, of the Natural Resources and Environmental Protection  
Act, 1994 PA 451, as amended

Applicants: The attached auction summary identifies the successful bidders,  
the total acreage, and the total revenue paid. There were nine  
registered bidders with eight successful bidders.

Mineral Description: The Official Auction Record shows the legal descriptions for each  
offering.

Acres Bid: Of the 4,131.88 acres offered, a total of 2,228.55 acres received  
successful bids (1,401.34 acres development, 827.21 acres  
nondevelopment) in 9 counties.

Lease Terms: Five-year primary term with two one-year extension options, 1/6  
royalty. Bonus amount of \$24,062.00 and rental amount of  
\$11,006.28. Total revenue generated at the auction was  
\$35,068.28.

Special Restrictions: In accordance with those described in the Official Auction Record  
for each applicable auction description.

Notice: This item will appear on the June 4, 2019, DNR Business  
Calendar and will be eligible for approval June 13, 2019.

48



State of Michigan  
Oil and Gas Lease Auction  
May 7, 2019

Bidder Number	Lessee	Total Acres	Total Bonus + Total Rental
101	Western Land Services, Inc. 1100 Conrad Industrial Drive Ludington, MI 49431	260.00	\$5,200.00
102	Hardy & Hardy Consulting, LLC PO Box 332 Dewitt, MI 48820	320.00	\$3,840.00
103	Great Lakes Land Company, L.L.C. PO Box 903 Frankfort, MI 49635	366.30	\$6,004.60
104	Savoy Energy, L.P., registered to transact business in Michigan as Savoy Limited Partnership PO Box 1560 Traverse City, MI 49685	40.50	\$835.00
105	Jordan Development Company 1503 Garfield Road North Traverse City, MI 49696	86.32	\$1,189.02
106	Gary Hackworth PO Box 301 Jackson, MI 49204	No Bid	No Bid
107	Clayton Energy Company PO Box 301 Jackson, MI 49204	640.58	\$7,701.16
108	Clayton Energy Company PO Box 301 Jackson, MI 49204	275.00	\$5,500.00
109	CORE Energy, LLC 1011 Noteware Drive Traverse City, MI 49686	239.85	\$4,798.50
Totals:		2,228.55	\$35,068.28

May 13, 2019

This page is signature page only, approved by Director.

Recommendation: That the oil and gas leases be issued to the successful bidders pursuant to the above terms and conditions.



Mark B. Sweatman, Director  
Office of Minerals Management



James L. Dexter, Chief  
Fisheries Division



Russ Mason, Ph.D., Chief  
Wildlife Division



Ronald A. Olson, Chief  
Parks and Recreation Division



William O'Neill  
Natural Resources Deputy



Debbie A. Begalle, Chief  
Forest Resources Division

I approve the staff recommendation.



Daniel Eichinger  
Director



Approval Date







GRETCHEN WHITMER  
GOVERNOR

STATE OF MICHIGAN  
DEPARTMENT OF NATURAL RESOURCES  
LANSING



DANIEL EICHINGER  
DIRECTOR

May 13, 2019

TO: Daniel Eichinger, Director

INFORMATION: Natural Resources Commission

Transaction: Sale of Surplus DNR-Managed Land  
Southwestern Lower Peninsula Region – Newaygo County  
Land Transaction Case #20050469

Sale: 0.23 acre

Sale Price: Sale price to be determined at auction.

Description: Newaygo County, Lincoln Township, T14N, R13W, Section 13:  
Lots 33, 34, 35, and 36, Addition C to Diamond Park

PA 240 of 2018: This parcel is south of the Mason-Arenac county line and will result in  
a decrease of 0.23 acre of DNR-managed lands.

Authority: Natural Resources and Environmental Protection Act, 1994 PA 451,  
as amended.

Notice: This item will appear on the Department of Natural Resources  
(Department) June 4, 2019 calendar and is eligible for approval on  
June 11, 2019.

Acquired: By tax reversion in 1923.

Minerals: Mineral rights will be reviewed when this transaction is prepared for  
auction.

Comments: The proposed surplus parcels are small lots that are surrounded by  
other parcels which have been identified for disposal during Phase II.

The proposed land disposal was recommended for approval as  
surplus by the Land Exchange Review Committee on April 20, 2017.

Proceeds from this sale will be deposited into the Land Exchange  
Facilitation Fund (LEFF). The LEFF allows the Department to sell  
rights in land and deposit the proceeds in a fund which can then be  
used to acquire replacement property.

Engagement: Local engagement will be completed as part of the auction process.

51

May 13, 2019

This page is signature page only approved by Director.

- Recommendation:
1. That the land be disposed of as surplus.
  2. That the proceeds of the sale be deposited into the LEFF.
  3. That the State of Michigan follow the recommendation of the Office of Minerals Management regarding mineral rights.



Russ Mason, Ph.D., Chief  
Wildlife Division



Deb Begalle, Chief  
Forest Resources Division



James L. Dexter, Chief  
Fisheries Division



Ronald A. Olson, Chief  
Parks and Recreation Division



William O'Neill  
Natural Resources Deputy



Mark H. Hoffman  
Chief Administrative Officer

I approve the staff recommendations.



Daniel Eichinger  
Director

6/13/19

Date Approved

# SALE OF SURPLUS DNR-MANAGED LAND Southwestern Lower Peninsula Region – Newaygo County Land Transaction Case #20050469

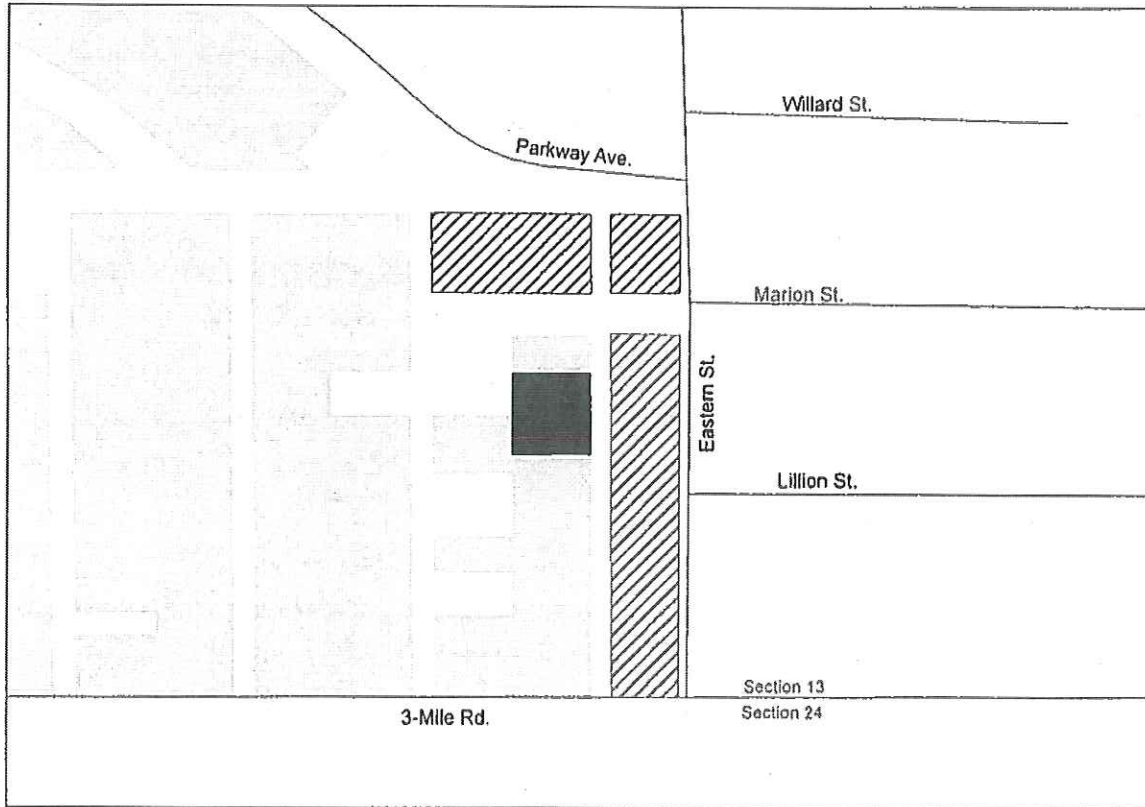

Section 13, T14N, R13W, Lincoln Township

- Surplus DNR land to be sold (4 lots)
- Surplus DNR land previously sold
- State land approved for disposal
- Private land

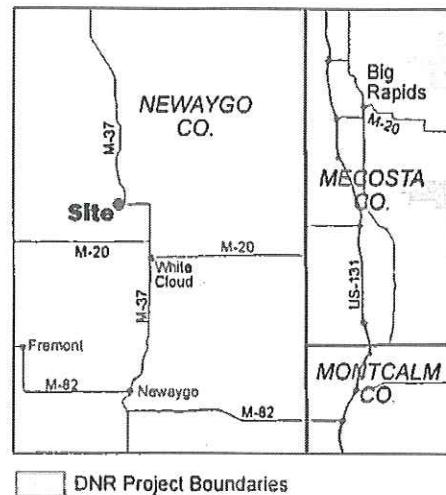
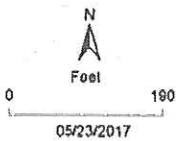







GRETCHEN WHITMER  
GOVERNOR

STATE OF MICHIGAN  
DEPARTMENT OF NATURAL RESOURCES  
LANSING



DANIEL EICHINGER  
DIRECTOR

May 13, 2019

TO: Daniel Eichinger, Director

INFORMATION: Natural Resources Commission

Transaction: Sale of Surplus DNR-Managed Land  
Cadillac Management Unit – Lake County  
Land Transaction Case #20170069

Sale: 0.28 acre

Sale Price: Sale price to be determined at auction.

Description: Lake County, Webber Township, T18N, R13W, Section 35:  
Lots 26 and 27, Block 69; and Lots 5 and 6, Block 75  
Lakeland Acres No. 2

PA 240 of 2018: This parcel is south of the Mason-Arenac county line and will result in  
a decrease of 0.28 acre of DNR-managed lands.

Authority: Natural Resources and Environmental Protection Act, 1994 PA 451,  
as amended.

Notice: This item will appear on the Department of Natural Resources  
(Department) June 4, 2019 calendar and is eligible for approval on  
June 11, 2019.

Acquired: By tax reversion in 1953.

Minerals: Mineral rights will be reviewed when this transaction is prepared for  
auction.

Comments: The proposed surplus parcels are small lots that are surrounded by  
other parcels which have been identified for disposal during Phase II.  
The surrounding lots in both blocks were sold at auction.

The proposed land disposal was recommended for approval as  
surplus by the Land Exchange Review Committee on April 20, 2017.

Proceeds from this sale will be deposited into the Land Exchange  
Facilitation Fund (LEFF). The LEFF allows the Department to sell  
rights in land and deposit the proceeds in a fund which can then be  
used to acquire replacement property.

Engagement: Local engagement will be completed as part of the auction process.

May 13, 2019

this page is signature page only      pproved by Director.

- Recommendation:
1. That the land be disposed of as surplus.
  2. That the proceeds of the sale be deposited in the LEFF.
  3. That the State of Michigan follow the recommendation of the Office of Minerals Management regarding mineral rights.



Russ Mason, Ph.D., Chief  
Wildlife Division



Debbie Begalle, Chief  
Forest Resources Division



James L. Dexter, Chief  
Fisheries Division



Ronald A. Olson, Chief  
Parks and Recreation Division



William O'Neill  
Natural Resources Deputy



Mark H. Hoffman  
Chief Administrative Officer

I approve the staff recommendations.



Daniel Eichinger  
Director

6/13/19  
Date Approved



# SALE OF SURPLUS DNR-MANAGED LAND

Cadillac Management Unit – Lake County

Land Transaction Case #20170069



Section 35, T18N, R13W, Webber Township

- Surplus DNR land to be sold (4 lots)
- Surplus DNR land previously sold
- Private land

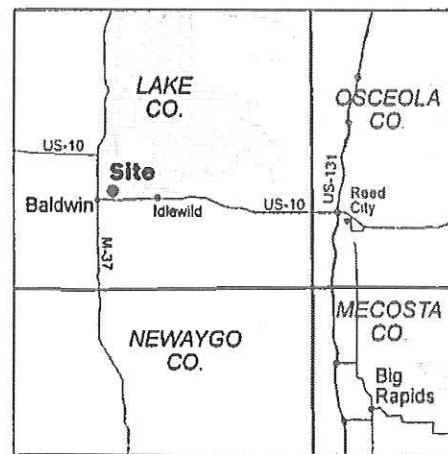
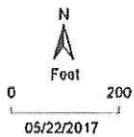

DNR Project Boundaries





GRETCHEN WHITMER  
GOVERNOR

STATE OF MICHIGAN  
DEPARTMENT OF NATURAL RESOURCES  
LANSING



DANIEL EICHINGER  
DIRECTOR

May 13, 2019

TO: Daniel Eichinger, Director

INFORMATION: Natural Resources Commission

Transaction: State Trail Acquisition  
Interlochen to Kaleva Trail – Manistee County  
The Benzie-Manistee Snowbirds Tract  
Land Transaction Case #20000206

Purchase: 20.39 acres (1.65 miles) - \$31,400.00

Funding Source: Land Exchange Facilitation Fund (LEFF)

PA 240 of 2018: PILT Estimate: \$306.46  
This parcel is located north of the Mason-Arenac county line and will result in an increase of 20.39 acres of DNR-managed lands.

Description: Manistee County, Maple Grove Township  
T23N, R14W, Section 9; and  
Manistee County, Springdale Township  
T24N, R14W, Section 27  
As more accurately described in the case file.

Seller(s): Benzie-Manistee Snowbirds, Kaleva, Michigan

Authority: Natural Resources and Environmental Protection Act, 1994 PA 451, as amended.

Notice: This item will appear on the Department of Natural Resources (Department) June 4, 2019 calendar and is eligible for approval on June 11, 2019.

Management Purpose: This land will be managed as part of the Interlochen to Kaleva Trail.

Comments: The offered property, running along a former Chesapeake and Ohio railroad corridor fills two gaps (totaling 1.65 miles) in the Interlochen to Kaleva Trail.

Acquisition of these two parcels will contribute to achieving Department and division goals and strategies by providing additional public recreation opportunities.

The seller does not hold the mineral rights relative to this tract of land.

57

May 13, 2019

This page is signature page only, approved by

- Recommendation:
1. That the acquisition be approved, with payment to be made from the Land Exchange Facilitation Fund.
  2. That the land be dedicated as part of the Interlochen to Kaleva Trail and administered by the Parks and Recreation Division.



Russ Mason, Ph.D., Chief  
Wildlife Division



Deb Begalle, Chief  
Forest Resources Division



James L. Dexter, Chief  
Fisheries Division



Ronald A. Olson, Chief  
Parks and Recreation Division



William O'Neill  
Natural Resources Deputy



Mark H. Hoffman  
Chief Administrative Officer

I approve the staff recommendations.



Daniel Eichinger  
Director

6/13/19  
Date Approved



# STATE TRAIL ACQUISITION

## Interlochen to Kaleva Trail – Manistee County

### Land Transaction Case #20000206

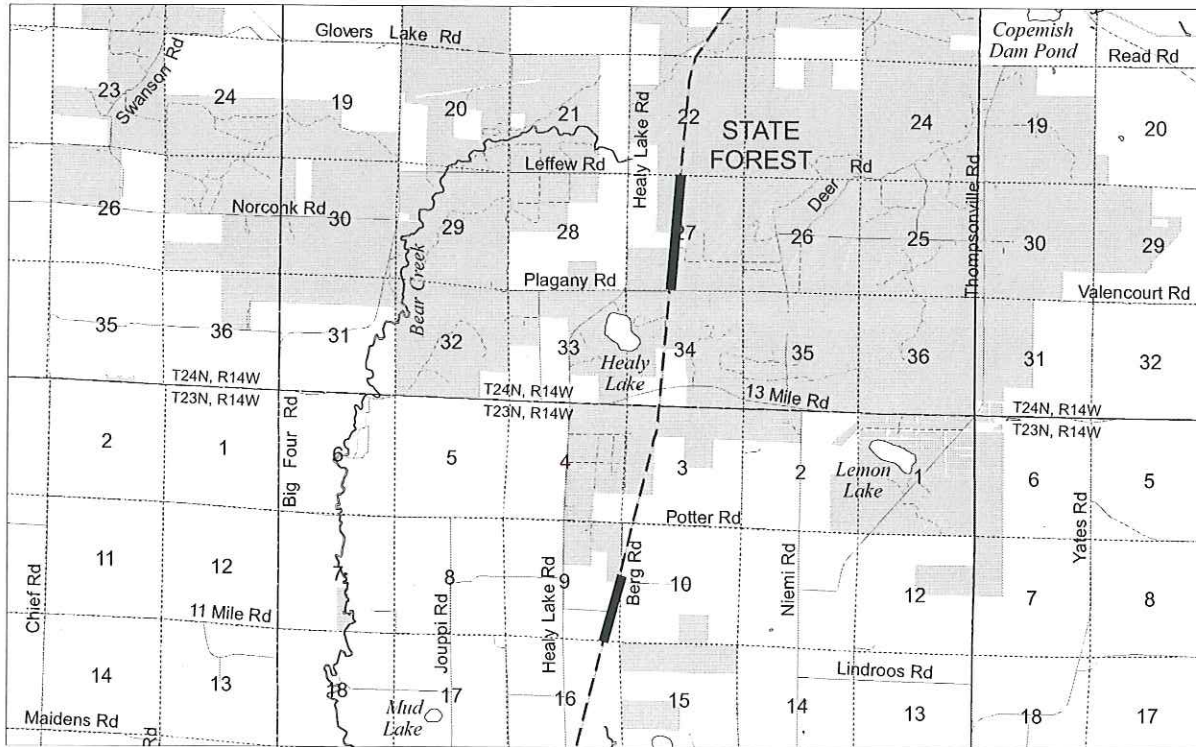

Section 9, T23N, R14W, Maple Grove Township  
 Section 27, T24N, R14W, Springdale Township

- Land to be acquired from Benzie-Manistee Snowbirds (20.39 acres, 1.65 miles, \$31,400)
- Interlochen to Kaleva Trail
- State land
- Private land

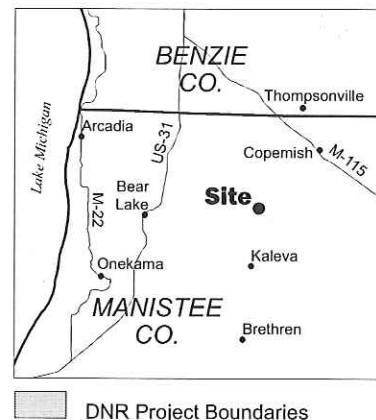





GRETCHEN WHITMER  
GOVERNOR

STATE OF MICHIGAN  
DEPARTMENT OF NATURAL RESOURCES  
LANSING



DANIEL EICHINGER  
DIRECTOR

June 5, 2019

TO: Daniel Eichinger, Director

Transaction: Conveyance of Conservation Easement  
Thompson State Fish Hatchery – Schoolcraft County  
Land Transaction Case #20190105

Conveyance: 120.0 acres (no consideration)  
Conservation easement to the Michigan Department of Environment,  
Great Lakes and Energy (EGLE).

Description: Schoolcraft County, Thompson Township, T41N, R16W, Section 29:  
The NW 1/4 of the SE 1/4 and the East 1/2 of the SE 1/4

Authority: Natural Resources and Environmental Protection Act (NREPA), 1994  
PA 451, as amended.

Acquired: Purchased in 1945 with Game and Fish Funds, and in 1946 as part of  
an exchange acquisition.

Comments: The Thompson State Fish Hatchery (TSFH) is undergoing a significant  
renovation and expansion to increase cool water fish production in the  
state. The new cool water facility is located on TSFH property, south  
of the existing facility, which minimizes impacts to wetlands and  
balances the land by maximizing the use of existing on-site soils  
without the need to bring in additional fill. The new facility will impact  
approximately six acres of previously disturbed scrub-shrub and  
forested wetlands.

Under Part 303 of the NREPA, the Department of Natural Resources (Department) is required to mitigate for the loss to any wetlands. The proposal is to place 120 acres of wooded dune swale wetland complex into permanent preservation. This land is administered by the Fisheries Division and is contiguous to the project site on land to the east. The area contains several threatened and endangered species and a vulnerable wetland type. The site is currently not actively managed, is under threat of off-road vehicle use, and has the presence of invasive species.

Under the wetland rules, EGLE requires a conservation easement on the property. The easement requires that the land be managed to reduce the threat of invasives and limit activities which can create permanent damage to the threatened and endangered species on the site. Mitigation also requires an endowment or funding to be in place for permanent long-term management of the preservation area.

June 5, 2019

This page is signature page only, approved by Director.

- Recommendation(s):
1. The conservation easement shall be granted to the Michigan Department of Environment, Great Lakes, and Energy.
  2. If allowable, funding from the Game and Fish Protection Fund will be utilized in-lieu of the endowment requirement.

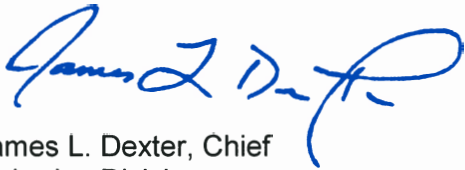

James L. Dexter, Chief  
Fisheries Division



Shannon Hanna  
Natural Resources Deputy



Mark H. Hoffman  
Chief Administrative Officer

I approve the staff recommendations.



Daniel Eichinger  
Director

6/5/19  
\_\_\_\_\_  
Date Approved



# CONVEYANCE OF CONSERVATION EASEMENT

Thompson State Fish Hatchery - Schoolcraft County  
Land Transaction Case #20190105

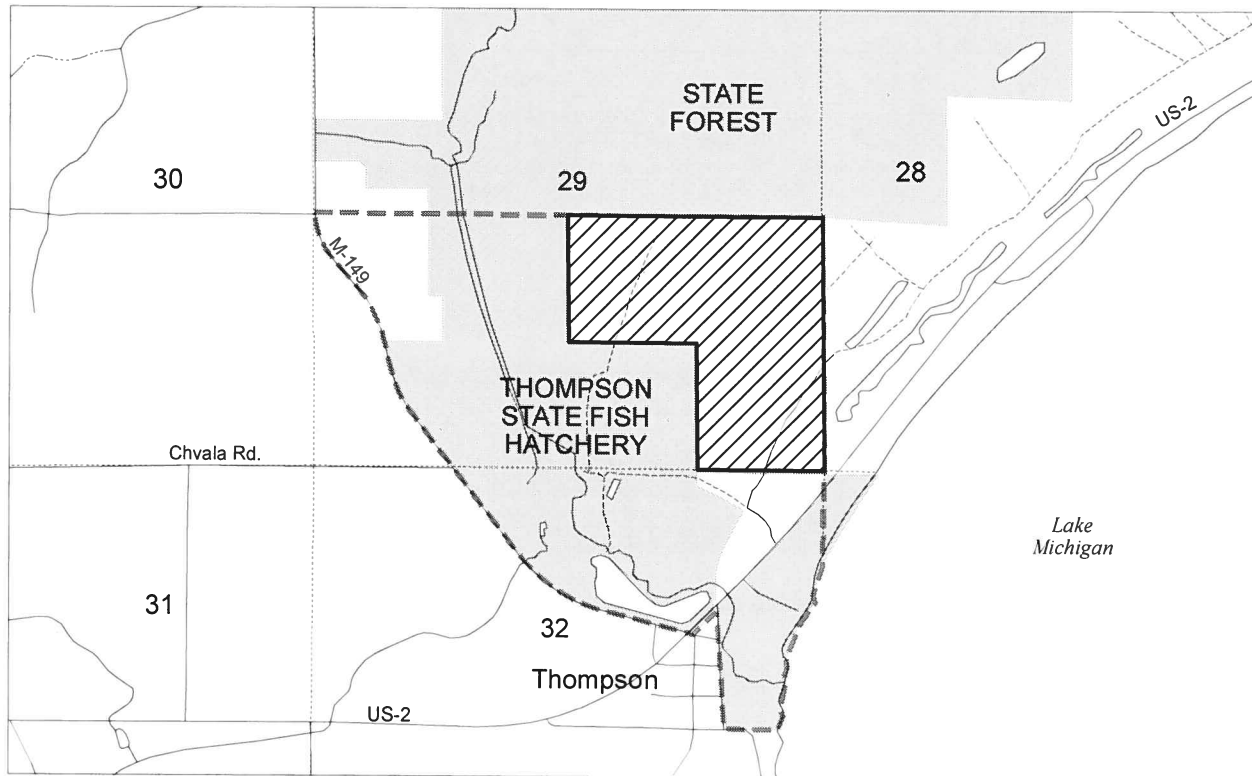

Section 29, T41N, R16W, Thompson Township

- Conservation easement to be conveyed (120 acres)
- State land
- Private land
- DNR Project Boundary

N  
Feet  
0 1,000  
06/05/2019

