



GRETCHEN WHITMER  
GOVERNOR

STATE OF MICHIGAN  
DEPARTMENT OF NATURAL RESOURCES  
LANSING



DANIEL EICHINGER  
DIRECTOR

SUBMITTED: August 12, 2019  
RESUBMITTED: September 16, 2019

MEMORANDUM TO THE NATURAL RESOURCES COMMISSION

Subject: Fisheries Order 205.20  
Michigan-Wisconsin Boundary Waters

<p><b>APPROVED</b></p> <hr/> <p><b>20</b></p> <hr/> <p>MICHIGAN NATURAL RESOURCES COMMISSION</p> <hr/> <p>(ASSISTANT TO THE COMMISSION)</p>
---

Authority:

The Natural Resources and Environmental Protection Act, 1994 PA 451, authorizes the Director and the Commission to issue Orders to regulate the taking of fish in the waters of this state.

Discussion and Background:

Fisheries Order 205 governs fishing regulations on the Michigan side of the Michigan-Wisconsin boundary waters, which are managed cooperatively with the State of Wisconsin. Fisheries and law enforcement staff meet annually from both states to discuss regulation proposals. Both parties have been working towards implementing similar regulations whenever possible to reduce regulatory complexities for anglers. The Department recommends modifying three regulations in the Order which will match Wisconsin's regulatory proposals: 50-inch muskellunge minimum size limit, a muskellunge possession season extension, and a bass possession season extension. Additional information is being added to the Order concerning mandatory reporting of lake sturgeon and muskellunge harvest to inform anglers of the process.

50 Inch Muskellunge Minimum Size Limit

Michigan raised the muskellunge minimum size limit (MSL) on the boundary waters from 40 inches to 42 inches at the onset of the 2018 fishing season. The change was implemented to match the statewide muskellunge minimum size limit while also increasing protection of this valued species. The size limit change resulted in two separate minimum size limit regulations for muskellunge in Michigan and Wisconsin portions of the boundary waters. Specifically, Wisconsin had a MSL of 40 inches and Michigan had a MSL of 42 inches. Since that time, Wisconsin managers have been reviewing their boundary water muskellunge minimum size limit regulation and have indicated their intention to enact a 50-inch minimum size limit for muskellunge in all Wisconsin boundary waters. After consideration and discussions with local anglers in Michigan, the Department is proposing to implement the same 50-inch minimum size limit on all boundary waters shared with Wisconsin. As a result, the recommended proposal would result in a uniform 50-inch minimum size limit regulation for muskellunge on all boundary waters and would be consistent with the existing exception for the Menominee River from the Hattie Street Dam downstream to the breakwalls of Green Bay which has been effective since April 1, 2005. This effort will simplify regulations for anglers in both states and allow muskellunge to live longer and reach larger sizes.

Muskellunge Possession Season Extension

Michigan and Wisconsin recommend extending the muskellunge possession season in the boundary waters. Michigan's current muskellunge possession season is from June 1 through November 30. The proposal will extend the possession season through December 31 and thus add 31 more days to the

existing regulation. Michigan implemented mandatory registration for all muskellunge harvested by anglers starting on April 1, 2018 and reporting indicates that 28 muskellunge were harvested statewide with no harvest reported from the boundary waters. In total, the harvest of seven muskellunge has been reported for the current fishing season. Given these results, managers feel that extending the harvest season would not have a negative effect on muskellunge populations. In addition, an increase in the size limit to 50 inches will provide additional protection for this species which is a popular catch-and-release species.

#### Bass Possession Season Extension

The Department proposes to extend the bass possession season by one month to be consistent with Wisconsin's bass possession season. This recommendation would also result in the boundary water bass possession season aligning with the statewide possession season closure date. Currently, the possession season for bass on the boundary waters is open on the third Saturday in June through November 30. The proposed season change will maintain open date of the third Saturday in June but would extend the closure date to December 31. This change will result in consistent regulations for shared boundary waters and would simplify regulations for anglers and law enforcement personnel. The possession season extension is not expected to have a negative effect on local bass populations as most bass are released by anglers unharmed.

#### *Issue Pros and Cons*

The three changes will result in uniform regulations for anglers fishing the shared boundary waters and make law enforcement easier. The bass season extension will also align with the statewide bass season regulation. The season extensions will result in more harvest opportunities while the higher size limit regulation will protect prized muskellunge from harvest until a later age enabling them to grow bigger. The recommended regulation would require anglers who catch a large muskellunge to release the muskellunge unless it has reached the new 50-inch minimum size limit. This could result in some anglers being discouraged about not being able to harvest large fish (e.g., 45-49.9 inches) that they still consider to be a trophy sized fish.

#### *Biological*

The season extensions should not result in any negative impacts to the fishery resource as bass and muskellunge are primarily caught and released by most anglers. The increase in the size limit for muskellunge will protect adult fish to larger sizes and allow them to live longer before being susceptible to angling harvest.

#### *Social*

Anglers are supportive of protecting muskellunge so they can reach larger sizes. Muskellunge and bass fisheries are valued by anglers and most fish are caught and returned to the water unharmed. Anglers are supportive of additional fishing opportunities when it poses no risk to the resource.

#### *Economic*

The Department does not expect the proposed changes to have any significant budgetary or personnel implications.

Recommendation:

Relevant Divisions have contributed to the preparation of this Order. This Order was submitted for information on September 12, 2019, at the Natural Resources Commission meeting. This item appeared on the Department's August 30, 2019 calendar and may be eligible for approval on October 10, 2019.

  
James Dexter, Chief  
Fisheries Division

   
Gary Hagler, Chief  
Law Enforcement Division

  
Russ Mason, Ph.D., Chief  
Wildlife Division

  
Debbie Begalle, Chief  
Forest Resources Division

  
Ronald A. Olson, Chief  
Parks and Recreation Division

  
Shannon Hanna  
Natural Resources Deputy

I have analyzed and discussed these recommendations with staff and concur as to matters over which the Director has authority.

\_\_\_\_\_  
Daniel Eichinger, Director

\_\_\_\_\_  
Date



# FISHERIES ORDER

## Michigan-Wisconsin Boundary Waters Order 205.20

By authority conferred on the Natural Resources Commission and the Department of Natural Resources by Part 487 and Part 491 of 1994 PA 451, MCL 324.48701 to 324.48740 and MCL 324.49101 to 324.49103, it is ordered on October 10, 2019, the following section(s) of the Fisheries Order shall read effective April 1, 2020, as follows:

The following rules and regulations govern fishing in the waters which form a common boundary between the States of Michigan and Wisconsin. These rules and regulations supersede all others governing fishing on Michigan-Wisconsin boundary waters that in any way conflict. Where regulations of Michigan and Wisconsin differ, persons shall comply with the regulations of the state in whose territorial waters they are fishing.

The interstate boundary waters in which fishing is to be governed by the special regulations are: The Lake Michigan waters between the breakwalls at the mouth of the Menominee River beginning at an imaginary line drawn between the most lakeward point of each breakwall: Menominee County, Michigan; Marinette County, Wisconsin.

Menominee River, its Sloughs and Impoundments: Menominee, Dickinson, Iron Counties, Michigan; Florence, Marinette Counties, Wisconsin; Brule River, Iron County, Michigan; Florence and Forest Counties, Wisconsin; Brule Island Impoundment, upstream to a line running east-west through the first island upstream from the junction of the Brule and Paint Rivers, Iron County, Michigan; Florence County, Wisconsin; Smoky Lake, Iron County, Michigan; Vilas County, Wisconsin; Norwood Lake, Lac Vieux Desert, Crystal Lake, Mill Lake, Big Bateau Lake, Mamie Lake, West Bay Lake, Big Lake, Crampton Lake, Plum Lake, Tenderfoot Lake, Roach Lake, Little Presque Isle Lake, Cyrus Lake, Basin Lake, Stateline Lake, Gogebic County, Michigan; Vilas County, Wisconsin; East Fork Montreal River up to the mouth of Layman Creek, Gogebic County, Michigan; Iron County, Wisconsin; Montreal River, Gogebic County, Michigan; Iron County, Wisconsin.

Regulations: Except as otherwise expressly provided, no person shall take fish by any means other than with hook-and-line; nor at any time other than the open season; nor have in his or her possession any fish in excess of the daily creel or possession limit, or fish of less than the legal minimum size.



Species	Waters	Open Seasons (dates inclusive)	Daily Possession Limit	Minimum Size Limit
Trout & Salmon	Montreal & Menominee Rivers from their mouths to first dam upstream and Smoky Lake	Open all year	5	10 inches
	Menominee & Montreal Rivers above the first dam and Brule River from its mouth to the US Highway 2 Bridge	Last Saturday in April – September 30	5	7 inches
	Brule River upstream from US Highway 2	Last Saturday in April – September 30	5	Brook Trout - 8 inches; Brown Trout - 12 inches
Smallmouth Bass & Largemouth Bass	All boundary waters	Catch-and- immediate-release season: open all year	0	---
		Possession season: 3 <sup>rd</sup> Saturday in June - December 31	5 in combination	14 inches
Walleye (See Note 1) & Sauger	All boundary waters except as otherwise provided in this paragraph	1 <sup>st</sup> Saturday in May - March 1	5 in combination	15 inches
	Rivers and Impoundments	March 2 - the Friday before 1 <sup>st</sup> Saturday in May	1	15 inches
	Rivers and Impoundments	1 <sup>st</sup> Saturday in May - March 1	5 in combination	15 inches
Northern Pike	All boundary Waters	1 <sup>st</sup> Saturday in May - March 1	5	None
Bluegills, Sunfish, Crappies, and Yellow Perch	All boundary waters	Open all year	25 in combination	None
Muskellunge (including Tiger Muskellunge) (See Note 2)	All boundary waters	Catch-and- immediate-release season: open all year	0	---
		Possession season: first Saturday in June – December 31	1 fish per angling season	50 inches
Lake Sturgeon (See Note 3)	All boundary waters	1 <sup>st</sup> Saturday in September - September 30	1 fish per angling season	60 inches
Channel Catfish	All boundary waters	Open all year	10	None

Species	Waters	Open Seasons (dates inclusive)	Daily Possession Limit	Minimum Size Limit
Lake Whitefish, Cisco (Lake Herring), and Round Whitefish (Menominee)	All boundary waters	Open all year	10	None
All others	All boundary waters	Open all year	None	None

Note 1 – On Lac Vieux Desert Flowage, the minimum size limit for walleye is 18 inches. The daily possession limit for Walleye shall be three (3) in combination from 1<sup>st</sup> Saturday in May - March 1.

Note 2 – For the Menominee River, from Hattie Street Dam downstream to the end of the breakwalls in Green Bay, the minimum size limit for Muskellunge is 50 inches. Anglers are required to register muskellunge (including tiger muskellunge) harvest within 24 hours. Anglers must report their harvest online ([www.michigan.gov/registerfish](http://www.michigan.gov/registerfish)), toll-free by calling 844-345-FISH(3474), or in person at any DNR Customer Service Center during normal state business hours with advanced notice of arrival. Muskellunge harvest is limited to one (1) Muskellunge per angler per year (April 1 – March 31).

Note 3 - For the Menominee River, from Grand Rapids Dam downstream to the end of the breakwalls in Green Bay, the possession limit for Lake Sturgeon is zero (0), catch-and-immediate-release only. Anglers are required to register Lake Sturgeon harvest within 24 hours. Anglers must report their harvest online ([www.michigan.gov/registerfish](http://www.michigan.gov/registerfish)), toll-free by calling 844-345-FISH(3474), or in person at any DNR Customer Service Center during normal state business hours with advanced notice of arrival. Lake Sturgeon harvest is limited to one (1) Lake Sturgeon per angler per year (April 1 – March 31).

#### LEGAL FISHING METHODS:

1. Up to three lines with a total of three (3) hooks or baits may be used.
2. Lines must be attended at all times.
3. A person may not fish for any fish by any means during the closed season on trout in the Brule River upstream from US Highway 2 bridge (T41N, R32W, S9) Iron County, Michigan, and the Montreal River above the Superior Falls Flowage.
4. Dip nets not exceeding nine (9) feet square or in diameter without walls may be used in the Menominee River (except from Hattie Street Bridge in Marinette-Menominee to the first dam upstream and within 200 feet of all other dams) from April 1 - May 14 for taking of Suckers, Redhorse, Carp, Smelt, and Burbot.
5. A person may fish from a motorboat with the motor running or a sailboat under sail.
6. All residents of Michigan and Wisconsin holding a resident sport fishing license from their respective state, or residents of states other than Michigan and Wisconsin holding a sport fishing license issued by either Michigan or Wisconsin, may fish in the boundary waters.
7. Crayfish may not be possessed or used for bait on Michigan-Wisconsin boundary waters.

This Order shall be assigned number FO-205.20, and is titled "Michigan-Wisconsin Boundary Waters Regulations."

This Order supersedes the Order titled "Michigan-Wisconsin Boundary Waters," which became effective April 1, 2018, and is assigned number FO-205.18.

This Order shall take effect on April 1, 2020, and shall remain in effect until amended/rescinded.

Issued on this 10th day of October, 2019.

Approved as to matters over which the Natural Resources Commission has authority.

Vicki J. Pontz, Chair  
Natural Resources Commission

Approved as to matters over which the Director has authority.

Daniel Eichinger  
Director





GRETCHEN WHITMER  
GOVERNOR

STATE OF MICHIGAN  
DEPARTMENT OF NATURAL RESOURCES  
LANSING



DANIEL EICHINGER  
DIRECTOR

SUBMITTED:  
RESUBMITTED:

August 12, 2019  
September 16, 2019

MEMORANDUM TO THE NATURAL RESOURCES COMMISSION

<b>APPROVED</b>
_____, 20____
MICHIGAN NATURAL RESOURCES COMMISSION
(ASSISTANT TO THE COMMISSION)

Subject: Fisheries Order 206.20  
Special Fishing Regulations for Warmwater Species on Select Waters

Authority:

The Natural Resources and Environmental Protection Act, 1994 PA 451, authorizes the Director and the Commission to issue Orders to regulate the taking of fish in the waters of this state.

Discussion and Background:

Fisheries Order 206 covers fishing regulations for warmwater species on select waters. Changes proposed to the Order include regulation modifications that are aimed to address size structure concerns of northern pike populations, protect spawning walleye in an area where they are susceptible to harvest, and address concerns stemming from the same waterbody having multiple common names.

The Department provides specific details related to each recommended regulation proposal below.

Additions

The following waters are recommended to be added to the Order for the reasons indicated below:

1. Twin Tomahawk Lakes (South and North Tomahawk Lakes; Montmorency County) – add to list of waters where up to five northern pike may be harvested with no more than 1 greater than 24 inches. The goal of this proposal is to increase the size structure of a northern pike population that is abundant and slow growing.
2. Magician Lake (St. Joseph County) – implement a 24” – 34” protected slot limit on northern pike with a daily possession limit of two fish. This regulation option has been chosen in response to slow growth of northern pike in this system. Managers believe that implementing a protected slot limit on this lake will allow anglers to harvest smaller northern pike while adding protection for larger females in the population. Anglers have indicated that few fish are reaching the current size limit and they have requested an opportunity to harvest smaller northern pike in this lake.
3. Cheboygan River (Cheboygan County) from the south end of the outermost breakwall on Mullett Lake downstream to Cheboygan Dam, and Black River from Alverno Dam downstream to its confluence with the Cheboygan River – the possession season for walleye shall be May 15 – March 15, inclusive. This regulation was placed into FO-204 as a spawning closure and is being moved into this Order which is the more appropriate order to protect spawning walleye while still allowing anglers to target bass during the catch-and-immediate-release season.

### Modifications

The following waters are recommended to be modified in the Order for the reasons indicated below:

1. Hamilton Lake (Delta County) – is listed as a water where up to five northern pike may be retained with no more than 1 greater than 24 inches. The lake is identified as McDonald Lake in the *Michigan Atlas & Gazetteer* map book and Hamilton Lake in the *Michigan County Map Guide* which has been causing confusion. Therefore, the listing will be modified to include the name McDonald Lake in parentheses.

### Removal

The following waters are recommended to be removed from the Order for the reasons indicated below:

1. Lake Lavine (Branch County) – is listed as a water where there is no size limit on northern pike and no limit on possession of northern pike. Special regulations were placed on northern pike here several years ago to increase angler harvest in attempts to reduce the northern pike population to reduce predation on stocked trout. Recent survey information indicates that the special regulations have not been effective at reducing the northern pike population; therefore, the management goal for this lake has shifted away from trying to create a trout fishery and is now focused on managing for northern pike. The proposed regulation would remove the existing special regulation for northern pike and shift the regulation back to the statewide regulation.

### *Issue Pros and Cons*

There are many waters where northern pike populations are considered to be stunted with individual fish not achieving sizes that reach or exceed the minimum size limit (24") under the statewide regulation. Adding waters to the Order with liberalized northern pike size and possession limits will benefit anglers who want to harvest smaller fish in places where growth potential is limited. Allowing anglers to harvest a greater number of small fish provides more angling opportunities and may benefit the resource by reducing competition. Adding a water to the northern pike protected slot limit regulation will allow anglers to harvest smaller northern pike while providing a protection for northern pike with good growth potential to grow to larger sizes. The goal of this management strategy is to shift the size structure towards a higher percentage of larger fish over time. Removing unnecessary regulations and modifying them in some circumstances reduces confusion for anglers as well as law enforcement staff. There are no expected negative outcomes associated with the proposed changes.

### *Biological*

Lowering the minimum size limit on stunted populations should not have a negative effect on the fish community in these waters. The protected slot limit regulation will allow angler harvest of some small fish while also protecting northern pike to larger sizes and allow them to live longer before being susceptible to angling harvest. Research has indicated that larger northern pike will prey upon smaller northern pike and potentially result in an improved population size structure over time.

### *Social*

Anglers are supportive of more liberalized regulations placed on northern pike in waters where fish are stunted and places no risk on the resource. Anglers are supportive of more protective fishing regulations when the goal is to improve the size structure which will benefit anglers in the future.

### *Economic*

The Department does not expect the proposed changes to have any significant budgetary or personnel implications.

The following page is a signature page only.

DE\_\_VP\_\_



Recommendation:

Relevant Divisions have contributed to the preparation of this Order. This Order was submitted for information on September 12, 2019, at the Natural Resources Commission meeting. This item appeared on the Department's August 30, 2019 calendar and may be eligible for approval on October 10, 2019.

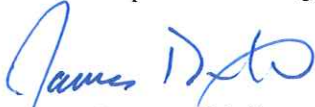

James Dexter, Chief  
Fisheries Division



Russ Mason, Ph.D., Chief  
Wildlife Division



Ronald A. Olson, Chief  
Parks and Recreation Division

 Steven B. Burton

Gary Hagler, Chief *for*  
Law Enforcement Division



Debbie Begalle, Chief  
Forest Resources Division



Shannon Hanna  
Natural Resources Deputy

I have analyzed and discussed these recommendations with staff and concur as to matters over which the Director has authority.

\_\_\_\_\_  
Daniel Eichinger, Director

\_\_\_\_\_  
Date



# FISHERIES ORDER

## Special Fishing Regulations for Warmwater Species on Select Waters Order 206.20

By authority conferred on the Natural Resources Commission and the Department of Natural Resources by Part 487 of 1994 PA 451, MCL 324.48701 to 324.48740, ordered on October 10, 2019, the following section(s) of the Fisheries Order shall read effective April 1, 2020, as follows:

The following special regulations are in effect for warmwater species on the selected waters and supersede those regulations that in any way conflict with those listed below:

### Alcona County

Badger Lake (T28N, R3E, S35): no size limit on Northern Pike and up to five (5) Northern Pike may be retained in the daily possession limit with only one (1) greater than 24.

### Alger County

Echo and Duck Lakes on Grand Island: the possession limit for Smallmouth Bass is zero (0).

Au Train basin, 16 Mile Lake, Echo Lake, Nawakwa Lake, and Trout Lake: no size limit on Northern Pike and up to five (5) Northern Pike may be retained in the daily possession limit with only one (1) greater than 24.

### Allegan County

Pine Creek Flooding: protected slot limit on Northern Pike from 24 – 34 inches.

### Antrim County

Clam Lake including all tributaries, Elk Lake (above Elk Rapids Dam) including all tributaries, Lake Bellaire including all tributaries upstream to Bellaire Dam, Lake Skegemog including all tributaries, and Torch Lake including all tributaries: the minimum size limit for Muskellunge is 50 inches.

Beals Lake including all tributaries, Benway Lake including all tributaries, Elsworth Lake including all tributaries, Hanley Lake including all tributaries, Intermediate Lake from Bellaire Dam upstream including all tributaries, Saint Clair Lake including all tributaries, Scotts Lake including all tributaries, Six Mile Lake including all tributaries, and Wilson Lake including all tributaries: the minimum size limit for Muskellunge is 46 inches.

Beals Lake, Benway Lake, Ellsworth Lake, Hanley Lake, Scotts Lake, Six Mile Lake (Antrim and Charlevoix Counties), St. Clair Lake (Antrim and Charlevoix Counties), and Wilson Lake: no size limit on Northern Pike and up to five (5) Northern Pike may be retained in the daily possession limit with only one (1) greater than 24.

### Baraga County

Vermillac (Worm) Lake: no size limit on Northern Pike and up to five (5) Northern Pike may be retained in the daily possession limit with only one (1) greater than 24 inches.

Barry County

Gun Lake: the minimum size limit for Muskellunge is 46 inches.

Thornapple Lake (from McKeown road to Barger road): the minimum size limit for Muskellunge is 50 inches. The possession season for Muskellunge and Northern Pike shall be the 1<sup>st</sup> Saturday in June through November 30, inclusive.

Williams Lake: the fishing season shall be the last Saturday in April through December 15, inclusive. The daily possession limit is zero (0).

Benzie County

Long Lake: no size limit on Northern Pike and up to five (5) Northern Pike may be retained in the daily possession limit with only one (1) greater than 24 inches.

Calhoun County

Harts Lake (T2S, R8W, S7, 18): the daily possession limit is zero (0).

Cass County

Corey Lake (T6S, R13W, S24) Little Crooked Lake, and Stone Lake (T6S, R15W, S35): the minimum size limit on Largemouth Bass is 10 inches.

Charlevoix County

Saint Clair Lake including all tributaries and Six Mile Lake including all tributaries: the minimum size limit for Muskellunge is 46 inches.

Deer Lake, Fox Lake, Geneserath Lake, Six Mile Lake (Antrim and Charlevoix Counties), St. Clair Lake (Antrim and Charlevoix Counties), and Susan Lake: no size limit on Northern Pike and up to five (5) Northern Pike may be retained in the daily possession limit with only one (1) greater than 24 inches.

Cheboygan County

Black Lake including all tributaries and Black River including all tributaries (upstream to Kleber Dam), Burt Lake, Cheboygan River, Crooked River (downstream from Crooked Lake confluence), Indian River, Mullet Lake: the minimum size limit on Muskellunge is 46 inches.

Black River upstream of Tower Dam (includes Tower Pond) and tributary streams only, Silver Lake (T33N, R3W, S11, 12), Wildwood Lake (T33N, R2W, S21), and Paradise (Carp) Lake (Cheboygan and Emmet Counties): no size limit on Northern Pike and up to five (5) Northern Pike may be retained in the daily possession limit with only one (1) greater than 24 inches.

Cheboygan River from the south end of the outermost breakwall on Mullett Lake downstream to Cheboygan Dam, and Black River from Alverno Dam downstream to its confluence with the Cheboygan River: the possession season for walleye shall be May 15 – March 15, inclusive.

Chippewa County

St. Marys River (from compensating gates downstream to DeTour/Drummond Island Ferry docks): the minimum size limit for Muskellunge is 46 inches.

Frenchman Lake (T44N, R6W, S23, 25, 26) and Trout (Carp) Lake: no size limit on Northern Pike and up to five (5) Northern Pike may be retained in the daily possession limit with only one (1) greater than 24 inches.

Clare County

Eight Point Lake and Lake Thirteen: no size limit on Northern Pike and up to five (5) Northern Pike may be retained in the daily possession limit with only one (1) greater than 24 inches.



Crawford County

Jones Lake (T28N, R2W, S30, 31): the fishing season shall be June 1 through September 30, inclusive. Tackle: artificial lures only. It shall be unlawful to use or possess live bait, dead bait, organic or processed food at any time on the shore or water. Daily possession limit is zero (0).

Wakeley Lake (T26N, R2W, S23): the fishing season shall be June 15 through August 31, inclusive. The daily possession limit is zero (0). Tackle: Artificial lures only. It shall be unlawful to use or possess live bait, dead bait, organic or processed food at any time on the shore or water.

Big Creek Impoundment (T28N, R1W, S24, 25), River Lake (T28N, R2W, S30), and Pickerel Lake (Crawford and Oscoda Counties, T24N, R1W, S24 and T28N, R1E, S19): no size limit on Northern Pike and up to five (5) Northern Pike may be retained in the daily possession limit with only one (1) greater than 24 inches.

Delta County

Chicago Lake, Carr Lake, Hamilton (McDonald) Lake, Lyman Lake, Escanaba River upstream from first dam at US-2, Round Lake (T40N, R20W, S1): no size limit on Northern Pike and up to five (5) Northern Pike may be retained in the daily possession limit with only one (1) greater than 24 inches.

Dickinson County

Sawyer Lake: no size limit on Northern Pike and up to five (5) Northern Pike may be retained in the daily possession limit with only one (1) greater than 24 inches.

Emmet County

Crooked River (downstream from Crooked Lake confluence): the minimum size limit on Muskellunge is 46 inches.

French Farm Lake Flooding, O'Neal Lake Flooding, and Paradise (Carp) Lake (Cheboygan and Emmet Counties): no size limit on Northern Pike and up to five (5) Northern Pike may be retained in the daily possession limit with only one (1) greater than 24 inches.

Gladwin County

Lake Lancer: no size limit on Northern Pike and up to five (5) Northern Pike may be retained in the daily possession limit with only one (1) greater than 24 inches.

Gogebic County

Lake Gogebic: the minimum size limit for Walleye is 15 inches; however, anglers may possess two (2) Walleye from 13 - 15 inches as part of the daily possession limit of five (5) Walleye.

Cisco Lake, Thousand Island Lake, Lindsley Lake, Poor Lake, Big African Lake, Little African Lake, Clearwater Lake, East Bay Lake, Fishhawk Lake, Indian Lake, Morley Lake, Record Lake, and Chaney Lake: no size limit on Northern Pike and up to five (5) Northern Pike may be retained in the daily possession limit with only one (1) greater than 24 inches.

Grand Traverse County

Elk Lake (above Elk Rapids Dam) including all tributaries and Lake Skegemog including all tributaries: the minimum size limit for Muskellunge is 50 inches.

Arbutus Lake and Spider Lake (T26N, R10W, S9, 10): the minimum size limit for Largemouth and Smallmouth Bass is 10 inches.

Boardman Lake, and Lake Dubonnet: no size limit on Northern Pike and up to five (5) Northern Pike may be retained in the daily possession limit with only one (1) greater than 24 inches.



Hillsdale County

Lake Diane: the minimum size limit for Muskellunge is 38 inches.

Houghton County

Portage and Torch Lake systems: no more than one (1) Walleye over 23 inches may be possessed in the daily possession limit.

Rice Lake: no size limit on Northern Pike and up to five (5) Northern Pike may be retained in the daily possession limit with only one (1) greater than 24 inches.

Ionia County

Woodard Lake: the minimum size limit for Largemouth and Smallmouth Bass is 10 inches.

Iron County

Chicagon Lake including all tributaries: the minimum size limit for Muskellunge is 50 inches.

Lake Ottawa the daily possession limit for Largemouth and Smallmouth Bass is zero (0).

Fire Lake and Indian Lake: the minimum size limit for Largemouth and Smallmouth Bass is 18 inches. The daily possession limit for Largemouth and Smallmouth Bass is one (1).

Bone Lake, Brule Lake, Buck Lake, Deer River, Hemlock Falls Reservoir, Indian Lake, Iron Lake, Lake Mary, Lake St. Kathryn, Michigamme Falls Reservoir, Michigamme Reservoir, Net River, Net River Wide Waters, Paint River Pond (downstream of Horserace Rapids and upstream of Frog Island), Peavy Pond, Railroad Lake, Runkle Lake, Sunset Lake, and Winslow Lake: no size limit on Northern Pike and up to five (5) Northern Pike may be retained in the daily possession limit with only one (1) greater than 24 inches.

Kalamazoo County

Long Lake (T3S, R10W, S17, 18, 19, 30): protected slot limit on Northern Pike from 24 – 34 inches.

Kalkaska County

Lake Skegemog including all tributaries: the minimum size limit for Muskellunge is 50 inches.

Cub Lake (T27N, R5W, S19): the minimum size limit for Largemouth and Smallmouth Bass is 10 inches.

Kent County

Murray Lake: the minimum size limit for Muskellunge is 46 inches.

Bass Lake (T10N, R9W, S12, 13, 14): protected slot limit on Northern Pike from 24 – 34 inches.

Scram Lake: no size limit on Northern Pike and up to five (5) Northern Pike may be retained in the daily possession limit with only one (1) greater than 24 inches.

Keweenaw County

Schlatter Lake: no size limit on Northern Pike and up to five (5) Northern Pike may be retained in the daily possession limit with only one (1) greater than 24 inches.

Lake County

Big Bass Lake (T20N, R14W, S34): the minimum size limit for Largemouth and Smallmouth Bass is 10 inches.

Leelanau County

North Manitou Lake (T32N, R14W, S29, 32): the minimum size limit for Largemouth and Smallmouth Bass is 18 inches. The daily possession limit for Largemouth and Smallmouth Bass is one (1). Tackle: Artificial lures only. It shall be unlawful to use or possess live bait, dead bait, organic or processed food at any time on the shore or water.

Florence Lake (T31N, R15W, S9): Tackle: Artificial lures only. It shall be unlawful to use or possess live bait, dead bait, organic or processed food at any time on the shore or water. No size limit on Northern Pike and up to five (5) Northern Pike may be retained in the daily possession limit with only one (1) greater than 24 inches.

Lenawee County

Lake Hudson: the possession season for Northern Pike and Muskellunge shall be the first Saturday in June through November 30, inclusive.

Luce County

Blind Sucker Flooding and Bodi Lake: protected slot limit on Northern Pike from 24 – 34 inches.

East Lake and Muskallonge Lake: no size limit on Northern Pike and up to five (5) Northern Pike may be retained in the daily possession limit with only one (1) greater than 24 inches.

Tahquamenon River and Tributaries upstream from Upper Falls: the minimum size limit for Muskellunge is 38 inches.

Mackinac County

East Lake, Millecoquins Lake, and South Manistique Lake: no size limit on Northern Pike and up to five (5) Northern Pike may be retained in the daily possession limit with only one (1) greater than 24 inches.

Manistee County

Bar Lake and Chief Lake: no size limit on Northern Pike and up to five (5) Northern Pike may be retained in the daily possession limit with only one (1) greater than 24 inches.

Marquette County

Deer Lake Basin (T48N, R27W, S27, 28, 29, 32, 33, 34), Carp River downstream from M-28 (T47N, R27W, S4) and all other tributaries to Deer Lake Basin: the daily possession limit is zero (0). Tackle: Artificial lures only. It shall be unlawful to use or possess live bait, dead bait, organic or processed food at any time on the shore or water.

Fish Lake (T47N, R29W, S5, 6, 8): the minimum size limit for Largemouth and Smallmouth Bass is 18 inches. The daily possession limit for Largemouth and Smallmouth Bass is one (1).

Bass (East) Lake, Cedar Lake (T47N, R27W, S11), Dead River Storage Basin, Engman Lake, Middle Branch Escanaba River, Big West Branch Escanaba River, Escanaba River Mainstream downstream to Boney Falls Basin (except Greenwood, Schweitzer and Cataract Reservoirs), Shag (Big) Lake, and Witch Lake: no size limit on Northern Pike and up to five (5) Northern Pike may be retained in the daily possession limit with only one (1) greater than 24 inches.

Mason County

Hackert (Crystal) Lake (T18N, R17W, S2, 3): no size limit on Northern Pike and up to five (5) Northern Pike may be retained in the daily possession limit with only one (1) greater than 24 inches.

Mecosta County

Canadian Lakes (in T14N, R8W, S20, 29, 30 north of Pierce Rd and south of Buchanan Rd in S19), Haymarsh Lake and Horsehead Lake: no size limit on Northern Pike and up to five (5) Northern Pike may be retained in the daily possession limit with only one (1) greater than 24 inches.



Menominee County

Shakey Lakes Chain including: Beecher Lake, Long Lake, East Lake, Resort Lake, Baker Lake, and Spring Lake and Westman Impoundment (including North and Hayward Lakes): no size limit on Northern Pike and up to five (5) Northern Pike may be retained in the daily possession limit with only one (1) greater than 24 inches.

Missaukee County

Missaukee Lake: no size limit on Northern Pike and up to five (5) Northern Pike may be retained in the daily possession limit with only one (1) greater than 24 inches.

Montcalm County

Townline Lake and Sand Lake: protected slot limit on Northern Pike from 24 – 34 inches.

Montmorency County

North and South Blue Lakes: the fishing season shall be the last Saturday in April through September 30, inclusive. The daily possession limit is zero (0). Tackle: Artificial lures only.

Black River and tributary streams only, East Town Corner Lake, North Tomahawk Lake, Pug Lakes (T31N, R2E, S4, 5), Robarge (Pike) Lake, South Tomahawk Lake, and West Town Corner Lake: no size limit on Northern Pike and up to five (5) Northern Pike may be retained in the daily possession limit with only one (1) greater than 24 inches.

Muskegon County

Mona Lake: the minimum size limit on Muskellunge is 46 inches.

Big Blue Lake (T12N, R16W, S2, 3, 4): no size limit on Northern Pike and up to five (5) Northern Pike may be retained in the daily possession limit with only one (1) greater than 24 inches

Newaygo County

Sand Lake (T11N, R13W, S19) and Brush Lake (T14N, R12W, S1): the daily possession limit is zero (0) for Channel Catfish, Flathead Catfish, and Bullhead.

Baptist Lake (T11N, R11W, S23, 24): the daily possession limit is zero (0) for Walleye, Channel Catfish, Flathead Catfish, and Bullhead.

Crystal Lake: the daily possession limit is zero (0) for walleye.

Diamond Lake, Nichols Lake, Ryerson (Long) Lake, Pickerel Lake, Kimball Lake, Emerald Lake, and Sylvan Lake: no size limit on Northern Pike and up to five (5) Northern Pike may be retained in the daily possession limit with only one (1) greater than 24 inches.

Oakland County

Upper Bushman Lake (T4N, R9E, S3): the daily possession limit is zero (0).

Oceana County

Round (Wykoff) Lake and Silver Lake: no size limit on Northern Pike and up to five (5) Northern Pike may be retained in the daily possession limit with only one (1) greater than 24 inches.

Ogemaw County

East Twin Lake and Lake Ogemaw: no size limit on Northern Pike and up to five (5) Northern Pike may be retained in the daily possession limit with only one (1) greater than 24 inches.



Ontonagon County

Ontonagon River (Ontonagon County): no more than one (1) Walleye over 23 inches may be possessed in the daily possession limit.

Lake Gogebic: the minimum size limit for Walleye is 15 inches; however, anglers may possess two (2) Walleye from 13 - 15 inches as part of the daily possession limit of five (5) Walleye.

Lake of the Clouds (T15N, R43W, S21, 22): the daily possession limit for Smallmouth Bass is zero (0). Tackle: Artificial lures only. It shall be unlawful to use or possess live bait, dead bait, organic or processed food at any time on the shore or water.

Osceola County

Diamond Lake, Lake Miramichi, Rose Lake, and Wells Lake: no size limit on Northern Pike and up to five (5) Northern Pike may be retained in the daily possession limit with only one (1) greater than 24 inches.

Oscoda County

Pickerel Lake (Crawford and Oscoda Counties T24N, R1W, S24 and T28N, R1E, S19): no size limit on Northern Pike and up to five (5) Northern Pike may be retained in the daily possession limit with only one (1) greater than 24 inches.

Ottawa County

Grand River (downstream from Sixth Street Dam) and Lake Macatawa: the minimum size limit for Muskellunge is 46 inches.

Presque Isle County

Black Lake including all tributaries: the minimum size limit on Muskellunge is 46 inches.

Ocqueoc River and tributary streams, all lakes of the Ocqueoc River watershed including Ann, Bullhead, Ella, Emma, Ferdelman, Gorman, Horseshoe, Lost, Louise, Lower and Upper Barnhart, May, McIntosh, Moore, Mud, Nettie, Ocqueoc, and Orchard, the Black River and tributary streams, and the following lakes of the Black River watershed: Francis Lake, Tomahawk Flooding, East Town Corner Lake, and West Town Corner Lake: no size limit on Northern Pike and up to five (5) Northern Pike may be retained in the daily possession limit with only one (1) greater than 24 inches.

Roscommon County

Backus Creek from the stream mouth upstream, including all tributaries, Little Mud Lake Flooding, Backus Creek Flooding, and Backus Lake Flooding, Cut River from the river mouth at Houghton Lake upstream to CO 100 just downstream of Higgins Lake, Houghton Lake, and Lake St. Helen: no size limit on Northern Pike and up to five (5) Northern Pike may be retained in the daily possession limit with only one (1) greater than 24 inches.

Schoolcraft County

Boot Lake, Crooked Lake, Kennedy Lake, Seney Wildlife Refuge Ponds, Stanley Lake, and Thunder Lake: no size limit on Northern Pike and up to five (5) Northern Pike may be retained in the daily possession limit with only one (1) greater than 24 inches.

St. Joseph County

Corey Lake (T6S, R12W, S17, 18, 19, 20, 29) and Big Pleasant Lake: the minimum size limit on Largemouth Bass is 10 inches.

Magician Lake: protected slot limit on Northern Pike from 24 – 34 inches.

Van Buren County

Crooked Lake and Little Crooked Lake: the minimum size limit on Largemouth Bass is 10 inches.

Round Lake: the minimum size limit on Muskellunge is 38 inches.

Washtenaw County

Horseshoe Lake: the daily possession limit for Largemouth Bass and Northern Pike is one (1). The daily possession limit for Bluegill, Pumpkinseed, Redear, Green Sunfish, Black Crappie and White Crappie, Warmouth, and Rock Bass in combination is ten (10).

Huron River, from the Mast Road Bridge in the Village of Dexter (T1S, R5E, S32) downstream to the Delhi Road Bridge (T2S, R5E, S2): the daily possession limit of Largemouth and Smallmouth Bass is zero (0)

This Order shall be assigned number FO-206.20, and is titled "Special Fishing Regulations for Warmwater Species on Select Waters."

This Order supersedes the Order titled "Special Fishing Regulations for Warmwater Species on Select Waters," which became effective April 1, 2019, and is assigned number FO-206.19.

This Order shall take effect April 1, 2020 and shall remain in effect until amended/rescinded.

Issued on this 10th day of October, 2019.

Approved as to matters over which the Natural Resources Commission has authority.

Vicki J. Pontz, Chair  
Natural Resources Commission

Approved as to matters over which the Director has authority.

Daniel Eichinger  
Director



GRETCHEN WHITMER  
GOVERNOR

STATE OF MICHIGAN  
DEPARTMENT OF NATURAL RESOURCES  
LANSING



DANIEL EICHINGER  
DIRECTOR

SUBMITTED: August 12, 2019  
RESUBMITTED: September 16, 2019

MEMORANDUM TO THE NATURAL RESOURCES COMMISSION

<b>APPROVED</b>
_____, 20____
MICHIGAN NATURAL RESOURCES COMMISSION
(ASSISTANT TO THE COMMISSION)

Subject: Fisheries Order 215.20  
Statewide Warmwater Regulations for Largemouth Bass, Smallmouth Bass, Northern Pike, Walleye, Muskellunge, Channel Catfish, Flathead Catfish, Yellow Perch, Sunfishes, and White Bass

Authority:

The Natural Resources and Environmental Protection Act, 1994 PA 451, authorizes the Director and the Commission to issue Orders to regulate the taking of fish in the waters of this state.

Discussion and Background:

Fisheries Order 215 governs statewide warmwater sportfishing regulations. The Department recommends expanding the waters covered by the harvest quota process developed for Lake Erie and used to establish the daily possession limit for walleye. The change would result in adding the Detroit River, Lake St. Clair, and St. Clair River to the annual walleye harvest quota process used for Lake Erie. This change would also result in allowing one additional walleye, for a total of six, to be harvested in the Detroit River from April 1, 2020 through April 30, 2020 as part of the conditions already in effect for Lake Erie next spring. The other waters being added already have a six fish daily possession limit for walleye in effect.

Currently there are discrepancies in the walleye regulations for Lake Erie and the St. Clair – Detroit River System (SCDRS), which includes the Detroit River, Lake St. Clair, and the St. Clair River. The walleye possession limit on the Detroit River aligns with the current statewide daily possession limit of five fish. The St. Clair River (beginning at the Ft. Gratiot Lighthouse) and Lake St. Clair walleye daily possession limit allows one additional walleye (above the statewide limit) for a total of six fish per day. Lake Erie's current daily possession limit for walleye also allows six fish, which is based on Michigan's share of the annual total allowable catch (TAC) for walleye pursuant to the categories in the table listed below in the Order. The TAC is determined in March of each year by the Lake Erie Committee, which is under the aegis of the Great Lakes Fishery Commission. The Lake Erie daily possession limit for walleye (as indicated in the Order) takes effect on May 1 of each year and is in place through April 30 of the following year. Prior to May 1 each year, a notice of the daily possession limit is posted on the Department's website ([www.michigan.gov/fishing](http://www.michigan.gov/fishing)), noted in a statewide news release, and available as a pre-recorded message at 888-367-7060. The recommended regulation proposal will simplify walleye possession limits by for the waters referenced above and shift to implementing a new management strategy for determining the walleye daily possession limit in the SCDRS by combining it with Lake Erie for a more unified process.

The biology of walleye in Lake Erie and SCDRS supports harvest strategies for the system as a whole. Lake Erie walleye are highly migratory and walleye from across western Lake Erie move through the Detroit River and up to Lake St. Clair and the St. Clair River. It is estimated that anywhere from 3.6 to 12.6 million walleye move through the St. Clair – Detroit River System (SCDRS) each year. Tagging,



telemetry, and genetic data indicate Lake Erie walleye are the major source of walleye in the SCDRS. Inland tributaries, such as the Clinton River, produce a negligible number in comparison and since at least 2000, the Thames River in Ontario is no longer a major contributor to the Lake St. Clair walleye population due to poor recruitment. Tagging data indicates less than one percent of walleye from Saginaw Bay/Lake Huron move down into Lake St. Clair. The walleye throughout the system are primarily Lake Erie stock that move and contribute to the SCDRS walleye fishery.

Although the daily possession limit will be tied to the Lake Erie TAC, walleye harvested in the SCDRS will not count towards the TAC, just as walleye caught in tributaries in other boundary jurisdictions are not counted toward their TAC. Managers have indicated that adding the SCDRS to the Lake Erie management process will improve their ability to respond to any future population declines by being able to better manage the stock as one population. This change will result in a consistent walleye daily possession limit throughout the connected waterbodies of the SCDRS and Lake Erie which will benefit anglers as well as law enforcement personnel.

#### *Issue Pros and Cons*

There are currently two different walleye possession limits in the Detroit River and the other connected waters of the SCDRS and Lake Erie. Moving to a new process, which manages the stock as one throughout the whole system, will result in a more streamlined management process and reduce confusion among anglers. There are no cons associated with this proposed change.

#### *Biological*

Tagging and genetic information have indicated that the walleye stock is primarily from Lake Erie; therefore, managing the system as one will be more efficient and better align with walleye dynamics in that area. The proposed change will benefit the resource and anglers.

#### *Social*

Anglers are supportive of more consistent regulations and continued protection of the resource. This change will make the walleye possession limit easier for anglers to follow. This will also benefit law enforcement efforts.

#### *Economic*

The Department does not expect the proposed changes to have any significant budgetary or personnel implications.

The following page is a signature page only.

September 16, 2019

Recommendation:

Relevant Divisions have contributed to the preparation of this Order. This Order was submitted for information on September 12, 2019, at the Natural Resources Commission meeting. This item appeared on the Department's August 30, 2019 calendar and may be eligible for approval on October 10, 2019.

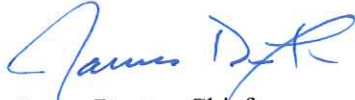

James Dexter, Chief  
Fisheries Division



Russ Mason, Ph.D., Chief  
Wildlife Division



Ronald A. Olson, Chief  
Parks and Recreation Division



Gary Hagler, Chief  
Law Enforcement Division



Debbie Begalle, Chief  
Forest Resources Division

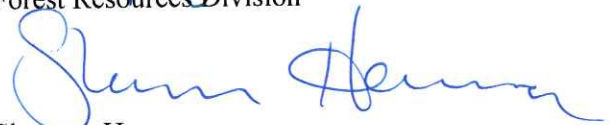

Shannon Hanna  
Natural Resources Deputy

I have analyzed and discussed these recommendations with staff and concur as to matters over which the Director has authority.

\_\_\_\_\_  
Daniel Eichinger, Director

\_\_\_\_\_  
Date

# FISHERIES ORDER

## Statewide Warmwater Regulations for Largemouth Bass, Smallmouth Bass, Northern Pike, Walleye, Muskellunge, Channel Catfish, Flathead Catfish, Yellow Perch, Sunfishes, and White Bass Order 215.20

By authority conferred on the Natural Resources Commission and the Department of Natural Resources by Part 487 of 1994 PA 451, MCL 324.48701 to 324.48740, ordered on October 10, 2019, the following section(s) of the Fisheries Order shall read effective April 1, 2020, as follows:

### A. For the purpose of this Order the following definitions are provided:

- 1) Catch-and-Immediate-Release (CIR): means the act of returning fish immediately to the water without injury and without holding in livewell or like object.
- 2) MH-4: is a Lake Trout management unit which is bounded on the north by a line beginning on the shore on Au Sable Point in Iosco County at Latitude 44°20'N and extending eastward along said latitude to Longitude 083°10'W, then southward along said longitude to Latitude 44°10'N, then eastward along said latitude to Longitude 082°40'W, then southward along said line to Latitude 44°00'N, then westward along said line to shore about 2.6 miles southeast of Point aux Barques Light in Huron County.

The statewide seasons, size limits, and daily possession limits on all state waters shall be as listed below, except as otherwise Ordered:

### B. Statewide Seasons

A person shall not take, catch, or kill or attempt to take, catch or kill any of the species of fish named in this Order except during the seasons that are specified below for each species of fish named in this Order.

- 1) Largemouth Bass and Smallmouth Bass:
  - a) CIR fishing shall be permitted all year.
  - b) On Lake St. Clair, St. Clair River, and Detroit River:
    - i) The possession season shall be the third Saturday in June - December 31.
  - c) On Lake Michigan within one-half mile of the following islands of the Beaver Island Archipelago – Beaver, Garden, High, and Hog, Charlevoix County:
    - i) The possession season shall be July 1 - December 31.
  - d) All other waters not otherwise closed to fishing:
    - i) The possession season shall be the Saturday before Memorial Day - December 31.
- 2) Walleye, Northern Pike, and Muskellunge:
  - a) CIR fishing for Muskellunge shall be permitted all year.



- b) An area in the Green Bay portion of Lake Michigan, Menominee County, beginning at the intersection of the north boundary line of Menominee County with the west shoreline of the Bay in Section 3, T36N, R24W or approximate latitude/longitude (45.5505, -87.2637); thence east approximately 8 miles to latitude/longitude (45.5505, -87.101); thence south approximately 10 miles to the intersection with the state boundary at approximate latitude/longitude (45.444, -87.101); thence southwesterly and westerly approximately 36 miles along the state boundary in Green Bay, between the mainland of Michigan and the Door Peninsula of Wisconsin, to the mouth of the Menominee River, thence northeasterly along the shoreline of Green Bay to the point of beginning:
    - i) The possession season for Walleye shall be open for the entire year.
    - ii) The possession season for Northern Pike shall be May 15 - March 15.
    - iii) The possession season for Muskellunge shall be from the first Saturday in June - March 15.
  - c) All other inland, Great Lakes, and connecting waters of the Upper Peninsula not otherwise closed to fishing:
    - i) The possession season for Walleye and Northern Pike shall be from May 15 - March 15.
    - ii) The possession season for Muskellunge shall be from the first Saturday in June - March 15.
  - d) Inland waters of the Lower Peninsula not otherwise closed to fishing:
    - i) The possession season for Walleye and Northern Pike shall be from the last Saturday in April - March 15.
    - ii) The possession season for Muskellunge shall be from the first Saturday in June - March 15.
  - e) Lake St. Clair, the St. Clair River, and Detroit River:
    - i) The possession season for Muskellunge shall be the first Saturday in June - December 31.
    - ii) The possession season for Walleye and Northern Pike shall be open for the entire year.
  - f) All other Great Lakes and connecting waters of the Lower Peninsula not otherwise closed to fishing:
    - i) The possession season for Walleye and Northern Pike shall be open for the entire year.
    - ii) The possession season for Muskellunge shall be from the first Saturday in June - March 15.
- 3) Flathead Catfish, Channel Catfish, Yellow Perch, Sunfishes, and White Bass:
- a) All waters not otherwise closed to fishing:
    - i) The possession season shall be open for the entire year.

**C. Statewide Warmwater Regulations; Size and Possession Limits**

Species	Minimum Size Limit	Daily Possession Limit
Largemouth Bass and Smallmouth Bass	14 inches	Five (5) per day in any combination
Walleye (See Note 1)	15 inches	Five (5) per day
Northern Pike (See Note 2)	24 inches	Two (2) per day
Flathead Catfish	15 inches	Five (5) per day
Muskellunge (including Tiger Muskellunge) (See Note 3)	42 inches	One (1) per angling season
Channel Catfish	12 inches	Ten (10) per day
Yellow Perch (See Note 4)	No size limit	Twenty-five (25) per day
Sunfishes: Black Crappie, Bluegill, Green Sunfish, Hybrid Sunfish, Longear Sunfish, Pumpkinseed, Redear, Rock Bass, Warmouth, White Crappie	No size limit	Twenty-five (25) per day in any combination
White Bass	No size limit	Twenty-five (25) per day on Great Lakes, Lake St. Clair, St. Marys River, St. Clair River, and Detroit River;  Ten (10) per day on inland waters

**NOTES**

1. **Walleye** - the following waters have regulations that differ from the statewide regulations:
  - a) St. Clair River beginning at the Ft. Gratiot Light and Lake St. Clair:
    - i) The minimum size limit shall be 13 inches.
  - b) Lake Michigan waters of Little Bay de Noc: that portion north of a line drawn from Peninsula Point Lighthouse to the mouth of the Bark River in Delta County.
    - i) The daily possession limit shall not include more than one (1) Walleye 23" or greater.
  - c) Lake Michigan waters of Green Bay: An area in the Green Bay portion of Menominee County, beginning at the intersection of latitude 45 degrees 30 minutes north with the west shoreline of the Bay in Section 24, T36N, R24W, thence east approximately 6 miles to the intersection of latitude 45 degrees 30 minutes north with longitude 87 degrees 10 minutes west, thence south approximately 10 miles to the intersection of longitude 87 degrees 10 minutes west with the state boundary, thence southwesterly and westerly approximately 36 miles along the state boundary in Green Bay, between the mainland of Michigan and the Door Peninsula of Wisconsin, to the mouth of the Menominee River, thence northeasterly along the shoreline of Green Bay to the point of beginning:



- i) March 2 - the Friday before the first Saturday in May the daily possession limit shall be one (1) Walleye; and
- ii) The first Saturday in May - March 1 the daily possession limit shall be five (5) Walleyes.
- d) Lake Huron waters of MH-4 including Saginaw Bay and Saginaw River up to Center Road Bridge:
  - i) The minimum size limit for Walleye shall be 13 inches.
  - ii) The daily possession limit for Walleye shall be eight (8).
- e) Lake Erie, Detroit River, Lake St. Clair, and St. Clair River (beginning at the Ft. Gratiot Light):
  - i) The daily possession limit for Walleye will be based on Michigan's share of the annual total allowable catch (TAC) for Walleye pursuant to the categories in the table below. The TAC is reported in March of each year by the Lake Erie Committee, which is under the aegis of the Great Lakes Fishery Commission.
    - (1) The daily possession limit for Walleye will take effect on May 1 of each year and will be in place through April 30 of the following year.
    - (2) Prior to May 1 each year, a notice of the daily possession limit will be posted on the DNR's website ([www.michigan.gov/fishing](http://www.michigan.gov/fishing)) and noted in a statewide news release.

Michigan TAC	Walleye Possession Limit
greater than 108,364	six (6)
96,958 to 108,364	five (5)
85,551 to 96,957	four (4)
74,144 to 85,550	three (3)
62,737 to 74,143	two (2)
less than 62,737	one (1)

- 2. **Northern Pike** - the following waters have daily possession limits that differ from the statewide daily possession limit:
  - a) Lake St. Clair, St. Clair River, and Detroit River:
    - i) The daily possession limit for Northern Pike shall be five (5).
- 3. **Muskellunge** - anglers are required to register Muskellunge (including Tiger Muskellunge) harvest within 24 hours online at [www.michigan.gov/fishing](http://www.michigan.gov/fishing).
  - a) Statewide:
    - i) Muskellunge harvest is limited to one (1) Muskellunge per angler per year (April 1 – March 31).
- 4. **Yellow Perch** – the following waters have daily possession limits that differ from the statewide daily possession limit:
  - a) Lake Erie:
    - i) The daily possession limit for Yellow Perch shall be fifty (50).
  - b) Lake Gogebic:
    - i) The daily possession limit for Yellow Perch shall be twenty-five (25), with no more than five (5) Yellow Perch 12 inches or greater.



This Order shall be assigned number FO-215.20, and is titled "Statewide Warmwater Regulations for Largemouth Bass, Smallmouth Bass, Northern Pike, Walleye, Muskellunge, Channel Catfish, Flathead Catfish, Yellow Perch, Sunfishes, and White Bass."

This Order supersedes the Order titled "Statewide Coolwater Regulations for Largemouth Bass, Smallmouth Bass, Northern Pike, Walleye, Muskellunge, Channel Catfish, Flathead Catfish, Yellow Perch, Sunfishes, and White Bass," which became effective April 1, 2019, and is assigned number FO-215.19.

This Order shall take effect on April 1, 2020, and shall remain in effect until amended/rescinded.

Issued on this 10th day of October, 2019.

Approved as to matters over which the Natural Resources Commission has authority.

Vicki J. Pontz, Chair  
Natural Resources Commission

Approved as to matters over which the Director has authority.

Daniel Eichinger  
Director



GRETCHEN WHITMER  
GOVERNOR

STATE OF MICHIGAN  
DEPARTMENT OF NATURAL RESOURCES  
LANSING



DANIEL EICHINGER  
DIRECTOR

SUBMITTED:  
RESUBMITTED:

August 12, 2019  
September 16, 2019

TO: Daniel Eichinger, Director

Subject: Fisheries Order 243.19  
State-Licensed Commercial Fishing

Authority:

The Natural Resources and Environmental Protection Act, 1994 PA 451, authorizes the Director and the Commission to issue Orders to regulate the taking of fish in the waters of this state.

Discussion and Background:

Fisheries Order 243 is used to address issues impacting management of the state-licensed commercial fishery for the better protection, preservation, maintenance, and harvesting of the fish. This Order has been renewed annually for the past three years and requires renewal again in 2019. The current Order is set to expire on November 15, 2019 and it is recommended by Fisheries Division and Law Enforcement Division to be modified as indicated below.

The Department proposes to modify the Order to address an administrative issue concerning wholesale reporting delinquencies which have habitually been submitted late. Tracking delinquencies has always been difficult as reports were mailed to the Department in Lansing, transferred from Law Enforcement Division to Fisheries Division, then hand entered as staff had time. It was not possible to accurately track delinquencies. As of March 1, 2019, all wholesale transactions are now reported electronically through software known as FACTS (Fishery Activity and Catch Tracking System). As postal mail, departmental transfer of paper, and hand entry are no longer part of the process, a delay in the time over which a report is delinquent is no longer necessary. In order to provide more timely and accurate information to Tribal governments, per the terms of the 2000 Consent Decree, delinquencies need immediate attention, and this Order change will allow Law Enforcement Division to address the problem. Therefore, the following modification is recommended for the Order at the end of section 11 to modify the last sentence to state:

- Reports not received by the Department by the tenth day after the end of the month in which the fish were acquired shall be considered delinquent and in violation of this Order.

Under the authority of Section 46702 of 1994 PA 451, the effective date of any Order issued by the Department under this part shall not be less than 30 days from and after the date of its issuance and requires notification by first class mail to all persons licensed under part 473. Therefore, it is recommended that this Order shall take effect November 16, 2019 and shall remain effective through November 15, 2020.

The following page is a signature page only.

Recommendation:

It is our recommendation to continue to utilize FO-243.19 to clarify commercial fishing law for the better protection, preservation, maintenance, and harvesting of the fish. Relevant Divisions have contributed to the preparation of this Order. This Order was submitted for information on September 12, 2019, at the Natural Resources Commission meeting. This item appeared on the Department's August 30, 2019 calendar and may be eligible for approval on October 10, 2019.

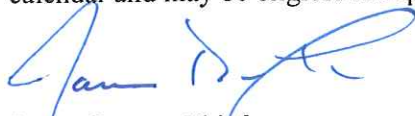
  
James Dexter, Chief  
Fisheries Division

 *Steven B. Burton*  
Gary Hagler, Chief *for*  
Law Enforcement Division

  
Russ Mason, Ph.D., Chief  
Wildlife Division

  
Debbie Begalle, Chief  
Forest Resources Division

  
Ronald A. Olson, Chief  
Parks and Recreation Division

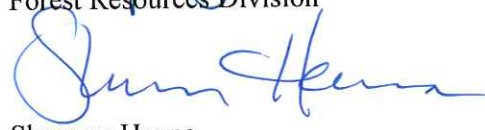
  
Shannon Hanna  
Natural Resources Deputy

I have analyzed and discussed these recommendations with staff and concur as to matters over which the Director has authority.

\_\_\_\_\_  
Daniel Eichinger, Director

\_\_\_\_\_  
Date



# FISHERIES ORDER

## State-Licensed Commercial Fishing Order 243.19

Under the authority of Sections 46701 and 46702 of 1994 PA 451, as amended, MCL 324.46701 and MCL 324.46702, the Director of the Department of Natural Resources on October 10, 2019, ordered that the following state-licensed commercial fishing regulations shall take effect November 16, 2019:

1. State-licensed commercial trap net fishing is permitted in water depths of up to 150 feet in Lakes Huron, Michigan, and Superior under licenses issued by the Director.
2. The commercial harvest of chubs (*Coregonus hoyi*) is permitted in Lake Michigan north of Grand Haven under licenses issued by the Director.
3. Lake Erie is designated as rough fish grounds for commercial fishing as defined in MCL 324.47309(g).
4. The commercial harvest of Lake whitefish (*Coregonus clupeaformis*), 17 inches in length and greater, caught in Lake Erie in legally set trap nets, is permitted under licenses issued by the Director.
5. The department or its properly permitted designee may take fish in any manner, in any of the waters mentioned in this part, at any and all seasons of the year, for the purpose of fish culture or scientific investigation; may have and hold ripe and unripe fish for scientific investigation or in order to take spawn from the fish; and may sell or direct to be sold all of those ripe and unripe fish. A permitted designee of the department shall comply with the conditions established in the permit.
6. State-licensed commercial fishers shall comply with all license conditions.
7. Whitefish in lakes Michigan, Huron, and Superior shall be closed to harvest from noon on November 1 to noon on November 30.
8. It shall be unlawful to market, have in possession, transport, or offer for sale at any time, whether caught within or without this state any catfish of a length less than 15 inches, except that catfish of a length not less than 14 inches may be taken from Lake Erie, but such fish shall not be sold or offered for sale except at a dock or docks along said lake.
9. Suckers may be commercially taken from all waters of the state open to commercial fishing without a size limit and without a closed season.
10. Imported commercial and game fish species of a size, weight, or species not prohibited by the laws of the state or country where caught that are not processed outside the state of Michigan and sold to the consumer in the same package as imported may be possessed, transported, offered for sale, and marketed as follows:
  - a. A wholesale fish dealer who directly or indirectly imports the fish shall:
    - i. Retain for 30 days following importation a commercial invoice or bill of sale or, if imported from Canada, the customs entry or customs broker's statement, which shall include the species of fish and formal entry number;

- ii. Keep a record including the quantity and species of fish and the name and address of every retailer to whom such fish are sold or shipped; and
    - iii. Make the documents and records required by this section available for inspection by any law enforcement officer at any reasonable time.
  - b. A retail fish dealer shall retain a bill of sale or invoice indicating the quantity and species of fish and the name and address of the consignor for inspection by any law enforcement officer at any reasonable time until the fish are disposed of by sale or otherwise.
11. In addition to the requirement established in Section 10(a) of this Order, wholesale fish dealers licensed in Michigan, whether they are located within or outside the state, shall fill out and submit monthly purchase records on forms provided by the Department. Forms containing the monthly purchase records shall be submitted to the Department by the tenth day after the end of the month in which the fish were acquired. Reports not received by the Department by the tenth day after the end of the month in which the fish were acquired shall be considered delinquent and in violation of this Order.

This Order modifies conditions as set forth in MCL 324.47302, MCL 324.47309 (h and i), MCL 324.47311 (b and f), MCL 324.47315, MCL 324.47319 (Subsection 1. e and f and Subsection 2), and MCL 324.47333 of 1994, PA 451, and Administrative Rule R 299.1074(b, c, and e) and Administrative Rule R 299.1075(3).

This Order shall be assigned number FO-243.19, and is titled "State-Licensed Commercial Fishing."

This Order supersedes the order titled "State-Licensed Commercial Fishing," which became effective November 15, 2018, and is assigned number FO-243.18.

Per MCL 324.46702, this Order shall not take effect less than 30 days after being issued. This Order shall take effect November 16, 2019 and shall remain effective through November 15, 2020.

Issued on this 10th day of October, 2019.

Daniel Eichinger  
Director



GRETCHEN WHITMER  
GOVERNOR

STATE OF MICHIGAN  
DEPARTMENT OF NATURAL RESOURCES  
LANSING



DANIEL EICHINGER  
DIRECTOR

September 16, 2019

TO: Daniel Eichinger, Director

INFORMATION: Natural Resources Commission

Transaction: Sale of Surplus DNR-Managed Land  
Traverse City Management Unit – Kalkaska County  
Land Transaction Case Nos. 20050367, 20050368, 20050369,  
20050370, and 20050372

Sale: 2.58 acres

Sale Price: \$10,000.00

Description: Kalkaska County, Blue Lake Township, T28N, R05W, Section 8:  
Part of the NW 1/4 of the SW1/4, as more completely described in the  
case file.

PA 240 of 2018: The parcels are north of the Mason-Arenac line and will result in a  
decrease of 2.58 acres in DNR-managed lands.

Applicant(s): Eagle Lake Subdivision Lot Owners

Authority: Natural Resources and Environmental Protection Act, 1994 PA 451,  
as amended.

Notice: This item will appear on the Department of Natural Resources  
(Department) October 2, 2019 calendar and is eligible for approval on  
October 8, 2019.

Acquired: By tax reversion in 1930.

Minerals: To be retained.

Comments: The applicants desire to acquire the small strip (0.64 acre) of shoreline  
portion, along with a portion of Eagle Lake which lies between their  
rear lot lines and the waters of Eagle Lake. The land is surplus to  
state needs and has been a chronic management issue for years.

The proposed land disposal was recommended for approval as  
surplus by the Land Exchange Review Committee on  
December 15, 2005.

Proceeds from the sale will be deposited into the Land Exchange  
Facilitation Fund (LEFF). The LEFF allows the Department to sell  
rights in land and deposit the proceeds in a fund which can then be  
used to acquire replacement property.



Engagement: Due to the small size and restricted access to this property, no local engagement is required.

- Recommendation(s):
1. That the land be sold to the applicants collectively for \$10,000.00.
  2. That the proceeds of the sale be deposited in the LEFF.
  3. That the state retain aboriginal antiquities and mineral rights.

The following on this page is signatures only.



Russ Mason, Ph.D., Chief  
Wildlife Division



Deb Begalle, Chief  
Forest Resources Division



James L. Dexter, Chief  
Fisheries Division



Ronald A. Olson, Chief  
Parks and Recreation Division



Shannon Hanna  
Natural Resources Deputy



Mark H. Hoffman  
Chief Administrative Officer

I approve the staff recommendations.

Daniel Eichinger  
Director

\_\_\_\_\_  
Date Approved

# SALE OF SURPLUS DNR-MANAGED LAND

Traverse City Management Unit - Kalkaska County

Land Transaction Cases #20050367, 20050368, 20050369, 20050370, 20050372

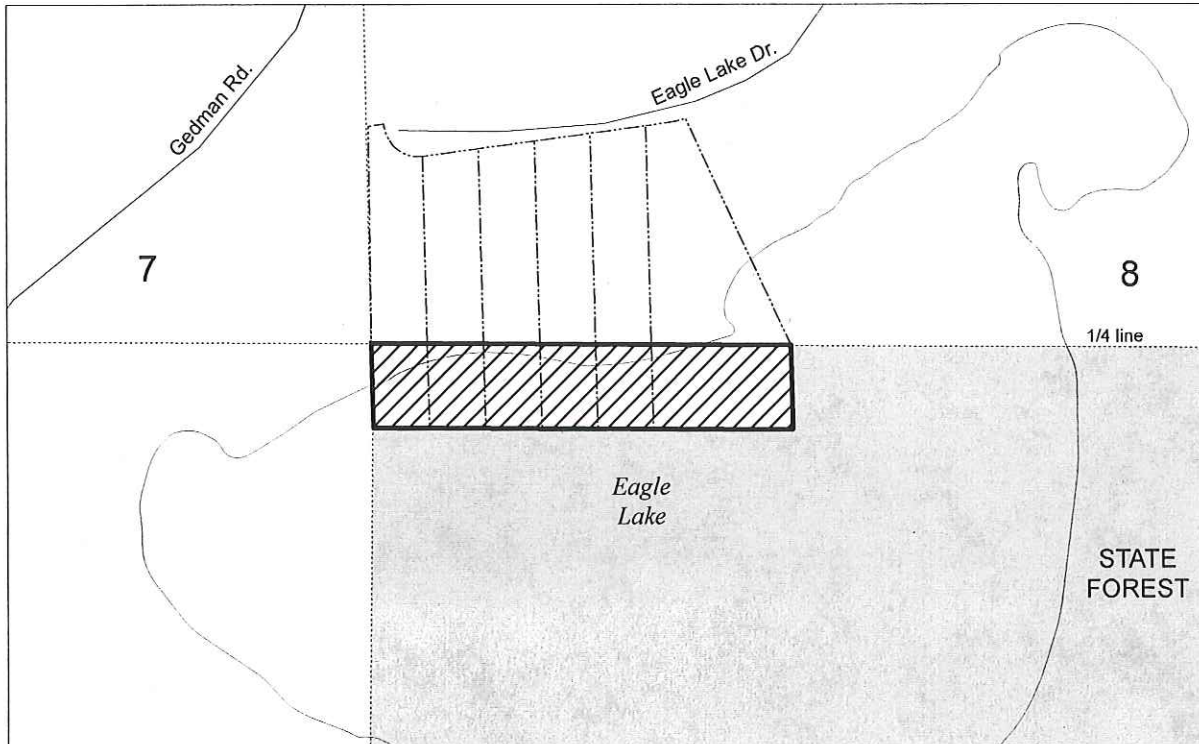

Section 8, T28N, R05W, Blue Lake Township

Surplus DNR land to be sold (2.58 acres)

State land

Private land

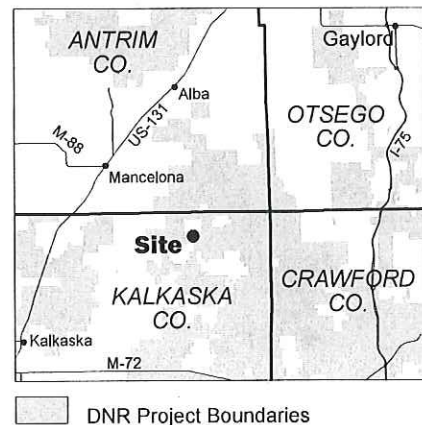



GRETCHEN WHITMER  
GOVERNOR

STATE OF MICHIGAN  
DEPARTMENT OF NATURAL RESOURCES  
LANSING



DANIEL EICHINGER  
DIRECTOR

September 16, 2019

TO: Daniel Eichinger, Director

INFORMATION: Natural Resources Commission

Transaction: Sale of Surplus DNR-Managed Land  
Atlanta Management Unit – Alpena County  
Land Transaction Case #20180009

Sale: 200 acres

Sale Price: Sale price to be determined at auction.

Description: Alpena County, Alpena Township, T32N, R09E, Section 32:  
The W 1/2 of the SW 1/4, NE 1/4 of SW 1/4, NW 1/4 of SE 1/4, and  
SE 1/4 of SE 1/4

PA 240 of 2018: These parcels are north of the Mason-Arenac county line and will  
result in a decrease of 200 acres in DNR-managed lands.

Authority: Natural Resources and Environmental Protection Act, 1994 PA 451,  
as amended.

Notice: This item will appear on the Department of Natural Resources  
(Department) October 2, 2019 calendar and is eligible for approval on  
October 8, 2019.

Acquired: By tax reversion in 1927, 1940 and 1941.

Minerals: Mineral rights will be reviewed when this transaction is prepared for  
auction.

Comments: The parcels are not adjacent to other state-owned land and are  
surrounded by private ownership.

The proposed land disposal was recommended for approval as  
surplus by the Land Exchange Review Committee on  
February 15, 2018.

Proceeds will be deposited into the Land Exchange Facilitation Fund  
(LEFF). The LEFF allows the Department to sell rights in land and  
deposit the proceeds in a fund which can then be used to acquire  
replacement property.

Engagement: As required by PA 240 of 2018, information regarding this transaction  
has been posted on the department's website, published in a local



newspaper, and sent to Alpena Township and Alpena County. No comments have been received.

- Recommendation:
1. That the lands be disposed of as surplus.
  2. That the proceeds of the sale be deposited in the LEFF.
  3. That the State of Michigan follow the recommendation of the Office of Minerals Management regarding mineral rights.

The following on this page are signatures only.



Russ Mason, Ph.D., Chief  
Wildlife Division



Deb Begalle, Chief  
Forest Resources Division



James L. Dexter, Chief  
Fisheries Division



Ronald A. Olson, Chief  
Parks and Recreation Division



Shannon Hanna  
Natural Resources Deputy



Mark H. Hoffman  
Chief Administrative Officer

I approve the staff recommendations.

Daniel Eichinger  
Director

\_\_\_\_\_  
Date Approved

# SALE OF SURPLUS DNR-MANAGED LAND

Atlanta Management Unit – Alpena County  
Land Transaction Case #20180009

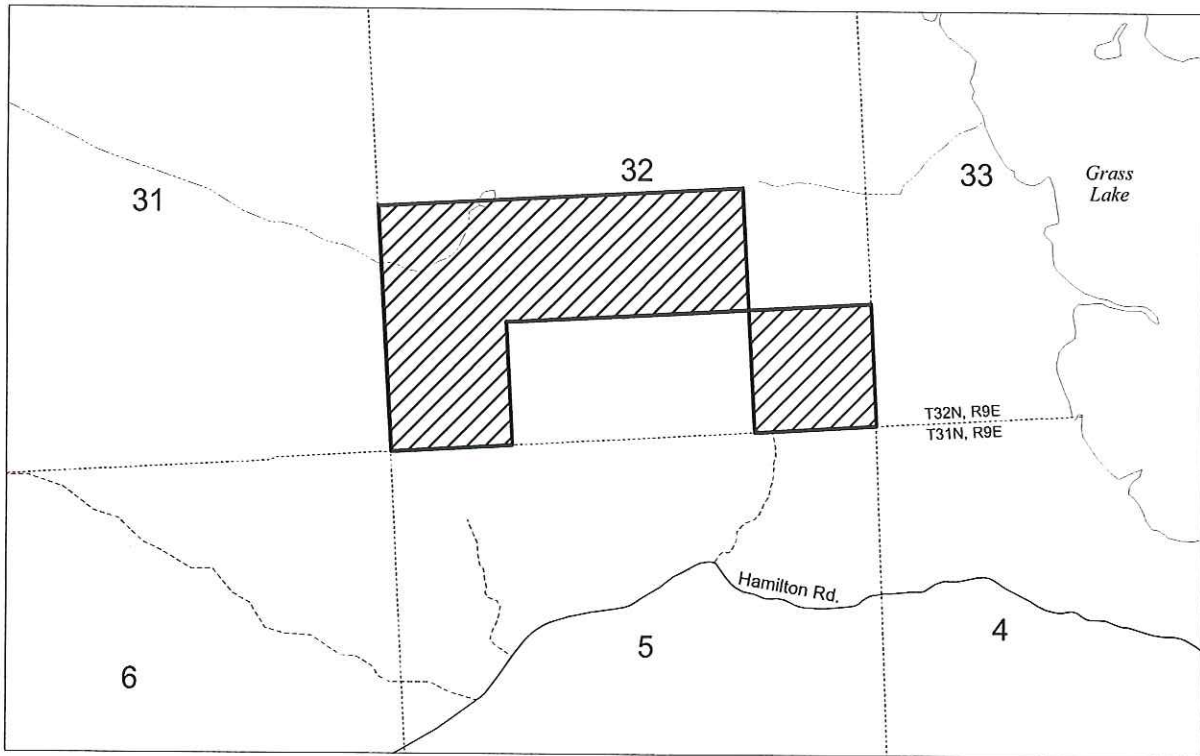

Section 32, T32N, R09E, Alpena Township

 Surplus DNR land to be sold (200 acres)

 State land

 Private land

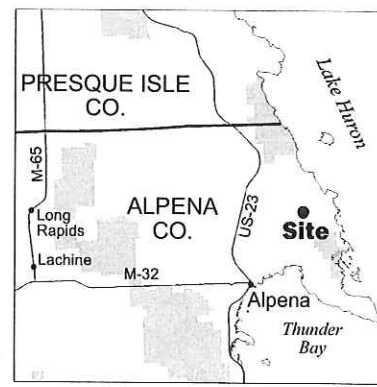
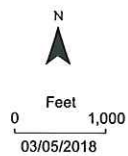

 DNR Project Boundaries



GRETCHEN WHITMER  
GOVERNOR

STATE OF MICHIGAN  
DEPARTMENT OF NATURAL RESOURCES  
LANSING



DANIEL EICHINGER  
DIRECTOR

September 16, 2019

TO: Daniel Eichinger, Director

INFORMATION: Natural Resources Commission

Transaction: Sale of Surplus DNR-Managed Land  
Cadillac Management Unit – Lake County  
Land Transaction Case #20180050

Sale: 10.24 acres

Sale Price: Sale price to be determined at auction.

Description: Lake County, Cherry Valley Township, T18N, R12W, Section 33:  
Lot 21, Cherry Valley Community, and part of the SW 1/4 of SE 1/4

PA 240 of 2018: These parcels are south of the Mason-Arenac county line and will  
result in a decrease of 10.24 acres in DNR-managed lands.

Authority: Natural Resources and Environmental Protection Act, 1994 PA 451,  
as amended.

Notice: This item will appear on the Department's October 2, 2019 calendar  
and is eligible for approval on October 8, 2019.

Acquired: By tax reversion in 1939, 1980, 1982 and 1984.

Minerals: Mineral rights will be reviewed when this transaction is prepared for  
auction.

Comments: These parcels are small in size and not easy to manage. The parcels  
in the SW 1/4 of SE 1/4 are not adjacent to other state-owned land  
and are surrounded by private ownership.

The proposed land disposal was recommended for approval as  
surplus by the Land Exchange Review Committee on  
June 20, 2019.

Proceeds will be deposited into the Land Exchange Facilitation Fund  
(LEFF). The LEFF allows the Department to sell rights in land and  
deposit the proceeds in a fund which can then be used to acquire  
replacement property.

Engagement: Local engagement will be completed as part of the auction process.



- Recommendation:
1. That the lands be disposed of as surplus.
  2. That the proceeds of the sale be deposited in the LEFF.
  3. That the State of Michigan follow the recommendation of the Office of Minerals Management regarding mineral rights.

The following on this page are signatures only.



Russ Mason, Ph.D., Chief  
Wildlife Division



Deb Begalle, Chief  
Forest Resources Division



James L. Dexter, Chief  
Fisheries Division



Ronald A. Olson, Chief  
Parks and Recreation Division



Shannon Hanna  
Natural Resources Deputy



Mark H. Hoffman  
Chief Administrative Officer

I approve the staff recommendations.

Daniel Eichinger  
Director

\_\_\_\_\_  
Date Approved

# SALE OF SURPLUS DNR-MANAGED LAND

Cadillac Management Unit - Lake County

Land Transaction Case #20180050

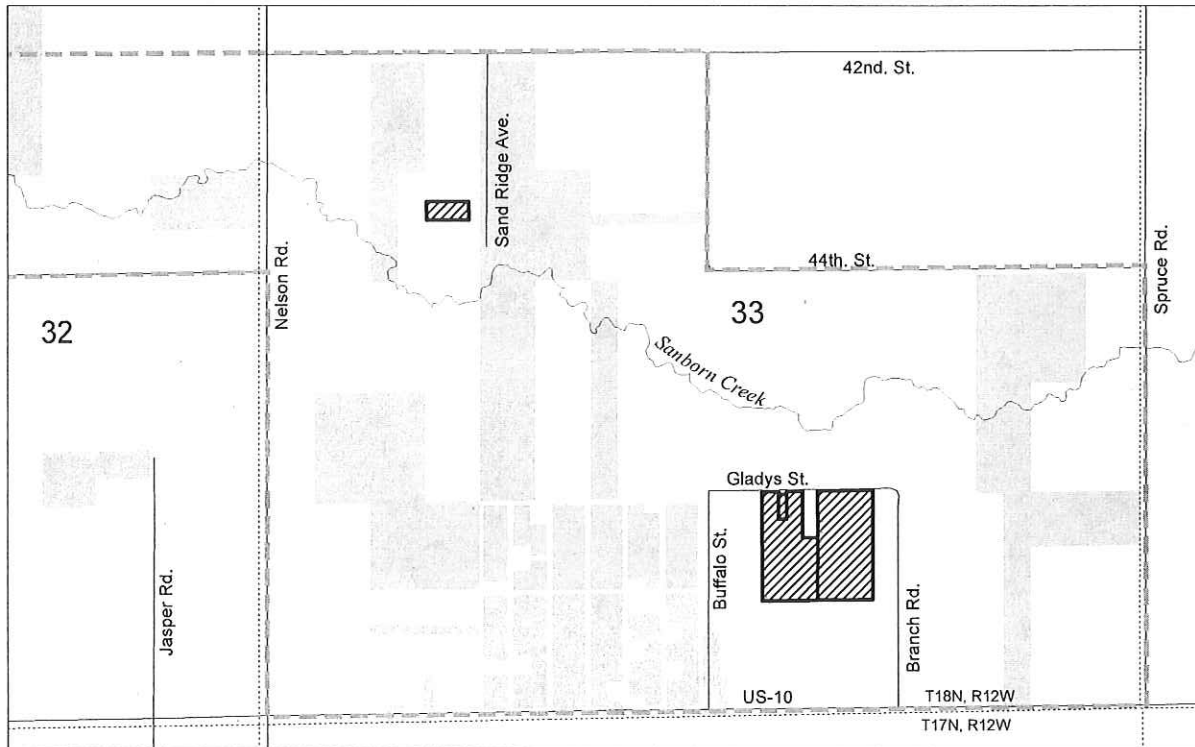

Section 33, T18N, R12W, Cherry Valley Township

Surplus DNR land to be sold (10.24 acres)

State land

Private land

DNR Project Boundary

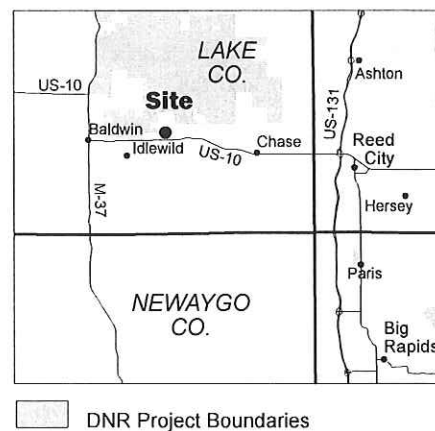
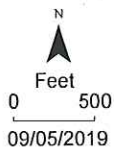



GRETCHEN WHITMER  
GOVERNOR

STATE OF MICHIGAN  
DEPARTMENT OF NATURAL RESOURCES  
LANSING



DANIEL EICHINGER  
DIRECTOR

September 16, 2019

TO: Daniel Eichinger, Director

INFORMATION: Natural Resources Commission

Transaction: Sale of Surplus DNR-Managed Land  
Michigan Air Line Trail – Oakland County  
Land Transaction Case #20180171

Sale: 4.90 acres

Sale Price : \$8,800.00

Description: Oakland County, City of Wixom, T02N, R08E, Section 31:  
All that portion of the 50-foot wide right of way and property of the  
Grand Trunk Western Railroad Company's abandoned Jackson  
Subdivision, as more accurately described in the case file.

PA 240 of 2018: These parcels are south of the Mason-Arenac county line and will  
result in a decrease of 4.90 acres in DNR-managed lands.

Applicant(s): City of Wixom

Authority: Natural Resources and Environmental Protection Act, 1994 PA 451,  
as amended.

Notice: This item will appear on the Department of Natural Resources  
(Department) October 2, 2019 calendar and is eligible for approval on  
October 8, 2019.

Acquired: Acquired in 1989 with Michigan Land Trust Fund.

Minerals: To be conveyed.

Comments: The City of Wixom desires to proceed with the second phase of  
development of the Michigan Air Line Trail. The trail is located along a  
former Grand Trunk Western Railroad corridor that the Department  
acquired in 1989 for recreational trail use. The City of Wixom has  
dedicated pathway money that can be used to construct the trail, but  
to do so the property needs to be under the City of Wixom's  
ownership.

The proposed transaction was reviewed by Department staff and  
recommended for direct sale. The Land Exchange Review Committee  
approved this transaction on December 20, 2018, with the condition  
that the property be conveyed with the Michigan Natural Resources  
Trust Fund encumbrances intact.



Proceeds from the sale will be deposited into the Michigan Natural Resources Trust Fund (MNRTF).

- Recommendation:
1. That the land be sold to the applicant for \$8,800.00, subject to the state retaining aboriginal antiquities.
  2. That the proceeds of the sale be deposited in the MNRTF.
  3. That the mineral rights be conveyed to the City of Wixom.

The following on this page are signatures only.



Russ Mason, Ph.D., Chief  
Wildlife Division



Deb Begalle, Chief  
Forest Resources Division



James L. Dexter, Chief  
Fisheries Division



Ronald A. Olson, Chief  
Parks and Recreation Division



Shannon Hanna  
Natural Resources Deputy



Mark H. Hoffman  
Chief Administrative Officer

I approve the staff recommendations.

Daniel Eichinger  
Director

\_\_\_\_\_  
Date Approved

# SALE OF SURPLUS DNR-MANAGED LAND

Michigan Air Line Trail - Oakland County  
Land Transaction Case #20180171

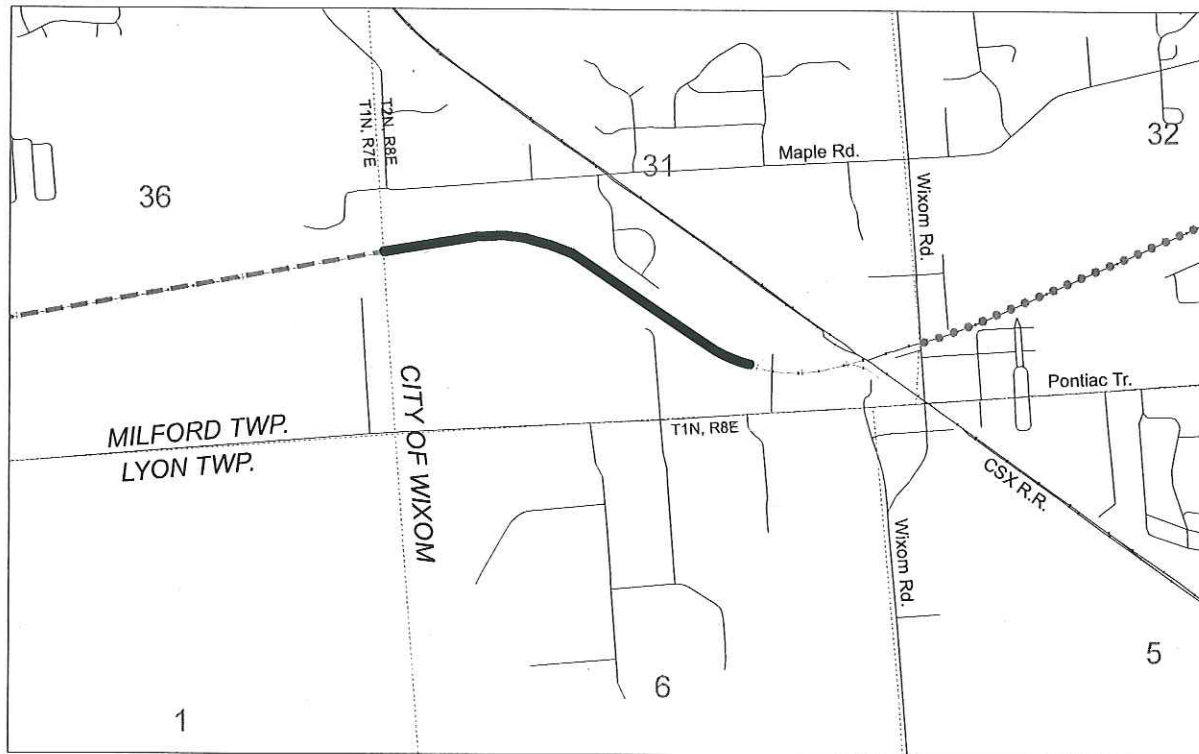

Section 31, T02N, R08E, City of Wixom

- DNR land to be sold (4.9 acres)
- - Huron Valley Trail
- ..... Michigan Air Line Trail

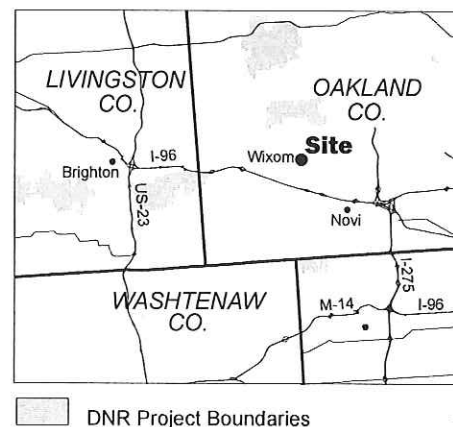
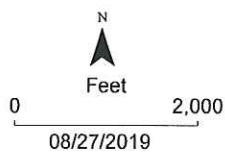



GRETCHEN WHITMER  
GOVERNOR

STATE OF MICHIGAN  
DEPARTMENT OF NATURAL RESOURCES  
LANSING



DANIEL EICHINGER  
DIRECTOR

September 16, 2019

TO: Daniel Eichinger, Director

INFORMATION: Natural Resources Commission

Transaction: Sale of Surplus DNR-Managed Land  
Leelanau State Park – Leelanau County  
Land Transaction Case #20190123

Sale: 17 acres

Sale Price: Sale price to be determined at auction.

Description: Leelanau County, Leelanau Township, T32N, R11W, Section 24:  
Part of the East 1/2 of the SE1/4

PA 240 of 2018: This parcel is north of the Mason-Arenac county line and will result in a decrease of 17 acres in DNR-managed lands.

Authority: Natural Resources and Environmental Protection Act, 1994 PA 451, as amended.

Notice: This item will appear on the Department of Natural Resources (Department) October 2, 2019 calendar and is eligible for approval on October 8, 2019.

Acquired: By tax reversion in 1961.

Minerals: Mineral rights will be reviewed when this transaction is prepared for auction.

Comments: This parcel has private ownership on three sides and Woolsey Lake Road on the fourth. The land is separated from other state-owned land by the road and is not easy to manage.

The proposed land disposal was recommended for approval as surplus by the Land Exchange Review Committee on June 20, 2019.

Proceeds will be deposited into the Land Exchange Facilitation Fund (LEFF). The LEFF allows the Department to sell rights in land and deposit the proceeds in a fund which can then be used to acquire replacement property.

Engagement: Local engagement will be completed as part of the auction process.



- Recommendation:
1. That the lands be disposed of as surplus.
  2. That the proceeds of the sale be deposited in the LEFF.
  3. That the State of Michigan follow the recommendation of the Office of Minerals Management regarding mineral rights.

The following on this page are signatures only.



Russ Mason, Ph.D., Chief  
Wildlife Division



Deb Begalle, Chief  
Forest Resources Division

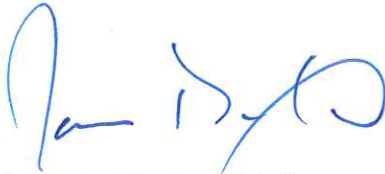

James L. Dexter, Chief  
Fisheries Division



Ronald A. Olson, Chief  
Parks and Recreation Division



Shannon Hanna  
Natural Resources Deputy



Mark H. Hoffman  
Chief Administrative Officer

I approve the staff recommendations.

Daniel Eichinger  
Director

\_\_\_\_\_  
Date Approved

# SALE OF SURPLUS DNR-MANAGED LAND

Leelanau State Park - Leelanau County

Land Transaction Case #20190123

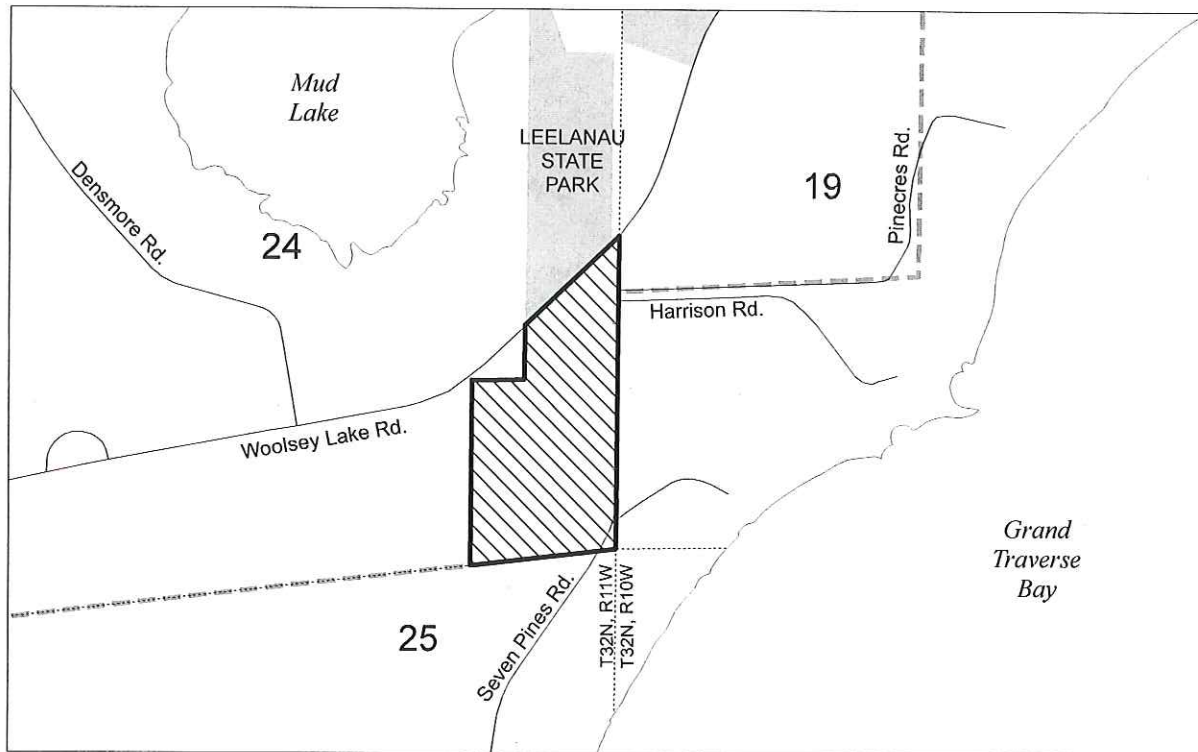

Section 24, T32N, R11W, Leelanau Township

Surplus DNR land to be sold (17 acres)

State land

Private land

DNR Project Boundary

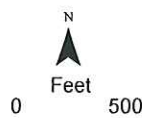

08/27/2019

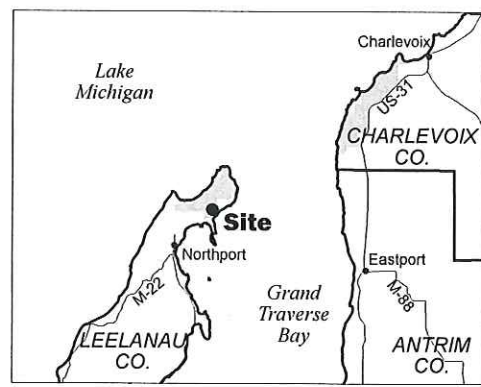

DNR Project Boundaries



GRETCHEN WHITMER  
GOVERNOR

STATE OF MICHIGAN  
DEPARTMENT OF NATURAL RESOURCES  
LANSING



DANIEL EICHINGER  
DIRECTOR

September 16, 2019

TO: Daniel Eichinger, Director

INFORMATION: Natural Resources Commission

Transaction: Sale of Surplus DNR-Managed Land  
Gaylord Management Unit – Cheboygan County  
Land Transaction Case #20190128

Sale: 27.61 acres

Sale Price: Sale price to be determined at auction.

Description: Cheboygan County, Hebron Township, T38N, R03W, Section 07:  
Part of the SW 1/4 of the NE 1/4, and part of the SE 1/4 of the NW 1/4  
lying West of I-75 right-of-way.

PA 240 of 2018: These parcels are north of the Mason-Arenac county line and will  
result in a decrease of 27.61 acres in DNR-managed lands.

Authority: Natural Resources and Environmental Protection Act, 1994 PA 451,  
as amended.

Notice: This item will appear on the Department of Natural Resources  
(Department) October 2, 2019 calendar and is eligible for approval on  
October 8, 2019.

Acquired: By tax reversion in 1919 and 1939.

Minerals: Mineral rights will be reviewed when this transaction is prepared for  
auction.

Comments: These parcels are separated from other state-owned land by I-75 on  
the east and it adjoins another state-owned parcel that has been  
identified as surplus on the north. There is private ownership to the  
south and Twin Lake on the west making it difficult to manage.

The proposed land disposal was recommended for approval as  
surplus by the Land Exchange Review Committee on June 20, 2019.

Proceeds will be deposited into the Land Exchange Facilitation Fund  
(LEFF). The LEFF allows the Department to sell rights in land and  
deposit the proceeds in a fund which can then be used to acquire  
replacement property.

Engagement: Local engagement will be completed as part of the auction process.



- Recommendation:
1. That the lands be disposed of as surplus.
  2. That the proceeds of the sale be deposited in the LEFF.
  3. That the State of Michigan follow the recommendation of the Office of Minerals Management regarding mineral rights.

The following on this page are signatures only.



Russ Mason, Ph.D., Chief  
Wildlife Division



Deb Begalle, Chief  
Forest Resources Division

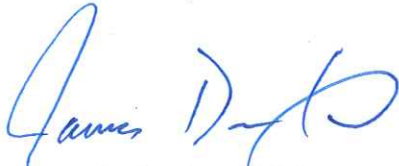

James L. Dexter, Chief  
Fisheries Division



Ronald A. Olson, Chief  
Parks and Recreation Division



Shannon Hanna  
Natural Resources Deputy



Mark H. Hoffman  
Chief Administrative Officer

I approve the staff recommendations.

Daniel Eichinger  
Director



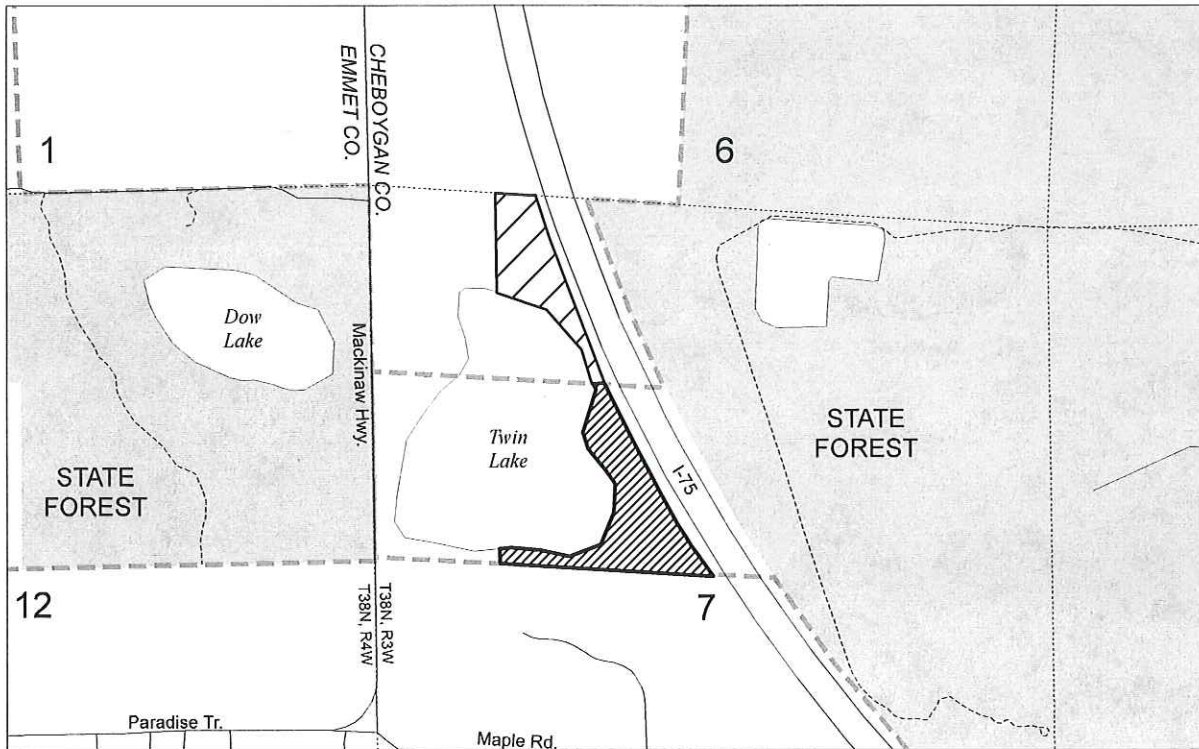

\_\_\_\_\_  
Date Approved

# SALE OF SURPLUS DNR-MANAGED LAND

Gaylord Management Unit - Cheboygan County  
Land Transaction Case #20190128



Section 7, T38N, R03W, Hebron Township

-  Surplus DNR land to be sold (27.61 acres)
-  DNR land previously approved for disposal
-  State land
-  Private land
-  DNR Project Boundary

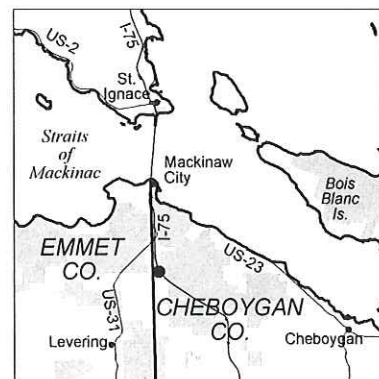
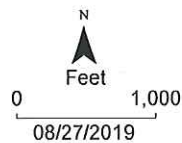

 DNR Project Boundaries



GRETCHEN WHITMER  
GOVERNOR

STATE OF MICHIGAN  
DEPARTMENT OF NATURAL RESOURCES  
LANSING



DANIEL EICHINGER  
DIRECTOR

September 16, 2019

TO: Daniel Eichinger, Director

INFORMATION: Natural Resources Commission

Transaction: Forest Resources Land Exchange  
Gladwin Management Unit – Midland County  
The Anderson Exchange  
Land Transaction Case #20160159

Applicant: Sheila Anderson, Sanford, Michigan

PA 240 of 2018: PILT Estimate: \$10.00  
The parcels involved in the exchange are south of the Mason-Arenac county line and will result in a decrease of 6.18 acres in DNR-managed lands.

---

**Private Land Offered in Exchange:**

Acreage: 0.75 acre

Location: Midland County, Edenville Township, T16N, R01W, Section 26:  
Part of the NW 1/4 of the NE 1/4, as more particularly described in the case file.

Value: \$30,000.00

---

**State Land Desired in Exchange:**

Acreage: 6.93 acres

Location: Midland County, Edenville Township, T16N, R01W, Section 26:  
Part of the NW 1/4 of the NE 1/4, as more particularly described in the case file.

Value: \$21,500.00

---

Authority: Natural Resources and Environmental Protection Act, 1994 PA 451, as amended.

Notice: This item will appear on the Department of Natural Resources (Department) October 2, 2019 calendar and is eligible for approval on October 8, 2019.

Comments: The desired state-owned land and the offered private land are located adjacent to each other. The desired state-owned land was acquired with the intention of providing public access to Sanford Lake, however, the property does not contain



September 16, 2019

water frontage and does not provide access. The private offered land contains frontage on Sanford Lake and will provide public access when assembled with the adjacent state ownership. The desired state-owned land will provide the applicant with contiguous ownership.

The state will retain mineral rights on the desired land due to its high oil and gas value. The applicant will convey the mineral rights on the offered property.

The desired state lands were purchased in 1958 with Dingell-Johnson Funds. The State received federal approval to complete this exchange on July 24, 2018.

The proposed land exchange was recommended for approval by the Land Exchange Review Committee on December 15, 2016.

- Recommendation(s):
1. That the exchange be approved, with the state reserving mineral rights and aboriginal antiquities.
  2. That the offered land be dedicated as part of the Gladwin Management Unit.

The following on this page are signatures only.



Russ Mason, Ph.D., Chief  
Wildlife Division



Deb Begalle, Chief  
Forest Resources Division



James L. Dexter, Chief  
Fisheries Division



Ronald A. Olson, Chief  
Parks and Recreation Division



Shannon Hanna  
Natural Resources Deputy



Mark H. Hoffman  
Chief Administrative Officer

I approve the staff recommendations.

Daniel Eichinger  
Director

---



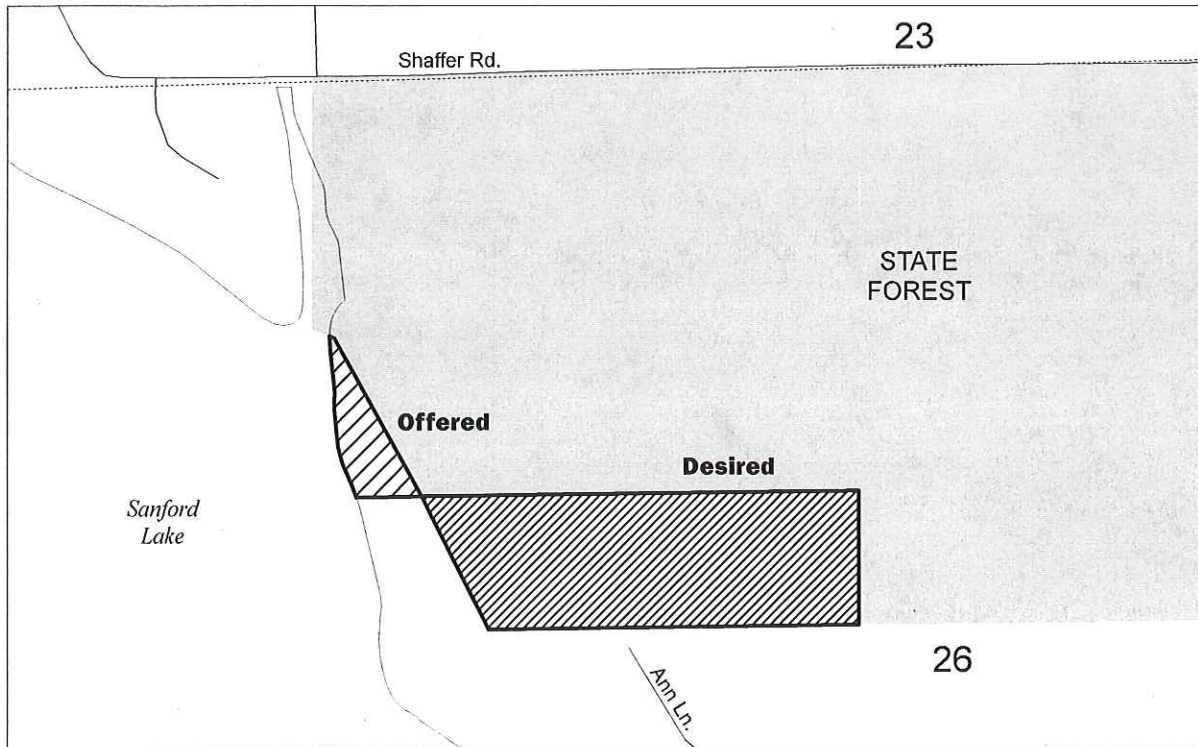

Date Approved

# FOREST RESOURCES LAND EXCHANGE

Gladwin Management Unit - Midland County  
Land Transaction Case #20160159



Section 26, T16N, R01W, Edenville Township

-  State land desired from DNR (6.93 acres)
-  Land offered to DNR in exchange (0.75 acre)
-  State land
-  Private land

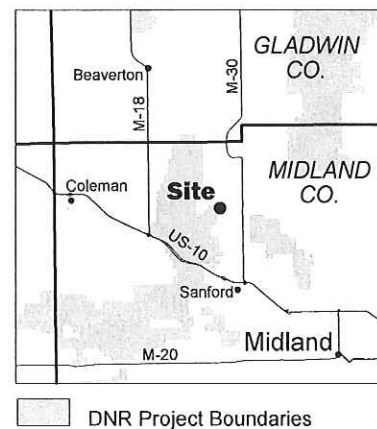





GRETCHEN WHITMER  
GOVERNOR

STATE OF MICHIGAN  
DEPARTMENT OF NATURAL RESOURCES  
LANSING



DANIEL EICHINGER  
DIRECTOR

September 16, 2019

TO: Daniel Eichinger, Director

INFORMATION: Natural Resources Commission

Transaction: State Trail Easement Acquisition  
Fruit Belt Trail – Van Buren County  
Land Transaction Case #20140139

Purchase: 51.35 acres (8.92 miles) - \$470,976.00

Funding Source: Michigan Natural Resources Trust Fund, Act 7 of 2015  
Paw Paw to Hartford Multi-Use Trail Partnership

PA 240 of 2018: PILT Estimate: None (trail easement)  
This trail easement is located south of the Mason-Arenac county line and will not result in an increase in counted acres.

Description: Van Buren County, Paw Paw Township/Village of Paw Paw  
T03S, R14W, Sections 13-18; and  
Van Buren County, Lawrence Township/Village of Lawrence  
T03S, R15W, Sections 8-10 and 13-15, as more accurately described in the case file.

Seller(s): West Michigan Railroad Company, Saugatuck, Michigan

Special Provisions: Preservation of the railroad corridor by provisions of federal law, Section 8(d) of the National Trails Act, 16 U.S.C. 1247(d).

Authority: Natural Resources and Environmental Protection Act, 1994 PA 451, as amended.

Notice: This item will appear on the Department of Natural Resources (Department) October 2, 2019 calendar and is eligible for approval on October 8, 2019.

Management Purpose: This land will be managed as the Fruit Belt Trail.

Comments: The offered property consists of two segments of inactive West Michigan Railroad Company railroad grade (totaling 8.92 miles) stretching between the Village of Paw Paw and the City of Hartford.

Acquisition of the recreational trail easement over the two parcels will contribute to achieving Department and division goals and strategies by providing additional public recreation opportunities.

- Recommendation:
1. That the acquisition be approved, with payment to be made from the Michigan Natural Resources Trust Fund, Paw Paw to Hartford Multi-Use Trail Partnership, as contained in Act 7 of 2015.
  2. That the land be dedicated as the Fruit Belt Trail and administered by the Parks and Recreation Division.

The following on this page are signatures only.



Russ Mason, Ph.D., Chief  
Wildlife Division



Deb Begalle, Chief  
Forest Resources Division

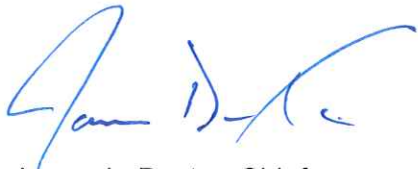

James L. Dexter, Chief  
Fisheries Division



Ronald A. Olson, Chief  
Parks and Recreation Division



Shannon Hanna  
Natural Resources Deputy



Mark H. Hoffman  
Chief Administrative Officer

I approve the staff recommendations.

Daniel Eichinger  
Director

\_\_\_\_\_  
Date Approved

# STATE TRAIL EASEMENT ACQUISITION

Fruit Belt Trail - Van Buren County  
Land Transaction Case #20140139

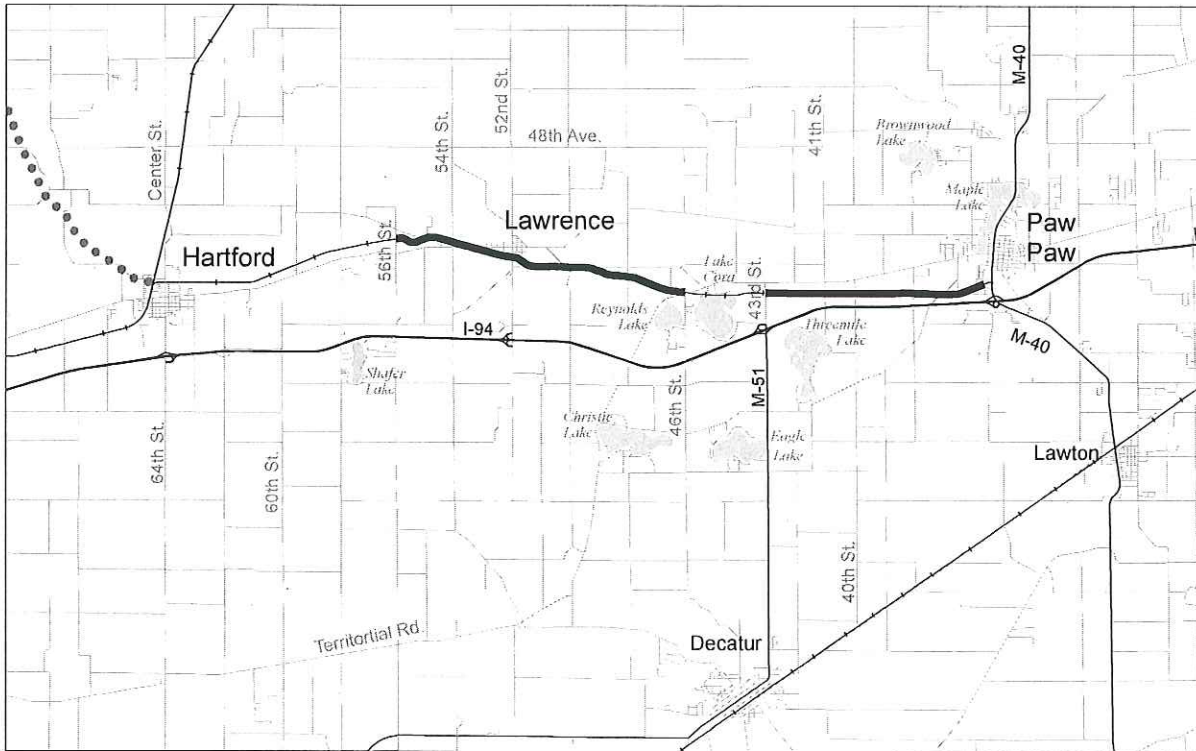

Sections 8-10, 13-15, T03S, R15W, Lawrence Township and Village of Lawrence  
Sections 13-18, T03S, R14W, Paw Paw Township and Village of Paw Paw

— Easement to be acquired by DNR (51.35 acres, 8.92 miles)

•••• Existing Van Buren State Park Trail

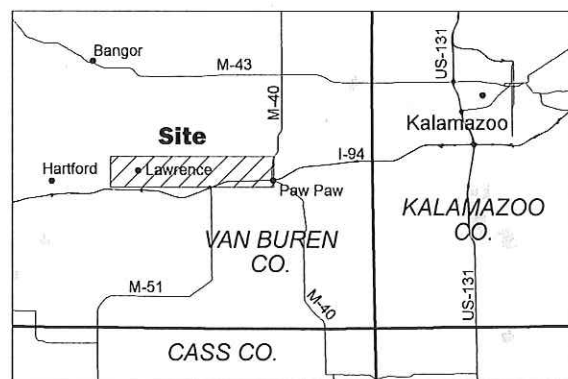

■ DNR Project Boundaries





GRETCHEN WHITMER  
GOVERNOR

STATE OF MICHIGAN  
DEPARTMENT OF NATURAL RESOURCES  
LANSING



DANIEL EICHINGER  
DIRECTOR

September 16, 2019

TO: Daniel Eichinger, Director

INFORMATION: Natural Resources Commission

Transaction: Wildlife Land Acquisition  
Pottersville State Game Area – Eaton County  
The Speaks Tract  
Land Transaction Case #20180175

Purchase: 444.09 acres - \$1,776,000.00

Funding Source: Michigan Natural Resources Trust Fund (TF17-0211 and TF18-0157)

PA 240 of 2018: PILT Estimate: \$13,499.15  
This parcel is located south of the Mason-Arenac county line and will result in an increase of 444.09 acres in DNR-managed lands.

Description: Eaton County, Benton Township, T03N, R04W  
Part of Sections 15, 21 and 22, as more accurately described in the case file.

Seller(s): Betty J. Speaks, Charlotte, Michigan

Authority: Natural Resources and Environmental Protection Act, 1994 PA 451, as amended.

Notice: This item will appear on the Department of Natural Resources (Department) October 2, 2019 calendar and is eligible for approval on October 8, 2019.

Management Purpose: This land will be managed as the Pottersville State Game Area.

Comments: The offered property is generally flat and mostly open agriculture fields with productive soils. Intermixed in the agriculture fields are wet areas with some forested/shrub areas. Presently, the southern 120 acres is in pasture grass. Agricultural row crops are planted in fields in the central part of the parcel.

The property also possesses outstanding pheasant and small game habitat hunting opportunities. The property is accessible from Vermontville and Gresham Highways.

Acquisition of this property will contribute to achieving Department and division goals and strategies by providing additional public recreation opportunities at the newly created Pottersville State Game Area.

The seller will convey mineral rights relative to this tract of land.

Engagement: As required by PA 240 of 2018, information regarding this transaction was posted on the department's website and published in a local newspaper. Both Benton Township and Eaton County were also notified of this transaction and support this acquisition.

Recommendation: 1. That the acquisition be approved, with payment to be made from the Michigan Natural Resources Trust Fund (TF17-0211 and TF18-0157).

2. That the land be dedicated as the Potterville State Game Area and administered by the Wildlife Division.

The following on this page are signatures only.



Russ Mason, Ph.D., Chief  
Wildlife Division



Deb Begalle, Chief  
Forest Resources Division



James L. Dexter, Chief  
Fisheries Division



Ronald A. Olson, Chief  
Parks and Recreation Division



Shannon Hanna  
Natural Resources Deputy



Mark H. Hoffman  
Chief Administrative Officer

I approve the staff recommendations.

Daniel Eichinger  
Director

\_\_\_\_\_  
Date Approved

# WILDLIFE LAND ACQUISITION

## Potterville State Game Area - Eaton County

### Land Transaction Case #20180175

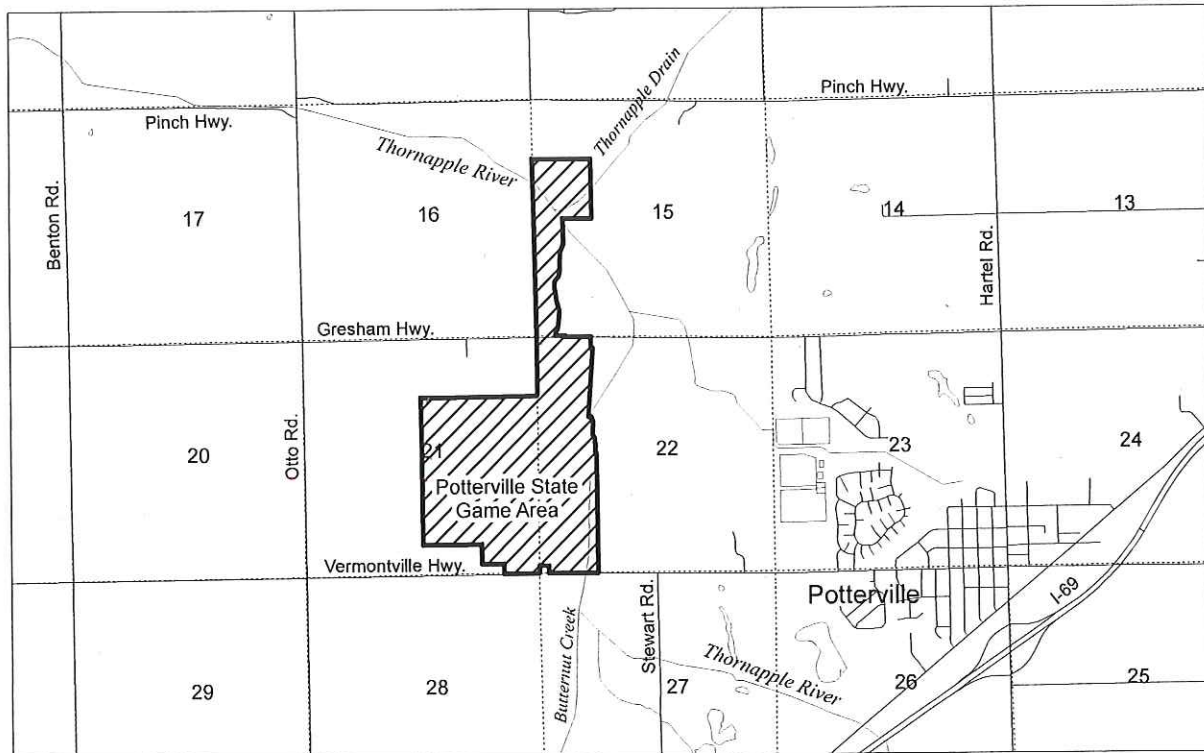

Sections 15, 21-22, T03N, R04W, Benton Township

Land to be acquired by DNR (444.09 acres)

State land

Private land

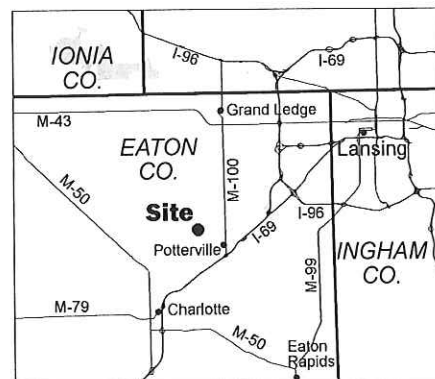
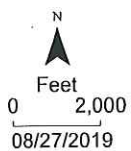

DNR Project Boundaries





GRETCHEN WHITMER  
GOVERNOR

STATE OF MICHIGAN  
DEPARTMENT OF NATURAL RESOURCES  
LANSING



DANIEL EICHINGER  
DIRECTOR

September 16, 2019

TO: Daniel Eichinger, Director

INFORMATION: Natural Resources Commission

Transaction: Wildlife Land Acquisition  
Cornish State Game Area – Van Buren County  
The Cornish Trust Purchase  
Land Transaction Case #20190004

Purchase: 101.51 acres - \$570,000.00

Funding Source: Michigan Natural Resources Trust Fund (TF18-0156) and  
Land Exchange Facilitation Fund (LEFF)

PA 240 of 2018: PILT Estimate: \$3,059.89  
This parcel is located south of the Mason-Arenac county line and will  
result in an increase of 101.51 acres in DNR-managed lands.

Description: Van Buren County, Porter Township, T04S, R13W  
Section 21: Part of the SW 1/4, and  
Section 28: Part of the NW 1/4 of the NW 1/4, as more accurately  
described in the case file.

Seller(s): Sharon S. Cornish Trust, Marcellus, Michigan

Authority: Natural Resources and Environmental Protection Act, 1994 PA 451, as  
amended.

Notice: This item will appear on the Department of Natural Resources  
(Department) October 2, 2019 calendar and is eligible for approval on  
October 8, 2019.

Management Purpose: This vacant property is located along Shaw Road on the west side of  
Grass Lake, and it is located within the dedicated boundary of the  
Cornish State Game Area. The property will be managed for wildlife  
habitat and provide added public outdoor recreation opportunities.

Comments: The property is characterized by rolling hills mostly vegetated with  
grass and several acres of oak forest. Along with portions of Grass  
Lake, it is mostly submergent marsh. The riparian borders are  
comprised of emergent marsh, southern wet meadow and shrub-carr.

There are currently two food plots on the property that can be  
perpetuated to benefit wildlife. White-tailed deer, wild turkey, rabbit,  
squirrel, mallard, wood ducks, Canada geese, and muskrats are game  
species present on the property. There is also a variety of wetland and

grassland birds that use the property, including sandhill crane, pied-billed grebe, eastern meadowlark, and eastern kingbird.

Acquiring these parcels will address the Department's Managed Public Land Strategy by increasing the Cornish State Game Area and Kinney Waterfowl Production Area complex to 588 acres.

Acquisition of this property also contributes toward meeting the Wildlife Division's land acquisition strategy and objective of acquiring 1,000 acres of waterfowl habitat with high quality natural resource values. This acquisition also provides increased public outdoor recreation opportunities in southern Michigan.

The seller will convey the mineral rights relative to this tract.

Engagement: As required by PA 240 of 2018, information regarding this transaction was posted on the department's website and published in a local newspaper. A resolution of support was received from Van Buren County, and Porter Township Board supports this acquisition.

Recommendation: 1. That the acquisition be approved, with payment to be made from the Michigan Natural Resources Trust Fund (TF18-0156) and the Land Exchange Facilitation Fund.

2. That the land be dedicated as part of the Cornish State Game Area.

The following on this page are signatures only.



Russ Mason, Ph.D., Chief  
Wildlife Division



Deb Begalle, Chief  
Forest Resources Division

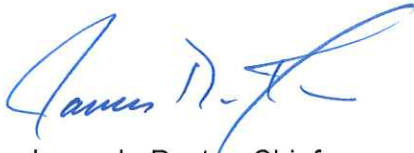

James L. Dexter, Chief  
Fisheries Division



Ronald A. Olson, Chief  
Parks and Recreation Division



Shannon Hanna  
Natural Resources Deputy



Mark H. Hoffman  
Chief Administrative Officer

I approve the staff recommendations.

Daniel Eichinger  
Director

\_\_\_\_\_  
Date Approved



# WILDLIFE LAND ACQUISITION

## Cornish State Game Area - Van Buren County

### Land Transaction Case #20190004

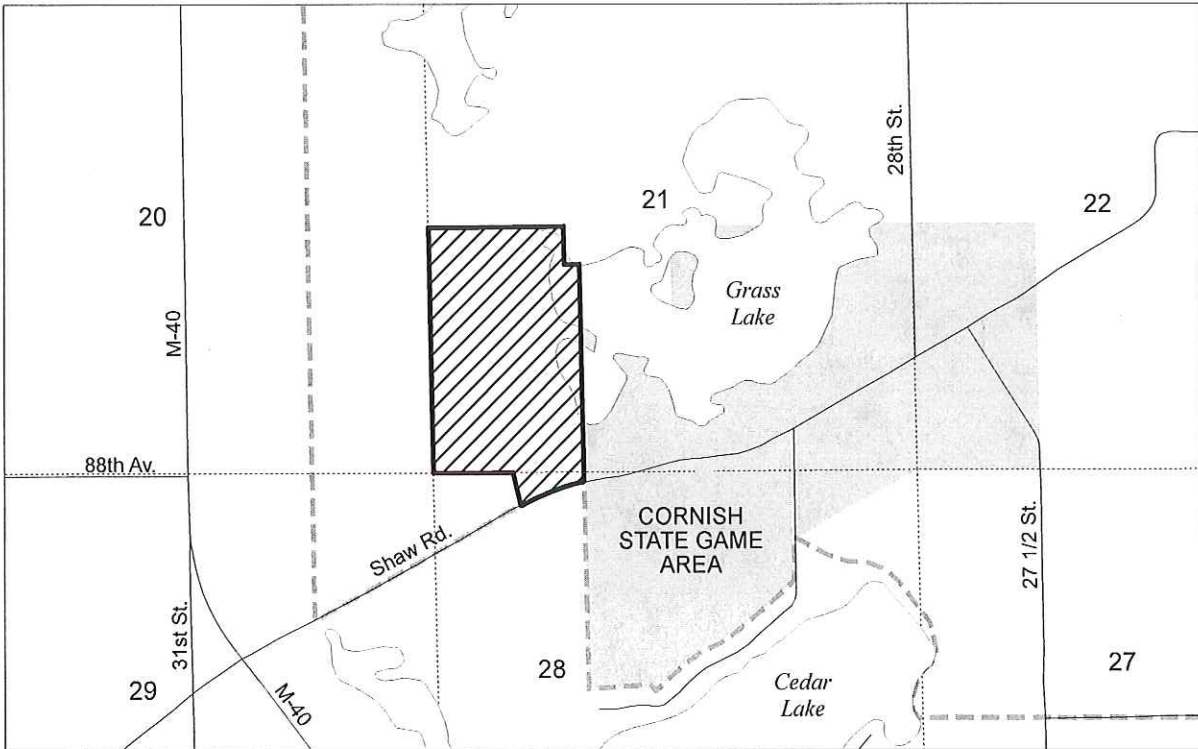

Sections 21 and 28, T04S, R13W, Porter Township

Land to be acquired by DNR (101.51 acres)

State land

Private land

DNR Project Boundary

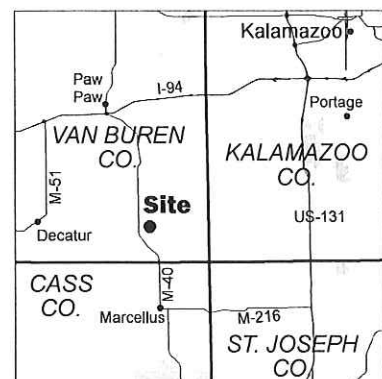

DNR Project Boundaries



GRETCHEN WHITMER  
GOVERNOR

STATE OF MICHIGAN  
DEPARTMENT OF NATURAL RESOURCES  
LANSING



DANIEL EICHINGER  
DIRECTOR

September 16, 2019

TO: Daniel Eichinger, Director

INFORMATION: Natural Resources Commission

Transaction: Wildlife Land Acquisition  
Lost Nation State Game Area – Hillsdale County  
The Hukill Purchase  
Land Transaction Case #20190005

Purchase: 31.77 acres - \$142,000.00

Funding Source: Michigan Natural Resources Trust Fund (TF17-0213)

PA 240 of 2018: PILT Estimate: \$666.05  
This parcel is located south of the Mason-Arenac county line and will result in an increase of 31.77 acres in DNR-managed lands.

Description: Hillsdale County, Jefferson Township, T07S, R02W, Section 23:  
The SE 1/4 of the NE 1/4, except that part lying east of centerline of the highway, as more accurately described in the case file.

Seller(s): Thomas L. and Christie Hukill, Pentwater, Michigan

Authority: Natural Resources and Environmental Protection Act, 1994 PA 451, as amended.

Notice: This item will appear on the Department of Natural Resources (Department) October 2, 2019 calendar and is eligible for approval on October 8, 2019.

Management Purpose: This vacant property offers approximately 1,000 feet of frontage on the East Branch of the St. Joseph River and lies entirely within the Lost Nation State Game area project boundary. Acquisition of the property adds to and consolidates land managed as part of the Lost National State Game Area.

Comments: The property provides excellent waterfowl, turkey and deer hunting opportunities, and it offers opportunities for trout fishing and small boat access along Reading Road. Acquisition of this property will create a link between two large compartments of the game area.

Purchase of this property contributes to the Department's Managed Public Land Strategy's goal of increasing the amount of land available for public recreation in southern Michigan by 25%. Hillsdale County is a southeast Michigan density "cold spot" county, with 0.07 acres per capita, making land acquisitions in this county a priority.

The seller will convey the mineral rights relative to this tract.

- Recommendation:
1. That the acquisition be approved, with payment to be made from the Michigan Natural Resources Trust Fund (TF17-0213).
  2. That the land be dedicated as part of the Lost Nation State Game Area.

The following on this page are signatures only.



Russ Mason, Ph.D., Chief  
Wildlife Division



Deb Begalle, Chief  
Forest Resources Division



James L. Dexter, Chief  
Fisheries Division

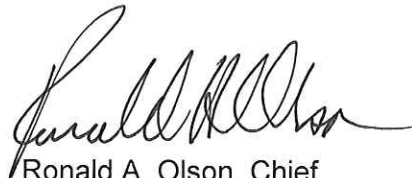

Ronald A. Olson, Chief  
Parks and Recreation Division



Shannon Hanna  
Natural Resources Deputy



Mark H. Hoffman  
Chief Administrative Officer

I approve the staff recommendations.

Daniel Eichinger  
Director

\_\_\_\_\_  
Date Approved



# WILDLIFE LAND ACQUISITION

## Lost Nation State Game Area - Hillsdale County

### Land Transaction Case #20190005

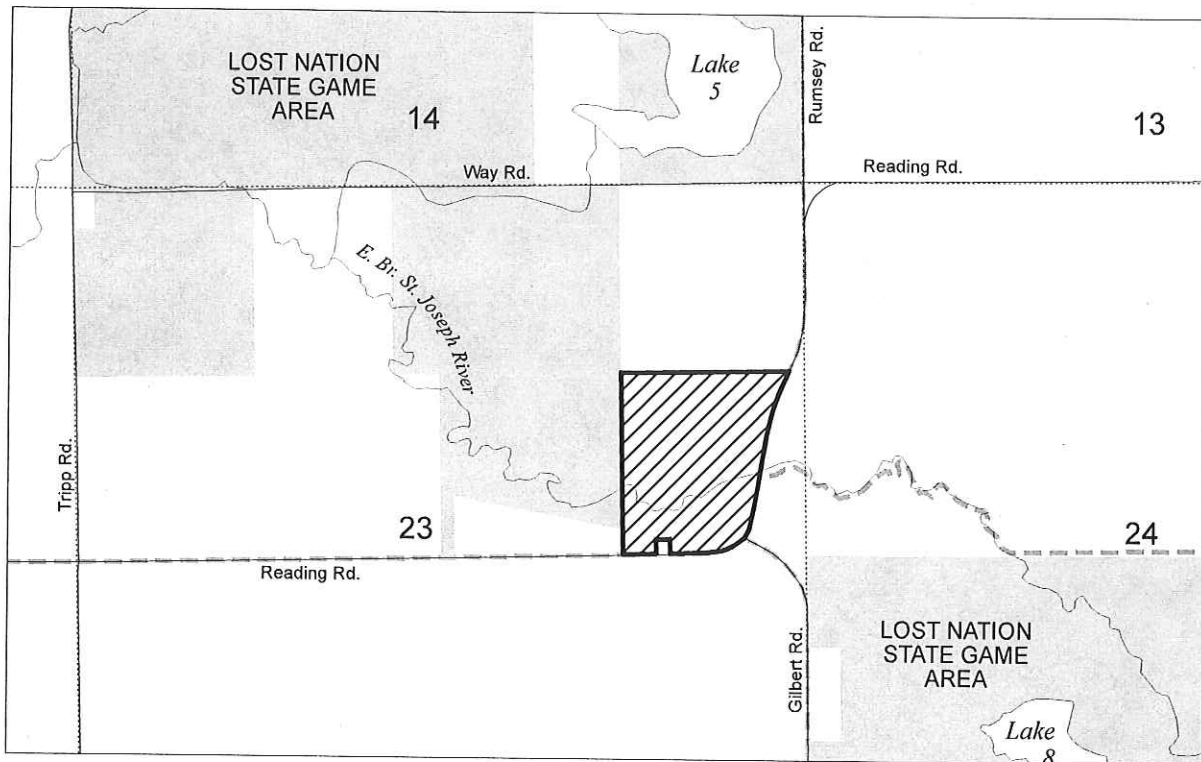

Section 23, T07S, R02W, Jefferson Township

Land to be acquired by DNR (31.77 acres)

State land

Private land

DNR Project Boundary

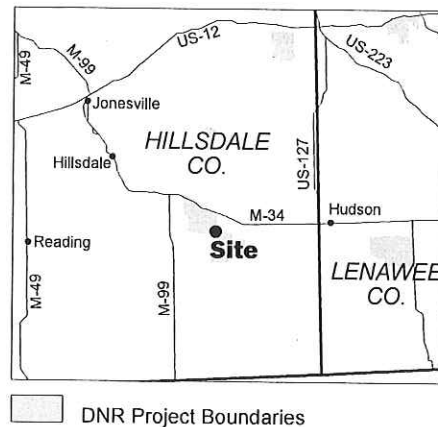
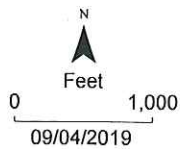

DNR Project Boundaries



GRETCHEN WHITMER  
GOVERNOR

STATE OF MICHIGAN  
DEPARTMENT OF NATURAL RESOURCES  
LANSING



DANIEL EICHINGER  
DIRECTOR

September 16, 2019

TO: Daniel Eichinger, Director

INFORMATION: Natural Resources Commission

Transaction: Purchase of Tax-Reverted Land  
Gaylord Management Unit and Traverse City Management Unit  
Cheboygan and Benzie Counties  
2019 County Auction  
Land Transaction Case Nos. 20190155 and 20190156

Purchase: 0.14-acre and 2 subdivision lots - \$1,950.00

Funding Source: Land Exchange Facilitation Fund (LEFF)

PA 240 of 2018: PILT Estimate: Cheboygan \$10; Benzie \$15  
This parcel is located north of the Mason-Arenac county line and will result in an increase of 0.14 acre of DNR-managed lands.

Description: Cheboygan County, Mackinaw Township, T39N, R03W, Section 34:  
Part of Section 34, as more accurately described in the case file.

Benzie County, Weldon Township, T25N, R14W, Section 05:  
Assessor's Plat of Cherry Grove  
Lot 10, Block 7  
Lot 38, Block 14

Seller(s): County of Cheboygan and County of Benzie

Authority: Act 123 of 1999; amended Act 206 of 1893, Section 211.131 of the General Property Tax Act; and Part 21, Act 451 of 1994, Natural Resources and Environmental Protection Act.

Notice: This item will appear on the Department of Natural Resources (Department) October 2, 2019 calendar and is eligible for approval on October 8, 2019.

Management Purpose: All three parcels are small lots and in-holdings within the state forest system. The state owns the majority of lots in both areas. Purchase of these lots will consolidate state ownership and simplify the management of adjacent state-owned lands.

Comments: The Department is proposing to acquire two parcels under the authority of Act 123 of 1999. Prior to 1999, the Department had the authority to retain tax-reverted parcels at no cost for natural resource and recreational purposes. Act 123 of 1999 now grants the Department a first

September 16, 2019

right of refusal to acquire tax-reverted properties by paying fair market value or minimum bid, whichever is greater. This first right of refusal applies to all lands that have been foreclosed upon either by the county or the state under Act 123. The Department also has the option of acquiring the properties at auction.

- Recommendation:
1. That the acquisition be approved, with payment to be made from the Land Exchange Facilitation Fund (LEFF).
  2. That the parcel being acquired in Cheboygan County be dedicated as part of the Gaylord Management Unit, and the parcels being acquired in Benzie County be dedicated as part of the Traverse City Management Unit.



September 16, 2019

The following on this page are signatures only.



Russ Mason, Ph.D., Chief  
Wildlife Division



Deb Begalle, Chief  
Forest Resources Division



James L. Dexter, Chief  
Fisheries Division



Ronald A. Olson, Chief  
Parks and Recreation Division



Shannon Hanna  
Natural Resources Deputy



Mark H. Hoffman  
Chief Administrative Officer

I approve the staff recommendations.

Daniel Eichinger  
Director

\_\_\_\_\_  
Date Approved

# PURCHASE OF TAX-REVERTED LAND UNDER Act 123, P.A. 1999

Traverse City Management Unit - Benzie County  
Land Transaction Case #20190155

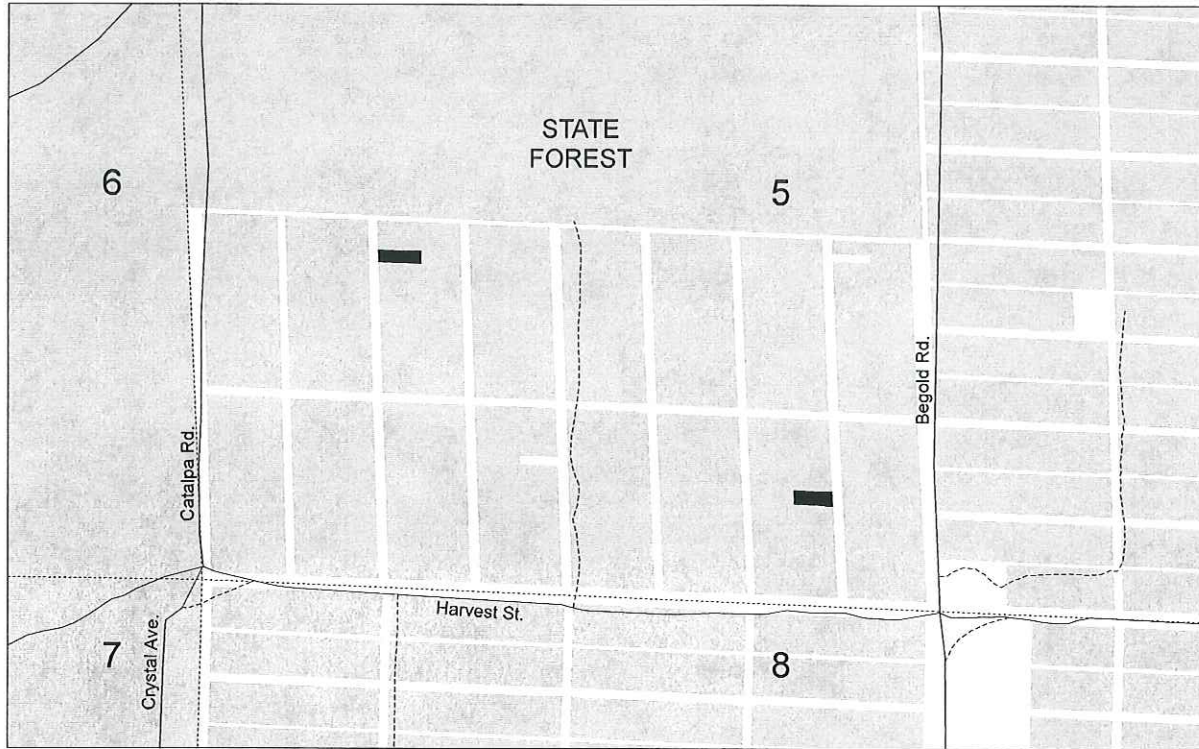

Section 5, T25N, R14W, Weldon Township  
Assessor's Plat of Cherry Grove

- County-owned land to be purchased (2 lots)
- State land
- Private land

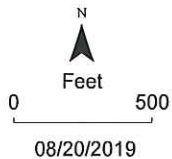

# PURCHASE OF TAX-REVERTED LAND UNDER Act 123, P.A. 1999

Gaylord Management Unit - Cheboygan County  
Land Transaction Case #20190156

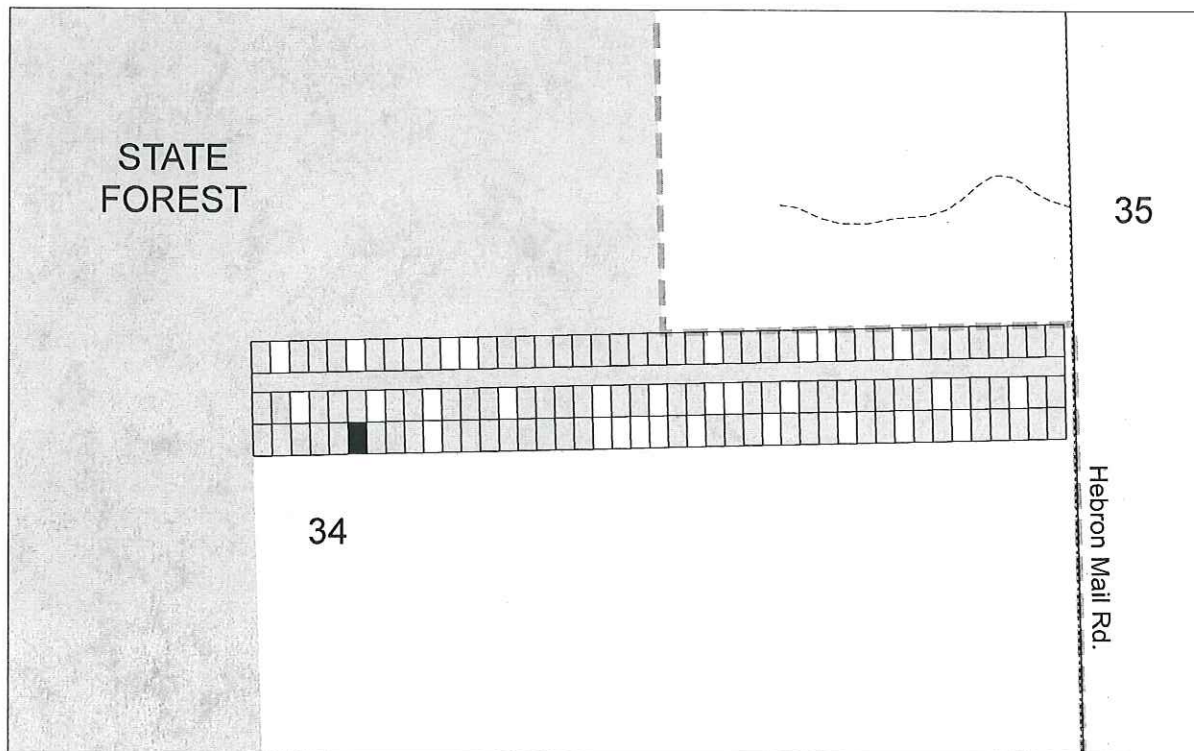

Section 34, T39N, R03W, Mackinaw Township

- County-owned land to be purchased (0.14 acre)
- State land
- Private land
- DNR Project Boundary

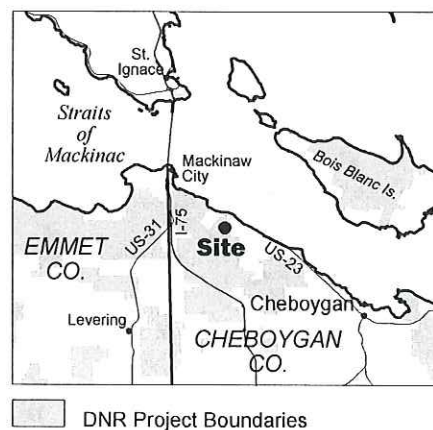
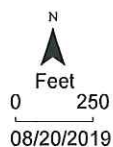





GRETCHEN WHITMER  
GOVERNOR

STATE OF MICHIGAN  
DEPARTMENT OF NATURAL RESOURCES  
LANSING



DANIEL EICHINGER  
DIRECTOR

September 16, 2019

TO: Daniel Eichinger, Director

INFORMATION: Natural Resources Commission

Transaction: Parks and Recreation Land Acquisition  
Fisherman's Island State Park – Charlevoix County  
The Holody Tract  
Land Transaction Case #20190064

Purchase: 2.36 acres - \$325,000.00

Funding Source: Michigan Natural Resources Trust Fund (TF17-0143)

PA 240 of 2018: PILT Estimate: \$4,306.68  
This parcel is located north of the Mason-Arenac county line and will result in an increase of 2.36 acres of DNR-managed lands.

Description: Charlevoix County, Norwood Township, T33N, R09W  
Section 27: The South 250 feet of Government Lot 2, except the East 250 feet thereof.

Seller(s): Paul and Helen Holody, Northville, Michigan

Authority: Natural Resources and Environmental Protection Act, 1994 PA 451, as amended.

Notice: This item will appear on the Department of Natural Resources (Department) October 2, 2019 calendar and is eligible for approval on October 8, 2019.

Management Purpose: This land will be managed as part of Fisherman's Island State Park.

Comments: The offered property is a vacant residential lot with 250 feet of Lake Michigan shoreline on the west boundary, and road access via Lakeshore Drive along the east boundary. The property is bounded on the north and east by state-owned land at Fisherman's Island State Park. The upland portions of the property are covered in trees, ending in a sand beach along the Lake Michigan shoreline. About one-half of the property is submerged land.

Acquisition of this property will contribute to achieving Department and division goals and strategies by providing additional public recreation opportunities.

The seller will convey mineral rights relative to this tract of land.

- Recommendation:
1. That the acquisition be approved, with payment to be made from the Michigan Natural Resources Trust Fund (TF17-0143).
  2. That the land be dedicated as part of Fisherman's Island State Park and administered by the Parks and Recreation Division.

The following on this page are signatures only.



Russ Mason, Ph.D., Chief  
Wildlife Division



Deb Begalle, Chief  
Forest Resources Division



James L. Dexter, Chief  
Fisheries Division



For Ronald A. Olson, Chief  
Parks and Recreation Division



Shannon Hanna  
Natural Resources Deputy



Mark H. Hoffman  
Chief Administrative Officer

I approve the staff recommendations.

Daniel Eichinger  
Director

\_\_\_\_\_  
Date Approved

# PARKS AND RECREATION LAND ACQUISITION

Fisherman's Island State Park - Charlevoix County

Land Transaction Case #20190064

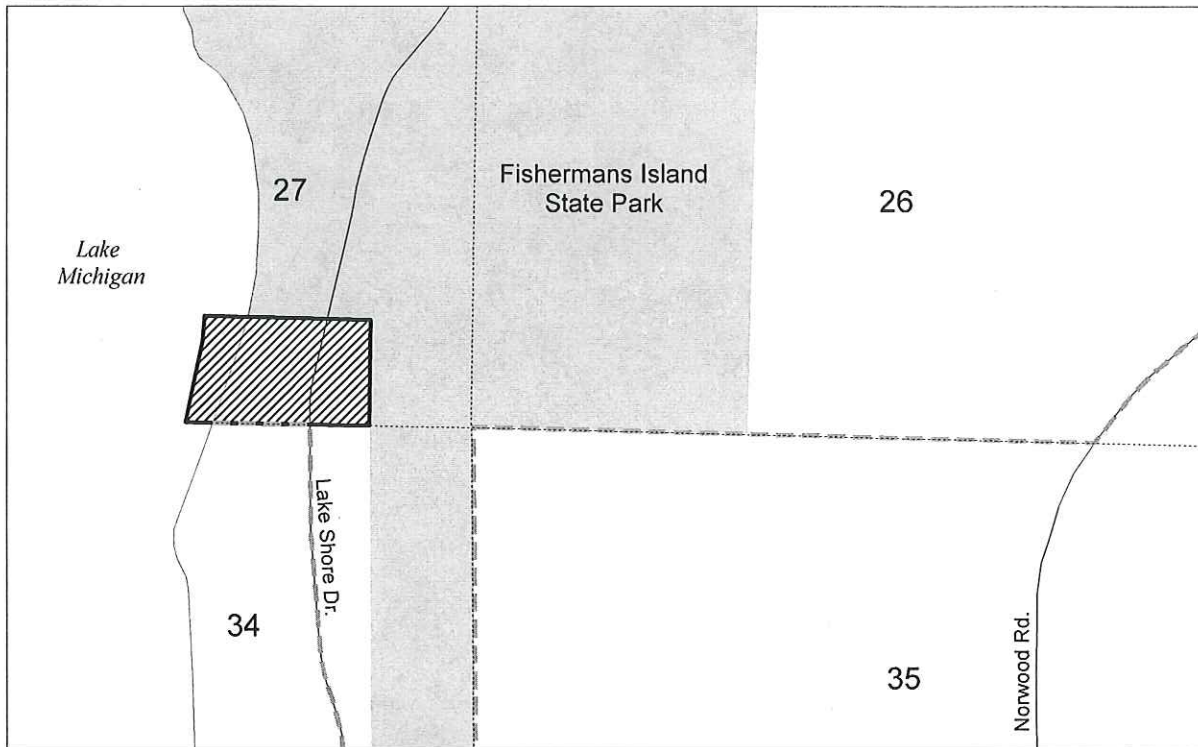

Section 27, T33N, R09W, Norwood Township

 Land to be acquired by DNR (2.36 acres)

 State land

 Private land

 DNR Project Boundary

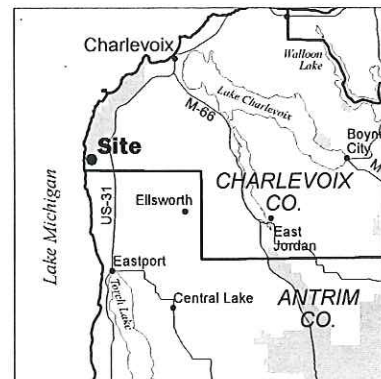

 DNR Project Boundaries