



STATE OF MICHIGAN
DEPARTMENT OF NATURAL RESOURCES
LANSING



GRETCHEN WHITMER
GOVERNOR

DANIEL EICHINGER
DIRECTOR

SUBMITTED: May 13, 2019
RESUBMITTED: June 17, 2019

MEMORANDUM TO THE DIRECTOR

Information: Natural Resources Commission
Subject: Order to Regulate Target Shooting on State Forest Lands in
Grand Traverse County
Land Use Order of the Director Amendment No. 03 of 2019

Authority:

The Natural Resources and Environmental Protection Act, 1994 PA 451, as amended, authorizes the Director to issue orders to implement land use rules.

Discussion and Background:

The area commonly known as Hoosier Valley Shooting Area is located in T26N, R11W, Sections 9, 14 and 15 of Grand Traverse County. Historically, the public used the area extensively for informal recreational shooting. By 2013, the neighboring private property was subdivided, and numerous single-family homes were built. The public's use of Hoosier Valley also continued to increase, and the type and size of firearms used had changed. Semi-automatic rifles up to 50-caliber were being used at Hoosier Valley, and the Department received complaints that rifles with night-vision scopes were being shot at all hours of the night. The public began utilizing high capacity magazines and firearms equipped with bump stocks to fire a large number of rounds in rapid succession. The increased use also resulted in littering issues due to the items shooters were using for targets. It was not uncommon to find old refrigerators, washing machines and other large items discarded at the site. Additionally, debris from exploding (Tannerite) targets littered the area.

Following multiple property damage, noise, and public safety complaints to the Department, staff held a public meeting on June 6, 2013, that was attended by over 100 people. The purpose of this meeting was to gather public input to formulate a solution to the target shooting conflict that would benefit both the shooting community and the Hoosier Valley neighbors. After weighing the comments gathered from this meeting, the Department decided to implement a 3-part plan:

- (1) placing immediate restrictions to regulate target shooting at Hoosier Valley;
- (2) constructing an alternative formal shooting range located on State-owned land in a more suitable location; and
- (3) closing the Hoosier Valley Area to target shooting.

Order to Regulate Target Shooting on State Forest Lands in Grand Traverse County

Land Use Order of the Director Amendment No. 03 of 2019

Page 2

June 17, 2019

The initial order to regulate shooting at Hoosier Valley was implemented in 2013 by Land Use Order of the Director (LUOD) 4.21, which placed restrictions on the hours of use for the site, the type of targets that could be utilized, and the caliber and capacity of the firearms that could be used on site.

Following the implementation of LUOD 4.21, the Department committed to selecting an alternative area that could be improved or developed as a target shooting location within the county. Department staff identified four nearby alternative locations to construct an improved, designated shooting range, and held a public meeting at the Traverse City Civic Center on June 24, 2014, to collect public comments regarding the proposed options. In 2015, the Department selected a site at the intersection of Supply Road and Fife Lake Road after considering public input and implementing sound studies and environmental assessments. The new site, approximately 14 miles east of the Hoosier Valley Area, provided ample separation from residential development and is located within a 30-minute drive from Traverse City.

The Department acquired complete funding in FY 2018 and completed construction of the new Supply Road Range in August 2018. The site opened to public use on September 1, 2018. The newly constructed Supply Road Range offers 12 target stations at 10, 25, 50, and 100-yards (three at each distance), as well as target retrievals, accessible parking, and vault toilets. Following the opening of the Supply Road Range, the Department issued a press release to inform the public of the newly constructed range and Department's plan to close Hoosier Valley to target shooting. This release was covered by major local media outlets. Department staff fielded several phone calls from the public seeking clarification. Some reflected concern over closing the informal ranges and others were supportive of the pending closure. There was no significant concern expressed associated with the proposal.

This order would complete the plan that was devised to alleviate the target shooting concerns that exist at the informal Hoosier Valley shooting area formally designating the Supply Road Range as a Department shooting range and closing the Hoosier Valley area to all target shooting. Further, this order would establish rules and regulations for the use of the Supply Road Range. These steps will resolve trash, unsafe shooting practices and conflict with neighboring landowners at Hoosier Valley.

The new Supply Road Range offers the public a safe, environmentally compatible location for shooting that is managed cooperatively by Forest Resources and Parks and Recreation Divisions. Shooting range hours for the Supply Road Range may need to fluctuate depending on seasonal weather conditions. Consequently, we recommend not specifying in the order but ensuring hours are posted on the site. This will avoid the need for a LUOD revision if/when hours change.

However, the hours should generally be as follows:

10 AM to 7 PM	April 15 (or snow departure) through September 30
10 AM to 5 PM	October 1 through November 30 (or snowfall)

Order to Regulate Target Shooting on State Forest Lands in Grand Traverse County

Land Use Order of the Director Amendment No. 03 of 2019

Page 3

June 17, 2019

Order to Regulate Target Shooting on State Forest Lands in Grand Traverse County

This order is being submitted for information and consideration. This order was submitted for information on May 9, 2019, at the Natural Resources Commission Meeting. This item appeared on the Department's May 2019 calendar and may be eligible for approval on July 11, 2019.



Debbie A. Begalle, Chief
Forest Resources Division



Gary Hagler, Chief
Law Enforcement Division



Ronald A. Olson, Chief
Parks and Recreation Division



Russ Mason, Ph.D., Chief
Wildlife Division

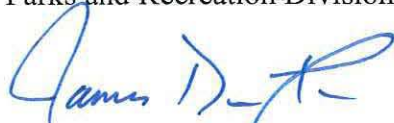

James Dexter, Chief
Fisheries Division



Shannon Hanna,
Natural Resources Deputy

LAND USE ORDERS OF THE DIRECTOR

Amendment No. 03 of 2016

By authority conferred on the Director of the Department of Natural Resources by Section 504 of the Natural Resources Environmental Protection Act, 1994 PA 451, as amended, MCL 324.504, and in accordance with R 299.921 to R 299.933, the Director of the Department of Natural Resources orders the following:

4.21 Certain state-owned lands, Grand Traverse county, camping, snowmobiles, dogs on groomed pathways, target shooting, prohibited conduct.

Order 4.21 (1) A person shall not camp upon, use or occupy spider lake state forest campground, section 10, T26N R10W, Grand Traverse county, between the hours of 11 p.m. and 4 a.m.

(2) A person shall not camp, except with written permit from the forest management division, on any state-owned lands lying south and east of the Boardman river in the W½ of the NE¼ and E½ of the NW¼ of section 8, T26N R9W, Grand Traverse county.

(3) A person shall not camp or use a snowmobile on any state-owned lands lying north of the Boardman river within the SW¼ of the NW¼ of section 13, T26N R11W, Grand Traverse county.

(4) A person shall not possess or allow a dog upon the state forest designated and groomed Muncie lakes and VASA cross country ski pathways, Grand Traverse county, from December 1 to April 15 unless the dog is a hunting dog or guide dog being used by a licensed hunter or handicapped person for that purpose.

(5) On state-owned land commonly known as Hoosier Valley Shooting Area in sections 9, 14, and 15 of T26N, R11W, Grand Traverse county, a person shall not target, trap, or skeet shoot

(6) On state-owned lands lying east of M37, north of Mill Road, south of River Road and west of Garfield Road in sections 13, and 21-28 of T26N, R11W, and sections 17-21, 29, and 30, T26N, R10W, Grand Traverse a person shall not target, trap, or skeet shoot.

(7) For the purposes of this order, the Supply Road Range shall mean the area upon state-owned lands north of Supply Road in the NWNW of Section 13, T26N, R9W, Union Township, Grand Traverse County. A person shall not do any of the following at the Supply Road Range:

- (a) Enter, use or occupy the range outside of designated range hours posted on site or when gates are closed.
- (b) Target shoot before completing the sign in sheet.
- (c) Target shoot without ear and eye protection.
- (d) Target shoot at any object other than a paper target with a bullseye or depiction of legal game only affixed to target holders provided.
- (e) Target shoot outside of existing shooting lanes.
- (f) Use human form silhouettes or metal targets.
- (g) Use a firearm other than a handgun on the 10-yard range.
- (h) Use aerial, incendiary, explosive, armor piercing or tracer ammunition, including tannerite.

- (i) Use a firearm other than pistol, revolver, shotgun, rifle, handheld firearm or muzzle loader.
 - (j) Use a firearm greater than .80 caliber.
 - (k) Utilize the shooting area while under the influence of alcohol or controlled substances.
- (8) This order does not apply to Department employees, designees of Department employees, law enforcement or other emergency personnel performing official duties.

This amended order shall be posted on or after the 12th day of July, 2019.

Issued on this 11th day of July, 2019.

Daniel Eichinger
Director

HOOSIER VALLEY SHOOTING AREA REGULATION

Land Use Order of the Director, Amendment No. 3 of 2019

Traverse City Forest Management Unit – Grand Traverse County

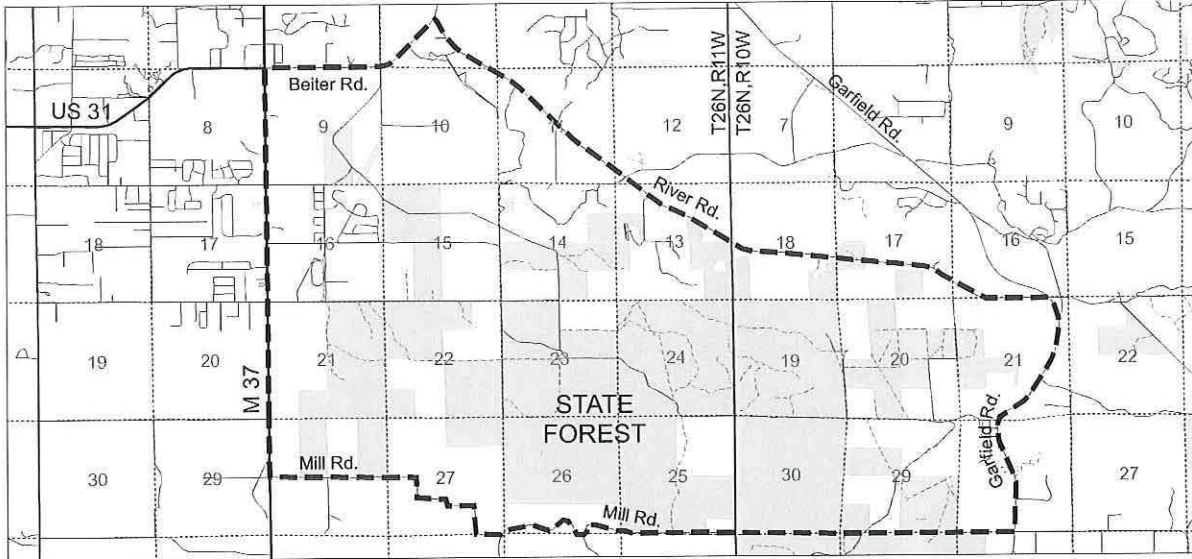

HOOSIER VALLEY AREA

- Area to be closed to target shooting on state land
- State land

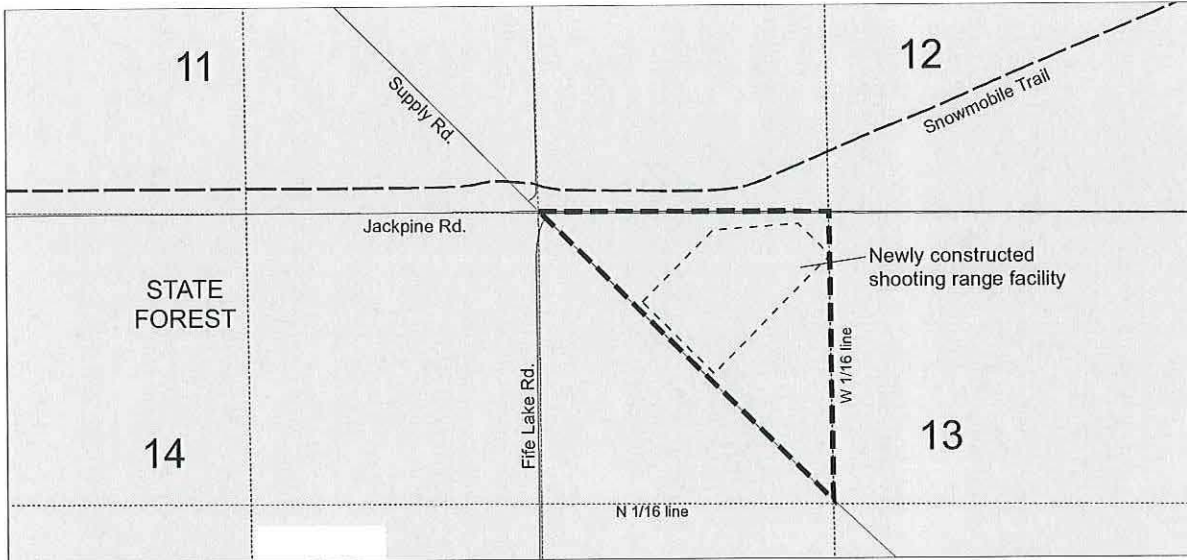
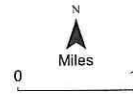

SUPPLY ROAD SHOOTING RANGE

- New shooting range boundary
- State land

