

Michigan Department of
Environment, Great Lakes, and Energy
Oil, Gas and Minerals Division

PERMIT LIST

5/3/2021 THRU 5/7/2021



Permit Number	Issue Date	Permittee Number	Permittee Name
61528	5/7/2021	104	WEST BAY EXPLORATION COMPANY
			13685 S WEST BAYSHORE DR TRAVERSE CITY, MI 49684
API Well No: 21-073-62006-00-00			Surface Owner: Lynn A. Witbeck Trust
Prev Permit:			True Vertical Depth: 4125FT
Well Name: WITBECK 1-5			Target Formation: DUNDEE
Well Type: Oil Well			Deepest Formation: DUNDEE
Permit Type: Drill			
H2S Present? Yes			

Page 1

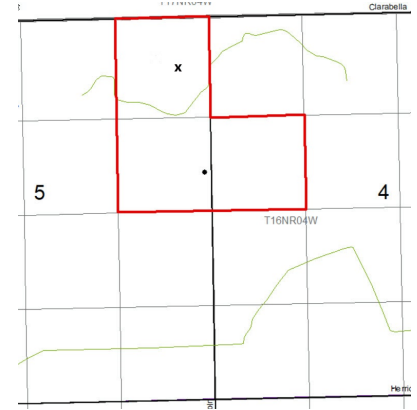

120-Acre R303 Drilling Unit, E/2 NE/4 Sec 5, SW/4 NW/4 Sec 6

Location:	QT QT QT	Sec	Township	Range	Township Name	County	Feet From Section Line	Feet From DRLG Unit Line
SL:	SENE		5 16N	4W	VERNON	ISABELLA	819 N 410 E	
BHL:	SESENE		5 16N	4W	VERNON	ISABELLA	2309 N 0 E	409 S 1303 E

Michigan Department of
Environment, Great Lakes, and Energy
Oil, Gas and Minerals Division

Updated Permits

5/3/2021 THRU 5/7/2021



Permit Number Permittee Number Permittee Name

PLUGGING INSTRUCTIONS ISSUED:

10384 8139 MUSKEGON OPERATING COMPANY
LLC
1425 S MISSION RD

MOUNT PLEASANT, MI 48858

API Well Number: 21-017-10384-00-00

Well Name: MEYER, LOUISE 2

Plug Inst. Issue Date: 4/29/2021

Location	QT QT QT	Sec	Township	Range	Township Name	County	Feet From Section Line	Feet From DRLG Unit
SL:	N2SWNW	12	14N	4E	MONITOR	BAY	990 S 688 W	990 S 688 W
BHL:	N2SWNW	12	14N	4E	MONITOR	BAY		

Comment: App to P&A expires on 4/29/22

13637 5951 PAN GAS STORAGE LLC DBA
SOUTHWEST GAS

1300 MAIN STREET
HOUSTON, TX 77002

API Well Number: 21-093-13637-00-00

Well Name: PARSONS, GUSSIE COMM 1

Plug Inst. Issue Date: 5/3/2021

Location	QT QT QT	Sec	Township	Range	Township Name	County	Feet From Section Line	Feet From DRLG Unit
SL:	NESWNE	2	2N	4E	MARION	LIVINGSTON	1934 N 1145 W	1934 N 1145 W
BHL:	NESWNE	2	2N	4E	MARION	LIVINGSTON		

Comment: App to P&A expires on 5/3/22

Michigan Department of
Environment, Great Lakes, and Energy
Oil, Gas and Minerals Division

Updated Permits

5/3/2021 THRU 5/7/2021



Permit Number Permittee Number Permittee Name

Page 2

14073 6371 BREITBURN OPERATING LIMITED
PARTNERSHIP
1111 BAGBY STREET, SUITE 1600

HOUSTON, TX 77002

API Well Number: 21-079-14073-00-00

Well Name: GARDEN, GEORGE "A" 3

Plug Inst. Issue Date: 5/6/2021

Location	QT QT QT	Sec	Township	Range	Township Name	County	Feet From Section Line	Feet From DRLG Unit
SL:	W2NWSE	12	25N	5W	GARFIELD	KALKASKA	660 N 330 W	660 N 2310 E
BHL:	W2NWSE	12	25N	5W	GARFIELD	KALKASKA		

Comment: App to P&A expires on 12/15/23

14389 6371 BREITBURN OPERATING LIMITED
PARTNERSHIP
1111 BAGBY STREET, SUITE 1600

HOUSTON, TX 77002

API Well Number: 21-079-14389-00-00

Well Name: GARDEN, GEORGE "A" 4

Plug Inst. Issue Date: 5/6/2021

Location	QT QT QT	Sec	Township	Range	Township Name	County	Feet From Section Line	Feet From DRLG Unit
SL:	W2SESW	12	25N	5W	GARFIELD	KALKASKA	660 S 990 E	660 S 990 E
BHL:	W2SESW	12	25N	5W	GARFIELD	KALKASKA		

Comment: App to P&A expires on 12/15/23

Michigan Department of
Environment, Great Lakes, and Energy
Oil, Gas and Minerals Division

Updated Permits

5/3/2021 THRU 5/7/2021



Permit Number Permittee Number Permittee Name

Page 3

14555 6371 BREITBURN OPERATING LIMITED
PARTNERSHIP
1111 BAGBY STREET, SUITE 1600
HOUSTON, TX 77002

API Well Number: 21-079-14555-00-00

Well Name: GARDEN, GEORGE "B" 2

Plug Inst. Issue Date: 5/6/2021

Location	QT QT QT	Sec	Township	Range	Township Name	County	Feet From Section Line	Feet From DRLG Unit
SL:	W2SENE	12	25N	5W	GARFIELD	KALKASKA	660 S 990 E	660 S 990 E
BHL:	W2SENE	12	25N	5W	GARFIELD	KALKASKA		

Comment: App to P&A expires on 12/15/23

15073 5951 PAN GAS STORAGE LLC DBA
SOUTHWEST GAS
1300 MAIN STREET
HOUSTON, TX 77002

API Well Number: 21-093-15073-01-00

Well Name: RICHARDS, P E COMM 1

Plug Inst. Issue Date: 5/3/2021

Location	QT QT QT	Sec	Township	Range	Township Name	County	Feet From Section Line	Feet From DRLG Unit
SL:	NWSESE	6	2N	5E	GENOA	LIVINGSTON	1174 S 1321 E	
BHL:	NWSESE	6	2N	5E	GENOA	LIVINGSTON		

Comment: App to P&A expires on 5/3/22

Michigan Department of
Environment, Great Lakes, and Energy
Oil, Gas and Minerals Division

Updated Permits

5/3/2021 THRU 5/7/2021



Permit Number Permittee Number Permittee Name

Page 4

15123 6371 BREITBURN OPERATING LIMITED
PARTNERSHIP
1111 BAGBY STREET, SUITE 1600

HOUSTON, TX 77002

API Well Number: 21-039-15123-00-00

Well Name: STATE BEAVER CREEK B-1

Plug Inst. Issue Date: 5/6/2021

Location	QT QT QT	Sec	Township	Range	Township Name	County	Feet From Section Line	Feet From DRLG Unit
SL:	W2SWNW	28	25N	4W	BEAVER CREEK	CRAWFORD	835 S 330 W	
BHL:	W2SWNW	28	25N	4W	BEAVER CREEK	CRAWFORD		

Comment: App to P&A expires on 12/15/21

16727 6371 BREITBURN OPERATING LIMITED
PARTNERSHIP
1111 BAGBY STREET, SUITE 1600

HOUSTON, TX 77002

API Well Number: 21-039-16727-00-00

Well Name: STATE BEAVER CREEK C 1

Plug Inst. Issue Date: 5/6/2021

Location	QT QT QT	Sec	Township	Range	Township Name	County	Feet From Section Line	Feet From DRLG Unit
SL:	W2NENW	29	25N	4W	BEAVER CREEK	CRAWFORD	660 N 990 E	660 N 330 W
BHL:	W2NENW	29	25N	4W	BEAVER CREEK	CRAWFORD		

Comment: App to P&A expires on 12/15/24

Michigan Department of
Environment, Great Lakes, and Energy
Oil, Gas and Minerals Division

Updated Permits

5/3/2021 THRU 5/7/2021



Permit Number Permittee Number Permittee Name

Page 5

16901 40 MUSKEGON DEVELOPMENT COMPANY
1425 S MISSION RD
MOUNT PLEASANT, MI 48858

API Well Number: 21-129-16901-00-00

Well Name: STATE FOSTER "D" 5

Plug Inst. Issue Date: 5/5/2021

Location	QT QT QT	Sec	Township	Range	Township Name	County	Feet From Section Line	Feet From DRLG Unit
SL:	NWNESE	20	24N	2E	FOSTER	OGEMAW	330 N 990 E	330 N 330 W
BHL:	NWNESE	20	24N	2E	FOSTER	OGEMAW		

Comment: App to P&A expires on 5/5/22

17195 40 MUSKEGON DEVELOPMENT COMPANY
1425 S MISSION RD
MOUNT PLEASANT, MI 48858

API Well Number: 21-051-17195-00-00

Well Name: MCCRANDALL, B & G 1-A

Plug Inst. Issue Date: 4/30/2021

Location	QT QT QT	Sec	Township	Range	Township Name	County	Feet From Section Line	Feet From DRLG Unit
SL:	SWSESW	2	17N	1E	BILLINGS	GLADWIN	360 S 990 E	360 S 330 W
BHL:	SWSESW	2	17N	1E	BILLINGS	GLADWIN		

Comment: App to P&A expires on 4/30/22

Michigan Department of
Environment, Great Lakes, and Energy
Oil, Gas and Minerals Division

Updated Permits

5/3/2021 THRU 5/7/2021



Permit Number Permittee Number Permittee Name

Page 6

61215 5280 JORDAN DEVELOPMENT COMPANY
LLC

1503 GARFIELD RD NORTH
TRAVERSE CITY, MI 49696

API Well Number: 21-051-61215-00-00

Well Name: GROVE 1-15

Plug Inst. Issue Date: 5/6/2021

Location	QT QT QT	Sec	Township	Range	Township Name	County	Feet From Section Line	Feet From DRLG Unit
SL:	SENENE	15	19N	2W	SAGE	GLADWIN	960 N 365 E	351 S 948 W
BHL:	SENENE	15	19N	2W	SAGE	GLADWIN		

Comment: App to P&A expires on 5/6/22



Michigan Department of
Environment, Great Lakes, and Energy
Oil, Gas and Minerals Division

Updated Permits

5/3/2021 THRU 5/7/2021



Permit Number Permittee Number Permittee Name

APPLICATIONS TO CHANGE WELL STATUS:

35926 6310 CORE ENERGY LLC
1011 NOTEWARE DRIVE
TRAVERSE CITY, MI 49686

API Well Number: 21-079-35926-00-00

Well Name: STATE BLUE LAKE 1-5

Approval Date: 5/3/2021

Location	QT QT QT	Sec	Township	Range	Township Name	County	Feet From Section Line	Feet From DRLG Unit
SL:	SESENW	5	28N	5W	BLUE LAKE	KALKASKA	545 S 350 E	545 S 350 E
BHL:	SESENW	5	28N	5W	BLUE LAKE	KALKASKA		

Proposed Rework: Temporarily Abandoned

Comment: ACOWS for TA expires on 3/31/22

42449 6361 RIVERSIDE ENERGY MICHIGAN LLC
10691 EAST CARTER ROAD
SUITE 201
TRAVERSE CITY, MI 49684

API Well Number: 21-137-42449-00-00

Well Name: MACKINNON ET AL 21-34

Approval Date: 5/4/2021

Location	QT QT QT	Sec	Township	Range	Township Name	County	Feet From Section Line	Feet From DRLG Unit
SL:	SEENW	34	29N	3W	OTSEGO LAKE	OTSEGO	646 N 664 E	645 S 664 E
BHL:	SEENW	34	29N	3W	OTSEGO LAKE	OTSEGO		

Proposed Rework: Temporarily Abandoned

Comment: ACOWS for TA expires on 4/30/22

Michigan Department of
Environment, Great Lakes, and Energy
Oil, Gas and Minerals Division

Updated Permits

5/3/2021 THRU 5/7/2021



Permit Number Permittee Number Permittee Name

Page 8

47350 6361 RIVERSIDE ENERGY MICHIGAN LLC
10691 EAST CARTER ROAD
SUITE 201
TRAVERSE CITY, MI 49684

API Well Number: 21-137-47350-00-00

Well Name: STATE HAYES (THOMAS LAKE I)
D4-34

Approval Date: 5/4/2021

Location	QT QT QT	Sec	Township	Range	Township Name	County	Feet From Section Line	Feet From DRLG Unit
SL:	SESESE	34	30N	4W	HAYES	OTSEGO	335 S 496 E	335 S 496 E
BHL:	SESESE	34	30N	4W	HAYES	OTSEGO		

Proposed Rework: Temporarily Abandoned

Comment: ACOWS for TA expires on 4/30/22

50139 6361 RIVERSIDE ENERGY MICHIGAN LLC
10691 EAST CARTER ROAD
SUITE 201
TRAVERSE CITY, MI 49684

API Well Number: 21-119-50139-00-00

Well Name: STATE HILLMAN 4-20

Approval Date: 5/4/2021

Location	QT QT QT	Sec	Township	Range	Township Name	County	Feet From Section Line	Feet From DRLG Unit
SL:	NENWNW	20	31N	4E	HILLMAN	MONTMORENCY	499 N 1220 W	
BHL:	NENWNW	20	31N	4E	HILLMAN	MONTMORENCY		

Proposed Rework: Temporarily Abandoned

Comment: ACOWS for TA expires on 5/4/22

Michigan Department of
Environment, Great Lakes, and Energy
Oil, Gas and Minerals Division

Updated Permits

5/3/2021 THRU 5/7/2021



Permit Number Permittee Number Permittee Name

Page 9

52964 6361 RIVERSIDE ENERGY MICHIGAN LLC
10691 EAST CARTER ROAD
SUITE 201
TRAVERSE CITY, MI 49684

API Well Number: 21-079-52964-00-00

Well Name: STRANG A2-6

Approval Date: 5/3/2021

Location	QT QT QT	Sec	Township	Range	Township Name	County	Feet From Section Line	Feet From DRLG Unit
SL:	SEENW	6	28N	7W	RAPID RIVER	KALKASKA	803 N 634 E	
BHL:	SEENW	6	28N	7W	RAPID RIVER	KALKASKA		

Proposed Rework: Temporarily Abandoned

Comment: ACOWS for TA expires on 3/31/22

52988 6361 RIVERSIDE ENERGY MICHIGAN LLC
10691 EAST CARTER ROAD
SUITE 201
TRAVERSE CITY, MI 49684

API Well Number: 21-137-52988-00-00

Well Name: LEIK A2-16

Approval Date: 5/4/2021

Location	QT QT QT	Sec	Township	Range	Township Name	County	Feet From Section Line	Feet From DRLG Unit
SL:	SEENW	16	32N	3W	CORWITH	OTSEGO	918 N 570 E	918 N 570 E
BHL:	SEENW	16	32N	3W	CORWITH	OTSEGO		

Proposed Rework: Temporarily Abandoned

Comment: ACOWS for TA expires on 5/4/22

Michigan Department of
Environment, Great Lakes, and Energy
Oil, Gas and Minerals Division

Updated Permits

5/3/2021 THRU 5/7/2021



Permit Number Permittee Number Permittee Name

Page 10

55344 6361 RIVERSIDE ENERGY MICHIGAN LLC
10691 EAST CARTER ROAD
SUITE 201
TRAVERSE CITY, MI 49684

API Well Number: 21-137-55344-00-00

Well Name: STATE CORWITH & PEDERSON
C1-3

Approval Date: 5/4/2021

Location	QT QT QT	Sec	Township	Range	Township Name	County	Feet From Section Line	Feet From DRLG Unit
SL:	SWNWSW	3	32N	3W	CORWITH	OTSEGO	1747 S 540 W	423 S 814 E
BHL:	SWNWSW	3	32N	3W	CORWITH	OTSEGO		

Proposed Rework: Temporarily Abandoned

Comment: ACOWS for TA expires on 5/4/22

55476 6310 CORE ENERGY LLC
1011 NOTEWARE DRIVE
TRAVERSE CITY, MI 49686

API Well Number: 21-079-36115-01-00

Well Name: STATE BLUE LAKE 1-4

Approval Date: 5/3/2021

Location	QT QT QT	Sec	Township	Range	Township Name	County	Feet From Section Line	Feet From DRLG Unit
SL:	NESENW	4	28N	5W	BLUE LAKE	KALKASKA	1942 N 2043 W	594 N 752 W
BHL:	NESENW	4	28N	5W	BLUE LAKE	KALKASKA		

Proposed Rework: Temporarily Abandoned

Comment: ACOWS for TA expires on 3/31/22

Michigan Department of
Environment, Great Lakes, and Energy
Oil, Gas and Minerals Division

Updated Permits

5/3/2021 THRU 5/7/2021



Permit Number Permittee Number Permittee Name

Page 11

58715 6361 RIVERSIDE ENERGY MICHIGAN LLC
10691 EAST CARTER ROAD
SUITE 201
TRAVERSE CITY, MI 49684

API Well Number: 21-119-58715-00-00

Well Name: ELLISON D3-22

Approval Date: 5/4/2021

Location	QT QT QT	Sec	Township	Range	Township Name	County	Feet From Section Line	Feet From DRLG Unit
SL:	SWSWE	22	30N	4E	RUST	MONTMORENCY	360 S 2283 E	360 S 375 W
BHL:	SWSWE	22	30N	4E	RUST	MONTMORENCY		

Proposed Rework: Temporarily Abandoned

Comment: ACOWS for TA expires on 5/4/22

60863 5320 SAVOY ENERGY LP
920 HASTINGS STREET, SUITE A
PO BOX 1560
TRAVERSE CITY, MI 49685-1560

API Well Number: 21-075-60831-01-00

Well Name: BOYCE 1-24A HD1

True Vertical Depth: 4227

Approval Date: 3/25/2021

Location	QT QT QT	Sec	Township	Range	Township Name	County	Feet From Section Line	Feet From DRLG Unit
SL:	NWNWSW	24	4S	1E	COLUMBIA	JACKSON	2671 S 331 W	
BHL:	SESWNW	24	4S	1E	COLUMBIA	JACKSON	2499 N 978 W	496 N 350 E

Proposed Rework: Temporarily Abandoned

Comment: ACOWS for TA expires on 3/31/22

Michigan Department of
Environment, Great Lakes, and Energy
Oil, Gas and Minerals Division

Updated Permits

5/3/2021 THRU 5/7/2021



Permit Number Permittee Number Permittee Name

60903 6310 CORE ENERGY LLC

1011 NOTEWARE DRIVE
TRAVERSE CITY, MI 49686

API Well Number: 21-039-60903-00-00

Well Name: STATE MAPLE FOREST 2-6 True Vertical Depth: 6880

Approval Date: 5/3/2021

Location	QT QT QT	Sec	Township	Range	Township Name	County	Feet From Section Line	Feet From DRLG Unit
SL:	NENWSE	6	28N	3W	MAPLE FOREST	CRAWFORD	2346 S 1478 E	
BHL:	SESENE	6	28N	3W	MAPLE FOREST	CRAWFORD	2398 N 608 E	1093 N 608 E

Proposed Rework: Temporarily Abandoned

Comment: ACOWS for TA expires on 3/31/22



Michigan Department of
Environment, Great Lakes, and Energy
Oil, Gas and Minerals Division

Updated Permits

5/3/2021 THRU 5/7/2021



Permit Number Permittee Number Permittee Name

RECORD OF CHANGE OF WELL STATUS:

37794 6310 CORE ENERGY LLC

1011 NOTEWARE DRIVE
TRAVERSE CITY, MI 49686

API Well Number: 21-137-37794-00-00

Well Name: JANIK & MACKOWIAC 1-11 True Vertical Depth: 6084

Change Date: 3/2/2021

Location	QT QT QT	Sec	Township	Range	Township Name	County	Feet From Section Line	Feet From DRLG Unit
SL:	NESESE	11	30N	3W	BAGLEY	OTSEGO	1155 S 562 E	
BHL:	NESWSE	11	30N	3W	BAGLEY	OTSEGO	710 S 703 W	610 N 617 E

Proposed Rework: Reworked to Perforate & Test Current Formation

Comment: Reworked to perf, stimulate, test, and return well to service.



Michigan Department of
Environment, Great Lakes, and Energy
Oil, Gas and Minerals Division

Updated Permits

5/3/2021 THRU 5/7/2021



Permit Number Permittee Number Permittee Name

TRANSFER OF OWNERSHIP:

24664 5986 TUSCOLA ENERGY INC
920 N WATER STREET, SUITE 213

BAY CITY, MI 48708

API Well Number: 21-087-24664-00-00

Well Name: NOWLIN, HOMER 2

Transfer Date: 5/3/2021

Previous Owner: BREITBURN OPERATING
LIMITED PARTNERSHIP

Location	QT QT QT	Sec	Township	Range	Township Name	County	Feet From Section Line	Feet From DRLG Unit
SL:	SWNESE	28	10N	10E	RICH	LAPEER	990 N 1040 E	990 N 1040 E
BHL:	SWNESE	28	10N	10E	RICH	LAPEER		

24829 5986 TUSCOLA ENERGY INC
920 N WATER STREET, SUITE 213

BAY CITY, MI 48708

API Well Number: 21-087-24829-00-00

Well Name: MOORE, GLEN H UNIT 1

Transfer Date: 5/3/2021

Previous Owner: BREITBURN OPERATING
LIMITED PARTNERSHIP

Location	QT QT QT	Sec	Township	Range	Township Name	County	Feet From Section Line	Feet From DRLG Unit
SL:	SWNWSW	27	10N	10E	RICH	LAPEER	990 N 480 W	330 S 480 W
BHL:	SWNWSW	27	10N	10E	RICH	LAPEER		

Michigan Department of
Environment, Great Lakes, and Energy
Oil, Gas and Minerals Division

Updated Permits

5/3/2021 THRU 5/7/2021



Permit Number Permittee Number Permittee Name

Page 15

24910 5986 TUSCOLA ENERGY INC
920 N WATER STREET, SUITE 213

BAY CITY, MI 48708

API Well Number: 21-087-24910-00-00

Well Name: VOLLWEILER, WM UNIT 1

Transfer Date: 5/3/2021

Previous Owner: BREITBURN OPERATING
LIMITED PARTNERSHIP

Location	QT QT QT	Sec	Township	Range	Township Name	County	Feet From Section Line	Feet From DRLG Unit
SL:	SWSENE	28	10N	10E	RICH	LAPEER	330 S 990 E	330 S 990 E
BHL:	SWSENE	28	10N	10E	RICH	LAPEER		

25026 5986 TUSCOLA ENERGY INC
920 N WATER STREET, SUITE 213

BAY CITY, MI 48708

API Well Number: 21-087-25026-00-00

Well Name: STRICH, GERALD N 1

Transfer Date: 5/3/2021

Previous Owner: BREITBURN OPERATING
LIMITED PARTNERSHIP

Location	QT QT QT	Sec	Township	Range	Township Name	County	Feet From Section Line	Feet From DRLG Unit
SL:	SWSWNW	27	10N	10E	RICH	LAPEER	330 S 330 W	330 S 330 W
BHL:	SWSWNW	27	10N	10E	RICH	LAPEER		

Michigan Department of
Environment, Great Lakes, and Energy
Oil, Gas and Minerals Division

Updated Permits

5/3/2021 THRU 5/7/2021



Permit Number Permittee Number Permittee Name

25162 5986 TUSCOLA ENERGY INC
920 N WATER STREET, SUITE 213

BAY CITY, MI 48708

API Well Number: 21-087-25162-00-00

Well Name: HEBBERD, MAE 1

Transfer Date: 5/3/2021

Previous Owner: BREITBURN OPERATING
LIMITED PARTNERSHIP

Location	QT QT QT	Sec	Township	Range	Township Name	County	Feet From Section Line	Feet From DRLG Unit
SL:	SWNESW	27	10N	10E	RICH	LAPEER	990 N 990 E	990 N 330 W
BHL:	SWNESW	27	10N	10E	RICH	LAPEER		

26371 5986 TUSCOLA ENERGY INC
920 N WATER STREET, SUITE 213

BAY CITY, MI 48708

API Well Number: 21-087-26371-00-00

Well Name: MOORE, GLEN H 2

Transfer Date: 5/3/2021

Previous Owner: BREITBURN OPERATING
LIMITED PARTNERSHIP

Location	QT QT QT	Sec	Township	Range	Township Name	County	Feet From Section Line	Feet From DRLG Unit
SL:	SWSWSW	27	10N	10E	RICH	LAPEER	380 S 330 W	380 S 330 W
BHL:	SWSWSW	27	10N	10E	RICH	LAPEER		

Michigan Department of
Environment, Great Lakes, and Energy
Oil, Gas and Minerals Division

Updated Permits

5/3/2021 THRU 5/7/2021



Permit Number Permittee Number Permittee Name

Page 17

26559 5986 TUSCOLA ENERGY INC
920 N WATER STREET, SUITE 213

BAY CITY, MI 48708

API Well Number: 21-087-26559-01-00

Well Name: CURELL, MAX & REMY 1

Transfer Date: 5/3/2021

Previous Owner: BREITBURN OPERATING
LIMITED PARTNERSHIP

Location	QT QT QT	Sec	Township	Range	Township Name	County	Feet From Section Line	Feet From DRLG Unit
SL:	SWNE	28	10N	10E	RICH	LAPEER	865 N 990 E	
BHL:	SWNE	28	10N	10E	RICH	LAPEER		

26867 5986 TUSCOLA ENERGY INC
920 N WATER STREET, SUITE 213

BAY CITY, MI 48708

API Well Number: 21-087-26867-00-00

Well Name: RANDALL, ALFRED E 1

Transfer Date: 5/3/2021

Previous Owner: BREITBURN OPERATING
LIMITED PARTNERSHIP

Location	QT QT QT	Sec	Township	Range	Township Name	County	Feet From Section Line	Feet From DRLG Unit
SL:	SWNWNW	27	10N	10E	RICH	LAPEER	755 N 380 W	545 S 380 W
BHL:	SWNWNW	27	10N	10E	RICH	LAPEER		

Michigan Department of
Environment, Great Lakes, and Energy
Oil, Gas and Minerals Division

Updated Permits

5/3/2021 THRU 5/7/2021



Permit Number Permittee Number Permittee Name

Page 18

26867 5986 TUSCOLA ENERGY INC
920 N WATER STREET, SUITE 213

BAY CITY, MI 48708

API Well Number: 21-087-26867-01-00

Well Name: RANDALL, ALFRED E 1

Transfer Date: 5/3/2021

Previous Owner: BREITBURN OPERATING
LIMITED PARTNERSHIP

Location	QT QT QT	Sec	Township	Range	Township Name	County	Feet From Section Line	Feet From DRLG Unit
SL:	SWNWNW	27	10N	10E	RICH	LAPEER	755 N 380 W	545 S 380 W
BHL:	SWNWNW	27	10N	10E	RICH	LAPEER		

26868 5986 TUSCOLA ENERGY INC
920 N WATER STREET, SUITE 213

BAY CITY, MI 48708

API Well Number: 21-087-26868-00-00

Well Name: KNOX, FRED & FEDERAL LAND
BANK, ST PAUL 1

Transfer Date: 5/3/2021

Previous Owner: BREITBURN OPERATING
LIMITED PARTNERSHIP

Location	QT QT QT	Sec	Township	Range	Township Name	County	Feet From Section Line	Feet From DRLG Unit
SL:	SWNENW	34	10N	10E	RICH	LAPEER	990 N 990 E	330 S 330 W
BHL:	SWNENW	34	10N	10E	RICH	LAPEER		

Michigan Department of
Environment, Great Lakes, and Energy
Oil, Gas and Minerals Division

Updated Permits

5/3/2021 THRU 5/7/2021



Permit Number Permittee Number Permittee Name

Page 19

27659 5986 TUSCOLA ENERGY INC
920 N WATER STREET, SUITE 213

BAY CITY, MI 48708

API Well Number: 21-087-27659-00-00

Well Name: DWYER, DANIEL W 1

Transfer Date: 5/3/2021

Previous Owner: BREITBURN OPERATING
LIMITED PARTNERSHIP

Location	QT QT QT	Sec	Township	Range	Township Name	County	Feet From Section Line	Feet From DRLG Unit
SL:	SWSESE	27	10N	10E	RICH	LAPEER	330 S 1001 E	330 S 330 W
BHL:	SWSESE	27	10N	10E	RICH	LAPEER		

27659 5986 TUSCOLA ENERGY INC
920 N WATER STREET, SUITE 213

BAY CITY, MI 48708

API Well Number: 21-087-27659-01-00

Well Name: DWYER, DANIEL W. 1

Transfer Date: 5/3/2021

Previous Owner: BREITBURN OPERATING
LIMITED PARTNERSHIP

Location	QT QT QT	Sec	Township	Range	Township Name	County	Feet From Section Line	Feet From DRLG Unit
SL:	SWSESE	27	10N	10E	RICH	LAPEER	330 S 1001 E	
BHL:	SWSESE	27	10N	10E	RICH	LAPEER		

Michigan Department of
Environment, Great Lakes, and Energy
Oil, Gas and Minerals Division

Updated Permits

5/3/2021 THRU 5/7/2021



Permit Number Permittee Number Permittee Name

Page 20

27660 5986 TUSCOLA ENERGY INC
920 N WATER STREET, SUITE 213

BAY CITY, MI 48708

API Well Number: 21-087-27660-00-00

Well Name: ADAMIC, JOHN 1

Transfer Date: 5/3/2021

Previous Owner: BREITBURN OPERATING
LIMITED PARTNERSHIP

Location	QT QT QT	Sec	Township	Range	Township Name	County	Feet From Section Line	Feet From DRLG Unit
SL:	W2SWNW	34	10N	10E	RICH	LAPEER	660 S 330 W	676 N 330 W
BHL:	W2SWNW	34	10N	10E	RICH	LAPEER		

28298 5986 TUSCOLA ENERGY INC
920 N WATER STREET, SUITE 213

BAY CITY, MI 48708

API Well Number: 21-087-28298-00-00

Well Name: ROACH, JAMES ET UX &
BODMER, KENNETH ETUX 1

Transfer Date: 5/3/2021

Previous Owner: BREITBURN OPERATING
LIMITED PARTNERSHIP

Location	QT QT QT	Sec	Township	Range	Township Name	County	Feet From Section Line	Feet From DRLG Unit
SL:	SWNWNE	35	10N	10E	RICH	LAPEER	990 N 220 W	330 S 220 W
BHL:	SWNWNE	35	10N	10E	RICH	LAPEER		

Michigan Department of
Environment, Great Lakes, and Energy
Oil, Gas and Minerals Division

Updated Permits

5/3/2021 THRU 5/7/2021



Permit Number Permittee Number Permittee Name

Page 21

30009 5986 TUSCOLA ENERGY INC
920 N WATER STREET, SUITE 213

BAY CITY, MI 48708

API Well Number: 21-087-30009-00-00

Well Name: COOPER, BEATRICE 1

Transfer Date: 5/3/2021

Previous Owner: BREITBURN OPERATING
LIMITED PARTNERSHIP

Location	QT QT QT	Sec	Township	Range	Township Name	County	Feet From Section Line	Feet From DRLG Unit
SL:	SWNE	27	10N	10E	RICH	LAPEER	990 N 990 E	990 N 990 E
BHL:	SWNE	27	10N	10E	RICH	LAPEER		

30010 5986 TUSCOLA ENERGY INC
920 N WATER STREET, SUITE 213

BAY CITY, MI 48708

API Well Number: 21-087-30010-00-00

Well Name: RANDALL, ALFRED E 2

Transfer Date: 5/3/2021

Previous Owner: BREITBURN OPERATING
LIMITED PARTNERSHIP

Location	QT QT QT	Sec	Township	Range	Township Name	County	Feet From Section Line	Feet From DRLG Unit
SL:	SWNE	27	10N	10E	RICH	LAPEER	990 N 990 E	990 N 990 E
BHL:	SWNE	27	10N	10E	RICH	LAPEER		

Michigan Department of
Environment, Great Lakes, and Energy
Oil, Gas and Minerals Division

Updated Permits

5/3/2021 THRU 5/7/2021



Permit Number Permittee Number Permittee Name

Page 22

30455 5986 TUSCOLA ENERGY INC
920 N WATER STREET, SUITE 213

BAY CITY, MI 48708

API Well Number: 21-087-30455-00-00

Well Name: RANDALL, ALFRED E
CONSOLIDATED 1

Transfer Date: 5/3/2021

Previous Owner: BREITBURN OPERATING
LIMITED PARTNERSHIP

Location	QT QT QT	Sec	Township	Range	Township Name	County	Feet From Section Line	Feet From DRLG Unit
SL:	SWNENW	27	10N	10E	RICH	LAPEER	990 N 1140 E	990 N 1140 E
BHL:	SWNENW	27	10N	10E	RICH	LAPEER		

33114 5986 TUSCOLA ENERGY INC
920 N WATER STREET, SUITE 213

BAY CITY, MI 48708

API Well Number: 21-087-33114-00-00

Well Name: STRICH, GERALD N TRACT 24 2

Transfer Date: 5/4/2021

Previous Owner: BREITBURN OPERATING
LIMITED PARTNERSHIP

Location	QT QT QT	Sec	Township	Range	Township Name	County	Feet From Section Line	Feet From DRLG Unit
SL:	SWSENW	27	10N	10E	RICH	LAPEER	330 S 990 E	
BHL:	SWSENW	27	10N	10E	RICH	LAPEER		

Michigan Department of
Environment, Great Lakes, and Energy
Oil, Gas and Minerals Division

Updated Permits

5/3/2021 THRU 5/7/2021



Permit Number Permittee Number Permittee Name

33115 5986 TUSCOLA ENERGY INC
920 N WATER STREET, SUITE 213

BAY CITY, MI 48708

API Well Number: 21-087-33115-00-00

Well Name: VOLLWEILER, WILLIAM TRACT
26 1

Transfer Date: 5/4/2021

Previous Owner: BREITBURN OPERATING
LIMITED PARTNERSHIP

Location	QT QT QT	Sec	Township	Range	Township Name	County	Feet From Section Line	Feet From DRLG Unit
SL:	SWSWNE	28	10N	10E	RICH	LAPEER	330 S 230 W	
BHL:	SWSWNE	28	10N	10E	RICH	LAPEER		

33116 5986 TUSCOLA ENERGY INC
920 N WATER STREET, SUITE 213

BAY CITY, MI 48708

API Well Number: 21-087-33116-00-00

Well Name: VOLLWEILER, WILLIAM TRACT
26 2

Transfer Date: 5/4/2021

Previous Owner: BREITBURN OPERATING
LIMITED PARTNERSHIP

Location	QT QT QT	Sec	Township	Range	Township Name	County	Feet From Section Line	Feet From DRLG Unit
SL:	SWSENE	28	10N	10E	RICH	LAPEER	330 S 990 E	0 S 330 W
BHL:	SWSENE	28	10N	10E	RICH	LAPEER		

Michigan Department of
Environment, Great Lakes, and Energy
Oil, Gas and Minerals Division

Updated Permits

5/3/2021 THRU 5/7/2021



Permit Number Permittee Number Permittee Name

Page 24

33118 5986 TUSCOLA ENERGY INC
920 N WATER STREET, SUITE 213

BAY CITY, MI 48708

API Well Number: 21-087-33118-00-00

Well Name: HEBBERD, MAE TRACT 23 2

Transfer Date: 5/4/2021

Previous Owner: BREITBURN OPERATING
LIMITED PARTNERSHIP

Location	QT QT QT	Sec	Township	Range	Township Name	County	Feet From Section Line	Feet From DRLG Unit
SL:	SWSESW	27	10N	10E	RICH	LAPEER	430 S 990 E	
BHL:	SWSESW	27	10N	10E	RICH	LAPEER		

33725 5986 TUSCOLA ENERGY INC
920 N WATER STREET, SUITE 213

BAY CITY, MI 48708

API Well Number: 21-087-33725-00-00

Well Name: RICH FIELD UNIT TRACT 12 3

Transfer Date: 5/4/2021

Previous Owner: BREITBURN OPERATING
LIMITED PARTNERSHIP

Location	QT QT QT	Sec	Township	Range	Township Name	County	Feet From Section Line	Feet From DRLG Unit
SL:	SWNWNE	27	10N	10E	RICH	LAPEER	940 N 330 W	
BHL:	SWNWNE	27	10N	10E	RICH	LAPEER		

Michigan Department of
Environment, Great Lakes, and Energy
Oil, Gas and Minerals Division

Updated Permits

5/3/2021 THRU 5/7/2021



Permit Number Permittee Number Permittee Name

Page 25

33726 5986 TUSCOLA ENERGY INC
920 N WATER STREET, SUITE 213

BAY CITY, MI 48708

API Well Number: 21-087-33726-00-00

Well Name: RICH FIELD UNIT TRACT 12 4

Transfer Date: 5/4/2021

Previous Owner: BREITBURN OPERATING
LIMITED PARTNERSHIP

Location	QT QT QT	Sec	Township	Range	Township Name	County	Feet From Section Line	Feet From DRLG Unit
SL:	SWSWNE	27	10N	10E	RICH	LAPEER	330 S 330 W	
BHL:	SWSWNE	27	10N	10E	RICH	LAPEER		

33728 5986 TUSCOLA ENERGY INC
920 N WATER STREET, SUITE 213

BAY CITY, MI 48708

API Well Number: 21-087-33728-00-00

Well Name: RICH FIELD UNIT TRACT 13 4

Transfer Date: 5/4/2021

Previous Owner: BREITBURN OPERATING
LIMITED PARTNERSHIP

Location	QT QT QT	Sec	Township	Range	Township Name	County	Feet From Section Line	Feet From DRLG Unit
SL:	SWNWNW	26	10N	10E	RICH	LAPEER	993 N 330 W	
BHL:	SWNWNW	26	10N	10E	RICH	LAPEER		

Michigan Department of
Environment, Great Lakes, and Energy
Oil, Gas and Minerals Division

Updated Permits

5/3/2021 THRU 5/7/2021



Permit Number Permittee Number Permittee Name

33730 5986 TUSCOLA ENERGY INC
920 N WATER STREET, SUITE 213

BAY CITY, MI 48708

API Well Number: 21-087-33730-00-00

Well Name: RICH FIELD UNIT TRACT 5 1

Transfer Date: 5/4/2021

Previous Owner: BREITBURN OPERATING
LIMITED PARTNERSHIP

Location	QT QT QT	Sec	Township	Range	Township Name	County	Feet From Section Line	Feet From DRLG Unit
SL:	SWSESE	22	10N	10E	RICH	LAPEER	330 S 997 E	
BHL:	SWSESE	22	10N	10E	RICH	LAPEER		

33734 5986 TUSCOLA ENERGY INC
920 N WATER STREET, SUITE 213

BAY CITY, MI 48708

API Well Number: 21-087-33734-00-00

Well Name: RICH FIELD UNIT TRACT 5 2

Transfer Date: 5/4/2021

Previous Owner: BREITBURN OPERATING
LIMITED PARTNERSHIP

Location	QT QT QT	Sec	Township	Range	Township Name	County	Feet From Section Line	Feet From DRLG Unit
SL:	SWSWSE	22	10N	10E	RICH	LAPEER	330 S 333 W	
BHL:	SWSWSE	22	10N	10E	RICH	LAPEER		

Michigan Department of
Environment, Great Lakes, and Energy
Oil, Gas and Minerals Division

Updated Permits

5/3/2021 THRU 5/7/2021



Permit Number Permittee Number Permittee Name

Page 27

34116 5986 TUSCOLA ENERGY INC
920 N WATER STREET, SUITE 213

BAY CITY, MI 48708

API Well Number: 21-087-34116-00-00

Well Name: RICH FIELD UNIT TRACT 21 2

Transfer Date: 5/4/2021

Previous Owner: BREITBURN OPERATING
LIMITED PARTNERSHIP

Location	QT QT QT	Sec	Township	Range	Township Name	County	Feet From Section Line	Feet From DRLG Unit
SL:	SWNENE	34	10N	10E	RICH	LAPEER	890 N 990 E	
BHL:	SWNENE	34	10N	10E	RICH	LAPEER		

34117 5986 TUSCOLA ENERGY INC
920 N WATER STREET, SUITE 213

BAY CITY, MI 48708

API Well Number: 21-087-34117-00-00

Well Name: RICH FIELD UNIT TRACT 42 2

Transfer Date: 5/4/2021

Previous Owner: BREITBURN OPERATING
LIMITED PARTNERSHIP

Location	QT QT QT	Sec	Township	Range	Township Name	County	Feet From Section Line	Feet From DRLG Unit
SL:	SWSWNE	34	10N	10E	RICH	LAPEER	330 S 330 W	
BHL:	SWSWNE	34	10N	10E	RICH	LAPEER		

Michigan Department of
Environment, Great Lakes, and Energy
Oil, Gas and Minerals Division

Updated Permits

5/3/2021 THRU 5/7/2021



Permit Number Permittee Number Permittee Name

Page 28

34151 5986 TUSCOLA ENERGY INC
920 N WATER STREET, SUITE 213

BAY CITY, MI 48708

API Well Number: 21-087-34151-00-00

Well Name: RICH FIELD UNIT TRACT 33 2

Transfer Date: 5/4/2021

Previous Owner: BREITBURN OPERATING
LIMITED PARTNERSHIP

Location	QT QT QT	Sec	Township	Range	Township Name	County	Feet From Section Line	Feet From DRLG Unit
SL:	SWNWNE	34	10N	10E	RICH	LAPEER	999 N 395 W	
BHL:	SWNWNE	34	10N	10E	RICH	LAPEER		

34256 5986 TUSCOLA ENERGY INC
920 N WATER STREET, SUITE 213

BAY CITY, MI 48708

API Well Number: 21-087-34256-00-00

Well Name: RICH FIELD UNIT TRACT 14 1

Transfer Date: 5/4/2021

Previous Owner: BREITBURN OPERATING
LIMITED PARTNERSHIP

Location	QT QT QT	Sec	Township	Range	Township Name	County	Feet From Section Line	Feet From DRLG Unit
SL:	SWNENW	26	10N	10E	RICH	LAPEER	990 N 990 E	
BHL:	SWNENW	26	10N	10E	RICH	LAPEER		

Michigan Department of
Environment, Great Lakes, and Energy
Oil, Gas and Minerals Division

Updated Permits

5/3/2021 THRU 5/7/2021



Permit Number Permittee Number Permittee Name

35232 5986 TUSCOLA ENERGY INC
920 N WATER STREET, SUITE 213

BAY CITY, MI 48708

API Well Number: 21-087-35232-00-00

Well Name: RICH FIELD UNIT TRACT 06 1

Transfer Date: 5/4/2021

Previous Owner: BREITBURN OPERATING
LIMITED PARTNERSHIP

Location	QT QT QT	Sec	Township	Range	Township Name	County	Feet From Section Line	Feet From DRLG Unit
SL:	SWSESW	22	10N	10E	RICH	LAPEER	330 S 990 E	
BHL:	SWSESW	22	10N	10E	RICH	LAPEER		

35343 5986 TUSCOLA ENERGY INC
920 N WATER STREET, SUITE 213

BAY CITY, MI 48708

API Well Number: 21-087-35343-00-00

Well Name: RICH FIELD UNIT TRACT 03 1

Transfer Date: 5/4/2021

Previous Owner: BREITBURN OPERATING
LIMITED PARTNERSHIP

Location	QT QT QT	Sec	Township	Range	Township Name	County	Feet From Section Line	Feet From DRLG Unit
SL:	SWSWSW	23	10N	10E	RICH	LAPEER	370 S 455 W	
BHL:	SWSWSW	23	10N	10E	RICH	LAPEER		

Michigan Department of
Environment, Great Lakes, and Energy
Oil, Gas and Minerals Division

Updated Permits

5/3/2021 THRU 5/7/2021



Permit Number Permittee Number Permittee Name

Page 30

35549 5986 TUSCOLA ENERGY INC
920 N WATER STREET, SUITE 213

BAY CITY, MI 48708

API Well Number: 21-087-35549-00-00

Well Name: RICH FIELD UNIT TRACT 16 1

Transfer Date: 5/4/2021

Previous Owner: BREITBURN OPERATING
LIMITED PARTNERSHIP

Location	QT QT QT	Sec	Township	Range	Township Name	County	Feet From Section Line	Feet From DRLG Unit
SL:	SWNWSE	26	10N	10E	RICH	LAPEER	1140 N 340 W	
BHL:	SWNWSE	26	10N	10E	RICH	LAPEER		

36466 5986 TUSCOLA ENERGY INC
920 N WATER STREET, SUITE 213

BAY CITY, MI 48708

API Well Number: 21-087-36466-00-00

Well Name: RICH FIELD UNIT TRACT 21 3 True Vertical Depth: 3170

Transfer Date: 5/4/2021

Previous Owner: BREITBURN OPERATING
LIMITED PARTNERSHIP

Location	QT QT QT	Sec	Township	Range	Township Name	County	Feet From Section Line	Feet From DRLG Unit
SL:	NESENE	34	10N	10E	RICH	LAPEER	815 S 160 E	
BHL:	NWSENE	34	10N	10E	RICH	LAPEER	800 S 672 E	

Michigan Department of
Environment, Great Lakes, and Energy
Oil, Gas and Minerals Division

Updated Permits

5/3/2021 THRU 5/7/2021



Permit Number Permittee Number Permittee Name

36464 5986 TUSCOLA ENERGY INC
920 N WATER STREET, SUITE 213

BAY CITY, MI 48708

API Well Number: 21-087-36464-00-00

Well Name: RICH FIELD UNIT TRACT 22 2

Transfer Date: 5/4/2021

Previous Owner: BREITBURN OPERATING
LIMITED PARTNERSHIP

Location	QT QT QT	Sec	Township	Range	Township Name	County	Feet From Section Line	Feet From DRLG Unit
SL:	SWNWSE	27	10N	10E	RICH	LAPEER	992 N 260 W	
BHL:	SWNWSE	27	10N	10E	RICH	LAPEER		



Michigan Department of
Environment, Great Lakes, and Energy
Oil, Gas and Minerals Division

Updated Permits

5/3/2021 THRU 5/7/2021



Permit Number Permittee Number Permittee Name

39855 100 APOLLO EXPLORATION AND
DEVELOPMENT INC
1710 E REMUS ROAD
PO BOX 190
MOUNT PLEASANT, MI 48804-0190

API Well Number: 21-101-39855-00-00

Well Name: CLINE 1-24

True Vertical Depth: 5040

Transfer Date: 5/5/2021

Previous Owner: OSOSKI EDWARD D DBA
FEDERAL OIL COMPANY

Location	QT QT QT	Sec	Township	Range	Township Name	County	Feet From Section Line	Feet From DRLG Unit
SL:	SENESE	24	23N	15W	BEAR LAKE	MANISTEE	712 N 249 E	
BHL:	NESWNE	24	23N	15W	BEAR LAKE	MANISTEE	1154 S 976 W	1154 S 361 E

52263 100 APOLLO EXPLORATION AND
DEVELOPMENT INC
1710 E REMUS ROAD
PO BOX 190
MOUNT PLEASANT, MI 48804-0190

API Well Number: 21-101-52263-00-00

Well Name: VALIQUETT 1-15 HD1

True Vertical Depth: 4662

Transfer Date: 5/5/2021

Previous Owner: OSOSKI EDWARD D DBA
FEDERAL OIL COMPANY

Location	QT QT QT	Sec	Township	Range	Township Name	County	Feet From Section Line	Feet From DRLG Unit
SL:	SENWSE	15	23N	15W	BEAR LAKE	MANISTEE	1263 N 665 W	
BHL:	SWSWSE	15	23N	15W	BEAR LAKE	MANISTEE	336 S 2271 E	336 S 369 W