

Michigan Department of
Environment, Great Lakes, and Energy (EGLE)
Community Water Supply

Quarterly Program Update

July 15, 2021



All lines are muted during the webinar.



Submit your questions using the “**Question**” box in your Go To Webinar tool bar.

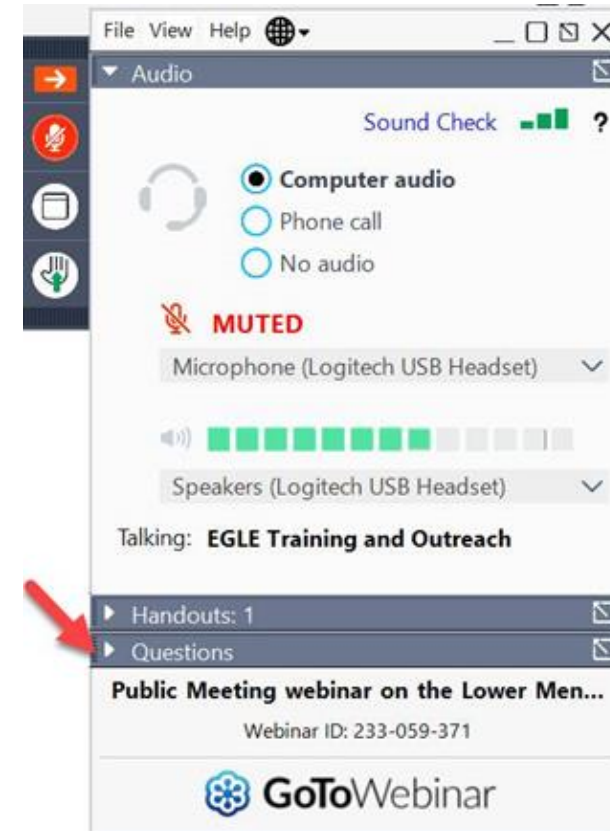

Poll Question 1

Q & A Panel

- Eric Oswald
 - Drinking Water and Environmental Health Division Director
- George Krisztian
 - DWEHD Assistant Division Director
- Brian Thurston
 - DWEHD Field Operations Section Manager
- Kris Philip
 - DWEHD Community Water Supply Section Manager

Topics Covered Today

- Urgent Update
- EGLE Updates
- Low Income Household Water Assistance Program
- Reminders & Resources
- Regulatory Updates
- Q&A Session

Urgent Update

- Wrong chemical delivered
- Chemical Supplier – PVS Nolwood Chemicals, Inc.
 - Chemical **Labeled** – Hydrofluorosilicic Acid (HFS) 23%
 - Lot Number L091520P
 - Actual Chemical from analysis: Sulfuric Acid 93%
- All 4 drums delivered contained Sulfuric Acid 93%
- If you feed HFS and used PVS, please check your inventory
- **If Lot Number L091520P, Do Not Use and contact PVS.**



EGLE Update

- In general, EGLE staff continue to telework from home until September 7.
 - Remote water supply surveillance visits, unless facility inspection is needed.
 - Remote sanitary surveys, except facility inspection portion
- In-person Visits:
 - DWEHD Field Operations Section (FOS) Standard Operating Procedures (SOP) updated to include additional safety precautions to protect water supply and DWEHD staff during in-person visits
 - DWEHD continues program critical in-person visits in all districts using updated SOP
 - Facility inspections; Sanitary Survey facilities review; Start-up of new facilities

EGLE Field Work COVID-19 Procedures

Some considerations in DWEHD's current field work procedures:

- Perform as much work as possible remotely
- Face coverings are recommended
- **EGLE staff will wear face coverings, if required by facility**
- Verify lack of COVID-19 symptoms for water supply personnel and EGLE inspector ahead of visit
- Do not shake hands and practice social distancing
- Avoid exchanging physical materials, including paper handouts

General Online Resources

- Michigan Webpage: Michigan.gov/Coronavirus
- EGLE CWS Webpage: Michigan.gov/CommunityWater, then "[COVID 19: Information for Water Operators](#)"
- EPA has established a website to assist water utilities: "[Water Utility Resources for the COVID-19 Pandemic](#)"
- MIOSHA provides information for various sectors, including factsheets, posters, and other guidance: [MIOSHA COVID-19 Workplace Safety Guidance](#)



Water Quality Within Buildings

Resources for managing building water quality following periods of low or no water use:

- [EGLE: School Flushing Guidance](#)
- [CDC: Guidance for Building Water Systems](#)
- [EPA: Maintaining or Restoring Water Quality in Buildings...](#)
- [ASDWA: COVID-19 Resources for Building Water Systems](#)
- [AWWA: Coronavirus Information, incl. Return to Service Guidance](#)
- [ESPRI: Flushing Guidance for Periods of Low or No Use](#)
- [Purdue: Water Quality in Low Occupancy and Shutdown Buildings](#)
- [AWWA/IAPMO: Responding to Water Stagnation in Buildings with Reduced or No Water Use](#)

Epidemic Orders & Other Laws

- All Executive Orders and DHHS Epidemic Orders have been lifted and the latest recommendations can be found at Michigan.gov/Coronavirus
- Water service restoration
 - Public Act 252 of 2020 was repealed effective March 31, 2021
 - **Shutoffs for nonpayment are discouraged**
 - **A community should consult with their legal counsel prior to enforcing shutoffs**

Low Income Household Water Assistance Program

Proposed Program

- Categorical Eligibility: LIHEAP, SSI, SNAP, TANF
- Countable income: Employment earnings, self-employment earnings, SSI, RSDI, child support, alimony, pension, retirement income, workers compensation, etc.
- FPL: 150%
- No asset test
- Renters: Referred to CERA. Renters will qualify if they are responsible for the water/sewer bill.
- Fiscal Year Cap: \$650/SER \$350
- No priority in eligibility: people with disabilities, young children, seniors
- Conditions: guarantee service for at least 30 days after receipt of payment.

Poll Question 2

Operator Training & Certification Update

2021 Certification Examinations

- Spring/summer examinations were held JULY 14, 2021
 - Results will be available approximately 45 days after exam date
- Fall exams will be held NOVEMBER 2, 2021
 - Application deadline for fall exam is SEPTEMBER 2, 2021

Operator Training

- Visit Michigan.gov/EGLEoperatortraining for a list of approved courses and other OTCU information, including an expanding list on online training opportunities

Operator Certification

Reminder!

- Individuals whose certification has expired **CANNOT** serve as an Operator in Charge (OIC) or a backup OIC
- The 1-year grace period for re-establishing certification after expiration relates only to the ability to restore certification without re-testing. Individuals **CANNOT** serve as an OIC during this grace period.

MI Clean Water Funding

- Governor's program invests in protecting public health, environment and the economy.
 - \$207 million towards Michigan's Drinking Water infrastructure needs
- FY 2022 forgiveness programs used in conjunction with State Revolving Fund (SRF) financing can help maximize impact in communities
 - Lead Service Line Replacement - \$102 Million
 - Drinking Water Infrastructure - \$35 Million
- Drinking Water Asset Management Grants - Priority Order published
 - \$139 Million requested in 1st round. (\$36.5 Million available)
- Contamination and Consolidation Grants - Priority Order published
 - 32 applicants requested \$80 Million in 1st round. (\$25 Million available)
- Affordability and Planning Grants – Approved Applications published (1.9 M)
 - 34 applicants requested \$13.9 Million in 1st round. (\$7.5 Million available)

MI Clean Water Funding

Funding Resources:

- www.michigan.gov/eglegrantsandloans
- www.michigan.gov/DWSRF

Source Water Protection Grants

- To provide matching funds to public water supply systems for the development and implementation of a source water protection program to help prevent drinking water sources from becoming contaminated.
- These funds can be used to develop a Surface Water Intake Protection Program for systems utilizing surface water or to develop a Wellhead Protection Program for those systems that use groundwater sources.
- Applications are to be postmarked or delivered by June 15 annually.
- More grant information: www.michigan.gov/whp

Risk and Resilience Assessments

- Consider risks from malevolent act and natural hazards
- Include:
 - Pipes/conveyances, source water, water collection/intake, pretreatment, treatment, storage and distribution, electronic, computer, or other automated systems (including security);
 - Monitoring practices;
 - Financial infrastructure;
 - Use, storage or handling of chemicals;
 - Operation and maintenance; and
 - May include capital and operational needs for risk management

Risk and Resilience Assessments

- Risk Assessments were due by June 30, 2021 for water supplies with population served 3,301 – 49,999 
- **Certify to EPA** that an **updated Emergency Response Plan** has been developed and is in place by **no later than December 30, 2021** for these water supplies.

2020 Drinking Water Infrastructure Needs Survey and Assessments (DWINSA)

- DWINSA Surveys were emailed and mailed to selected water supplies in January 2021
- Completed DWINSA surveys need to be submitted back to EGLE for review and submission to EPA.
 - All outstanding completed DWINSA need to be returned to EGLE.
- **If you received a DWINSA please complete and return to EGLE as soon as you can and no later than August 31, 2021.**
- Thank you to all that have completed this important survey of water supply industry needs!

PFAS Rules Update

- PFAS drinking water rules took effect August 3, 2020
- Establish MCLs for 7 PFAS compounds
- Initial monitoring was completed in February 2021
 - Nearly 99% of CWS sampled by initial deadline, as required
- EGLE and DHHS are working with water supplies whose PFAS results are at a level of concern
- Visit Michigan.gov/PFASDrinkingWaterRules for rule info, overview documents, certified laboratory lists, sampling procedure documents and video

Michigan LCR Reminders

- Service Line Replacement Requirements began this year
 - Requirement to replace lead service lines and galvanized previously connected to lead began January 1, 2021
 - Must replace an average of 5% per year, not to exceed 20 years
 - Annual reporting of replacement progress is required per 11604(c)(vii). (Reporting form under develop)
- Complete Distribution System Materials Inventory
 - Minimum service line material verification guidance recently provided to municipal supplies (available at Michigan.gov/LCR)
 - Webinars about this guidance were offered in April

Federal Lead and Copper Rule Revisions (LCRR)

Previous Actions

- [Federal Lead and Copper Rule Revisions](#) published 1/15/2021, with initial compliance deadline of 1/16/2024 (3 years from publication)

Recent Actions

- First Action - [Effective date extended](#) from 3/16/2021 to 6/17/2021 to allow time for comment on second action
- Second Action - [Effective date extended](#) again to 12/16/2021 and corresponding extension of compliance deadline to 10/16/2024

Federal LCRR (cont.)

EPA Gathering Additional Input on LCRR

- Public Listening Sessions were held April 28 and May 5
- Community Roundtables focused on communities disproportionately impacted by lead in drinking water held June & July (MI communities include Benton Harbor, Highland Park, Flint, and Detroit)
- For information and recording of events visit link above.

Federal LCRR (cont.)

- Timeline for Michigan rule changes
 - Timeline dependent on outcomes of EPA actions
 - EGLE will hold stakeholder meetings in the future
- Key Differences in new LCRR (as currently written)
 - School/daycare testing, trigger level, sampling, tiering criteria, find-and-fix, small system flexibility, outreach
- For now, supplies should **continue following current Michigan Lead and Copper Rule requirements**

DWEHD IT Upgrades

MiEHDWIS - Michigan Environmental Health and Drinking Water Information System (nicknamed "**Eddy**")

- New data system being built for DWEHD
- Will serve all DWEHD programs
- Will allow supplies to submit documents and manage information online
- Currently working on a small pilot project for CWS
- Expect access for all CWS later this year
- Software being developed in stages with future versions supporting online permit processing, online forms, and other tools

Sanitary Surveys Goals

- Improve the public health protection provided
- Support the Community's investment in infrastructure
- Provide recommendations for improvements
- Give opportunity for discussion on water system operations, maintenance, and optimization
- Evaluate compliance with existing SDWA regulations
- Support the Community's investment to ensure adequate Technical, Managerial, and Financial Capacity

Q&A Session

- Submit questions using the "Question" box in your Go To Webinar tool bar.
- Questions will be compiled and posted to the Community Water COVID-19 website as a Q&A document.
- Between meetings, general programmatic questions/issues can be sent to:
EGLE-DWEHD-CWS@Michigan.gov

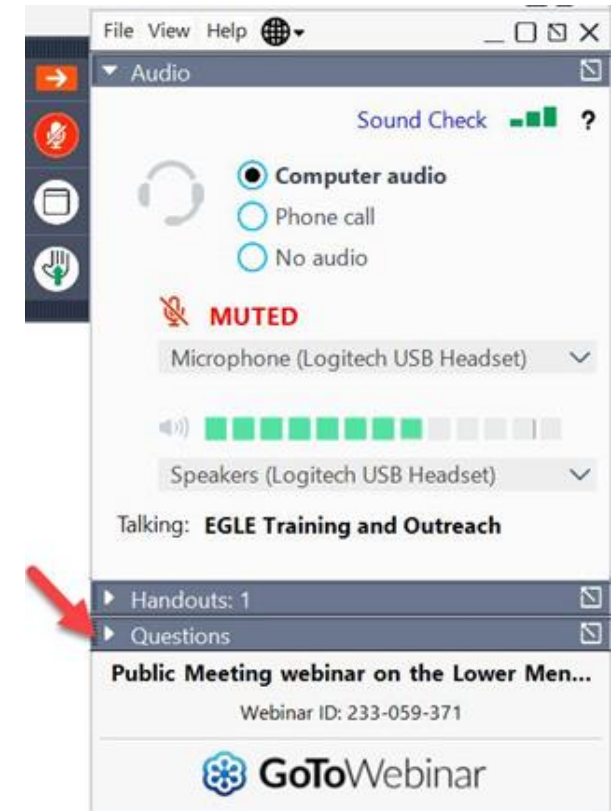

Thank you for tuning in!

- Look for notification of future sessions
- Stay in contact with your district engineer and communicate any challenges you are facing
- Stay safe out there!