

Michigan Department of  
Environment, Great Lakes, and Energy  
Oil, Gas and Minerals Division

PERMIT APPLICATIONS

9/20/2021 THRU 9/24/2021



Application Number

Date Received

Permittee  
Number

Permittee  
Name

Page 1

632                      09/23/2021                      6498                      WOLVERINE GAS & OIL CO OF  
MICHIGAN LLC  
One Riverfront Plaza  
Grand Rapids, MI 49503

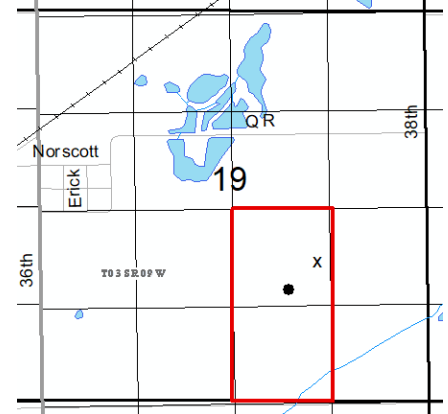

Prev Permit:

Well Name: Keystone Unlimited, LLC 19-1

Surface Owner: Keystone Unlimited,  
LLC

Well Type: OIL

True Vertical Depth: 3755

Permit Type: Drill

Target Formation: TRENTON

H2S Present? Yes

Deepest Formation: GLENWOOD

80-Acre R303 Drilling unit, W/2  
SE/4 Section 19

Location:	QT QT QT	Sec	Township	Range	Township Name	County	Feet From Section Line	Feet From DRLG Unit Line
SL:	SENWSE	19	3S	9W	CLIMAX	KALAMAZOO	1663 S 1548 E	
BHL:	NWNESE	19	3S	9W	CLIMAX	KALAMAZOO	1581 S 1887 W	1059 N 566 E

Michigan Department of  
Environment, Great Lakes, and Energy  
Oil, Gas and Minerals Division

PERMIT APPLICATIONS

9/20/2021 THRU 9/24/2021



Application Number

Date Received

Permittee  
Number

Permittee  
Name

Page 2

631                      09/23/2021                      5320                      SAVOY ENERGY LP  
920 HASTINGS STREET, SUITE A  
PO BOX 1560  
TRAVERSE CITY, MI 49685-1560

Prev Permit: 61552

Well Name: Bennett 1-14 HD1

Well Type: OIL

Permit Type: Re-Entry

H2S Present? No

Surface Owner: Bennett, Sharon L.

True Vertical Depth: 3476

Target Formation: TRENTON-BLACK  
RIVER

Deepest Formation: TRENTON-BLACK  
RIVER

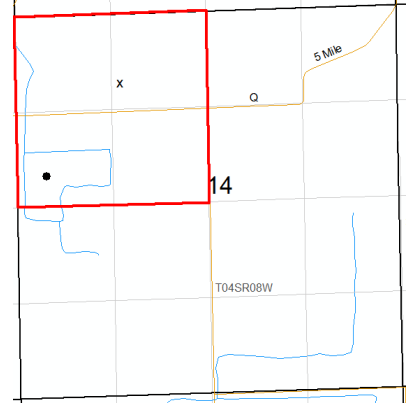

160-Acre R303 Drilling Unit,  
NW/4 Section 14

Location:	QT QT QT	Sec	Township	Range	Township Name	County	Feet From Section Line	Feet From DRLG Unit Line
SL:	SWNENW	14	4S	8W	ATHENS	CALHOUN	980 N 1479 W	980 N 1180 E
BHL:	SWNENW	14	4S	8W	ATHENS	CALHOUN	2012 N 401 W	636 S 401 W

Michigan Department of  
Environment, Great Lakes, and Energy  
Oil, Gas and Minerals Division

PERMIT LIST

9//20/2021 THRU 9/24/2021



Permit Number: 61558  
Issue Date: 9/20/2021  
Permittee Number: 6418  
Permittee Name: W B OSBORN OIL AND GAS OPERATIONS LTD  
P O BOX 8C  
SAN ANTONIO, TX 78217

Page 1

API Well No: 21-117-62018-00-00

Prev Permit:

Well Name: WALDRON FARMS TRUST 1-30

Surface Owner: W. and M. Waldron Farm Land Trust

Well Type: Oil Well

True Vertical Depth: 3050FT

Permit Type: Drill

Target Formation: TRAVERSE LIMESTONE

H2S Present? No

Deepest Formation: TRAVERSE LIMESTONE

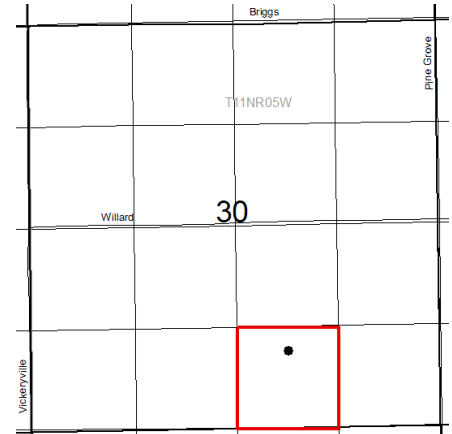

40-Acre Drilling Unit, SW/4 SE/4 Section 30

Location:	QT QT QT	Sec	Township	Range	Township Name	County	Feet From Section Line	Feet From DRLG Unit Line
SL:	NWSWSE	30	11N	5W	FERRIS	MONTCALM	998 S 1983 E	
BHL:	NWSWSE	30	11N	5W	FERRIS	MONTCALM	998 S 1983 E	332 N 661 E

61559 9/23/2021 4934  
FEDERATED OIL AND GAS PROPERTIES INC  
PO BOX 946  
TRAVERSE CITY, MI 49685-0946

API Well No: 21-107-62002-01-00

Prev Permit: 61383

Well Name: DAUGHERTY 1-16A

Surface Owner: EDWIN N. & MARY f. DAUGHERTY

Well Type: Oil Well

True Vertical Depth: 3760FT

Permit Type: Re-Entry

Target Formation: DUNDEE

H2S Present? Yes

Deepest Formation: DUNDEE

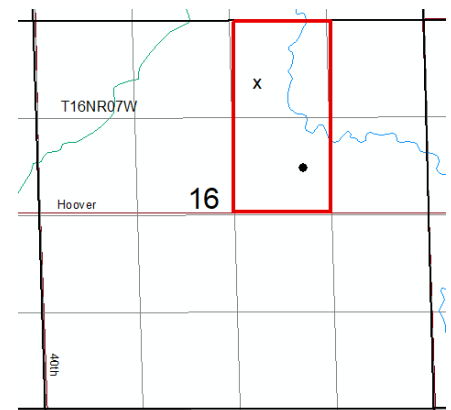

80-Acre R303 Drilling Unit, NE/4, Section 16

Location:	QT QT QT	Sec	Township	Range	Township Name	County	Feet From Section Line	Feet From DRLG Unit Line
SL:	SWNWNE	16	16N	7W	FORK	MECOSTA	873 N 2299 E	
BHL:	SESWNE	16	16N	7W	FORK	MECOSTA	2013 N 1686 E	624 S 363 E

Michigan Department of  
Environment, Great Lakes, and Energy  
Oil, Gas and Minerals Division

PERMIT LIST

9//20/2021 THRU 9/24/2021



Permit Number	Issue Date	Permittee Number	Permittee Name
61560	9/23/2021	8139	MUSKEGON OPERATING COMPANY LLC 1425 S MISSION RD  MOUNT PLEASANT, MI 48858

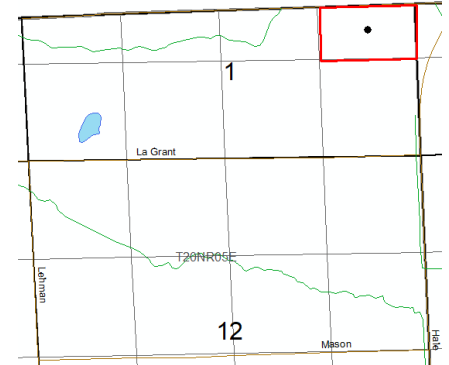

API Well No: 21-011-62008-00-00

Prev Permit:

Well Name: ROHDE 1-1

Surface Owner: Thomas Rohde

Well Type: Oil Well

True Vertical Depth: 3500FT

Permit Type: Drill

Target Formation: DUNDEE

H2S Present? Yes

Deepest Formation: DETROIT RIVER ANHY

40-Acre (nominal) Drilling Unit,  
NE fr/4, E fr/2, Irregular Section 1

Location:	QT QT QT	Sec	Township	Range	Township Name	County	Feet From Section Line	Feet From DRLG Unit Line
SL:	NENENE	1	20N	5E	MASON	ARENAC	330 N 660 E	
BHL:	NENENE	1	20N	5E	MASON	ARENAC	330 N 660 E	330 N 660 E

Michigan Department of  
Environment, Great Lakes, and Energy  
Oil, Gas and Minerals Division  
Updated Permits  
9/20/2021 THRU 9/24/2021



Permit Number      Permittee Number      Permittee Name

**PLUGGING INSTRUCTIONS ISSUED:**

33123                  6366                  MAVERICK EXPLORATION AND PRODUCTION INC  
  
3301 VETERANS DR STE 107  
TRAVERSE CITY, MI 49684

API Well Number: 21-055-33123-00-00

Well Name: TULLER 1-28

Plug Inst. Issue Date: 9/24/2021

Location	QT QT QT	Sec	Township	Range	Township Name	County	Feet From Section Line	Feet From DRLG Unit
SL:	NESWNE	28	26N	10W	PARADISE	GRAND TRAVERSE	827 S 1075 W	485 N 1075 W
BHL:	NESWNE	28	26N	10W	PARADISE	GRAND TRAVERSE		

Comment: App to P&A expires on 7/31/2022

45363                  25                  DELTA OIL CO INC  
  
125 WINDSOR DR STE 101  
OAK BROOK, IL 60523

API Well Number: 21-119-45363-00-00

Well Name: STATE VIENNA A4-23

Plug Inst. Issue Date: 9/17/2021

Location	QT QT QT	Sec	Township	Range	Township Name	County	Feet From Section Line	Feet From DRLG Unit
SL:	NWNENE	23	31N	1E	VIENNA	MONTMORENCY	335 N 975 E	335 N 346 W
BHL:	NWNENE	23	31N	1E	VIENNA	MONTMORENCY		

Comment: App to P&A expires on 9/17/2022

Michigan Department of  
 Environment, Great Lakes, and Energy  
 Oil, Gas and Minerals Division  
 Updated Permits  
 9/20/2021 THRU 9/24/2021



Permit Number      Permittee Number      Permittee Name

45697                  25                                  DELTA OIL CO INC  
 125 WINDSOR DR STE 101  
 OAK BROOK, IL 60523

API Well Number: 21-119-45697-00-00

Well Name: STATE VIENNA B3-23

Plug Inst. Issue Date: 9/17/2021

Location	QT QT QT	Sec	Township	Range	Township Name	County	Feet From Section Line	Feet From DRLG Unit
SL:	SWSWNE	23	31N	1E	VIENNA	MONTMORENCY	508 S 612 W	
BHL:	SWSWNE	23	31N	1E	VIENNA	MONTMORENCY		

Comment: App to P&A expires on 9/17/2022

46919                  25                                  DELTA OIL CO INC  
 125 WINDSOR DR STE 101  
 OAK BROOK, IL 60523

API Well Number: 21-119-46919-00-00

Well Name: STATE VIENNA A4-14

Plug Inst. Issue Date: 9/17/2021

Location	QT QT QT	Sec	Township	Range	Township Name	County	Feet From Section Line	Feet From DRLG Unit
SL:	SWNE	14	31N	1E	VIENNA	MONTMORENCY	840 N 908 E	460 S 407 W
BHL:	SWNE	14	31N	1E	VIENNA	MONTMORENCY		

Comment: App to P&A expires on 9/17/2022

Michigan Department of  
 Environment, Great Lakes, and Energy  
 Oil, Gas and Minerals Division  
 Updated Permits  
 9/20/2021 THRU 9/24/2021



Permit Number      Permittee Number      Permittee Name

47773                      25                                      DELTA OIL CO INC  
 125 WINDSOR DR STE 101  
 OAK BROOK, IL 60523

API Well Number: 21-119-47773-00-00

Well Name: STATE VIENNA B4-12

Plug Inst. Issue Date: 9/17/2021

Location	QT QT QT	Sec	Township	Range	Township Name	County	Feet From Section Line	Feet From DRLG Unit
SL:	NWSENE	12	31N	1E	VIENNA	MONTMORENCY	722 S 700 E	589 N 619 W
BHL:	NWSENE	12	31N	1E	VIENNA	MONTMORENCY		

Comment: App to P&A expires on 9/17/2022

48014                      25                                      DELTA OIL CO INC  
 125 WINDSOR DR STE 101  
 OAK BROOK, IL 60523

API Well Number: 21-119-48014-00-00

Well Name: CUMPER B2-31

Plug Inst. Issue Date: 9/17/2021

Location	QT QT QT	Sec	Township	Range	Township Name	County	Feet From Section Line	Feet From DRLG Unit
SL:	NWSENW	31	30N	3E	AVERY	MONTMORENCY	692 S 704 E	629 N 616 W
BHL:	NWSENW	31	30N	3E	AVERY	MONTMORENCY		

Comment: App to P&A expires on 9/17/2022

Michigan Department of  
 Environment, Great Lakes, and Energy  
 Oil, Gas and Minerals Division  
 Updated Permits  
 9/20/2021 THRU 9/24/2021



Permit Number      Permittee Number      Permittee Name

61247      6366      MAVERICK EXPLORATION AND PRODUCTION INC  
 3301 VETERANS DR STE 107  
 TRAVERSE CITY, MI 49684

API Well Number: 21-055-32543-02-00

Well Name: CUNNINGHAM & STATE      True Vertical Depth: 6525  
 PARADISE 1-27A

Plug Inst. Issue Date: 9/24/2021

Location	QT QT QT	Sec	Township	Range	Township Name	County	Feet From Section Line	Feet From DRLG Unit
SL:	SWNWSW	27	26N	10W	PARADISE	GRAND TRAVERSE	1966 S 240 W	
BHL:	SWNWSW	27	26N	10W	PARADISE	GRAND TRAVERSE	1956 S 280 W	630 S 1041 E

Comment: App to P&A expires on 7/31/22

61509      6310      CORE ENERGY LLC  
 1011 NOTEWARE DRIVE  
 TRAVERSE CITY, MI 49686

API Well Number: 21-137-62006-00-00

Well Name: BUCKHORN 3-23

Plug Inst. Issue Date: 9/23/2021

Location	QT QT QT	Sec	Township	Range	Township Name	County	Feet From Section Line	Feet From DRLG Unit
SL:	NENESE	22	31N	1W	CHARLTON	OTSEGO	2216 S 239 E	
BHL:	NWSWNW	23	31N	1W	CHARLTON	OTSEGO	1563 N 513 W	1015 S 799 E

Comment: App to P&A expires on 9/23/2022



Michigan Department of  
Environment, Great Lakes, and Energy  
Oil, Gas and Minerals Division  
Updated Permits  
9/20/2021 THRU 9/24/2021



Permit Number      Permittee Number      Permittee Name

**RECORD OF WELL PLUGGING:**

51138      6361      RIVERSIDE ENERGY MICHIGAN LLC  
10691 EAST CARTER ROAD  
SUITE 201  
TRAVERSE CITY, MI 49684

API Well Number: 21-009-51138-00-00

Well Name: BRUMMELER C2-30

Plugging Date: 8/25/2021

Location	QT QT QT	Sec	Township	Range	Township Name	County	Feet From Section Line	Feet From DRLG Unit
SL:	SWNESW	30	31N	7W	ECHO	ANTRIM	800 N 700 E	800 N 620 W
BHL:	SWNESW	30	31N	7W	ECHO	ANTRIM		

52681      6361      RIVERSIDE ENERGY MICHIGAN LLC  
10691 EAST CARTER ROAD  
SUITE 201  
TRAVERSE CITY, MI 49684

API Well Number: 21-009-52681-00-00

Well Name: BURNS D4-30

Plugging Date: 9/2/2021

Location	QT QT QT	Sec	Township	Range	Township Name	County	Feet From Section Line	Feet From DRLG Unit
SL:	SWSESE	30	31N	7W	ECHO	ANTRIM	369 S 883 E	369 S 434 W
BHL:	SWSESE	30	31N	7W	ECHO	ANTRIM		

Michigan Department of  
 Environment, Great Lakes, and Energy  
 Oil, Gas and Minerals Division  
 Updated Permits  
 9/20/2021 THRU 9/24/2021



Permit Number      Permittee Number      Permittee Name

52682      6361      RIVERSIDE ENERGY MICHIGAN LLC  
 10691 EAST CARTER ROAD  
 SUITE 201  
 TRAVERSE CITY, MI 49684

API Well Number: 21-009-52682-00-00

Well Name: MCDIVITT B1-31

Plugging Date: 8/25/2021

Location	QT QT QT	Sec	Township	Range	Township Name	County	Feet From Section Line	Feet From DRLG Unit
SL:	NESWNW	31	31N	7W	ECHO	ANTRIM	856 S 848 W	460 N 848 W
BHL:	NESWNW	31	31N	7W	ECHO	ANTRIM		

52683      6361      RIVERSIDE ENERGY MICHIGAN LLC  
 10691 EAST CARTER ROAD  
 SUITE 201  
 TRAVERSE CITY, MI 49684

API Well Number: 21-009-52683-00-00

Well Name: BURNS B4-31

Plugging Date: 9/17/2021

Location	QT QT QT	Sec	Township	Range	Township Name	County	Feet From Section Line	Feet From DRLG Unit
SL:	SESENE	31	31N	7W	ECHO	ANTRIM	372 S 343 E	372 S 343 E
BHL:	SESENE	31	31N	7W	ECHO	ANTRIM		

Michigan Department of  
 Environment, Great Lakes, and Energy  
 Oil, Gas and Minerals Division  
 Updated Permits  
 9/20/2021 THRU 9/24/2021



Permit Number      Permittee Number      Permittee Name

52774      6361      RIVERSIDE ENERGY MICHIGAN LLC  
 10691 EAST CARTER ROAD  
 SUITE 201  
 TRAVERSE CITY, MI 49684

API Well Number: 21-009-52774-00-00

Well Name: PERSON ET AL A2-32

Plugging Date: 9/17/2021

Location	QT QT QT	Sec	Township	Range	Township Name	County	Feet From Section Line	Feet From DRLG Unit
SL:	SWNENW	32	31N	7W	ECHO	ANTRIM	1163 N 927 E	1163 N 381 W
BHL:	SWNENW	32	31N	7W	ECHO	ANTRIM		

52905      6361      RIVERSIDE ENERGY MICHIGAN LLC  
 10691 EAST CARTER ROAD  
 SUITE 201  
 TRAVERSE CITY, MI 49684

API Well Number: 21-009-52905-00-00

Well Name: STATE ECHO & BURNS ET AL D2  
 -32

Plugging Date: 9/17/2021

Location	QT QT QT	Sec	Township	Range	Township Name	County	Feet From Section Line	Feet From DRLG Unit
SL:	SESESW	32	31N	7W	ECHO	ANTRIM	441 S 381 E	868 N 381 E
BHL:	SESESW	32	31N	7W	ECHO	ANTRIM		

Michigan Department of  
Environment, Great Lakes, and Energy  
Oil, Gas and Minerals Division  
Updated Permits  
9/20/2021 THRU 9/24/2021



Permit Number      Permittee Number      Permittee Name

53296      6361      RIVERSIDE ENERGY MICHIGAN LLC  
10691 EAST CARTER ROAD  
SUITE 201  
TRAVERSE CITY, MI 49684

API Well Number: 21-009-53296-00-00

Well Name: MCDIVITT C2-31

Plugging Date: 8/25/2021

Location	QT QT QT	Sec	Township	Range	Township Name	County	Feet From Section Line	Feet From DRLG Unit
SL:	NWNESW	31	31N	7W	ECHO	ANTRIM	2217 S 1927 W	407 N 432 W
BHL:	NWNESW	31	31N	7W	ECHO	ANTRIM		

53543      6361      RIVERSIDE ENERGY MICHIGAN LLC  
10691 EAST CARTER ROAD  
SUITE 201  
TRAVERSE CITY, MI 49684

API Well Number: 21-009-53543-00-00

Well Name: KNIPE 1-13 SWD

Plugging Date: 9/17/2021

Location	QT QT QT	Sec	Township	Range	Township Name	County	Feet From Section Line	Feet From DRLG Unit
SL:	SENESE	13	31N	8W	CENTRAL LAKE	ANTRIM	1580 S 496 E	
BHL:	SENESE	13	31N	8W	CENTRAL LAKE	ANTRIM		

Michigan Department of  
 Environment, Great Lakes, and Energy  
 Oil, Gas and Minerals Division  
 Updated Permits  
 9/20/2021 THRU 9/24/2021



Permit Number      Permittee Number      Permittee Name

53625      6361      RIVERSIDE ENERGY MICHIGAN LLC  
 10691 EAST CARTER ROAD  
 SUITE 201  
 TRAVERSE CITY, MI 49684

API Well Number: 21-009-53625-00-00

Well Name: FOLKER B2-6

Plugging Date: 9/17/2021

Location	QT QT QT	Sec	Township	Range	Township Name	County	Feet From Section Line	Feet From DRLG Unit
SL:	NWSEW	6	30N	7W	KEARNEY	ANTRIM	2291 N 638 W	595 N 638 W
BHL:	NWSEW	6	30N	7W	KEARNEY	ANTRIM		

53673      6361      RIVERSIDE ENERGY MICHIGAN LLC  
 10691 EAST CARTER ROAD  
 SUITE 201  
 TRAVERSE CITY, MI 49684

API Well Number: 21-009-53673-00-00

Well Name: STATE ECHO C4-31

Plugging Date: 9/17/2021

Location	QT QT QT	Sec	Township	Range	Township Name	County	Feet From Section Line	Feet From DRLG Unit
SL:	SWNESE	31	31N	7W	ECHO	ANTRIM	1314 S 720 E	1308 N 585 W
BHL:	SWNESE	31	31N	7W	ECHO	ANTRIM		

Michigan Department of  
 Environment, Great Lakes, and Energy  
 Oil, Gas and Minerals Division  
 Updated Permits  
 9/20/2021 THRU 9/24/2021



Permit Number      Permittee Number      Permittee Name

53709                  6361                  RIVERSIDE ENERGY MICHIGAN LLC  
 10691 EAST CARTER ROAD  
 SUITE 201  
 TRAVERSE CITY, MI 49684

API Well Number: 21-009-53709-00-00

Well Name: BARNES A1-6

Plugging Date: 9/17/2021

Location	QT QT QT	Sec	Township	Range	Township Name	County	Feet From Section Line	Feet From DRLG Unit
SL:	NWNWNW	6	30N	7W	KEARNEY	ANTRIM	564 N 435 W	564 N 435 W
BHL:	NWNWNW	6	30N	7W	KEARNEY	ANTRIM		

54033                  6361                  RIVERSIDE ENERGY MICHIGAN LLC  
 10691 EAST CARTER ROAD  
 SUITE 201  
 TRAVERSE CITY, MI 49684

API Well Number: 21-009-54033-00-00

Well Name: MCDIVITT A1-31

Plugging Date: 8/25/2021

Location	QT QT QT	Sec	Township	Range	Township Name	County	Feet From Section Line	Feet From DRLG Unit
SL:	NWNWNW	31	31N	7W	ECHO	ANTRIM	335 N 335 W	335 N 335 W
BHL:	NWNWNW	31	31N	7W	ECHO	ANTRIM		

Michigan Department of  
 Environment, Great Lakes, and Energy  
 Oil, Gas and Minerals Division  
 Updated Permits  
 9/20/2021 THRU 9/24/2021



Permit Number      Permittee Number      Permittee Name

54034      6361      RIVERSIDE ENERGY MICHIGAN LLC  
 10691 EAST CARTER ROAD  
 SUITE 201  
 TRAVERSE CITY, MI 49684

API Well Number: 21-009-54034-00-00

Well Name: BURNS A3-31

Plugging Date: 9/2/2021

Location	QT QT QT	Sec	Township	Range	Township Name	County	Feet From Section Line	Feet From DRLG Unit
SL:	NWNWNE	31	31N	7W	ECHO	ANTRIM	407 N 2035 E	407 N 592 W
BHL:	NWNWNE	31	31N	7W	ECHO	ANTRIM		

56184      6361      RIVERSIDE ENERGY MICHIGAN LLC  
 10691 EAST CARTER ROAD  
 SUITE 201  
 TRAVERSE CITY, MI 49684

API Well Number: 21-009-56184-00-00

Well Name: QUISENBERRY D1-25

Plugging Date: 8/26/2021

Location	QT QT QT	Sec	Township	Range	Township Name	County	Feet From Section Line	Feet From DRLG Unit
SL:	SESWSW	25	31N	8W	CENTRAL LAKE	ANTRIM	502 S 953 W	805 N 352 E
BHL:	SESWSW	25	31N	8W	CENTRAL LAKE	ANTRIM		

Michigan Department of  
 Environment, Great Lakes, and Energy  
 Oil, Gas and Minerals Division  
 Updated Permits  
 9/20/2021 THRU 9/24/2021



Permit Number      Permittee Number      Permittee Name

56294      6361      RIVERSIDE ENERGY MICHIGAN LLC  
 10691 EAST CARTER ROAD  
 SUITE 201  
 TRAVERSE CITY, MI 49684

API Well Number: 21-009-56294-00-00

Well Name: MERIWETHER C2-25

Plugging Date: 8/25/2021

Location	QT QT QT	Sec	Township	Range	Township Name	County	Feet From Section Line	Feet From DRLG Unit
SL:	SENE SW	25	31N	8W	CENTRAL LAKE	ANTRIM	1642 S 2199 W	978 N 409 E
BHL:	SENE SW	25	31N	8W	CENTRAL LAKE	ANTRIM		

56295      6361      RIVERSIDE ENERGY MICHIGAN LLC  
 10691 EAST CARTER ROAD  
 SUITE 201  
 TRAVERSE CITY, MI 49684

API Well Number: 21-009-56295-00-00

Well Name: TEETZEL D3-25

Plugging Date: 8/25/2021

Location	QT QT QT	Sec	Township	Range	Township Name	County	Feet From Section Line	Feet From DRLG Unit
SL:	NESWSE	25	31N	8W	CENTRAL LAKE	ANTRIM	804 S 1570 E	508 N 1039 W
BHL:	NESWSE	25	31N	8W	CENTRAL LAKE	ANTRIM		



Michigan Department of  
 Environment, Great Lakes, and Energy  
 Oil, Gas and Minerals Division  
 Updated Permits  
 9/20/2021 THRU 9/24/2021



Permit Number      Permittee Number      Permittee Name

56296      6361      RIVERSIDE ENERGY MICHIGAN LLC  
 10691 EAST CARTER ROAD  
 SUITE 201  
 TRAVERSE CITY, MI 49684

API Well Number: 21-009-56296-00-00

Well Name: MCQUEEN B2-36

Plugging Date: 8/25/2021

Location	QT QT QT	Sec	Township	Range	Township Name	County	Feet From Section Line	Feet From DRLG Unit
SL:	NESENW	36	31N	8W	CENTRAL LAKE	ANTRIM	1708 N 2231 W	918 S 368 E
BHL:	NESENW	36	31N	8W	CENTRAL LAKE	ANTRIM		

56683      6361      RIVERSIDE ENERGY MICHIGAN LLC  
 10691 EAST CARTER ROAD  
 SUITE 201  
 TRAVERSE CITY, MI 49684

API Well Number: 21-009-56683-00-00

Well Name: U S A & MERIWETHER A3-36

Plugging Date: 9/2/2021

Location	QT QT QT	Sec	Township	Range	Township Name	County	Feet From Section Line	Feet From DRLG Unit
SL:	SEWNW	36	31N	8W	CENTRAL LAKE	ANTRIM	899 N 1406 E	414 S 1208 W
BHL:	SEWNW	36	31N	8W	CENTRAL LAKE	ANTRIM		

Michigan Department of  
 Environment, Great Lakes, and Energy  
 Oil, Gas and Minerals Division  
 Updated Permits  
 9/20/2021 THRU 9/24/2021



Permit Number      Permittee Number      Permittee Name

58118      6559      TRIMONT ENERGY MICHIGAN LLC  
 1305 GRANDVIEW AVE, SUITE 450  
 PITTSBURGH, PA 15221

API Well Number: 21-055-38277-04-00

Well Name: PINWOOD SHORES & STATE 2-2C HD1      True Vertical Depth: 5933

Plugging Date: 8/3/2021

Location	QT QT QT	Sec	Township	Range	Township Name	County	Feet From Section Line	Feet From DRLG Unit
SL:	NENESE	2	26N	10W	EAST BAY	GRAND TRAVERSE	2244 S 145 E	
BHL:	NESWNE	2	26N	10W	EAST BAY	GRAND TRAVERSE	1729 N 1741 E	395 N 945 W

58118      6559      TRIMONT ENERGY MICHIGAN LLC  
 1305 GRANDVIEW AVE, SUITE 450  
 PITTSBURGH, PA 15221

API Well Number: 21-055-38277-05-00

Well Name: PINWOOD SHORES & STATE 2-2C HD2      True Vertical Depth: 5959

Plugging Date: 8/3/2021

Location	QT QT QT	Sec	Township	Range	Township Name	County	Feet From Section Line	Feet From DRLG Unit
SL:	NENESE	2	26N	10W	EAST BAY	GRAND TRAVERSE	2244 S 145 E	
BHL:	SESWNE	2	26N	10W	EAST BAY	GRAND TRAVERSE	2103 N 1940 E	573 S 742 W

Michigan Department of  
 Environment, Great Lakes, and Energy  
 Oil, Gas and Minerals Division  
 Updated Permits  
 9/20/2021 THRU 9/24/2021



Permit Number      Permittee Number      Permittee Name

58438      6361      RIVERSIDE ENERGY MICHIGAN LLC  
 10691 EAST CARTER ROAD  
 SUITE 201  
 TRAVERSE CITY, MI 49684

API Well Number: 21-009-58438-00-00

Well Name: SWAIN D1-30

Plugging Date: 8/25/2021

Location	QT QT QT	Sec	Township	Range	Township Name	County	Feet From Section Line	Feet From DRLG Unit
SL:	NWSWSW	30	31N	7W	ECHO	ANTRIM	1195 S 335 W	1195 S 335 W
BHL:	NWSWSW	30	31N	7W	ECHO	ANTRIM		

61174      5122      CENTURY OIL COMPANY INC  
 19305 30TH AVE  
 MARION, MI 49665

API Well Number: 21-055-29892-01-00

Well Name: WEBER 1-6A

Plugging Date: 11/11/2020

Location	QT QT QT	Sec	Township	Range	Township Name	County	Feet From Section Line	Feet From DRLG Unit
SL:	NWNWNW	6	25N	11W	MAYFIELD	GRAND TRAVERSE	367 N 469 W	367 N 469 W
BHL:	NWNWNW	6	25N	11W	MAYFIELD	GRAND TRAVERSE		

Michigan Department of  
 Environment, Great Lakes, and Energy  
 Oil, Gas and Minerals Division  
 Updated Permits  
 9/20/2021 THRU 9/24/2021



Permit Number      Permittee Number      Permittee Name

61250                      5122                      CENTURY OIL COMPANY INC  
 19305 30TH AVE  
 MARION, MI 49665

API Well Number: 21-055-29892-02-00

Well Name: WEBER 1-6A

Plugging Date: 11/11/2020

Location	QT QT QT	Sec	Township	Range	Township Name	County	Feet From Section Line	Feet From DRLG Unit
SL:	NWNWNW	6	25N	11W	MAYFIELD	GRAND TRAVERSE	367 N 469 W	367 N 469 W
BHL:	NWNWNW	6	25N	11W	MAYFIELD	GRAND TRAVERSE	367 N 469 W	367 N 469 W



Michigan Department of  
Environment, Great Lakes, and Energy  
Oil, Gas and Minerals Division  
Updated Permits  
9/20/2021 THRU 9/24/2021



Permit Number      Permittee Number      Permittee Name

**APPLICATIONS TO CHANGE WELL STATUS:**

43559                      5312                      PAXTON RESOURCES LLC  
  
132 N OTSEGO AVE  
GAYLORD, MI 49735

API Well Number: 21-137-43559-00-00

Well Name: BOTT, J A A3-13

True Vertical Depth: 1627

Approval Date: 9/20/2021

Location	QT QT QT	Sec	Township	Range	Township Name	County	Feet From Section Line	Feet From DRLG Unit
SL:	NWNWNE	13	29N	3W	OTSEGO LAKE	OTSEGO	518 N 177 W	518 N 439 W
BHL:	NWNWNE	13	29N	3W	OTSEGO LAKE	OTSEGO	444 N 367 W	444 N 367 W

Proposed Rework:                      Temporarily Abandoned

Comment:      ACOWS for TA expires on 9/20/2022

43562                      5312                      PAXTON RESOURCES LLC  
  
132 N OTSEGO AVE  
GAYLORD, MI 49735

API Well Number: 21-137-43562-00-00

Well Name: BOTT, J A A1-13

Approval Date: 9/20/2021

Location	QT QT QT	Sec	Township	Range	Township Name	County	Feet From Section Line	Feet From DRLG Unit
SL:	NWNWNW	13	29N	3W	OTSEGO LAKE	OTSEGO	347 N 610 W	347 N 610 W
BHL:	NWNWNW	13	29N	3W	OTSEGO LAKE	OTSEGO		

Proposed Rework:                      Temporarily Abandoned

Comment:      ACOWS for TA expires on 9/10/22

Michigan Department of  
 Environment, Great Lakes, and Energy  
 Oil, Gas and Minerals Division  
 Updated Permits  
 9/20/2021 THRU 9/24/2021



Permit Number      Permittee Number      Permittee Name

45917      5312      PAXTON RESOURCES LLC  
 132 N OTSEGO AVE  
 GAYLORD, MI 49735

API Well Number: 21-137-45917-00-00

Well Name: BOTT J A C3-13

Approval Date: 9/20/2021

Location	QT QT QT	Sec	Township	Range	Township Name	County	Feet From Section Line	Feet From DRLG Unit
SL:	SWNWSE	13	29N	3W	OTSEGO LAKE	OTSEGO	984 N 335 W	339 S 335 W
BHL:	SWNWSE	13	29N	3W	OTSEGO LAKE	OTSEGO		

Proposed Rework:      Temporarily Abandoned

Comment: ACOWS for TA expires on 9/10/22

52157      6371      BREITBURN OPERATING LIMITED  
 PARTNERSHIP  
 1111 BAGBY STREET, SUITE 1600  
 HOUSTON, TX 77002

API Well Number: 21-137-52157-00-00

Well Name: FONTINALIS CLUB D1-17

Approval Date: 9/24/2021

Location	QT QT QT	Sec	Township	Range	Township Name	County	Feet From Section Line	Feet From DRLG Unit
SL:	SWSWSW	17	32N	2W	CORWITH	OTSEGO	330 S 415 W	330 S 415 W
BHL:	SWSWSW	17	32N	2W	CORWITH	OTSEGO		

Proposed Rework:      Temporarily Abandoned

Comment: ACOWS for TA expires on 9/24/2022

Michigan Department of  
 Environment, Great Lakes, and Energy  
 Oil, Gas and Minerals Division  
 Updated Permits  
 9/20/2021 THRU 9/24/2021



Permit Number      Permittee Number      Permittee Name

52821      6371      BREITBURN OPERATING LIMITED  
 PARTNERSHIP  
 1111 BAGBY STREET, SUITE 1600  
 HOUSTON, TX 77002

API Well Number: 21-137-52821-00-00

Well Name: FONTINALIS CLUB A4-24

Approval Date: 9/24/2021

Location	QT QT QT	Sec	Township	Range	Township Name	County	Feet From Section Line	Feet From DRLG Unit
SL:	NWNENE	24	32N	3W	CORWITH	OTSEGO	330 N 990 E	330 N 990 E
BHL:	NWNENE	24	32N	3W	CORWITH	OTSEGO		

Proposed Rework:      Temporarily Abandoned

Comment: ACOWS for TA expires on 9/24/2022

53083      6371      BREITBURN OPERATING LIMITED  
 PARTNERSHIP  
 1111 BAGBY STREET, SUITE 1600  
 HOUSTON, TX 77002

API Well Number: 21-137-53083-00-00

Well Name: FONTINALIS CLUB A2-18

Approval Date: 9/24/2021

Location	QT QT QT	Sec	Township	Range	Township Name	County	Feet From Section Line	Feet From DRLG Unit
SL:	NENENW	18	32N	2W	CORWITH	OTSEGO	330 N 125 E	
BHL:	NENENW	18	32N	2W	CORWITH	OTSEGO		

Proposed Rework:      Temporarily Abandoned

Comment: ACOWS for TA expires on 9/24/2022

Michigan Department of  
 Environment, Great Lakes, and Energy  
 Oil, Gas and Minerals Division  
 Updated Permits  
 9/20/2021 THRU 9/24/2021



Permit Number      Permittee Number      Permittee Name

53084      6371      BREITBURN OPERATING LIMITED  
 PARTNERSHIP  
 1111 BAGBY STREET, SUITE 1600  
 HOUSTON, TX 77002

API Well Number: 21-137-53084-00-00

Well Name: FONTINALIS CLUB A1-18

Approval Date: 9/24/2021

Location	QT QT QT	Sec	Township	Range	Township Name	County	Feet From Section Line	Feet From DRLG Unit
SL:	NWNWNW	18	32N	2W	CORWITH	OTSEGO	534 N 330 W	
BHL:	NWNWNW	18	32N	2W	CORWITH	OTSEGO		

Proposed Rework:      Temporarily Abandoned

Comment: ACOWS for TA expires on 9/24/22

53523      6371      BREITBURN OPERATING LIMITED  
 PARTNERSHIP  
 1111 BAGBY STREET, SUITE 1600  
 HOUSTON, TX 77002

API Well Number: 21-137-53523-00-00

Well Name: FONTINALIS CLUB C1-18

Approval Date: 9/24/2021

Location	QT QT QT	Sec	Township	Range	Township Name	County	Feet From Section Line	Feet From DRLG Unit
SL:	NWNWSW	18	32N	2W	CORWITH	OTSEGO	2356 S 330 W	1012 S 330 W
BHL:	NWNWSW	18	32N	2W	CORWITH	OTSEGO		

Proposed Rework:      Temporarily Abandoned

Comment: ACOWS for TA expires on 9/24/2022



Michigan Department of  
 Environment, Great Lakes, and Energy  
 Oil, Gas and Minerals Division  
 Updated Permits  
 9/20/2021 THRU 9/24/2021



MICHIGAN DEPARTMENT OF  
 ENVIRONMENT, GREAT LAKES, AND ENERGY

Permit Number      Permittee Number      Permittee Name

**RECORD OF CHANGE OF WELL STATUS:**

61483                      7772                      LAMBDA ENERGY RESOURCES LLC  
 12012 Wickchester  
 Suite 300  
 Houston, TX 77079 USA

API Well Number: 21-039-62000-00-00

Well Name: STATE FREDERIC 3-16

Change Date: 9/16/2021

Location	QT QT QT	Sec	Township	Range	Township Name	County	Feet From Section Line	Feet From DRLG Unit
SL:	SWNWNW	16	28N	4W	FREDERIC	CRAWFORD	1286 N 158 W	1286 N 1168 E
BHL:	SWNWNW	16	28N	4W	FREDERIC	CRAWFORD	1293 N 136 W	1293 N 1189 E

Proposed Rework: Reworked to Perforate & Test Current Formation

Comment: Reworked to perf and test the A-1 Carb and Niagaran formations.

