

Michigan Department of  
Environment, Great Lakes, and Energy  
Oil, Gas and Minerals Division

PERMIT LIST

9/27/2021 THRU 10/1/2021



Permit Number: 61562  
Issue Date: 9/28/2021  
Permittee Number: 5320  
Permittee Name: SAVOY ENERGY LP  
920 HASTINGS STREET, SUITE A  
PO BOX 1560  
TRAVERSE CITY, MI 49685-1560

API Well No: 21-055-62000-00-00

Prev Permit:

Well Name: WEBER 2-6

Surface Owner: Weber, Joseph J.  
and Donna M.

Well Type: Oil Well

True Vertical Depth: 5975FT

Permit Type: Drill

Target Formation: NIAGARAN

H2S Present? No

Deepest Formation: NIAGARAN

Page 1

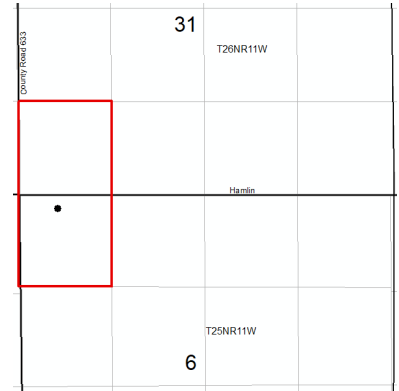

80-Acre Drilling Unit, SW/4 SW/4  
Section 31, NW/4 NW/4 Section 6.

Location:	QT QT QT	Sec	Township	Range	Township Name	County	Feet From Section Line	Feet From DRLG Unit Line
SL:	NWNWNW	6	25N	11W	MAYFIELD	GRAND TRAVERSE	199 N 544 W	
BHL:	NWNWNW	6	25N	11W	MAYFIELD	GRAND TRAVERSE	199 N 544 W	1165 S 758 E

61563  
10/1/2021  
7772  
LAMBDA ENERGY RESOURCES  
LLC  
12012 Wickchester  
Suite 300  
Houston, TX 77079

API Well No: 21-141-62298-00-00

Prev Permit:

Well Name: LAMBDA-STATE CASE 7-28

Surface Owner: Lambda Energy  
Resources, LLC

Well Type: Oil Well

True Vertical Depth: 3685FT

Permit Type: Drill

Target Formation: NIAGARAN BROWN

H2S Present? No

Deepest Formation: NIAGARAN GRAY

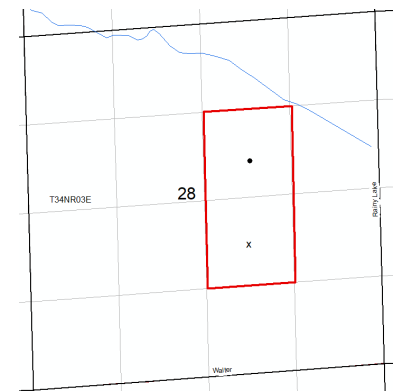

80-Acre Drilling Unit, SW/4 NE/4,  
NW/4 SE/4, Section 28

Location:	QT QT QT	Sec	Township	Range	Township Name	County	Feet From Section Line	Feet From DRLG Unit Line
SL:	NWNWSE	28	34N	3E	CASE	PRESQUE ISLE	1985 S 1959 E	
BHL:	SESWNE	28	34N	3E	CASE	PRESQUE ISLE	2072 N 1909 E	768 N 669 W

Michigan Department of  
Environment, Great Lakes, and Energy  
Oil, Gas and Minerals Division

PERMIT LIST

9/27/2021 THRU 10/1/2021



Permit Number      Issue Date      Permittee  
61564                10/1/2021      Number  
6498

Permittee  
Name  
WOLVERINE GAS AND OIL  
COMPANY OF MICHIGAN LLC  
ONE RIVERFRONT PLAZA  
55 CAMPAU, NW  
GRAND RAPIDS, MI 49503

Page 2

API Well No: 21-077-62032-00-00

Prev Permit:

Well Name: SUTHERLAND 7-1 HD1

Surface Owner: Mark W. Sutherland  
and Brad F. Sutherland

Well Type: Oil Well

True Vertical Depth: 3515FT

Permit Type: Drill

Target Formation: TRENTON

H2S Present? Yes

Deepest Formation: TRENTON

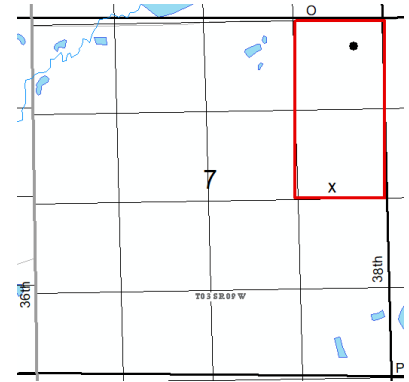

80-Acre R303 Drilling Unit, E/2 NE/4  
Section 7

Location:	QT QT QT	Sec	Township	Range	Township Name	County	Feet From Section Line	Feet From DRLG Unit Line
SL:	SWSENE	7	3S	9W	CLIMAX	KALAMAZOO	2487 N 815 E	
BHL:	NENENE	7	3S	9W	CLIMAX	KALAMAZOO	340 N 415 E	340 N 415 E

Michigan Department of  
Environment, Great Lakes, and Energy  
Oil, Gas and Minerals Division

Updated Permits

9/27/2021 THRU 10/1/2021



Permit Number      Permittee Number      Permittee Name

Page 1

**RECORD OF WELL PLUGGING:**

19885      4428      MID MICHIGAN GAS STORAGE CO  
PO BOX 2446  
HOUSTON, TX 77252-2446 USA

API Well Number: 21-133-19885-00-00

Well Name: SHOOK 1

Plugging Date: 9/22/2021

Location	QT QT QT	Sec	Township	Range	Township Name	County	Feet From Section Line	Feet From DRLG Unit
SL:	N2SESE	6	17N	10W	RICHMOND	OSCEOLA	1040 S 560 E	280 N 560 E
BHL:	N2SESE	6	17N	10W	RICHMOND	OSCEOLA		

-----

Michigan Department of  
Environment, Great Lakes, and Energy  
Oil, Gas and Minerals Division

Updated Permits

9/27/2021 THRU 10/1/2021



Permit Number      Permittee Number      Permittee Name

**APPLICATIONS TO CHANGE WELL STATUS:**

23243                      491                      CONSUMERS ENERGY CO  
  
1945 W PARNALL RD  
JACKSON, MI 49201

API Well Number: 21-005-23243-00-00

Well Name: CONSUMERS POWER CO 251

Approval Date: 3/25/2021

Location	QT QT QT	Sec	Township	Range	Township Name	County	Feet From Section Line	Feet From DRLG Unit
SL:	W2NENW	14	4N	14W	OVERISEL	ALLEGAN	660 N 690 E	660 N 30 E
BHL:	W2NENW	14	4N	14W	OVERISEL	ALLEGAN		

Proposed Rework: ACOWS to Underream Open Hole

Comment: ACOWS to clean well, log, underream, and return well to service expires 9/30/21; Based on E-mail correspondence, decision was made not to underream, so no RCOWS will be received for this.

33710                      6371                      BREITBURN OPERATING LIMITED  
PARTNERSHIP  
1111 BAGBY STREET, SUITE 1600  
  
HOUSTON, TX 77002

API Well Number: 21-039-33710-00-00

Well Name: STATE BEAVER CREEK 13

Approval Date: 9/29/2021

Location	QT QT QT	Sec	Township	Range	Township Name	County	Feet From Section Line	Feet From DRLG Unit
SL:	SWNESE	7	25N	4W	BEAVER CREEK	CRAWFORD	986 N 967 E	330 S 330 W
BHL:	SWNESE	7	25N	4W	BEAVER CREEK	CRAWFORD		

Proposed Rework: ACOWS to Perforate and Test Current Formation

Comment: ACOWS to re-perf and test current formation expires on 9/29/22

Michigan Department of  
Environment, Great Lakes, and Energy  
Oil, Gas and Minerals Division

Updated Permits

9/27/2021 THRU 10/1/2021



Permit Number      Permittee Number      Permittee Name

**RECORD OF CHANGE OF WELL STATUS:**

37794                  6310                          CORE ENERGY LLC  
  
1011 NOTEWARE DRIVE  
TRAVERSE CITY, MI 49686

API Well Number: 21-137-37794-00-00

Well Name: JANIK & MACKOWIAC 1-11                  True Vertical Depth: 6084

Change Date: 7/27/2021

Location	QT QT QT	Sec	Township	Range	Township Name	County	Feet From Section Line	Feet From DRLG Unit
SL:	NESESE	11	30N	3W	BAGLEY	OTSEGO	1155 S 562 E	
BHL:	NESWSE	11	30N	3W	BAGLEY	OTSEGO	710 S 703 W	610 N 617 E

Proposed Rework: Reworked to Perforate & Test Current Formation

Comment: Reworked to perf and test the A1 Carbonate F/ 5968' T/ 5978'

