

Michigan Department of  
Environment, Great Lakes, and Energy  
Oil, Gas and Minerals Division

PERMIT APPLICATIONS

5/28/2019 THRU 5/31/2019



Application Number      Date Received      Permittee Number      Permittee Name      Page 1

336      05/29/2019      6310      CORE ENERGY LLC  
1011 NOTEWARE DRIVE  
TRAVERSE CITY, MI49686

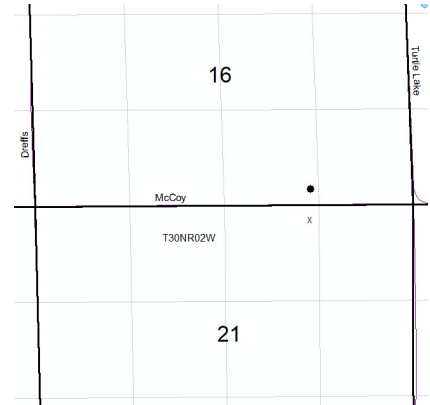

Prev Permit: 61186

Well Name: CHESTER 16 UNIT 8-16      Surface Owner: JEFF WEAVER

Well Type: OTI      True Vertical Depth: 6356

Permit Type: Convert      Target Formation: A-1 CARBONATE

H2S Present? No      Deepest Formation: NIAGARAN GRAY

Chester EOR Unit, Order 09-2013,  
320 acres: Sec 16: SE/4, SE/4 SW/4;  
Sec 21: NE/4 NW/4, N/2 NE/4

Location:	QT QT QT	Sec	Township	Range	Township Name	County	Feet From Section Line	Feet From DRLG Unit Line
SL:	NENWNE	21	30N	2W	CHESTER	OTSEGO	195 N 1405 E	
BHL:	SESWSE	16	30N	2W	CHESTER	OTSEGO	237 S 1364 E	1556 S 1373 E

340      05/29/2019      6310      CORE ENERGY LLC  
1011 NOTEWARE DRIVE  
TRAVERSE CITY, MI49686

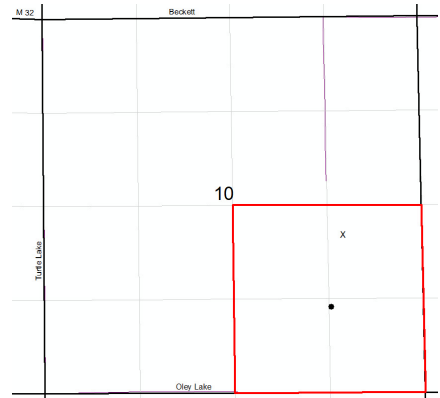

Prev Permit:

Well Name: DUFFIELD 4-10      Surface Owner: DAVID M DUFFIELD

Well Type: OIL      True Vertical Depth: 6249

Permit Type: Drill      Target Formation: A-1 CARBONATE

H2S Present? No      Deepest Formation: NIAGARAN GRAY

160 acre R303 exception requested:  
SE/4 Sec 10

Location:	QT QT QT	Sec	Township	Range	Township Name	County	Feet From Section Line	Feet From DRLG Unit Line
SL:	NWNESE	10	30N	2W	CHESTER	OTSEGO	2094 S 1021 E	
BHL:	NWSESE	10	30N	2W	CHESTER	OTSEGO	1190 S 1198 E	1190 S 1198 E

Michigan Department of  
Environment, Great Lakes, and Energy  
Oil, Gas and Minerals Division

PERMIT APPLICATIONS

5/28/2019 THRU 5/31/2019



Application Number

Date Received

Permittee  
Number

Permittee  
Name

Page 2

341 05/29/2019 6418 W B OSBORN OIL AND GAS  
OPERATIONS LTD  
P.O. BOX 8C  
SAN ANTONIO, TX 78217

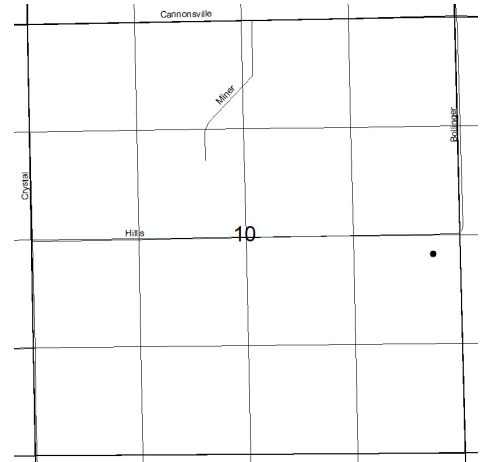

Prev Permit:

Well Name: WB Osborn SWD 1-22

Surface Owner: W.B. Osborn Oil &  
Gas Operations

Well Type: BDW

True Vertical Depth: 3500

Permit Type: Drill

Target Formation: DUNDEE

H2S Present? Yes

Deepest Formation: DUNDEE

Brine Disposal Well: No drilling unit

Location:	QT QT QT	Sec	Township	Range	Township Name	County	Feet From Section Line	Feet From DRLG Unit Line
SL:	NENESE	22	11N	5W	FERRIS	MONTCALM	2426 S 314 E	
BHL:	NENENE	22	11N	5W	FERRIS	MONTCALM	2426 S 314 E	

347 05/31/2019 5303 KLINGLER AUTOMATIC  
INDUSTRIES INC  
837 DeGurse Avenue  
  
Marine City, MI 48039

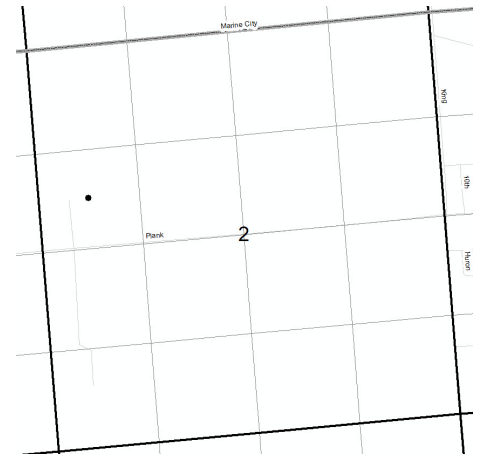

Prev Permit: 23394

Well Name: UMLAUF 1

Surface Owner: NOT PROVIDED

Well Type: BDW

True Vertical Depth: 2301

Permit Type: Convert

Target Formation: NIAGARAN

H2S Present? No

Deepest Formation: NIAGARAN

Brine Disposal Well: No drilling unit

Location:	QT QT QT	Sec	Township	Range	Township Name	County	Feet From Section Line	Feet From DRLG Unit Line
SL:	NWSWNW	2	3N	16E	COTTRELL-VILLE	SAINT CLAIR	660 S 660 W	
BHL:	NWSWNW	2	3N	16E	COTTRELL-VILLE	SAINT CLAIR	660 S 660 W	

Michigan Department of  
Environment, Great Lakes, and Energy  
Oil, Gas and Minerals Division

Updated Permits

5/28/2019 THRU 5/31/2019



Permit Number      Permittee Number      Permittee Name

Page 1

**PLUGGING INSTRUCTIONS ISSUED:**

12756      491      CONSUMERS ENERGY CO  
  
1945 W PARNALL RD  
JACKSON, MI 49201

API Well Number: 21-035-12756-00-00

Well Name: MICHIGAN GAS STORAGE CO  
228

Plug Inst. Issue Date: 5/24/2019

Location	QT QT QT	Sec	Township	Range	Township Name	County	Feet From Section Line	Feet From DRLG Unit
SL:	CNNWSW	31	20N	6W	WINTERFIELD	CLARE	660 N 530 W	660 N 530 W

Comment: App. to P&A expires 5/24/20.

20622      491      CONSUMERS ENERGY CO  
  
1945 W PARNALL RD  
JACKSON, MI 49201

API Well Number: 21-035-20622-00-00

Well Name: M G S C 919

Plug Inst. Issue Date: 5/24/2019

Location	QT QT QT	Sec	Township	Range	Township Name	County	Feet From Section Line	Feet From DRLG Unit
SL:	SESESW	28	20N	6W	WINTERFIELD	CLARE	100 S 100 E	100 S 100 E

Comment: App. to P&A expires 5/24/20.

Michigan Department of  
Environment, Great Lakes, and Energy  
Oil, Gas and Minerals Division

Updated Permits

5/28/2019 THRU 5/31/2019



Permit Number      Permittee Number      Permittee Name

Page 2

53418      5257      STURGEON POINT DEVELOPMENT  
CO  
311 E FRONT STE 2  
PO BOX 4356  
TRAVERSE CITY, MI49685-4356

API Well Number: 21-125-53418-00-00

Well Name: STATE TROY & MSU 1-9

True Vertical Depth: 3228

Plug Inst. Issue Date: 5/22/2019

Location	QT QT QT	Sec	Township	Range	Township Name	County	Feet From Section Line	Feet From DRLG Unit
SL:	SWNENW	9	2N	11E	TROY	OAKLAND	1204 N 1341 W	
BHL:	NWNWNW	9	2N	11E	TROY	OAKLAND	360 N 393 W	360 N 393 W

Comment: App. to P&A expires 5/22/20.

Michigan Department of  
Environment, Great Lakes, and Energy  
Oil, Gas and Minerals Division

Updated Permits

5/28/2019 THRU 5/31/2019



Permit Number      Permittee Number      Permittee Name

**RECORD OF WELL PLUGGING:**

41150      4745      BELDEN AND BLAKE CORP DBA  
WARD LAKE ENERGY

685 EAST M-32 SUITE 201  
GAYLORD, MI 49735

API Well Number: 21-137-41150-00-00

Well Name: WALKER 1-29

Plugging Date: 5/20/2019

Location	QT QT QT	Sec	Township	Range	Township Name	County	Feet From Section Line	Feet From DRLG Unit
SL:	SWNWNE	29	30N	1W	CHARLTON	OTSEGO	810 N 330 W	498 S 330 W

41154      4745      BELDEN AND BLAKE CORP DBA  
WARD LAKE ENERGY

685 EAST M-32 SUITE 201  
GAYLORD, MI 49735

API Well Number: 21-137-41154-00-00

Well Name: WALKER 4-20

Plugging Date: 5/10/2019

Location	QT QT QT	Sec	Township	Range	Township Name	County	Feet From Section Line	Feet From DRLG Unit
SL:	NWSWSE	20	30N	1W	CHARLTON	OTSEGO	975 S 330 W	330 N 330 W

Michigan Department of  
Environment, Great Lakes, and Energy  
Oil, Gas and Minerals Division

Updated Permits

5/28/2019 THRU 5/31/2019



Permit Number      Permittee Number      Permittee Name

Page 4

42061      4745      BELDEN AND BLAKE CORP DBA  
WARD LAKE ENERGY

685 EAST M-32 SUITE 201  
GAYLORD, MI 49735

API Well Number: 21-137-42061-00-00

Well Name: WESANEN A1-20

Plugging Date: 5/16/2019

Location	QT QT QT	Sec	Township	Range	Township Name	County	Feet From Section Line	Feet From DRLG Unit
SL:	SWNWNW	20	30N	1W	CHARLTON	OTSEGO	937 N 420 W	369 S 420 W

42062      4745      BELDEN AND BLAKE CORP DBA  
WARD LAKE ENERGY

685 EAST M-32 SUITE 201  
GAYLORD, MI 49735

API Well Number: 21-137-42062-00-00

Well Name: WESANEN B1-20

Plugging Date: 5/14/2019

Location	QT QT QT	Sec	Township	Range	Township Name	County	Feet From Section Line	Feet From DRLG Unit
SL:	SWSWNW	20	30N	1W	CHARLTON	OTSEGO	464 S 382 W	464 S 382 W

Michigan Department of  
Environment, Great Lakes, and Energy  
Oil, Gas and Minerals Division

Updated Permits

5/28/2019 THRU 5/31/2019



Permit Number      Permittee Number      Permittee Name

**APPLICATIONS TO CHANGE WELL STATUS:**

61354      6498      WOLVERINE GAS AND OIL  
COMPANY OF MICHIGAN LLC  
ONE RIVERFRONT PLAZA  
55 CAMPAU, NW  
GRAND RAPIDS, MI 49503

API Well Number: 21-077-62006-02-00

Well Name: CLOUGH 29-1B

Approval Date: 5/20/2019

Location	QT QT QT	Sec	Township	Range	Township Name	County	Feet From Section Line	Feet From DRLG Unit
SL:	NENESE	29	3S	9W	CLIMAX	KALAMAZOO	2431 S 100 E	
BHL:	NENESE	29	3S	9W	CLIMAX	KALAMAZOO	2317 S 624 E	990 S 709 W

Proposed Rework: ACOWS to Perforate and Test Current Formation

Comment: ACOWS to move uphole in the Trenton Fmn. (existing fmn.), add perms and acid stimulate, expires 12/31/19.

21521      6003      SUNOCO PARTNERS MARKETING  
AND TERMINALS LP  
3807 WEST CHESTER PIKE  
NEWTOWN SQUARE, PA 19073

API Well Number: 21-163-21521-00-00

Well Name: SUN INKSTER JUNCTION 5

Approval Date: 5/23/2019

Location	QT QT QT	Sec	Township	Range	Township Name	County	Feet From Section Line	Feet From DRLG Unit
SL:	NWNWNW	7	3S	10E	TAYLOR	WAYNE	420 N 570 W	205 N 180 E

Proposed Rework: ACOWS to Repair Casing or Squeeze Cement

Comment: ACOWS to install an internal casing patch on the 10 3/4" csg. and perform MIT, expires 5/23/20.