

# Insufficient Data to Contour

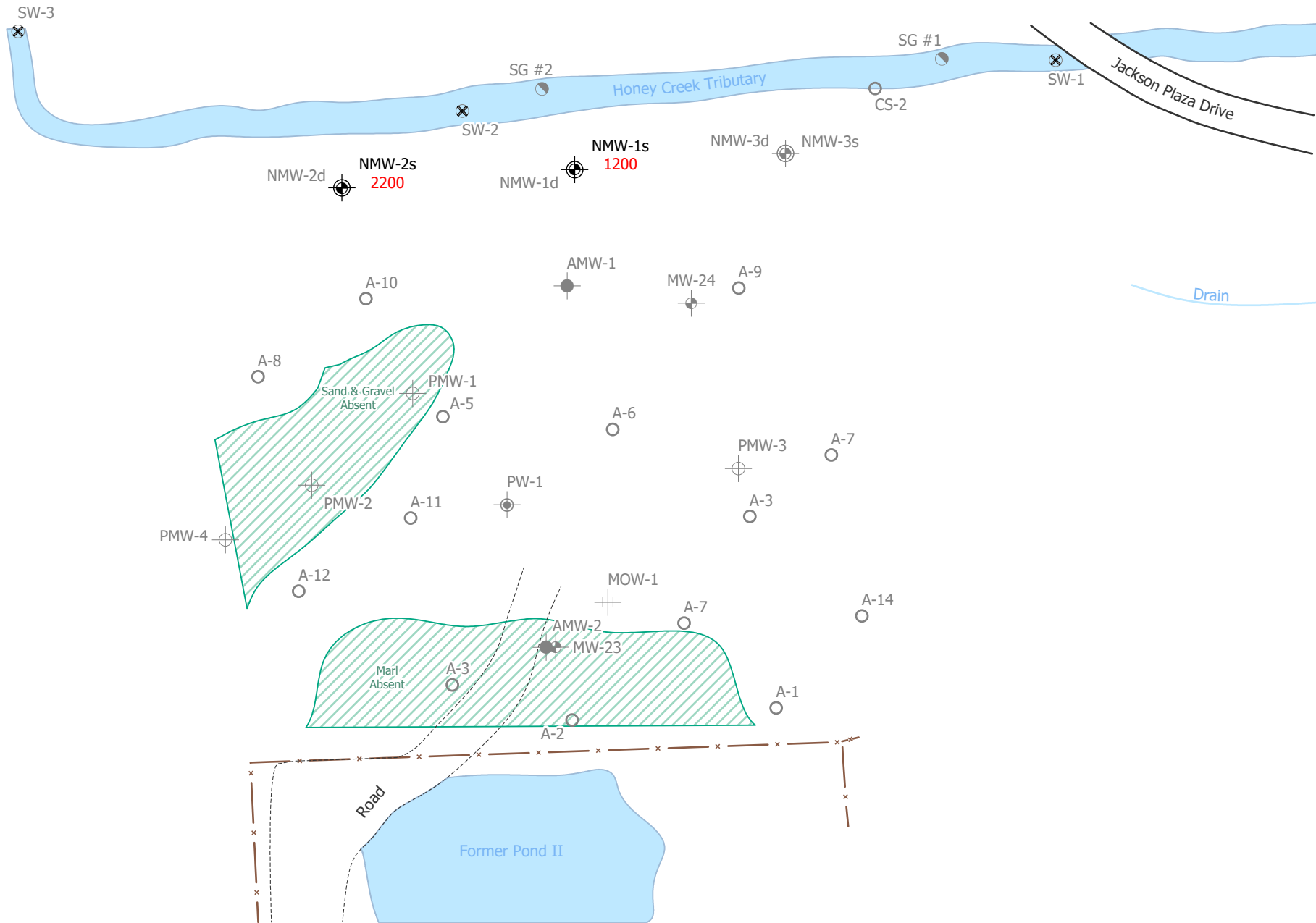

**1,4-Dioxane Isoconcentration Map**

Observation Well: Circle with crosshair  
 Aperture Monitoring Well: Circle with dot  
 Aeration: Circle with horizontal lines  
 Surface Water: Circle with vertical lines  
 Staff Gauge: Circle with horizontal lines and vertical bar  
 1,4-Dioxane Isoconcentration Contour: Solid line  
 #1: Red square  
 #2: Blue square  
 Data Not Used: Circle with 'X'

**1,4-Dioxane Isoconcentration Map**

Marshy Area - Peat (October 2020 - March 2021)

Gelman Sciences, Scio Twp., Washtenaw County, Michigan

DRAWN BY	DATE
saml	4/15/2021
PROJECT NO.	SCALE
806500	1:960
FILE LOCATION	
K:\GIS\806500\806500_000000_Peal Copy1.rxd	
2020/04/15 10:48 Revised Project.mxd	
2021/04/15/15_1521_2021.rxd	
SOURCES	
FW, MGL, Gelman Sciences	

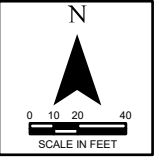

# Unable to Contour Due to Flat Gradient

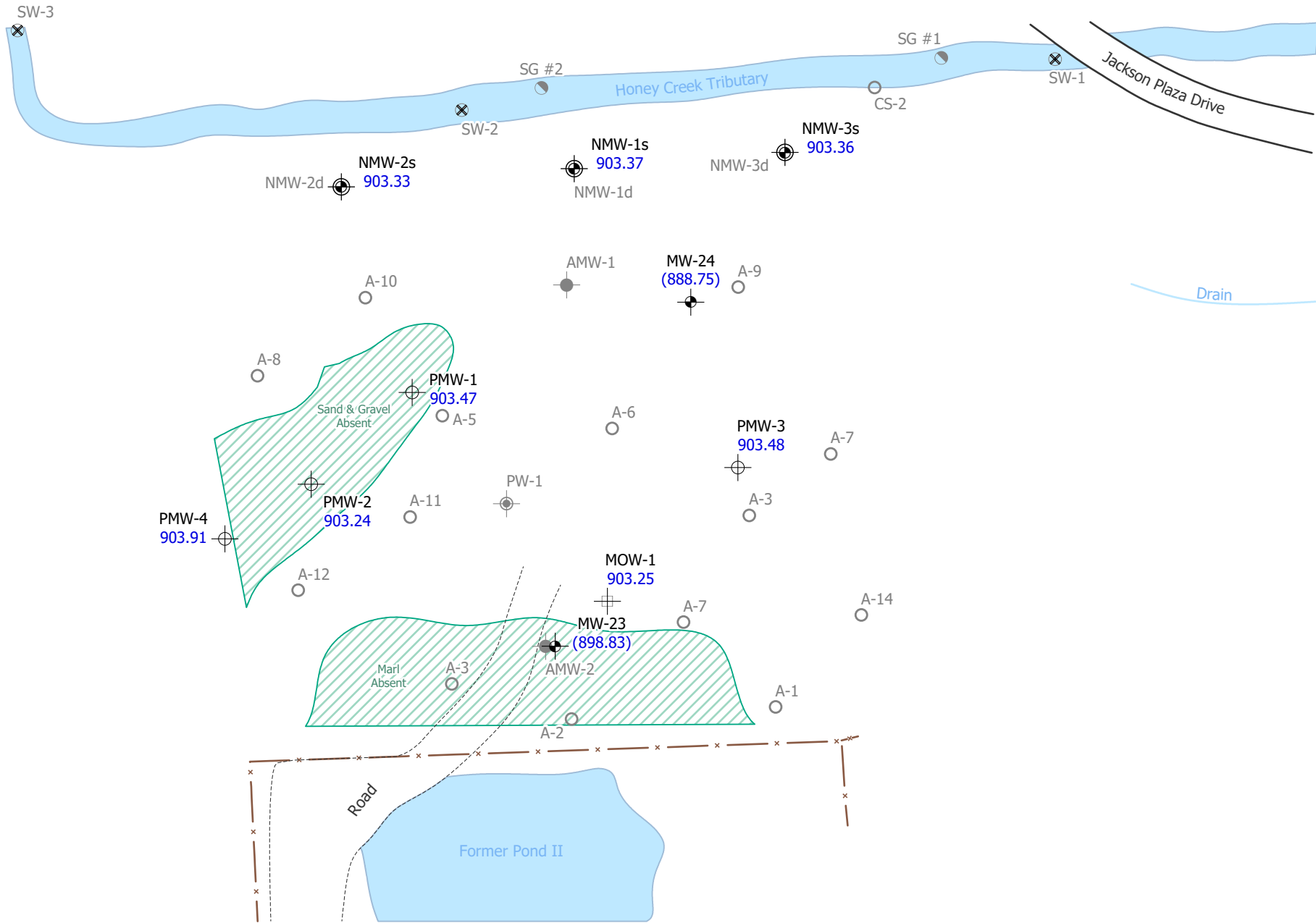

<ul style="list-style-type: none"> <li>Aperture Monitoring Well</li> <li>Aperture</li> <li>Surface Water</li> <li>Staff Gauge</li> <li>Potentiometric Surface Contour</li> <li>Potentiometric Elevation</li> <li>#</li> <li>Data Not Used</li> <li>(#)</li> </ul>	<ul style="list-style-type: none"> <li>Observation Well</li> <li>Purge Well/Slump</li> <li>Monitoring Well</li> <li>Nested Monitoring Well</li> <li>Peat Monitoring Well</li> </ul>
---	---

**Potentiometric Surface Map**  
 Marshy Area - Peat (April 12, 2021)  
 Gelman Sciences, Scio Twp., Washtenaw County, Michigan

DRAWN BY	DATE
saml	4/16/2021
PROJECT NO.	SCALE
806500	1:960
FILE LOCATION	
H:\GIS\806500\806500\000000\Peat Copy1.rxd	
2021/04/12 10:48 Revised Project	
2021/04/12/12_12/21_PSC.rxd	
SOURCES	
FWS, MGLL, Gelman Sciences	

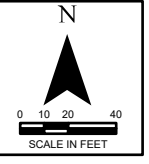

# Insufficient Data to Contour

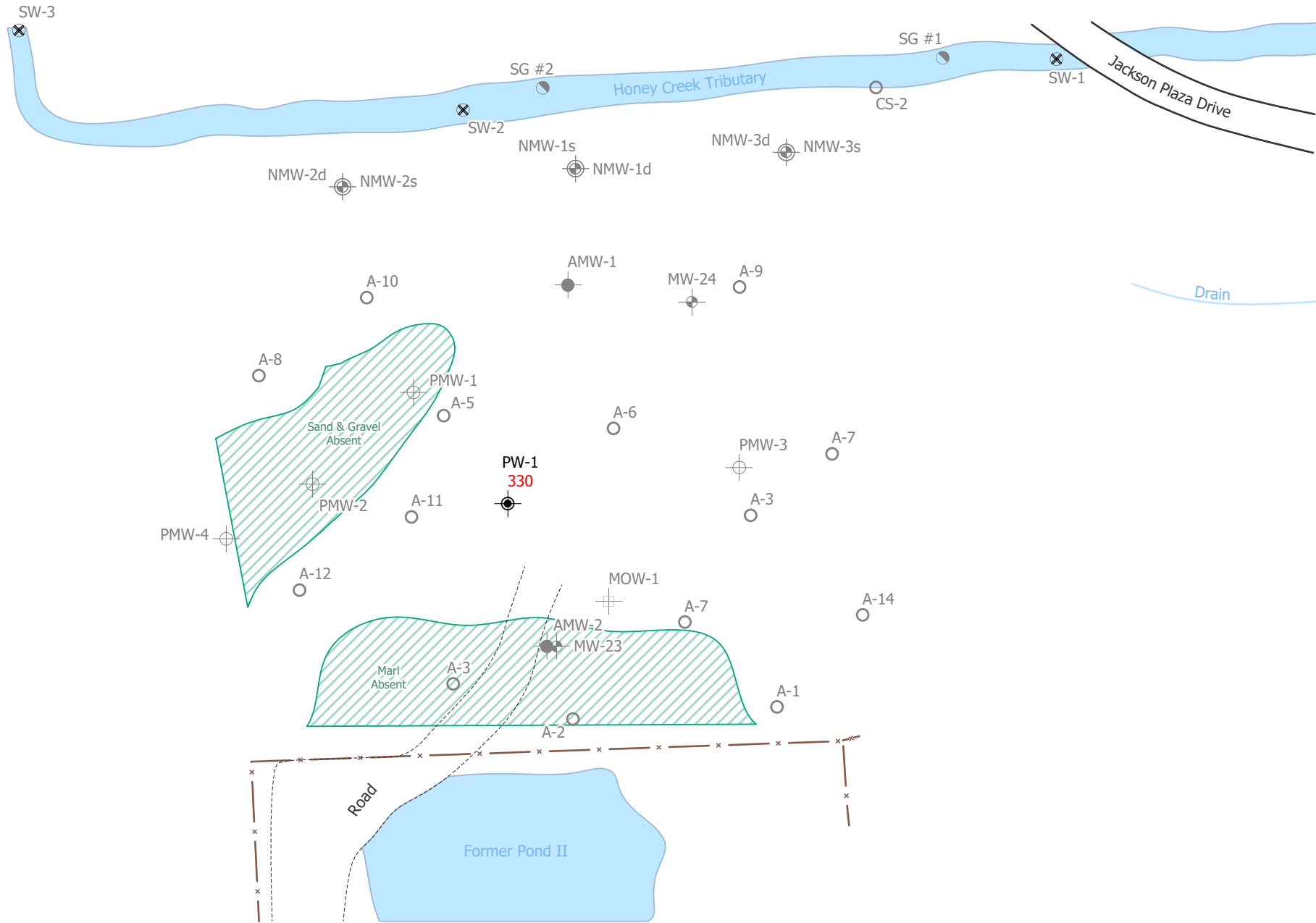

**Legend**

- Aperture Monitoring Well
- Aperture
- Surface Water
- Staff Gauge
- 1,4-Dioxane Isoconcentration Contour
- #
- Data Not Used
- (#)

Observation Well  
 Pump Well/Slump  
 Monitoring Well  
 Nested Monitoring Well  
 Feet Monitoring Well

**1,4-Dioxane Isoconcentration Map**  
 Marshy Area - Sand (October 2020 - March 2021)  
 Gelman Sciences, Scio Twp., Washtenaw County, Michigan

DRAWN BY	DATE
saml	4/15/2021
PROJECT NO.	SCALE
806500	1:960
FILE LOCATION	
<small>           H:\GIS\806500\806500\806500_Prel_Conc\1,4D            2020\Fig1_1,4D Isoconcentration Map.mxd            2021\Fig1,4D_SAND_ISO.mxd         </small>	
SOURCES	
<small>           FW, MGL, Gelman Sciences         </small>	

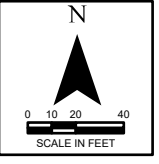

# Unable to Contour Due to Flat Gradient

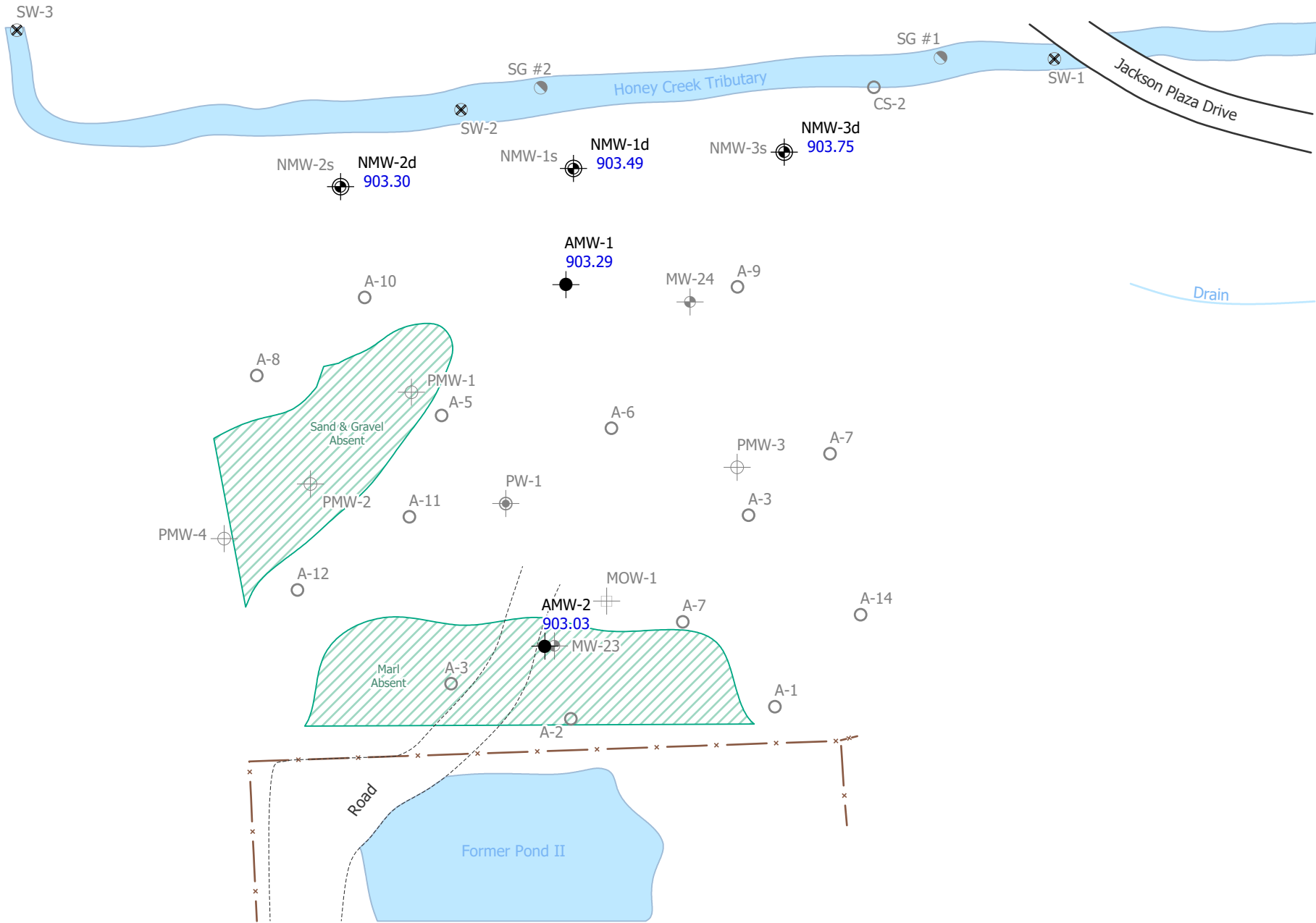

Arterial Monitoring Well	●
Aperture	○
Surface Water	○
Staff Gauge	⊗
Potentiometric Surface Contour	—
#	(Elev.)
Dist Not Used	(N/A)
Observation Well	⊕
Purge Well/Slump	⊕
Monitoring Well	⊕
Neot Monitoring Well	⊕
Piez Monitoring Well	⊕

**Potentiometric Surface Map**  
**Marshy Area - Sand (April 12, 2021)**  
 Gelman Sciences, Scio Twp., Washtenaw County, Michigan

DRAWN BY	DATE
saml	4/16/2021
PROJECT NO.	SCALE
806500	1:960
FILE LOCATION <small>H:\proj\806500\806500\000000\Plot Copy\CAD        2021\Fig1 - 10M Revised.dwg        2021\Fig111_SAND_PSC.dwg</small>	
SOURCES <small>PW, MGL, Gelman Sciences</small>	

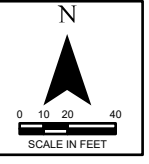

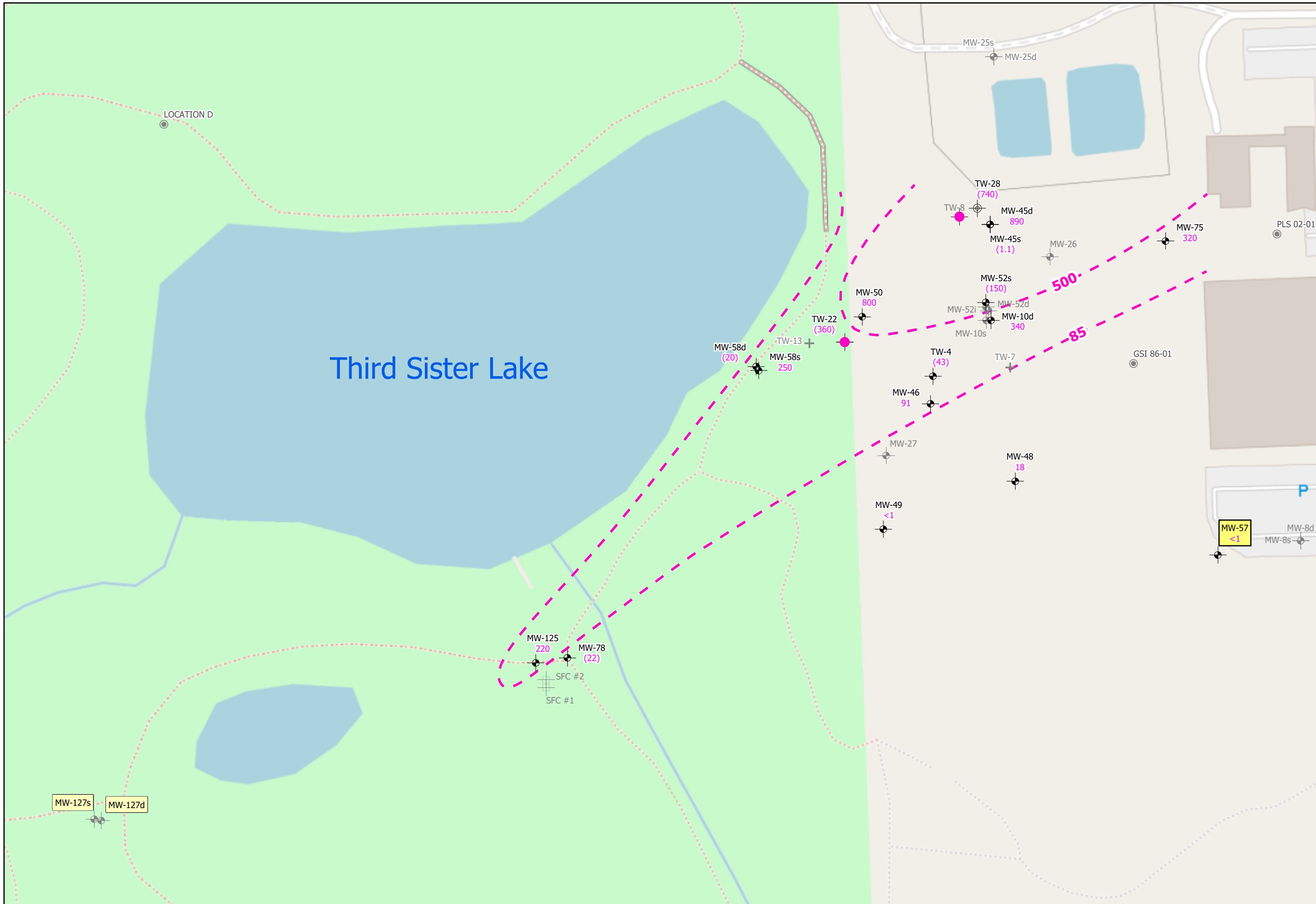

**Well Type**

- + Abandoned Well
- + Artesian Well
- + Extraction Well
- + Injection Well
- + Monitor Well
- + Production Well
- + Current/Former Drinking Water Well
- + SW & C3 Extraction Well Operating During Sampling
- + Soil Boring

**1,4-Dioxane Isoconcentration Contours**

- - - Unit C3 SW Property
- - - Other Farms
- - - Potentiometric Surface Elevation
- - - Data Not Used
- - - Compliance Monitoring Well

**1,4-Dioxane Isoconcentration Map**

Southwest Property (October 2020 - March 2021)

Gelman Sciences, Scio Twp., Washtenaw County, Michigan

<b>DRAWN BY</b> sami	<b>DATE</b> 4/19/2021
<b>PROJECT NO.</b> 806500	<b>SCALE</b> 1:1,560
<b>FILE LOCATION</b> M:\Projects\806500-810000\806500 Rail Corp\CAD 2020\FINAL_1048 Plots and Projects 2021\April\0421_SW_ISO.pdf	
<b>SOURCES</b> FIM, NGDL, Gelman Sciences, © OpenStreetMap (and contributors, CC-BY-SA	

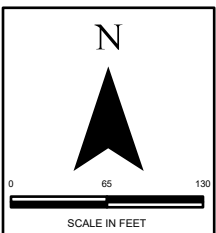

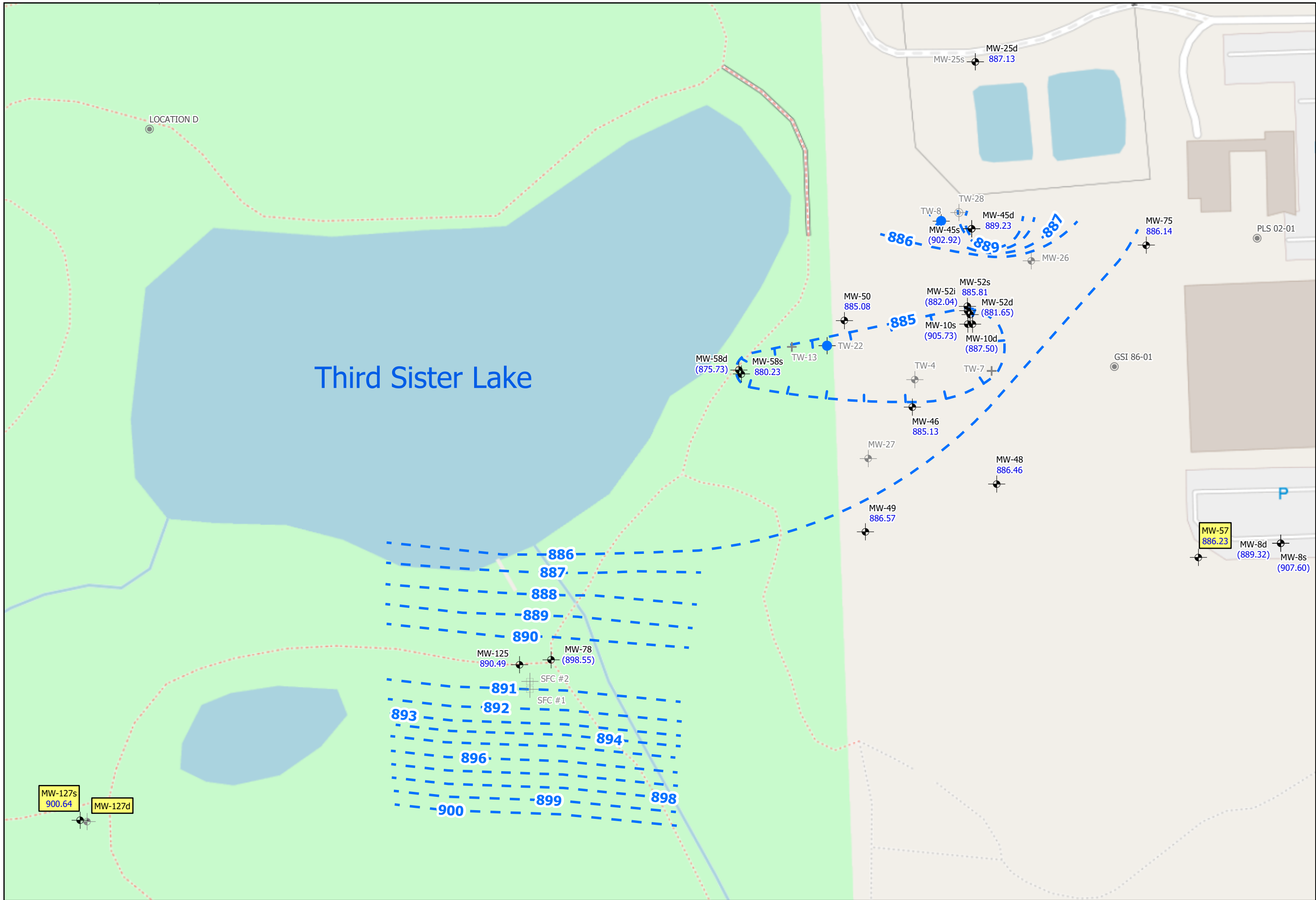

+	Plugged or Abandoned
+	Potentiometric Surface Contours
+	Potentiometric Surface Elevation
+	Unit C3 & SW Property
+	Other Items
+	Potentiometric Surface Elevation
+	Data Not Used
+	Compliance Monitoring Well
+	Soil Boring
+	Artesian Well
+	Extraction Well
+	Injection Well
+	Monitor Well
+	Production Well
+	Current/Former Drinking Water Well
+	SW & C3 Extraction Well Operating During Sampling
+	SW & C3 Extraction Well Operating During Sampling

**Potentiometric Surface Map**  
Southwest Property (April 12, 2021)  
Gelman Sciences, Scio Twp., Washtenaw County, Michigan

DRAWN BY	DATE
saml	4/19/2021
PROJECT NO.	SCALE
806500	1:1,560
FILE LOCATION	
M:\Projects\806500-810000\806500_Pail Corp\CAD	
2021\April\0421_SW_PSC.pdf	
SOURCES	
FIM, NGDL, Gelman Sciences, © OpenStreetMap (and) contributors, CC-BY-SA	

